



US00D69555S

(12) **United States Design Patent**
Wind

(10) **Patent No.:** **US D695,555 S**

(45) **Date of Patent:** **** Dec. 17, 2013**

- (54) **WATER JUG SHELF UNIT**
- (71) Applicant: **Societe des Produits Nestle S.A., Vevey (CH)**
- (72) Inventor: **Patrick Wind, Darien, CT (US)**
- (73) Assignee: **Societe des Produits Nestle S.A. (CH)**
- (**) Term: **14 Years**
- (21) Appl. No.: **29/434,470**
- (22) Filed: **Oct. 12, 2012**
- (51) **LOC (9) Cl.** **06-06**
- (52) **U.S. Cl.**
USPC **D6/705.6**
- (58) **Field of Classification Search**
USPC D6/396-397, 449, 491-492, 509-511, D6/513-514, 566-567, 672, 673, 675, D6/675.2, 705, 705.2, 705.6; 211/1, 10, 211/13.1, 27, 44, 50-53, 59.2, 59.3, 70, 211/70.1, 86.01, 119.003, 133.5, 153, 211/183-184; 312/348.3
See application file for complete search history.

D323,307	S *	1/1992	Fernandez-Bell	D12/115
5,370,245	A	12/1994	Tersch et al.		
5,678,706	A	10/1997	Husak et al.		
D399,479	S *	10/1998	Jones	D12/407
D427,963	S *	7/2000	Gogan et al.	D12/407
D430,532	S *	9/2000	Frazier	D12/407
6,202,867	B1	3/2001	Di Blasi et al.		
6,290,074	B1	9/2001	Syvuk et al.		
6,520,356	B2	2/2003	Miller, Jr.		
6,637,607	B2	10/2003	Tombu		
6,811,042	B2	11/2004	Kelly et al.		
7,254,952	B2	8/2007	Lilke		
D570,133	S *	6/2008	Goodman et al.	D6/462
D575,722	S *	8/2008	Beauchamp et al.	D12/412
D584,675	S *	1/2009	Crum, Jr.	D12/223
D599,580	S *	9/2009	Whittier et al.	D6/462
7,963,407	B2	6/2011	Donnellan		
7,988,118	B2	8/2011	Shye		
D651,506	S *	1/2012	Nilsson	D8/381

(Continued)

FOREIGN PATENT DOCUMENTS

EP	0062374	A2	10/1982
WO	98/03098	A1	1/1998
WO	2005/044060	A1	5/2005

Primary Examiner — Kelley Donnelly

(74) *Attorney, Agent, or Firm* — Thompson Coburn LLP

(56) **References Cited**
U.S. PATENT DOCUMENTS

3,606,023	A	9/1971	Edmunds
3,746,178	A	7/1973	Wagschal
3,783,801	A	1/1974	Engman
3,831,533	A	8/1974	Kellogg
4,093,076	A	6/1978	Newton
4,099,472	A	7/1978	Kellogg
4,321,873	A	3/1982	Nealis
4,485,930	A	12/1984	Savelkouls
4,506,796	A	3/1985	Thompson
4,567,989	A	2/1986	Hurst, Jr.
4,930,643	A	6/1990	Flum
4,942,967	A	7/1990	Schneider

(57) **CLAIM**

The ornamental design for the water jug shelf unit, as shown and described.

DESCRIPTION

FIG. 1 is a top, right perspective view of the water jug shelf unit;
FIG. 2 is a front view thereof; the rear view being identical;
FIG. 3 is a right side view thereof; the left side view being identical; and,
FIG. 4 is a top view thereof; the bottom view being identical.

1 Claim, 2 Drawing Sheets

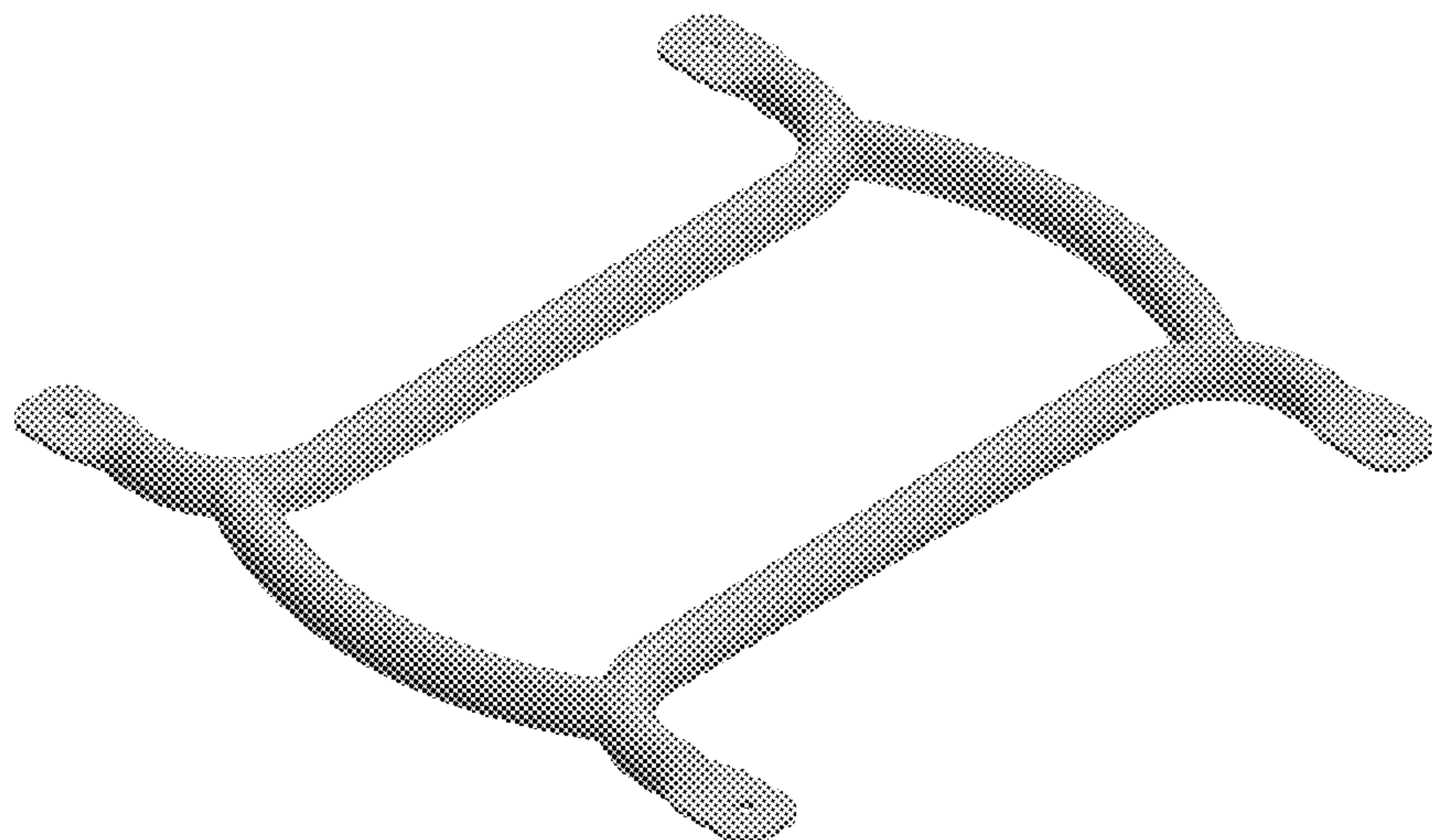

(56)

References Cited

U.S. PATENT DOCUMENTS

D666,857 S *	9/2012	Goodman et al.	D6/566	2007/0017884 A1	1/2007	Yang
2002/0000418 A1	1/2002	Miller, Jr.		2007/0062892 A1	3/2007	Donnellan
2002/0036178 A1	3/2002	Tombu		2008/0053940 A1	3/2008	Whalen et al.
2003/0080073 A1	5/2003	Huang et al.		2008/0302748 A1	12/2008	Tsai
2003/0205543 A1	11/2003	Kao		2009/0057249 A1	3/2009	Donnellan
2004/0026346 A1	2/2004	Kelly et al.		2009/0140115 A1	6/2009	Shye
2005/0132718 A1	6/2005	Lilke		2009/0289018 A1	11/2009	Yang
				2011/0036798 A1	2/2011	Chen
				2011/0079565 A1	4/2011	Alli
				2011/0233164 A1	9/2011	Chang

* cited by examiner

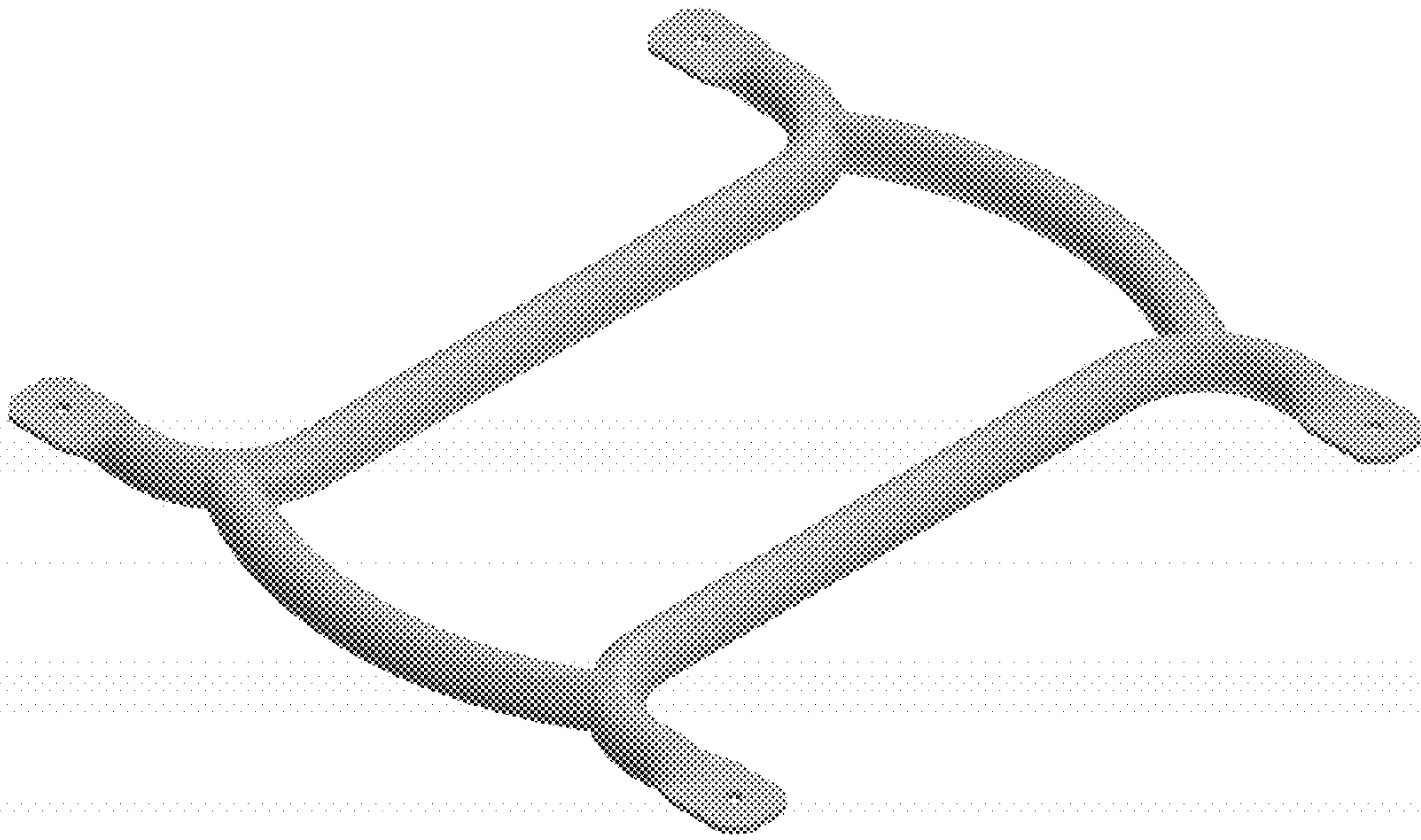

FIG. 1

FIG. 2

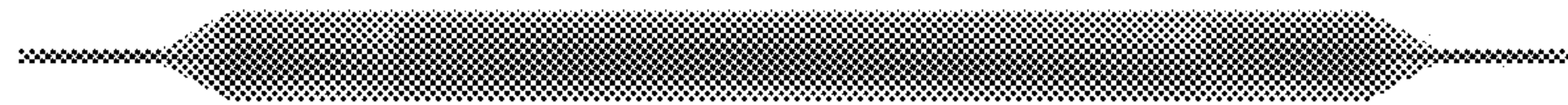
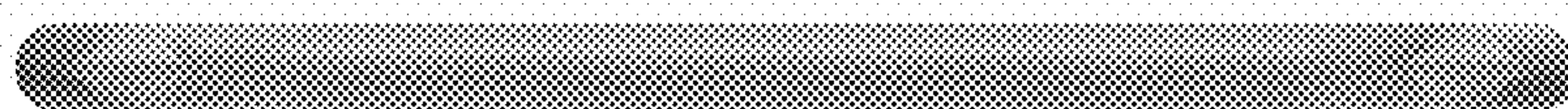

FIG. 3



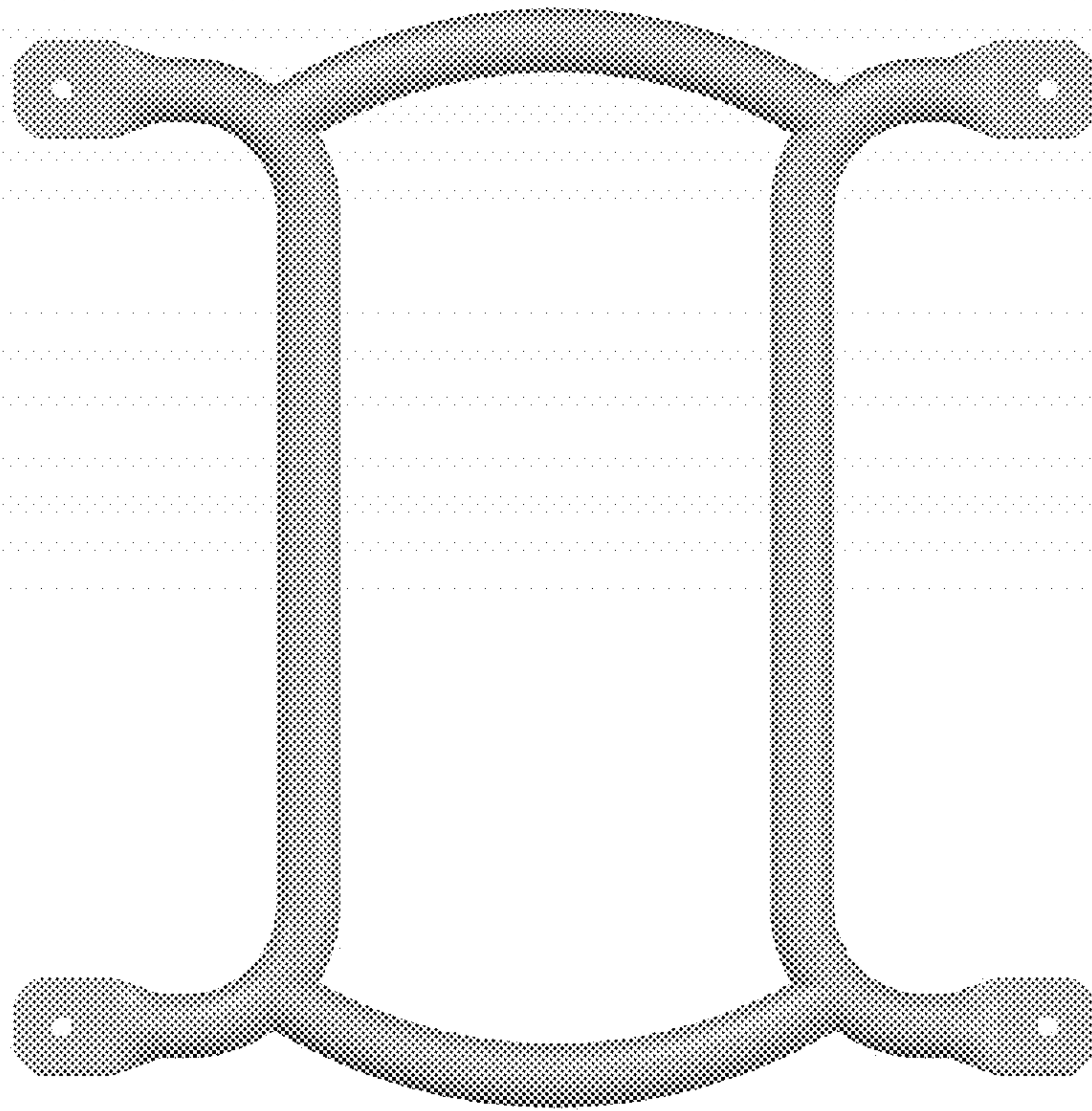

FIG. 4