



US00D695138S

(12) **United States Design Patent**
Ball

(10) **Patent No.:** **US D695,138 S**

(45) **Date of Patent:** **** Dec. 10, 2013**

(54) **BEVERAGE CAN AND CAP ASSEMBLY**

Primary Examiner — Keli L Hill

(76) Inventor: **Michael F. Ball**, Inglewood, CA (US)

(74) *Attorney, Agent, or Firm* — Roylance, Abrams, Berdo & Goodman, L.L.P.

(**) Term: **14 Years**

(21) Appl. No.: **29/397,742**

(57) **CLAIM**

The ornamental design for a beverage can and cap assembly, as shown and described.

(22) Filed: **Jul. 20, 2011**

(51) **LOC (9) Cl.** **09-01**

(52) **U.S. Cl.**

USPC **D9/772; D9/435**

(58) **Field of Classification Search**

USPC D9/434, 345, 454, 500, 503, 504, 516,
D9/529, 549, 763-783; 215/227, 228, 316,
215/381-385; 220/660, 662, 675

See application file for complete search history.

DESCRIPTION

(56) **References Cited**

U.S. PATENT DOCUMENTS

3,419,181	A	12/1968	Stec	
D263,024	S	2/1982	Atkinson et al.	
D277,646	S	2/1985	Jorgensen	
D286,604	S *	11/1986	Bierlein et al.	D7/523
4,715,510	A	12/1987	van der Meulen et al.	
4,790,444	A *	12/1988	Terzi	220/714
5,139,163	A	8/1992	Diaz	
5,273,176	A	12/1993	Diaz	
D415,685	S	10/1999	Braun	

(Continued)

FOREIGN PATENT DOCUMENTS

DE	29703776	7/1997
JP	D1296517	3/2007

(Continued)

OTHER PUBLICATIONS

Smay et al., SIR Reg. No. US H2217, published Jun. 3, 2008.

(Continued)

FIG. 1 is a front perspective view of a beverage can and cap assembly, embodying my new design; FIG. 2 is an exploded front perspective view thereof, showing the cap, inner ring and beverage can; FIG. 3 is a front elevational view thereof, the left, right and rear views being identical thereto; FIG. 4 is a top plan view thereof; FIG. 5 is a top plan view of the can of the assembly of FIG. 1, shown separately for ease of illustration; FIG. 6 is a bottom plan view thereof; FIG. 7 is a side elevational view of the cap of the assembly of FIG. 1, shown separately for ease of illustration; FIG. 8 is a cross-sectional view thereof, taken in the direction of line 8-8 of FIG. 9; FIG. 9 is a bottom plan view thereof; FIG. 10 is a top plan view of the inner ring of the assembly of FIG. 1, shown separately for ease of illustration; FIG. 11 is a bottom plan view thereof; FIG. 12 is a cross-sectional view thereof, taken in the direction of line 12-12 of FIG. 11; FIG. 13 is a partial cross-sectional view thereof, taken in the direction of line 12-12 of FIG. 11; and, FIG. 14 is a side elevational view thereof. The broken lines shown are included for the purpose of illustrating the unclaimed portions of the beverage can and cap assembly and form no part of the claim.

1 Claim, 4 Drawing Sheets

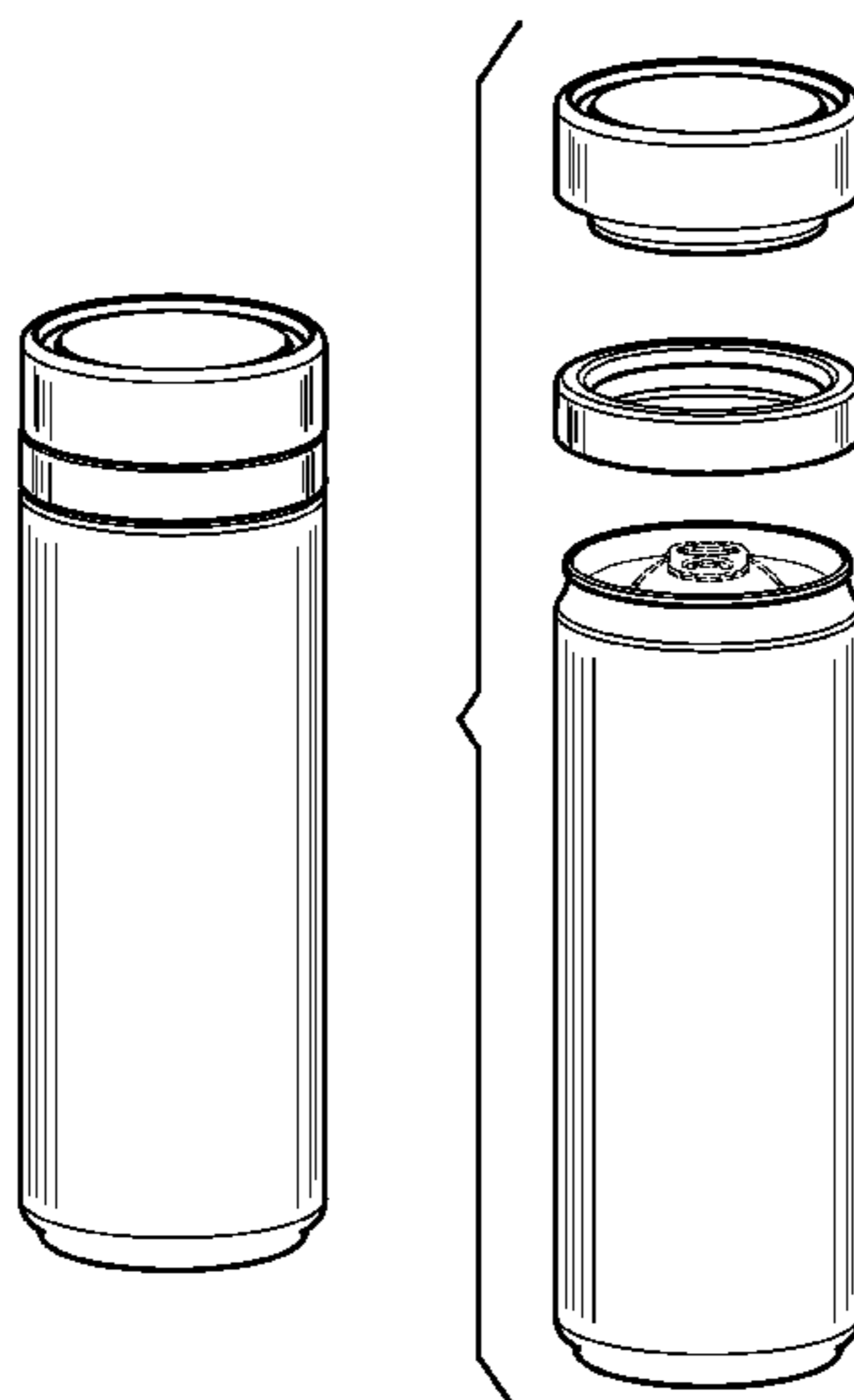

(56)

References Cited

U.S. PATENT DOCUMENTS

D424,431 S 5/2000 Suzuki
6,216,904 B1 4/2001 Cagan
6,241,114 B1 6/2001 Savino et al.
7,017,769 B1 3/2006 Talmon
D570,228 S * 6/2008 van Dam D9/772
D612,747 S * 3/2010 Ball D9/772
D632,589 S * 2/2011 George D9/772
D641,644 S * 7/2011 George D9/772
D649,469 S * 11/2011 Fine et al. D9/551
D652,682 S * 1/2012 Eyal D7/510
D656,236 S * 3/2012 Marechal et al. D24/224

D662,827 S * 7/2012 Watabe D9/529
2005/0218013 A1 10/2005 Tabeshnekoo
2006/0266751 A1 11/2006 Ali et al.

FOREIGN PATENT DOCUMENTS

JP D1319553 1/2008
TW 285599 9/1996
TW D139935 4/2011

OTHER PUBLICATIONS

Taiwan Office Action dated Oct. 17, 2012 in corresponding TW
Appln. No. 101300424.

* cited by examiner

FIG.1

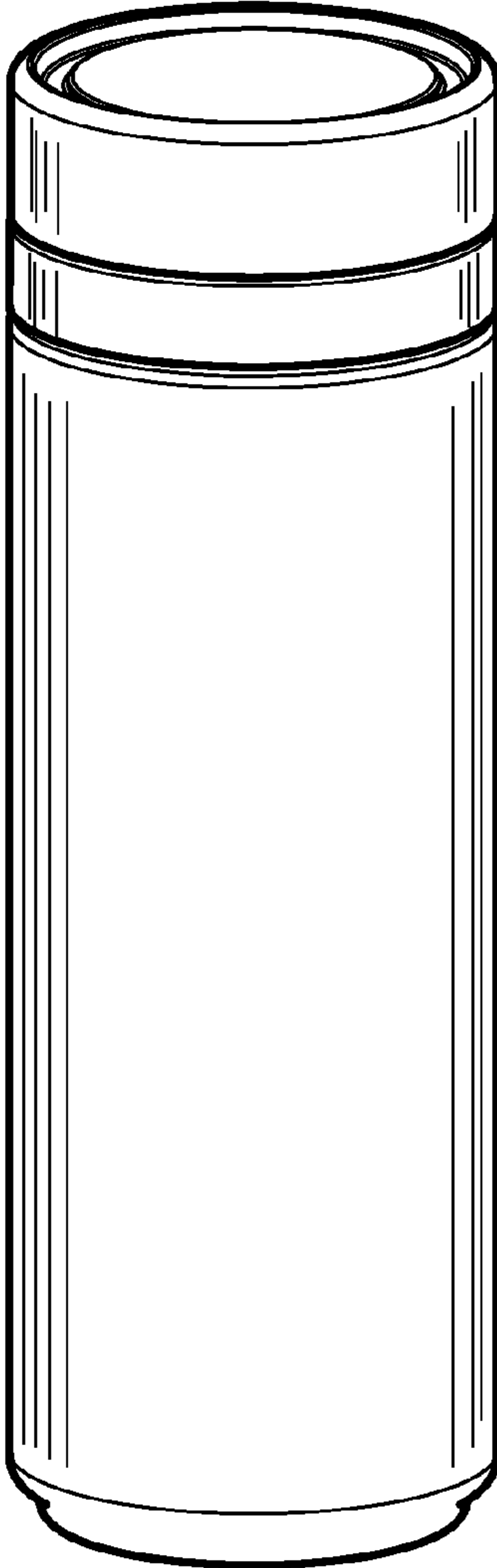

FIG.2

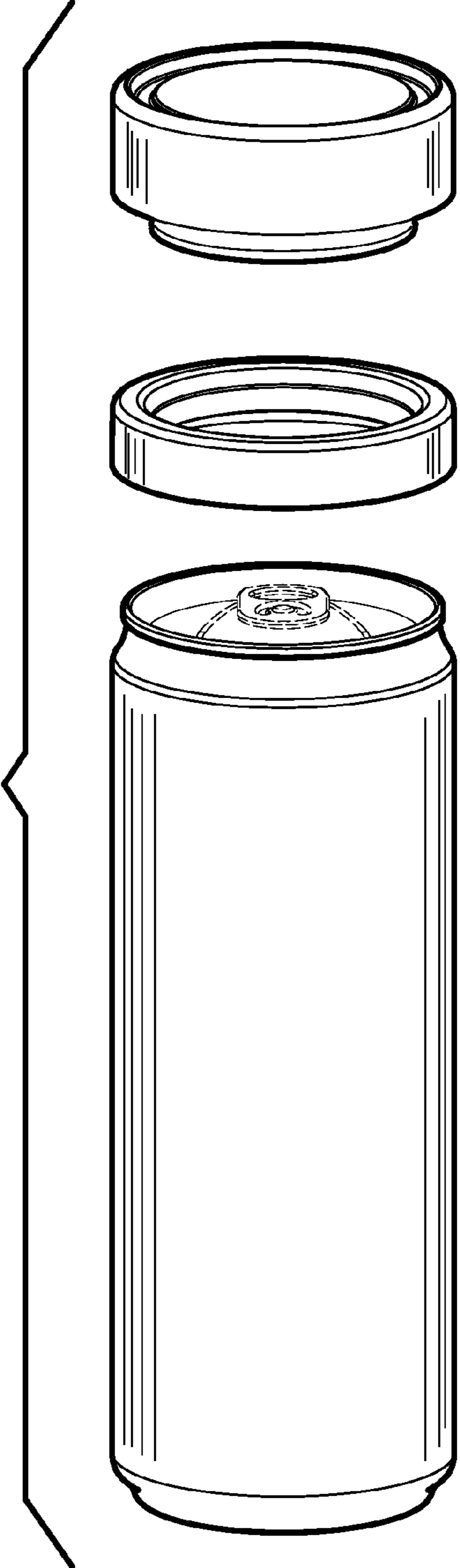

FIG.3

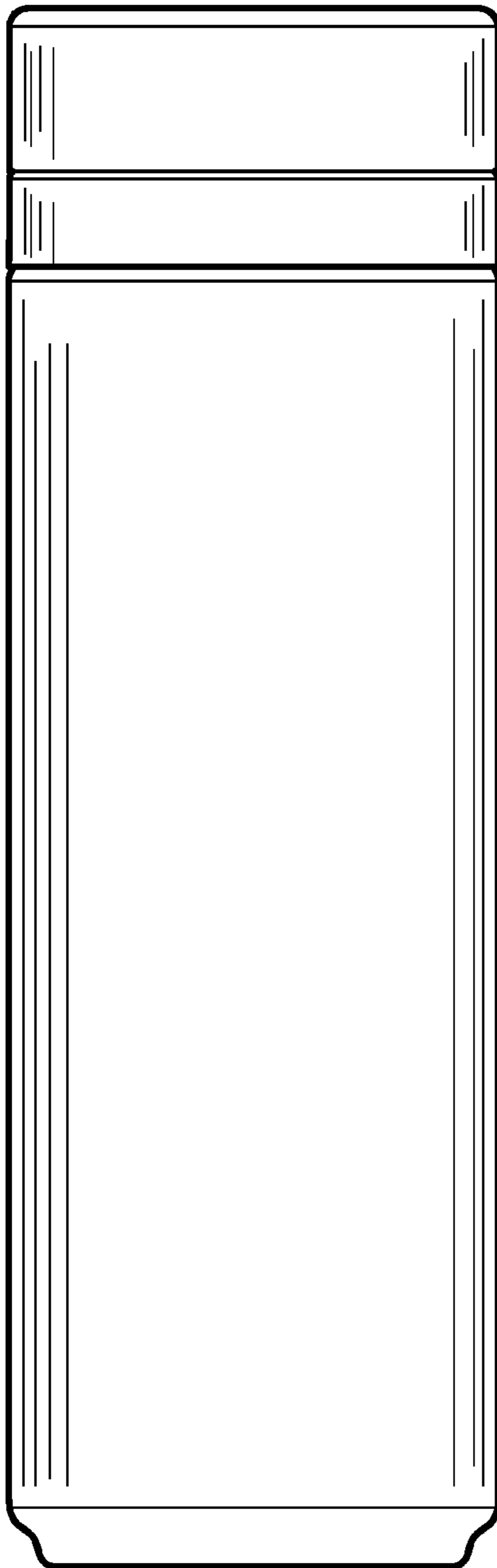

FIG.4

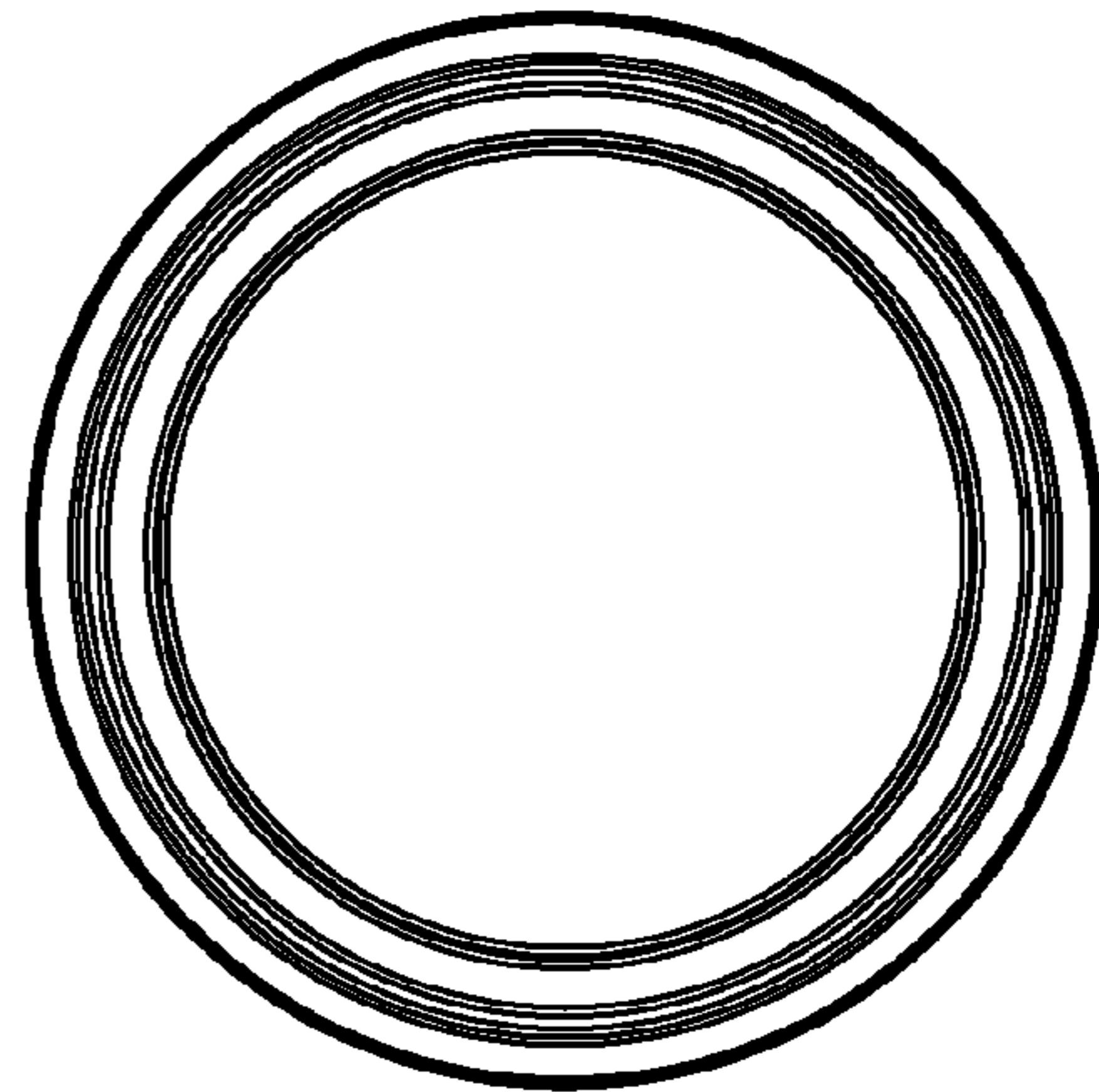

FIG.5

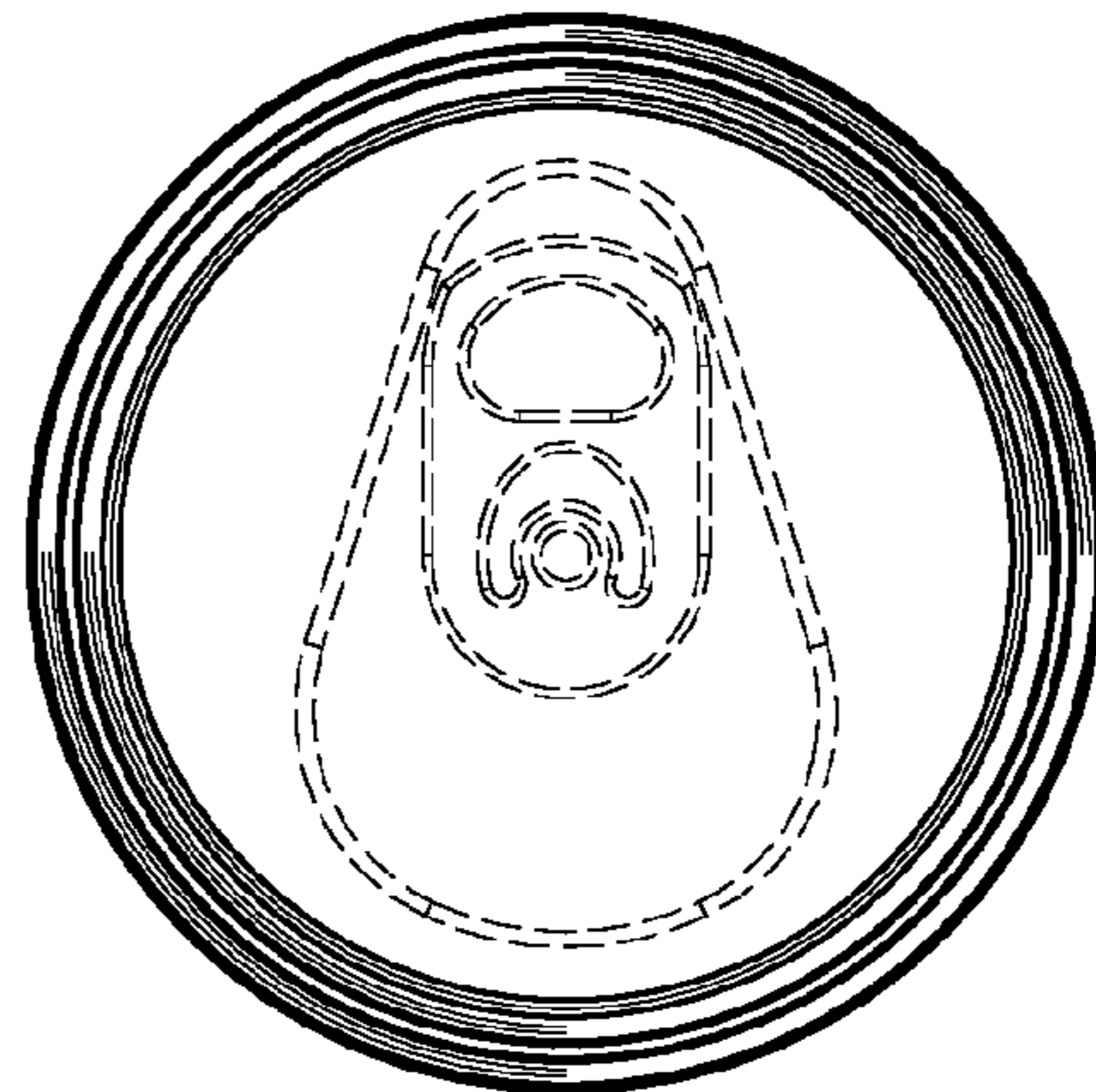

FIG.6

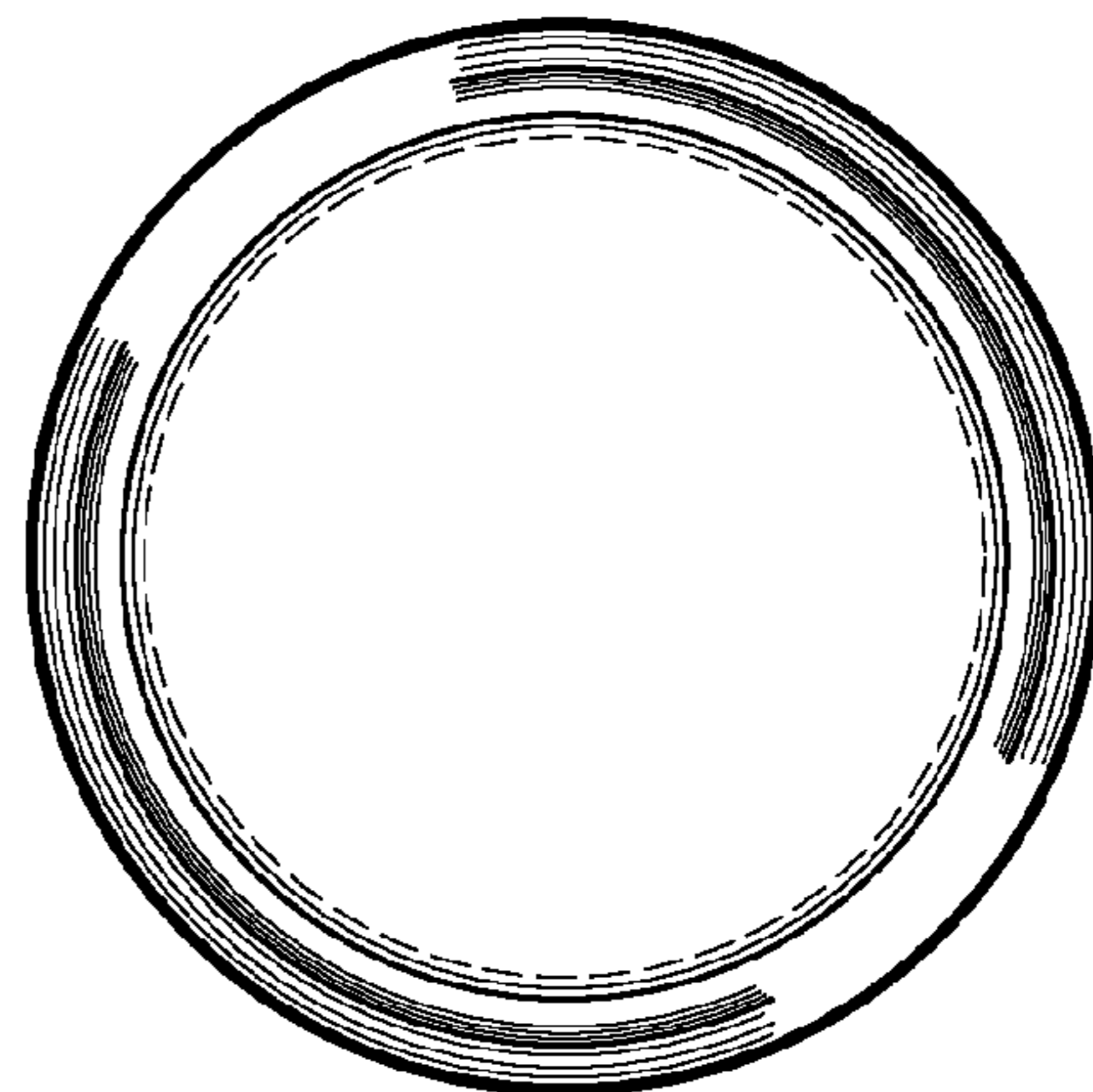

FIG.7

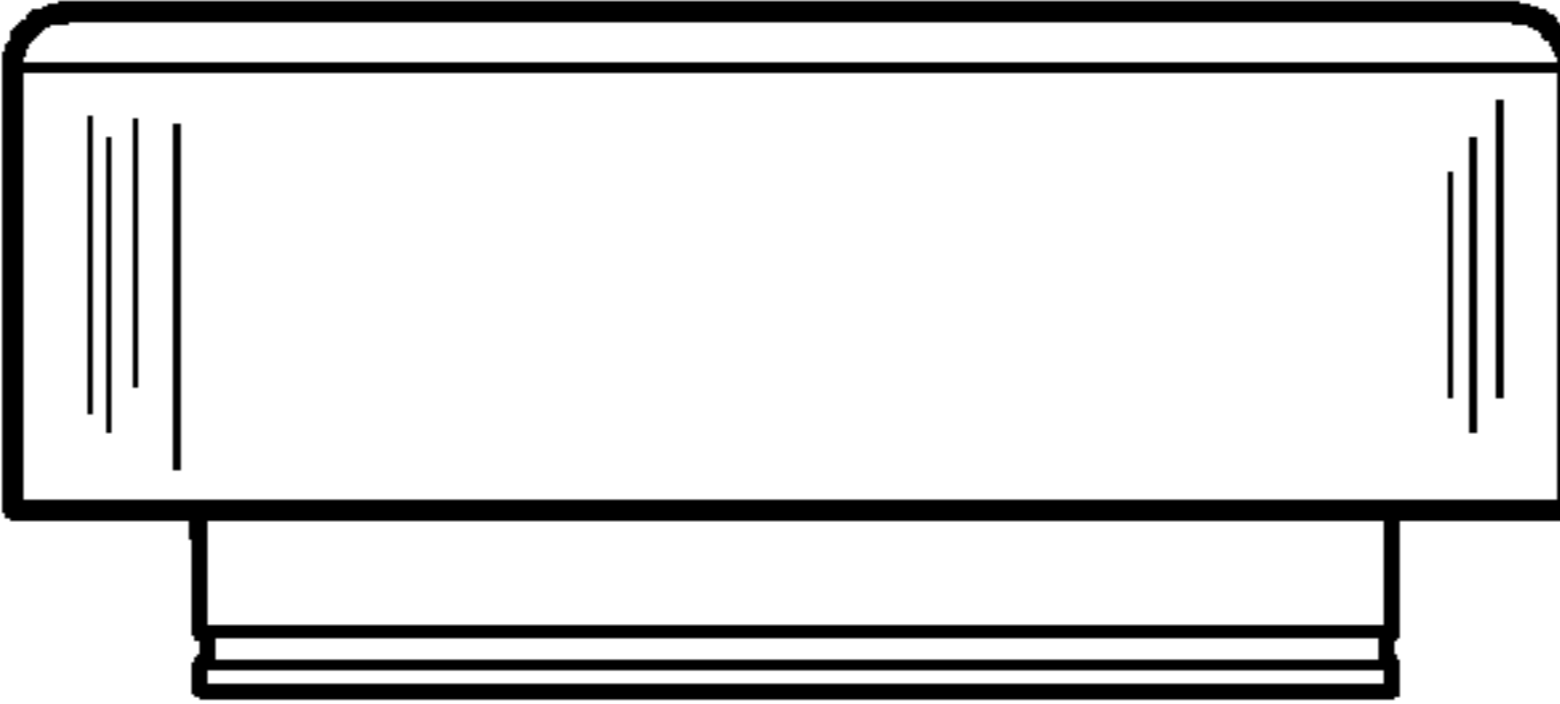

FIG.8

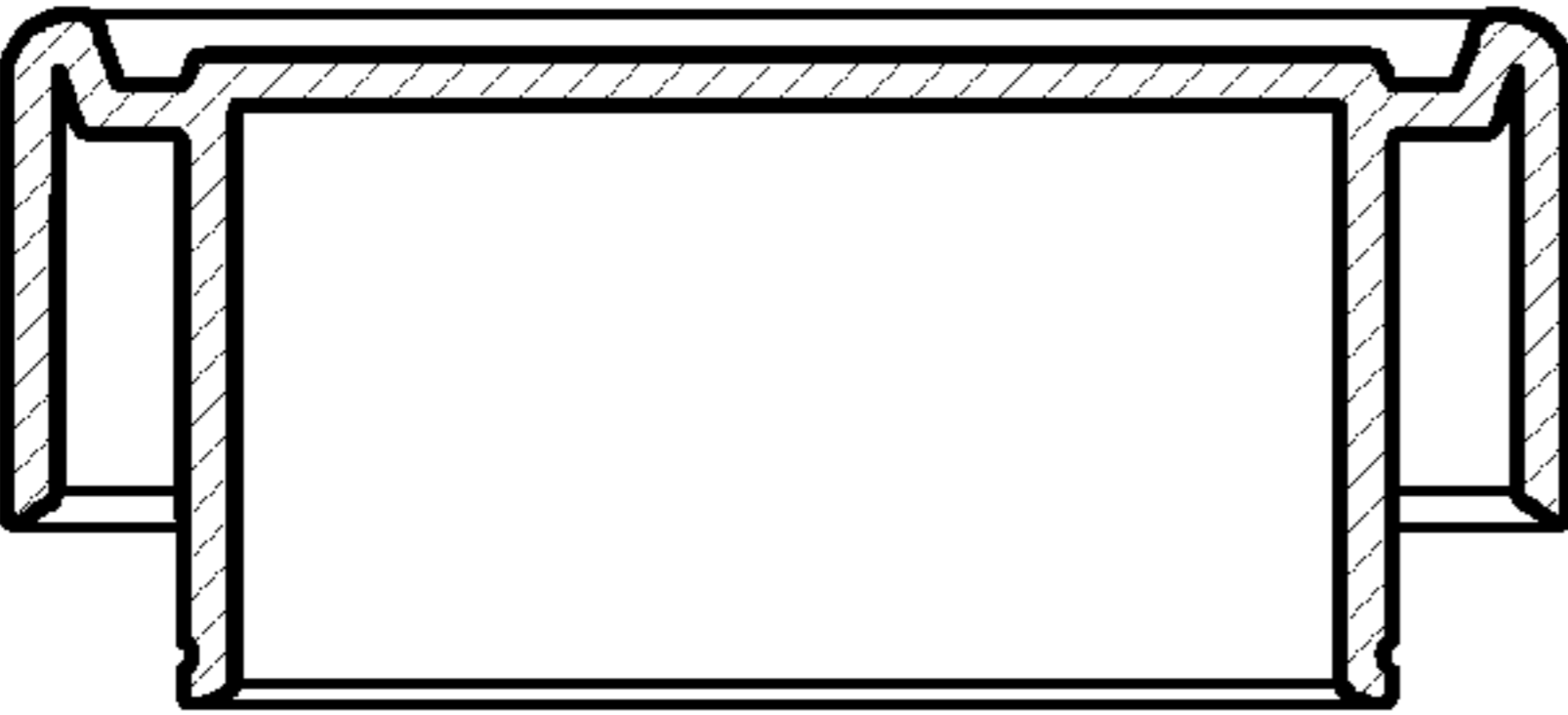

FIG.9

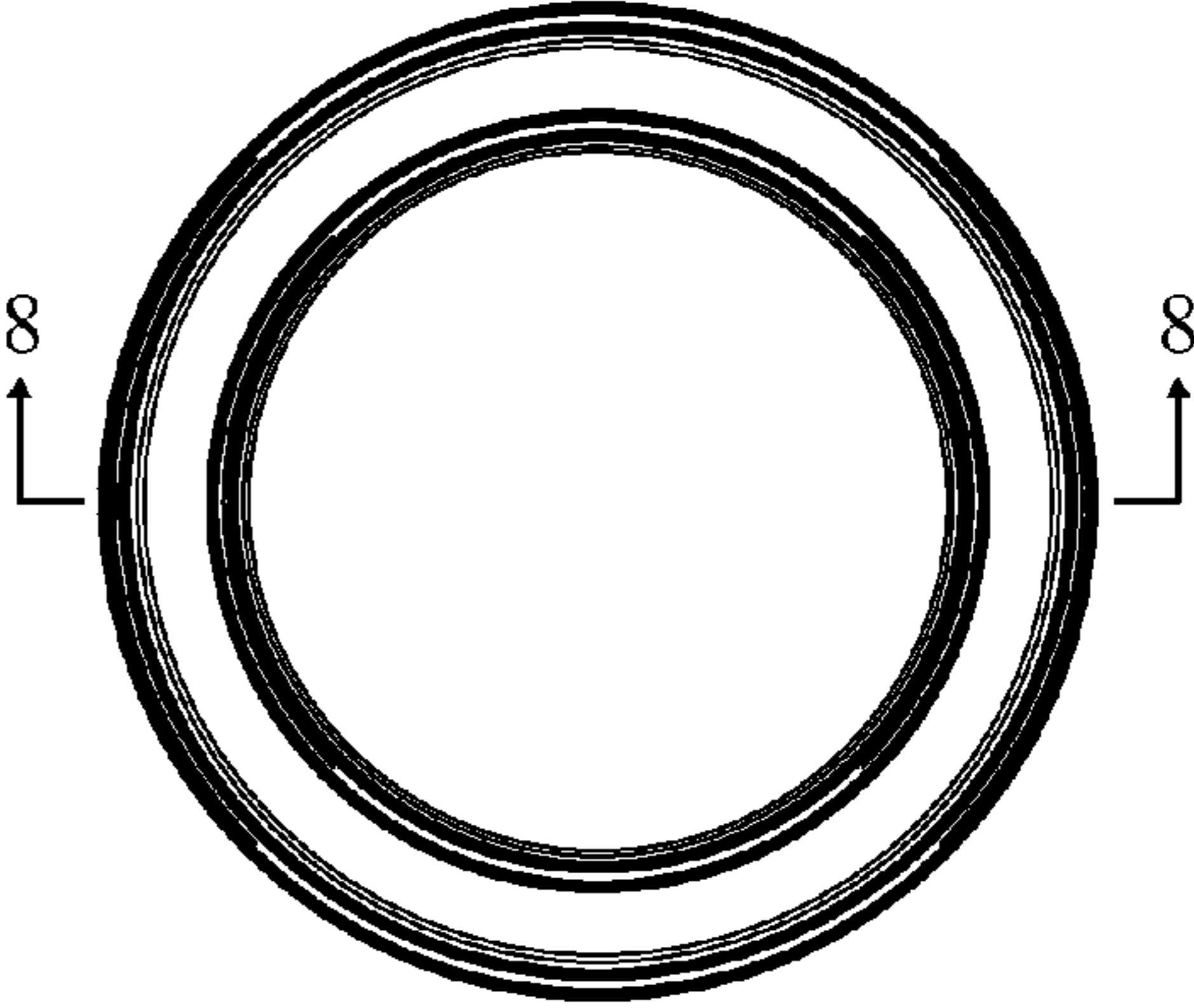

FIG.10

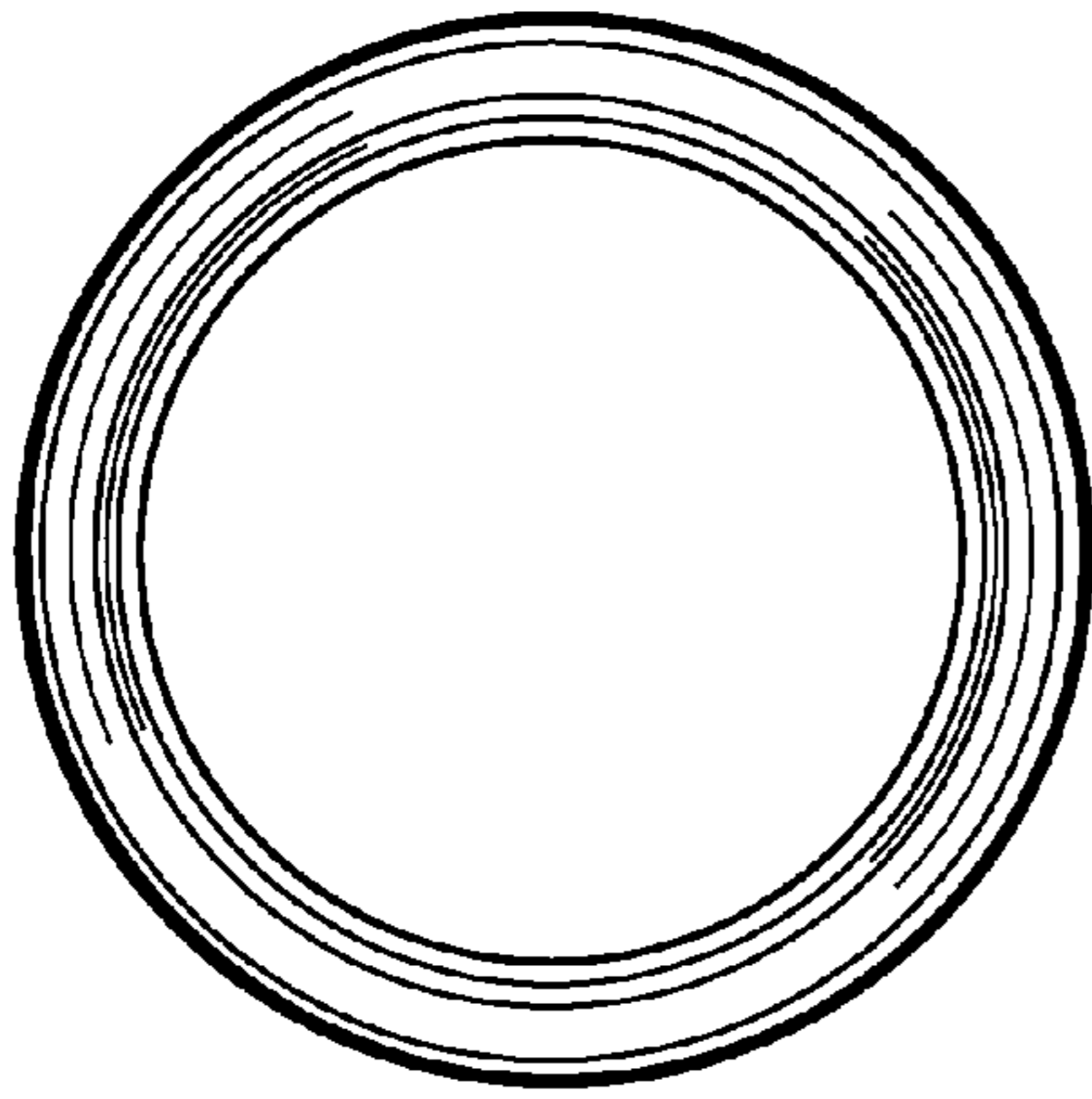

FIG.11

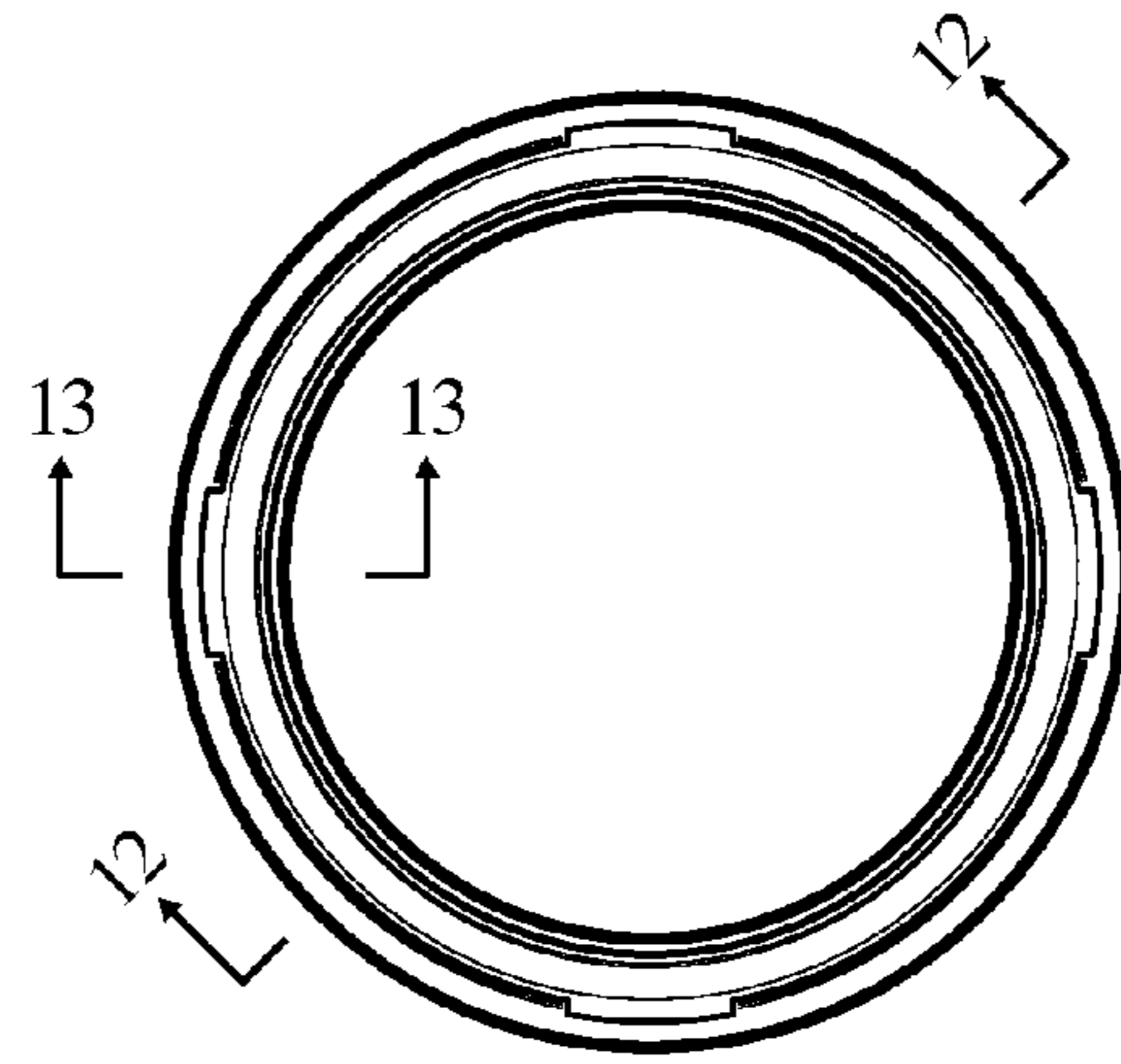

FIG.12

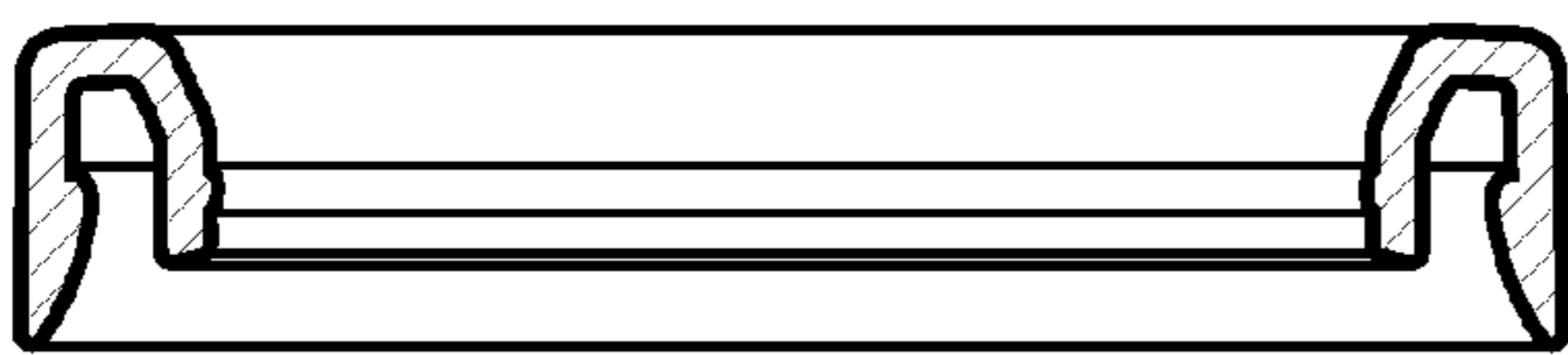

FIG.13

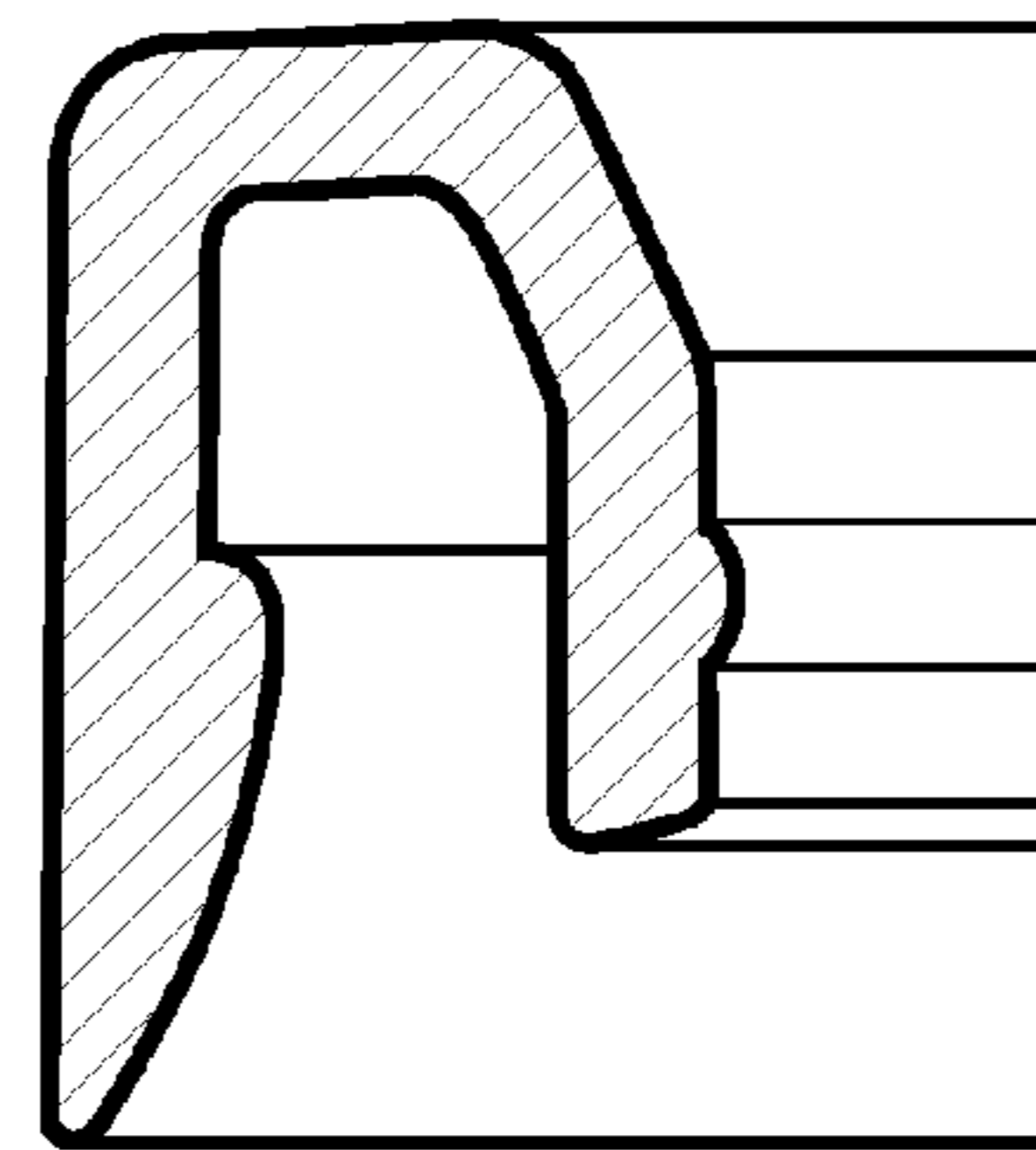

FIG.14

