



US00D694913S

(12) **United States Design Patent**
Kopish et al.

(10) **Patent No.:** **US D694,913 S**
(45) **Date of Patent:** **** Dec. 3, 2013**

(54) **WALL PANEL**

(75) Inventors: **Andrew J. Kopish**, Green Bay, WI (US);
Robert M. Wittl, De Pere, WI (US);
Scott A. Bosman, Green Bay, WI (US);
Joseph D. Vanderlinden, De Pere, WI
(US); **Nathan A. Quintal**, De Pere, WI
(US); **James M. Durand**, De Pere, WI
(US)

(73) Assignee: **Krueger International, Inc.**, Green Bay,
WI (US)

(**) Term: **14 Years**

(21) Appl. No.: **29/419,205**

(22) Filed: **Apr. 26, 2012**

(51) **LOC (9) Cl.** **25-01**

(52) **U.S. Cl.**
USPC **D25/103; D25/138**

(58) **Field of Classification Search**
USPC D25/58, 103, 138; 52/202, 235, 238.1,
52/239, 243, 243.1
See application file for complete search history.

(56) **References Cited**

U.S. PATENT DOCUMENTS

3,189,140 A * 6/1965 Luss 52/204.597
D405,198 S * 2/1999 St. Louis D25/138
6,141,925 A 11/2000 Halvorson, Jr. et al.

D485,368 S * 1/2004 Hayashi D25/58
6,688,056 B2 2/2004 Von Hoyningen Huene et al.
6,761,004 B2 7/2004 Anglin et al.
D559,408 S * 1/2008 Dorris D25/103
7,434,790 B1 10/2008 Hansen
7,461,484 B2 12/2008 Battey et al.
2008/0295426 A1 * 12/2008 Milligan et al. 52/238.1

FOREIGN PATENT DOCUMENTS

WO 2011/137530 A9 11/2011

* cited by examiner

Primary Examiner — Doris Clark

(74) *Attorney, Agent, or Firm* — Andrus, Scales, Starke &
Sawall, LLP

(57) **CLAIM**

The ornamental design for a wall panel, as shown and
described.

DESCRIPTION

FIG. 1 is an isometric view of a wall panel as included in an
entire wall panel system;
FIG. 2 is a magnified isometric view of the wall panel;
FIG. 3 is a front view thereof,
FIG. 4 is a back view thereof;
FIG. 5 is a top view thereof; and,
FIG. 6 is a bottom view thereof.

The broken lines shown in the drawing figures are meant to
indicate indeterminate length and environment and form no
part of the claimed design.

1 Claim, 5 Drawing Sheets

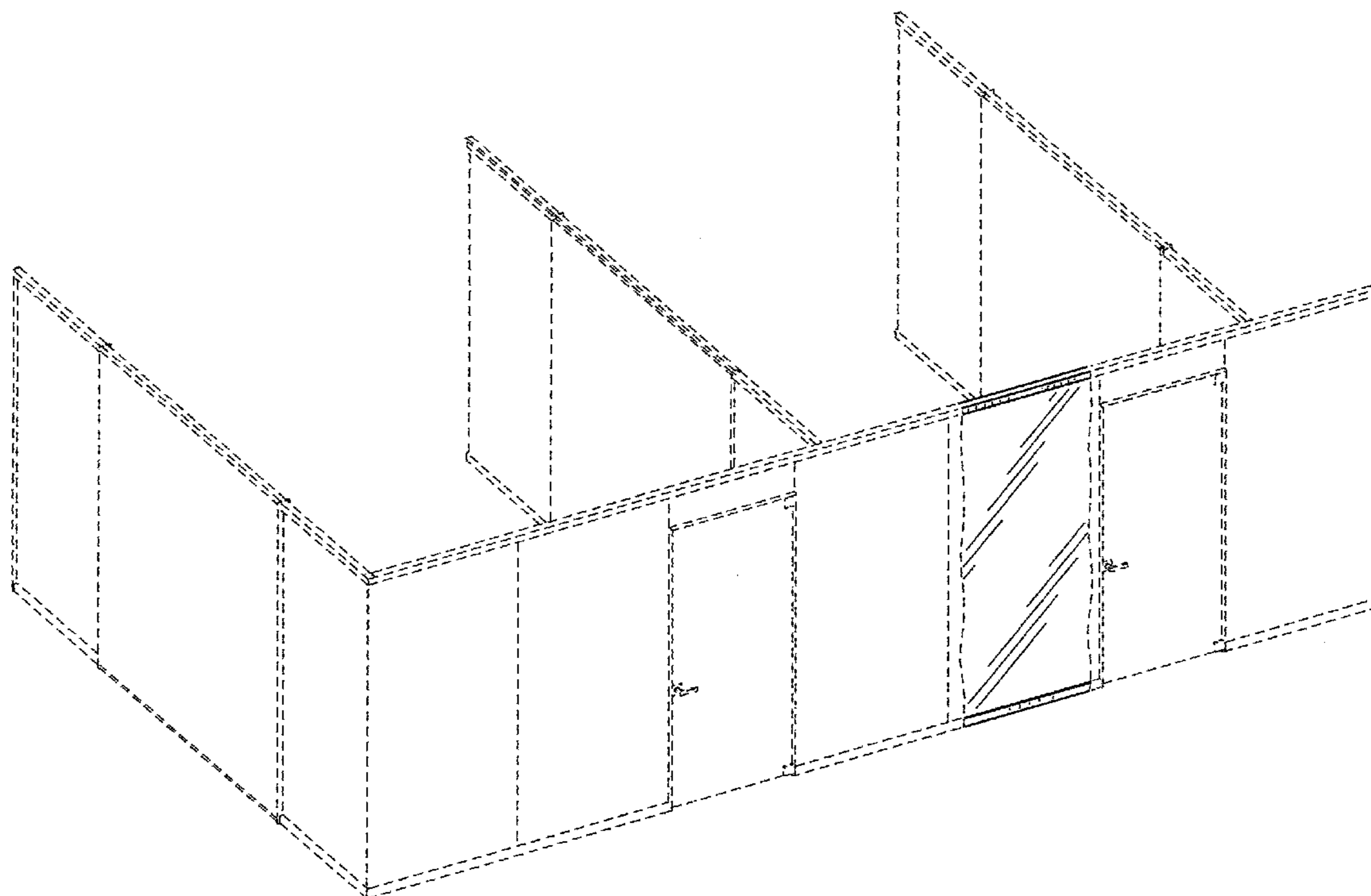

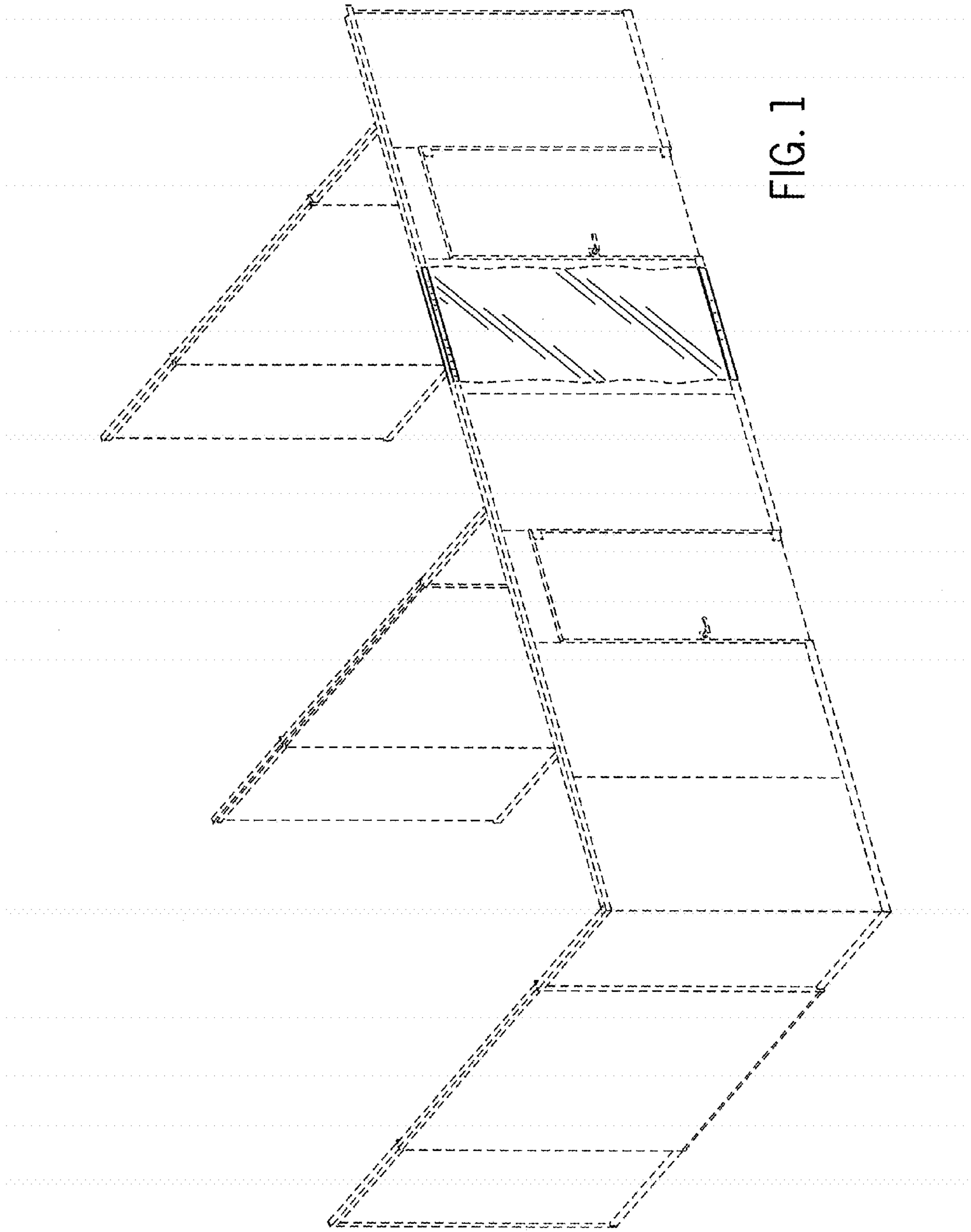

FIG. 1

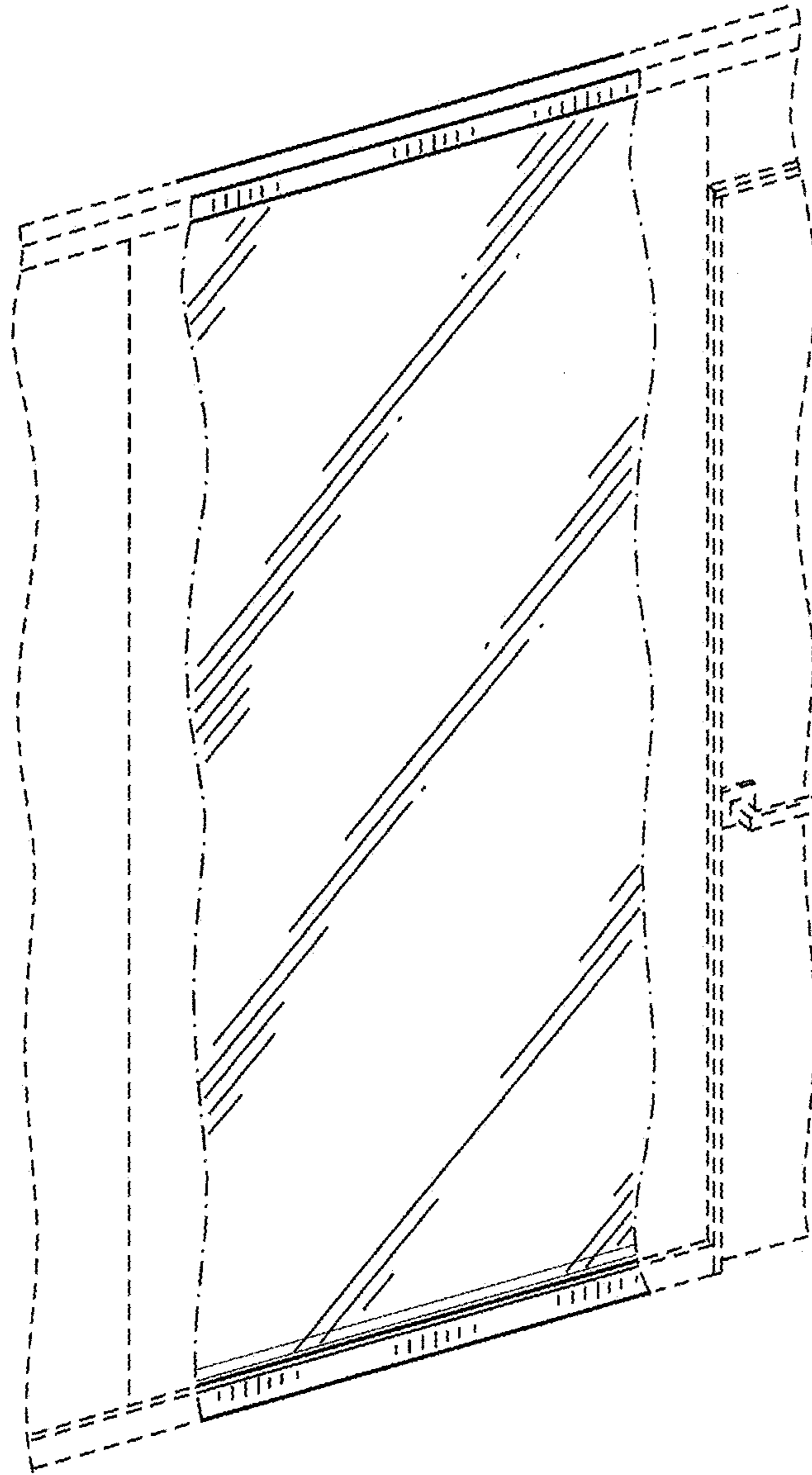

FIG. 2

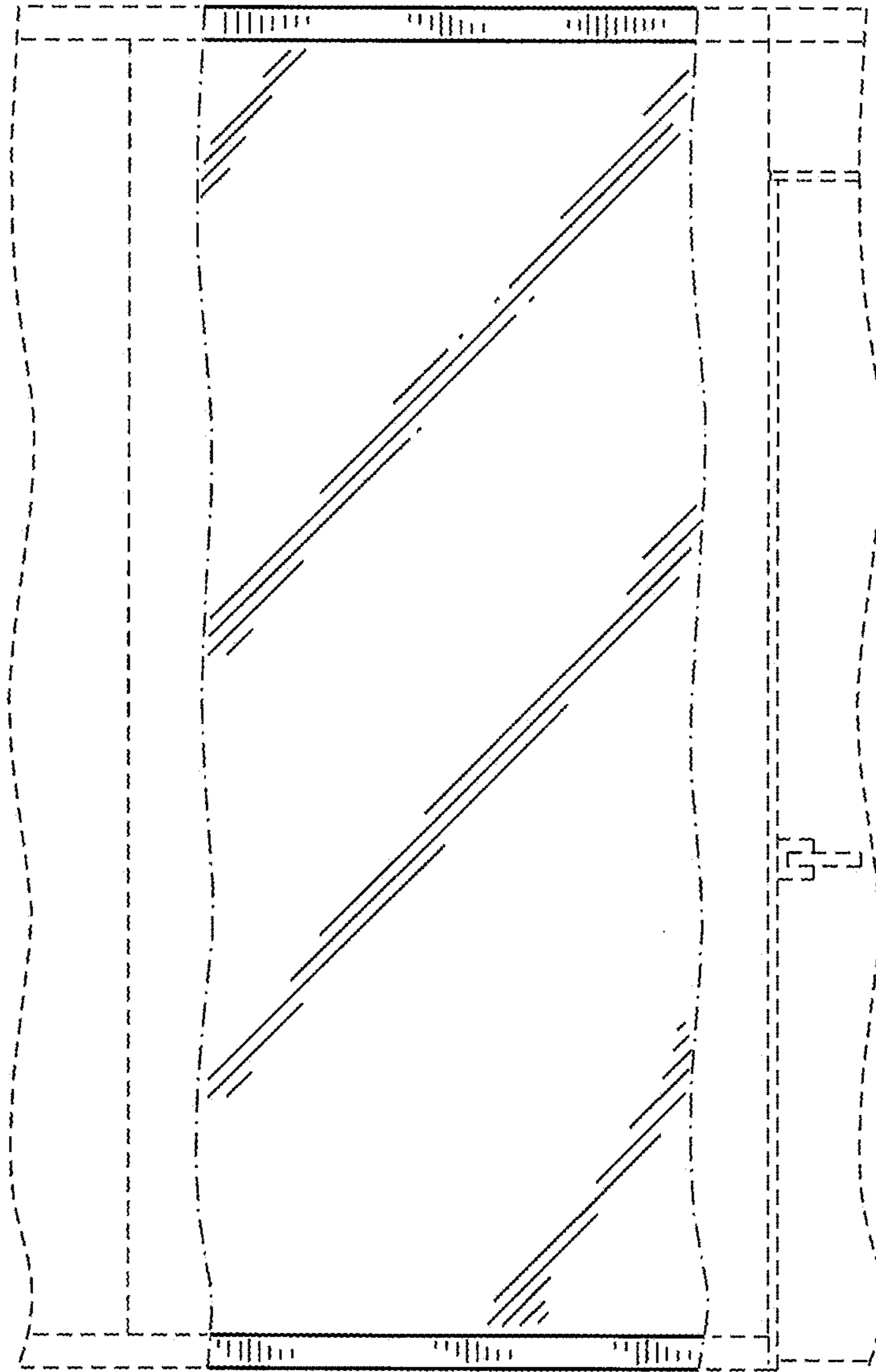

FIG. 3

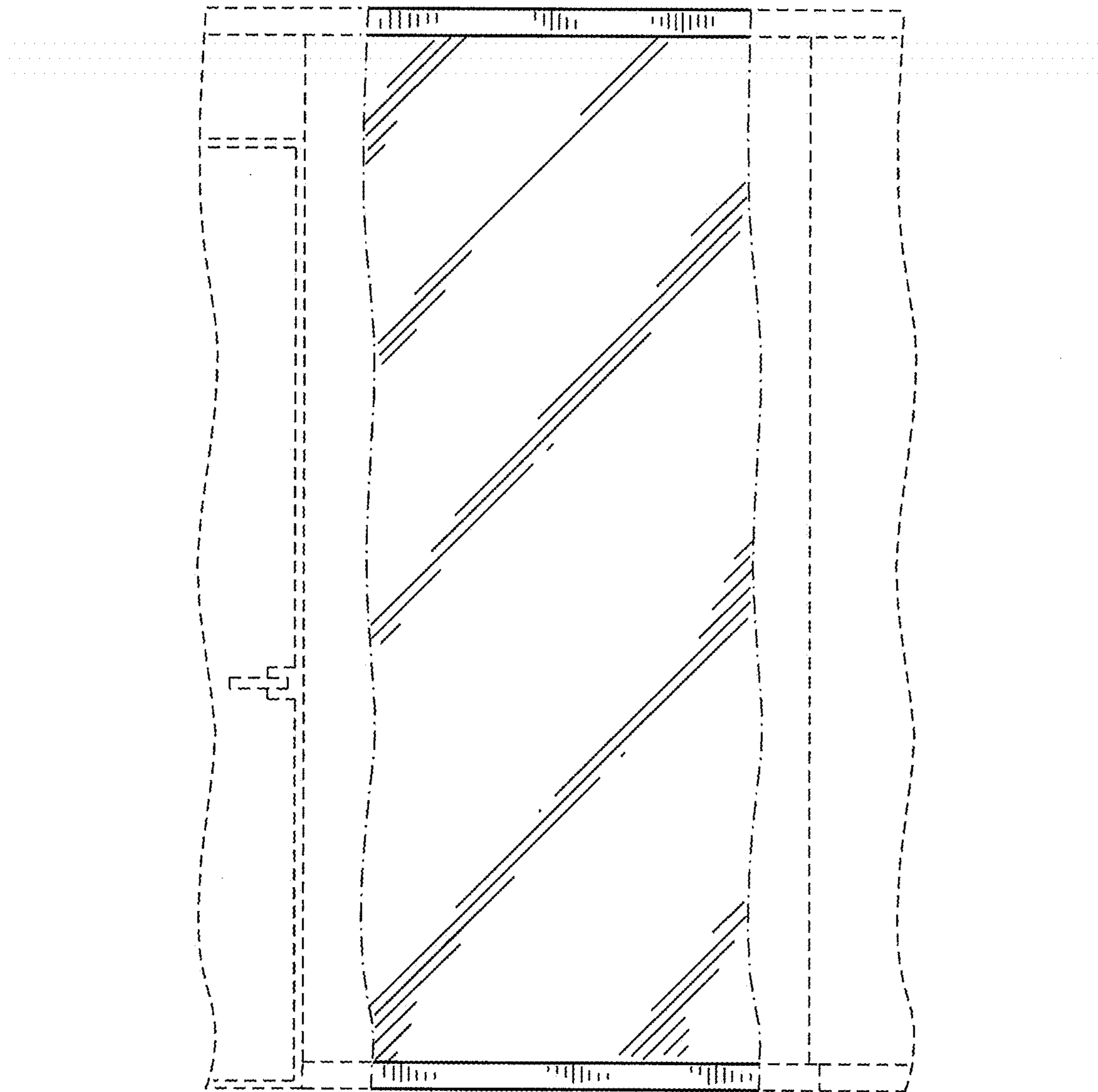

FIG. 4

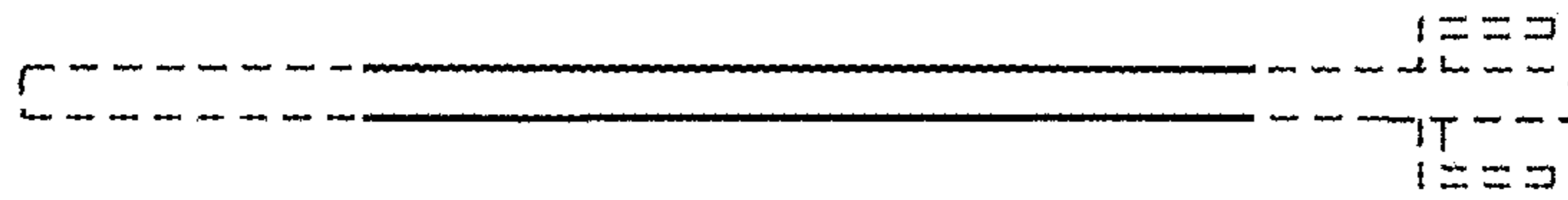

FIG. 5

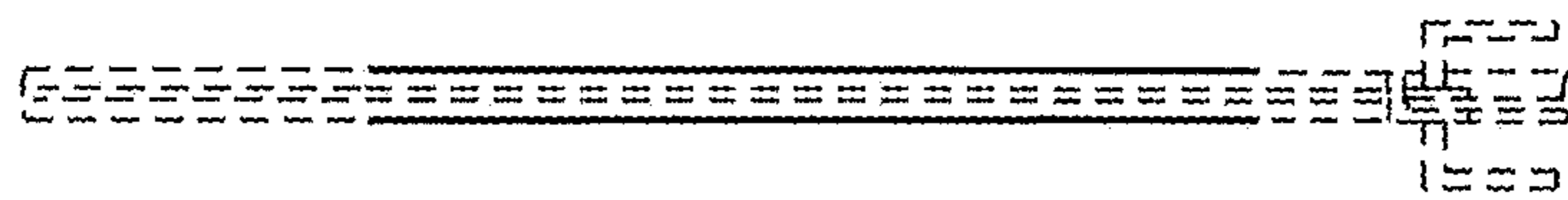

FIG. 6