



US00D694788S

(12) **United States Design Patent**  
**Carper**

(10) **Patent No.:** **US D694,788 S**

(45) **Date of Patent:** **\*\* Dec. 3, 2013**

(54) **PUNCH FOR A PROGRESSIVE FORMER**

(71) Applicant: **National Machinery LLC**, Tiffin, OH  
(US)

(72) Inventor: **Jeffrey W. Carper**, Tiffin, OH (US)

(73) Assignee: **National Machinery LLC**, Tiffin, OH  
(US)

(\*\*) Term: **14 Years**

(21) Appl. No.: **29/433,218**

(22) Filed: **Sep. 27, 2012**

(51) **LOC (9) Cl.** ..... **15-09**

(52) **U.S. Cl.**  
USPC ..... **D15/128**

(58) **Field of Classification Search**  
USPC ..... D8/98; D15/128, 136; D19/65, 72;  
29/240, 256, 264; 30/366, 367; 279/96,  
279/100, 101, 102; 403/16

See application file for complete search history.

(56) **References Cited**

U.S. PATENT DOCUMENTS

229,227	A *	6/1880	Walton	248/397
1,318,489	A *	10/1919	Donaldson	407/1
1,336,724	A *	4/1920	Berberich	30/113
2,522,440	A *	9/1950	Freter	72/464
3,763,730	A *	10/1973	Ahlegian	83/521
4,273,015	A *	6/1981	Johnson	83/670
D294,000	S *	2/1988	Friedrich	D8/47
4,762,043	A *	8/1988	Sneed	83/688

5,017,157	A *	5/1991	Liu et al.	439/607.18
5,138,866	A *	8/1992	Hite et al.	72/455
5,183,053	A *	2/1993	Yeh et al.	600/567
5,363,686	A *	11/1994	Hite et al.	72/455
5,792,163	A *	8/1998	Hitzig	606/167
5,799,662	A *	9/1998	Conte	131/255
D417,525	S *	12/1999	Brushett	D27/195
D444,693	S *	7/2001	Griese et al.	D8/107
D458,308	S *	6/2002	Hsuan	D19/72
D518,178	S *	3/2006	Christiansen	D24/147
D526,667	S *	8/2006	Sakamoto et al.	D15/128
D615,569	S *	5/2010	Greenleaf	D15/128
D629,111	S *	12/2010	Oppelt	D24/169
D665,832	S *	8/2012	Nguyen	D15/128
2003/0075034	A1 *	4/2003	Brenneke	83/684

\* cited by examiner

*Primary Examiner* — Patricia Palasik

(74) *Attorney, Agent, or Firm* — Pearne & Gordon LLP

(57) **CLAIM**

The ornamental design for a punch for a progressive former, as shown and described.

**DESCRIPTION**

FIG. 1 is an isometric view of a punch for a progressive former showing my new design;

FIG. 2 is a top plan view thereof;

FIG. 3 is a left side elevational view, the right side elevational view being a mirror image thereof;

FIG. 4 is a bottom plan view thereof;

FIG. 5 is a rear elevational view thereof; and,

FIG. 6 is a front elevational view thereof.

**1 Claim, 1 Drawing Sheet**

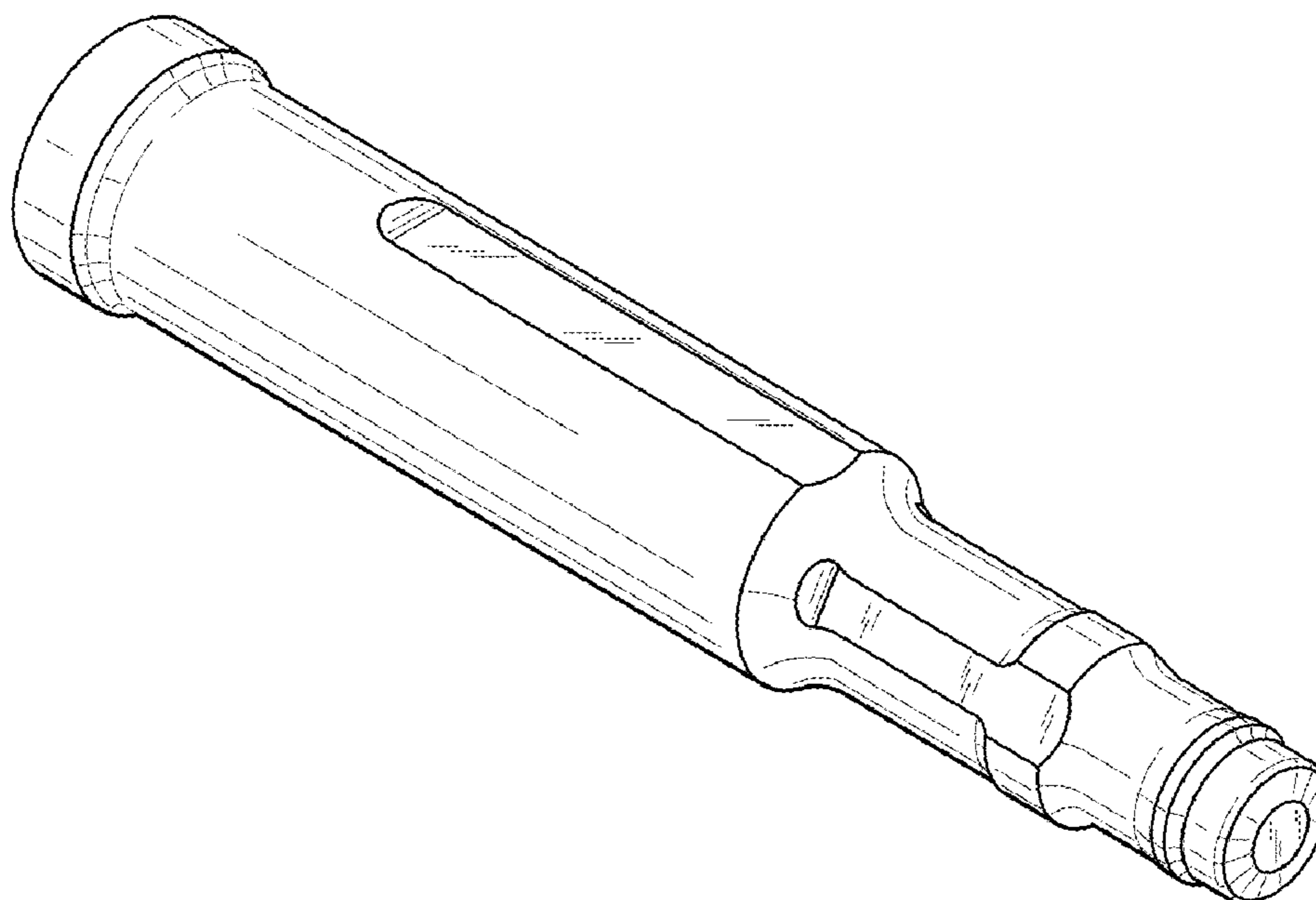

FIG. 1

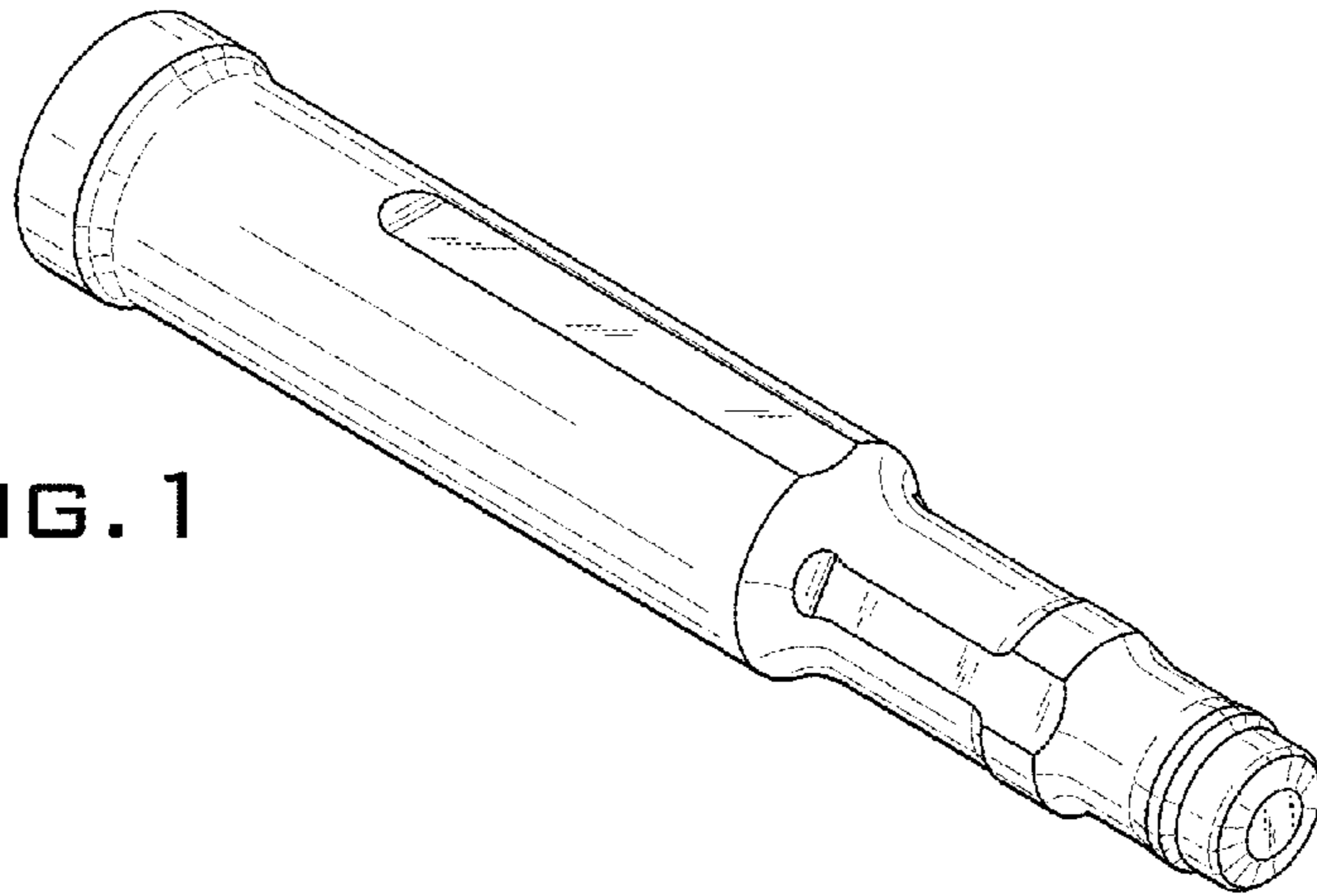

FIG. 2

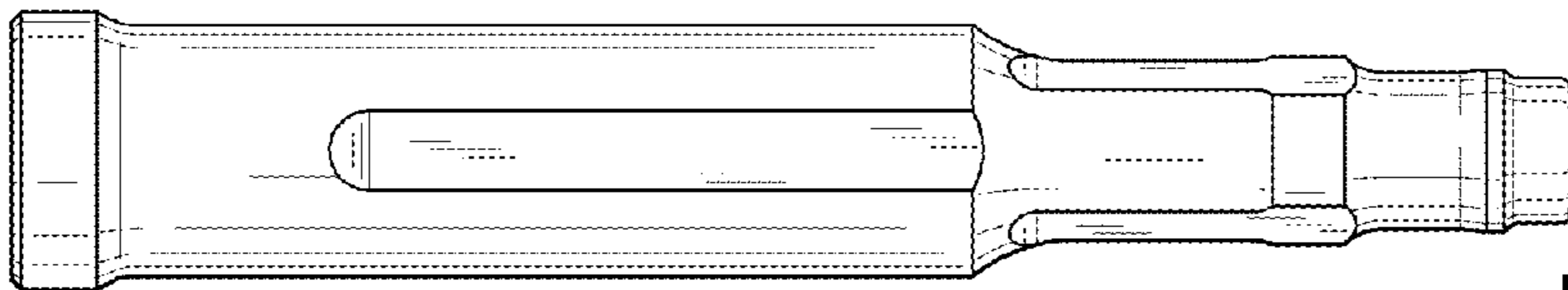

FIG. 3

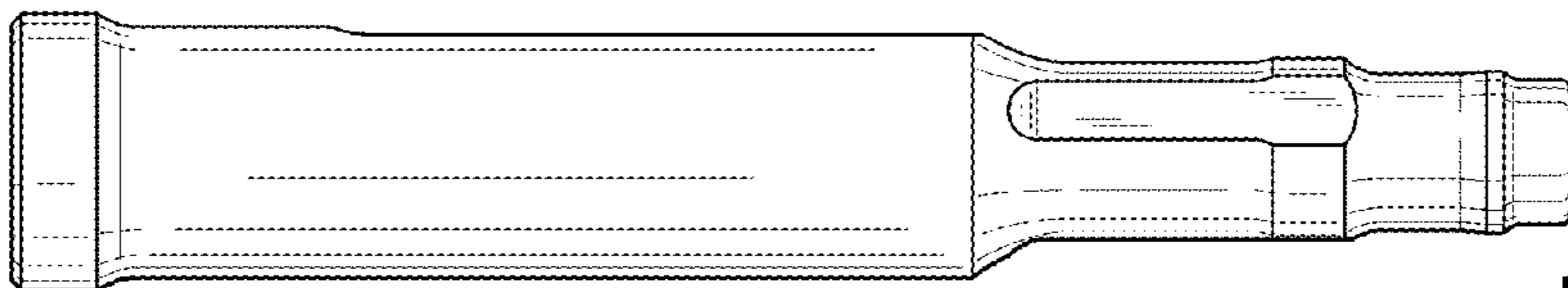

FIG. 4

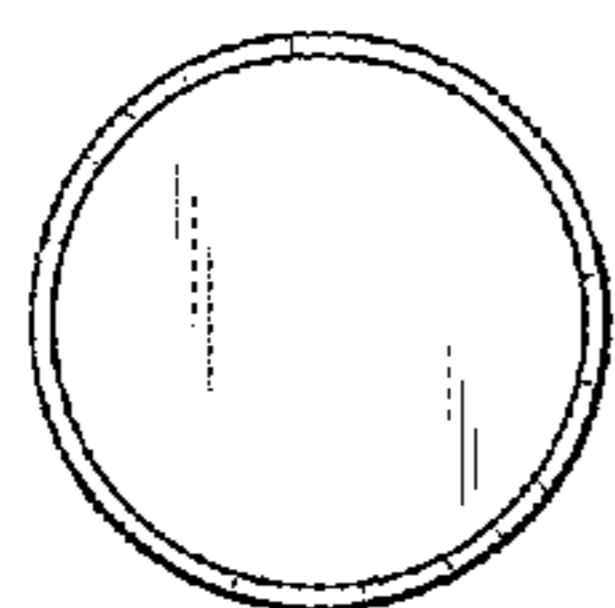
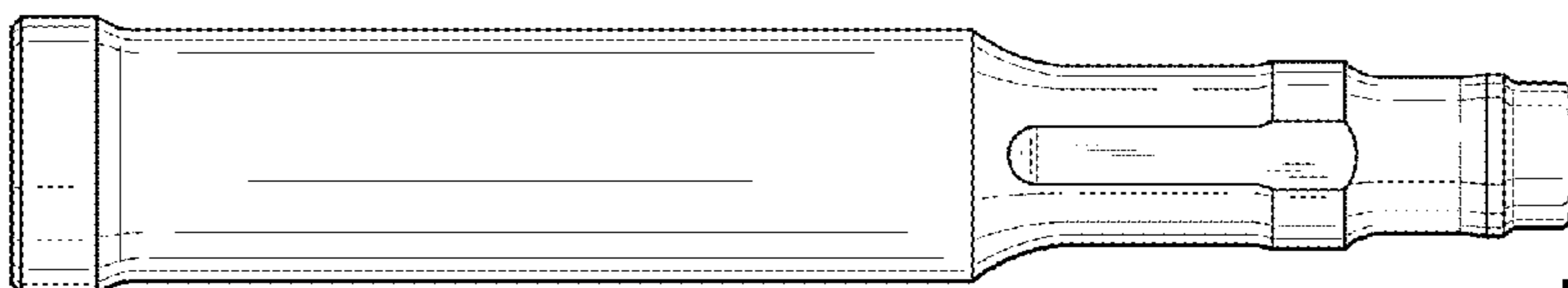

FIG. 5

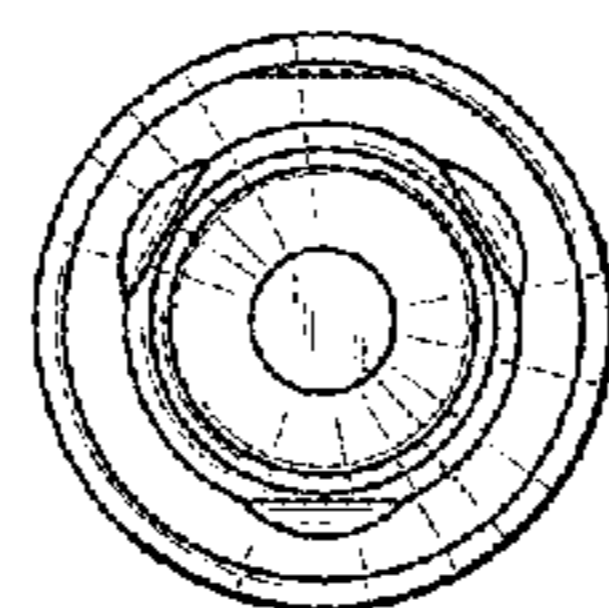

FIG. 6