

US00D694612S

(12) **United States Design Patent**  
**DeFrancisci**

(10) **Patent No.:** **US D694,612 S**

(45) **Date of Patent:** **\*\* Dec. 3, 2013**

(54) **SHELTER SUPPORT**

(76) **Inventor:** **Leonard J. DeFrancisci**, West  
Melbourne, FL (US)

(\*\*) **Term:** **14 Years**

(21) **Appl. No.:** **29/397,035**

(22) **Filed:** **Jul. 11, 2011**

(51) **LOC (9) Cl.** ..... **08-05**

(52) **U.S. Cl.**  
USPC ..... **D8/354**

(58) **Field of Classification Search**  
USPC ..... D8/349, 354, 355, 363, 373, 394, 333,  
D8/300; D12/115; 248/161, 158, 176, 274,  
248/298, 499-500, 551, 680, 251, 309.1,  
248/309.2, 300, 201, 218.4, 200, 140;  
40/606, 612, 607.14, 607.12;  
211/17-24; 24/455

See application file for complete search history.

(56) **References Cited**

**U.S. PATENT DOCUMENTS**

3,293,789	A *	12/1966	Pack	43/15
D261,596	S *	11/1981	Beck, Jr.	D7/388
D327,602	S *	7/1992	Walker	D7/335
D342,184	S *	12/1993	Sanchez	D7/335
D344,207	S *	2/1994	Bauman	D7/336
D346,638	S *	5/1994	Streeter	D22/147
D353,625	S *	12/1994	Thomsen	D20/41
5,666,940	A *	9/1997	Kreiter	126/30
D396,379	S *	7/1998	Stoetzl	D7/335
D402,431	S *	12/1998	Peterson	D30/133
D430,378	S *	8/2000	Worsoe	D34/38
6,094,852	A *	8/2000	Roach	43/16
D452,551	S *	12/2001	Gonnello	D22/147
D522,163	S *	5/2006	Begasse	D26/71
D542,355	S *	5/2007	Kauppila	D20/41

D543,442	S *	5/2007	Shea	D8/370
D586,438	S *	2/2009	Hockemeyer et al.	D23/267
D592,443	S *	5/2009	Fraser	D7/335
D637,316	S *	5/2011	Parent	D25/126
D637,894	S *	5/2011	Maurer	D8/373
D639,448	S *	6/2011	Grainger	D25/1
2010/0314509	A1 *	12/2010	Conger	248/121
2011/0132420	A1 *	6/2011	Livacich et al.	135/123
2011/0203628	A1 *	8/2011	Gross	135/96

\* cited by examiner

*Primary Examiner* — Mark Goodwin

(74) *Attorney, Agent, or Firm* — Allen, Dyer, Doppelt,  
Milbrath & Gilchrist, P.A.

(57) **CLAIM**

The ornamental design for a shelter support, as shown and described.

**DESCRIPTION**

FIG. 1 is a bottom, left, rear perspective view of a shelter support showing my new design;  
 FIG. 2 is a top, right, front perspective view;  
 FIG. 3 is a front view;  
 FIG. 4 is a rear view;  
 FIG. 5 is a left side view;  
 FIG. 6 is a right side view;  
 FIG. 7 is a top view;  
 FIG. 8 is a bottom view;  
 FIG. 9 is a bottom, left, rear perspective view in an alternate configuration thereof; and,  
 FIG. 10 is a top, right, front perspective view in the alternate configuration thereof.  
 Broken lines in FIGS. 9 and 10 indicate the attachment of the alternately configured components, and form no part of the claimed design.

**1 Claim, 5 Drawing Sheets**

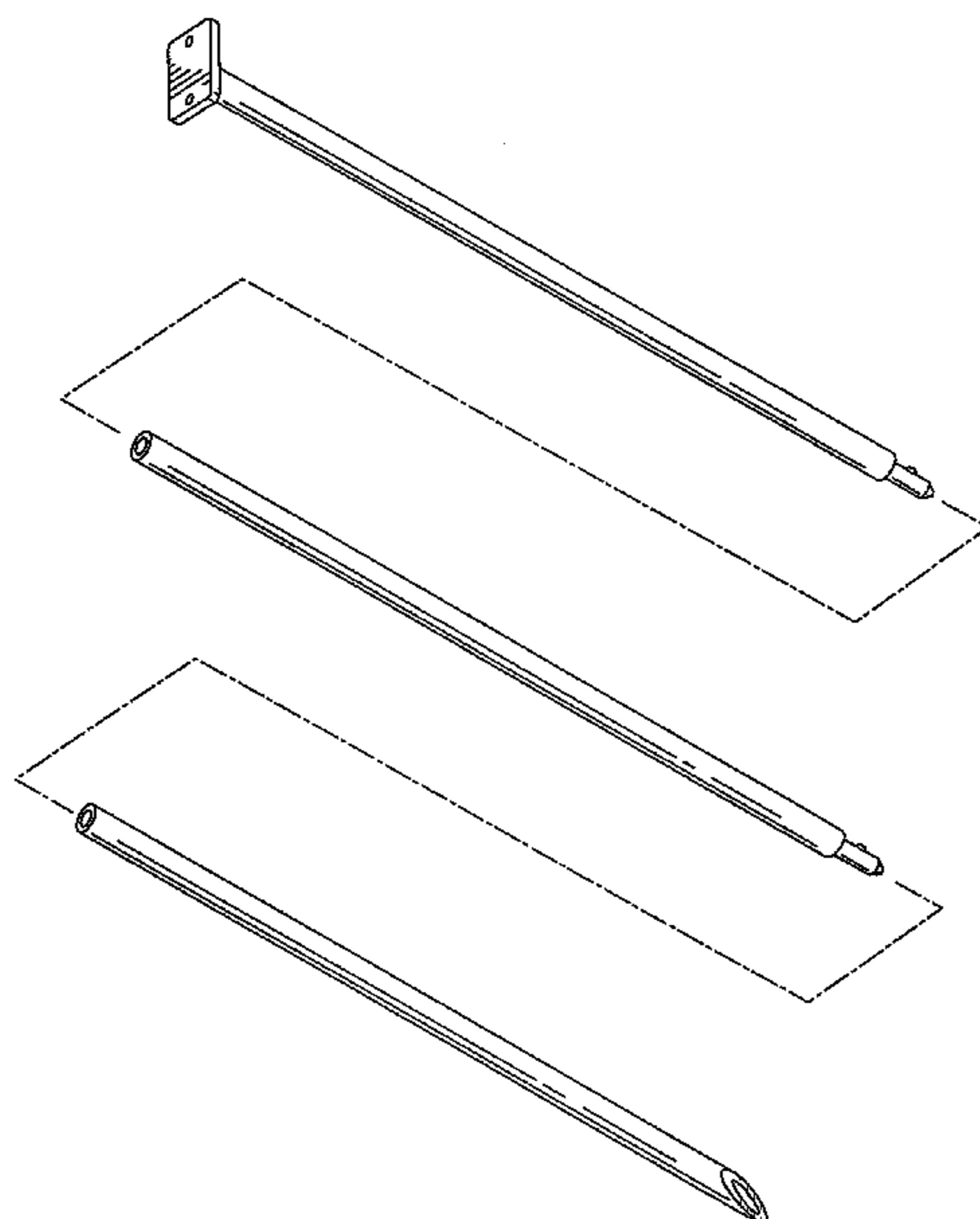

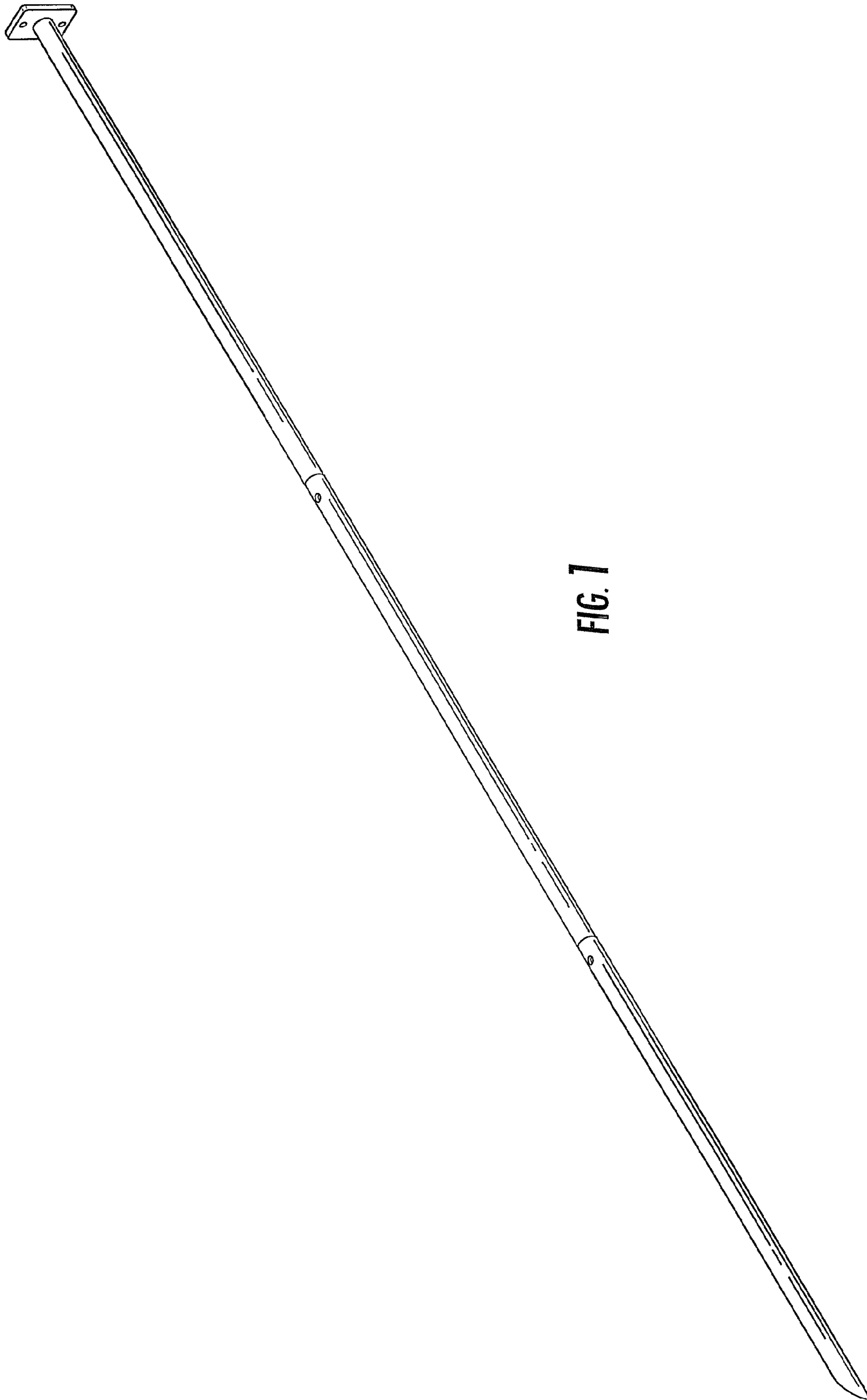

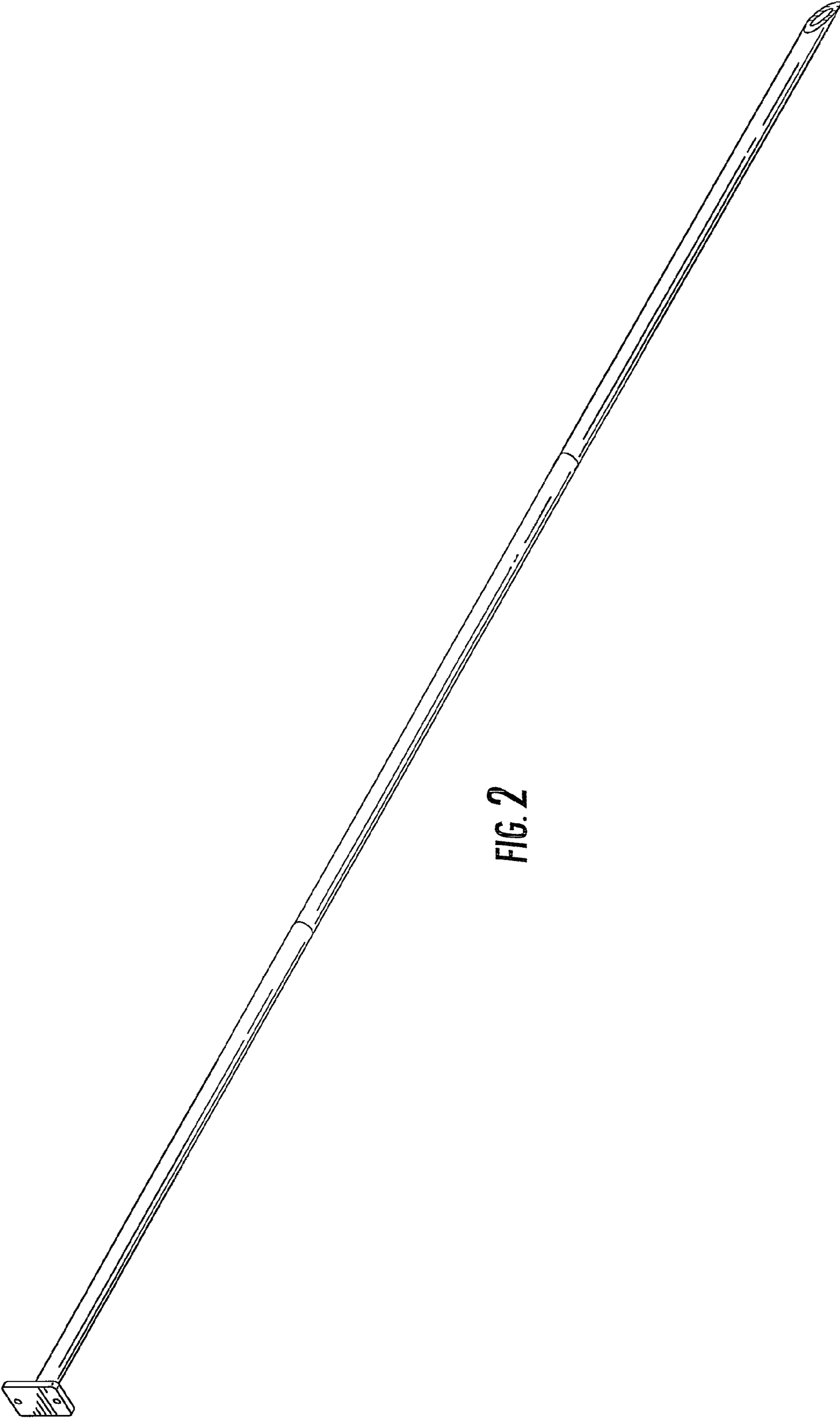
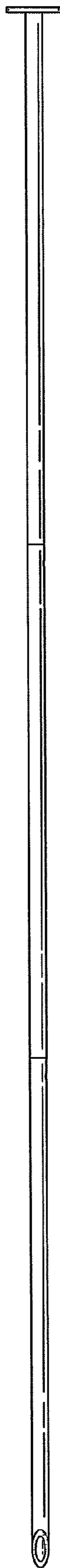
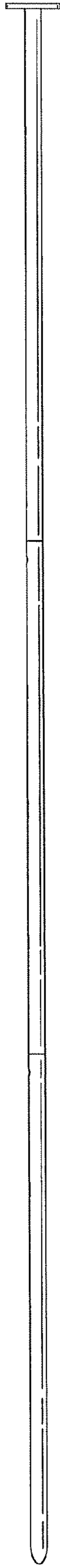

FIG. 2



**FIG. 3**



**FIG. 4**



**FIG. 5**



**FIG. 6**



**FIG. 7**



**FIG. 8**

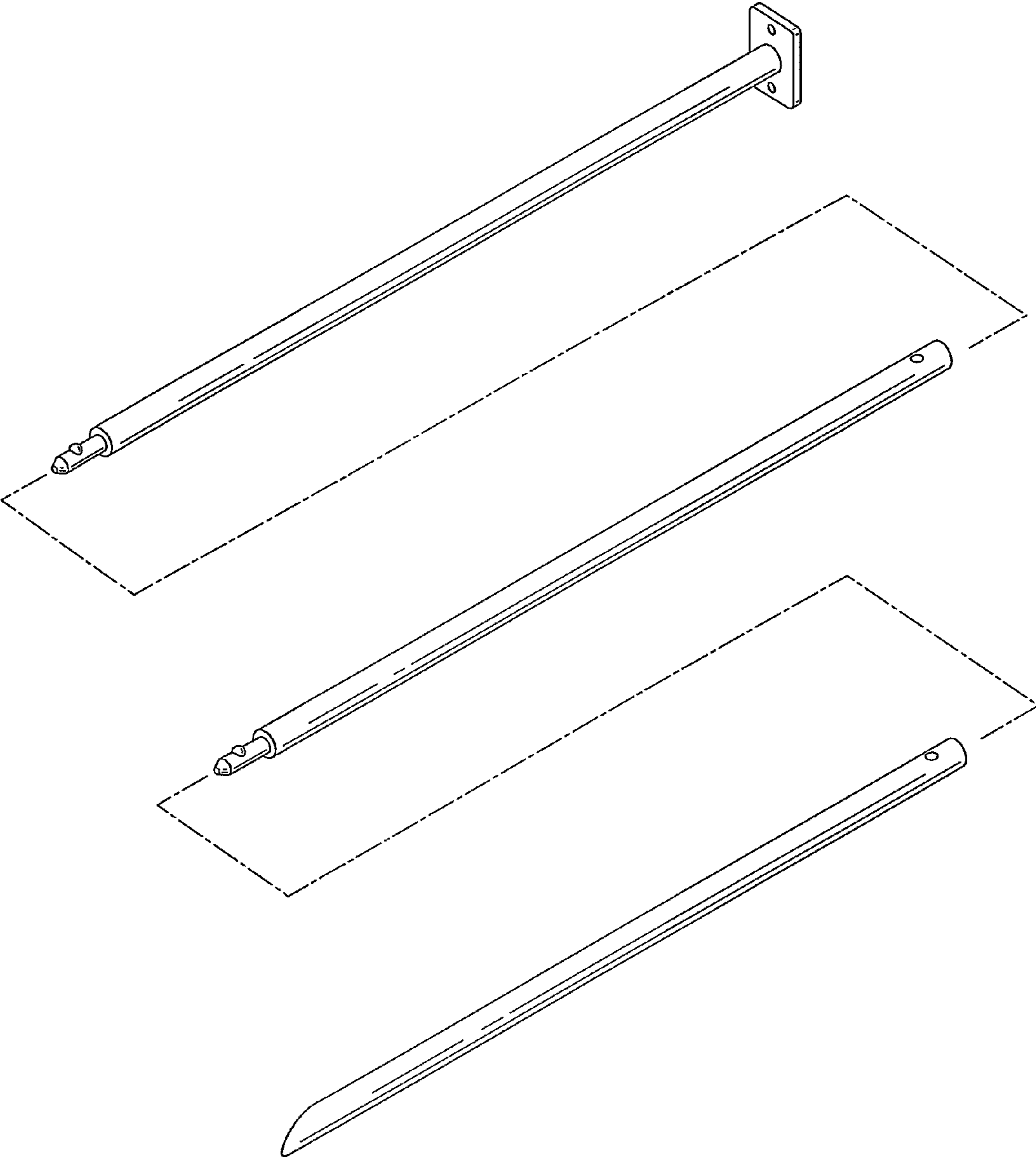

FIG. 9

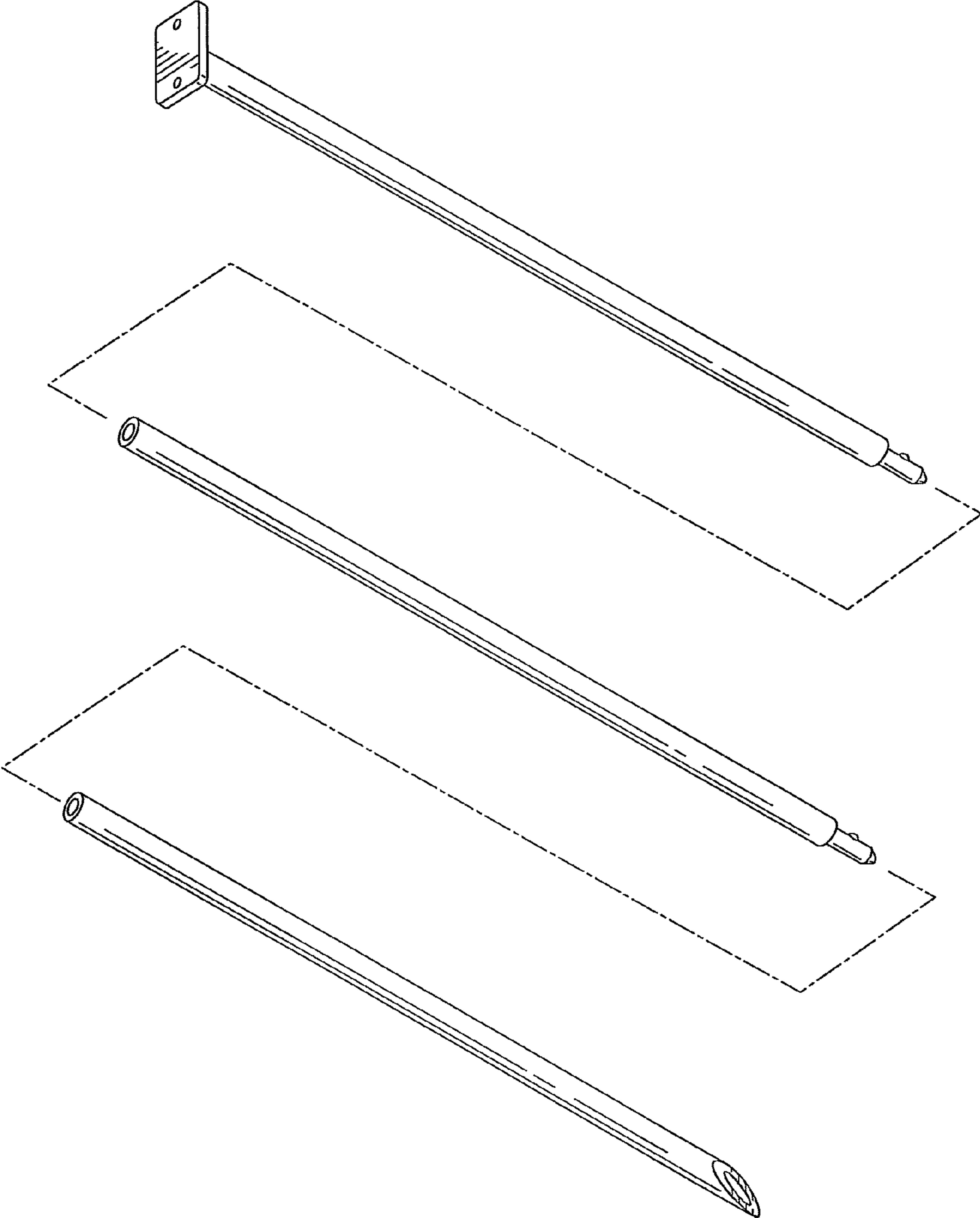

FIG. 10