



US00D694427S

(12) **United States Design Patent**  
**Eckert et al.**

(10) **Patent No.:** **US D694,427 S**

(45) **Date of Patent:** **\*\* Nov. 26, 2013**

(54) **KITCHEN**

(71) Applicant: **Bulthaup GmbH & Co. KG,**  
Bodenkirchen (DE)

(72) Inventors: **Marc Eckert, Landshut (DE); Klaus Dellbeck, Munich (DE)**

(73) Assignee: **Bulthaup GmbH & Co. KG,**  
Bodenkirchen (DE)

(\*\*) Term: **14 Years**

(21) Appl. No.: **29/444,447**

(22) Filed: **Jan. 30, 2013**

(30) **Foreign Application Priority Data**

Aug. 9, 2012 (EP) ..... 2 085 878

(51) **LOC (9) Cl.** ..... **25-03**

(52) **U.S. Cl.**  
USPC ..... **D25/35**

(58) **Field of Classification Search**  
USPC ..... D25/36, 58, 59, 555; 52/33, 36, 38, 234  
See application file for complete search history.

(56) **References Cited**

**U.S. PATENT DOCUMENTS**

|           |     |         |                        |       |         |
|-----------|-----|---------|------------------------|-------|---------|
| 3,195,701 | A * | 7/1965  | Brazelton              | ..... | 52/461  |
| D208,256  | S * | 8/1967  | Rich                   | ..... | D6/421  |
| D224,932  | S * | 10/1972 | Schuler et al.         | ..... | D23/272 |
| 3,708,709 | A   | 1/1973  | Morrison et al.        |       |         |
| 4,288,948 | A * | 9/1981  | Harris                 | ..... | 52/28   |
| 4,360,991 | A * | 11/1982 | West                   | ..... | 52/29   |
| D290,658  | S * | 6/1987  | Bianchin Scarpa et al. | ...   | D25/58  |
| 4,832,208 | A   | 5/1989  | Finnegan               |       |         |
| D340,533  | S * | 10/1993 | Beaulieu et al.        | ..... | D25/58  |

|          |     |        |                 |       |        |
|----------|-----|--------|-----------------|-------|--------|
| D395,521 | S * | 6/1998 | De Leu          | ..... | D25/58 |
| D397,561 | S * | 9/1998 | DePottay et al. | ..... | D6/455 |
| D473,952 | S * | 4/2003 | Smith et al.    | ..... | D25/58 |
| D674,114 | S * | 1/2013 | Van De Ven      | ..... | D25/58 |

**FOREIGN PATENT DOCUMENTS**

|    |                   |    |         |
|----|-------------------|----|---------|
| DE | 1781142           | U  | 1/1959  |
| DE | 3601583           | A1 | 8/1986  |
| DE | 4231460           | C2 | 3/1994  |
| DE | 29809122          | U1 | 9/1998  |
| DE | 400002970001      |    | 2/2000  |
| DE | 202008000393      | U1 | 4/2008  |
| DE | 102008047315      | A1 | 5/2010  |
| DE | 402009005769-0005 |    | 7/2010  |
| DE | 202009001325      | U1 | 11/2010 |
| DE | 402010004191-0019 |    | 9/2011  |
| DE | 402010004191-0024 |    | 9/2011  |
| DE | 202012003483      | U1 | 5/2012  |
| EP | 00023577-0001     |    | 10/2003 |
| EP | 00107222-0015     |    | 3/2004  |
| EP | 000257811-0001    |    | 2/2005  |

(Continued)

*Primary Examiner* — Eric Goodman

(74) *Attorney, Agent, or Firm* — Alleman Hall McCoy Russell & Tuttle LLP

(57) **CLAIM**

The ornamental design for a kitchen, as shown and described.

**DESCRIPTION**

FIG. 1 is a top view of a design for a kitchen according to the present disclosure.

FIG. 2 is a top-front perspective view of the kitchen of FIG. 1.

FIG. 3 is a right side view of the kitchen of FIG. 1; and,

FIG. 4 is a left side view of the kitchen of FIG. 1.

The solid lines in FIGS. 1-4 illustrate a kitchen according to the present disclosure. Front, rear, and bottom views are not shown as they do not show any additional claimed features.

**1 Claim, 1 Drawing Sheet**

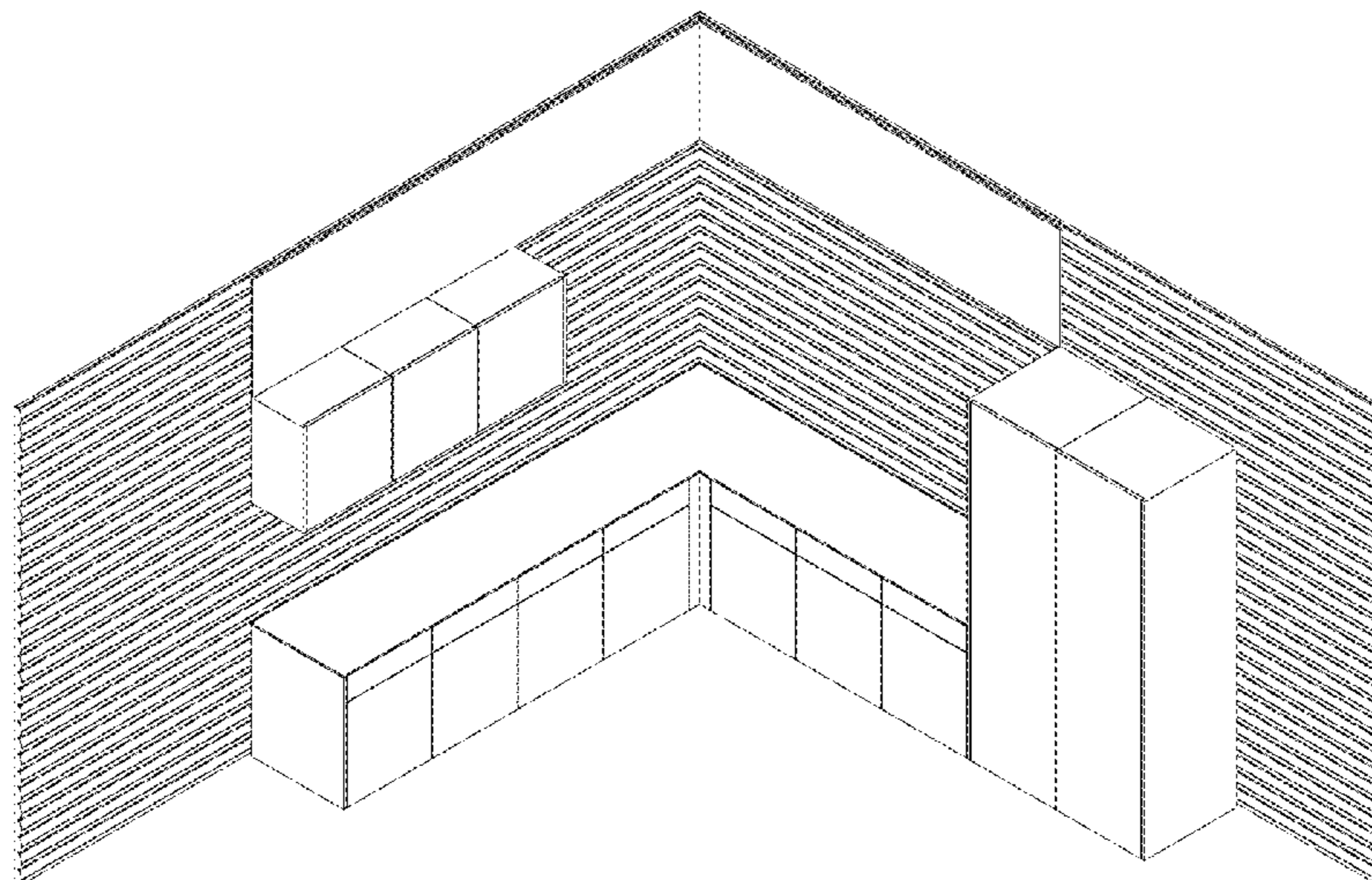

(56)

**References Cited**

FOREIGN PATENT DOCUMENTS

|    |                |         |
|----|----------------|---------|
| EP | 000257811-0031 | 2/2005  |
| EP | 000257811-0032 | 2/2005  |
| EP | 000263942-0001 | 3/2005  |
| EP | 000263942-0002 | 3/2005  |
| EP | 000301361-0001 | 3/2005  |
| EP | 1195117 B1     | 8/2005  |
| EP | 000558366-0002 | 8/2006  |
| EP | 00724018-0001  | 6/2007  |
| EP | 000789946-0001 | 10/2007 |

|    |                |         |
|----|----------------|---------|
| EP | 000824990-0001 | 11/2007 |
| EP | 00845243       | 1/2008  |
| EP | 001206015-0005 | 5/2010  |
| EP | 001206015-0006 | 5/2010  |
| EP | 001206015-0007 | 5/2010  |
| EP | 001206015-0008 | 5/2010  |
| EP | 001206015-0009 | 5/2010  |
| EP | 001206015-0010 | 5/2010  |
| EP | 2243396 A2     | 10/2010 |
| EP | 2353459 A1     | 8/2011  |
| WO | 9005354 A1     | 5/1990  |
| WO | 20064837       | 11/2003 |

\* cited by examiner

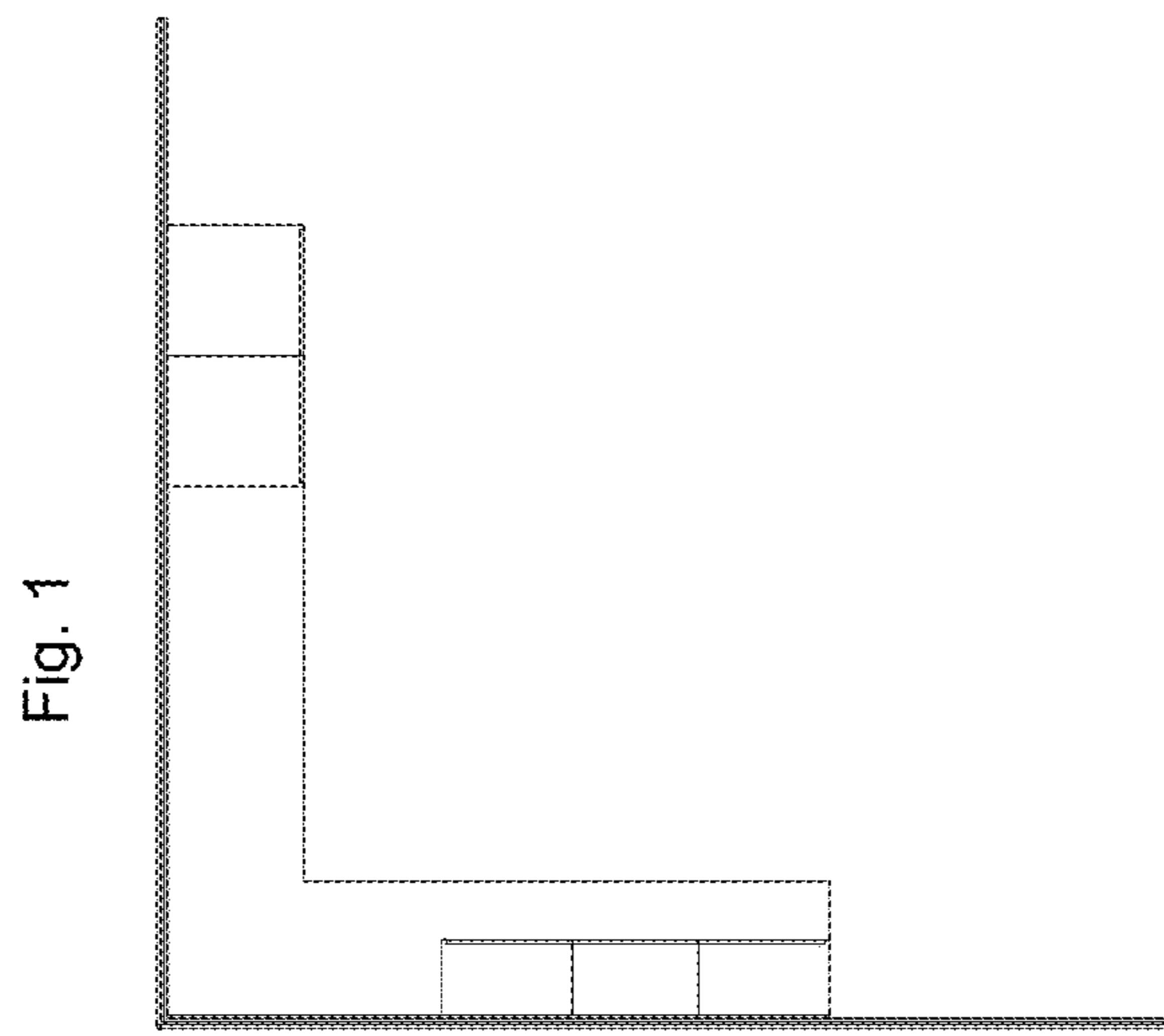

Fig. 1

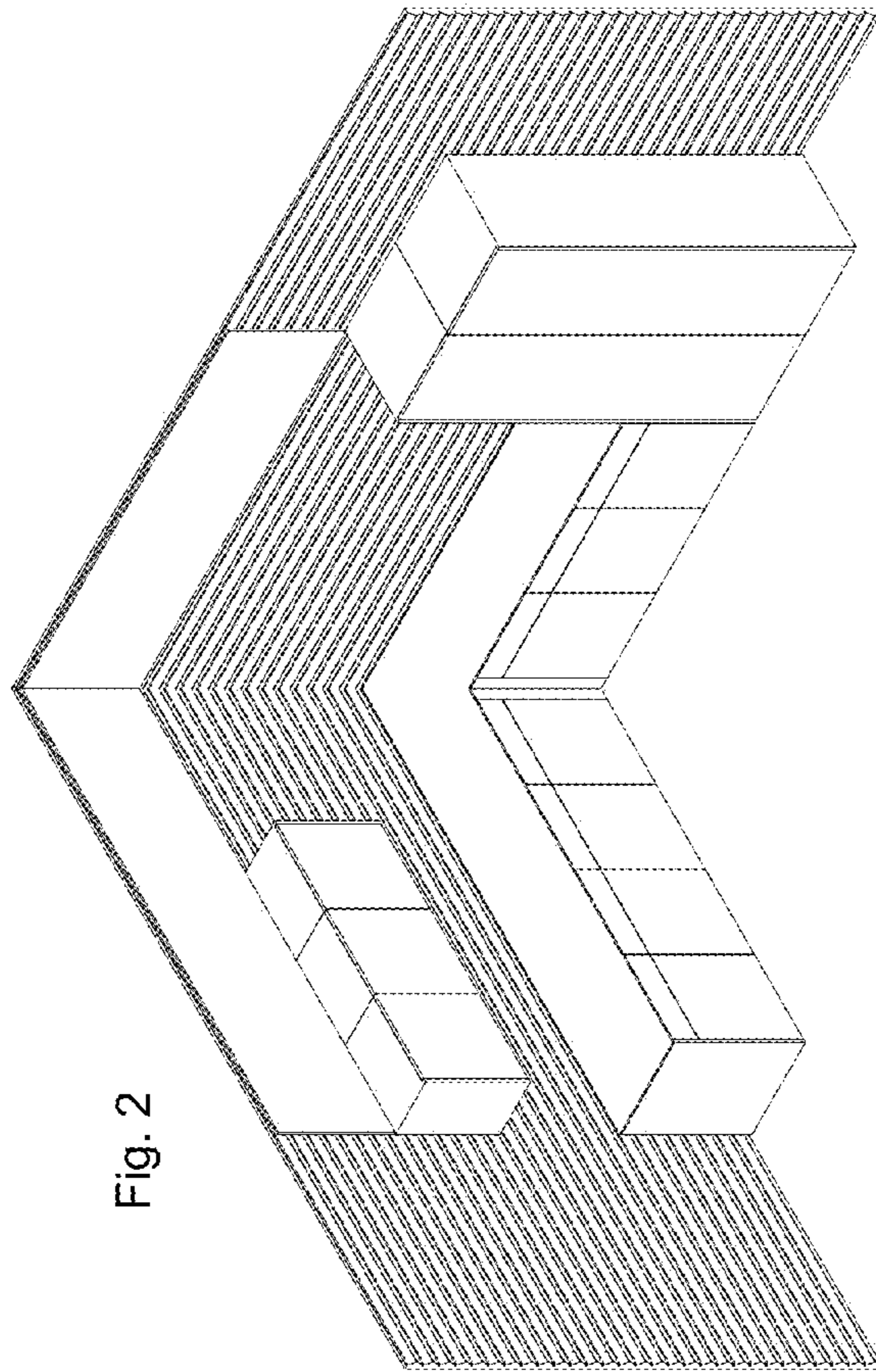

Fig. 2

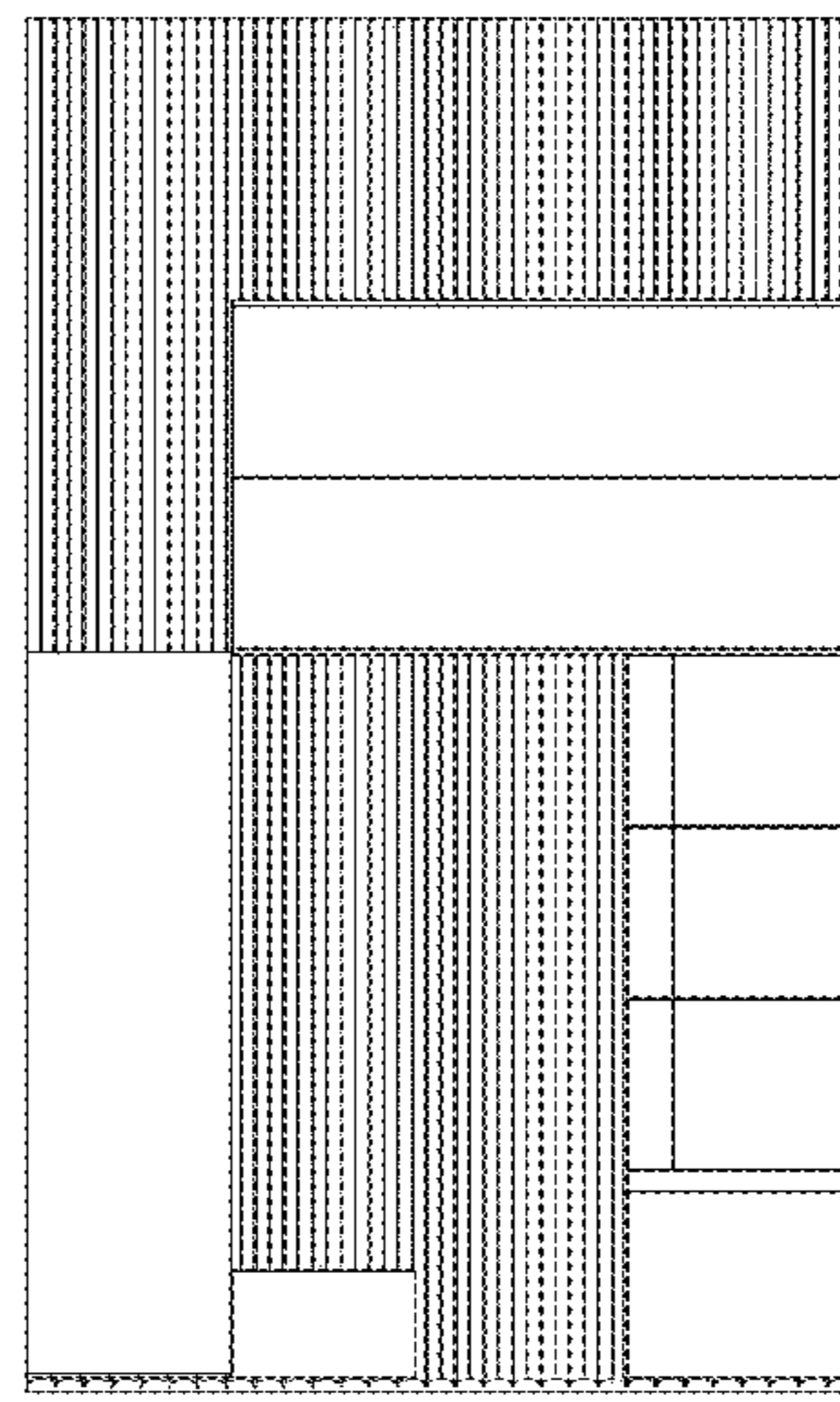

Fig. 3

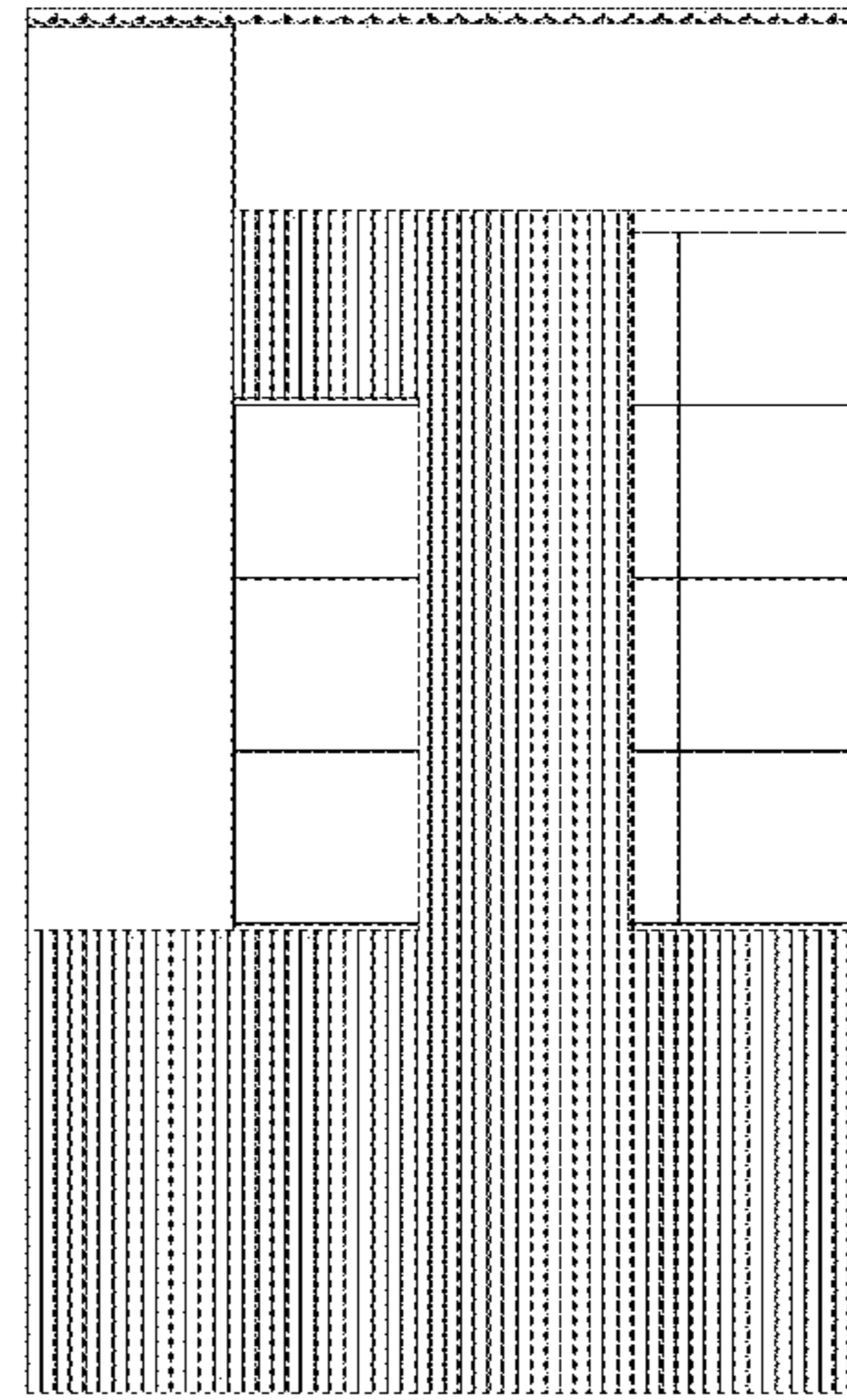

Fig. 4