



US00D693859S

(12) **United States Design Patent**
Kitamura

(10) **Patent No.:** **US D693,859 S**

(45) **Date of Patent:** **** Nov. 19, 2013**

(54) **MACHINING CENTER**

(71) Applicant: **Kitamura Machinery Co., Ltd.**,
Takaoka (JP)

(72) Inventor: **Akihiro Kitamura**, Takaoka (JP)

(73) Assignee: **Kitamura Machinery Co., Ltd.**,
Takaoka-Shi (JP)

(**) Term: **14 Years**

(21) Appl. No.: **29/421,941**

(22) Filed: **Oct. 26, 2012**

(30) **Foreign Application Priority Data**

Apr. 27, 2012 (JP) 2012-010174

(51) **LOC (9) Cl.** **15-09**

(52) **U.S. Cl.**
USPC **D15/122**

(58) **Field of Classification Search**
USPC D15/122, 124, 127, 128, 130, 131;
29/26 A, 26 R, 30, 33 A-33 T, 34 R, 39,
29/50, 563-566, 564.1-564.8; 483/17-57
See application file for complete search history.

(56) **References Cited**

U.S. PATENT DOCUMENTS

D266,520 S *	10/1982	Engel	D15/122
4,443,929 A *	4/1984	Bayer et al.	483/32
D319,834 S *	9/1991	Rutschle	D15/131
D388,103 S *	12/1997	Gotou et al.	D15/127
D399,221 S *	10/1998	Schwartz	D15/141
D445,807 S *	7/2001	Baulk	D15/127
D495,723 S *	9/2004	Kawamura et al.	D15/127
7,013,543 B2 *	3/2006	Iwabuchi et al.	29/27 C
D548,754 S *	8/2007	Itabashi et al.	D15/122

D548,755 S *	8/2007	Takeshima et al.	D15/122
D559,871 S *	1/2008	Kittaka et al.	D15/122
D567,263 S *	4/2008	Sugihara et al.	D15/122
D578,144 S *	10/2008	Arisue et al.	D15/122
D614,210 S *	4/2010	Basler et al.	D15/122
D620,508 S *	7/2010	Jacquet et al.	D15/122
D635,596 S *	4/2011	Hiroshima et al.	D15/122
D636,796 S *	4/2011	Hiroshima et al.	D15/122
D637,631 S *	5/2011	Hiroshima et al.	D15/122
D644,570 S *	9/2011	Chuang	D12/110
D649,173 S *	11/2011	Bruce et al.	D15/122
D649,174 S *	11/2011	Schindler	D15/127
D649,567 S *	11/2011	Schindler	D15/127
D654,099 S *	2/2012	Schindler et al.	D15/122
D654,518 S *	2/2012	Miyake et al.	D15/122
D658,686 S *	5/2012	Mueller	D15/122
D659,728 S *	5/2012	Mueller	D15/122
D667,031 S *	9/2012	Mueller	D15/122
D667,032 S *	9/2012	Egami	D15/122
D671,969 S *	12/2012	Yang et al.	D15/122
D676,882 S *	2/2013	Mueller	D15/122
D680,563 S *	4/2013	Yang et al.	D15/122

* cited by examiner

Primary Examiner — Patricia Palasik

(74) *Attorney, Agent, or Firm* — Manabu Kanesaka

(57) **CLAIM**

The ornamental design for a machining center, as shown and described.

DESCRIPTION

FIG. 1 is a front right-side perspective view of a machining center showing my new design;
FIG. 2 is a front left-side perspective view thereof;
FIG. 3 is a front view thereof;
FIG. 4 is a back view thereof;
FIG. 5 is a left side view thereof;
FIG. 6 is a right view thereof; and,
FIG. 7 is a plan view thereof.

1 Claim, 7 Drawing Sheets

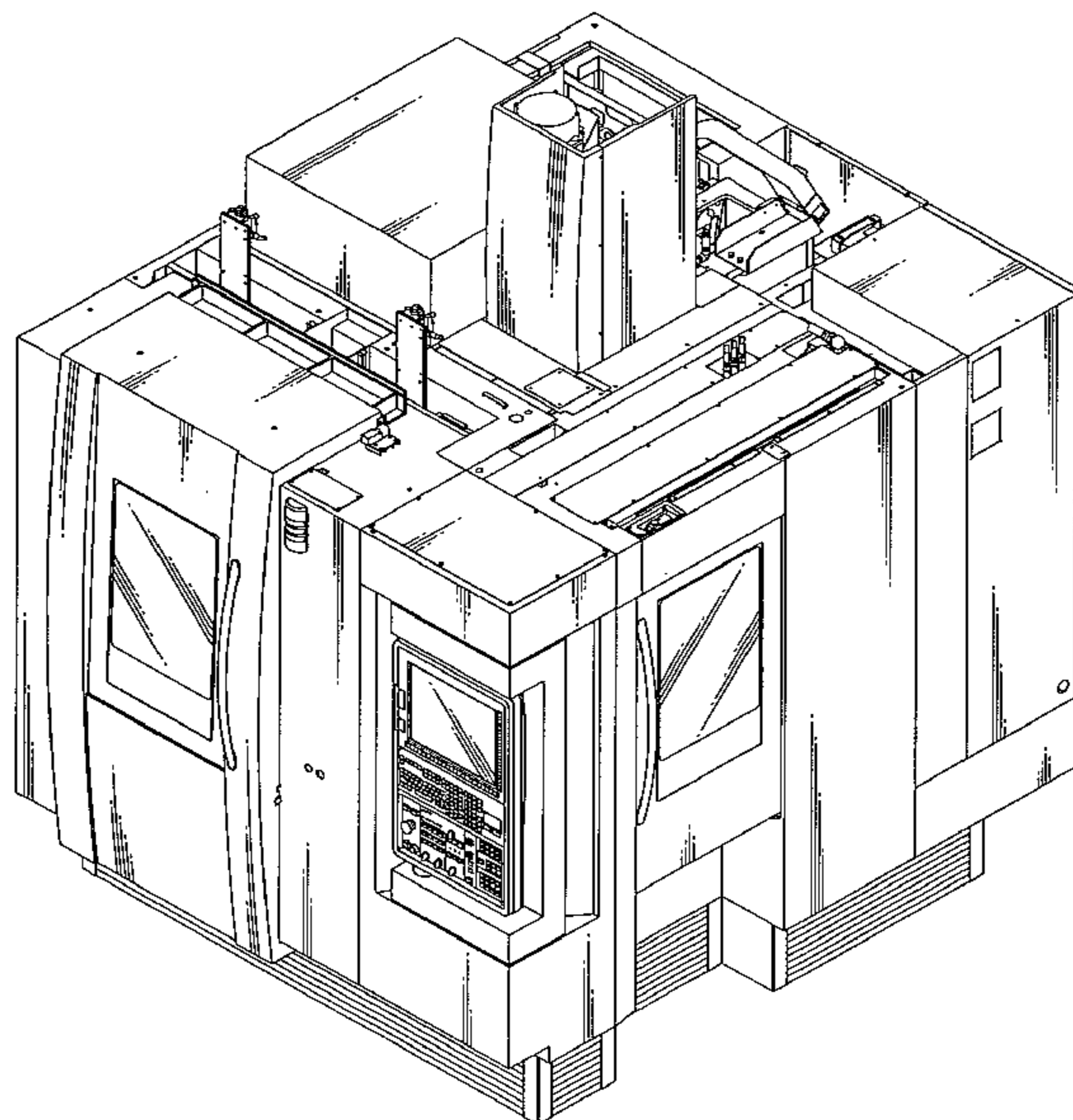

FIG. 1

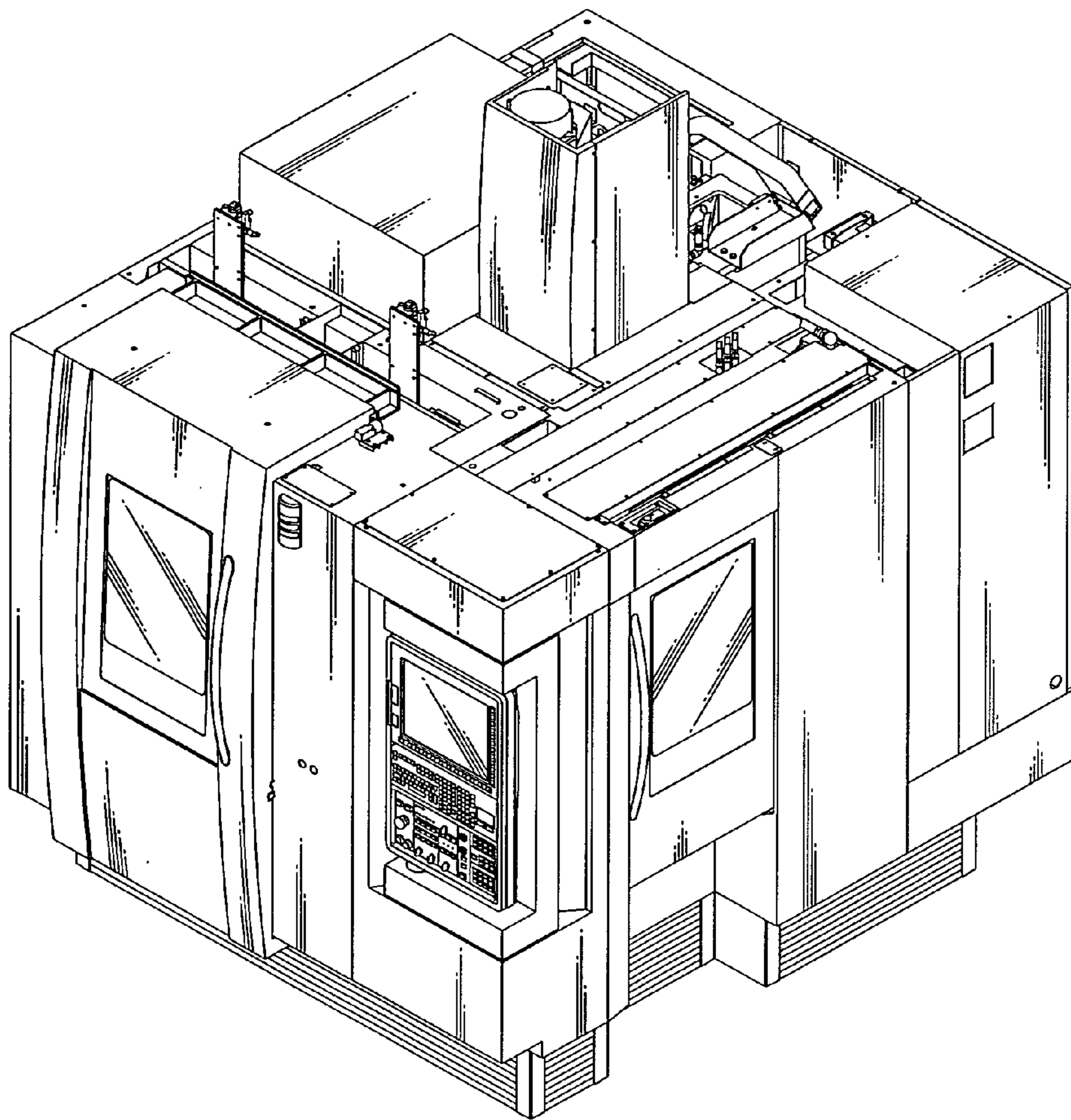

FIG.2

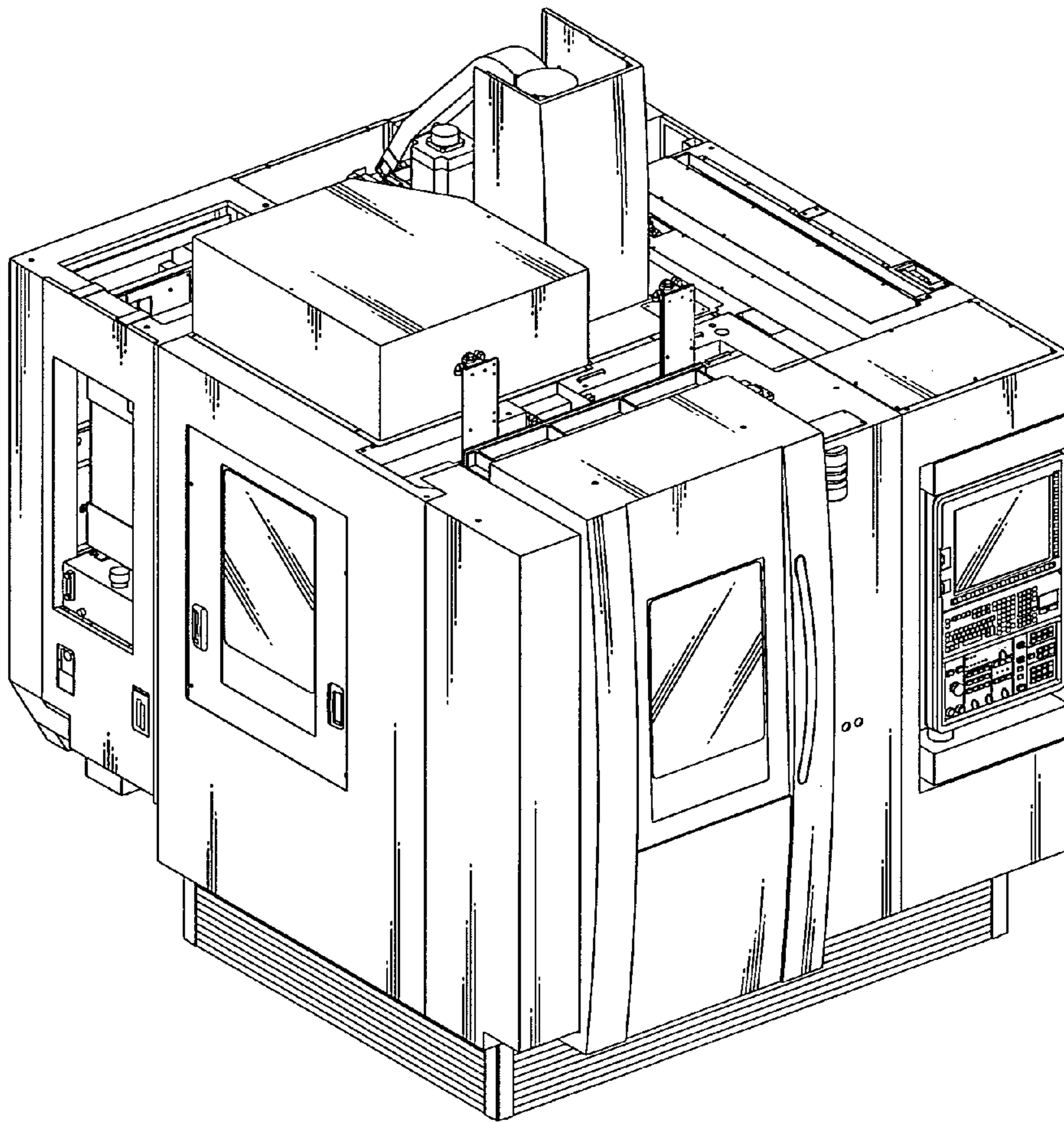

FIG.3

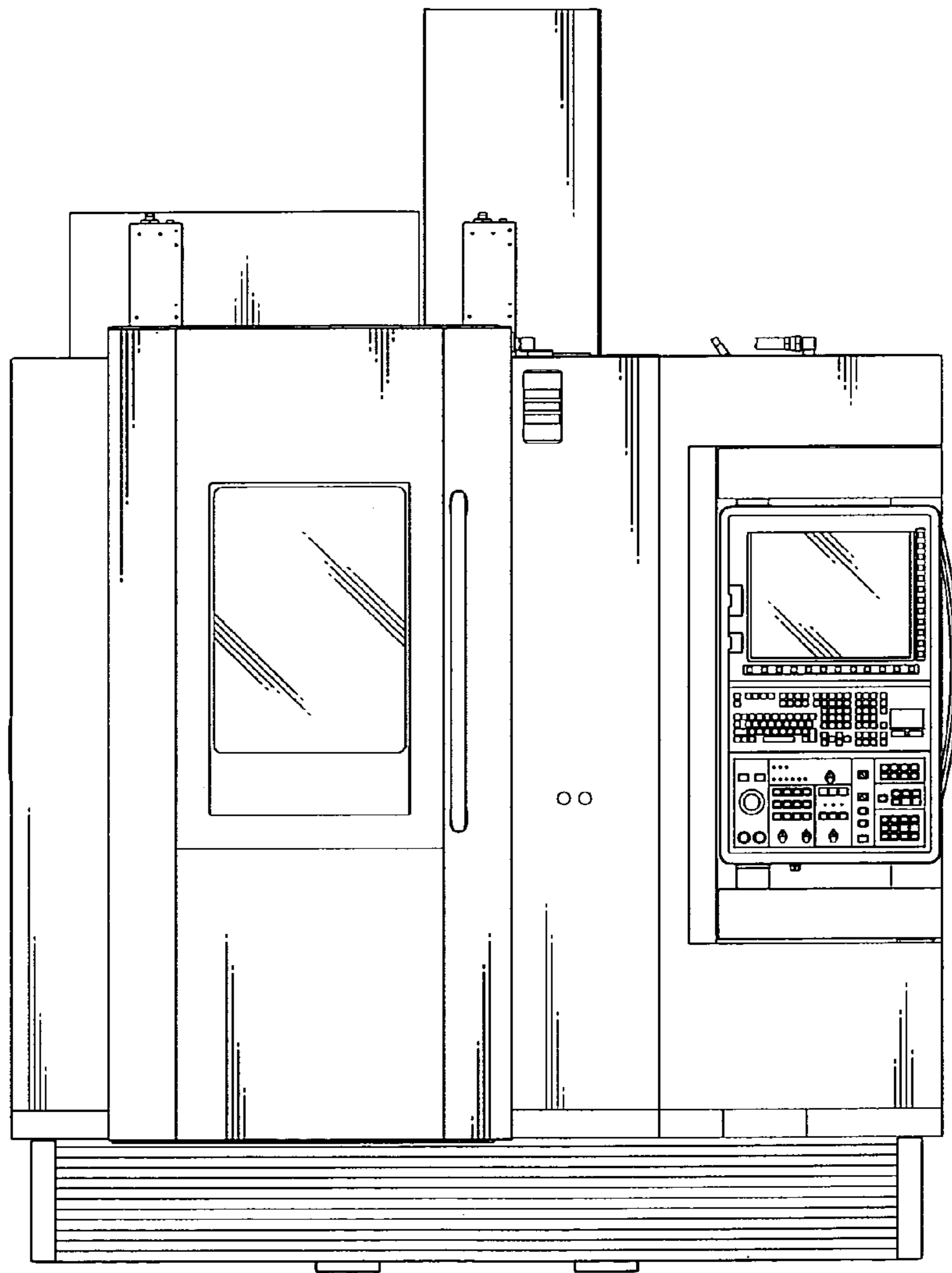

FIG. 4

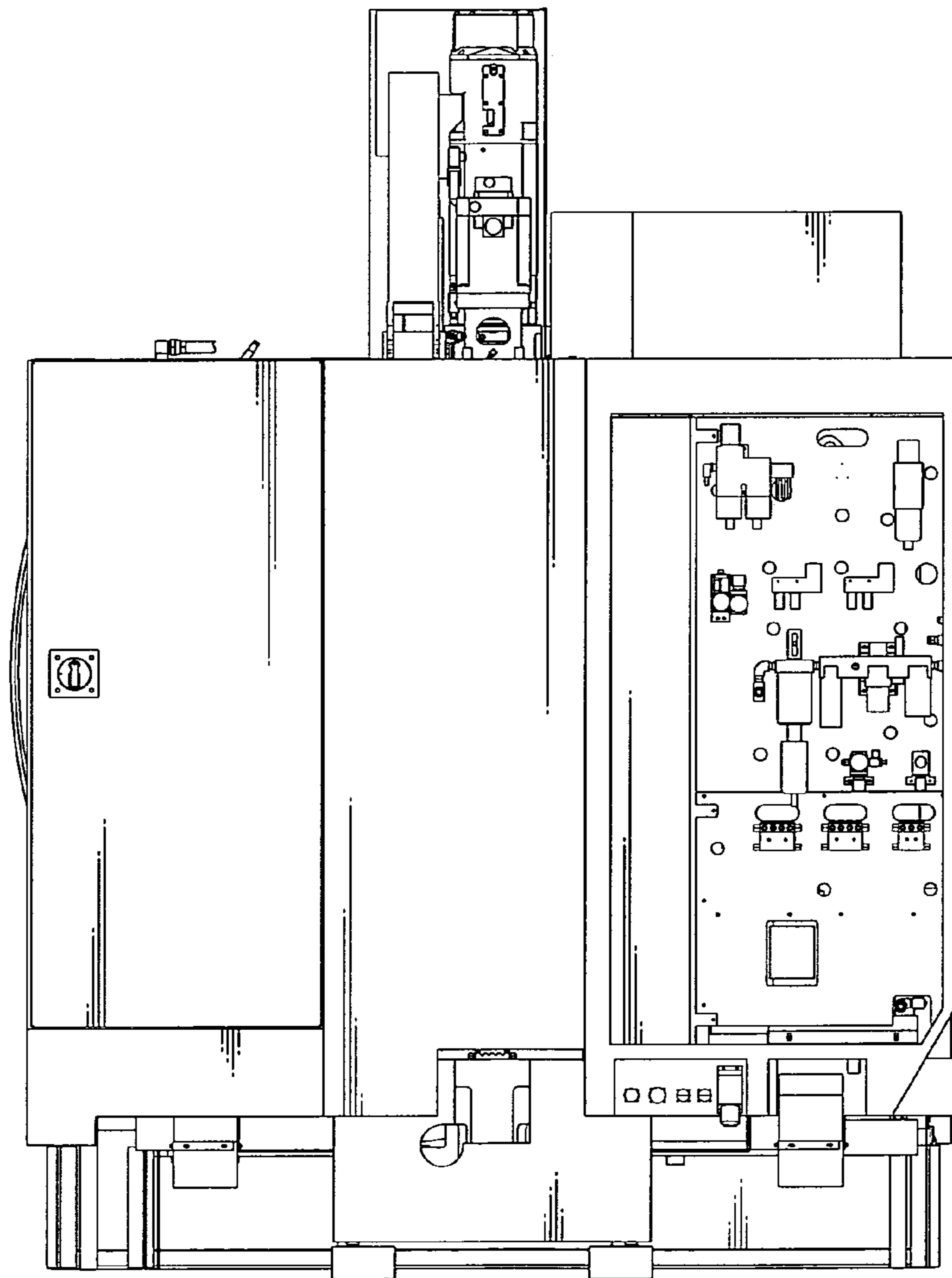

FIG.5

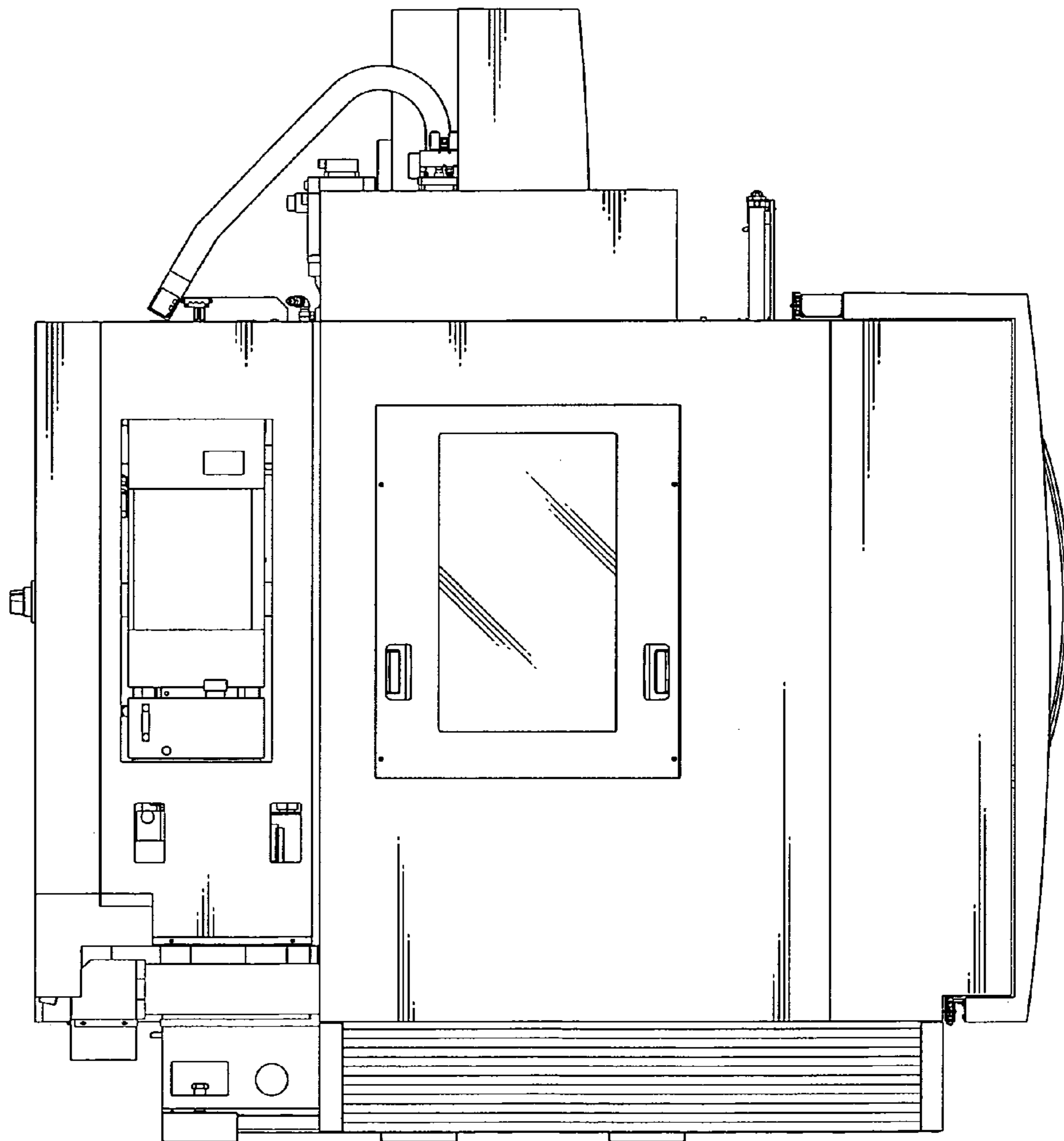

FIG.6

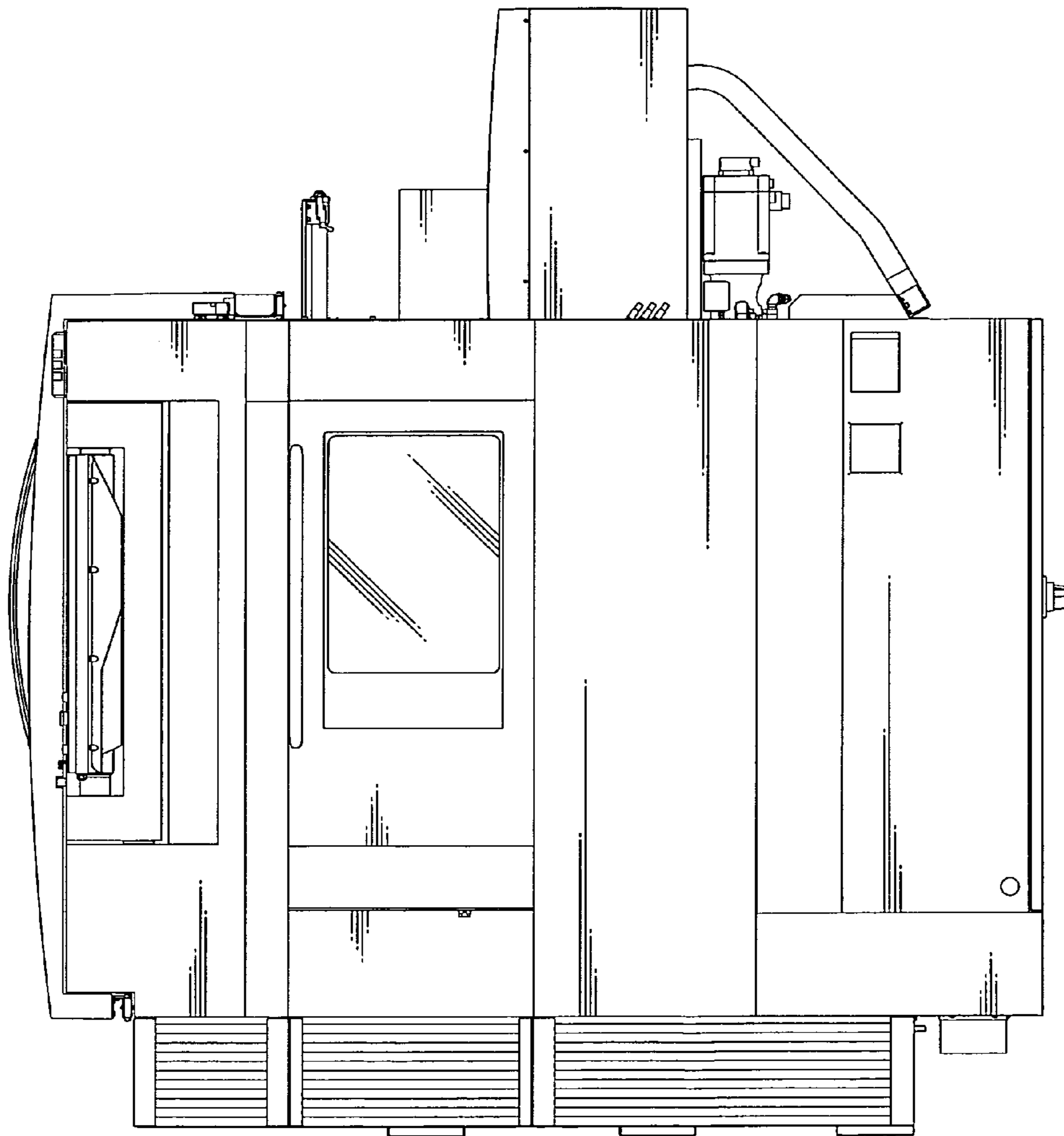

FIG. 7

