



US00D693119S

(12) **United States Design Patent**
Butler

(10) **Patent No.:** **US D693,119 S**

(45) **Date of Patent:** **** Nov. 12, 2013**

(54) **EYEGASSES HOLDER AND LENS
PROTECTOR WRAP**

D264,976 S * 6/1982 Greene D3/265
D279,522 S * 7/1985 Scoppettone D3/265
4,823,943 A * 4/1989 Chang 206/5

(Continued)

(71) Applicant: **Irene Butler**, Henderson, NV (US)

Primary Examiner — T. Chase Nelson

(72) Inventor: **Irene Butler**, Henderson, NV (US)

(74) *Attorney, Agent, or Firm* — Howard & Howard
Attorneys PLLC

(**) Term: **14 Years**

(21) Appl. No.: **29/446,424**

(57) **CLAIM**

The ornamental design for an eyeglasses holder and lens protector wrap, as shown and described.

(22) Filed: **Feb. 22, 2013**

DESCRIPTION

(51) **LOC (9) Cl.** **03-01**

(52) **U.S. Cl.**
USPC **D3/265**

(58) **Field of Classification Search**

USPC D3/207, 215, 219, 229, 263–268, 301;
D12/417; D16/330, 339; 24/3.3, 3.7,
24/3.8; 206/5, 5.1, 6; 248/902; 351/112,
351/155

See application file for complete search history.

FIG. 1 is a perspective view of my new eyeglasses holder and lens protector wrap in the fully closed position.

FIG. 2 is a perspective view of the eyeglasses holder and lens protector wrap shown in FIG. 1 in a partially closed position;

FIG. 3 is a top view of the eyeglasses holder and lens protector wrap of FIG. 1, shown in a fully open position;

FIG. 4 is a side view of the eyeglasses holder and lens protector wrap of FIG. 3;

FIG. 5 is a side view of the opposing side of the eyeglasses holder and lens protector wrap of FIG. 3;

FIG. 6 is a bottom view of the eyeglasses holder and lens protector wrap of FIG. 3;

FIG. 7 is a front view of the eyeglasses holder and lens protector wrap of FIG. 3; and,

FIG. 8 is a rear view of the eyeglasses holder and lens protector wrap of FIG. 3.

It is noted the surface markings are provided for clarity of the shape of the design but do not indicate the use of any specific type of surface material. The surface markings, where partially shown, are understood to fully and uniformly cover the surfaces upon which they are shown. Additionally, the eyeglasses, short broken lines near the perimeter of the design, as well as any other broken lines are for purposes of illustrating environmental structure and portions of the eyeglasses holder and lens protector wrap that form no part of the claimed design.

(56) **References Cited**

U.S. PATENT DOCUMENTS

D103,879 S * 3/1937 Hirschburg D3/265
D136,361 S * 9/1943 Socket D3/265
2,351,447 A * 6/1944 Nathan 206/5
D140,142 S * 1/1945 Jerry D3/265
D146,223 S * 1/1947 Kalnitz D3/265
2,440,552 A * 4/1948 Mittell 206/5
2,467,984 A * 4/1949 Patts 206/5
2,473,292 A * 6/1949 Nathan 206/5
2,657,791 A * 11/1953 Grosvenor 206/5
D173,801 S * 1/1955 Gay D3/265
D179,462 S * 12/1956 Stegeman D3/265
D179,924 S * 3/1957 Stegeman D3/265
2,866,539 A * 12/1958 McCulloch 206/5
2,909,276 A * 10/1959 Stegeman 206/5
2,913,100 A * 11/1959 Carmichael 206/5
D189,994 S * 3/1961 Spielberg D3/265
3,000,417 A * 9/1961 Goldstein 206/5
3,977,516 A * 8/1976 Tilve 206/5
D247,200 S * 2/1978 Marks D3/265

1 Claim, 4 Drawing Sheets

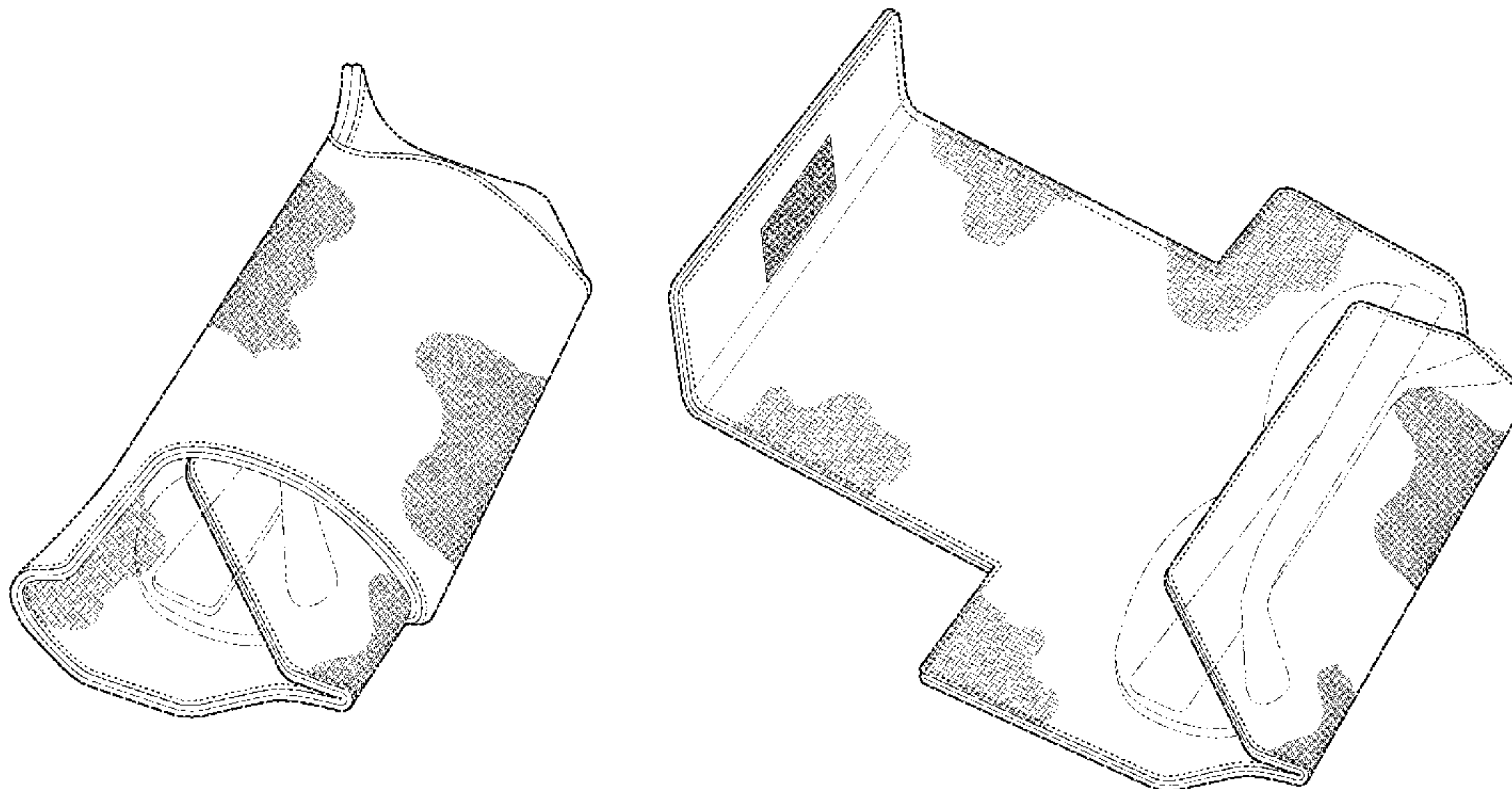

US D693,119 S

Page 2

(56)

References Cited

U.S. PATENT DOCUMENTS

D308,598 S *	6/1990	Burchett	D3/265	D361,660 S *	8/1995	Booth et al.	D3/265
D309,828 S *	8/1990	Cook	D3/265	D374,766 S *	10/1996	Raus	D3/215
4,951,811 A *	8/1990	Lines	206/5	D391,075 S *	2/1998	Jackson et al.	D3/215
4,984,682 A *	1/1991	Cummins	206/5	D411,661 S *	6/1999	Spence	D3/265
5,032,019 A *	7/1991	Burchett	351/158	D577,760 S *	9/2008	Alexander	D16/330
D346,815 S *	5/1994	Wake	D3/265	D610,806 S *	3/2010	Alexander	D3/265
					D645,660 S *	9/2011	Liebers	D3/265
					D646,481 S *	10/2011	Taylor	D3/266
					D648,528 S *	11/2011	Liebers	D3/264

* cited by examiner

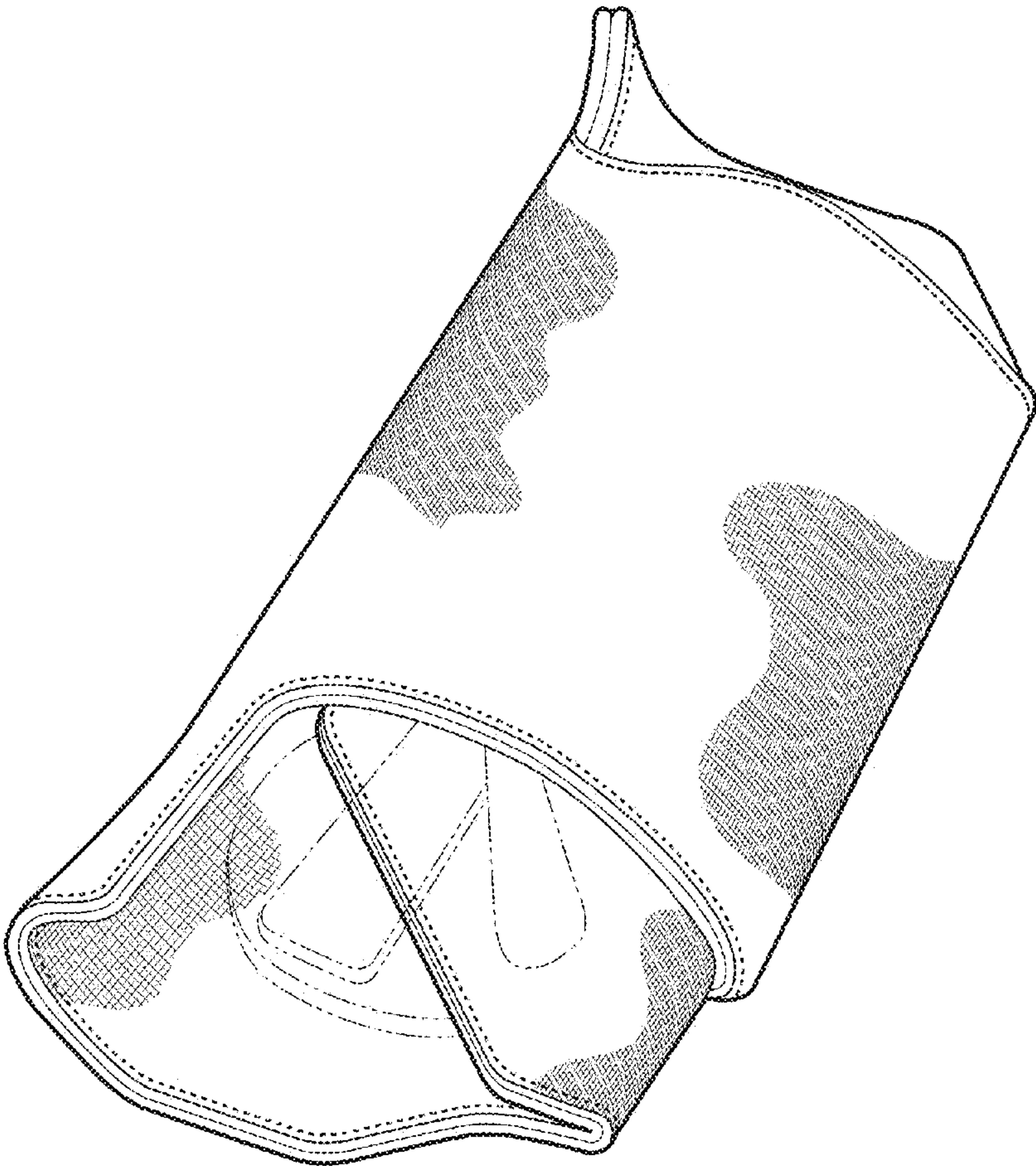

FIG. 1

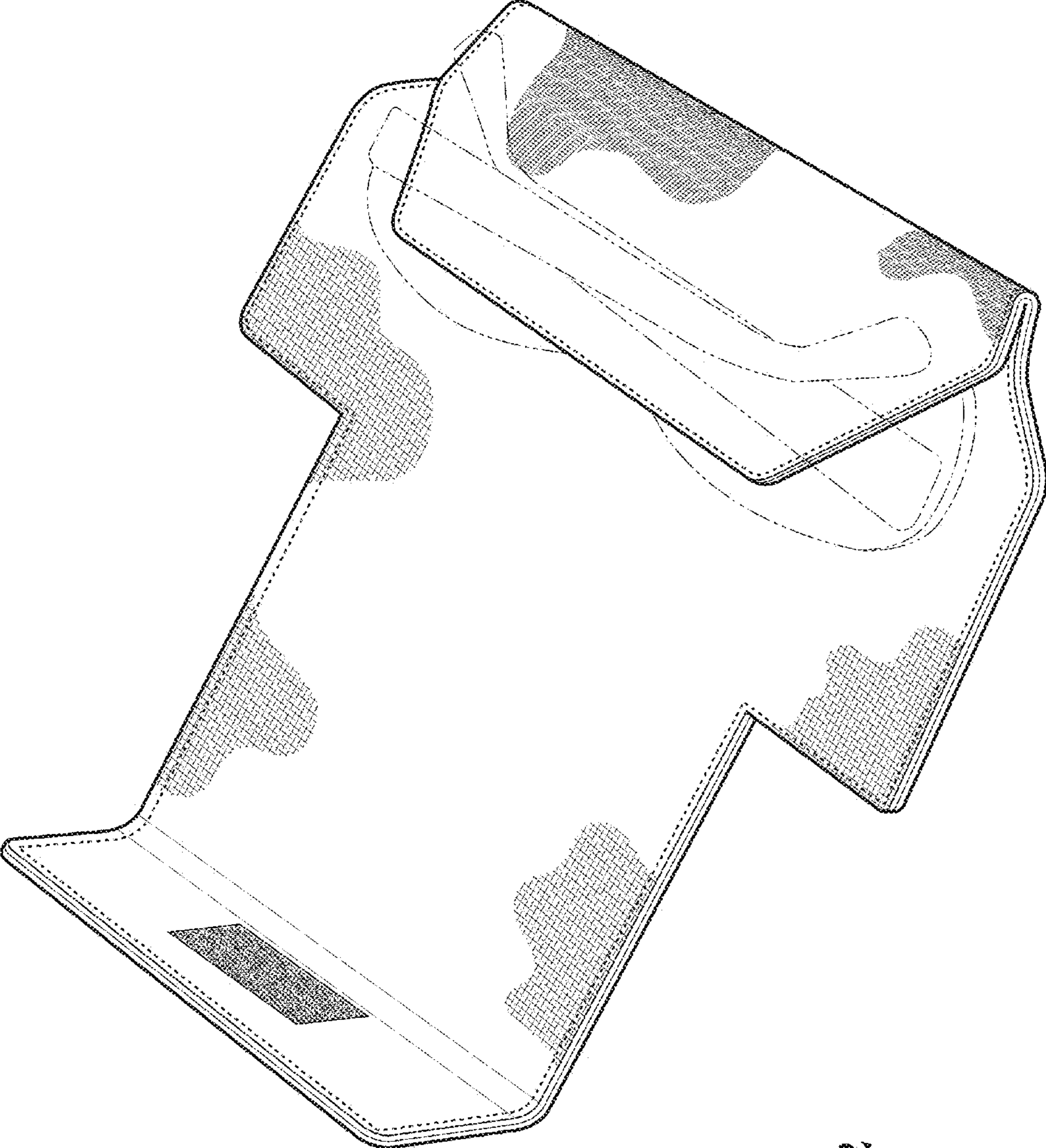

FIG. 2

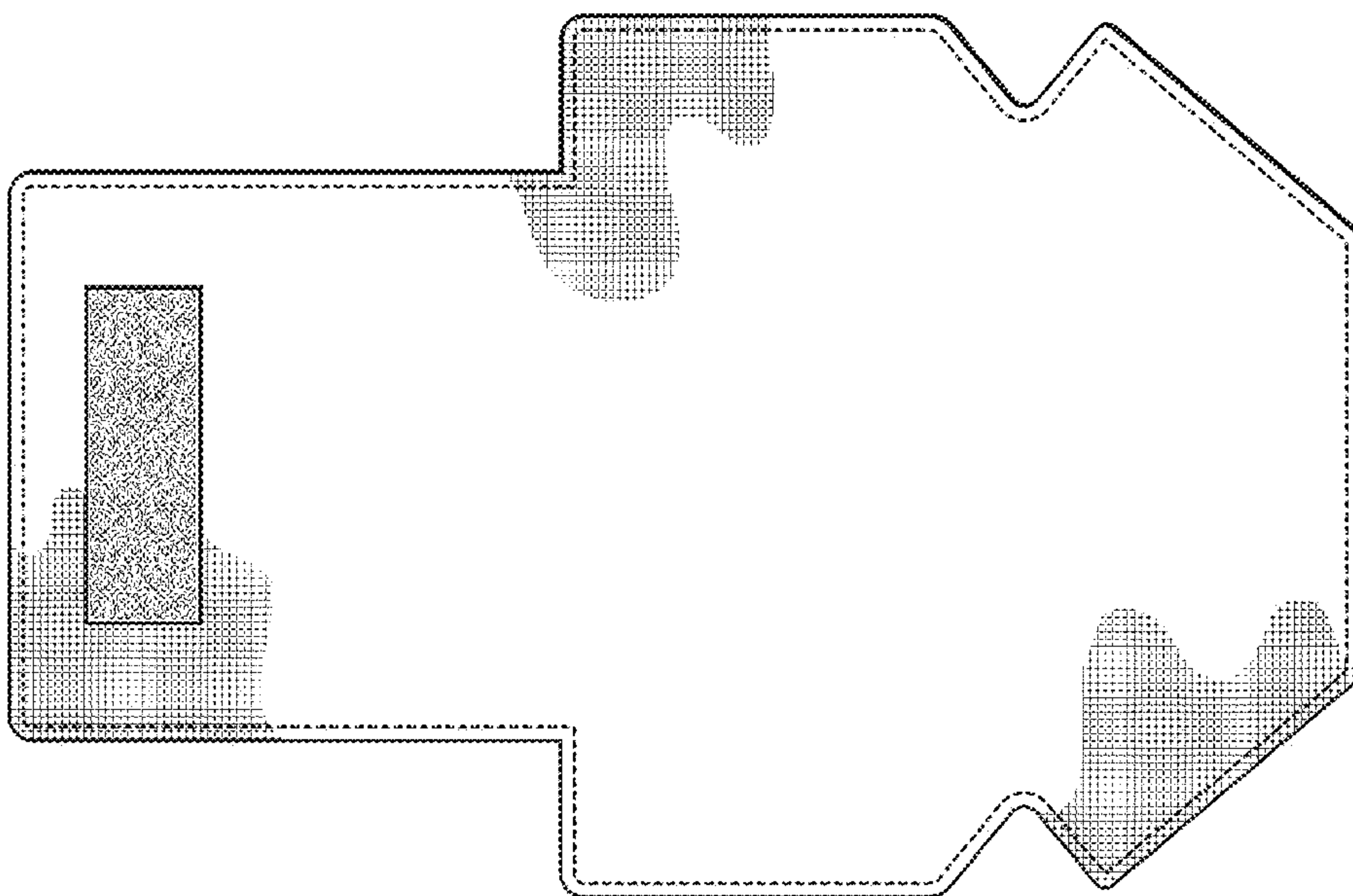

FIG. 3

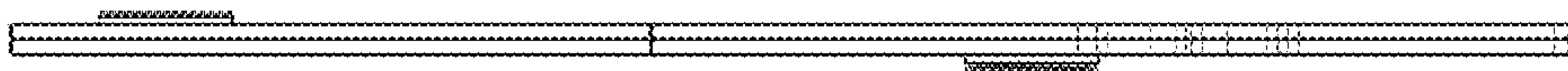

FIG. 4

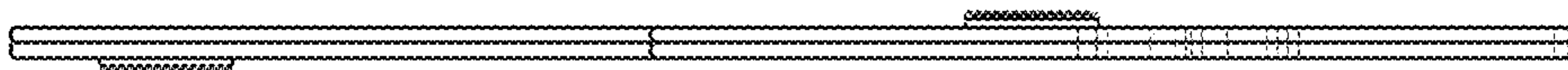

FIG. 5



FIG. 7



FIG. 8

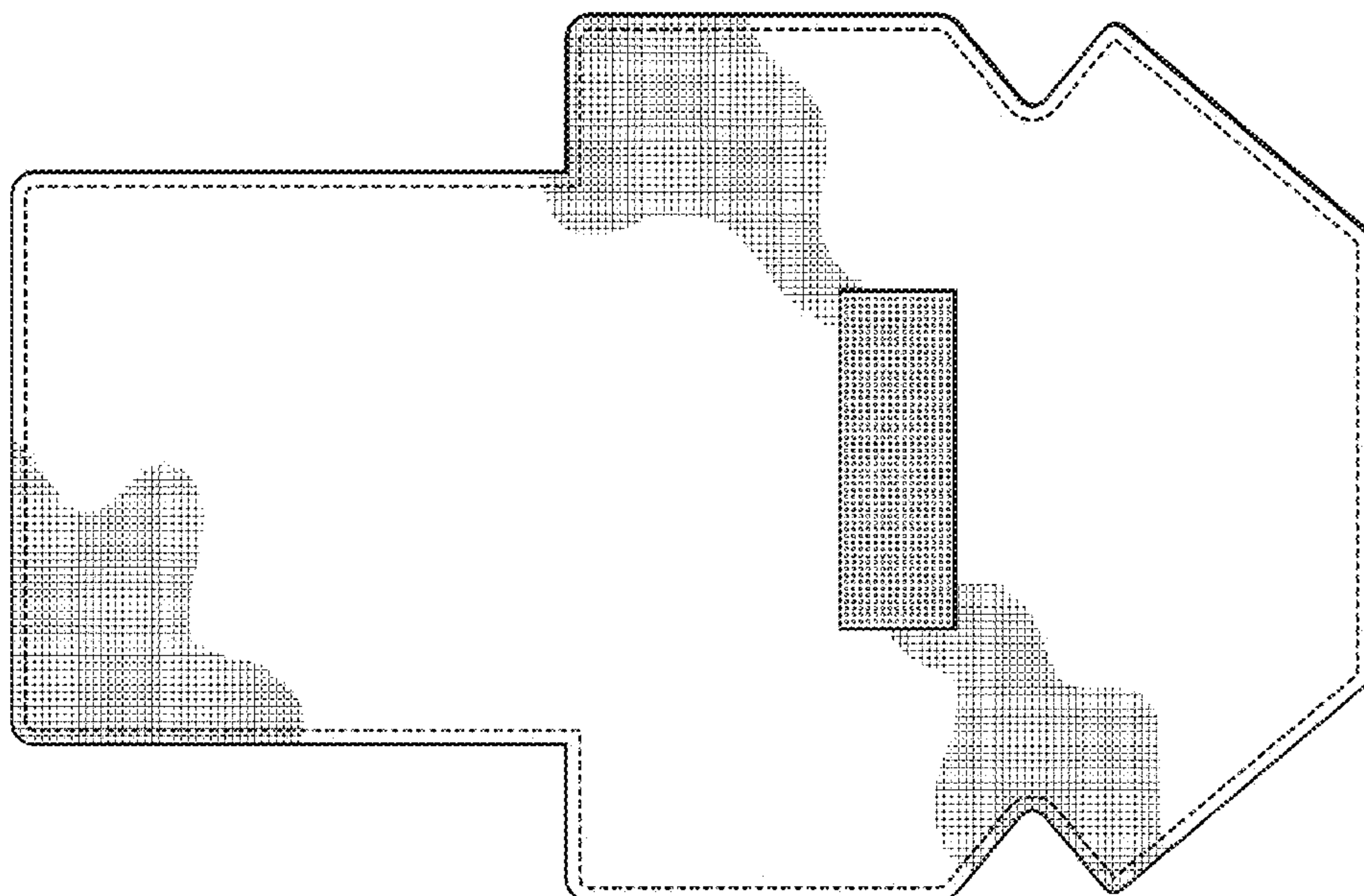

FIG. 6