



US00D691950S

(12) **United States Design Patent**  
**Asai et al.**

(10) **Patent No.:** **US D691,950 S**  
(45) **Date of Patent:** **\*\* Oct. 22, 2013**

(54) **ELECTRICAL CONNECTOR**

(75) Inventors: **Kiyoshi Asai**, Yokohama (JP); **Manabu Dobashi**, Tokyo (JP)

(73) Assignee: **SMK Corporation**, Tokyo (JP)

(\*\*) Term: **14 Years**

(21) Appl. No.: **29/421,743**

(22) Filed: **Sep. 13, 2012**

(30) **Foreign Application Priority Data**

Jun. 21, 2012 (JP) ..... 2012-016255

(51) **LOC (9) Cl.** ..... **13-03**

(52) **U.S. Cl.**  
USPC ..... **D13/133**

(58) **Field of Classification Search**  
USPC ..... D13/133, 154, 184, 199; 439/180, 246,  
439/252, 278, 374, 378, 380, 381, 527, 529,  
439/606, 668-669, 675-676, 680, 750-751,  
439/892, 894

See application file for complete search history.

(56) **References Cited**

**U.S. PATENT DOCUMENTS**

4,433,222 A \* 2/1984 Kodaira ..... 200/536  
D287,359 S \* 12/1986 Ohashi ..... D13/171  
D296,325 S \* 6/1988 Hugin ..... D13/133  
D340,029 S \* 10/1993 Takizawa ..... D13/133  
D340,224 S \* 10/1993 Gierut ..... D13/171

D403,305 S \* 12/1998 Lorenzo Regidor ..... D13/158  
D491,145 S \* 6/2004 Hu et al. .... D13/147  
D513,606 S \* 1/2006 Yamane ..... D13/149  
D561,706 S \* 2/2008 Mishima ..... D13/171  
D586,756 S \* 2/2009 Magnuson et al. .... D13/154  
D607,820 S \* 1/2010 Thorner ..... D13/133  
D653,211 S \* 1/2012 Magnezi ..... D13/133  
D665,745 S \* 8/2012 Yamauchi et al. .... D13/133  
2006/0051986 A1 \* 3/2006 Asai et al. .... 439/71

\* cited by examiner

*Primary Examiner* — Thomas Johannes

(74) *Attorney, Agent, or Firm* — Jean C. Edwards, Esq.;  
Edwards Neils PLLC

(57) **CLAIM**

The ornamental design for an electrical connector, as shown and described.

**DESCRIPTION**

FIG. 1 is a perspective view of the front and right side of an electrical connector showing our new design;  
FIG. 2 is a perspective view of the rear and right side thereof;  
FIG. 3 is a front view thereof;  
FIG. 4 is a rear view thereof;  
FIG. 5 is a right view thereof; the left view being a mirror image thereof;  
FIG. 6 is a top view thereof; and,  
FIG. 7 is a bottom view thereof.

The present article is an electrical connector, which establishes electrical connection between a circuit on a printed circuit board.

**1 Claim, 7 Drawing Sheets**

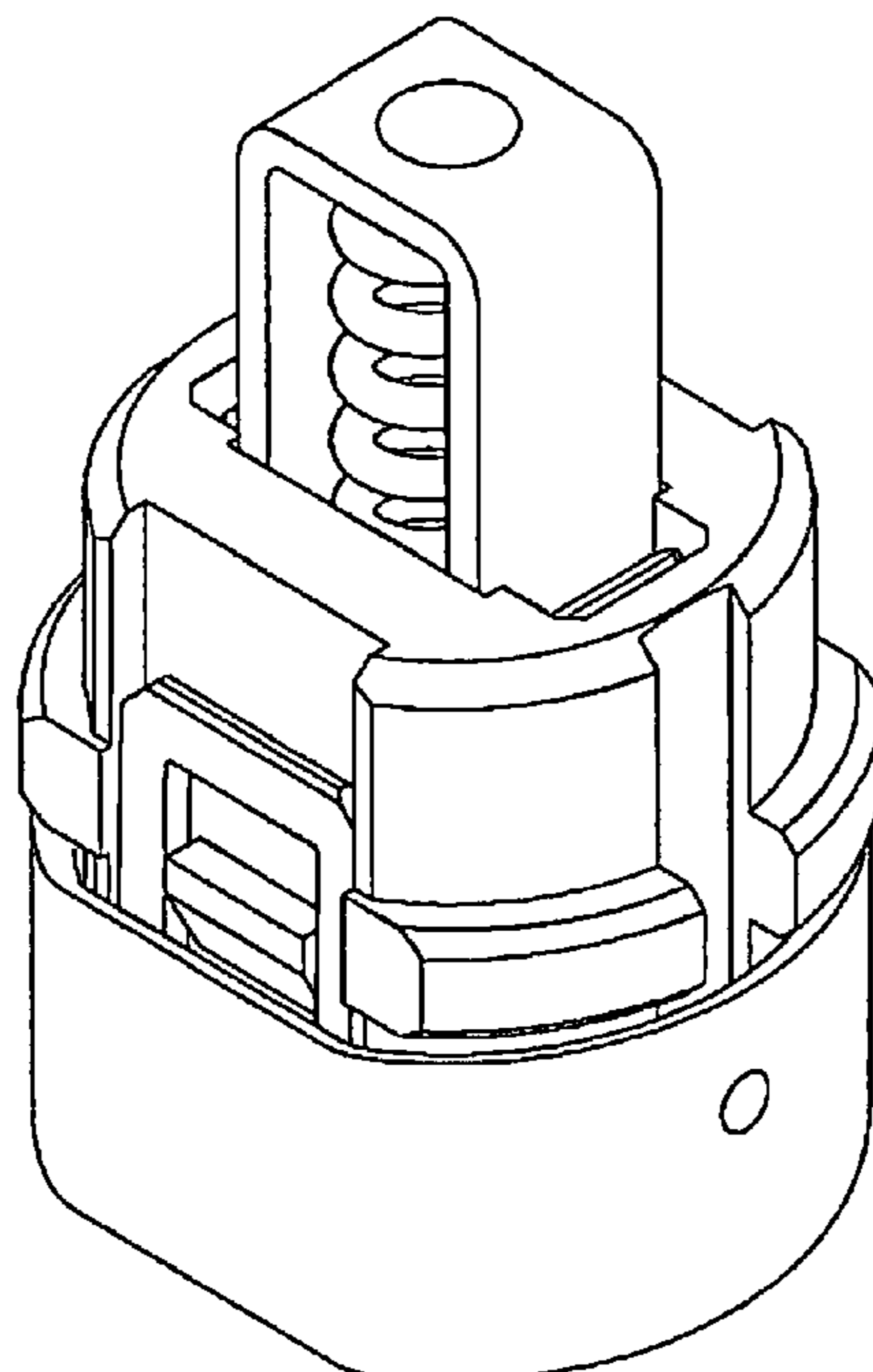

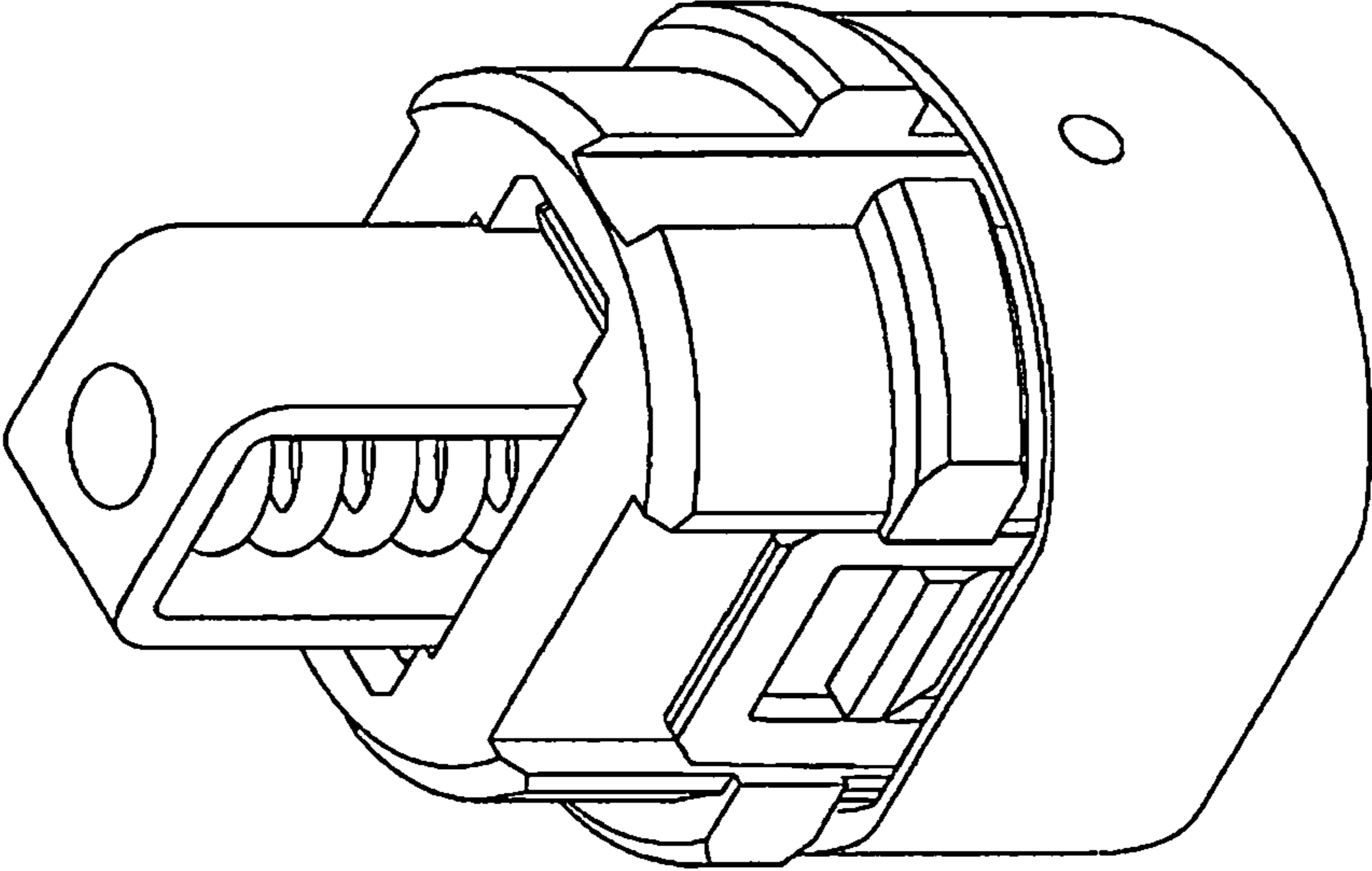

FIG. 1

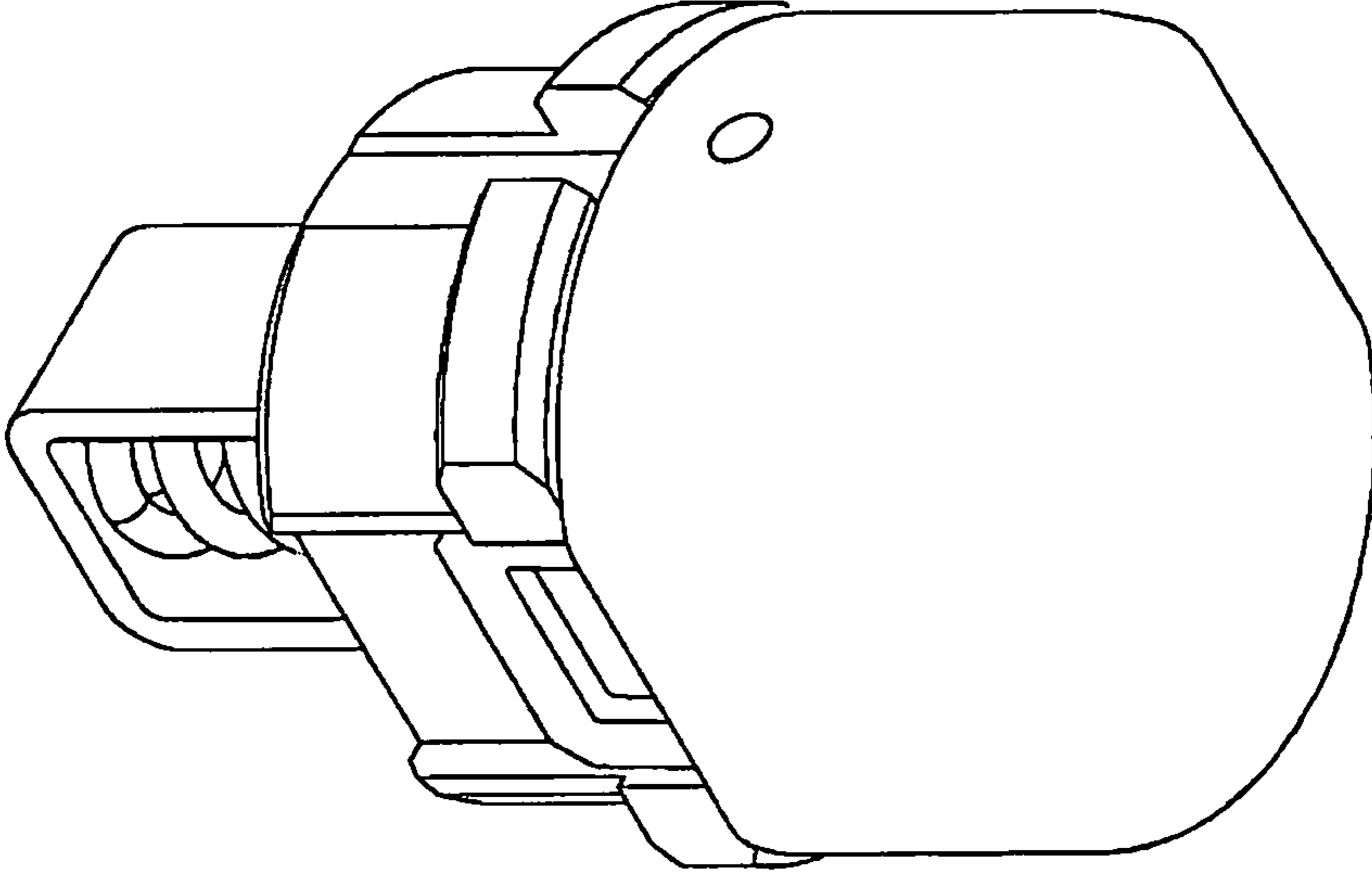

FIG. 2

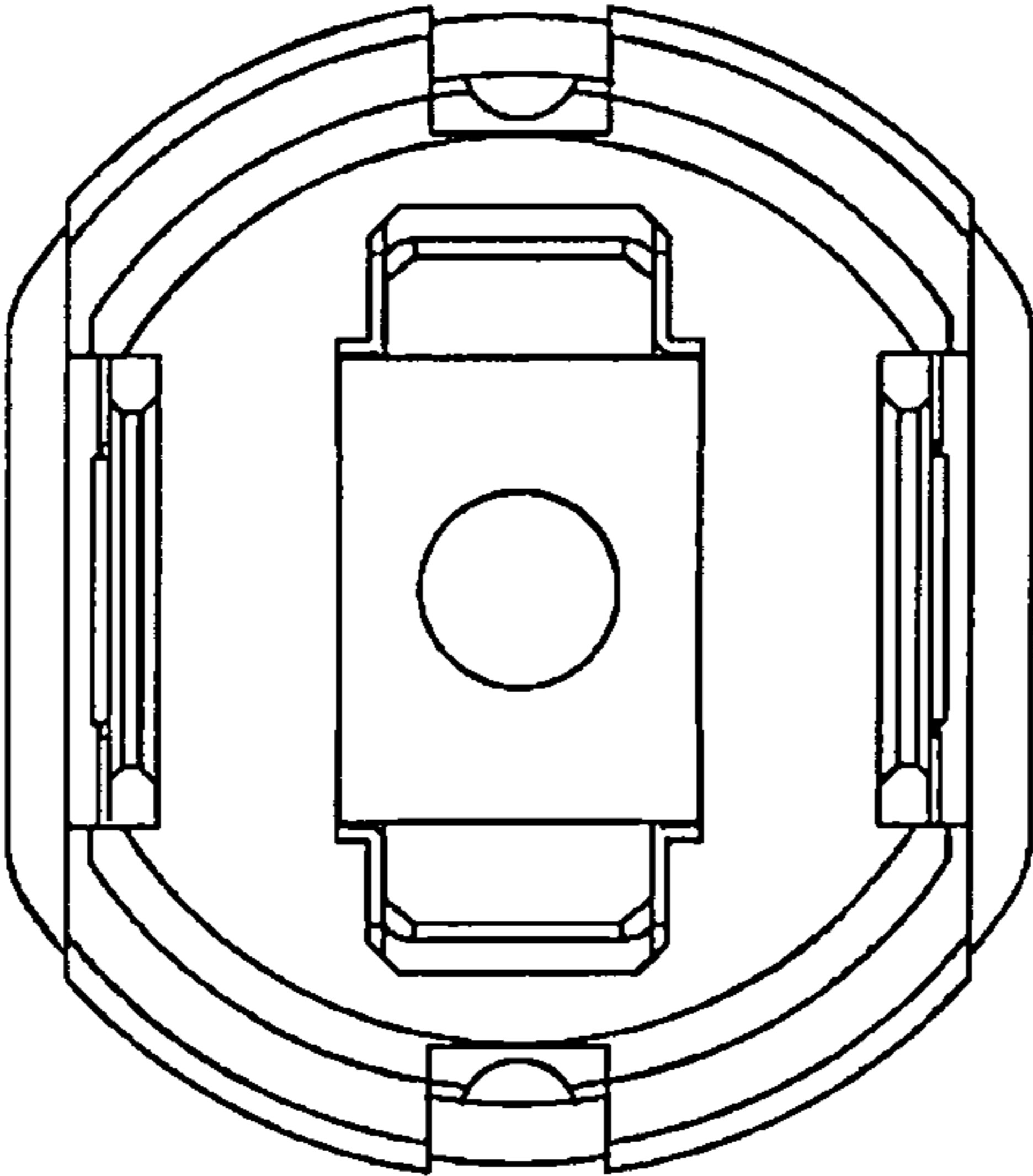

FIG. 3

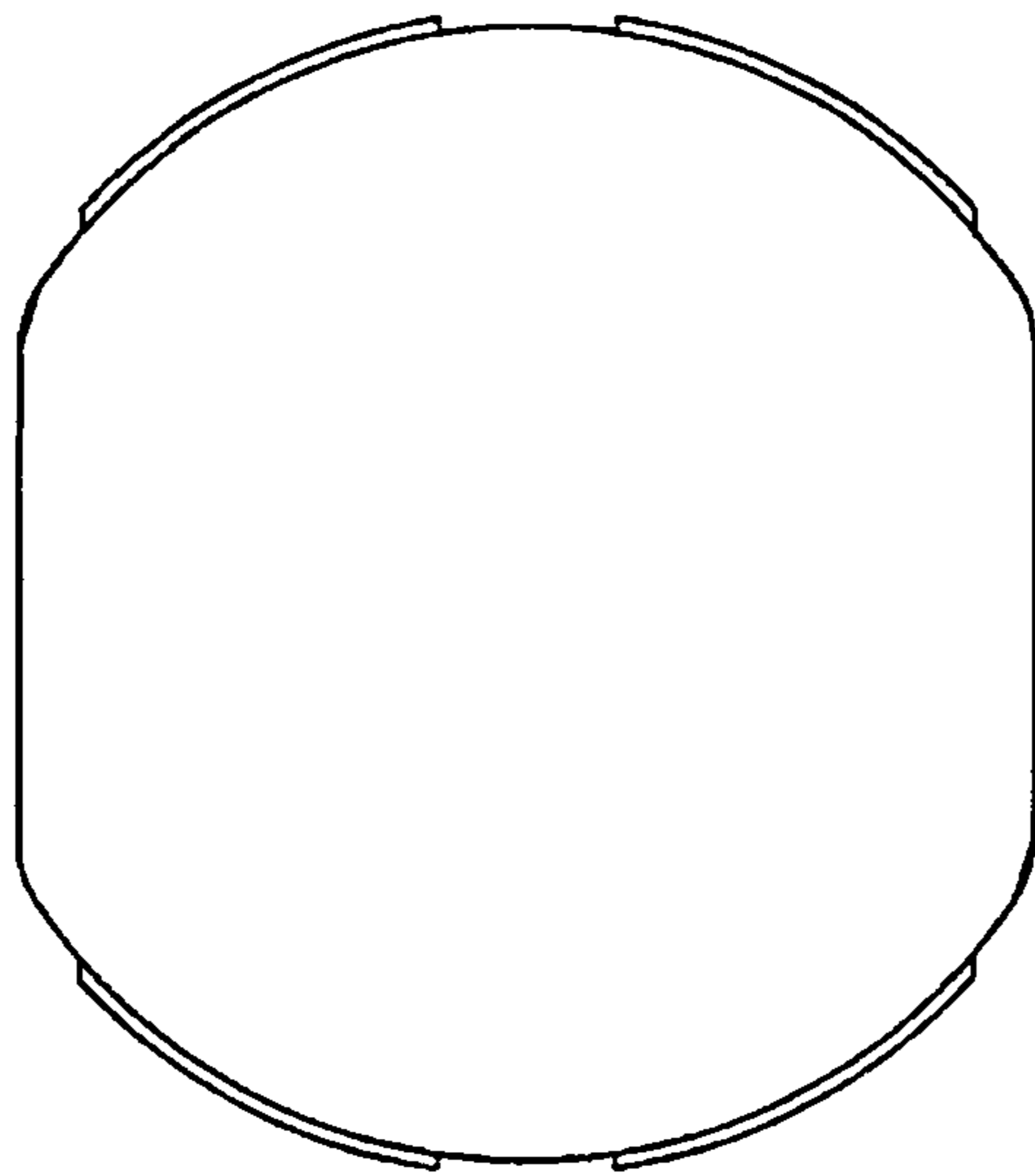

FIG. 4

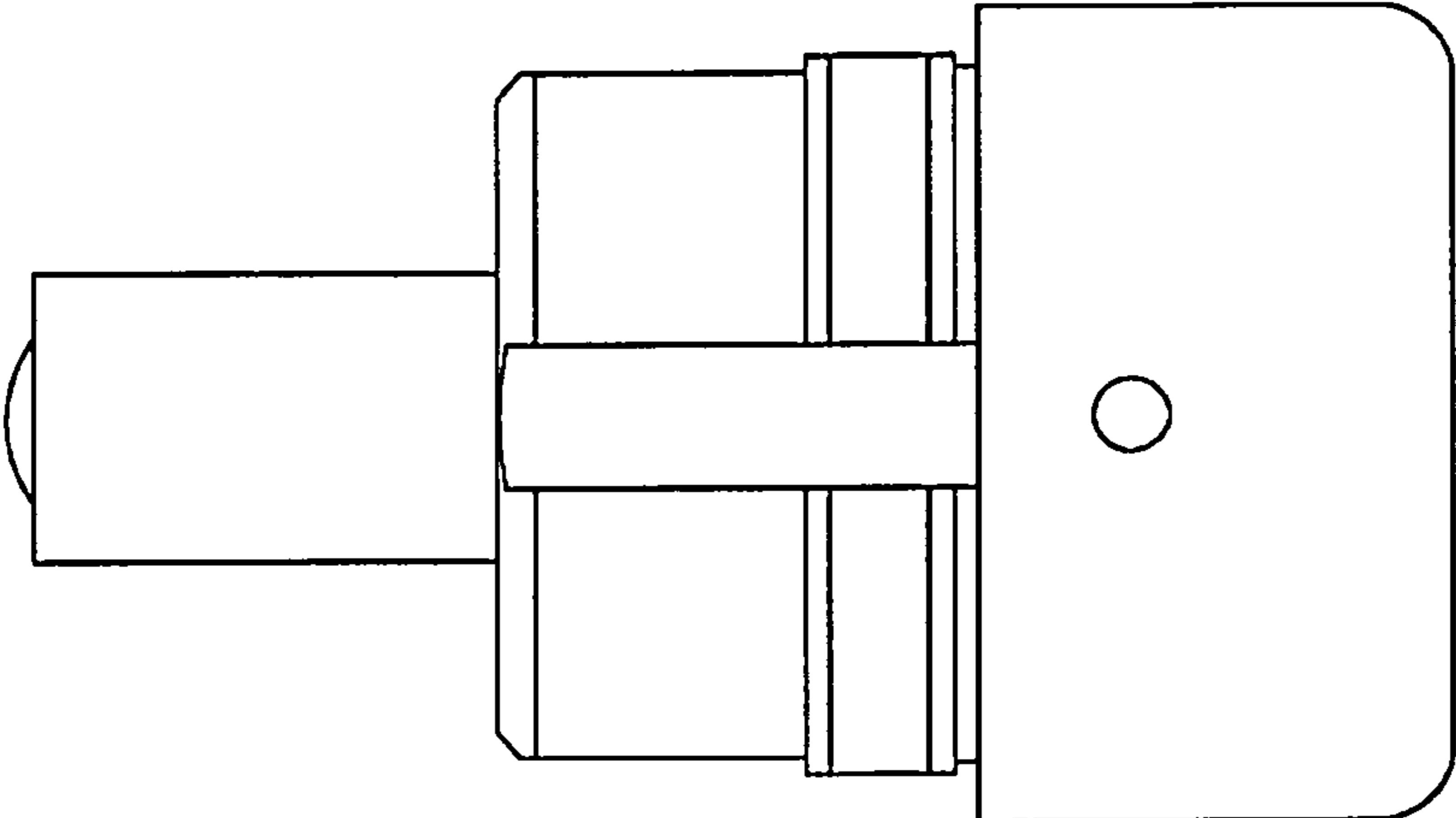

FIG. 5

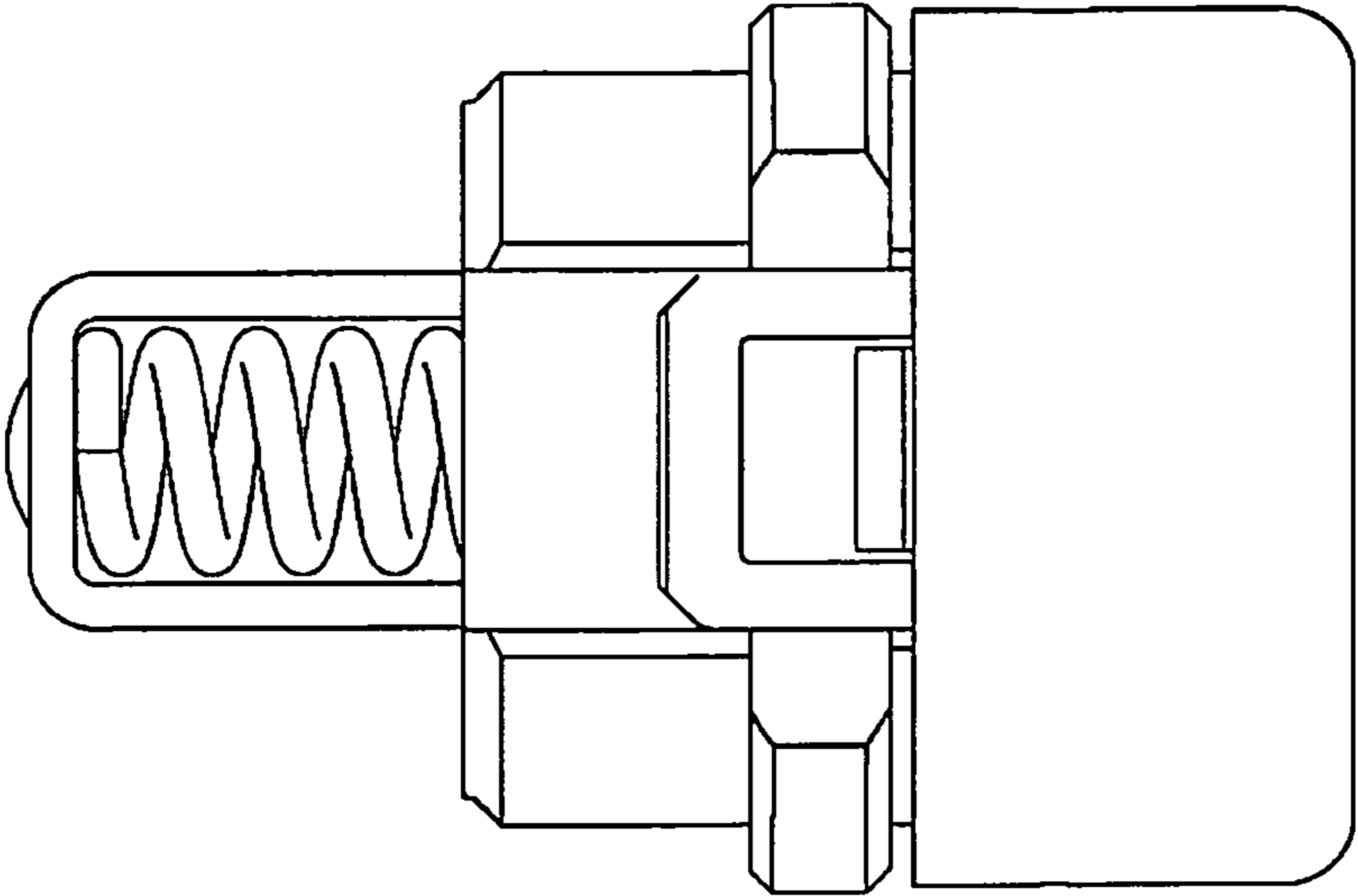

FIG. 6

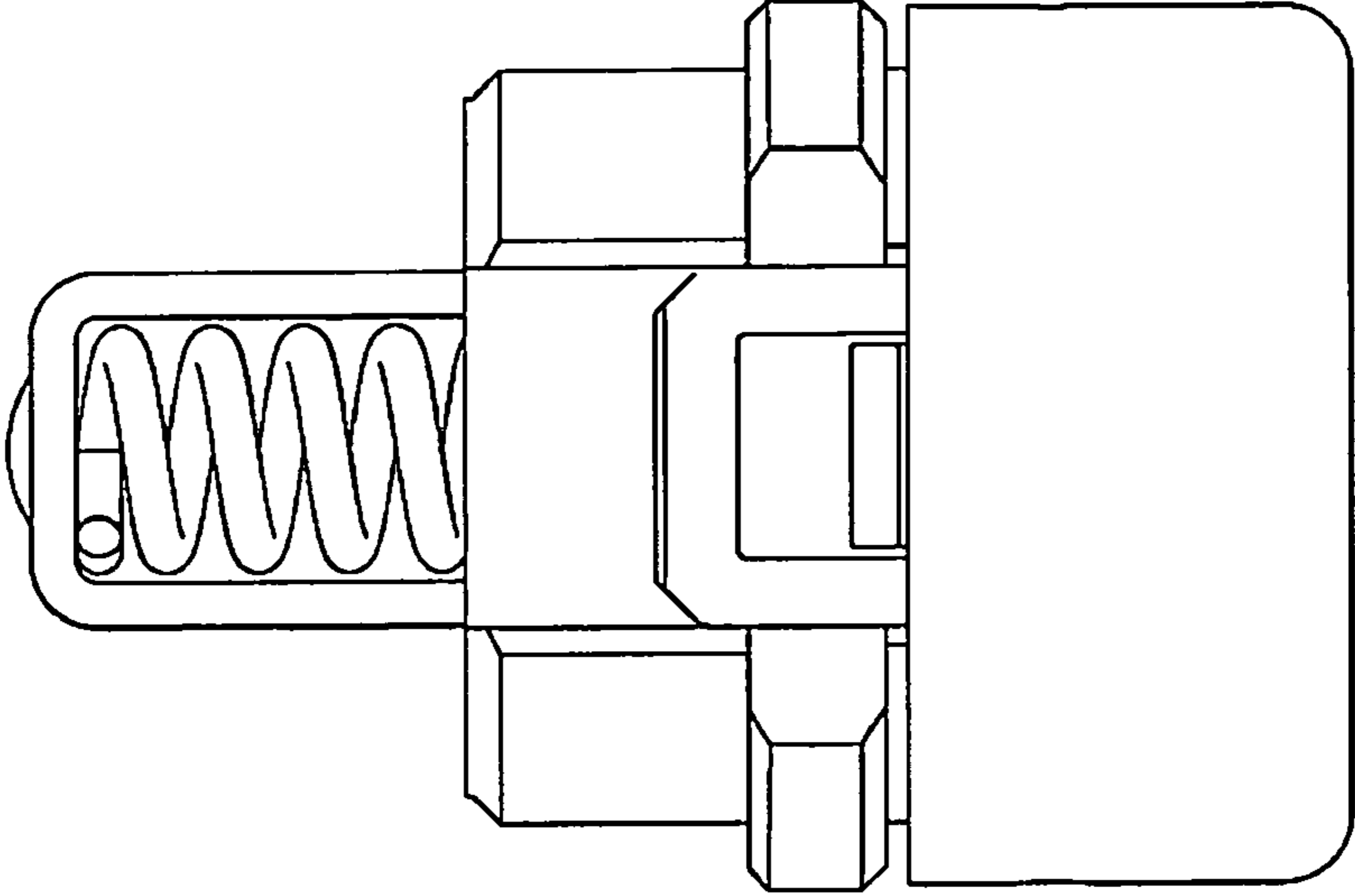

FIG. 7