



US00D691903S

(12) **United States Design Patent**
Tong et al.

(10) **Patent No.:** **US D691,903 S**

(45) **Date of Patent:** **** Oct. 22, 2013**

(54) **SHEET INSPECTION MACHINE**

(56) **References Cited**

(75) Inventors: **Yonggang Tong**, Tianjin (CN); **Yuxin Wang**, Tianjin (CN); **Tingting Sun**, Tianjin (CN)

U.S. PATENT DOCUMENTS

5,175,633 A * 12/1992 Saito et al. 358/406
2013/0148143 A1* 6/2013 Ooyanagi 358/1.12

(73) Assignee: **Masterwork Machinery Co., Ltd.**, Tianjin (CN)

* cited by examiner

(**) Term: **14 Years**

Primary Examiner — Antoine D Davis

(74) *Attorney, Agent, or Firm* — Michael D. Bednarek; Axinn Veltrop Harkrider LLP

(21) Appl. No.: **29/419,436**

(57) **CLAIM**

We claim the sheet inspection machine, as shown and described.

(22) Filed: **Apr. 27, 2012**

DESCRIPTION

(30) **Foreign Application Priority Data**

Feb. 13, 2012 (CN) 2012 3 0027057

FIG. 1 is a perspective view of the front, top, and right side of a sheet inspection machine;
FIG. 2 is a perspective view of the front, top, and left side of a sheet inspection machine;
FIG. 3 is a perspective view of the back, top, and right side of a sheet inspection machine;
FIG. 4 is a front view thereof;
FIG. 5 is a back view thereof;
FIG. 6 is a right view thereof;
FIG. 7 is a left view thereof;
FIG. 8 is a top view thereof; and,
FIG. 9 is a bottom view thereof.

(51) **LOC (9) Cl.** **04-04**

(52) **U.S. Cl.**
USPC **D10/46; D15/199**

(58) **Field of Classification Search**
USPC D10/46; D15/199; 358/1.12, 1.14, 1.5;
382/112

See application file for complete search history.

1 Claim, 9 Drawing Sheets

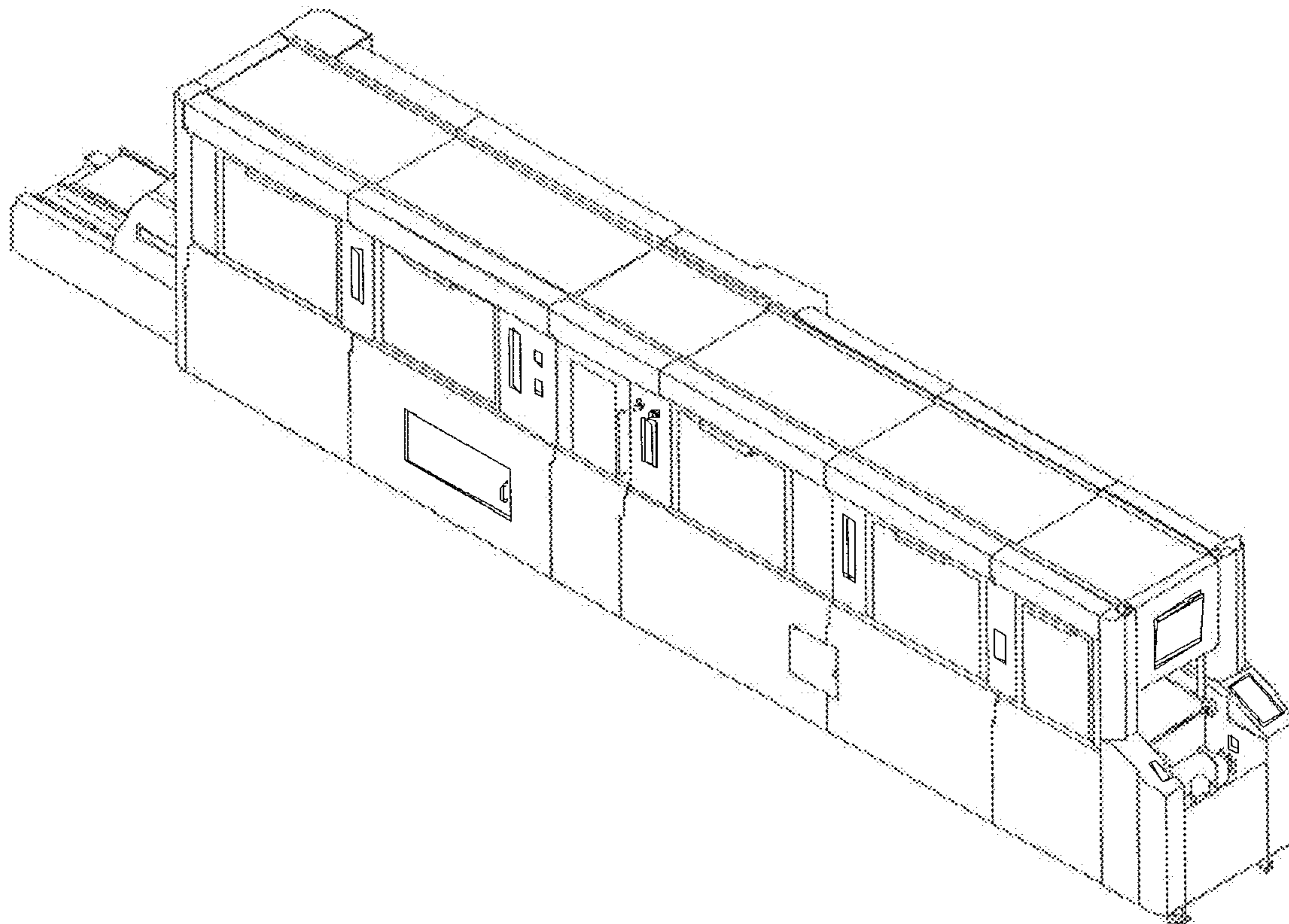

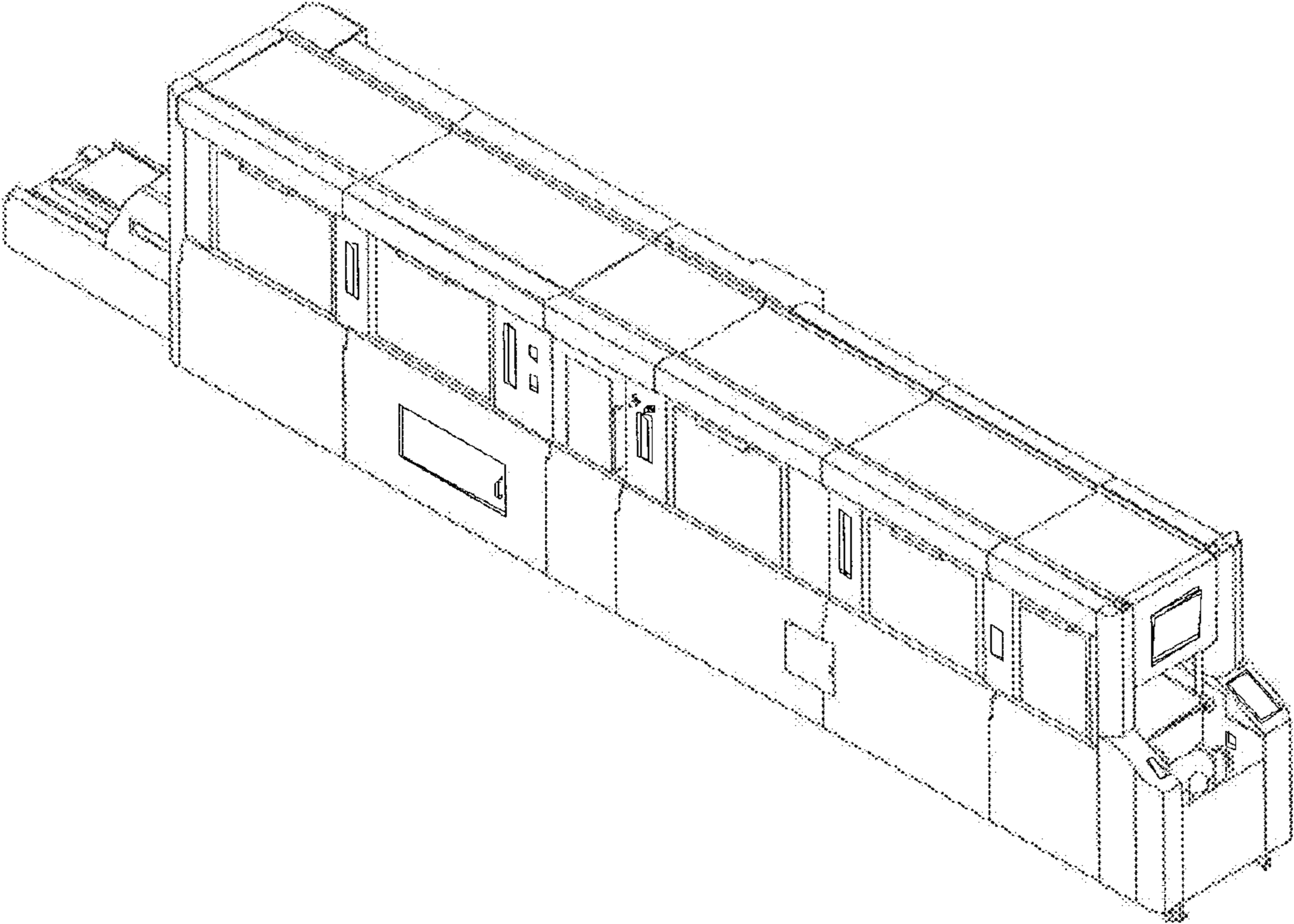

Fig. 1

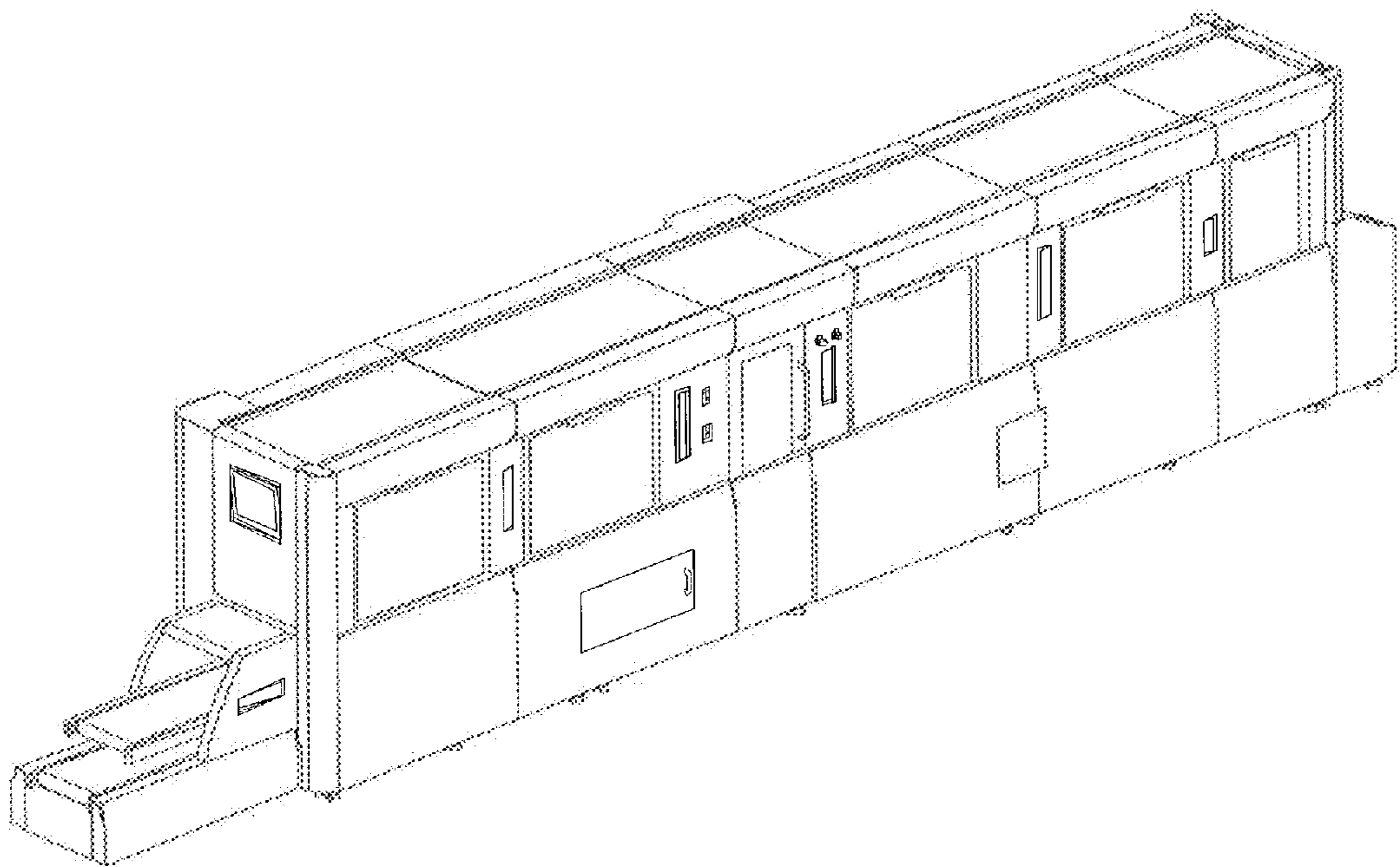

Fig. 2

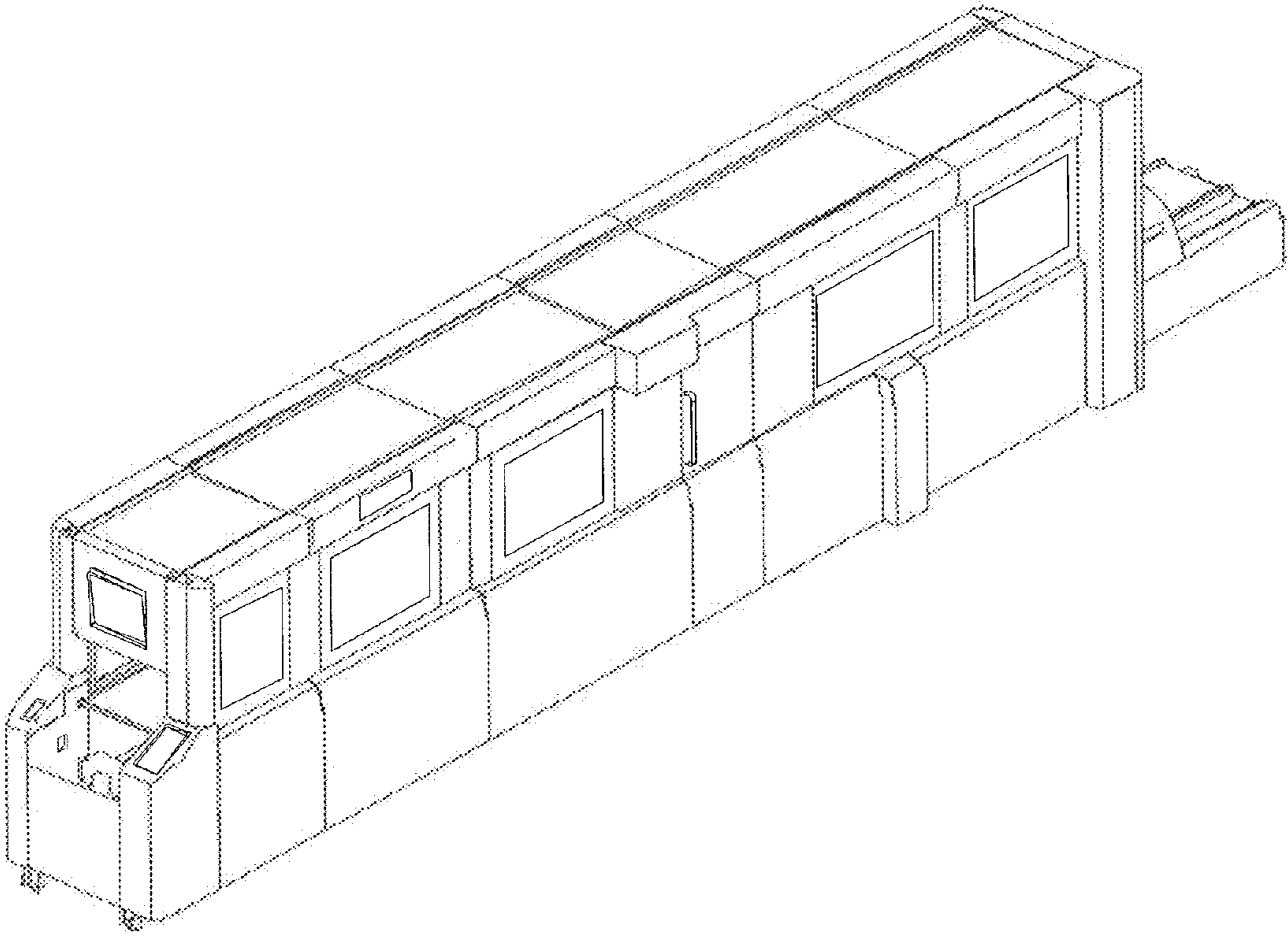

Fig. 3

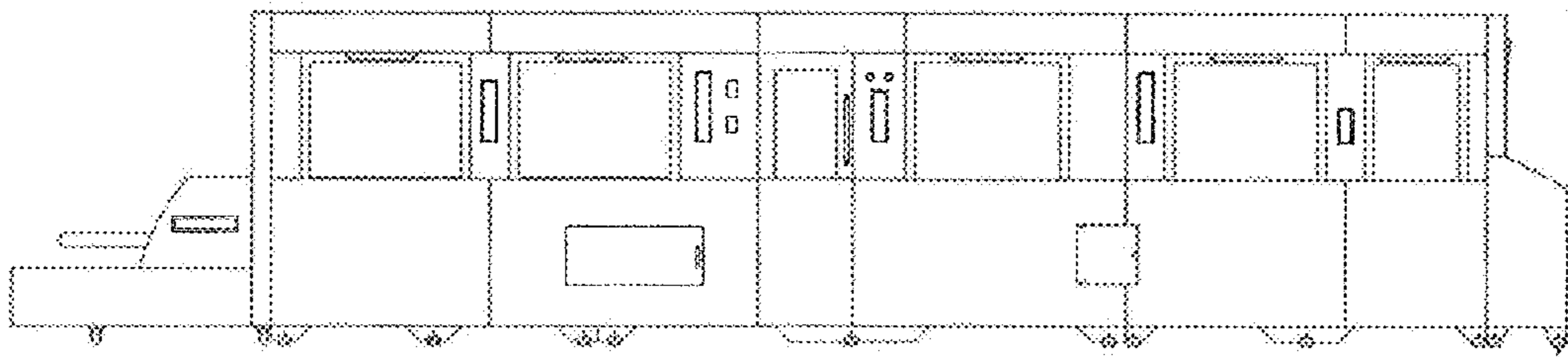

Fig. 4

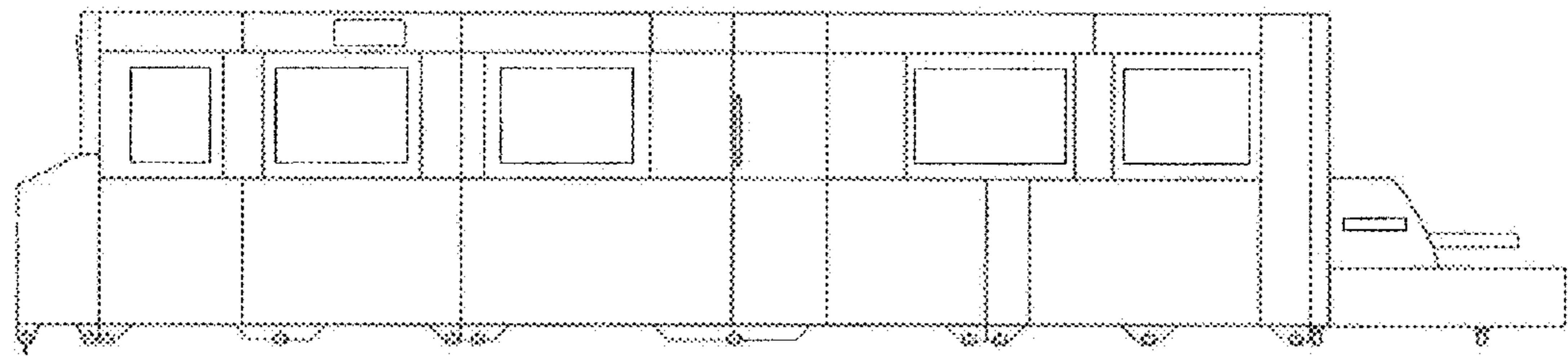

Fig. 5

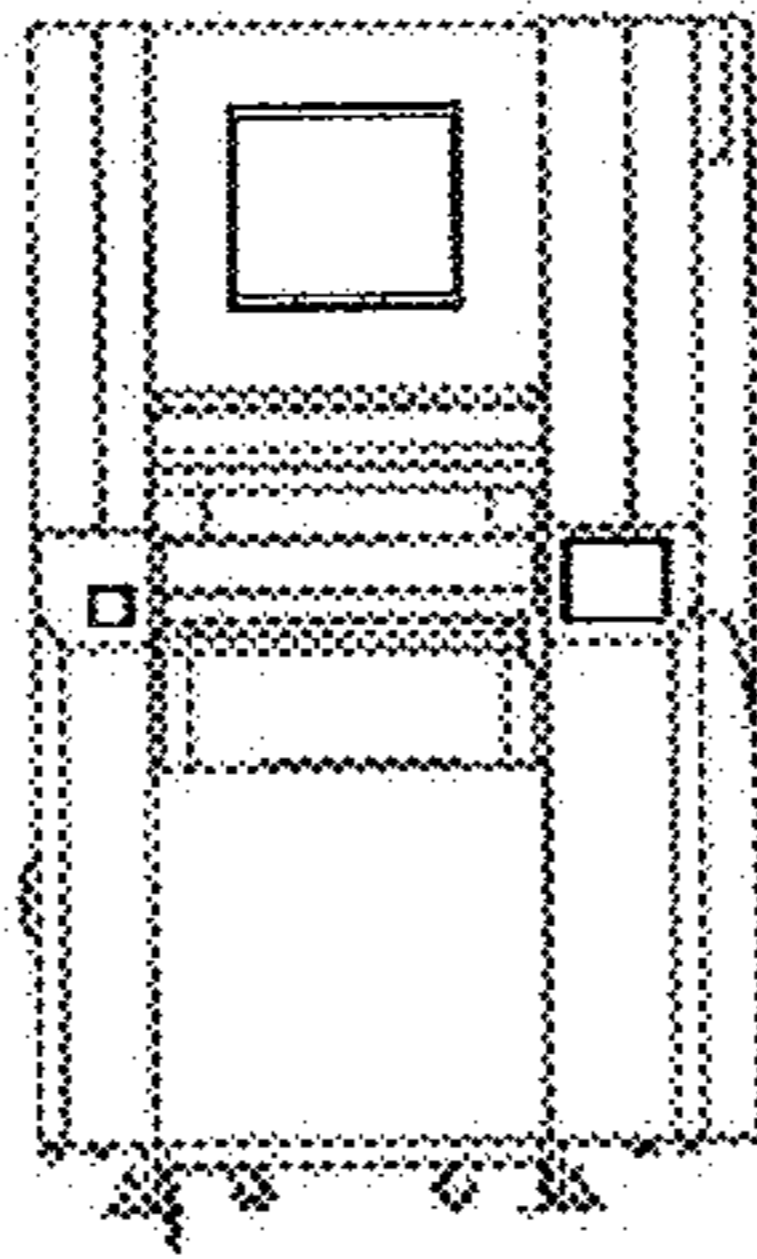

Fig. 6

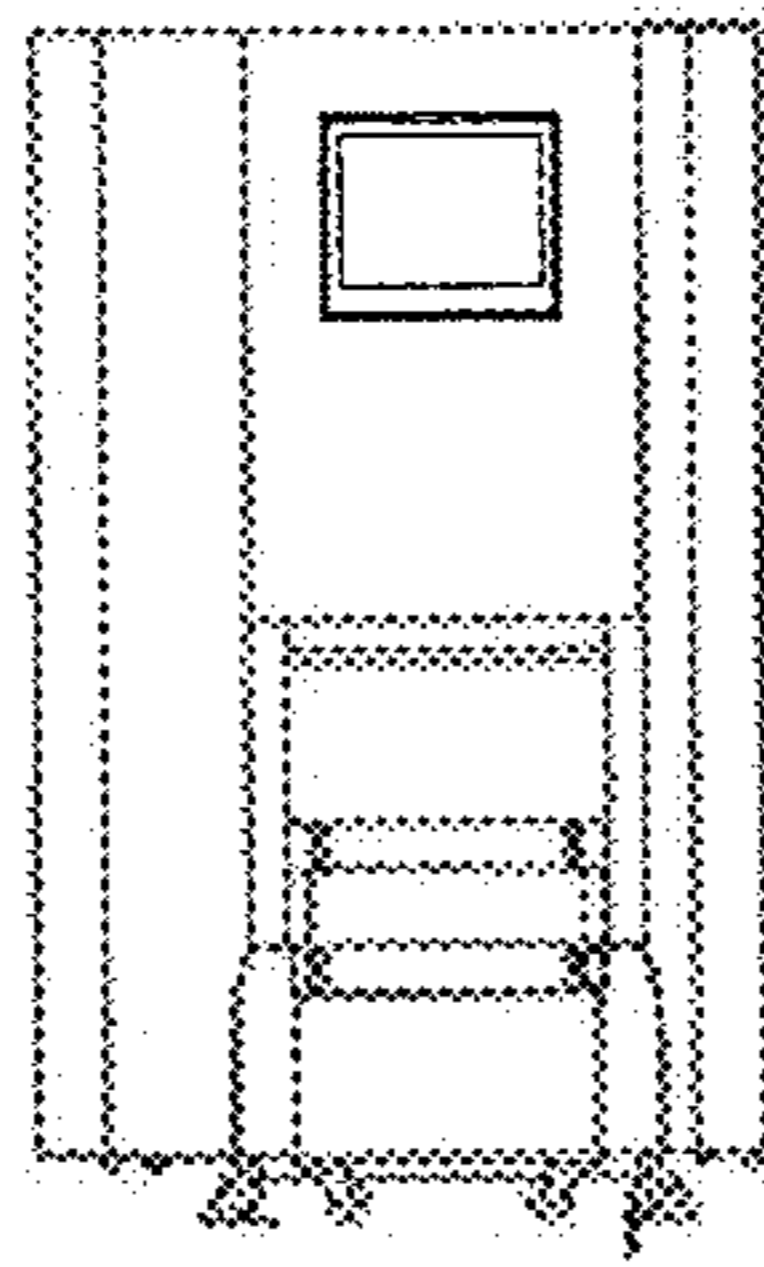

Fig. 7

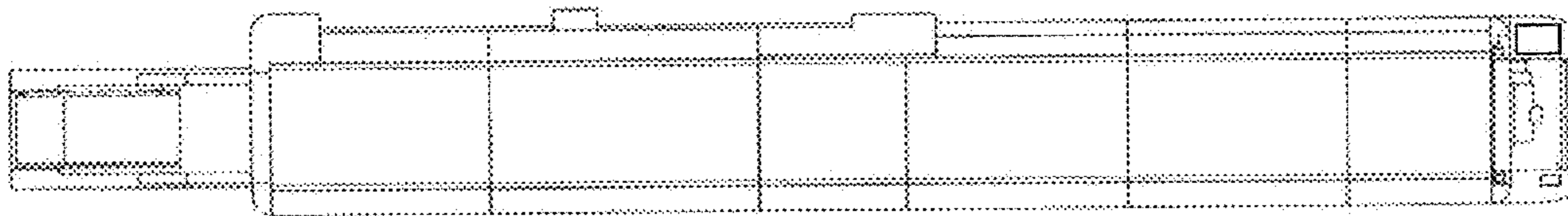

Fig. 8

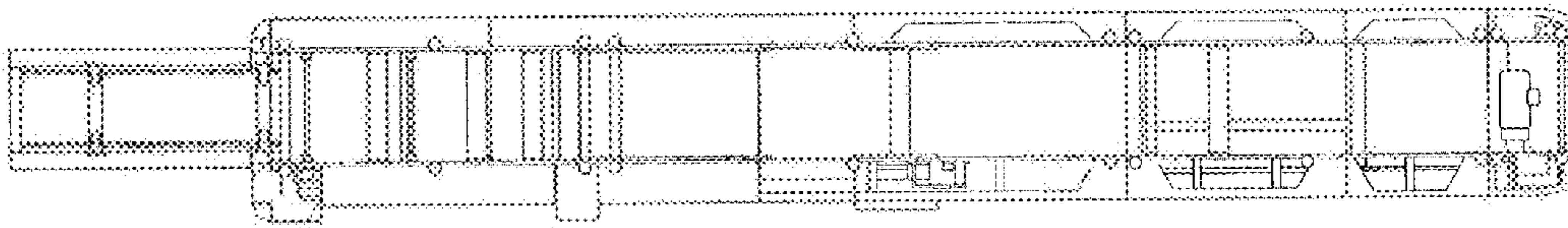

Fig. 9