



US00D691444S

(12) **United States Design Patent**  
**Tirone et al.**

(10) **Patent No.:** **US D691,444 S**

(45) **Date of Patent:** **\*\* Oct. 15, 2013**

(54) **IMPACT DRIVER**

(75) Inventors: **James C. Tirone**, Baltimore, MD (US);  
**David A. Miller**, Baltimore, MD (US);  
**John Burnie**, Baltimore, MD (US);  
**Robert B. Schoch**, Baltimore, MD (US);  
**Michael Walstrum**, Abingdon, MD (US)

(73) Assignee: **Black & Decker Inc.**, Newark, DE (US)

(\*\*) Term: **14 Years**

(21) Appl. No.: **29/427,510**

(22) Filed: **Jul. 19, 2012**

(51) **LOC (9) Cl.** ..... **08-03**

(52) **U.S. Cl.**  
USPC ..... **D8/68**

(58) **Field of Classification Search**  
USPC ..... D8/61, 67, 68; 81/57.11, 429, 469;  
173/13, 104, 178, 213, 216, 217;  
408/20, 124, 125, 234, 241 R  
See application file for complete search history.

(56) **References Cited**

**U.S. PATENT DOCUMENTS**

D519,808 S *	5/2006	Otsuka et al.	.....	D8/68
D520,834 S *	5/2006	Furuta et al.	.....	D8/68
D525,099 S *	7/2006	Nagasaka et al.	.....	D8/68
D606,376 S *	12/2009	Okuda et al.	.....	D8/68
7,896,097 B2 *	3/2011	Teng	.....	173/48

8,075,155 B2 *	12/2011	Watanabe et al.	.....	362/119
2005/0121209 A1 *	6/2005	Shimizu et al.	.....	173/217
2007/0056760 A1 *	3/2007	Yoshimizu et al.	.....	173/217
2009/0295313 A1 *	12/2009	Suzuki et al.	.....	318/139
2010/0031781 A1 *	2/2010	Ito et al.	.....	81/57.4
2011/0139479 A1 *	6/2011	Nagasaka et al.	.....	173/217
2012/0043102 A1 *	2/2012	Okuda	.....	173/217
2012/0061117 A1 *	3/2012	Nagasaka et al.	.....	173/217

\* cited by examiner

*Primary Examiner* — Philip S Hyder

*Assistant Examiner* — Darlington Ly

(74) *Attorney, Agent, or Firm* — Stephen R. Valancius

(57) **CLAIM**

The ornamental design for an impact driver, as shown and described.

**DESCRIPTION**

FIG. 1 is a perspective view of an impact driver showing our new design;

FIG. 2 is a front view thereof

FIG. 3 is a rear view thereof;

FIG. 4 is a right side view thereof;

FIG. 5 is a left side view thereof;

FIG. 6 is a top plan view thereof; and,

FIG. 7 is a bottom plan view thereof.

In the above drawings, the broken lines and the areas within the broken lines form no part of the claimed design.

The broken line(s) which define the bounds of the claimed design form no part thereof.

**1 Claim, 7 Drawing Sheets**

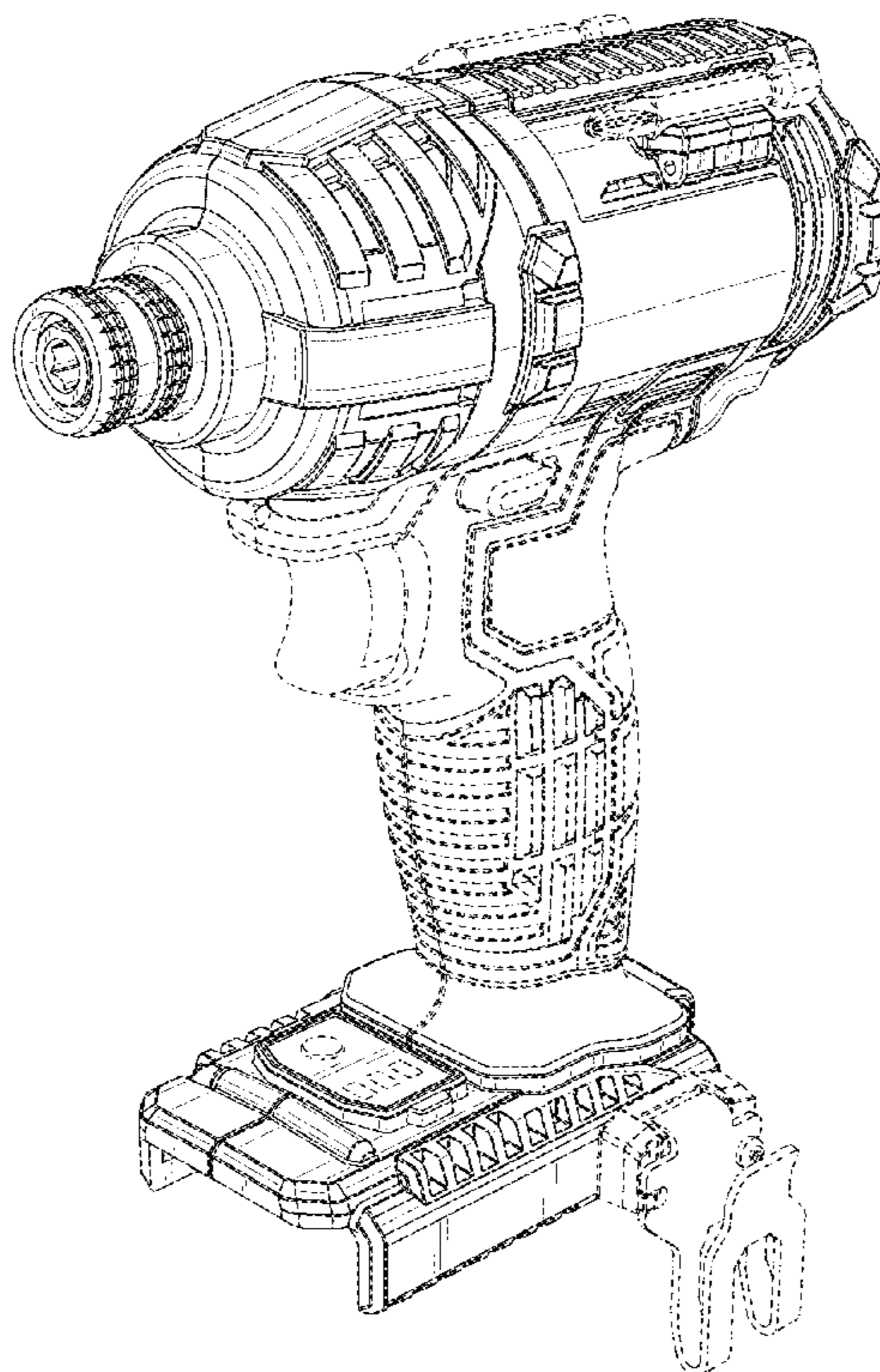

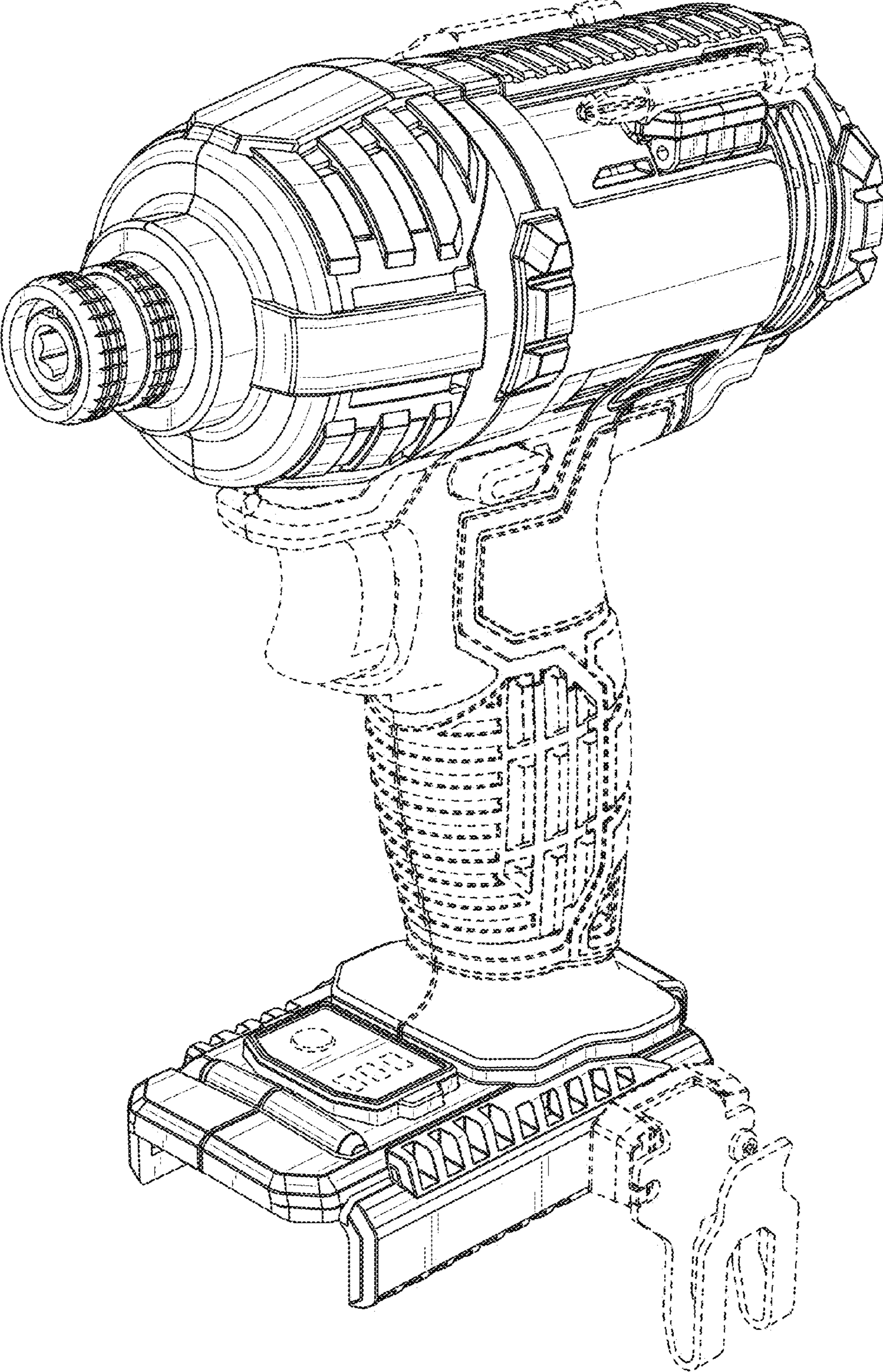

FIG. 1

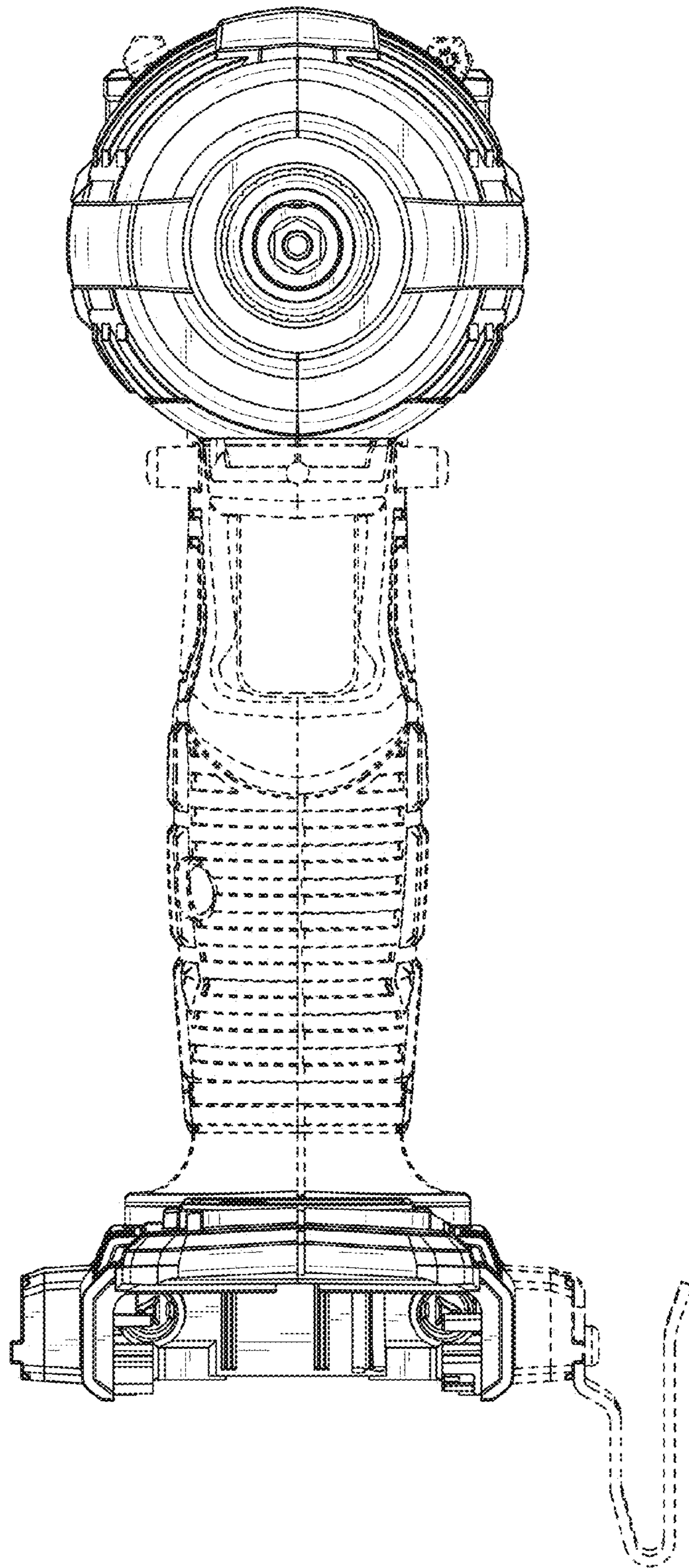

FIG. 2

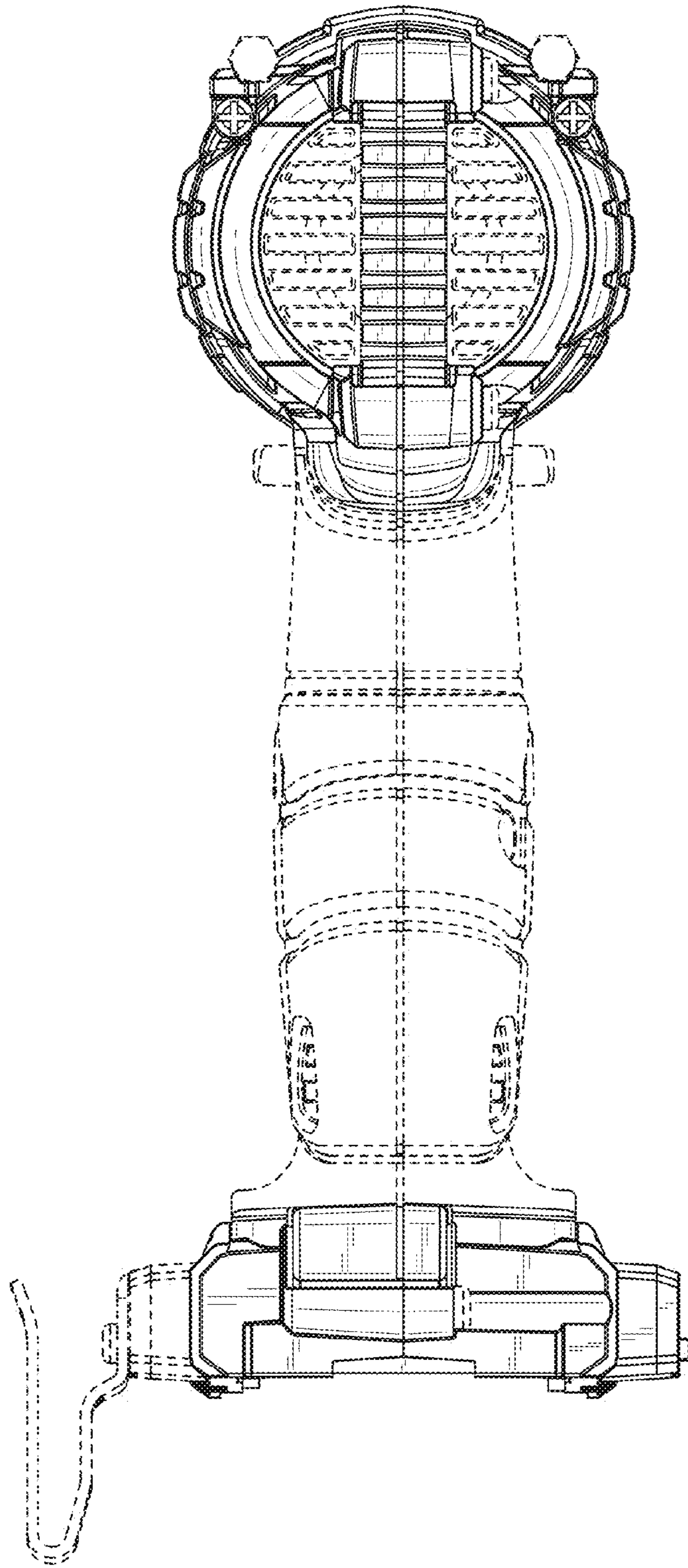

FIG. 3

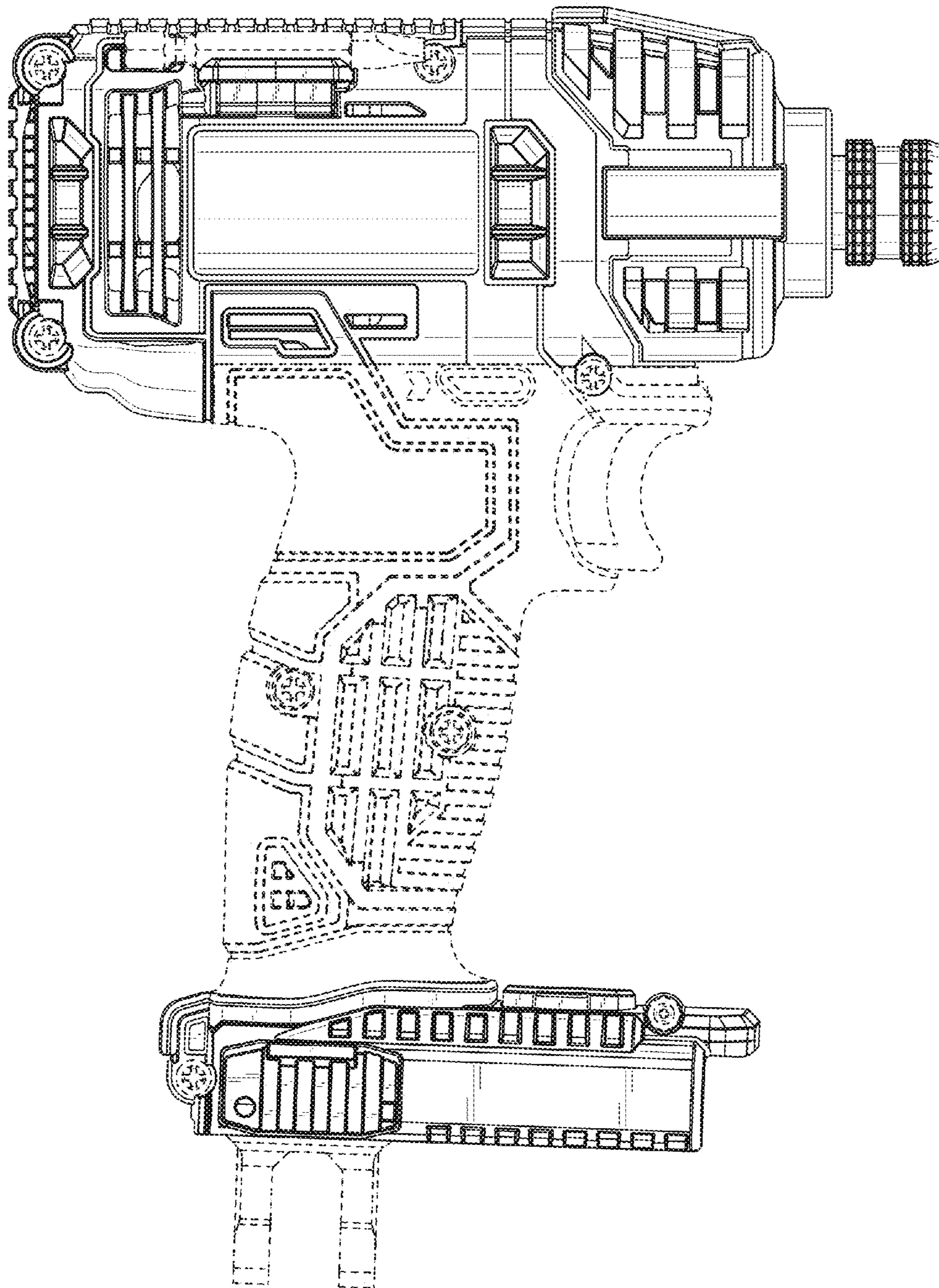

FIG. 4

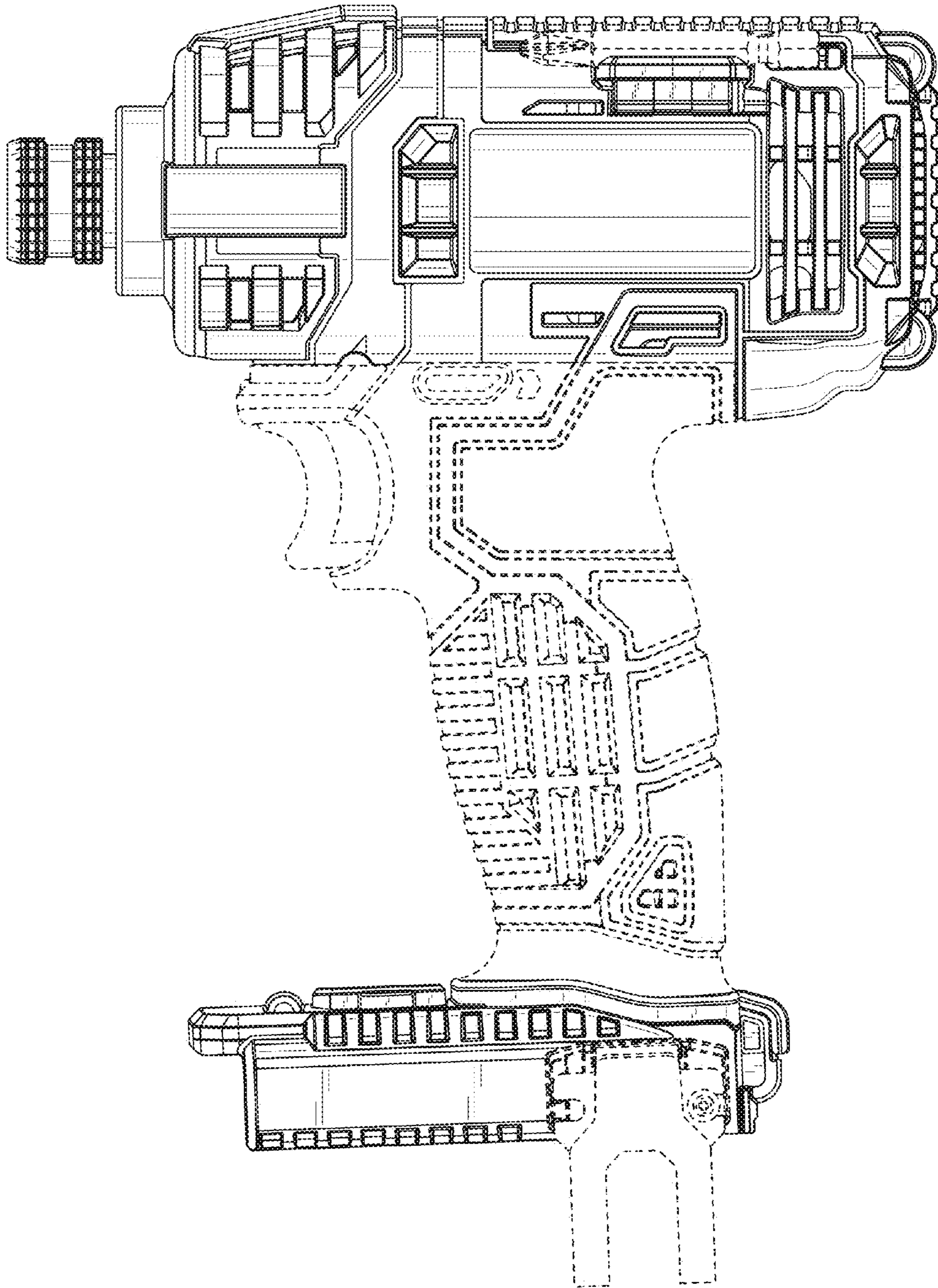

FIG. 5

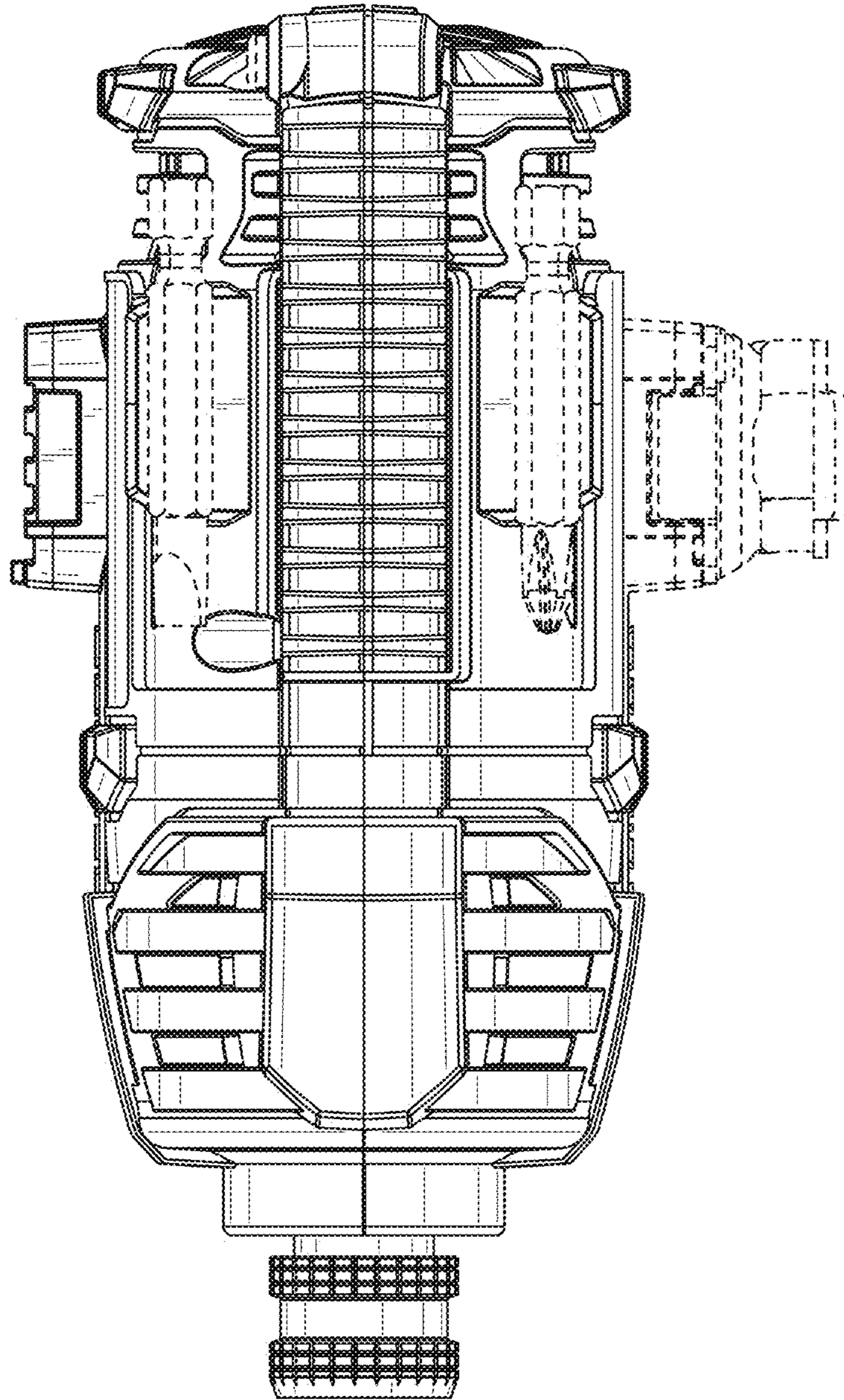

FIG. 6

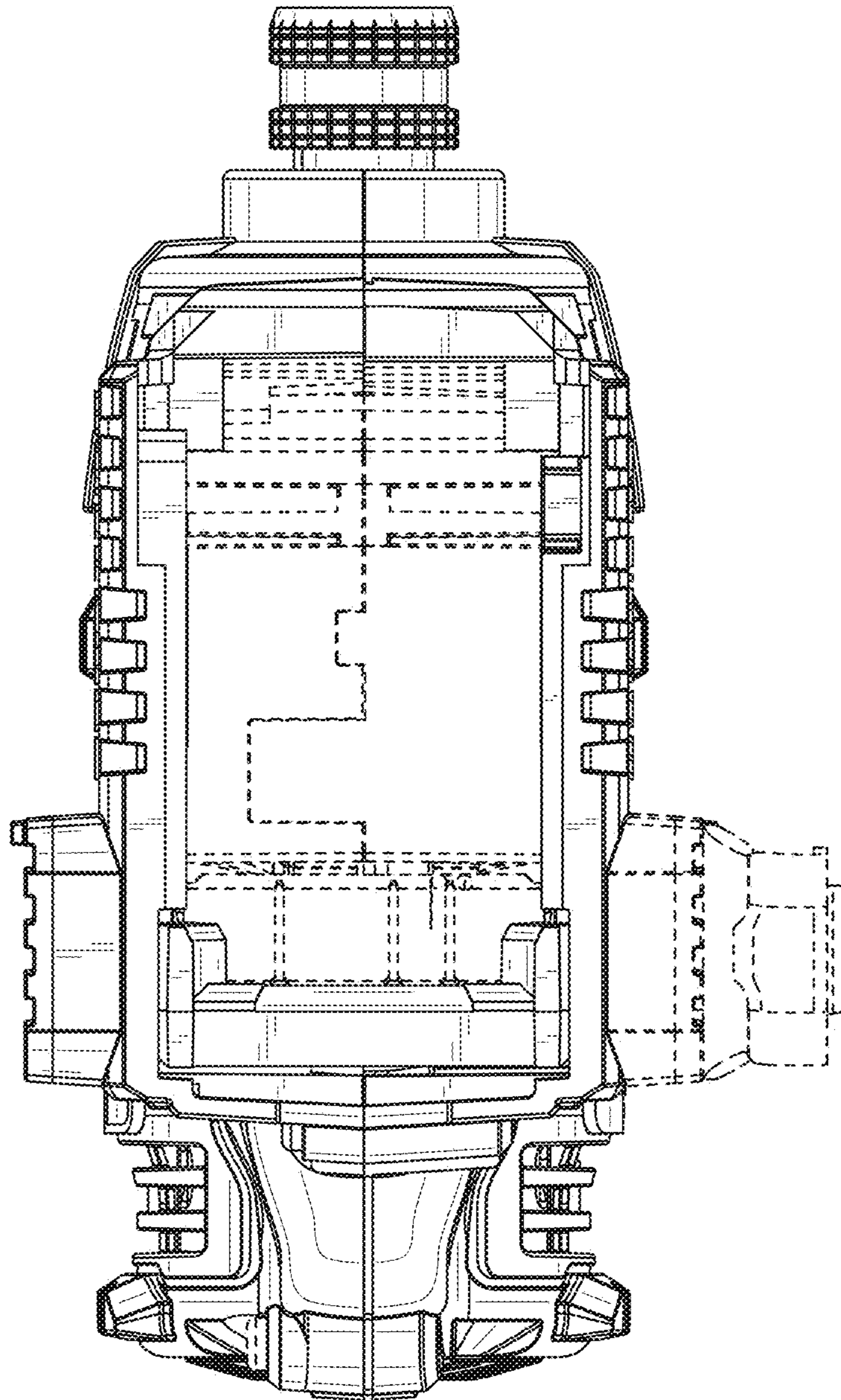

FIG. 7