



US00D689888S

(12) **United States Design Patent**
Meng et al.

(10) **Patent No.:** **US D689,888 S**

(45) **Date of Patent:** **** Sep. 17, 2013**

(54) **DISPLAY SCREEN OR PORTION THEREOF WITH A GRAPHICAL USER INTERFACE**

(75) Inventors: **Wayne Meng**, Fogelsville, PA (US);
Keith Fraser, Philadelphia, PA (US);
Robert Tannen, Philadelphia, PA (US);
Glenn Allen Straub, Douglassville, PA (US)

(73) Assignee: **PMD Healthcare**, Allentown, PA (US)

(**) Term: **14 Years**

(21) Appl. No.: **29/405,573**

(22) Filed: **Nov. 3, 2011**

Related U.S. Application Data

(63) Continuation-in-part of application No. 12/844,980, filed on Jul. 28, 2010.

(51) **LOC (9) Cl.** **14-04**

(52) **U.S. Cl.**
USPC **D14/486**

(58) **Field of Classification Search**
USPC D14/485-495; 715/700-867, 961-978
See application file for complete search history.

(56) **References Cited**

U.S. PATENT DOCUMENTS

D574,396 S * 8/2008 Tomizawa et al. D14/487
D577,736 S * 9/2008 Ryu et al. D14/486
D579,459 S * 10/2008 Tomizawa et al. D14/487

D583,386 S * 12/2008 Tomizawa et al. D14/487
D595,306 S * 6/2009 Um et al. D14/486
D614,634 S * 4/2010 Nilsen D14/486
D639,822 S * 6/2011 Jones et al. D14/486
2012/0029376 A1* 2/2012 Meng et al. 600/538

* cited by examiner

Primary Examiner — Barbara Fox

(74) *Attorney, Agent, or Firm* — Saul Ewing LLP

(57) **CLAIM**

The ornamental design for a display screen or portion thereof with a graphical user interface, as shown and described.

DESCRIPTION

The patent or application file contains at least one drawing executed in color. Copies of this patent or patent application publication with color drawing(s) will be provided by the Office upon request and payment of the necessary fee.

FIG. 1 is a front view of a first embodiment of a display screen or portion thereof with a graphical user interface showing our new design.

FIG. 2 is a front view of a second embodiment thereof.

FIG. 3 is a front view of a third embodiment thereof.

FIG. 4 is a front view of a fourth embodiment thereof.

FIG. 5 is a front view of a fifth embodiment thereof; and,

FIG. 6 is a front view of a sixth embodiment thereof.

The perimeters of the underlying display screen or portion thereof and the graphical user interface are understood to be flush. The broken line showing of text forms no part of the claimed design.

1 Claim, 6 Drawing Sheets
(6 of 6 Drawing Sheet(s) Filed in Color)

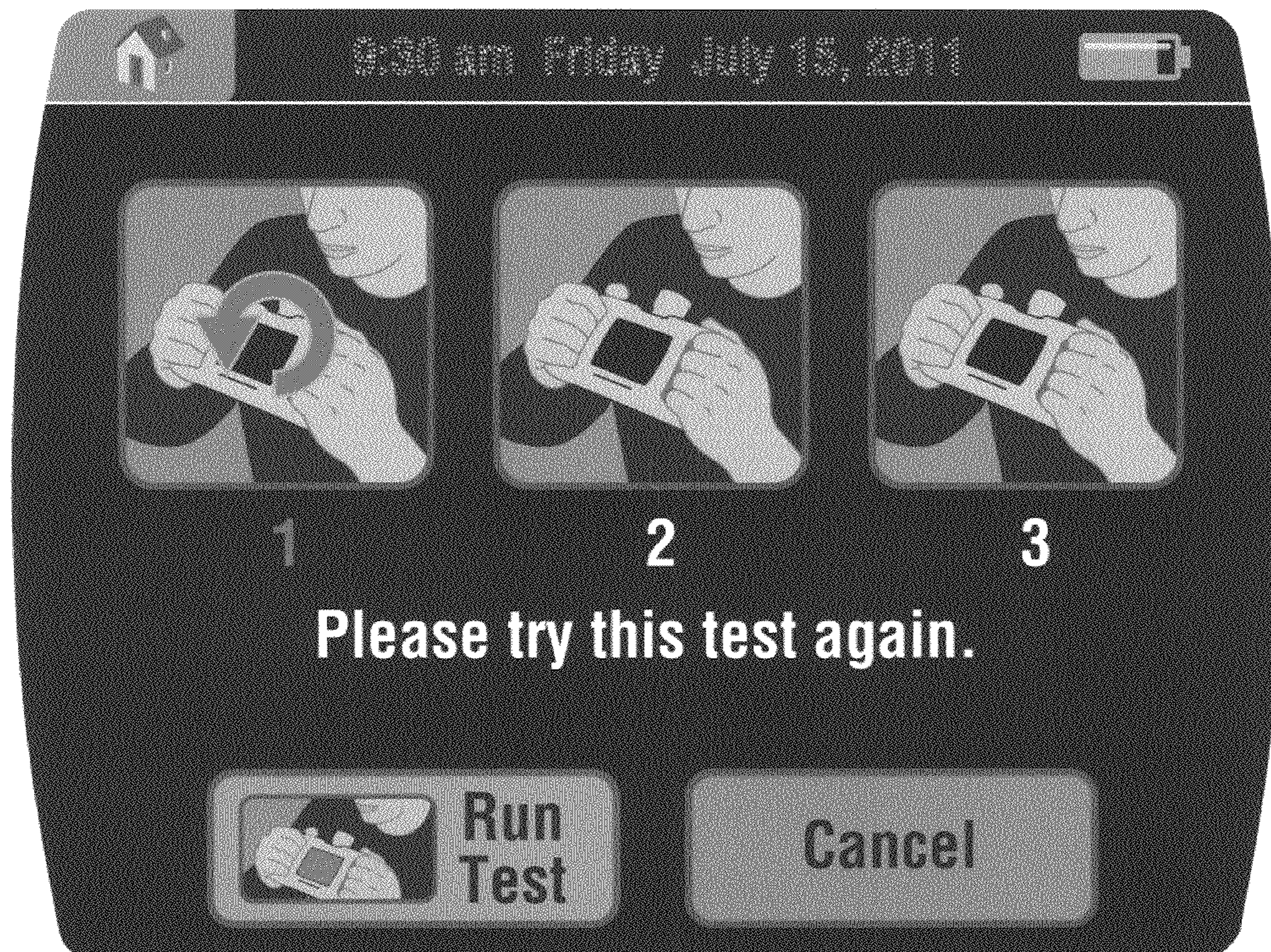



FIGURE 1

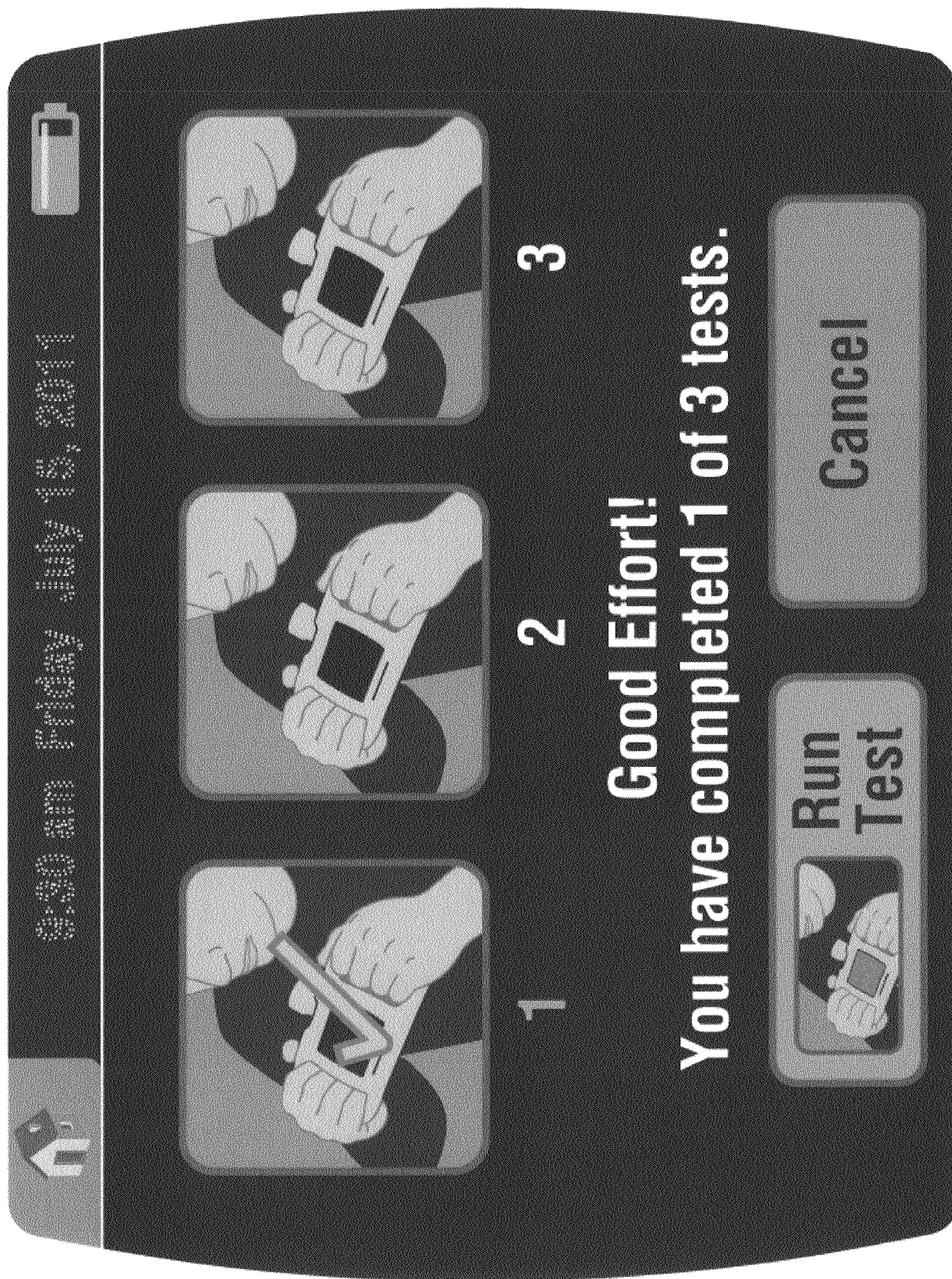

FIGURE 2

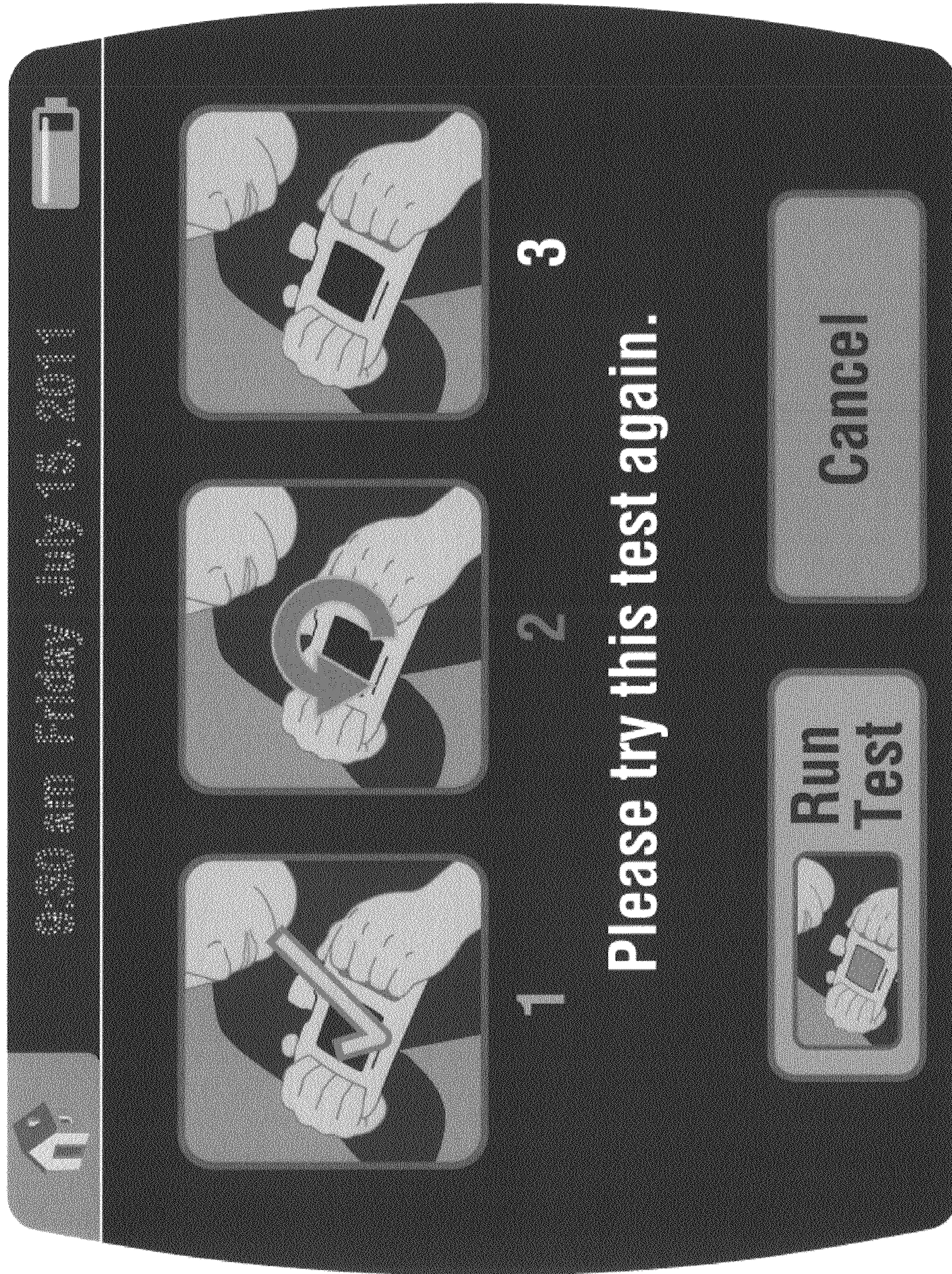

FIGURE 3

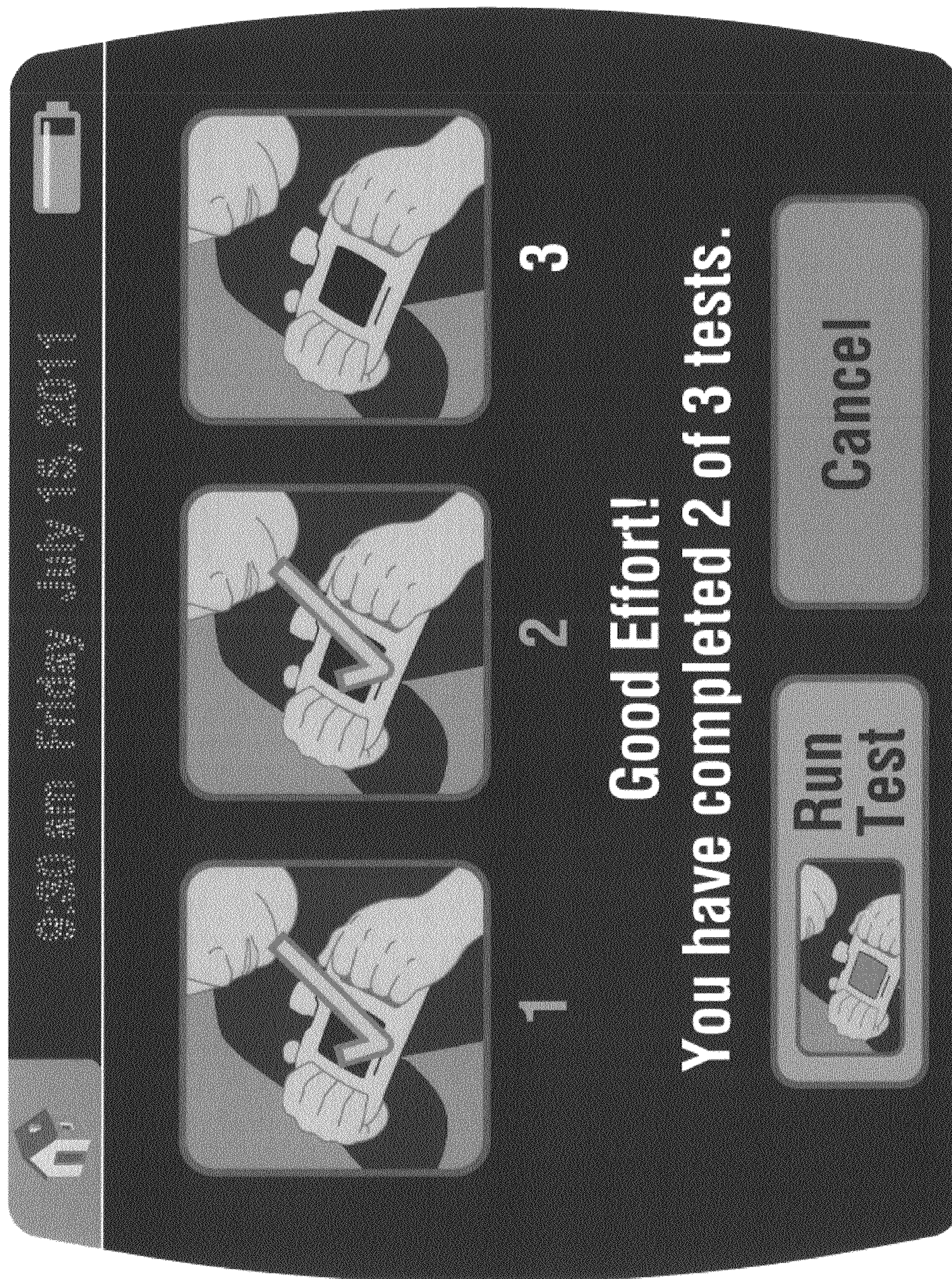

FIGURE 4

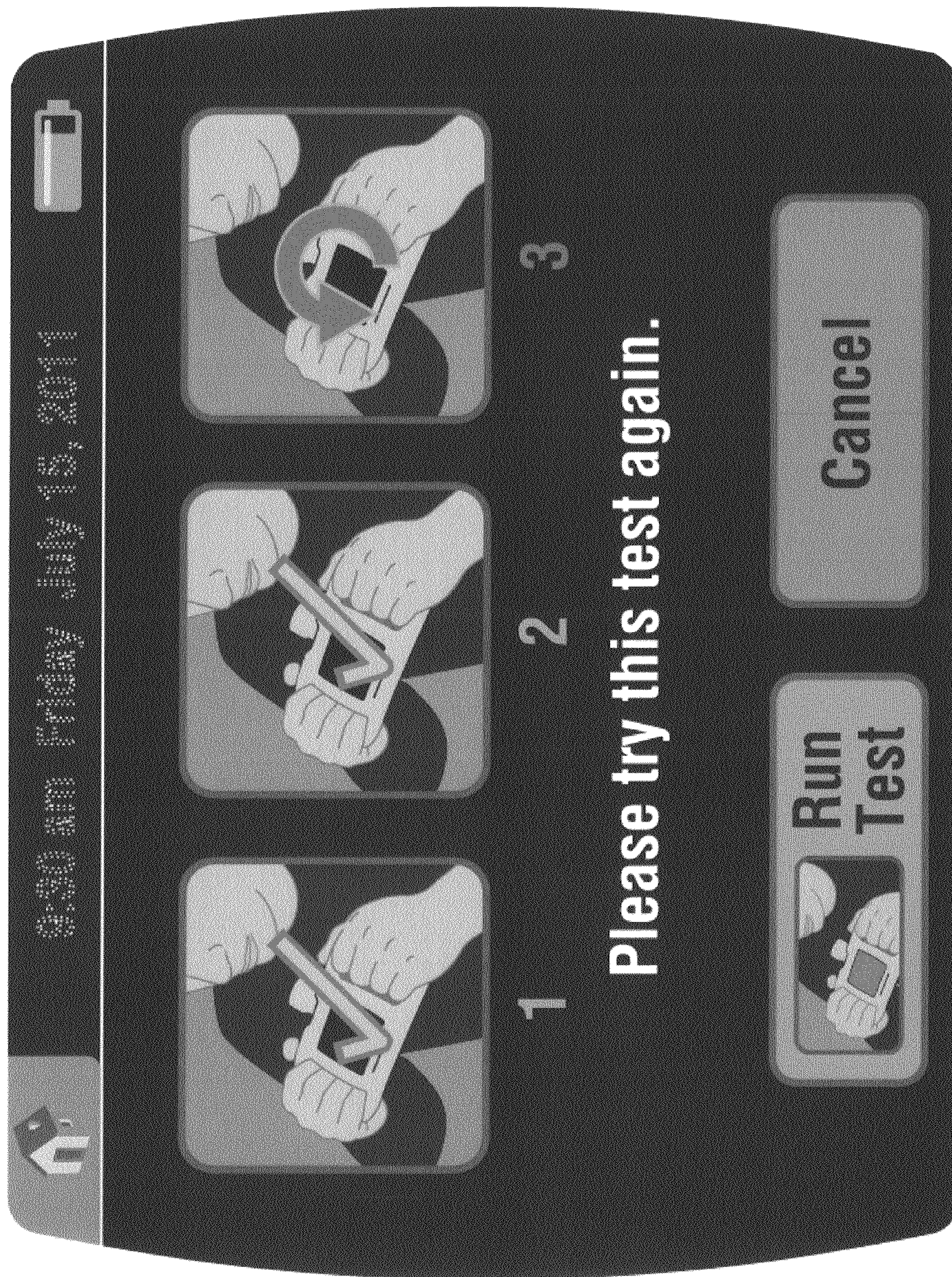

FIGURE 5

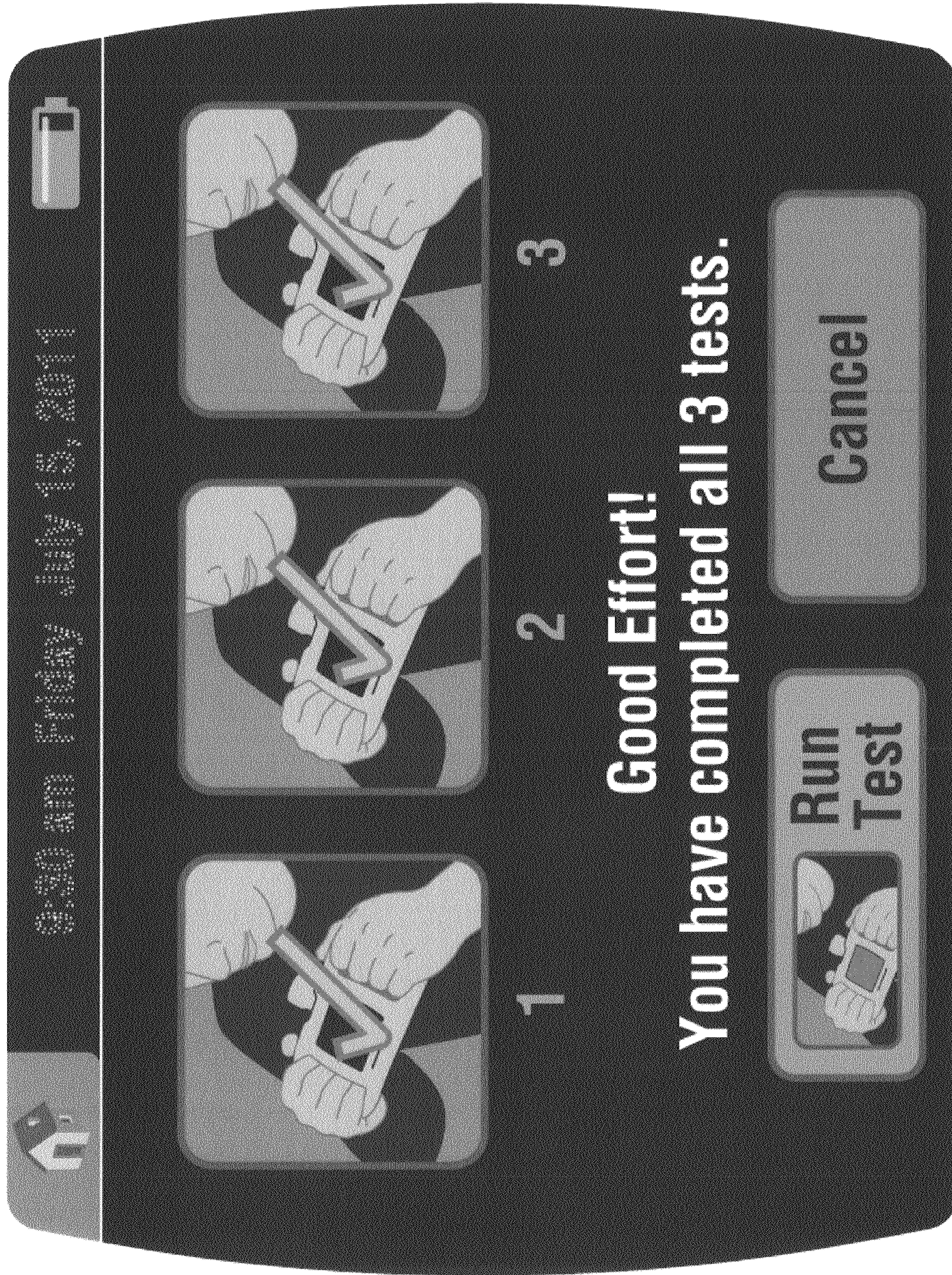

FIGURE 6