



US00D689624S

(12) **United States Design Patent**
Pacitto

(10) **Patent No.:** **US D689,624 S**

(45) **Date of Patent:** **** Sep. 10, 2013**

(54) **PAVER**

(75) Inventor: **Jeffrey Pacitto**, Richmond Hill (CA)

(73) Assignee: **Best Way Stone Limited**, Ontario (CA)

(**) Term: **14 Years**

(21) Appl. No.: **29/385,552**

(22) Filed: **Feb. 16, 2011**

(30) **Foreign Application Priority Data**

Jan. 24, 2011 (CA) 138842

(51) **LOC (9) Cl.** **25-01**

(52) **U.S. Cl.**

USPC **D25/113**

(58) **Field of Classification Search**

USPC D25/102–118, 136, 138, 140, 151,
D25/152, 153, 156–162, 164; D21/484–491,
D21/499–504; 405/16, 284, 286; 52/503–505,
52/574, 575, 596–612; 404/27–42

See application file for complete search history.

(56) **References Cited**

U.S. PATENT DOCUMENTS

2,397,119	A *	3/1946	Bohn	D25/113
3,222,840	A *	12/1965	Rosenfeld	D25/113
5,496,129	A *	3/1996	Dube	404/29
D389,926	S *	1/1998	Barth et al.	D25/113
D393,727	S *	4/1998	Wiegand, Jr.	D25/113
D425,628	S *	5/2000	Barth et al.	D25/113
6,055,784	A *	5/2000	Geiger	52/603
D498,543	S *	11/2004	Schmitz et al.	D25/113
D505,733	S *	5/2005	Castonguay et al.	D25/113
D639,454	S *	6/2011	Thomassen	D25/113
2008/0240857	A1	10/2008	Ciccarello		

FOREIGN PATENT DOCUMENTS

CA	1180218	1/1985
CA	81908	10/1997
CA	95294	1/2006
CA	97272	1/2006
CA	109688	1/2006
CA	2550358	12/2007
CA	121170	4/2008
CA	131922	12/2009
CA	130858	10/2010
DE	1790054	6/1959
DE	1116695	11/1961
FR	870037	2/1942
FR	2252467	6/1975
GB	2184143 A	6/1987

OTHER PUBLICATIONS

U.S. Appl. No. 29/385,550, filed Feb. 16, 2011, Pacitto, Jeffrey.

* cited by examiner

Primary Examiner — Anhdao Doan

(74) *Attorney, Agent, or Firm* — Locke Lord LLP; Peter J. Fallon

(57) **CLAIM**

I claim the ornamental design for a paver, as shown and described.

DESCRIPTION

FIG. 1 is a top view of the present design.

FIG. 2 is a left perspective view of the paver of FIG. 1.

FIG. 3 is a right perspective view of the paver of FIG. 1.

FIG. 4 is a top view of a variant of the present design.

FIG. 5 is a left perspective view of the paver of FIG. 4; and,

FIG. 6 is a right perspective view of the paver of FIG. 4.

The broken lines in the drawing views are included for the purpose of illustrating portions of the paver that form no part of the claimed design. The paver is shown broken away to indicate indeterminate thickness.

1 Claim, 6 Drawing Sheets

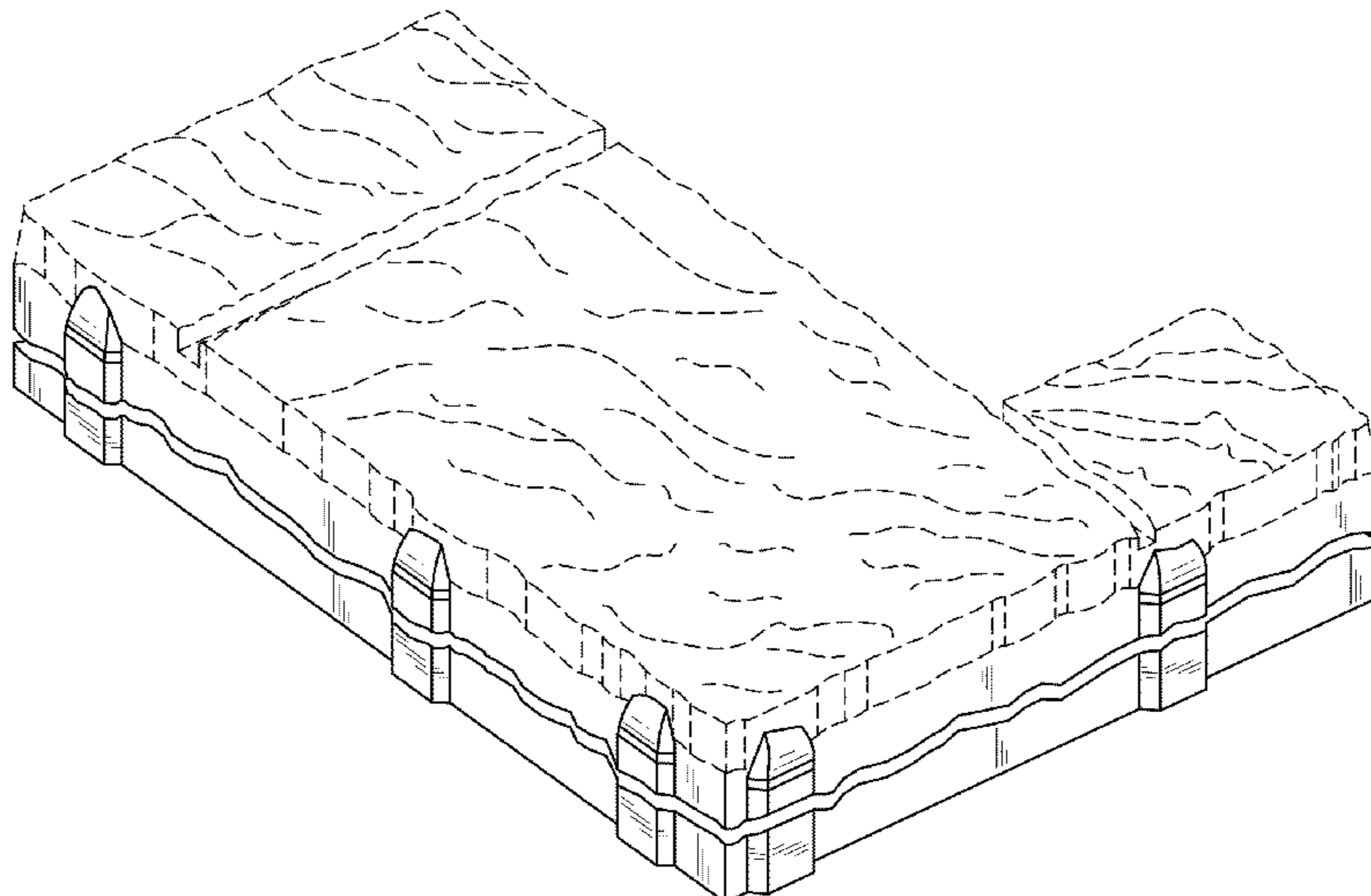

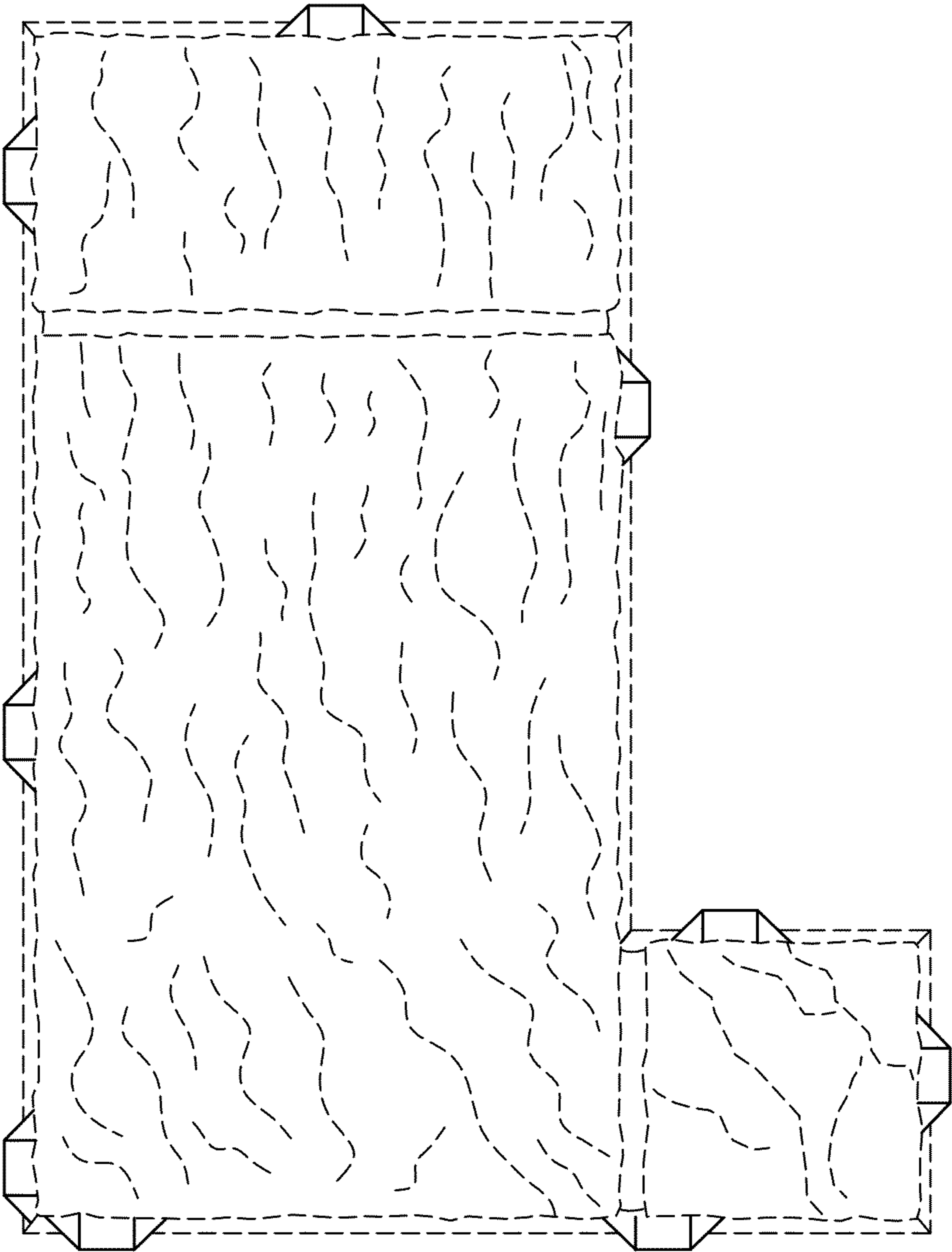

Figure 1

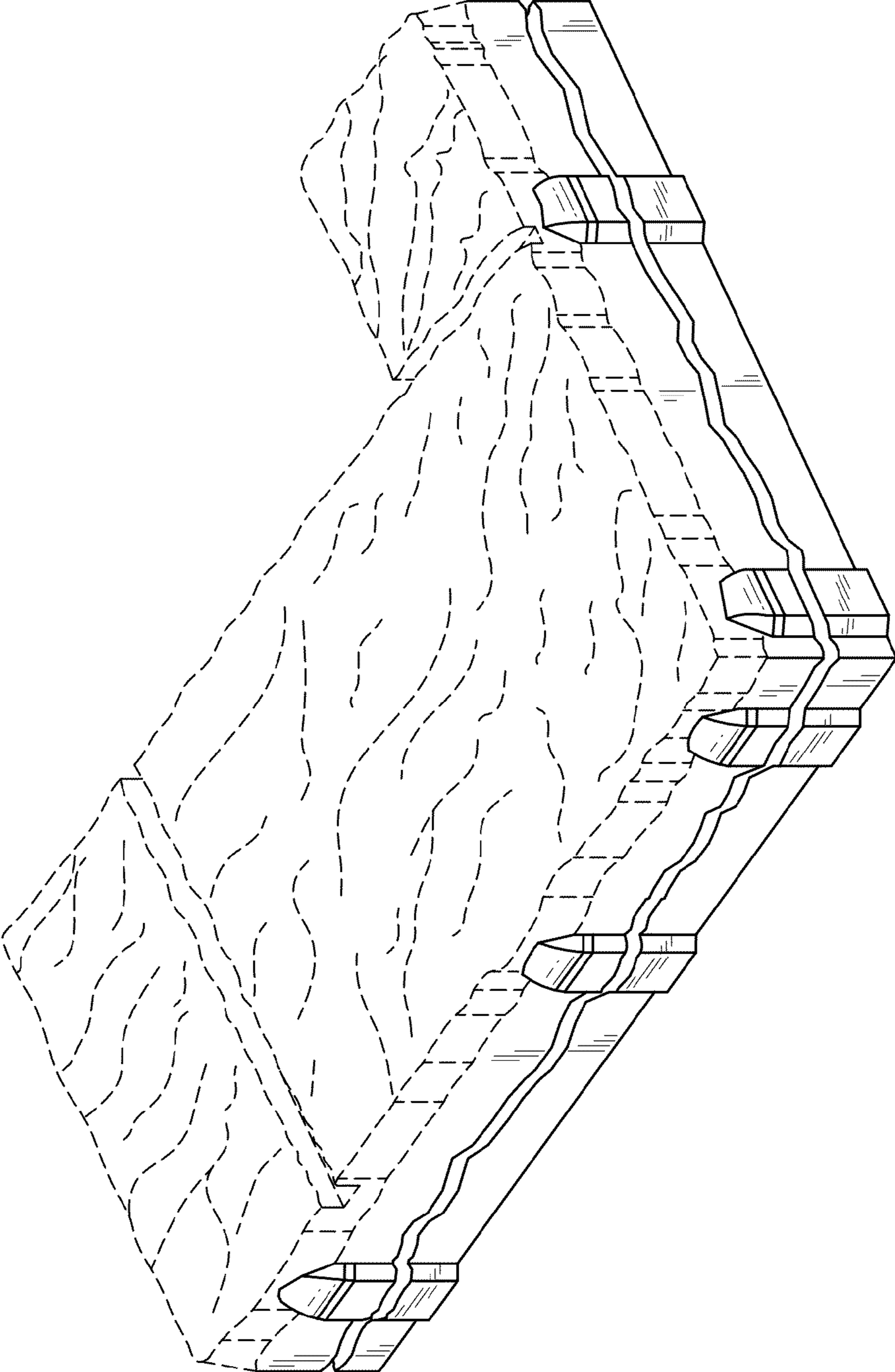

Figure 2

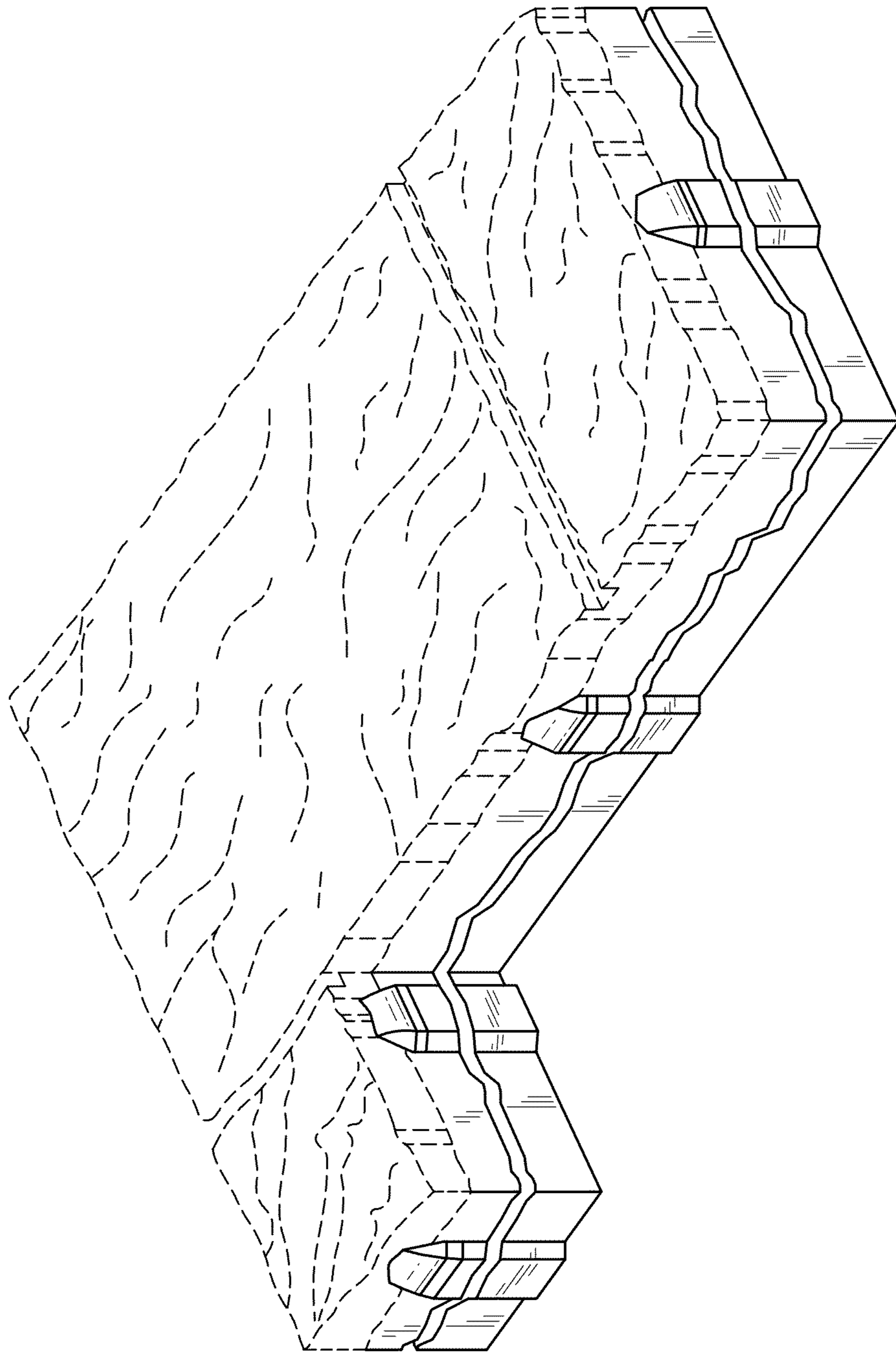

Figure 3

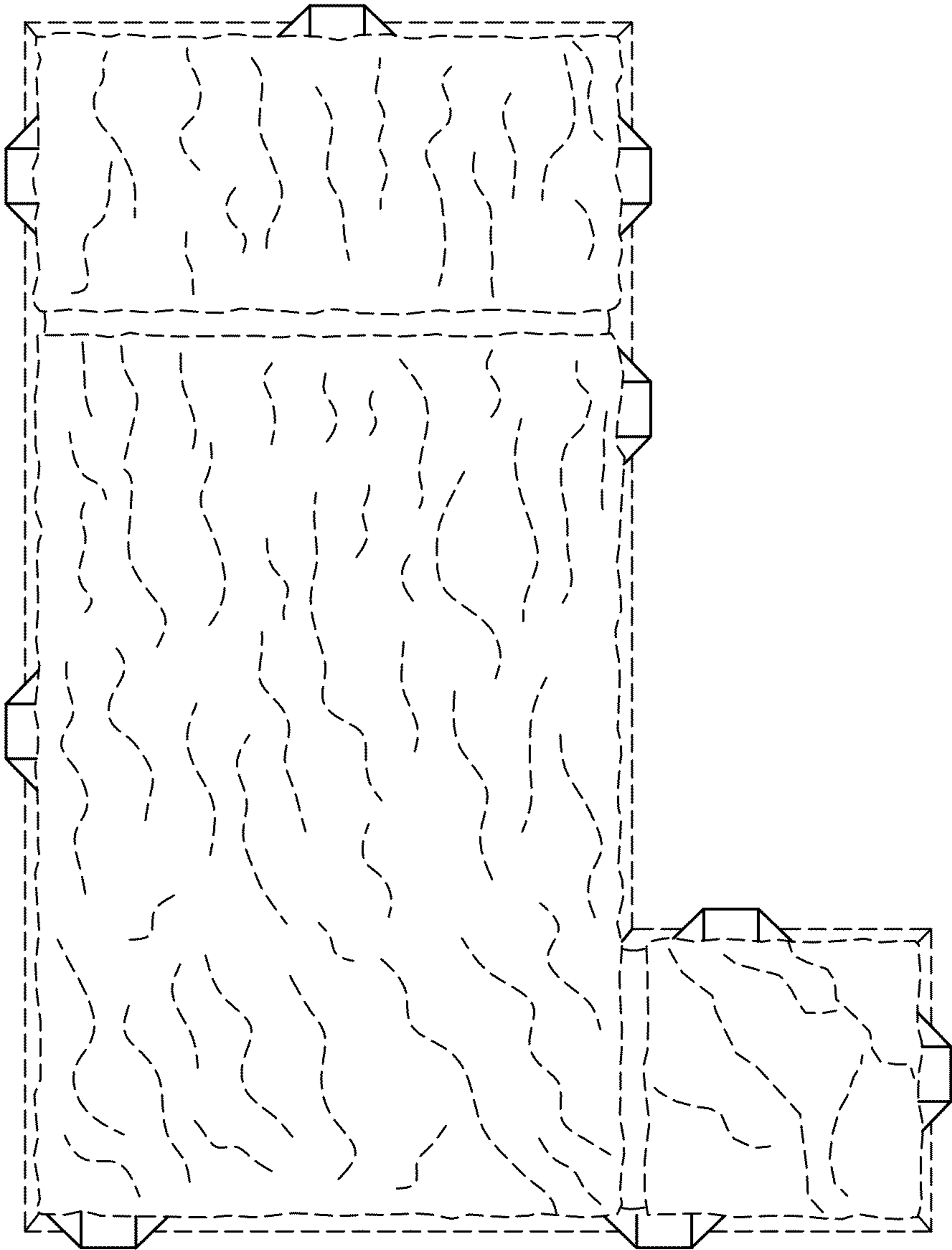

Figure 4

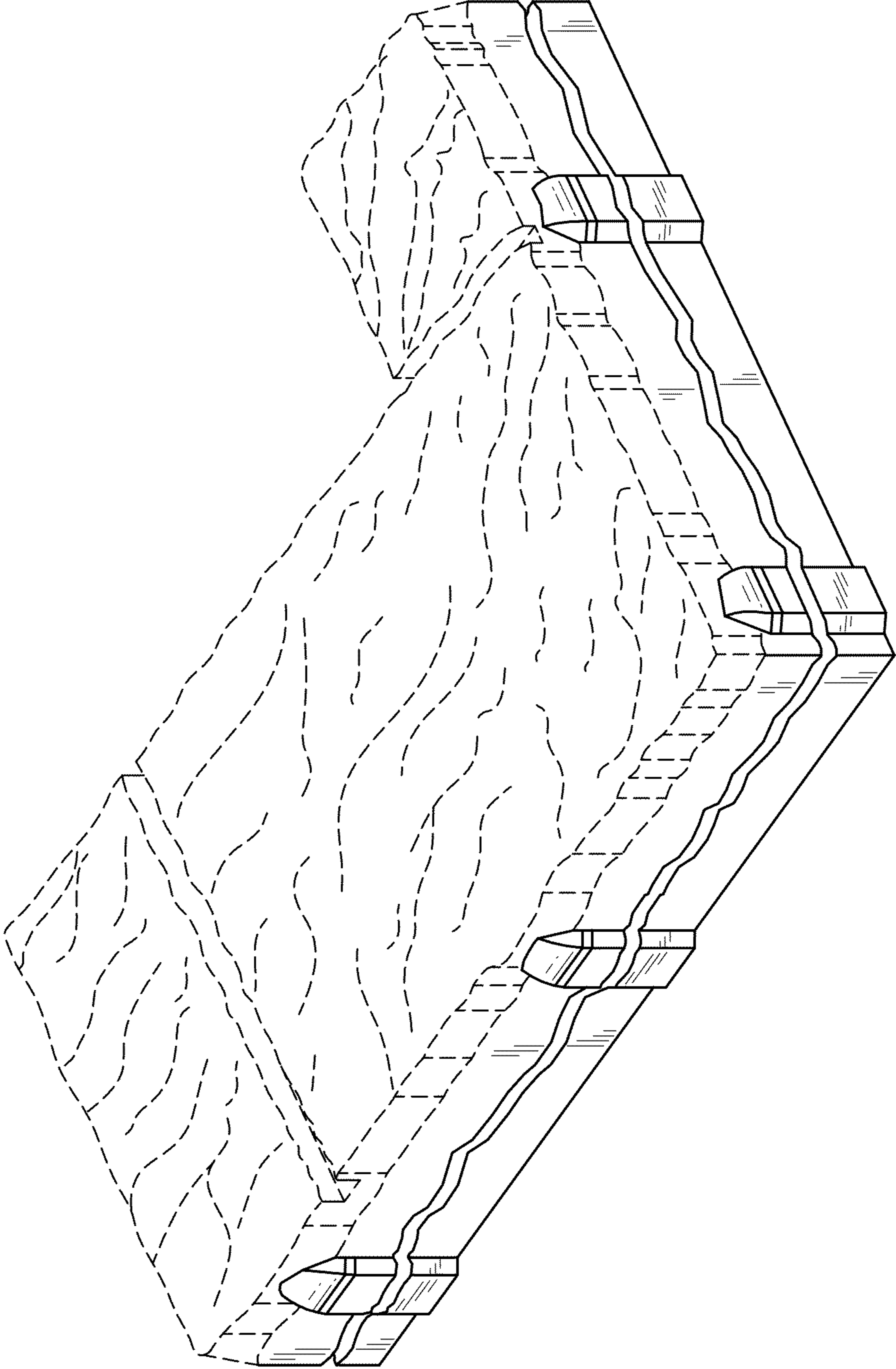

Figure 5

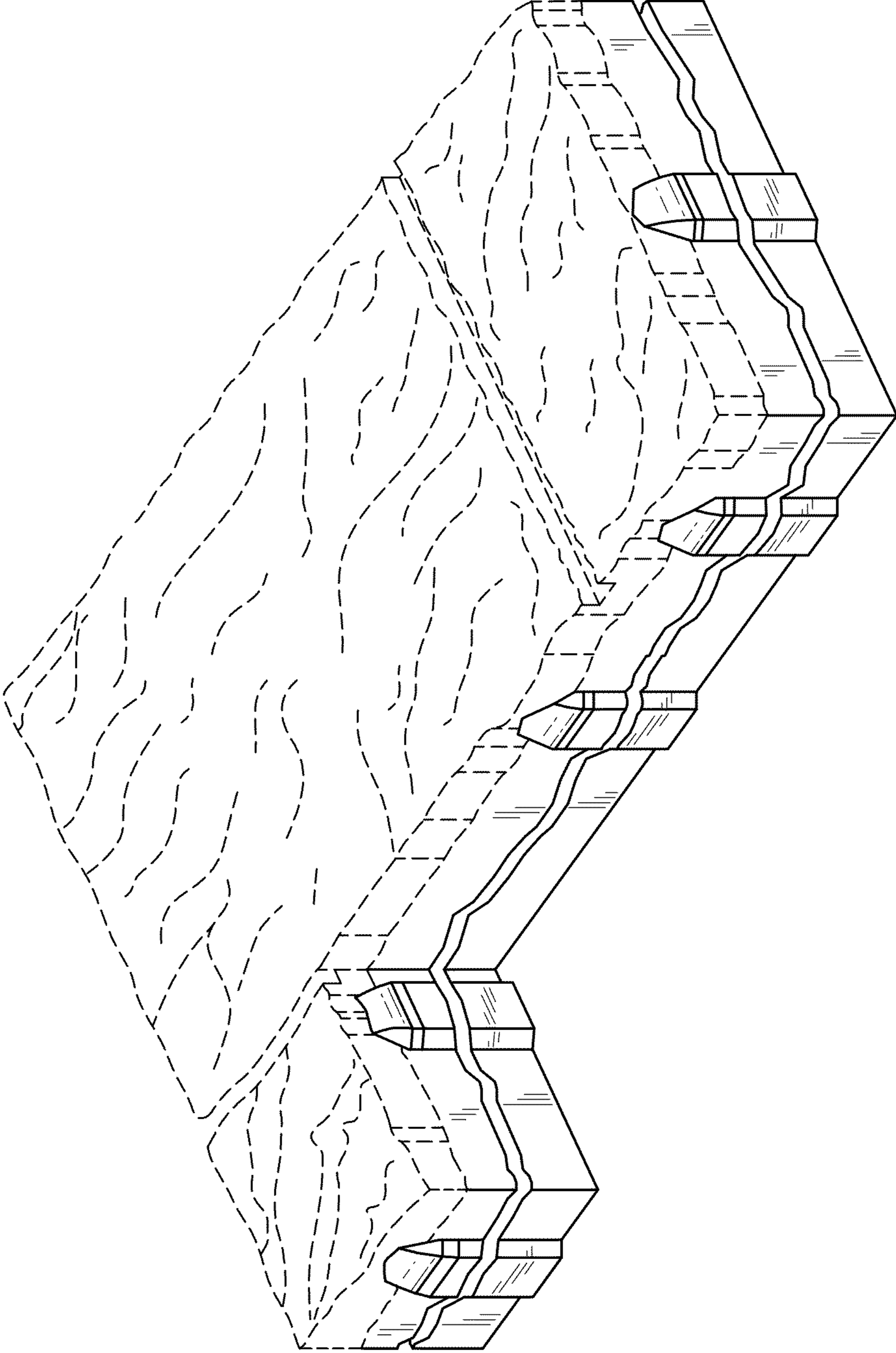

Figure 6