



US00D689442S

(12) **United States Design Patent**
Sakai et al.

(10) **Patent No.:** **US D689,442 S**

(45) **Date of Patent:** **** Sep. 10, 2013**

(54) **REMOTE CONTROLLER**

(75) Inventors: **Yuki Sakai**, Chiyoda-ku (JP); **Azumi Shimada**, Chiyoda-ku (JP)

(73) Assignee: **Mitsubishi Electric Corporation**, Tokyo (JP)

(**) Term: **14 Years**

(21) Appl. No.: **29/419,020**

(22) Filed: **Apr. 24, 2012**

(30) **Foreign Application Priority Data**

Nov. 24, 2011 (JP) 2011-027073

(51) **LOC (9) Cl.** **14-03**

(52) **U.S. Cl.**
USPC **D13/168**

(58) **Field of Classification Search**
USPC D13/168; D10/49, 50, 104.1, 106.1;
D14/203.7, 341, 496; 165/238; 315/158,
315/295; 340/4.3, 4.42, 12.22, 12.23, 12.24,
340/12.29, 12.3, 13.2, 13.21, 13.24; 341/176;
236/49.3, 46 R, 51, 1 C, 94; 348/734; 455/352;
700/17, 65, 83, 86, 276, 277

See application file for complete search history.

(56) **References Cited**

U.S. PATENT DOCUMENTS

4,768,230 A * 8/1988 Viebrantz et al. 398/106
4,980,522 A * 12/1990 Murakami et al. 200/5 A
D351,141 S * 10/1994 Van Akkeren et al. D13/168
D374,693 S * 10/1996 Osborne D21/513
D409,200 S * 5/1999 Cooper D14/218
D450,305 S * 11/2001 Masuzoe et al. D13/168
D493,148 S * 7/2004 Shibata et al. D13/168

D503,686 S * 4/2005 Knox et al. D13/162
D606,129 S * 12/2009 Ben-Moshe D21/517
D623,606 S * 9/2010 Nakai et al. D13/168
D639,751 S * 6/2011 Tucker et al. D13/168
D642,544 S * 8/2011 Kataoka et al. D13/168
D660,809 S * 5/2012 Kern Koskela et al. D13/168
D661,662 S * 6/2012 Kikuchi et al. D13/168

* cited by examiner

Primary Examiner — Selina Sikder

(74) *Attorney, Agent, or Firm* — Sughrue Mion, PLLC

(57) **CLAIM**

The ornamental design for a remote controller, as shown and described.

DESCRIPTION

FIG. 1 is a front, top and right side perspective view of a remote controller, showing my new design;
FIG. 2 is a front elevational view thereof;
FIG. 3 is a rear elevational view thereof;
FIG. 4 is a left side elevational view thereof;
FIG. 5 is a right side elevational view thereof;
FIG. 6 is a top plan view thereof;
FIG. 7 is a bottom plan view thereof;
FIG. 8 is a reference vertical cross-sectional view thereof; taken in the direction of line 8-8 in FIG. 2, with the internal system omitted;
FIG. 9 is a reference horizontal cross-sectional view thereof; taken in the direction of line 9-9 in FIG. 2, with the internal system omitted;
FIG. 10 is a reference front elevational view thereof; and,
FIG. 11 is a reference cross-sectional view thereof; taken in the direction of line 11-11 in FIG. 10, with the internal system omitted.

The broken lines in all views are shown for illustrative purposes only and form no part of the claimed design.

1 Claim, 9 Drawing Sheets

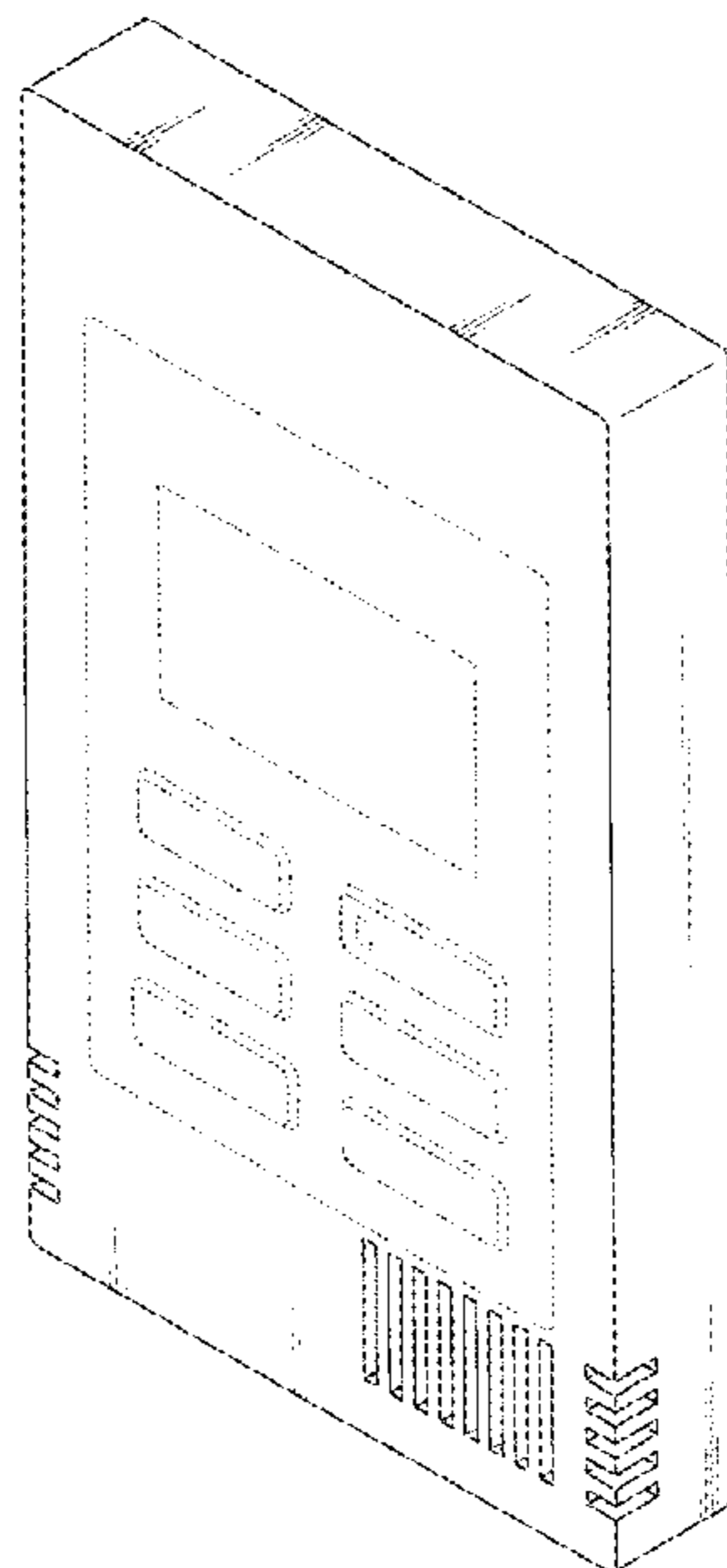

Fig. 1

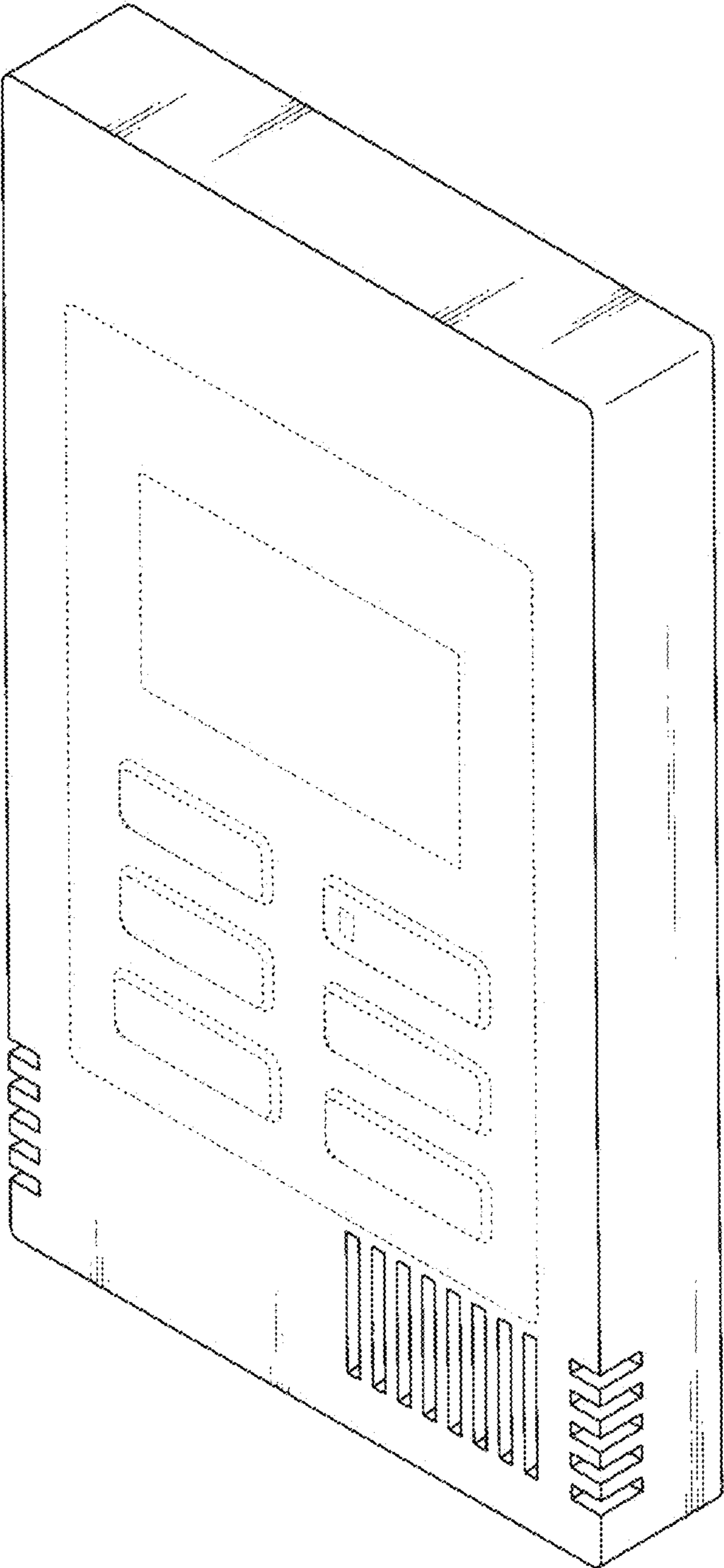

Fig. 2

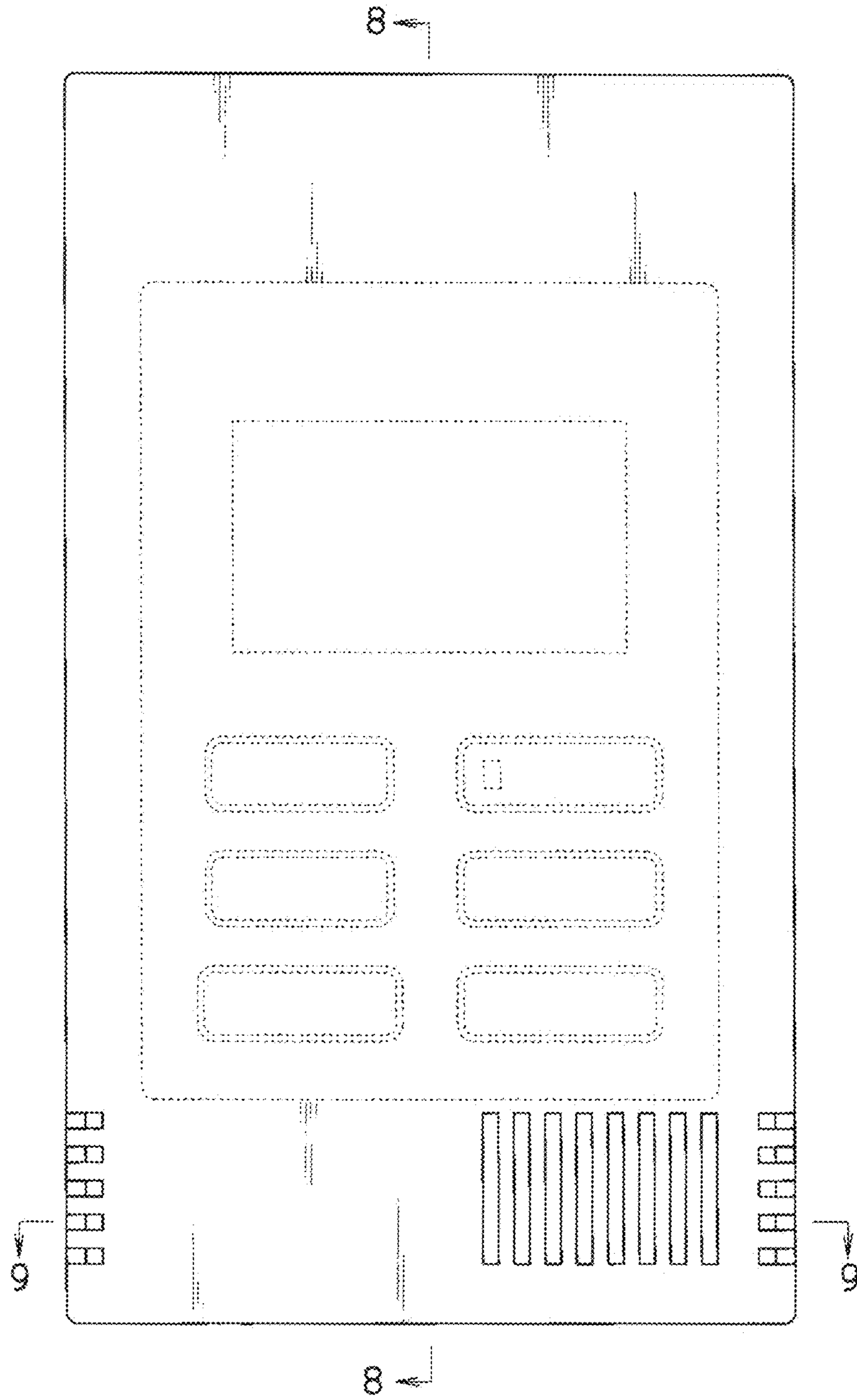

Fig. 3

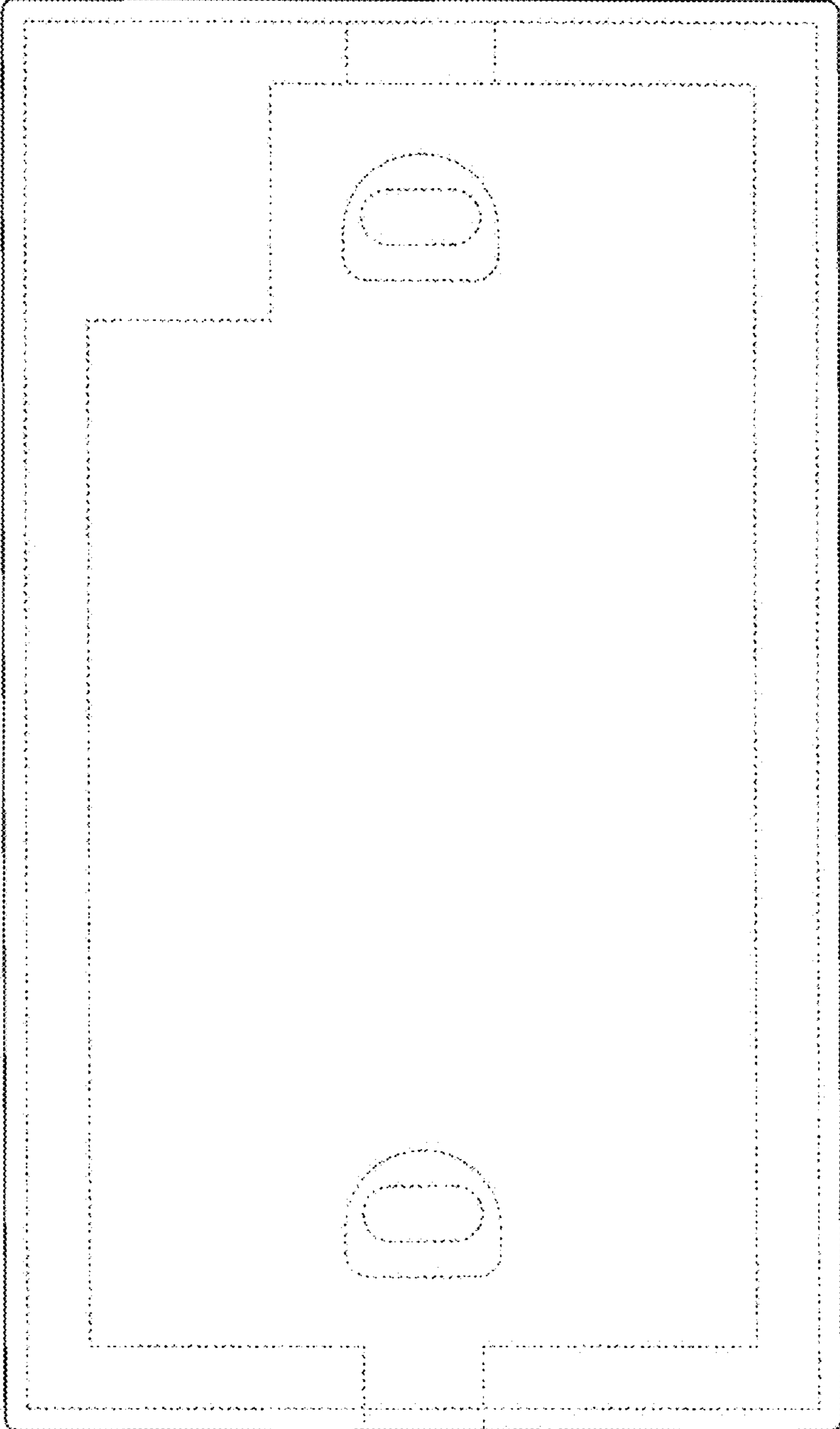

Fig. 4

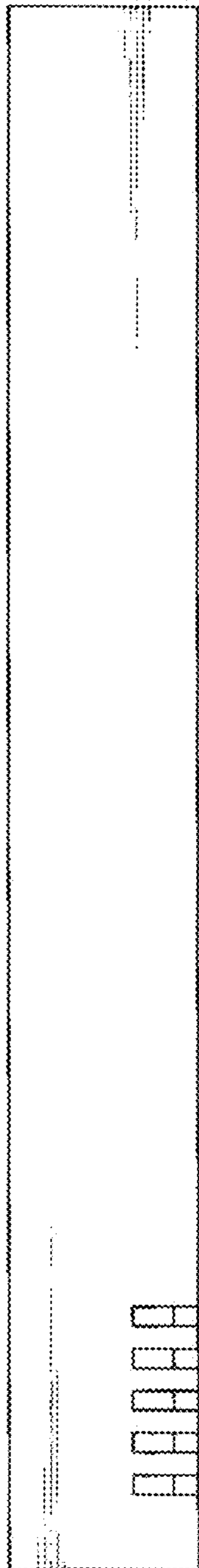

Fig. 5

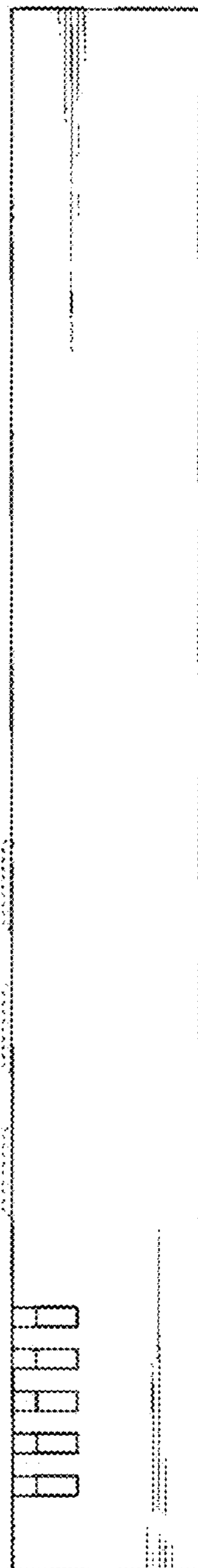

Fig. 6

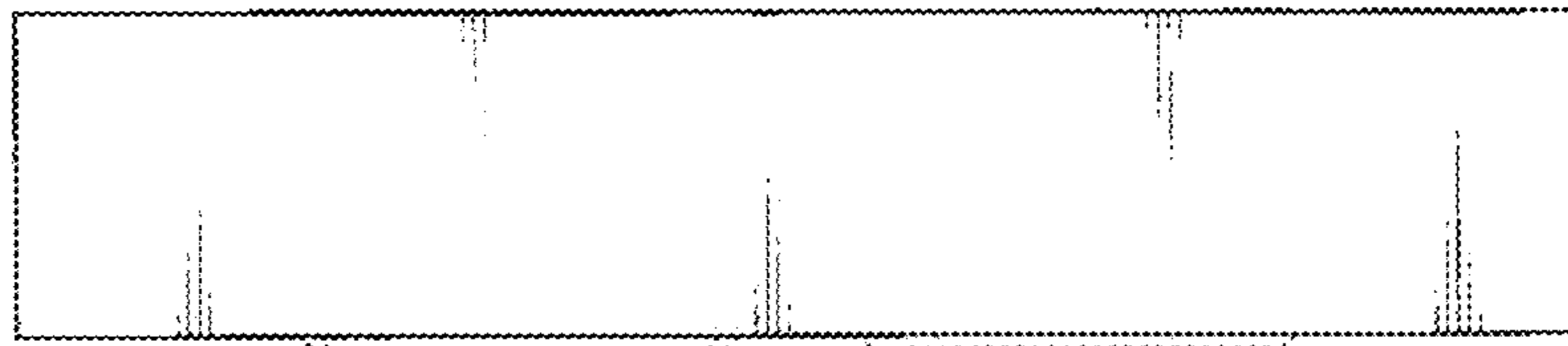

Fig. 7



Fig. 8

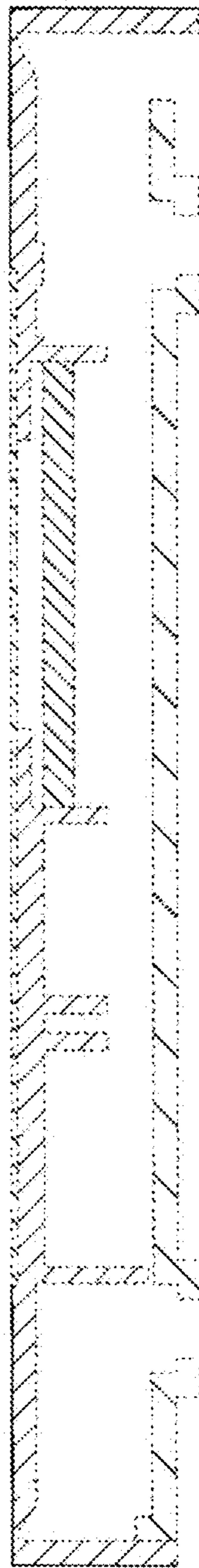

Fig. 9

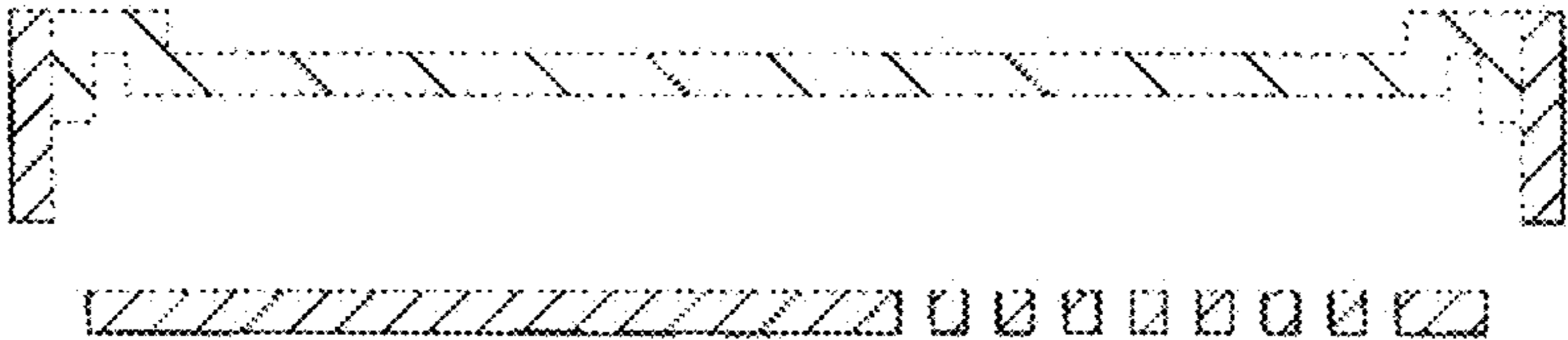

Fig. 10

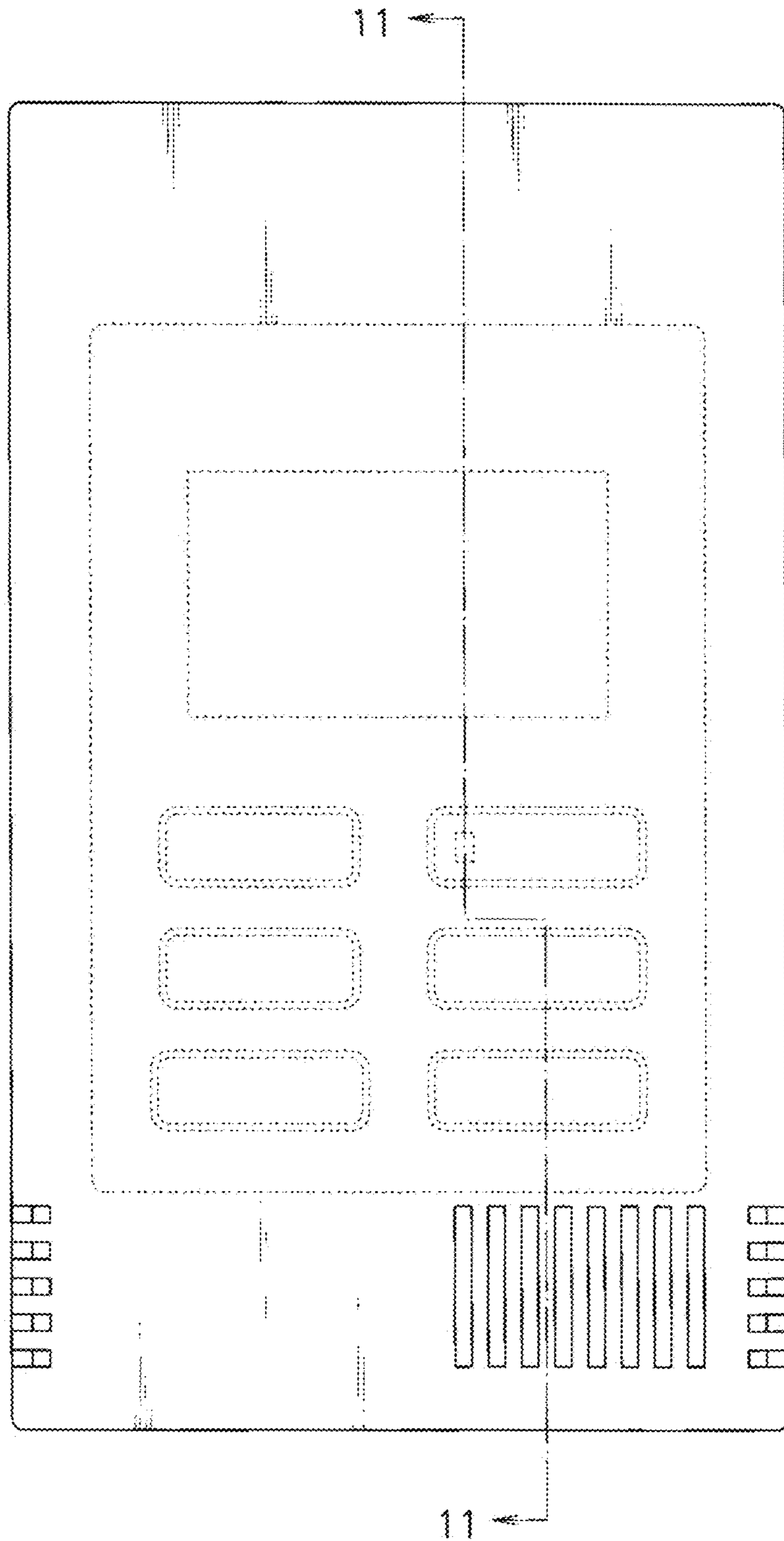

Fig. 11

