



US00D687747S

(12) **United States Design Patent**
Terpsma

(10) **Patent No.:** **US D687,747 S**

(45) **Date of Patent:** **** Aug. 13, 2013**

(54) **PINTLE HOOK**

(75) **Inventor:** **Eric M. Terpsma**, Holland, MI (US)

(73) **Assignee:** **Saf-Holland, Inc.**, Holland, MI (US)

(**) **Term:** **14 Years**

(21) **Appl. No.:** **29/416,261**

(22) **Filed:** **Mar. 20, 2012**

(51) **LOC (9) Cl.** **12-16**

(52) **U.S. Cl.**
USPC **D12/162**

(58) **Field of Classification Search**
USPC D12/162, 159, 160, 161; 56/DIG. 14;
37/399; 280/406.2, 407, 407.1, 408, 411.1,
280/416.1, 416.2, 416.3, 418, 418.1, 433,
280/434, 435, 441.1, 441.2, 455.1, 456.1,
280/480, 493, 504, 507, 508; 224/42.11,
224/42.12, 401, 412, 413, 488, 494, 500-501,
224/519, 537; 135/88.05; 150/166
See application file for complete search history.

(56) **References Cited**

U.S. PATENT DOCUMENTS

2,842,380 A * 7/1958 Weiss 280/504
3,963,266 A * 6/1976 Thelin 280/504

4,758,015 A * 7/1988 Pixley 280/504
4,989,892 A * 2/1991 Kerins et al. 280/504
5,240,274 A * 8/1993 Blacklaw 280/504
D457,113 S * 5/2002 Zapushek et al. D12/162
D486,763 S * 2/2004 Nunez D12/160
D496,888 S * 10/2004 Johnson, Jr. D12/162
6,889,995 B2 * 5/2005 Staggs 280/507
D615,462 S * 5/2010 Barrette D12/162
D656,868 S * 4/2012 Jansen et al. D12/162
D661,627 S * 6/2012 Noone et al. D12/162
2007/0145716 A1 * 6/2007 Schulze 280/483

* cited by examiner

Primary Examiner — Katrina A Betton

(74) *Attorney, Agent, or Firm* — Price Heneveld LLP

(57) **CLAIM**

The ornamental design for a pintle hook, as shown and described.

DESCRIPTION

FIG. 1 is a perspective view of a pintle hook;
FIG. 2 is an elevational view of a left side of the pintle hook;
FIG. 3 is an elevational view of a right side of the pintle hook;
FIG. 4 is a front elevational view of the pintle hook;
FIG. 5 is a rear elevational view of the pintle hook;
FIG. 6 is a top plan view of the pintle hook; and,
FIG. 7 is a bottom plan view of the pintle hook.
The dashed lines within the figures are shown for illustrative purposes only and form no part of the claimed invention.

1 Claim, 2 Drawing Sheets

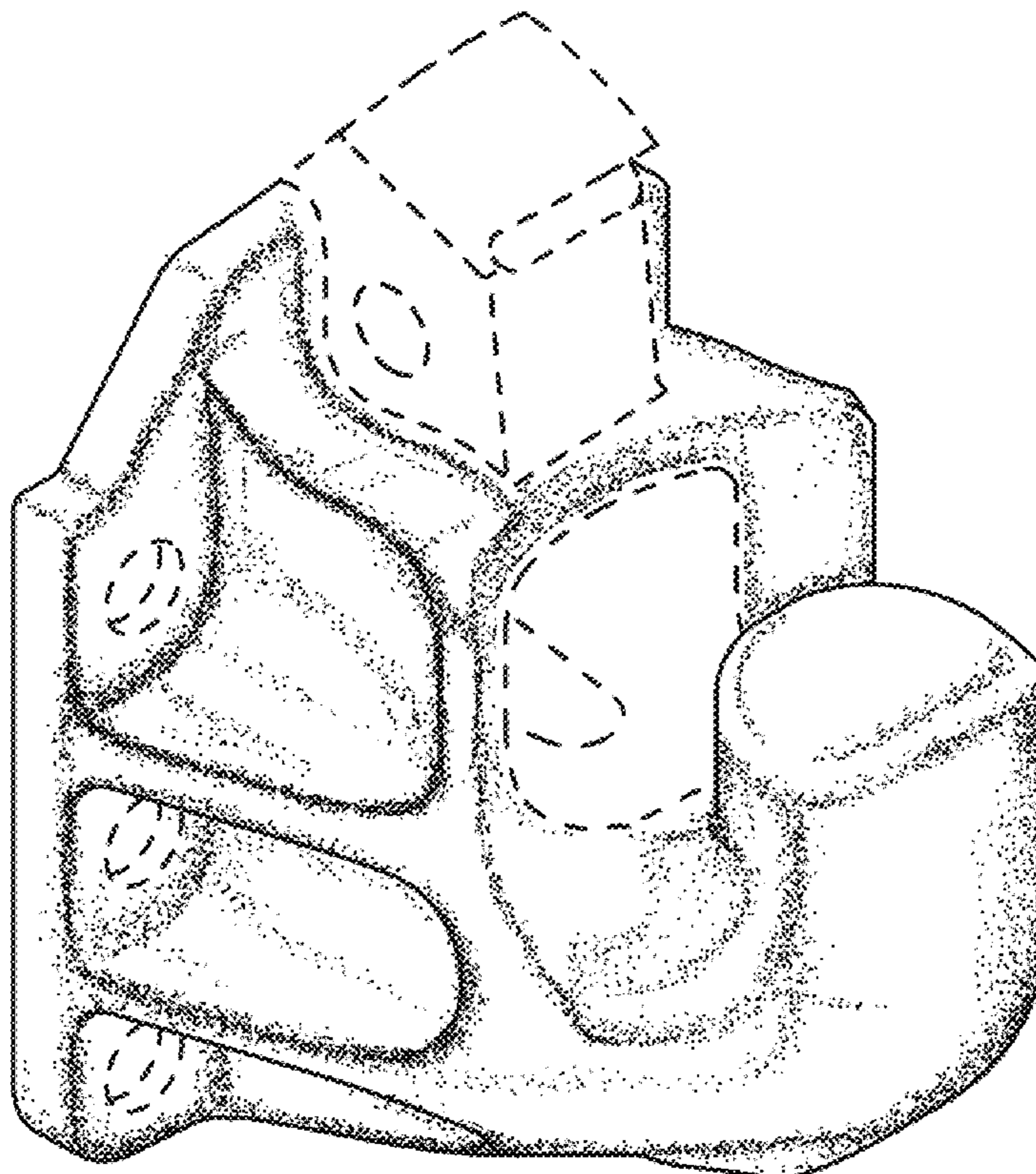

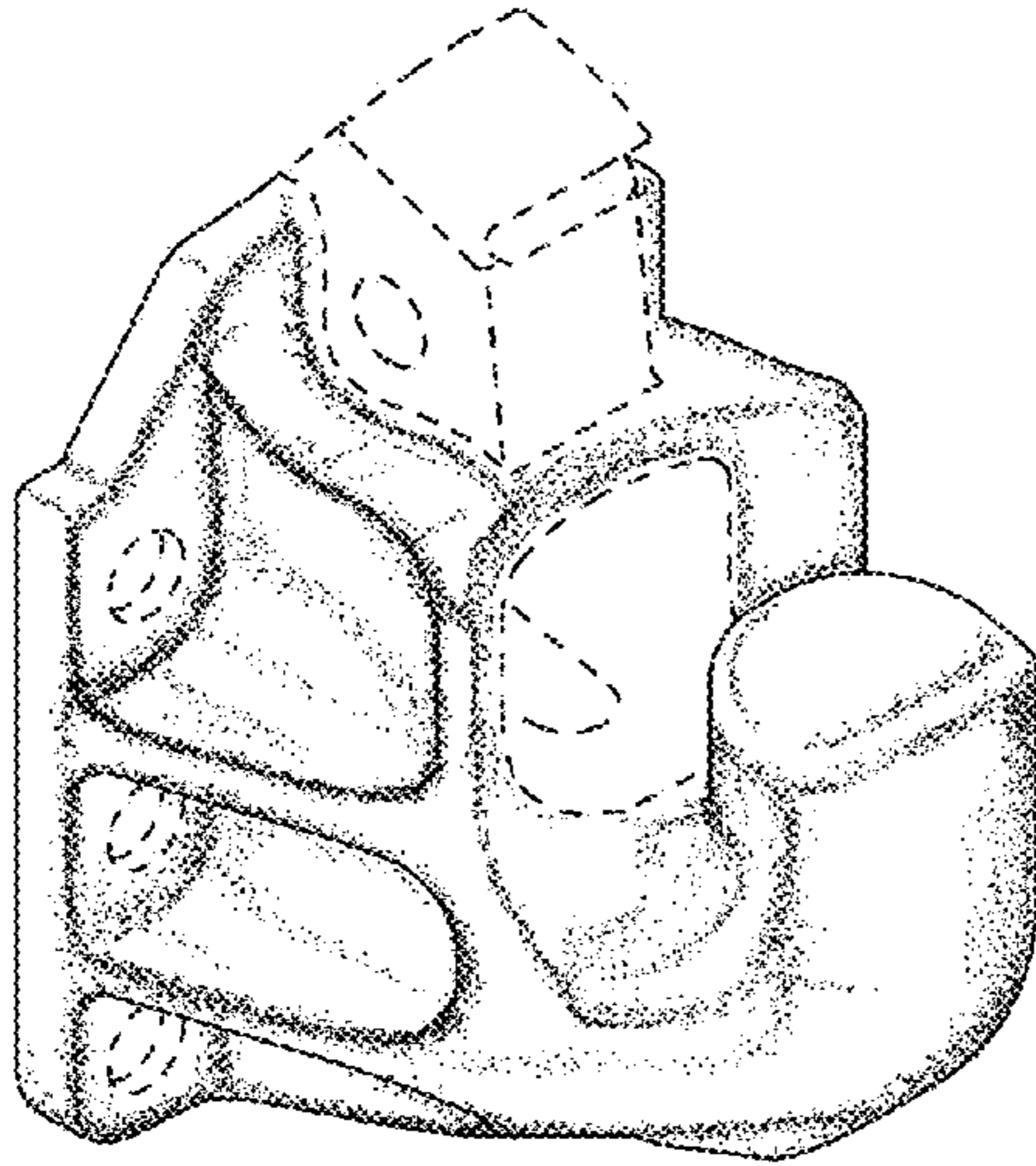

FIG. 1

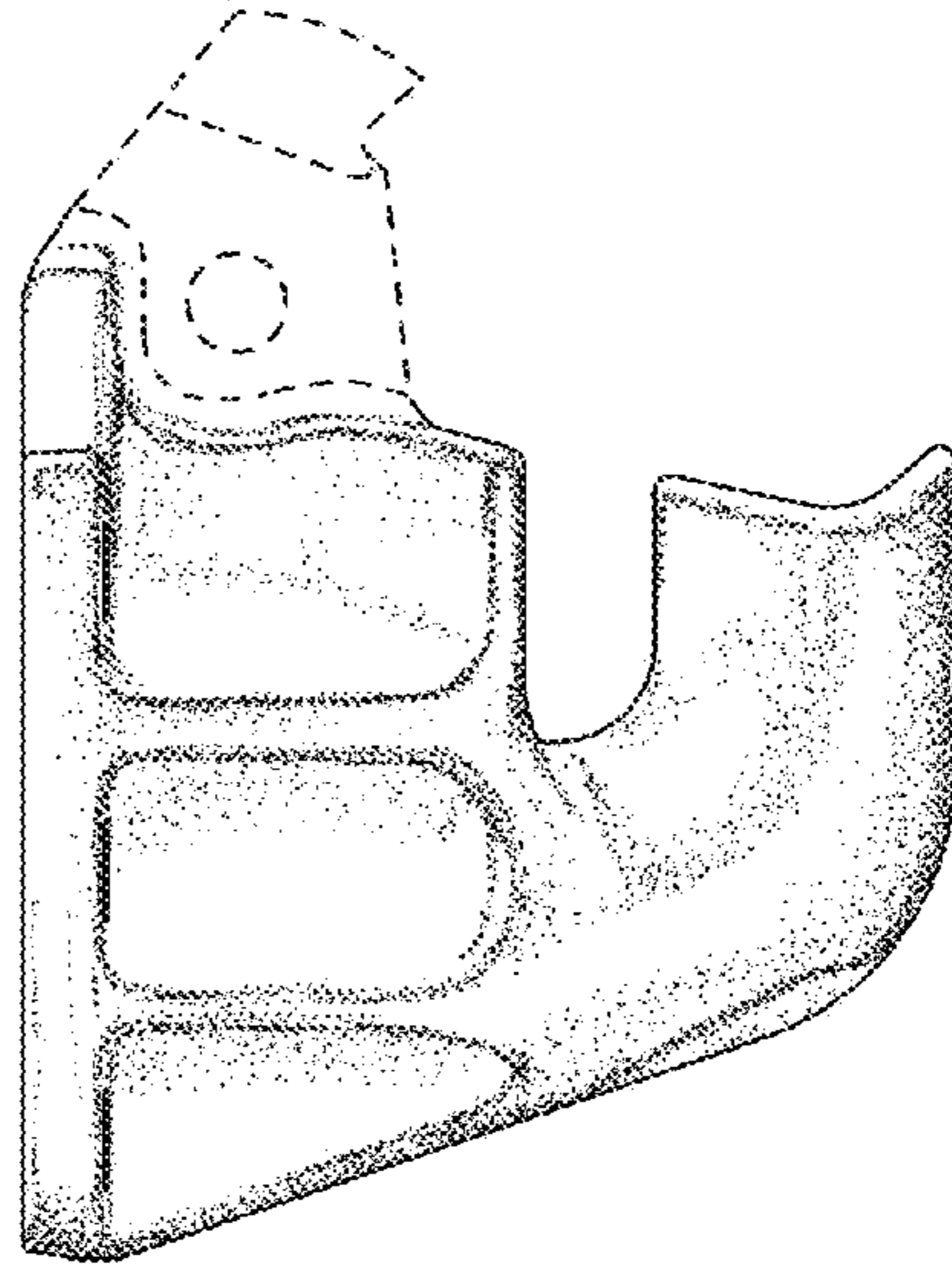

FIG. 2

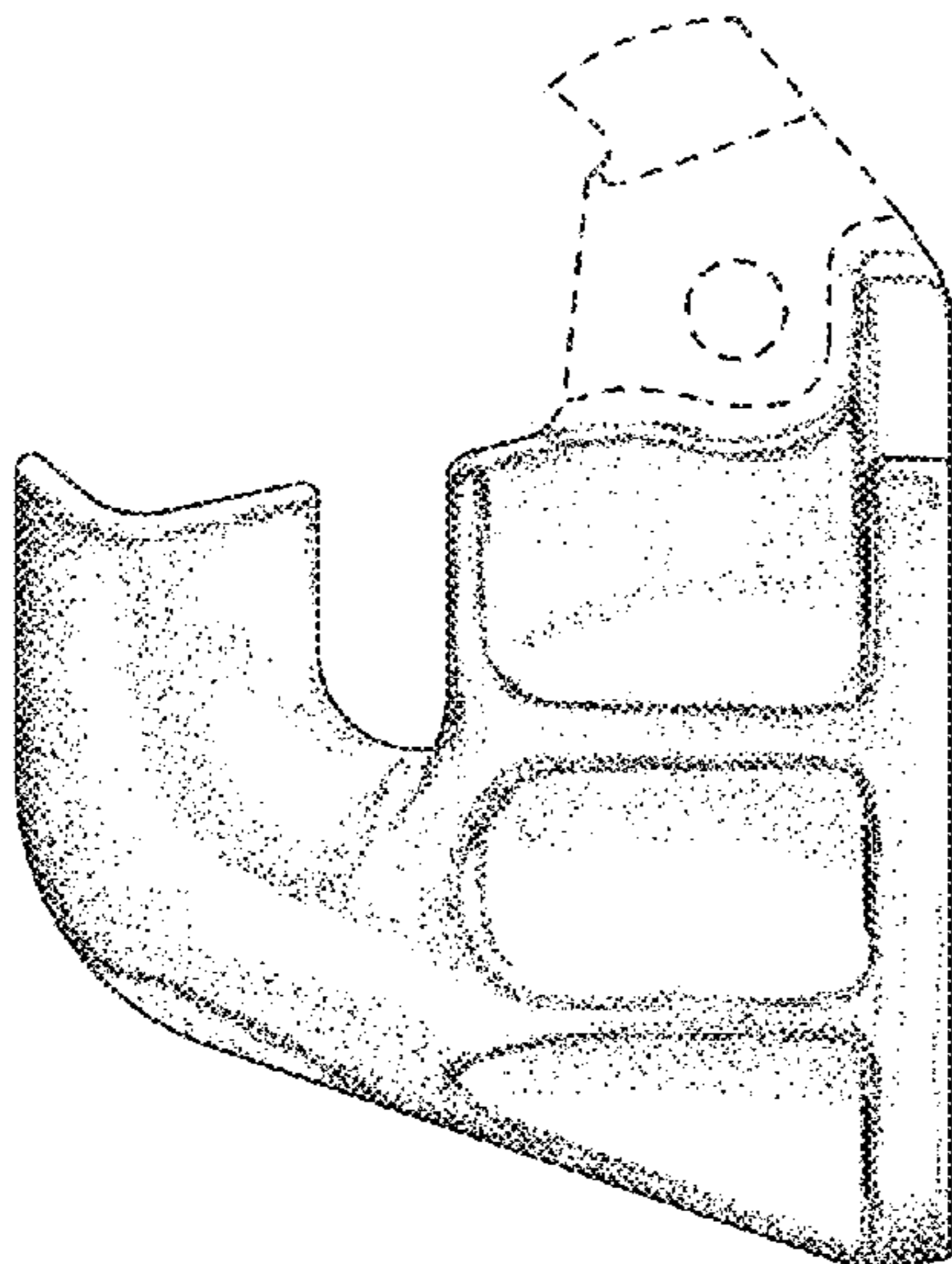

FIG. 3

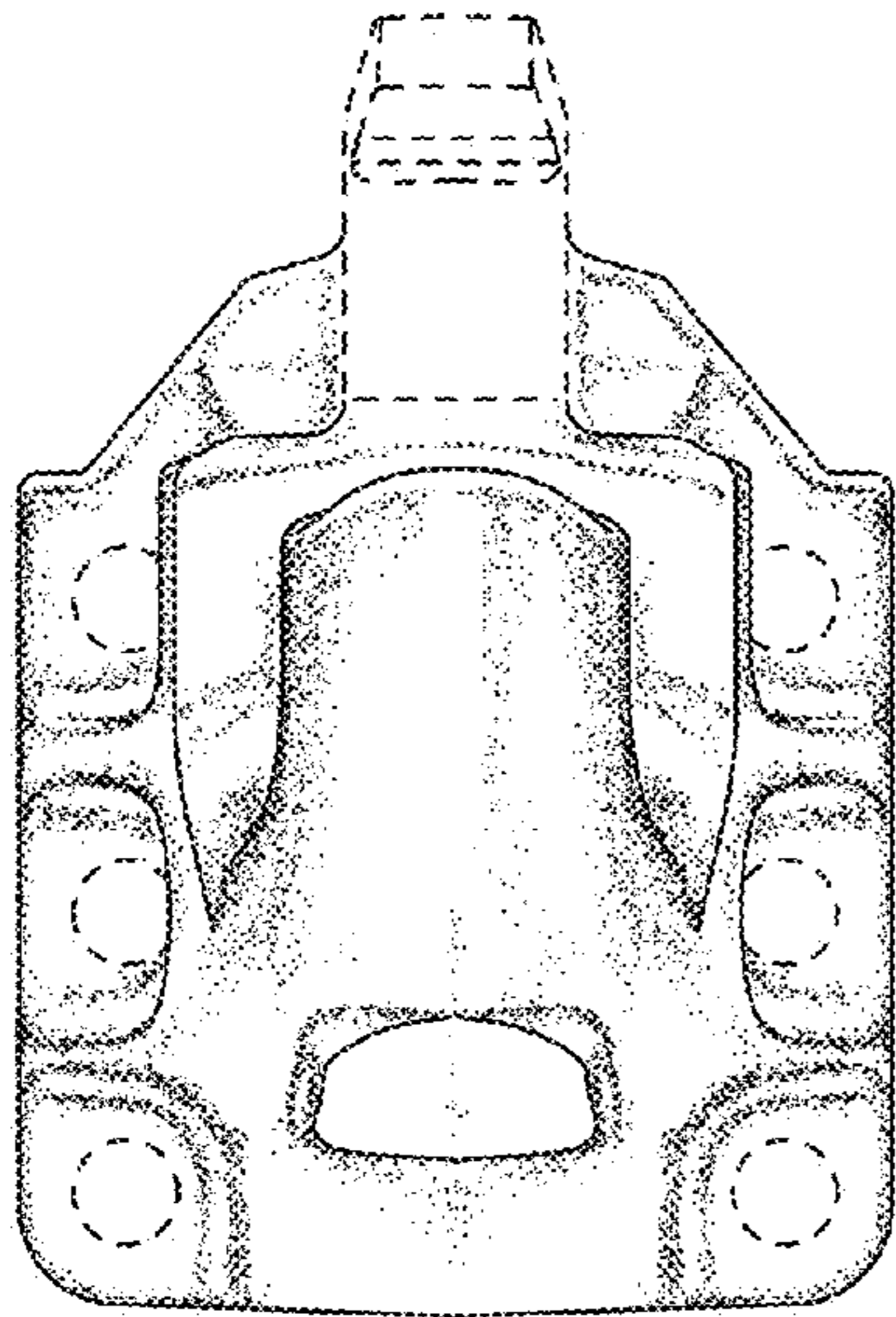

FIG. 4

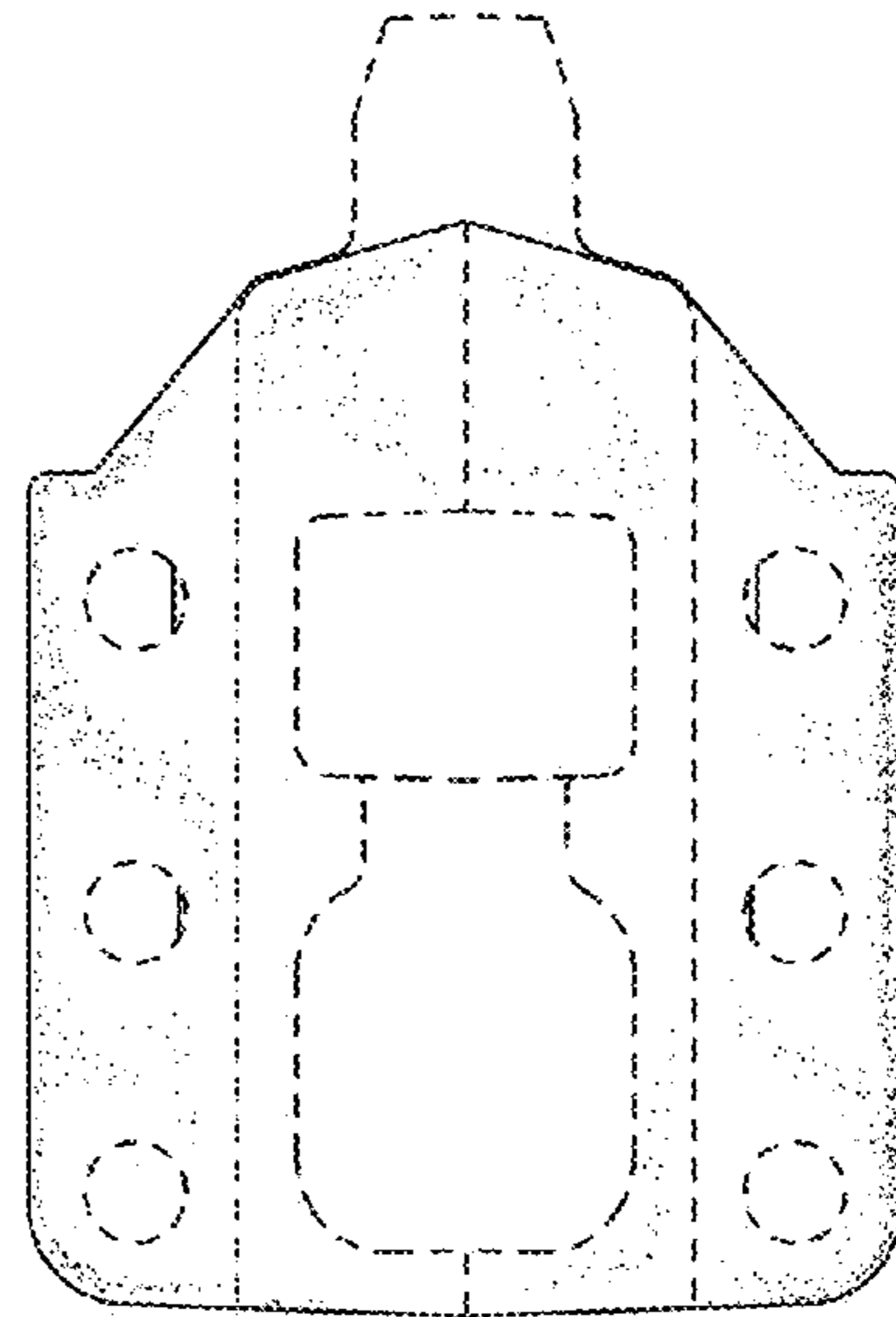

FIG. 5

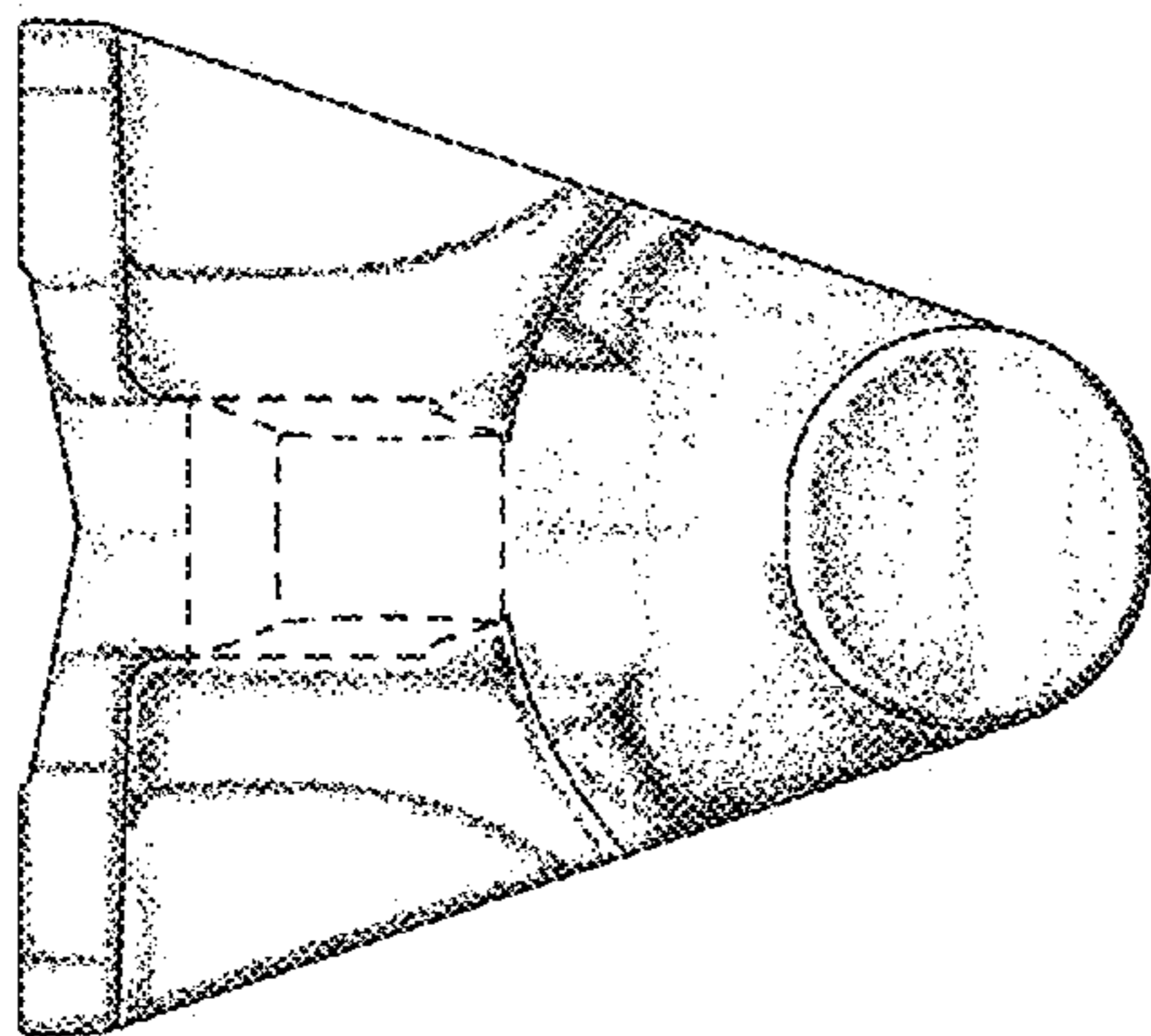

FIG. 6

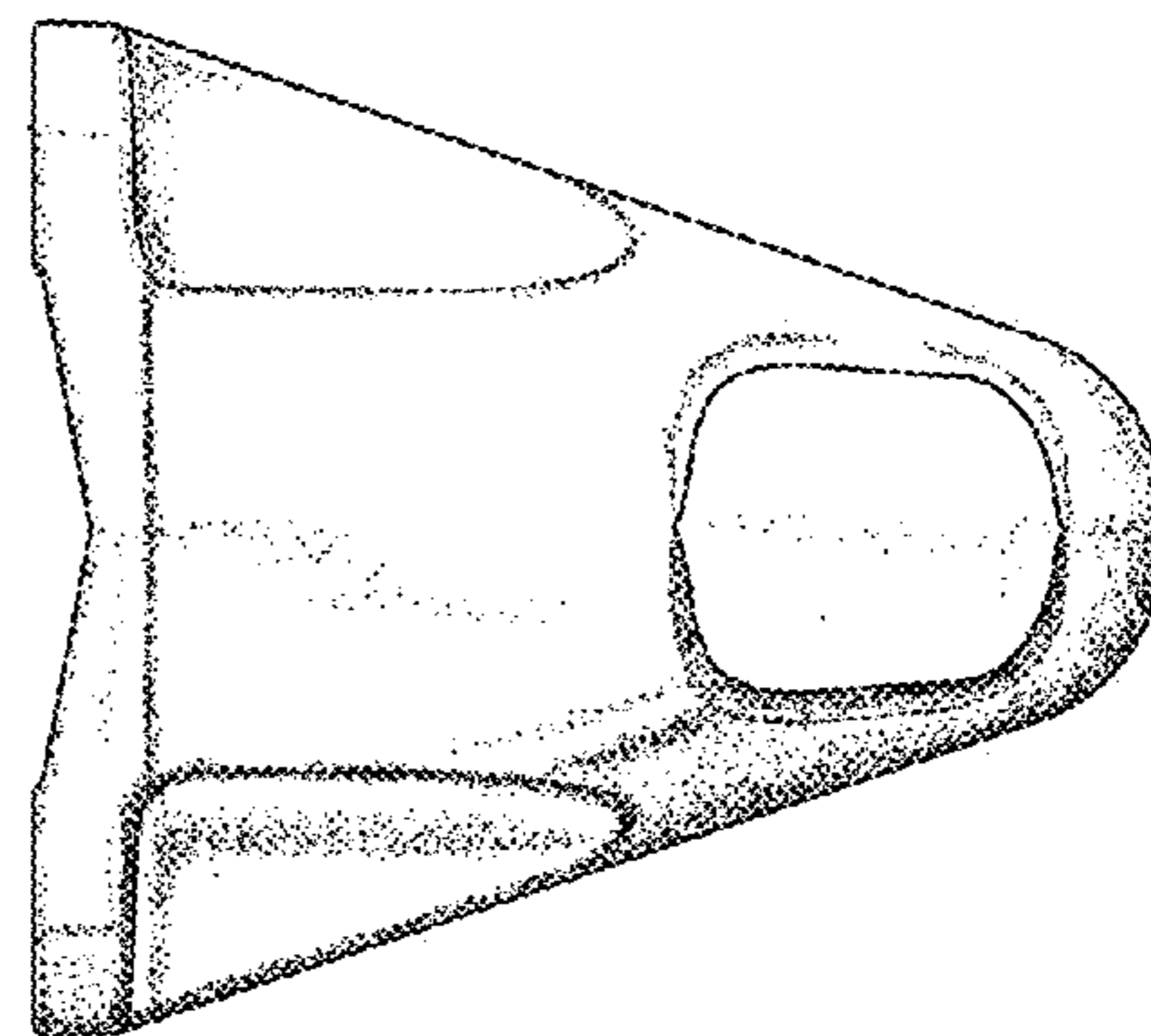

FIG. 7