



US00D686310S

(12) **United States Design Patent**
Laskowski et al.

(10) **Patent No.:** **US D686,310 S**
(45) **Date of Patent:** **** Jul. 16, 2013**

(54) **CHIP STATION PLATE WITH LED ASSEMBLY**

(75) Inventors: **Conrad Laskowski**, Baltimore, MD (US); **Eric Schneider**, Catonsville, MD (US); **Jeremy Savage**, Rockville, MD (US); **Hongye Liang**, Clarksville, MD (US); **Kenton Hasson**, Germantown, MD (US)

(73) Assignee: **Canon U.S. Life Sciences, Inc.**, Rockville, MD (US)

(**) Term: **14 Years**

(21) Appl. No.: **29/385,964**

(22) Filed: **Feb. 23, 2011**

(51) **LOC (9) Cl.** **24-01**

(52) **U.S. Cl.**
USPC **D24/107**; D24/216; D24/232

(58) **Field of Classification Search**

USPC D24/107, 216–232, 169, 186; D10/81; 422/62–63, 66–67, 68.1, 500, 502, 503; 435/287.1, 287.2, 288.3, 288.7, 305.1
See application file for complete search history.

(56) **References Cited**

U.S. PATENT DOCUMENTS

D324,426 S * 3/1992 Fan et al. D24/226
6,395,554 B1 * 5/2002 Regan et al. 422/67
D463,031 S * 9/2002 Slomski et al. D24/226
6,511,277 B1 * 1/2003 Norris et al. 414/331.05

D613,184 S * 4/2010 Nalagatla et al. D24/229
D625,428 S * 10/2010 Bare et al. D24/220
2012/0052560 A1 * 3/2012 Knight et al. 435/287.2
2012/0115190 A1 * 5/2012 Coursey et al. 435/91.2
2012/0115214 A1 * 5/2012 Battrell et al. 435/287.2

* cited by examiner

Primary Examiner — Wan Laymon

(74) *Attorney, Agent, or Firm* — Rothwell, Figg, Ernst & Manbeck, P.C.

(57) **CLAIM**

The ornamental design for chip station plate with LED assembly, as shown and described.

DESCRIPTION

FIG. 1 is an elevated perspective view of the top, front and right side of the chip station plate with LED assembly; FIG. 2 is an elevated perspective view of the bottom, front and right side of the chip station plate with LED assembly; FIG. 3 is a front view of the chip station plate with LED assembly; FIG. 4 is a rear view of the chip station plate with LED assembly; FIG. 5 is a left side view of the chip station plate with LED assembly; FIG. 6 is a right side view of the chip station plate with LED assembly; FIG. 7 is an enlarged top view of the chip station plate with LED assembly; and, FIG. 8 is an enlarged bottom view of the chip station plate with LED assembly.

The portions of the chip station plate with LED assembly shown in broken lines form no part of the claimed design.

1 Claim, 8 Drawing Sheets

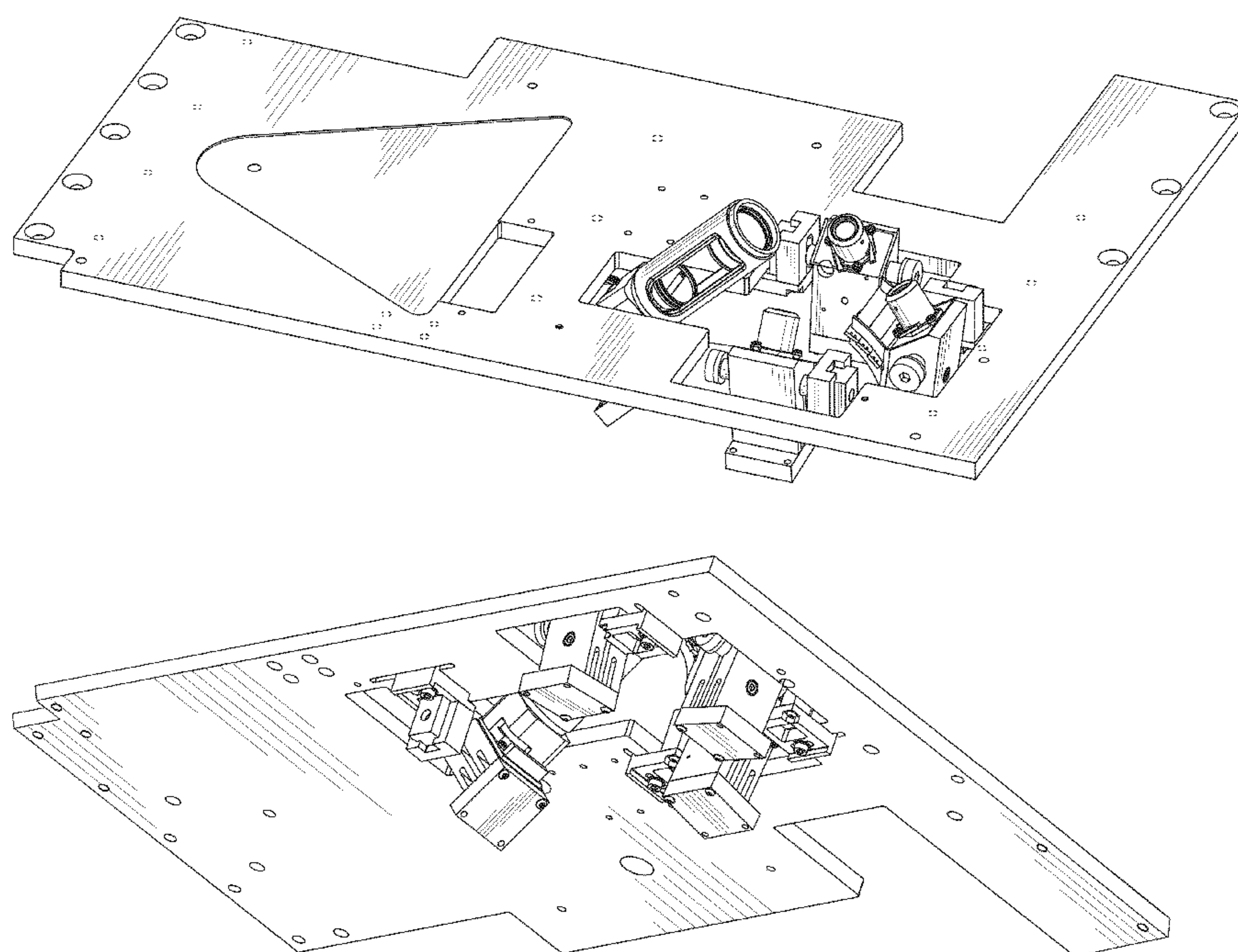

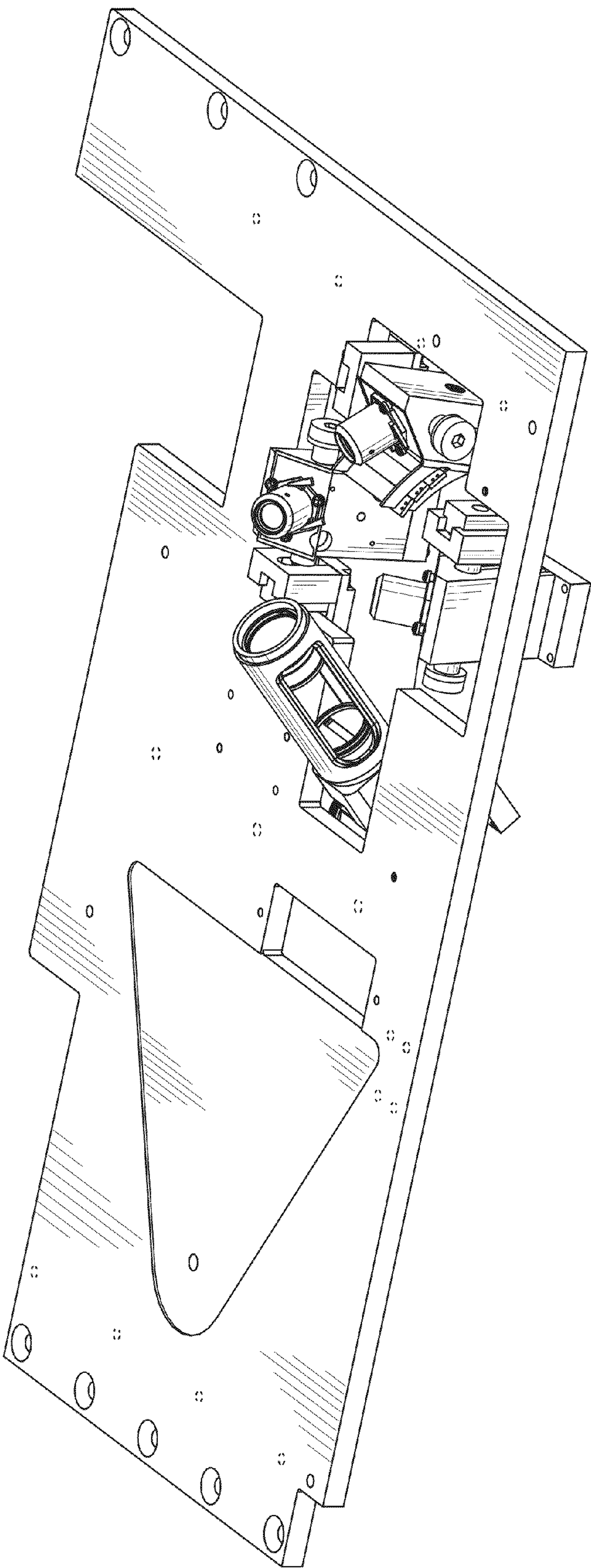

FIG.1

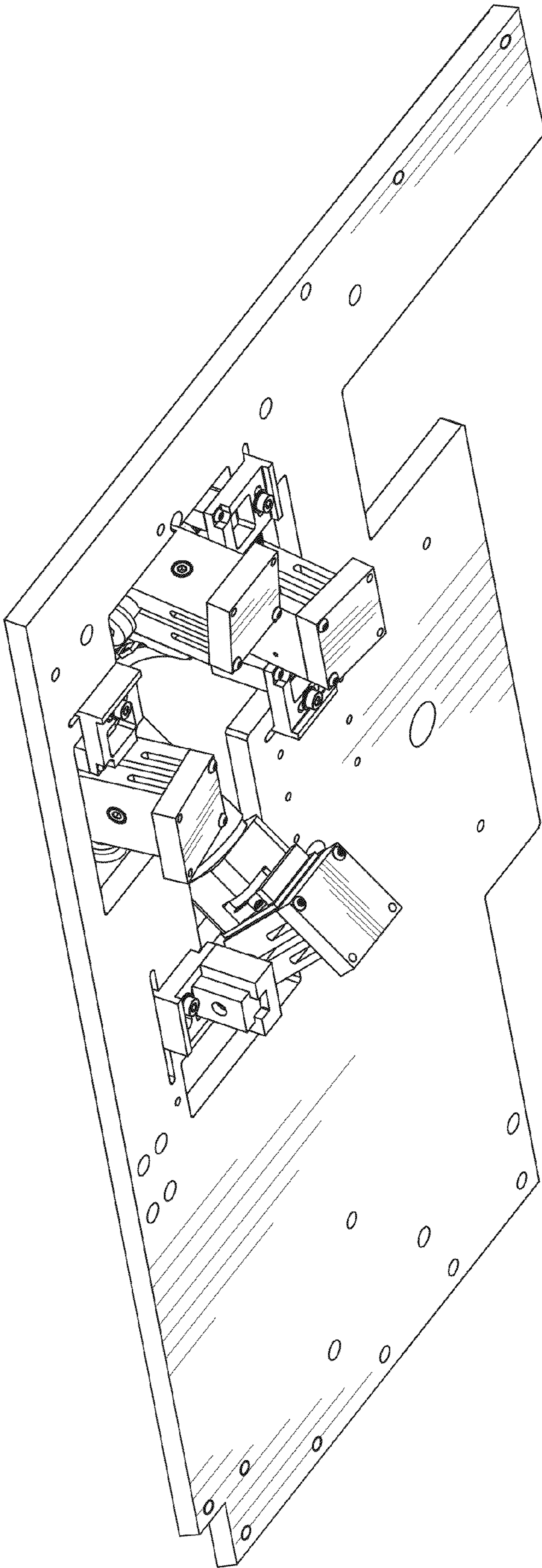

FIG.2

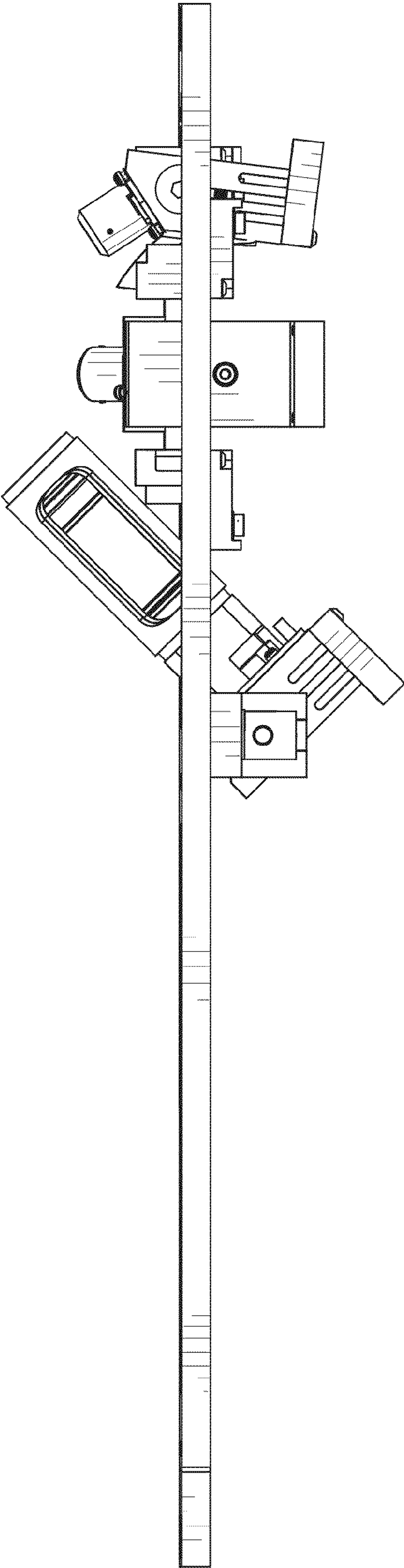

FIG.3

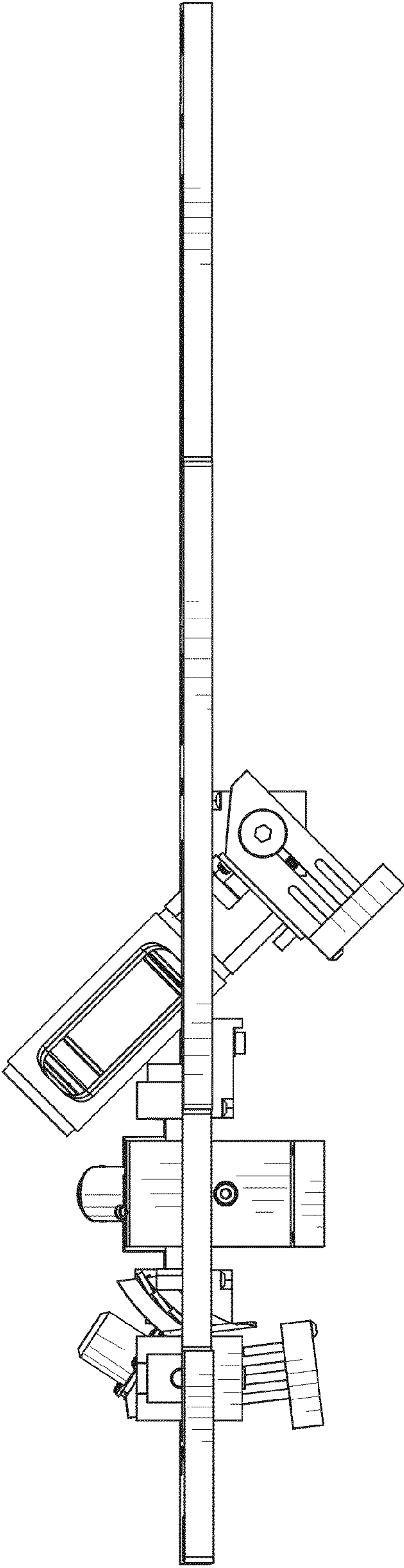

FIG.4

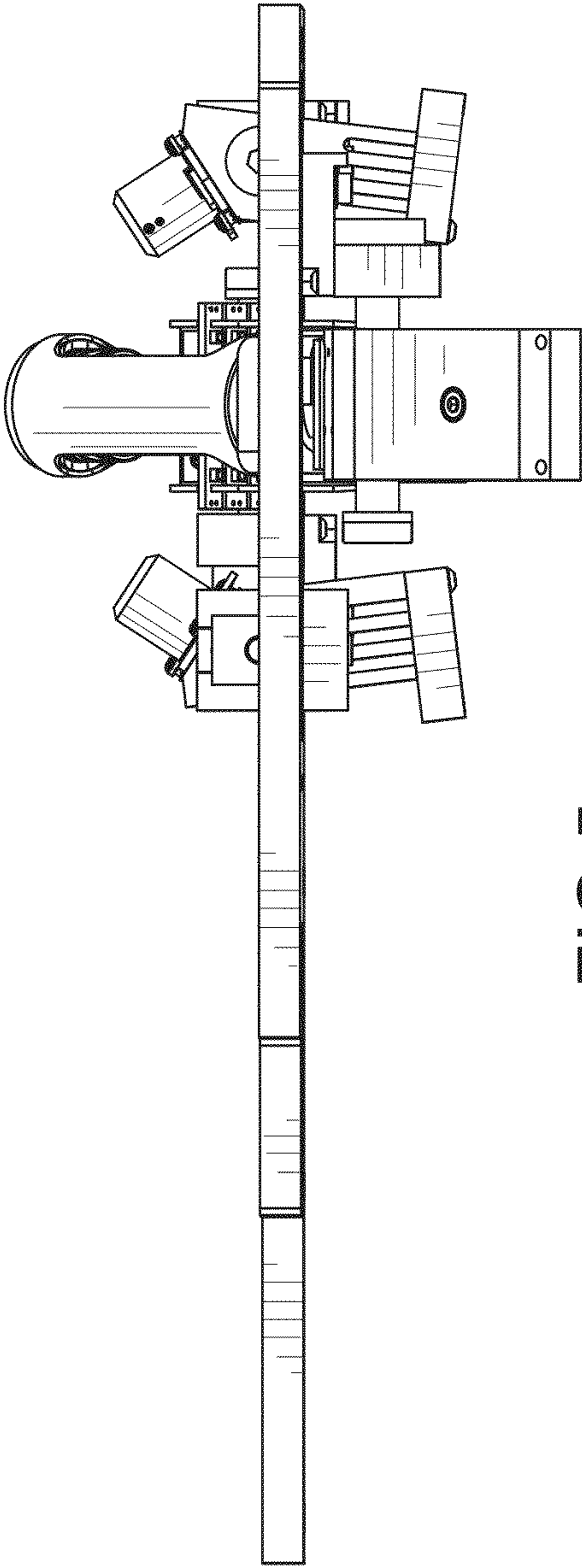

FIG.5

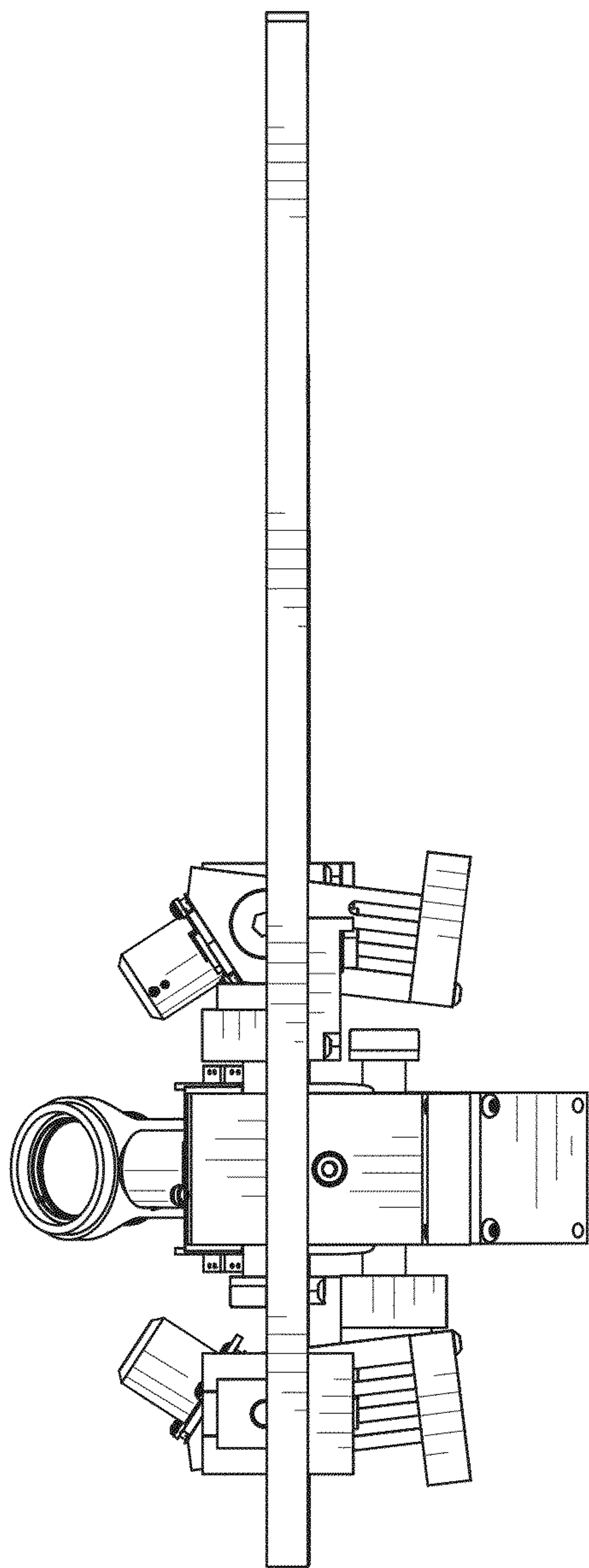

FIG.6

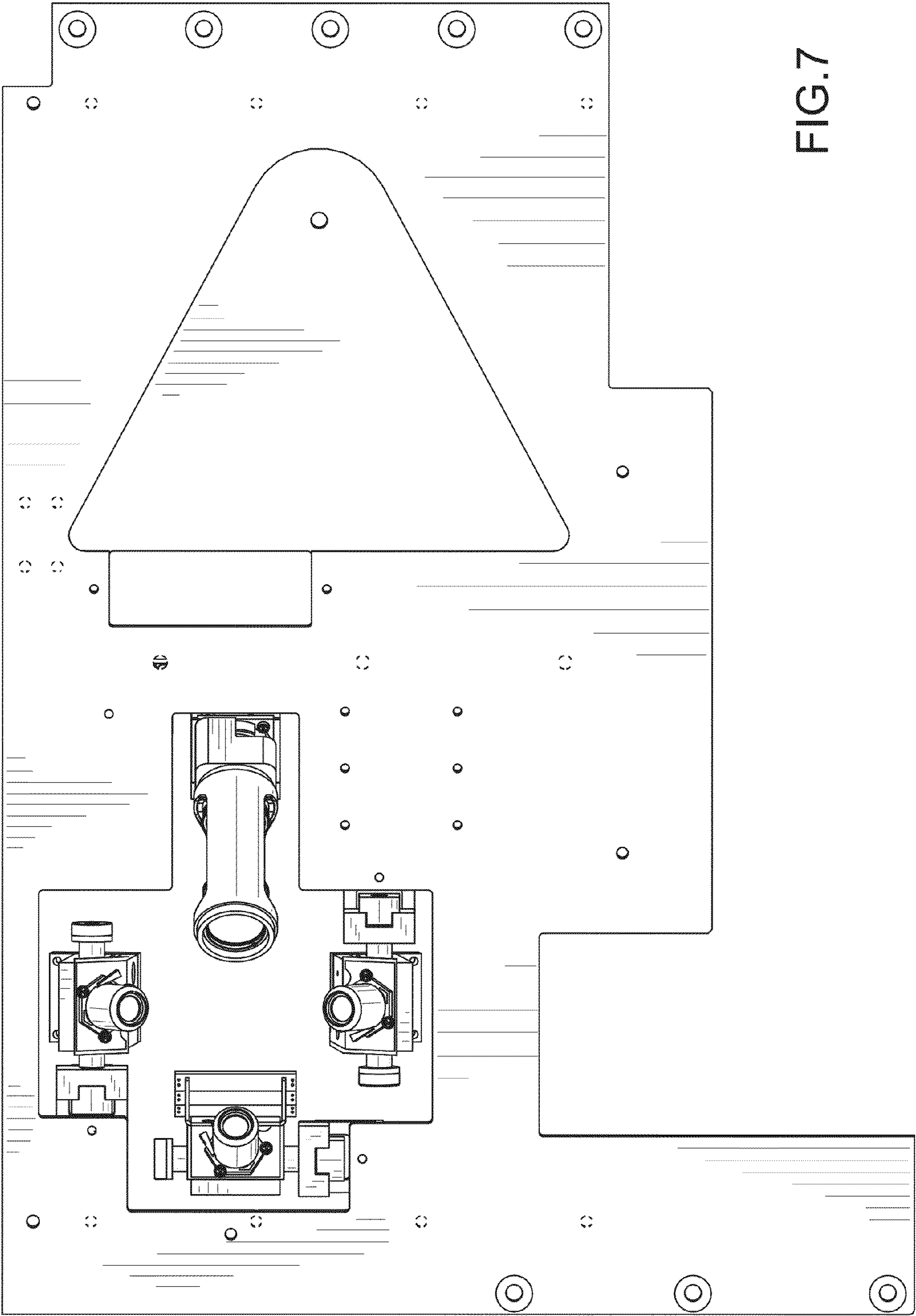

FIG. 7

FIG.8

