



US00D686224S

(12) **United States Design Patent**  
**Rodenhouse et al.**

(10) **Patent No.:** **US D686,224 S**  
(45) **Date of Patent:** **\*\* Jul. 16, 2013**

(54) **DISPLAY SCREEN WITH ANIMATED GRAPHICAL USER INTERFACE**

(75) Inventors: **Jennifer Rodenhouse**, Seattle, WA (US); **Colin Michael Riley**, Seattle, WA (US); **Brian Walker**, Seattle, WA (US); **Paula Luckenbach**, Seattle, WA (US); **Salvador Alucema**, Seattle, WA (US)

(73) Assignee: **Microsoft Corporation**, Redmond, WA (US)

(\*\*) Term: **14 Years**

(21) Appl. No.: **29/406,959**

(22) Filed: **Nov. 21, 2011**

(51) **LOC (9) Cl.** ..... **14-02**

(52) **U.S. Cl.**  
USPC ..... **D14/486**

(58) **Field of Classification Search**  
USPC ..... D14/485-495; 715/700-867  
See application file for complete search history.

(56) **References Cited**

U.S. PATENT DOCUMENTS

6,185,476	B1 *	2/2001	Sakai	700/182
6,268,854	B1 *	7/2001	Borden et al.	715/786
D513,511	S *	1/2006	Decombe	D14/486
D526,654	S *	8/2006	McDougall et al.	D14/485
D527,387	S *	8/2006	McDougall et al.	D14/485
D528,556	S *	9/2006	Decombe	D14/486
D533,182	S *	12/2006	McDougall et al.	D14/485
D545,828	S	7/2007	Vong et al.	
D546,335	S	7/2007	Vong et al.	
D546,336	S	7/2007	Vong et al.	
D573,600	S *	7/2008	Kaminaga	D14/486
D599,363	S	9/2009	Mays	
D599,364	S	9/2009	Mays	
D599,365	S	9/2009	Brown et al.	
D599,366	S	9/2009	Brown et al.	
D599,367	S	9/2009	Mays et al.	

D599,368	S	9/2009	Kanga et al.	
7,703,031	B2 *	4/2010	Nakagawa et al.	715/765
D622,730	S	8/2010	Krum et al.	
D627,361	S	11/2010	Lew et al.	
D627,363	S	11/2010	Lew	
D629,417	S	12/2010	Weir et al.	
7,898,600	B2 *	3/2011	Lee et al.	348/565
D641,372	S	7/2011	Gardner et al.	
D641,373	S	7/2011	Gardner et al.	
D643,438	S	8/2011	Gardner et al.	
D645,469	S	9/2011	Gardner et al.	
D655,719	S *	3/2012	Zaman et al.	D14/486
8,199,125	B2 *	6/2012	Misawa et al.	345/173
D666,209	S *	8/2012	Cranfill	D14/486
D667,417	S *	9/2012	Long et al.	D14/486

\* cited by examiner

*Primary Examiner* — Deanna L Fluegeman

(74) *Attorney, Agent, or Firm* — Banner & Witcoff, Ltd.

(57) **CLAIM**

The ornamental design for a display screen with animated graphical user interface, as shown and described.

**DESCRIPTION**

FIG. 1 is a front view of a display screen with animated graphical user interface showing the new design; and FIG. 2 is the second image thereof; FIG. 3 is the third image thereof; FIG. 4 is the fourth image thereof; FIG. 5 is the fifth image thereof; FIG. 6 is the sixth image thereof; and, FIG. 7 is the seventh image thereof.

The appearance of the transitional image sequentially transitions between the images shown in FIGS. 1-7. The process or period in which one image transitions to another image forms no part of the claimed design.

The broken line showing of the rectangle, squares, and the remainder of the display screen is for environmental purposes only and forms no part of the claimed design.

**1 Claim, 7 Drawing Sheets**

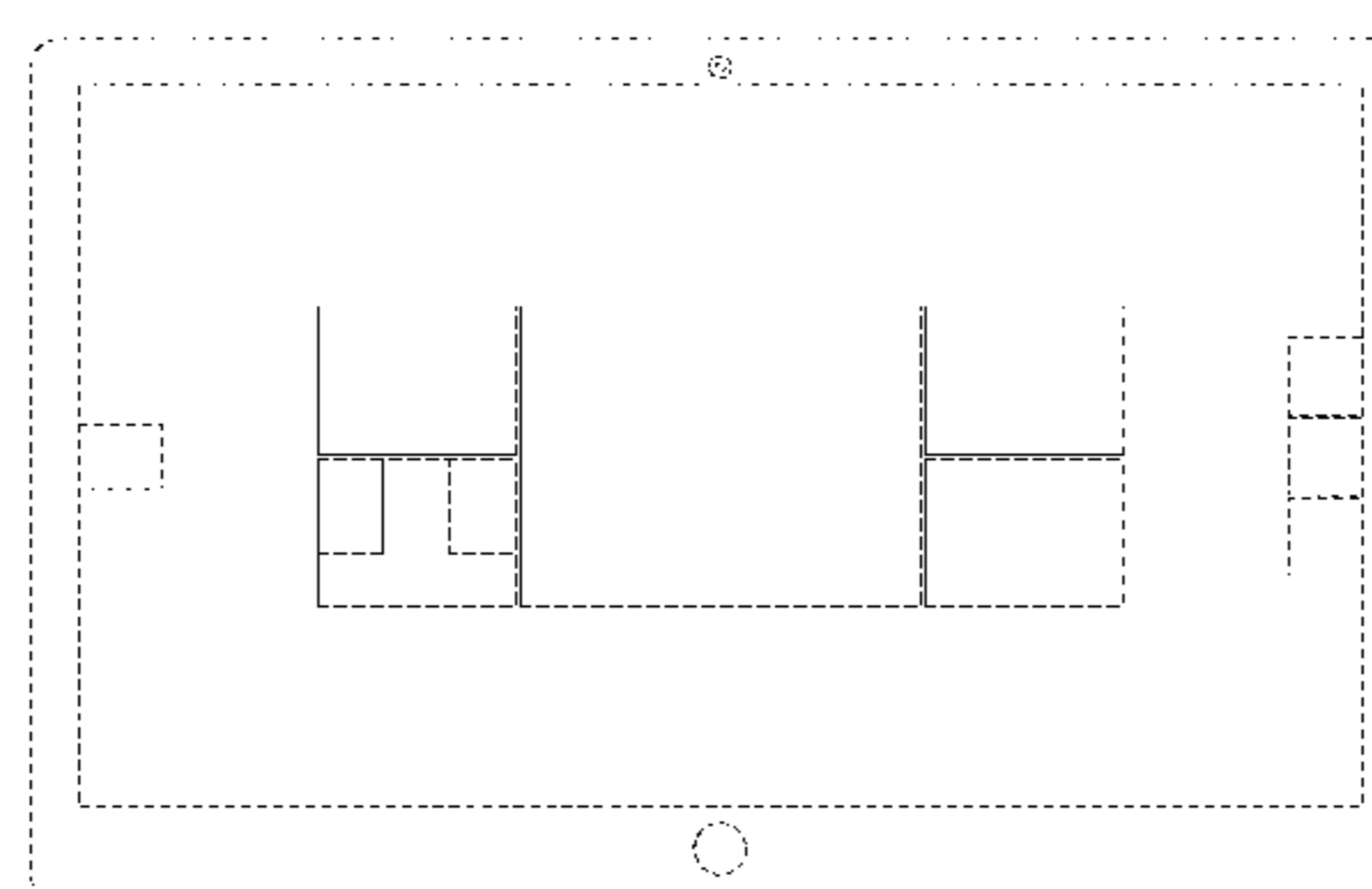
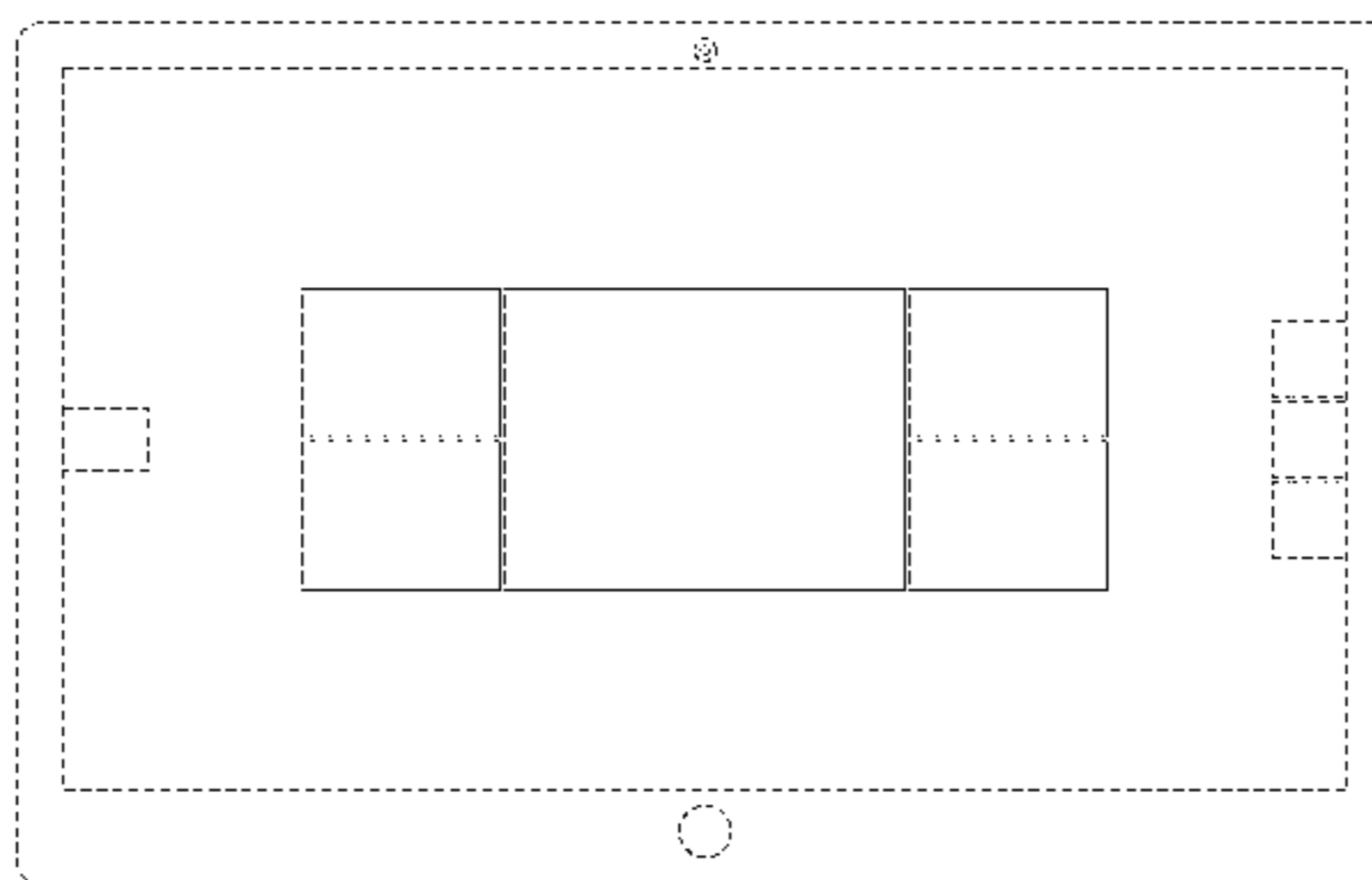

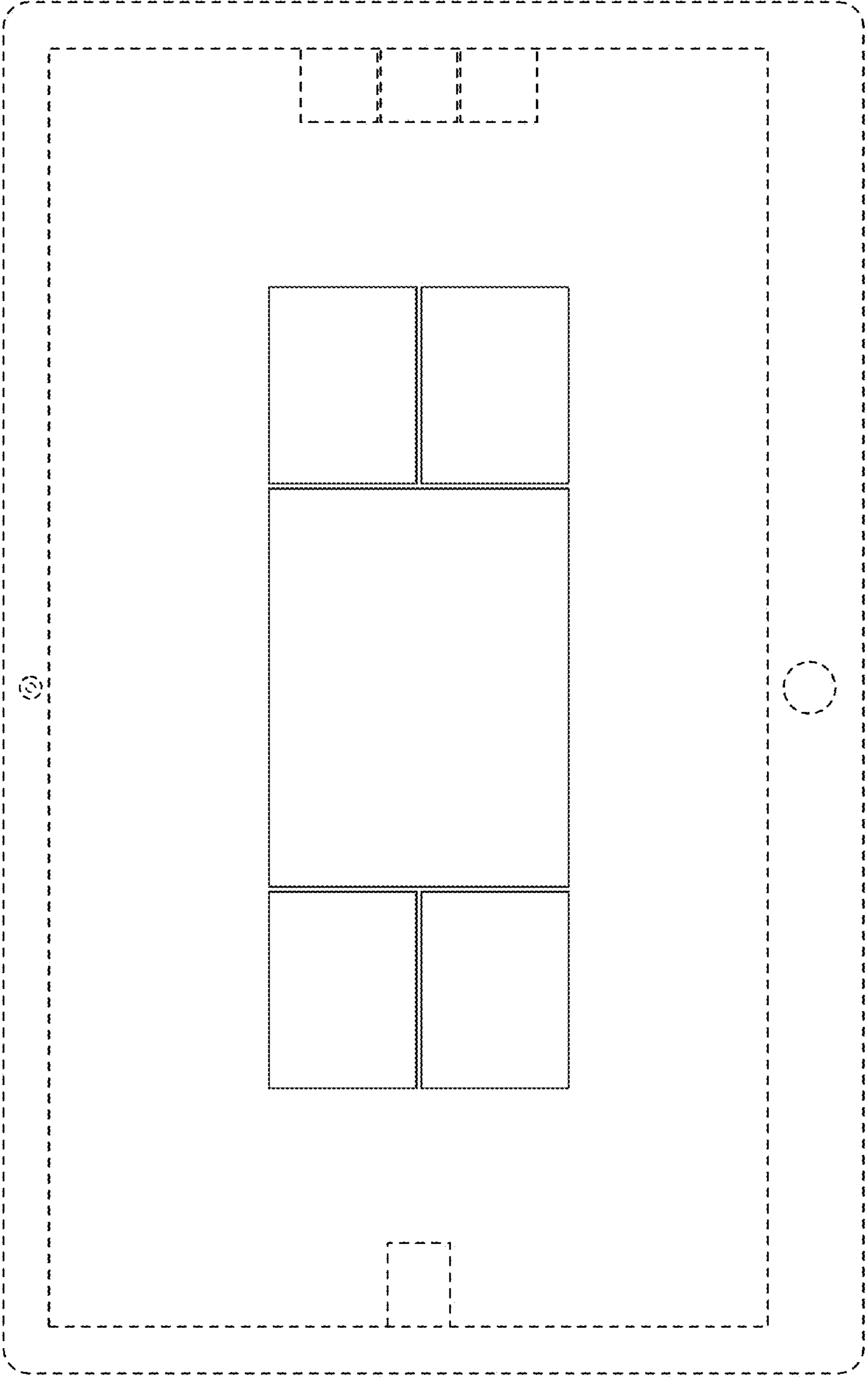

FIG. 1

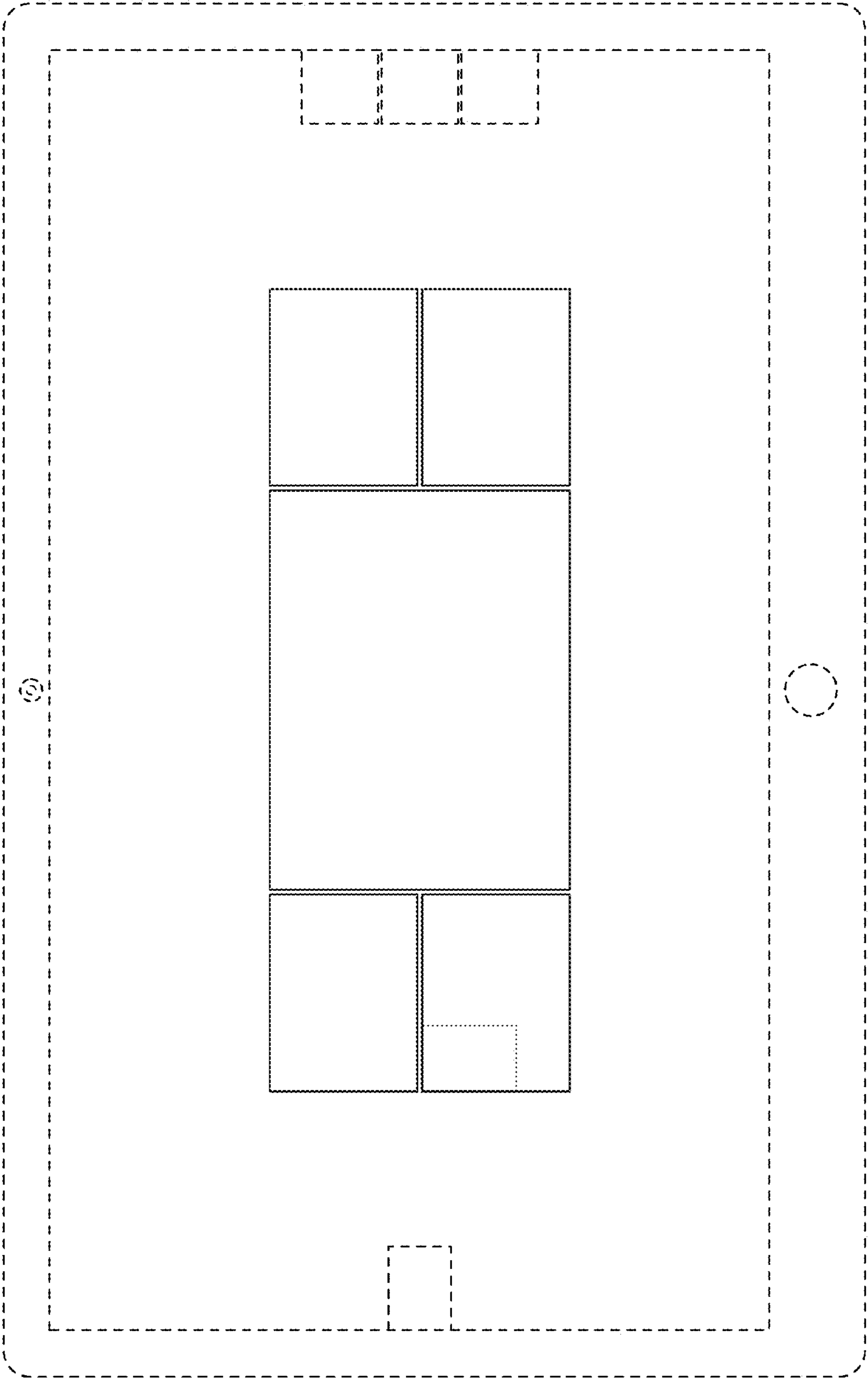

FIG. 2

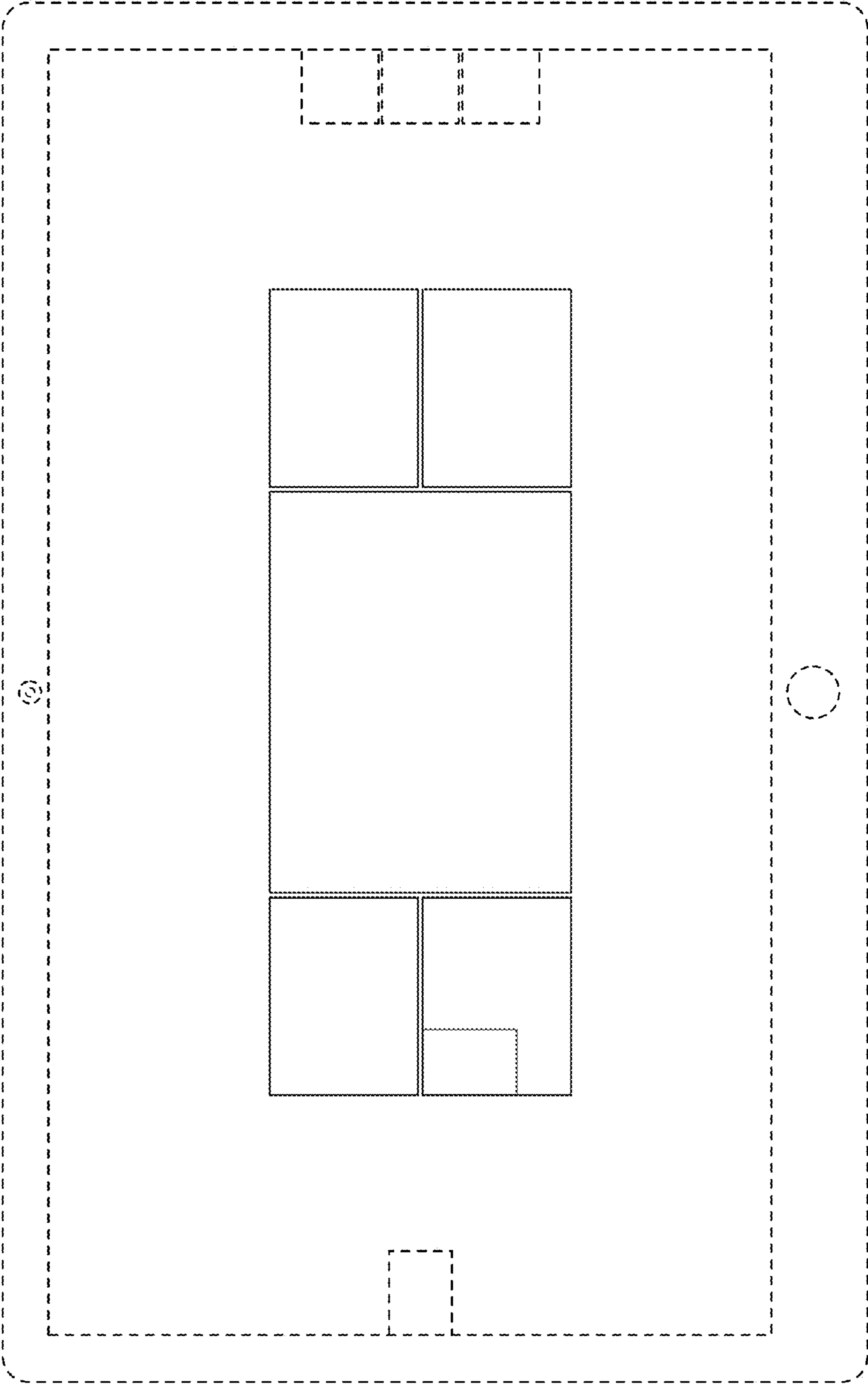

FIG. 3

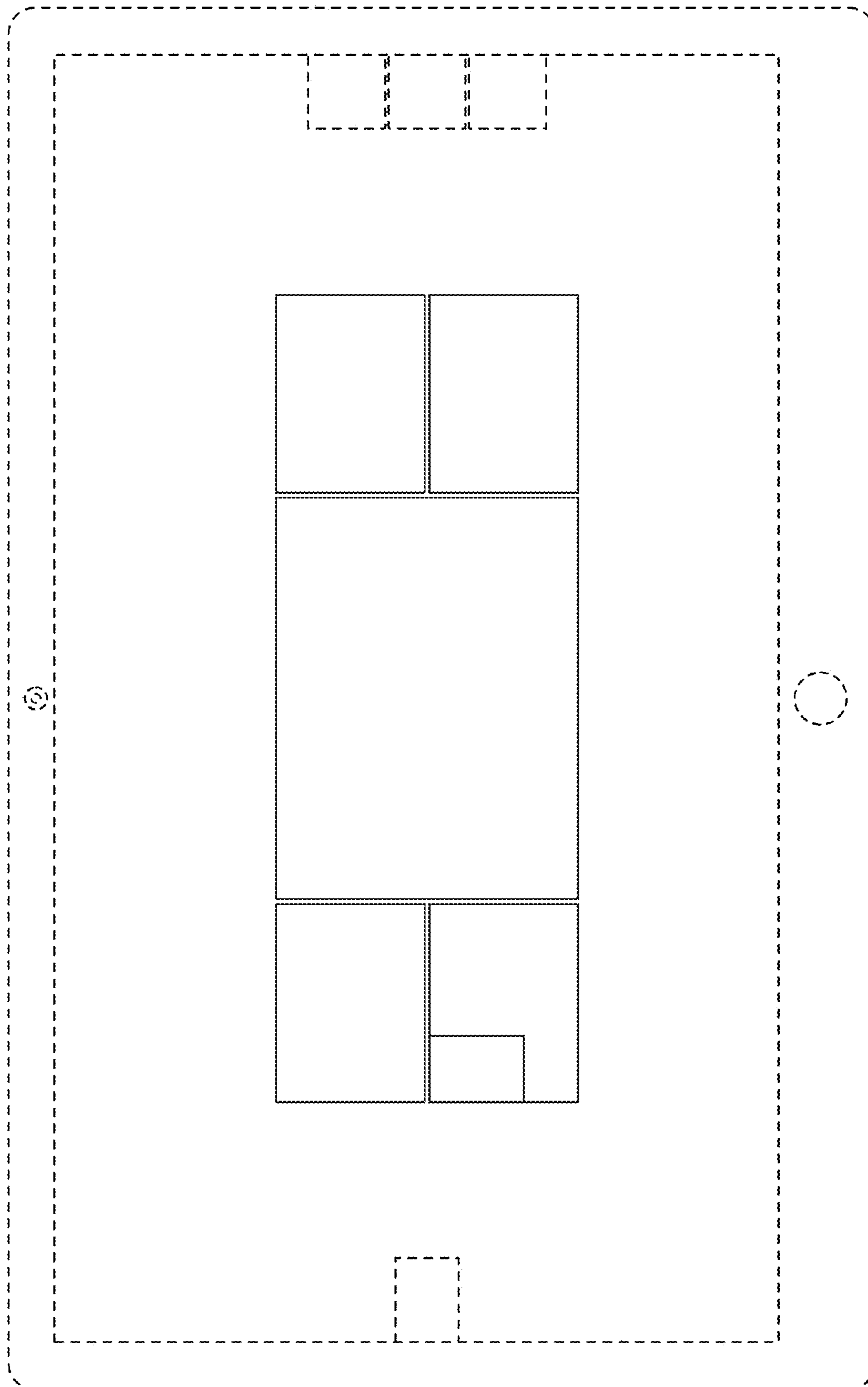

FIG. 4

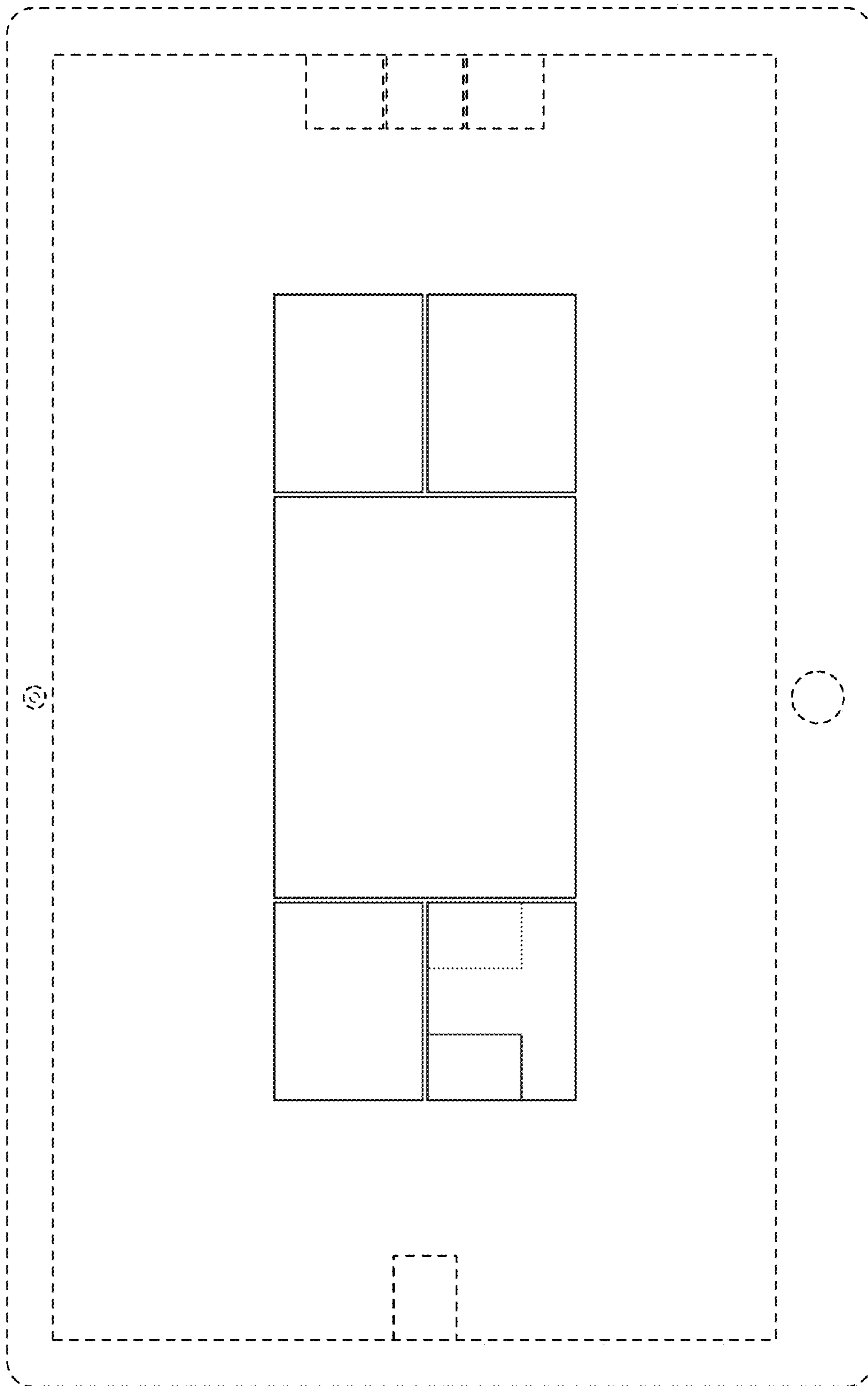

FIG. 5

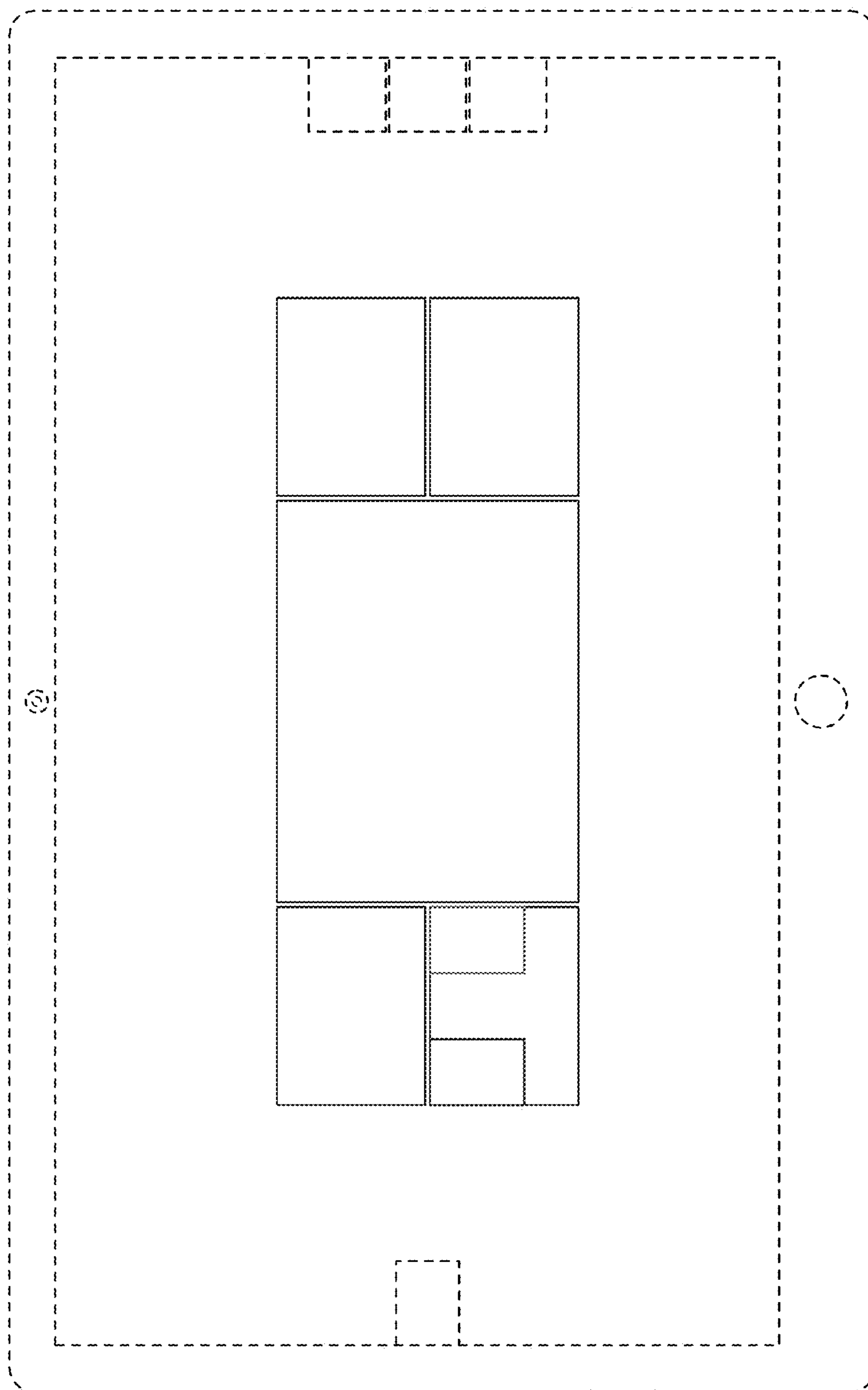

FIG. 6

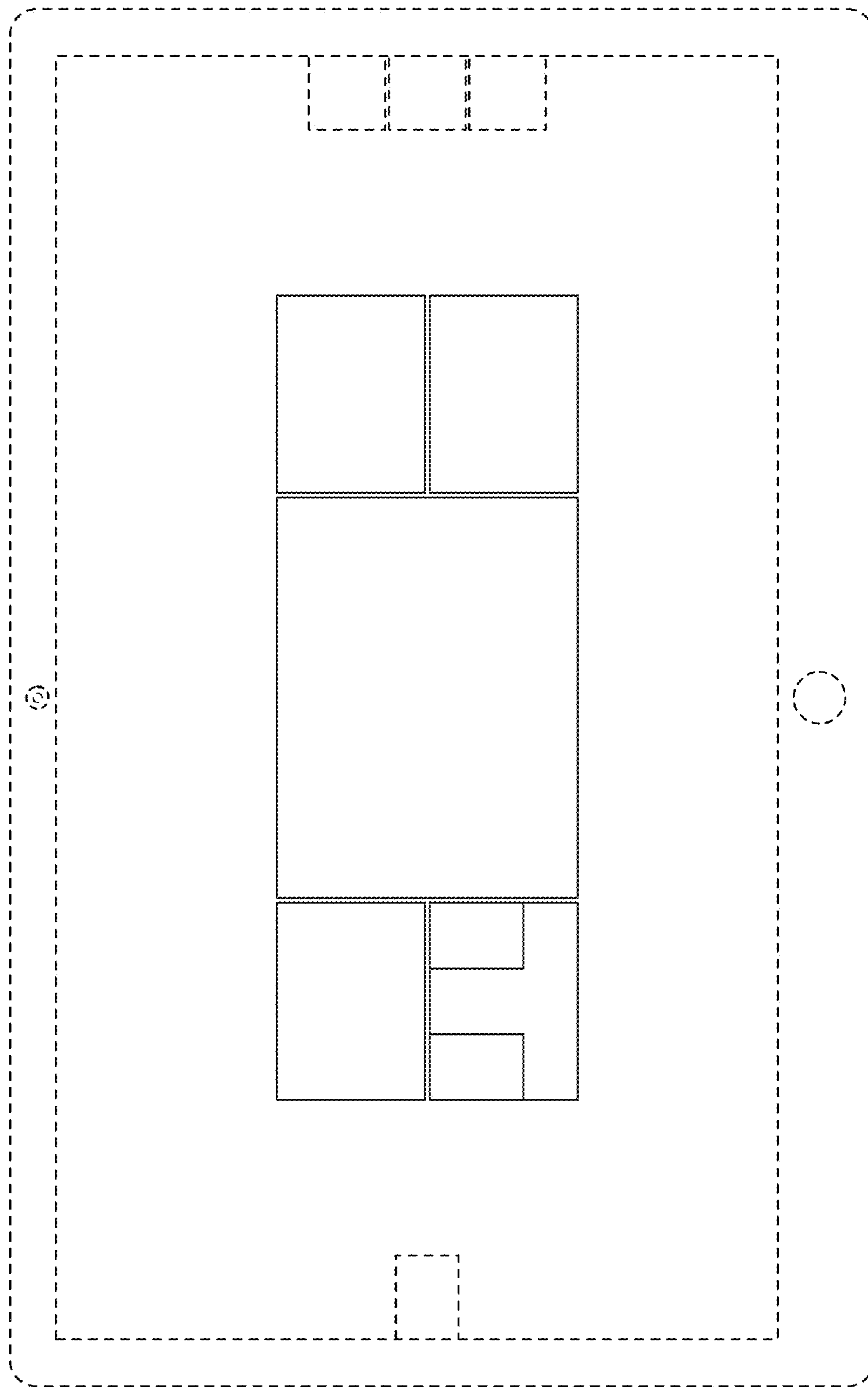

FIG. 7