



US00D685324S

(12) **United States Design Patent**  
**Deck et al.**

(10) **Patent No.:** **US D685,324 S**  
(45) **Date of Patent:** **\*\* Jul. 2, 2013**

(54) **REMOTE INPUT OUTPUT POWER SUPPLY MODULE**

(75) Inventors: **Bernhard Deck**, Weilheim (DE); **Vijay Shah**, Vadodara (IN)

(73) Assignee: **ABB Technology Ltd**, Zurich (CH)

(\*\*) Term: **14 Years**

(21) Appl. No.: **29/407,623**

(22) Filed: **Nov. 30, 2011**

(30) **Foreign Application Priority Data**

Jun. 10, 2011 (IN) ..... 237211

(51) **LOC (9) Cl.** ..... **13-02**

(52) **U.S. Cl.**  
USPC ..... **D13/110; D14/240**

(58) **Field of Classification Search**  
USPC ..... D14/240, 242, 357, 358, 140-140.9,  
D14/155, 137, 139, 243, 348, 349, 351, 354,  
D14/355; D13/110, 184; 375/222; 455/557;  
725/111

See application file for complete search history.

(56) **References Cited**

**U.S. PATENT DOCUMENTS**

D326,267 S \* 5/1992 Weiser et al. .... D14/243  
D352,505 S \* 11/1994 Pullman et al. .... D14/140.4  
5,483,229 A \* 1/1996 Tamura et al. .... 340/691.7  
D371,134 S \* 6/1996 Brosowske et al. .... D14/140.2  
D372,247 S \* 7/1996 Beaumont ..... D14/140.3  
5,544,222 A \* 8/1996 Robinson et al. .... 455/557

5,737,397 A \* 4/1998 Skinner et al. .... 379/93.29  
D465,782 S \* 11/2002 Johnsen et al. .... D14/140.4  
D466,111 S \* 11/2002 Johnsen ..... D14/140.4  
D529,892 S \* 10/2006 Weidinger ..... D14/140.1  
D622,672 S \* 8/2010 Wu et al. .... D13/162  
2011/0170579 A1\* 7/2011 Halverson et al. .... 375/222

\* cited by examiner

*Primary Examiner* — Bridget L Eland

(74) *Attorney, Agent, or Firm* — Buchanan Ingersoll & Rooney PC

(57) **CLAIM**

The ornamental design for a remote input output power supply module, as shown and described.

**DESCRIPTION**

FIG. 1 is a right side perspective view of a remote input output power supply module according to our new design.

FIG. 2 is a left perspective view thereof.

FIG. 3 is a front perspective view thereof.

FIG. 4 is a rear perspective view thereof.

FIG. 5 is a top perspective view thereof.

FIG. 6 is a bottom perspective view thereof.

FIG. 7 is a front elevational view thereof.

FIG. 8 is a rear elevational view thereof.

FIG. 9 is a top plan view thereof.

FIG. 10 is a bottom plan view thereof.

FIG. 11 is a left side elevational view thereof; and,

FIG. 12 is a right side elevational view thereof.

The wireframe lines shown throughout the views are intended to indicate surface contour and are not intended to be surface ornamentation.

**1 Claim, 12 Drawing Sheets**

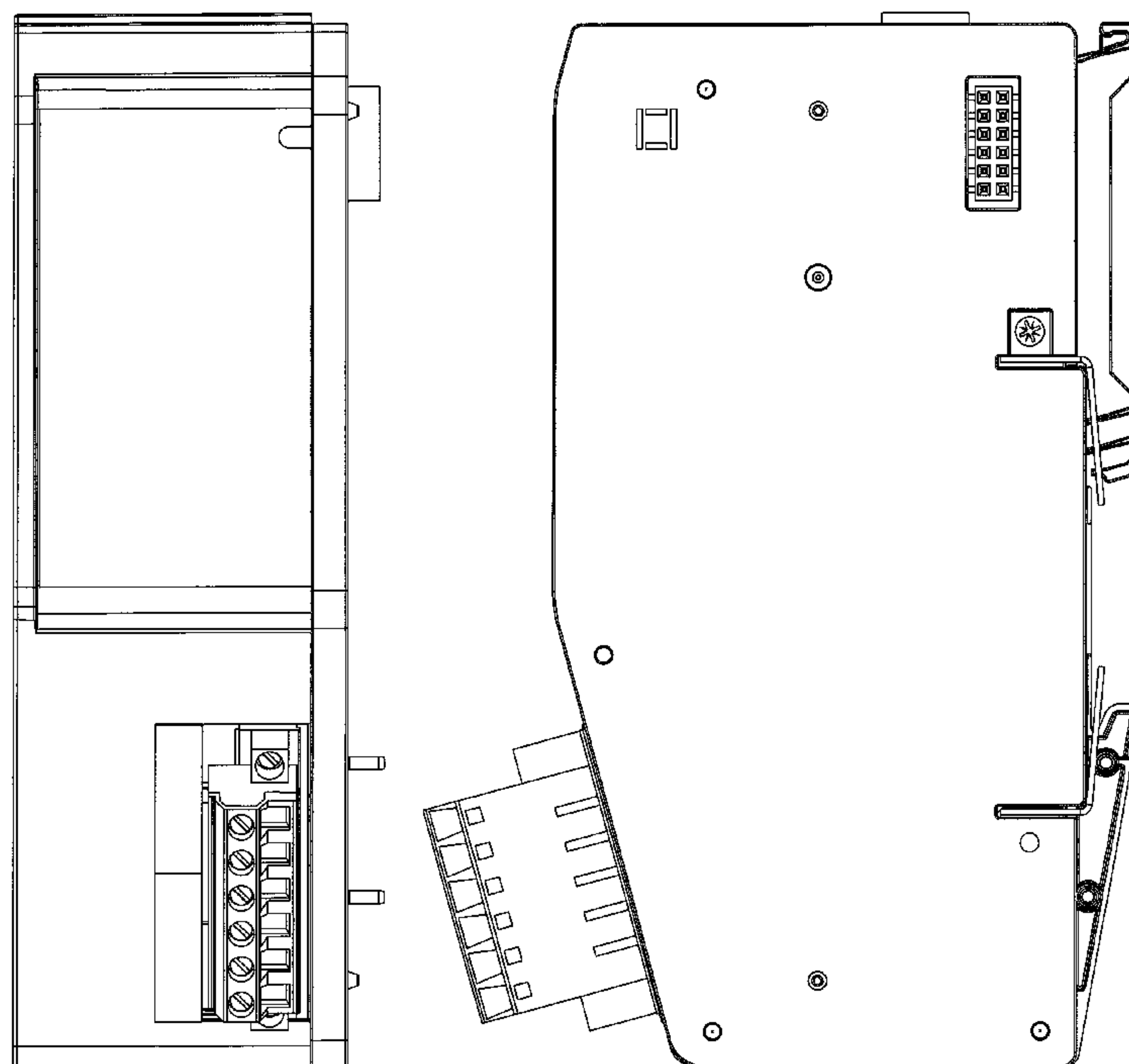

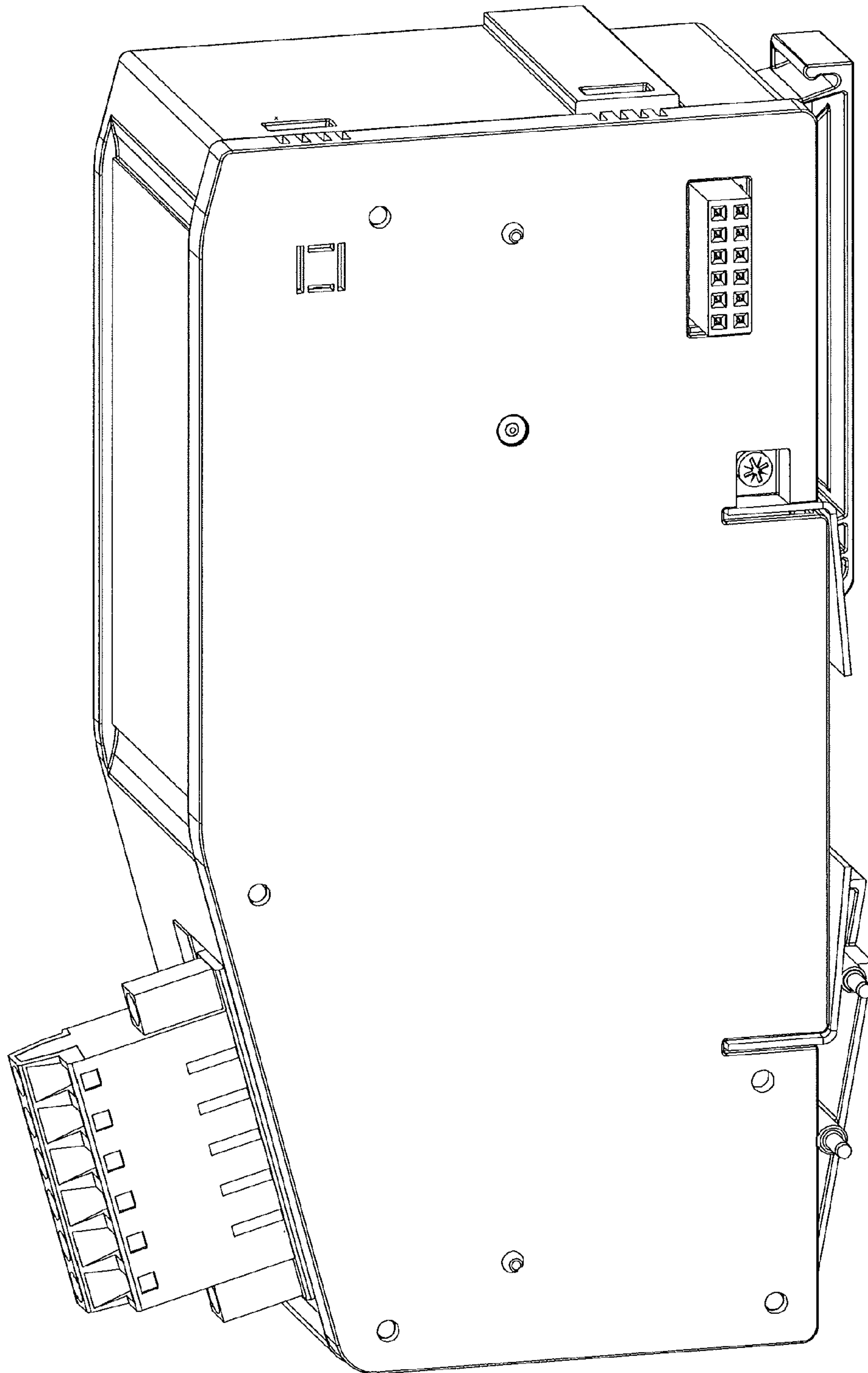

FIG. 1

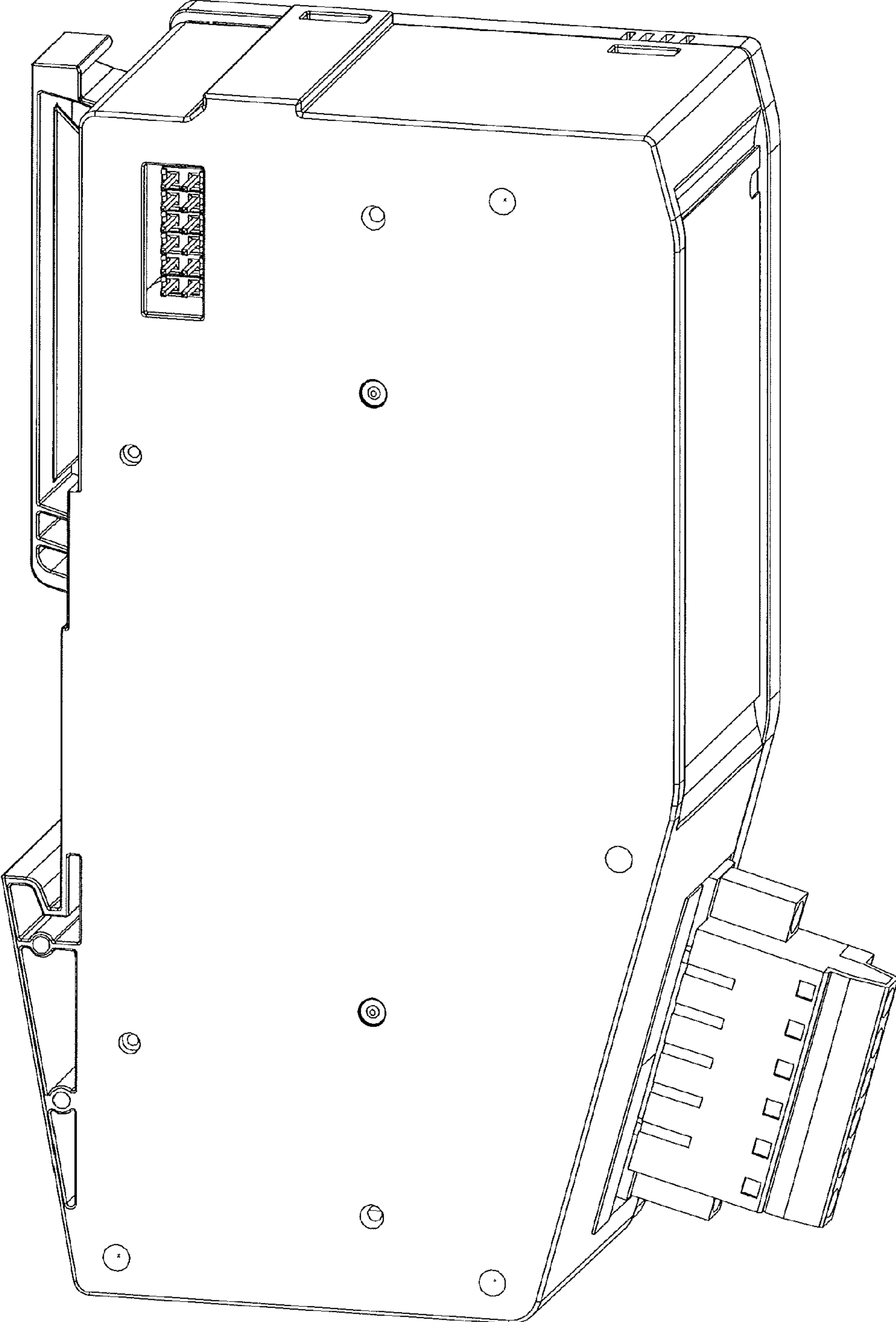

FIG. 2

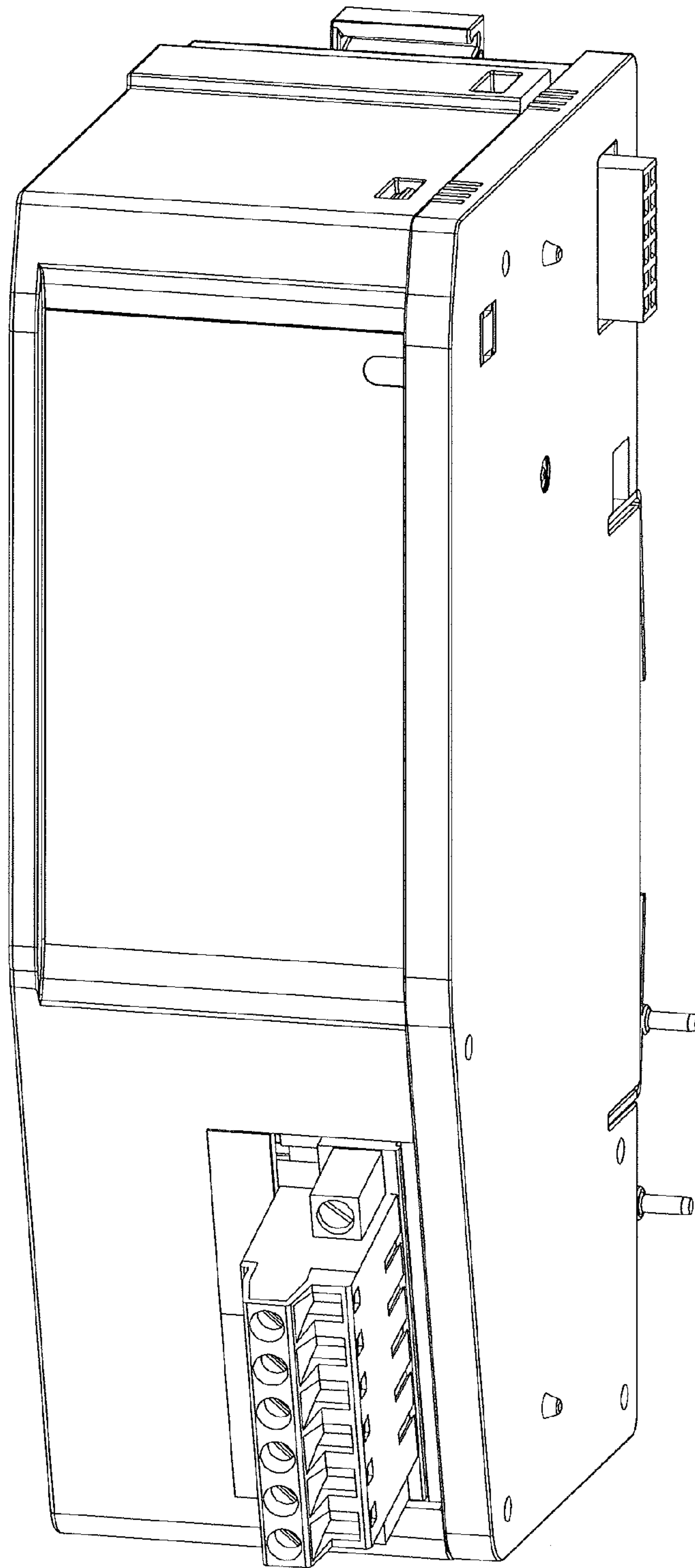

FIG. 3

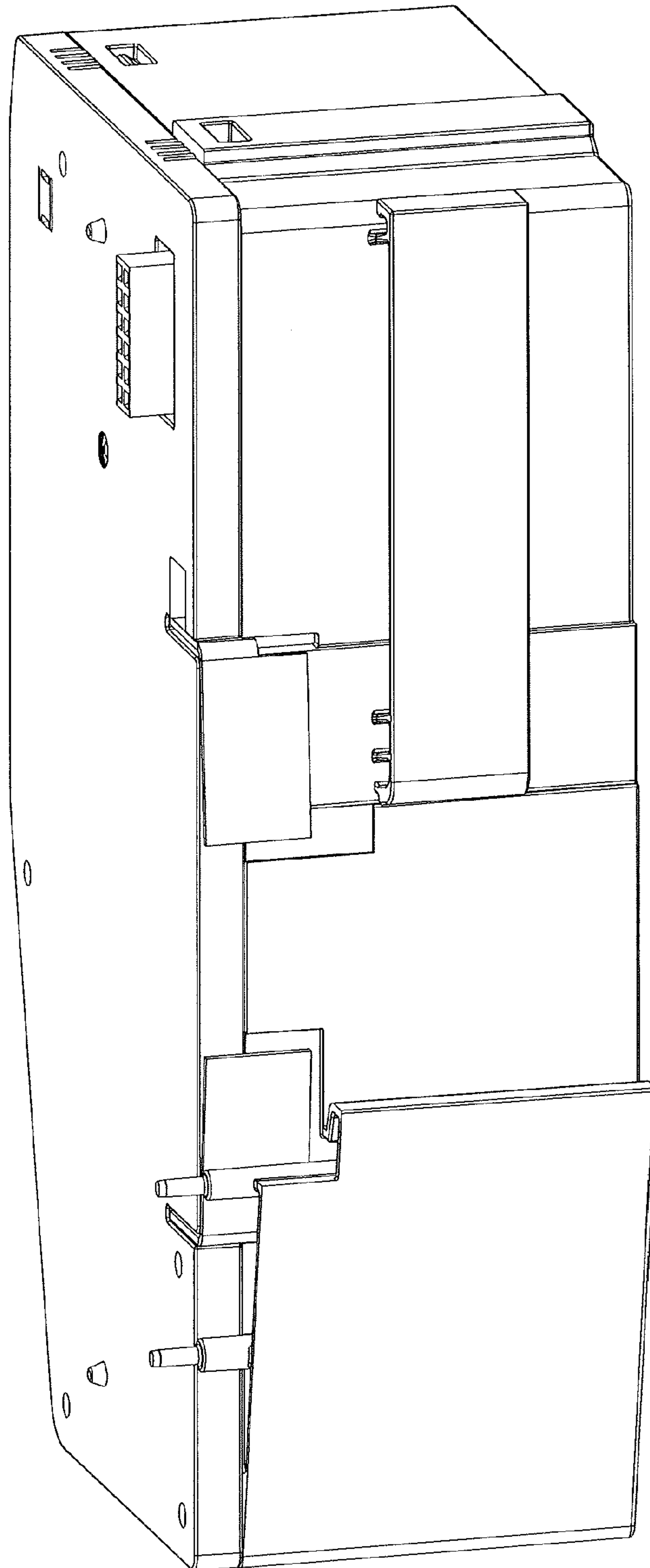

FIG. 4



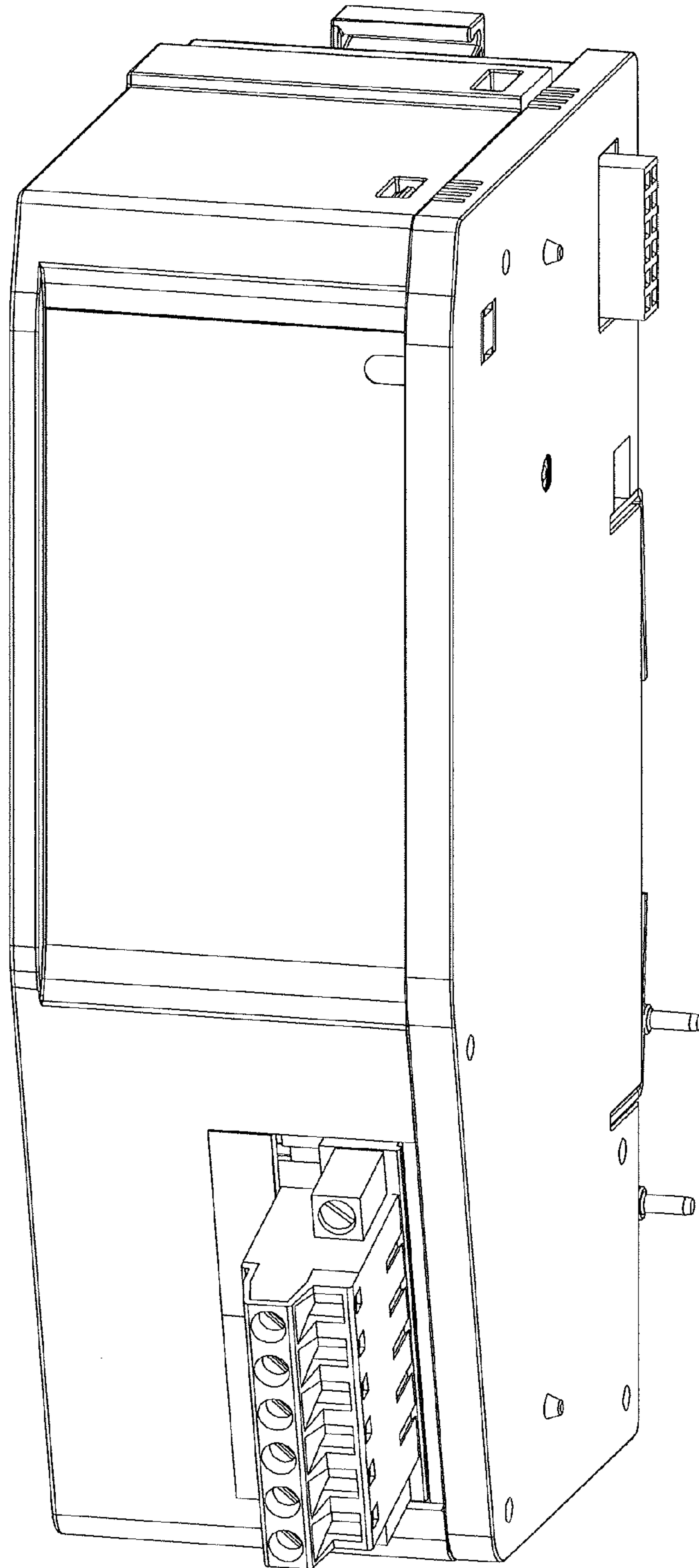

FIG. 5

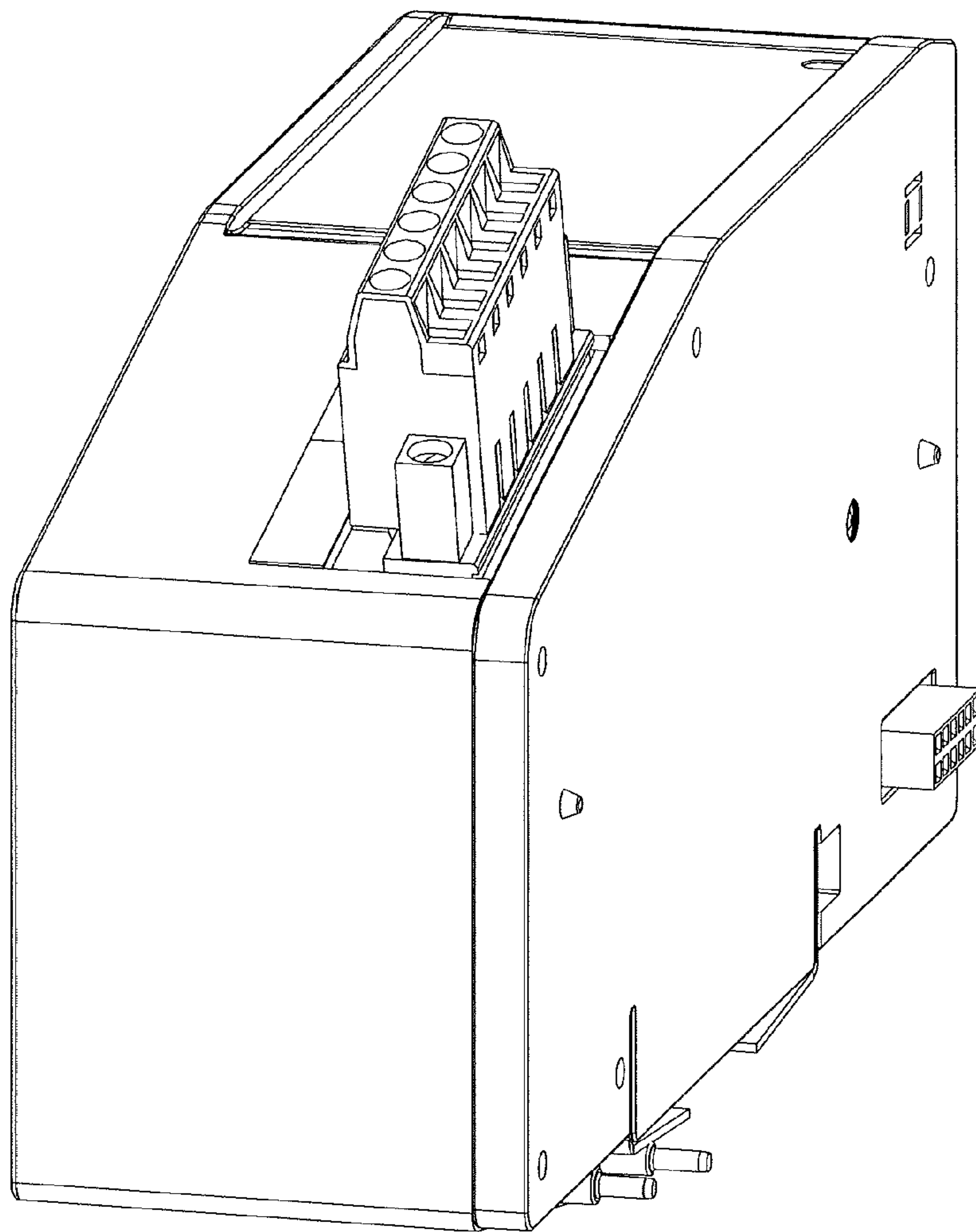

FIG. 6

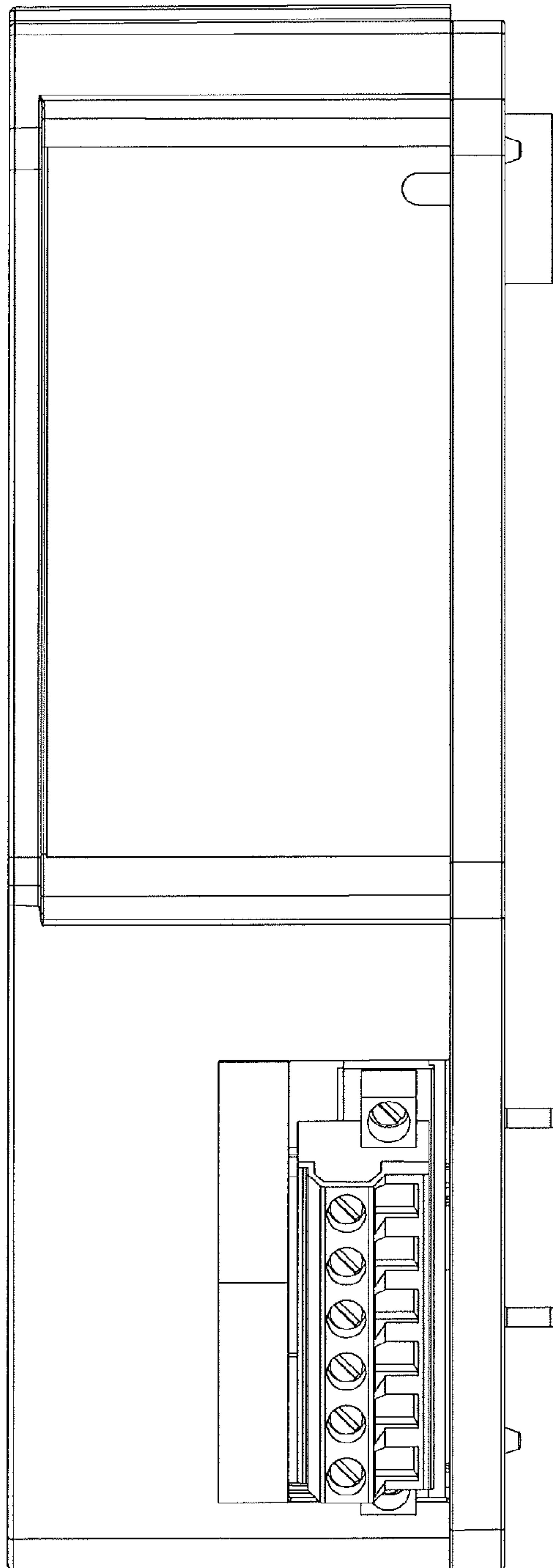

FIG. 7



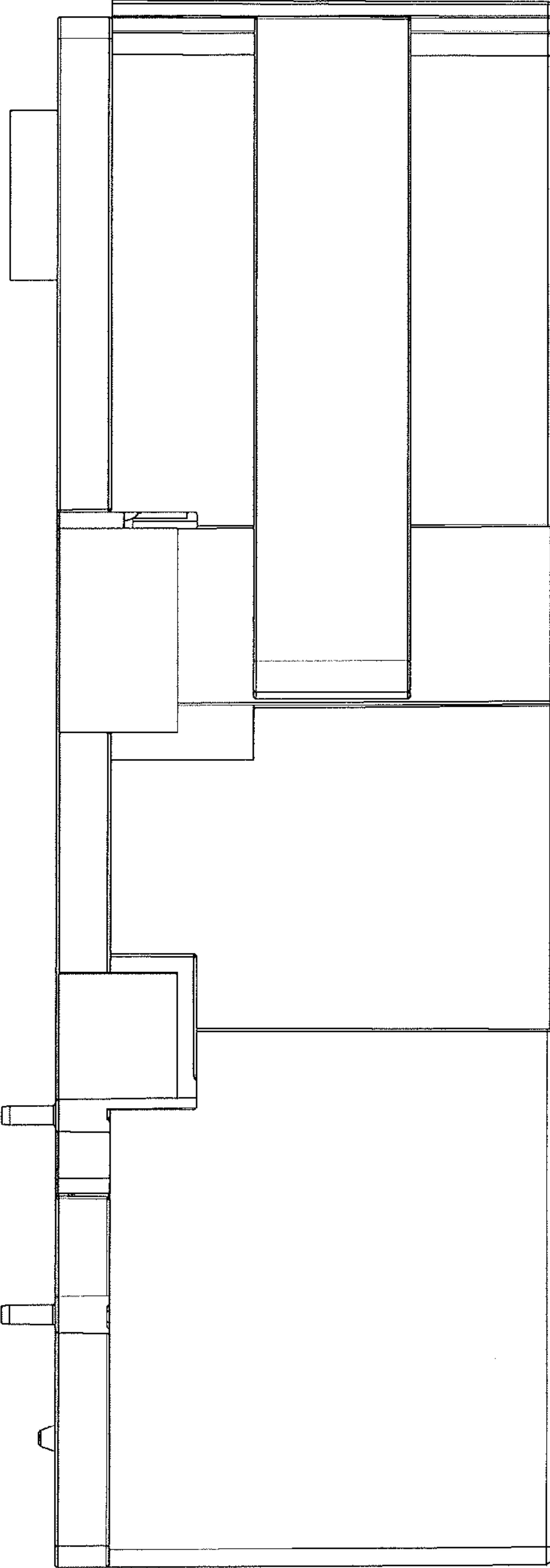

FIG. 8

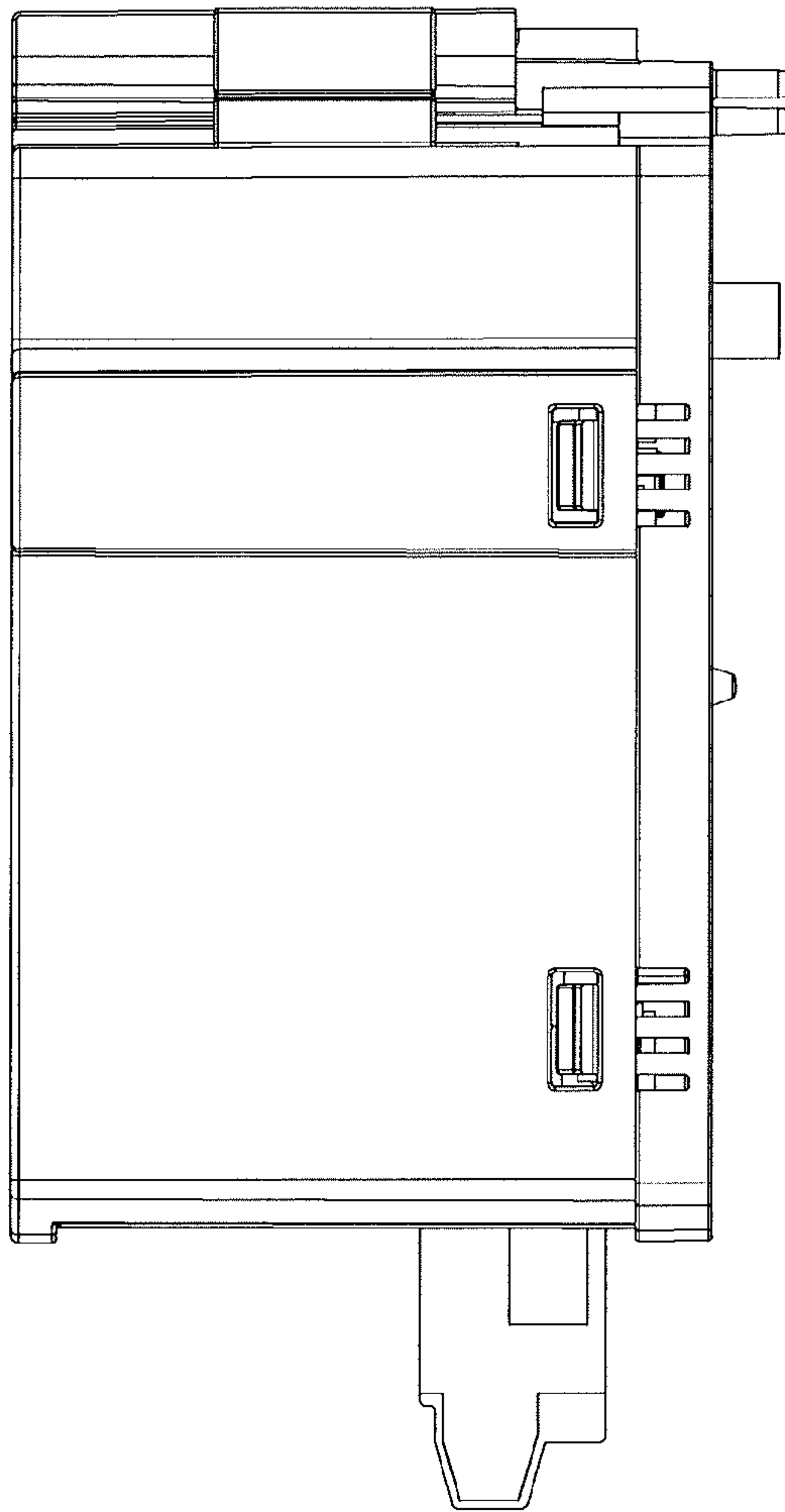

FIG. 9

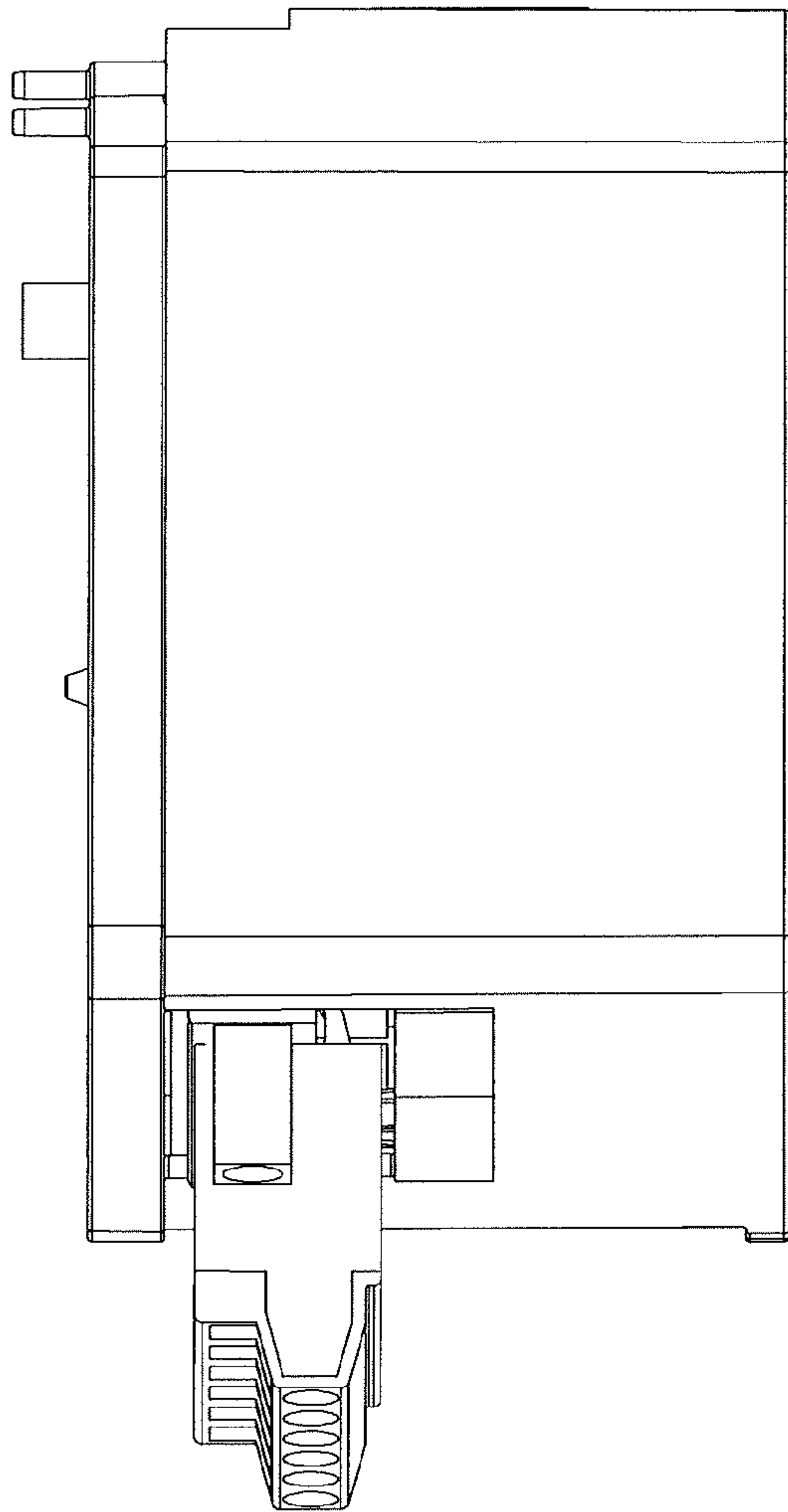

FIG. 10

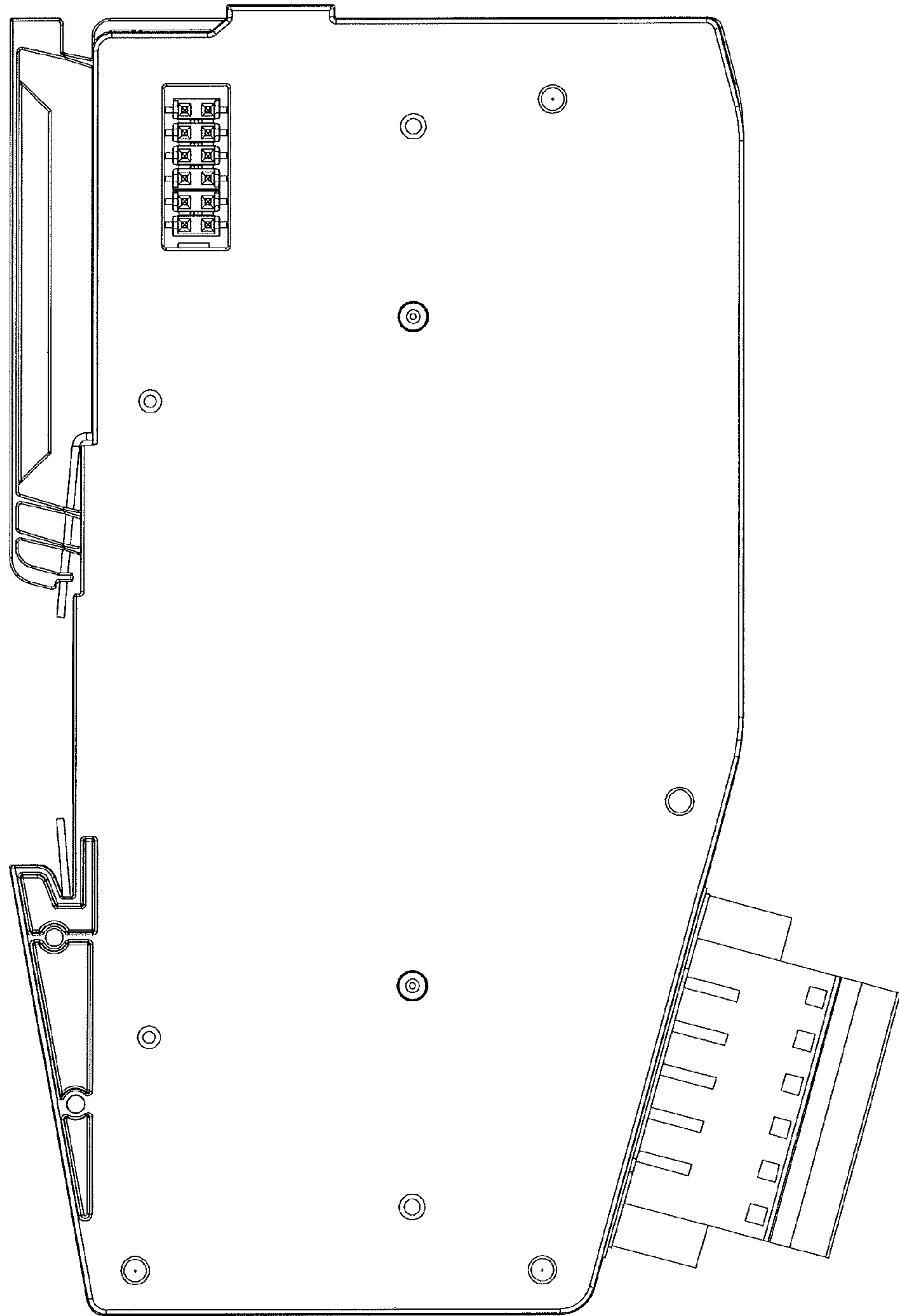

FIG. 11

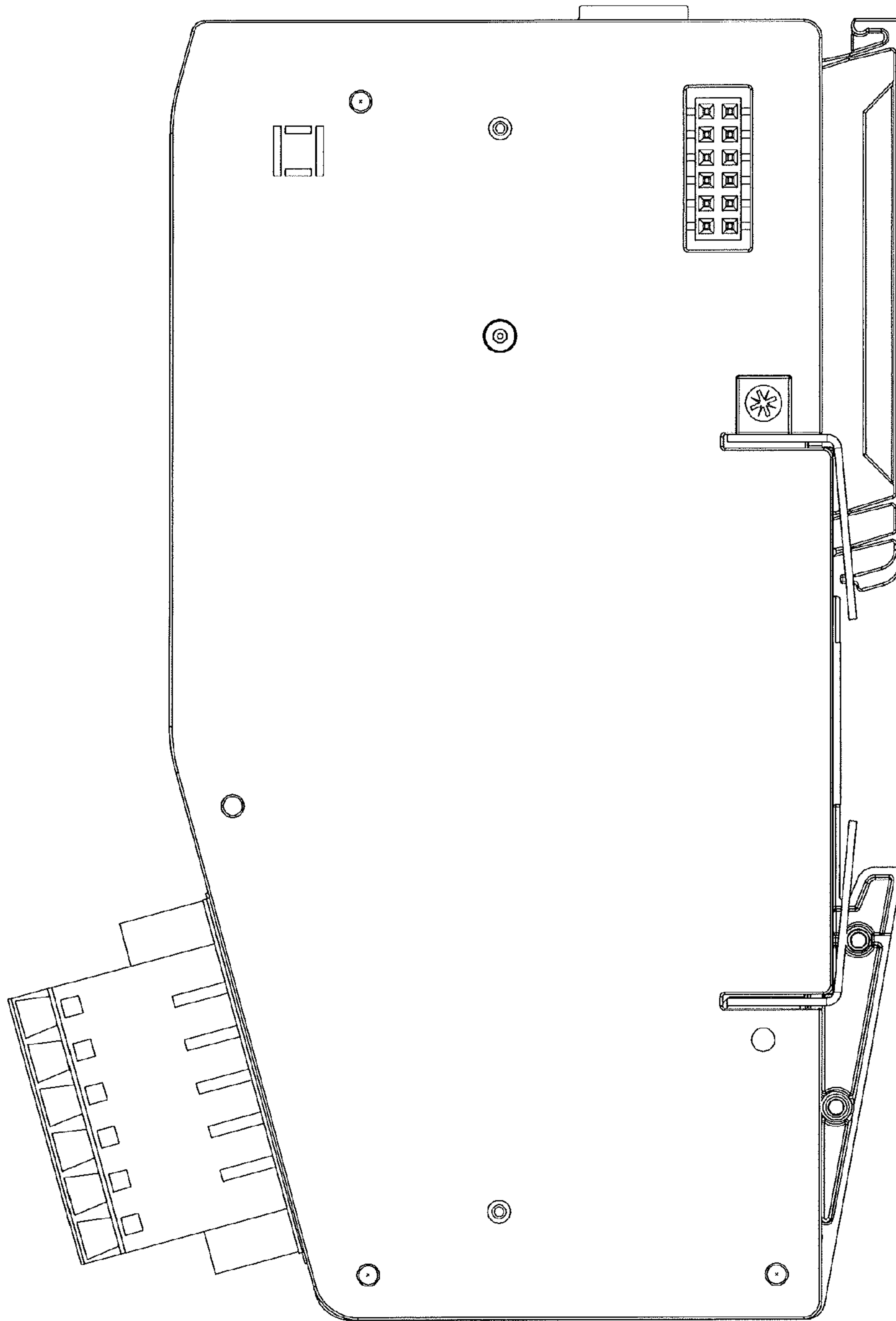

FIG. 12