



US00D685305S

(12) **United States Design Patent**  
**Tase et al.**

(10) **Patent No.:** **US D685,305 S**  
(45) **Date of Patent:** **\*\* Jul. 2, 2013**

(54) **FRONT FENDER FOR AUTOMOBILE**

D669,829 S \* 10/2012 Iwao et al. .... D12/184  
D671,871 S \* 12/2012 Ohkoshi ..... D12/184  
D672,295 S \* 12/2012 Yamada et al. .... D12/184

(75) Inventors: **Nobutaka Tase**, Kanagawa (JP);  
**Kazunori Murabayashi**, Tokyo (JP)

**FOREIGN PATENT DOCUMENTS**

(73) Assignee: **Nissan Motor Co., Ltd.**, Yokohama (JP)

EM 001226856-0005 9/2010  
JP D1297374 S 4/2007  
JP D1297371 S 3/2008

(\*\*) Term: **14 Years**

\* cited by examiner

(21) Appl. No.: **29/415,971**

*Primary Examiner* — Melody Brown

(22) Filed: **Mar. 16, 2012**

(74) *Attorney, Agent, or Firm* — Global IP Counselors, LLP

(30) **Foreign Application Priority Data**

Feb. 3, 2012 (JP) ..... 2012-002252

(51) **LOC (9) Cl.** ..... **12-16**

(52) **U.S. Cl.**  
USPC ..... **D12/184**

(58) **Field of Classification Search**  
USPC ..... D12/184, 196, 90-92, 181; 280/152.1,  
280/847-849, 851; 296/181.1, 181.5  
See application file for complete search history.

(57) **CLAIM**

The ornamental design for a front fender for an automobile, as shown and described.

(56) **References Cited**

**DESCRIPTION**

**U.S. PATENT DOCUMENTS**

D557,177 S 12/2007 Endo et al.  
D607,798 S \* 1/2010 Weil ..... D12/184  
D620,407 S \* 7/2010 Froehlich ..... D12/184  
D629,344 S \* 12/2010 Komuro ..... D12/181  
D659,616 S \* 5/2012 Matsumoto et al. .... D12/184

FIG. 1 is a front elevational view of a front bumper for an automobile showing our new design;  
FIG. 2 is a rear elevational view thereof;  
FIG. 3 is a top plan view thereof;  
FIG. 4 is a bottom plan view thereof;  
FIG. 5 is a right side elevational view thereof;  
FIG. 6 is a left side elevational view thereof;  
FIG. 7 is a left, front perspective view thereof; and,  
FIG. 8 is a right, front perspective view thereof.

**1 Claim, 8 Drawing Sheets**

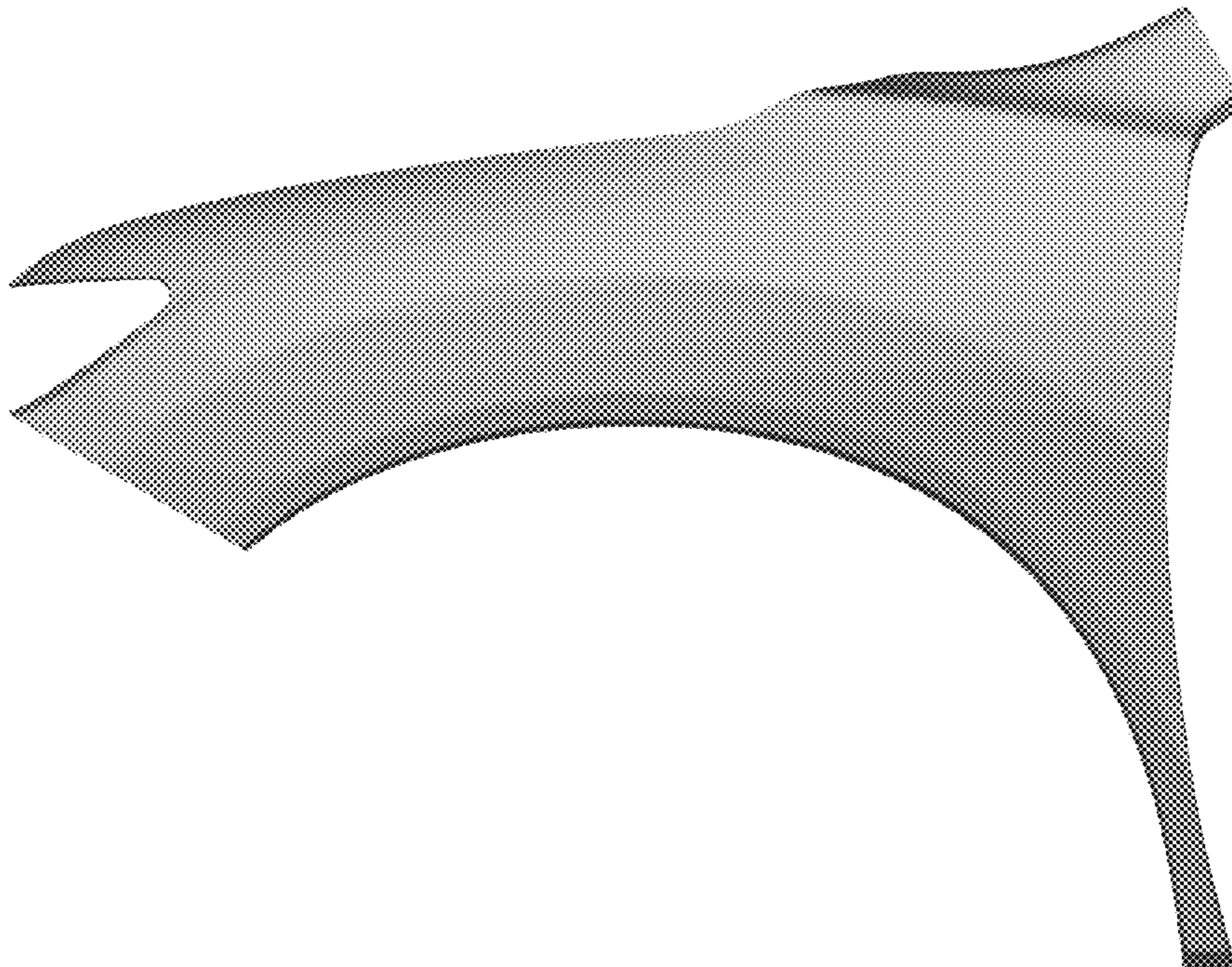

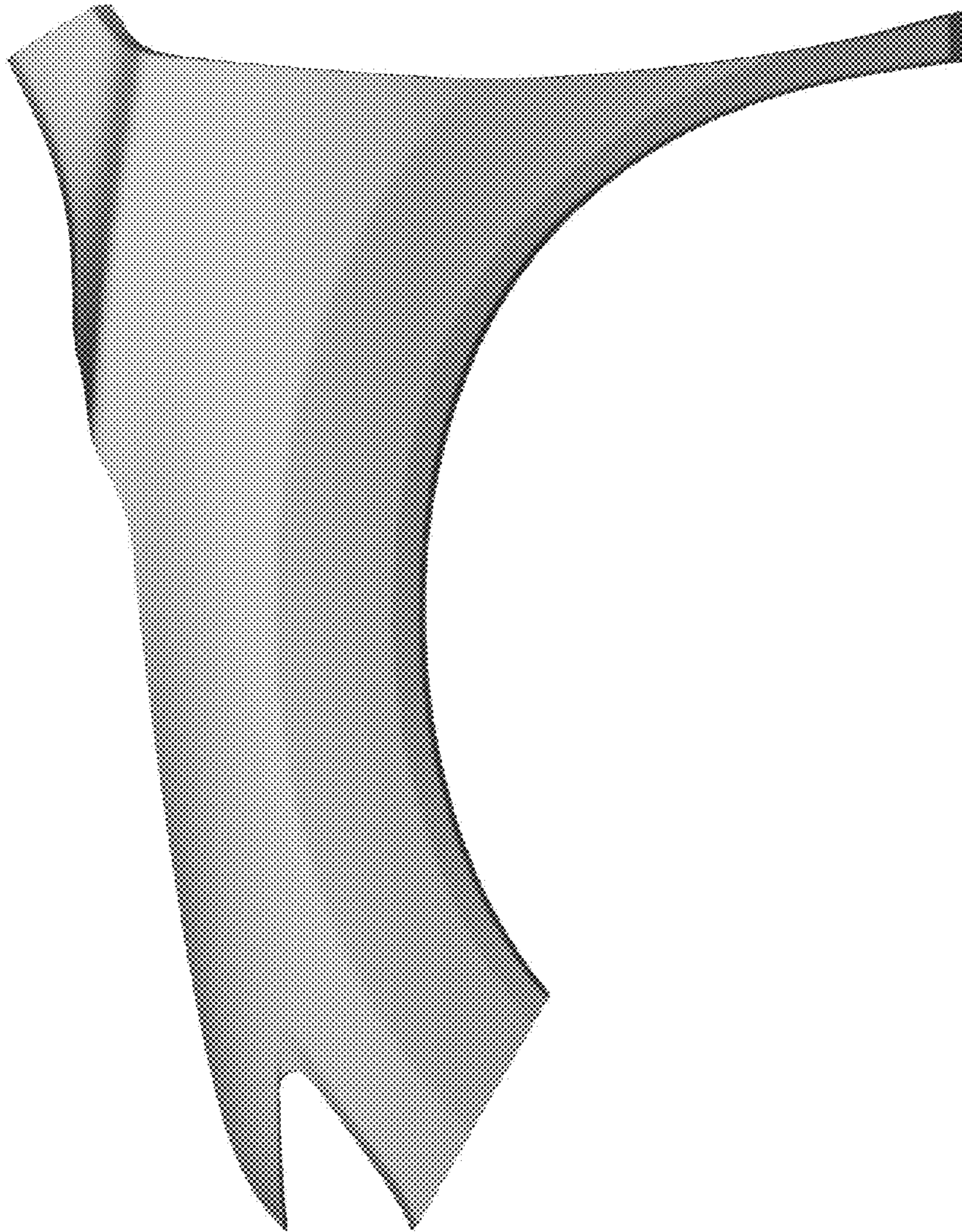

FIG. 1

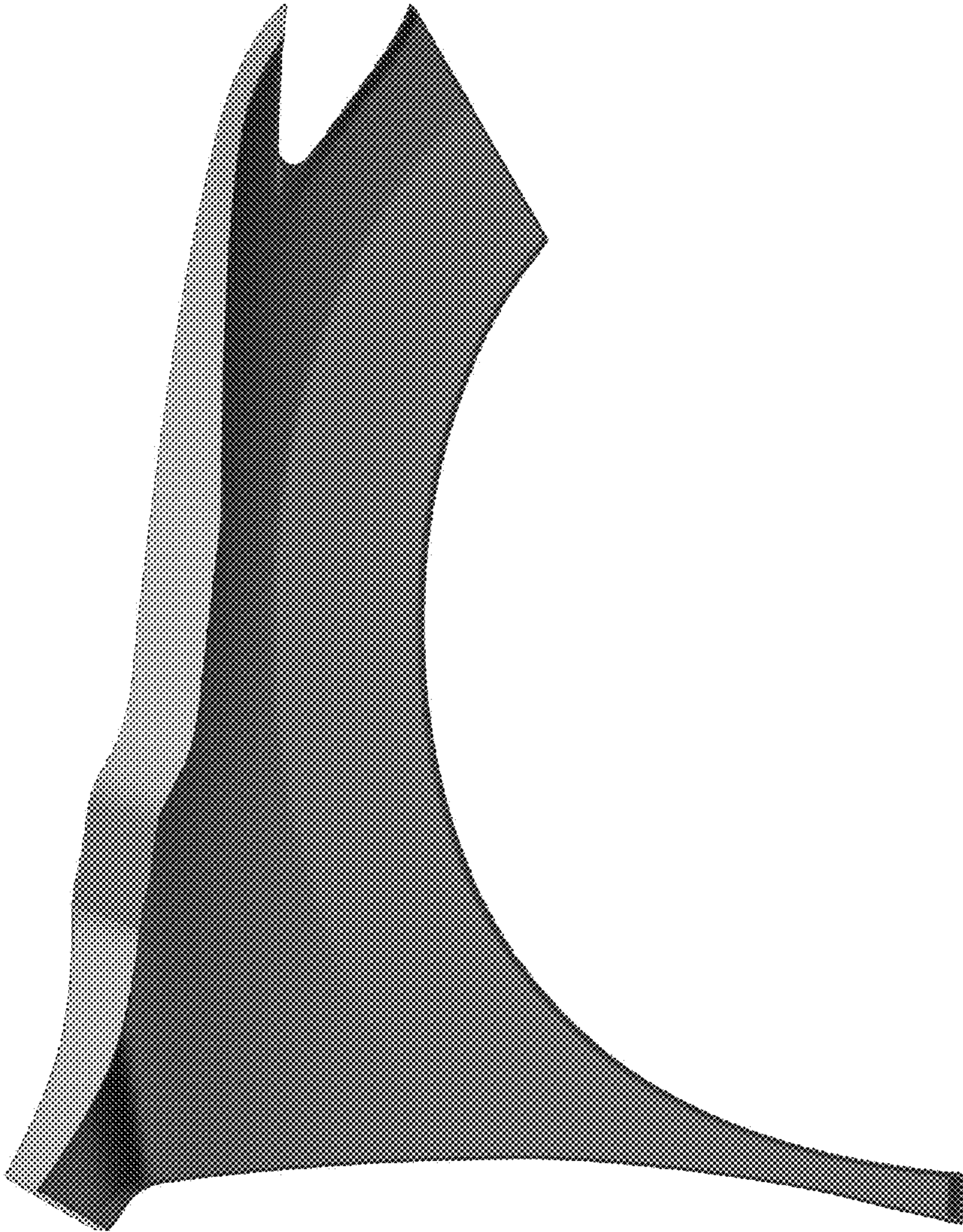

FIG. 2

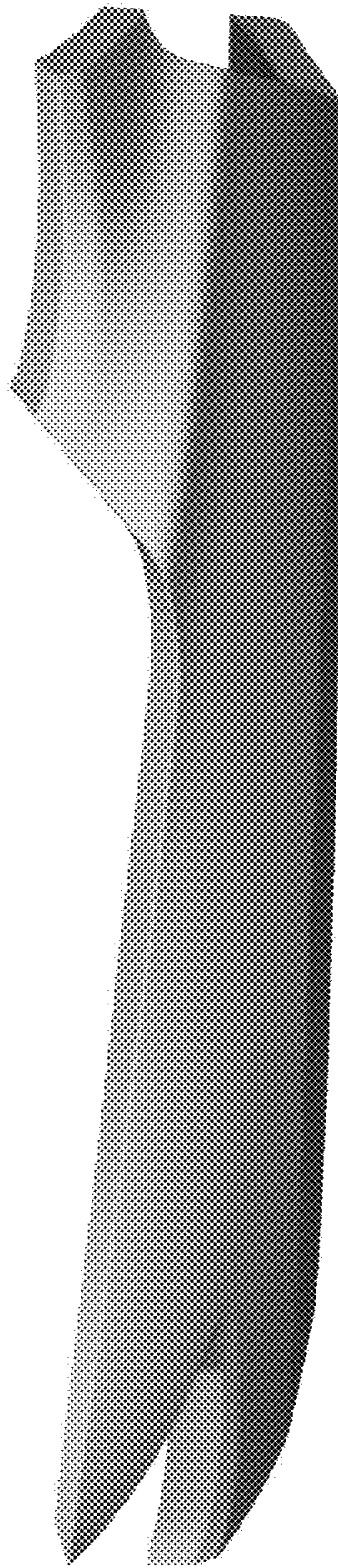

FIG. 3

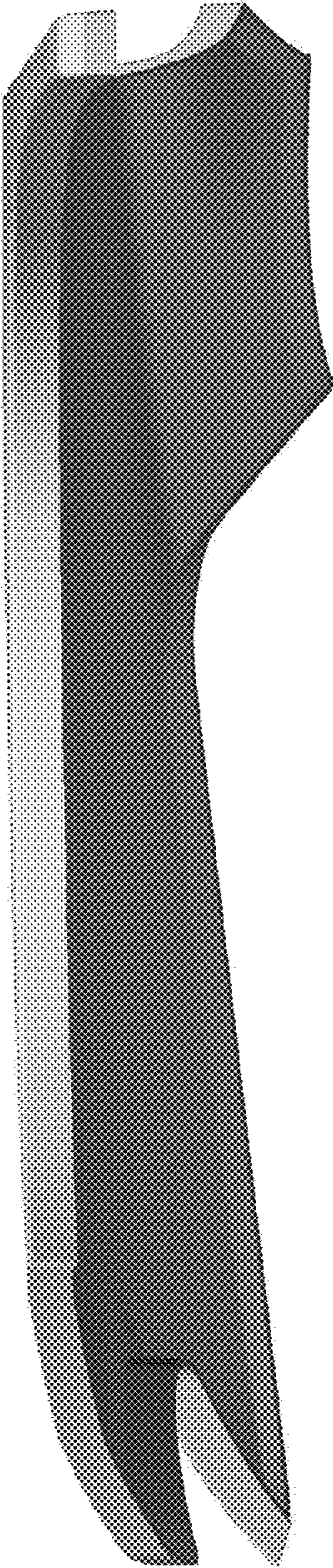

FIG. 4

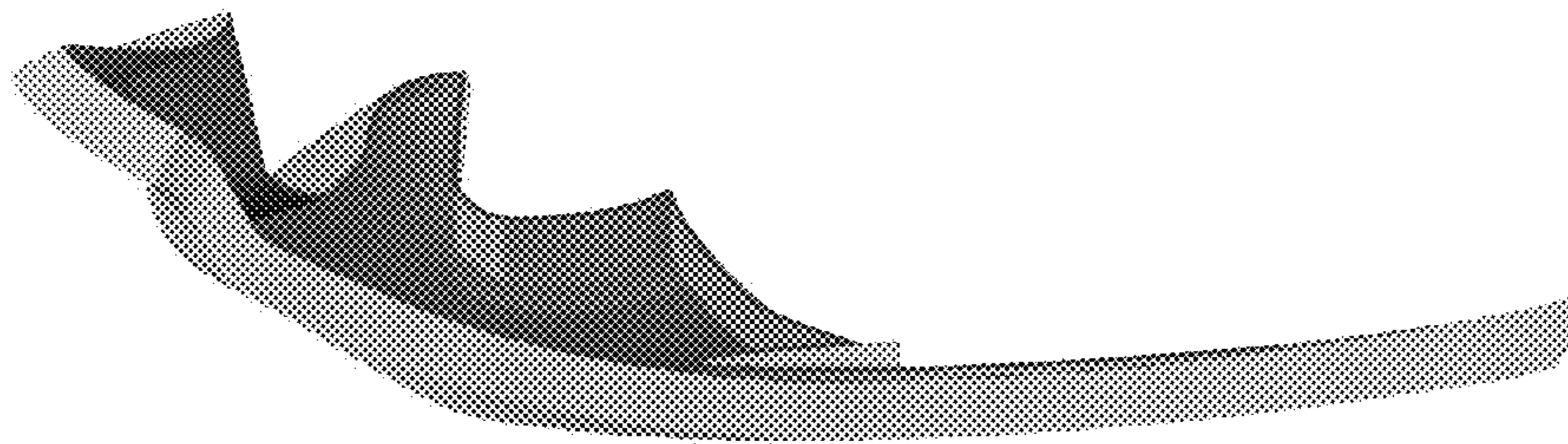

FIG. 5

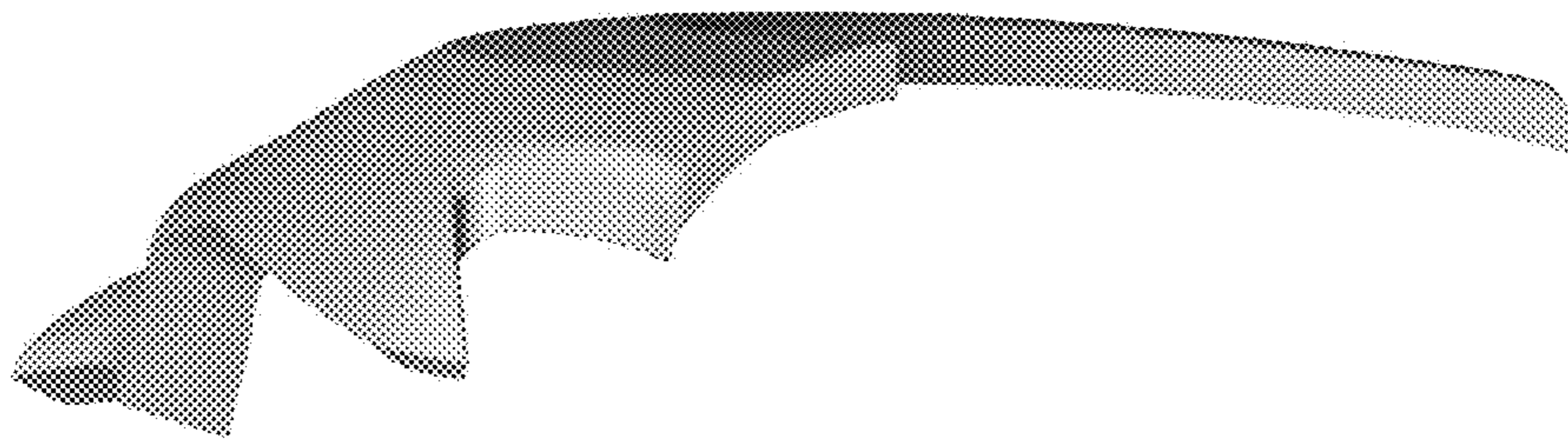

FIG. 6

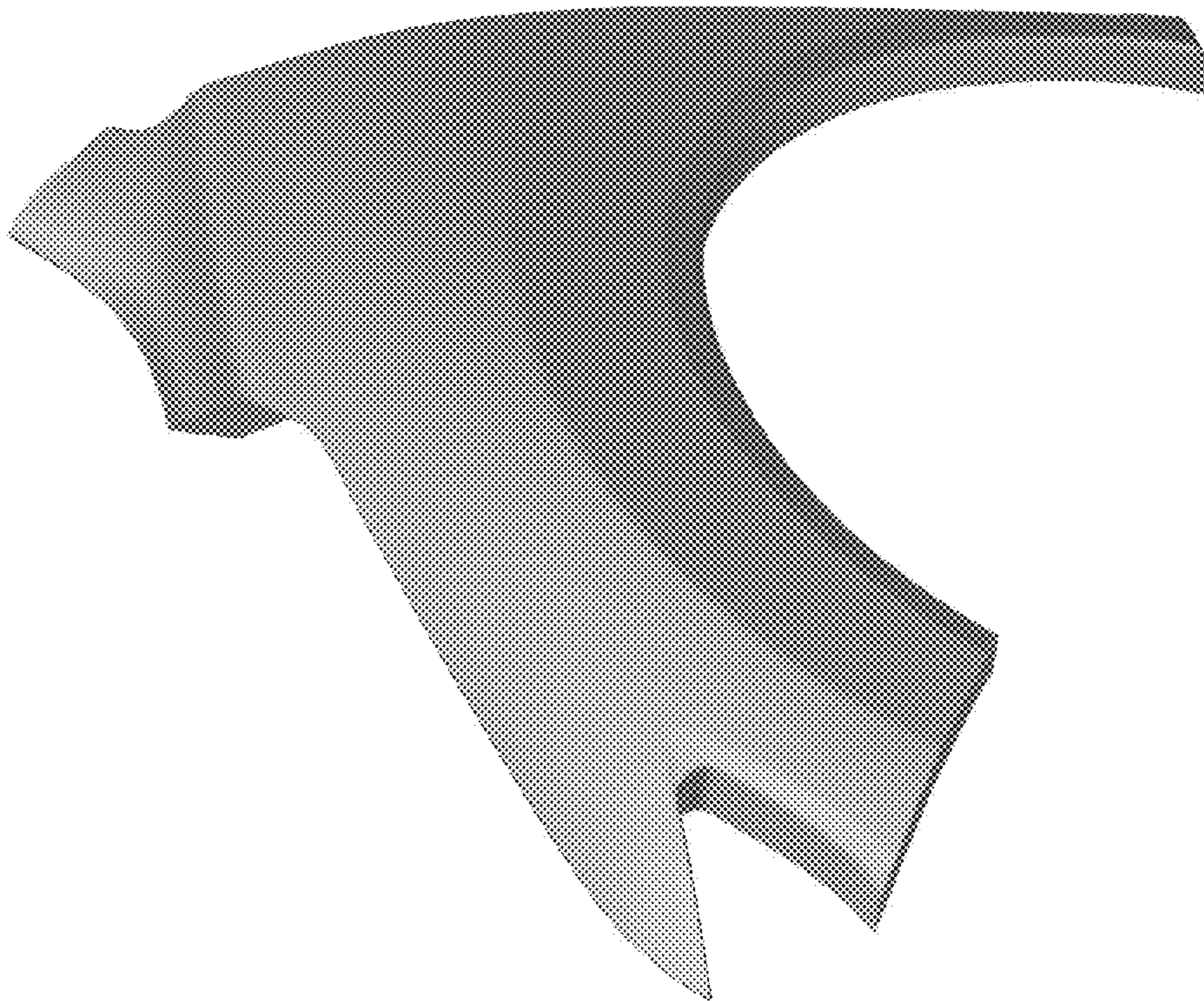

FIG. 7



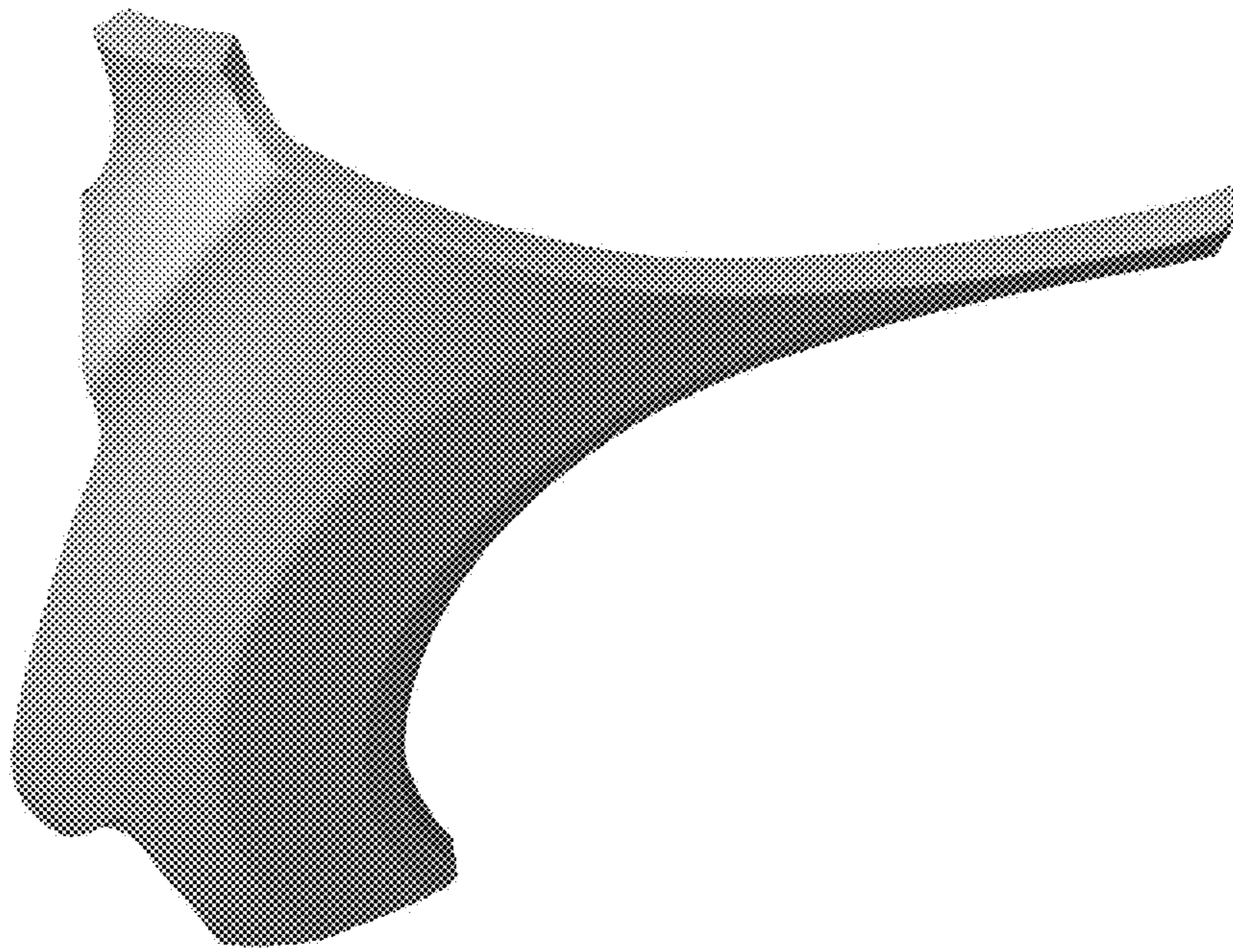

FIG. 8