



US00D684049S

(12) **United States Design Patent**
McCarthy

(10) **Patent No.:** **US D684,049 S**
(45) **Date of Patent:** **** Jun. 11, 2013**

(54) **LAUNDRY PRODUCT CONTAINER**

(75) Inventor: **Adam McCarthy**, Raleigh, NC (US)

(73) Assignee: **Greenology Products, Inc.**, Raleigh, NC (US)

(**) Term: **14 Years**

(21) Appl. No.: **29/414,518**

(22) Filed: **Feb. 29, 2012**

(51) **LOC (9) Cl.** **09-03**

(52) **U.S. Cl.**
USPC **D9/432**

(58) **Field of Classification Search**
USPC D9/414, 416, 418, 420-424, 430-433,
D9/455-456; D3/272, 273, 302; 206/267,
206/269, 270, 273, 299, 737, 740, 822; 229/100,
229/101, 101.3, 106, 108-122, 123-123.3
See application file for complete search history.

(56) **References Cited**

U.S. PATENT DOCUMENTS

2,639,080	A *	5/1953	Anderson, Jr.	229/122
3,499,582	A *	3/1970	Berney	222/183
D277,553	S *	2/1985	Ito et al.	D9/416
D280,491	S *	9/1985	Nielsen	D9/432
5,373,960	A *	12/1994	Gunn et al.	229/117.25
D364,087	S *	11/1995	Farley	D9/418
D372,861	S *	8/1996	Hoell et al.	D9/418
D379,759	S *	6/1997	Mulry	D9/418
6,045,036	A *	4/2000	Ring	229/117.24
D503,614	S *	4/2005	Sax et al.	D9/416
D548,072	S *	8/2007	Nixon	D9/432

7,708,186	B2 *	5/2010	Pawlick	229/117.3
7,984,845	B2 *	7/2011	Kelly	229/242
D668,951	S *	10/2012	Voelker	D9/430
2006/0180643	A1 *	8/2006	Stephenson	229/117.3
2009/0084834	A1 *	4/2009	Duyst	229/117.3

* cited by examiner

Primary Examiner — Susan Bennett Hattan

Assistant Examiner — Vy Koenig

(74) *Attorney, Agent, or Firm* — Ward and Smith, P.A.

(57) **CLAIM**

The ornamental design for a laundry product container, as shown and described.

DESCRIPTION

FIG. 1 is a front left side perspective view of a laundry product container showing a new design; FIG. 2 is a top rear right side perspective view thereof; FIG. 3 is a front elevation view thereof; FIG. 4 is a rear elevation view thereof; FIG. 5 is a right side elevation view thereof; FIG. 6 is a left side elevation view thereof; FIG. 7 is a top plan view thereof; FIG. 8 is a bottom plan view thereof; and, FIG. 9 is another front left side perspective view thereof, showing the laundry station container in an alternate configuration.

The dashed lines shown in the drawings are for environmental purposes only and form no part of the claimed design. The dotted lines shown in the drawings depict perforations and form part of the claimed design.

1 Claim, 9 Drawing Sheets

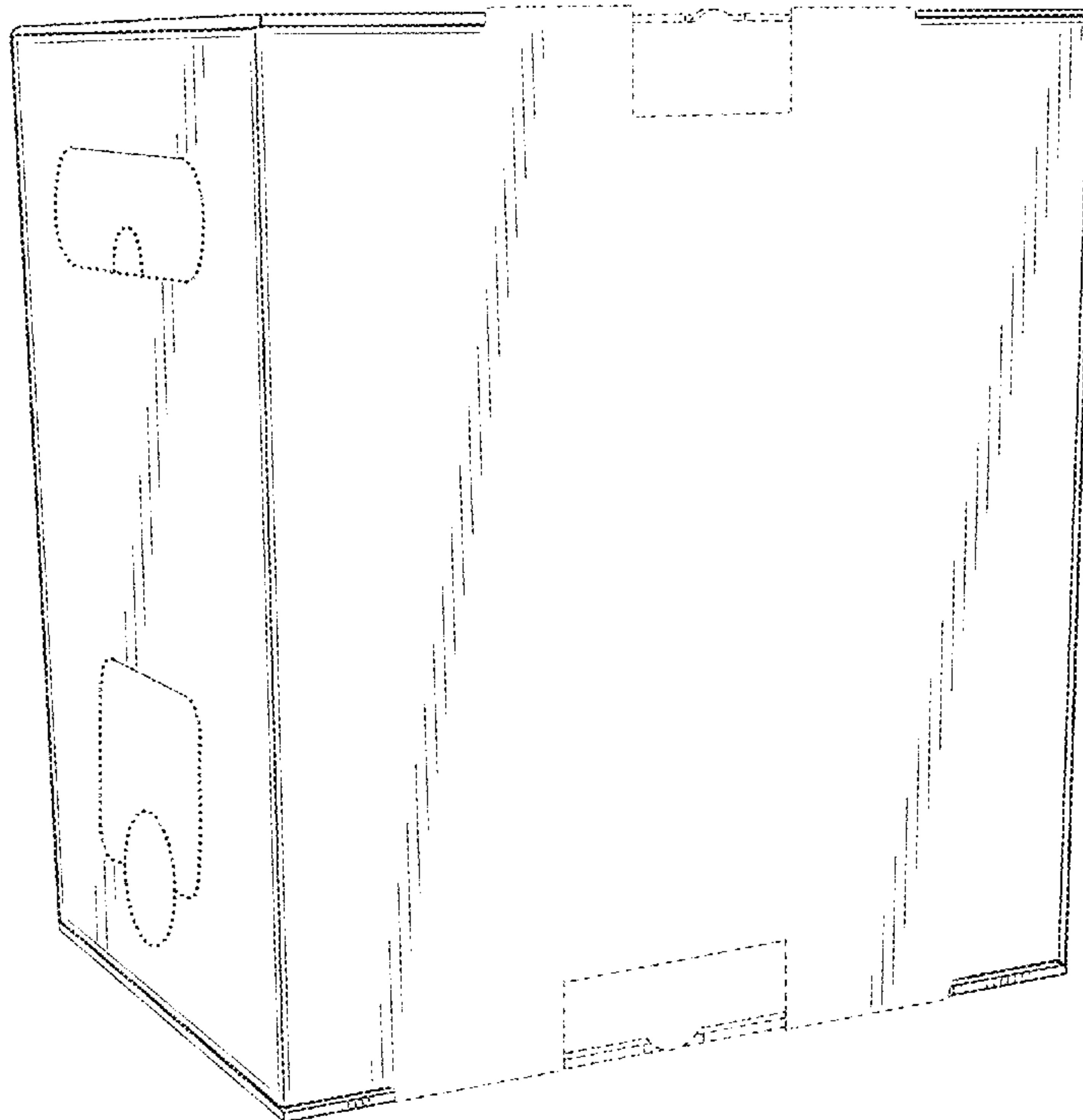

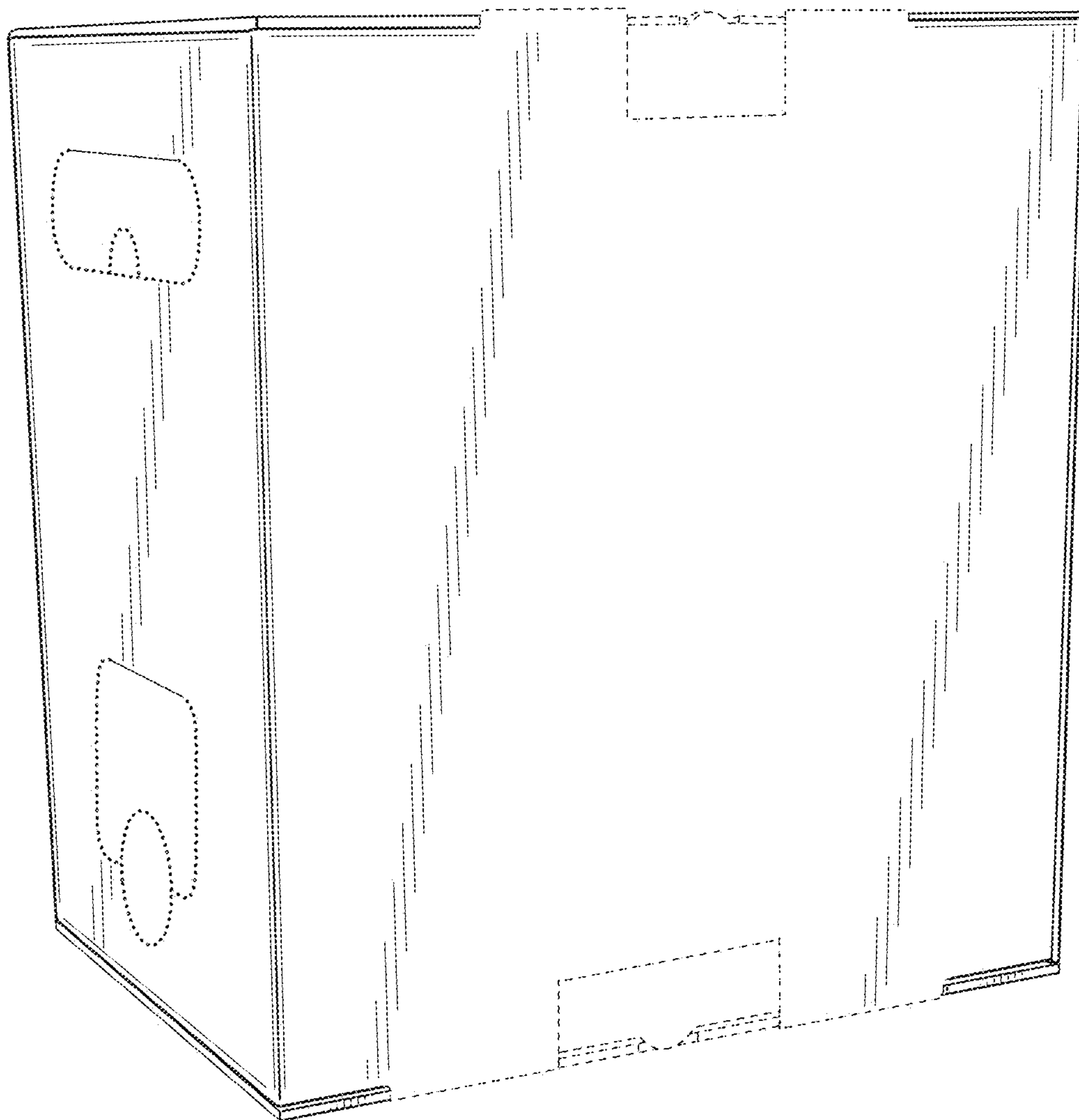

FIG. 1

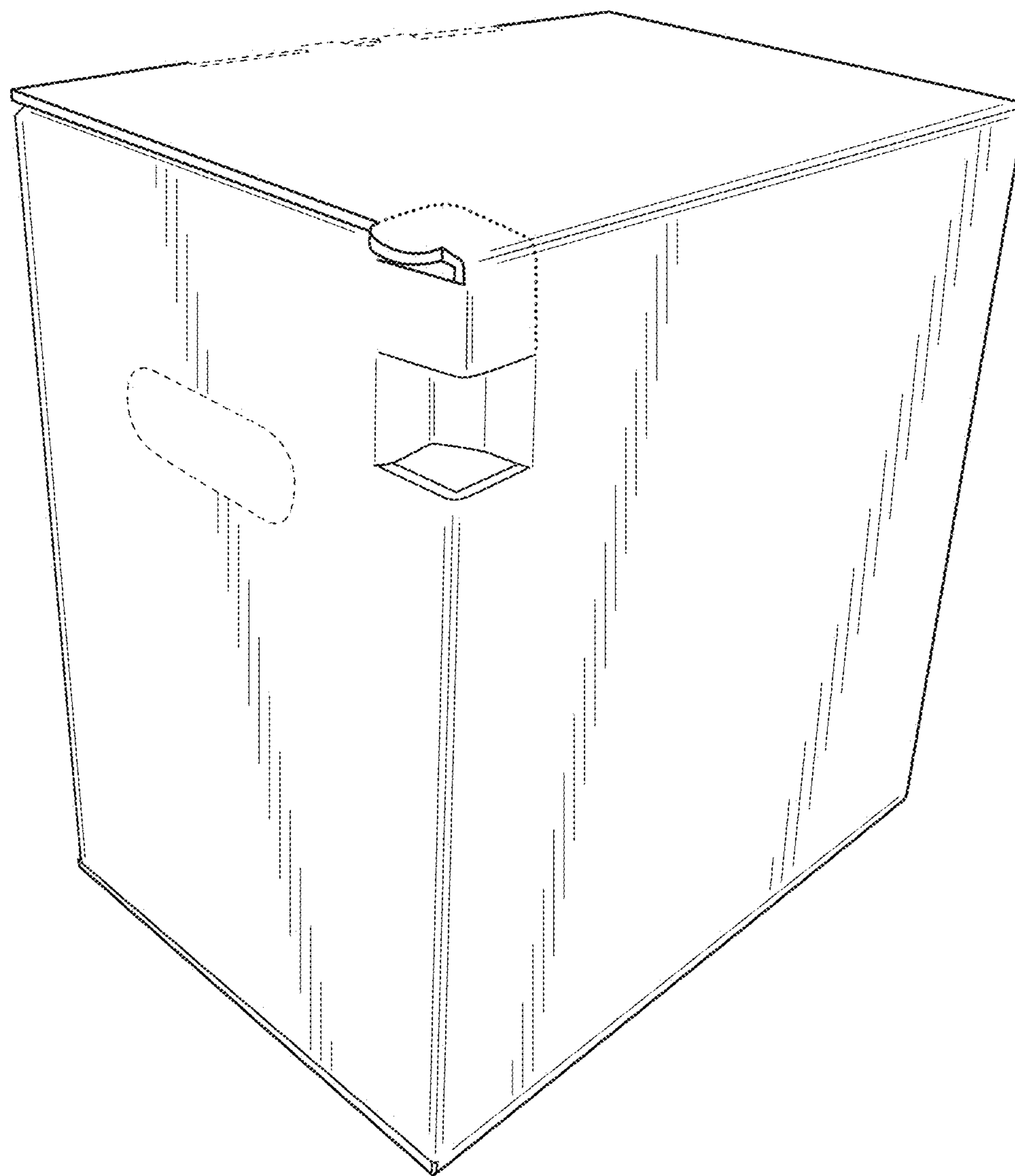

FIG. 2

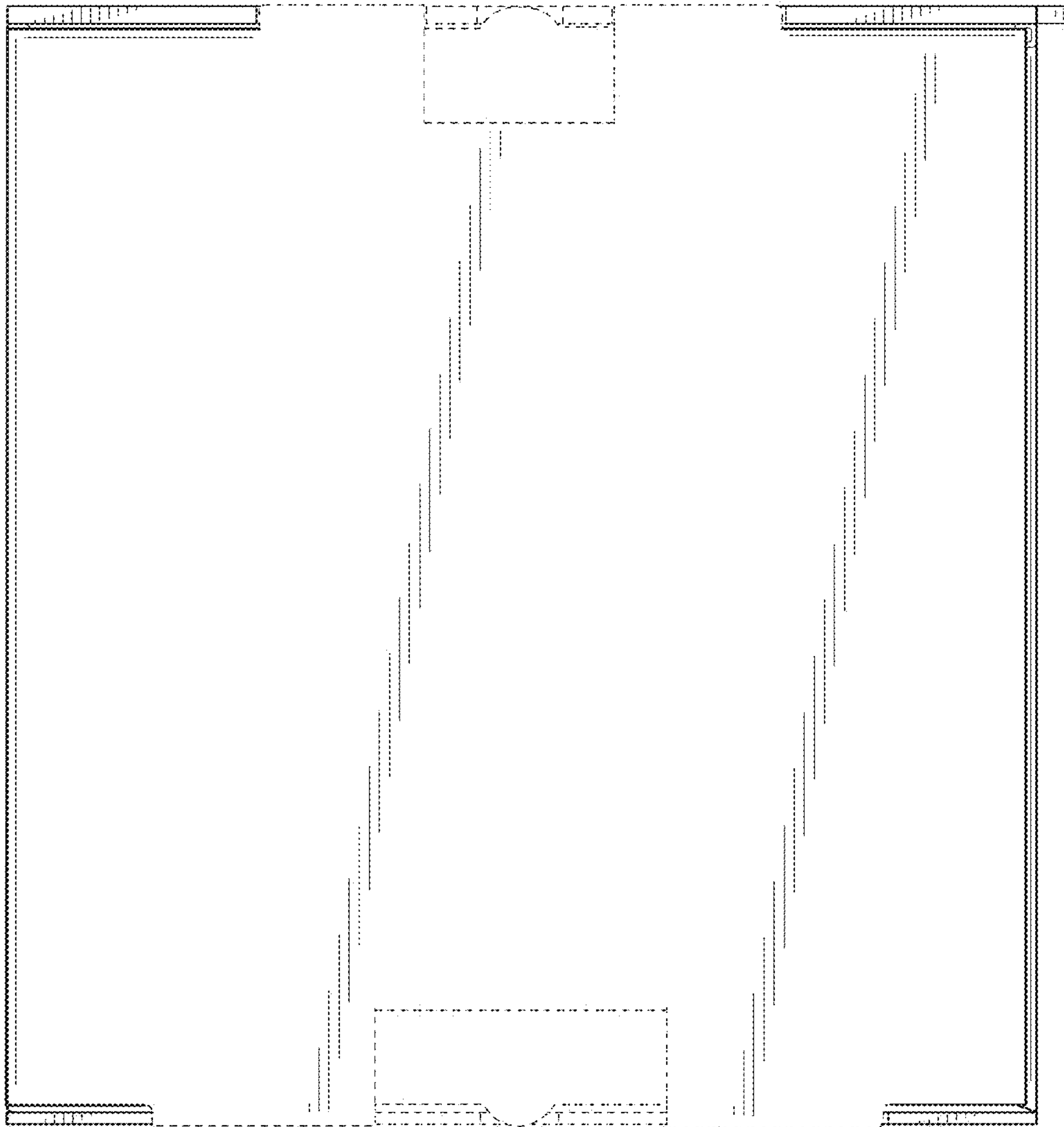

FIG. 3

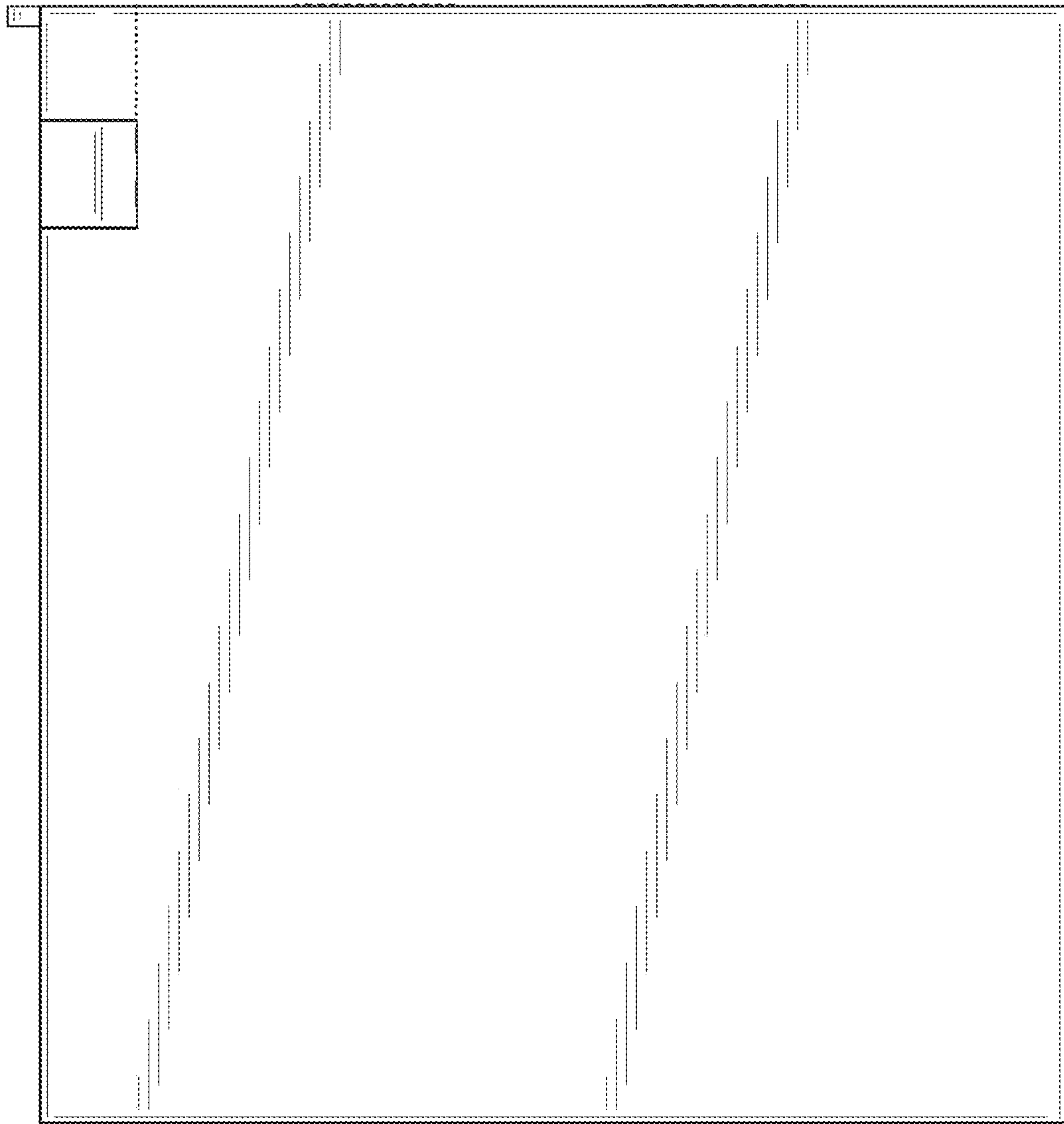

FIG. 4

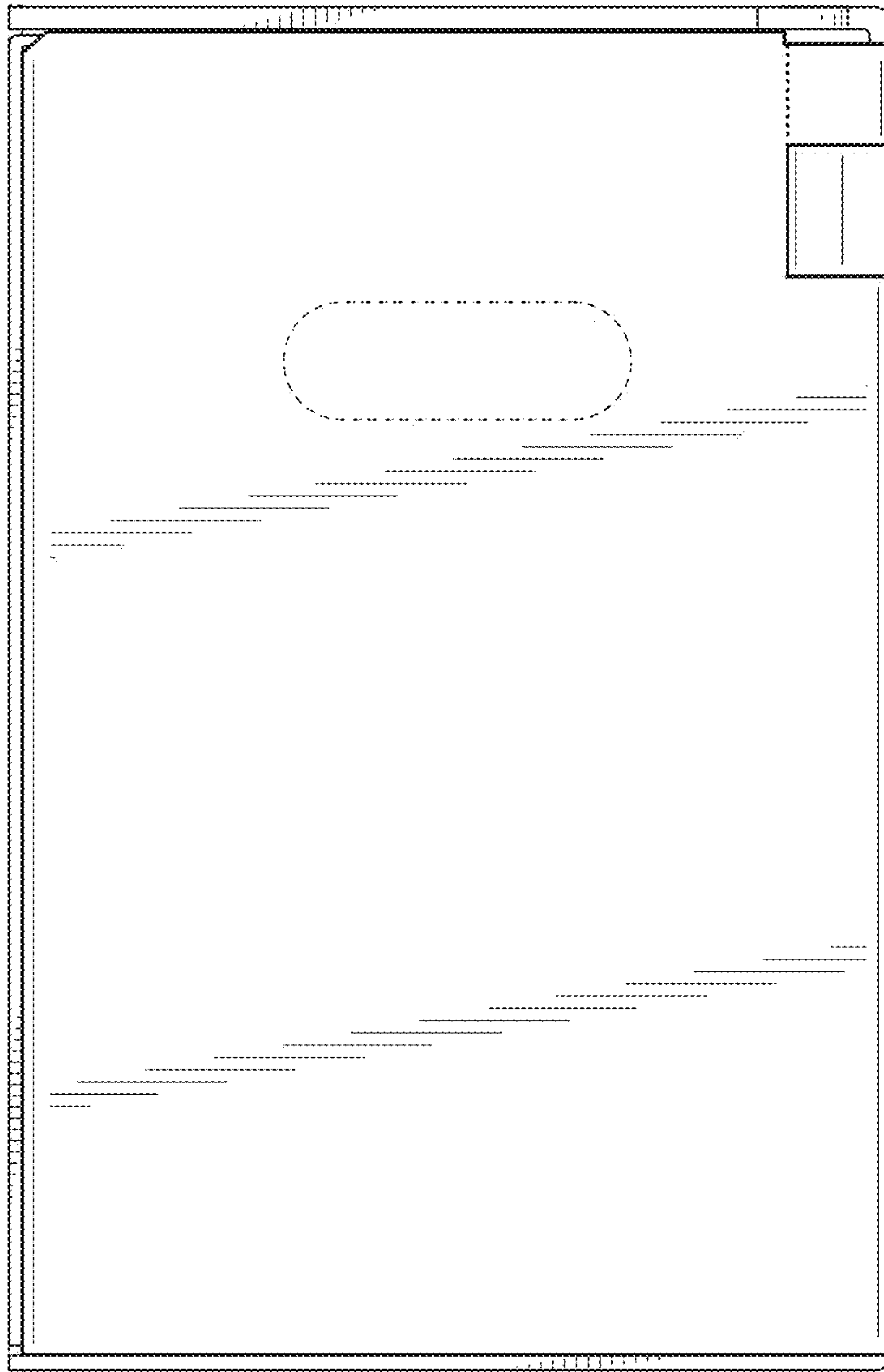

FIG. 5

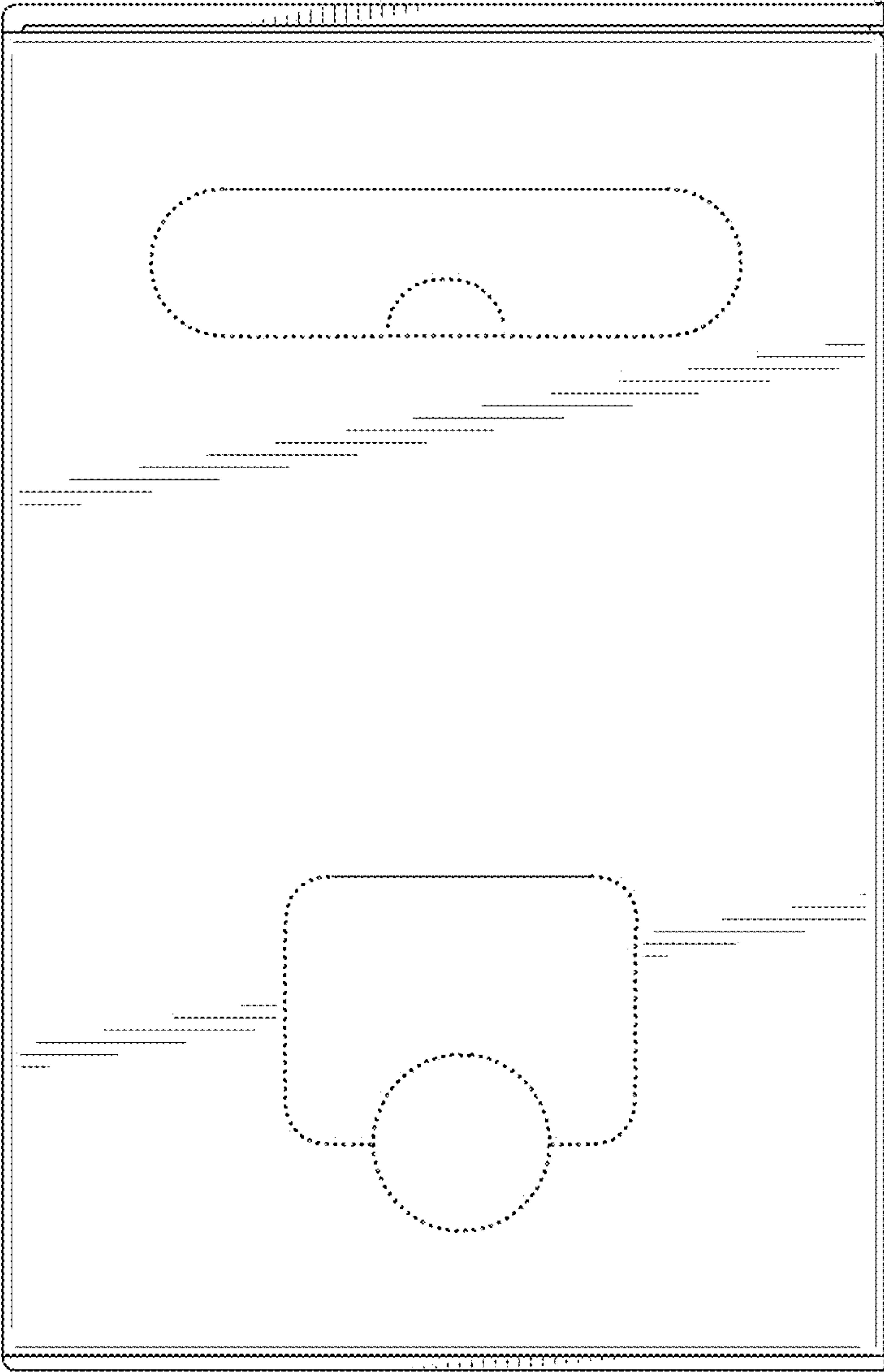

FIG. 6

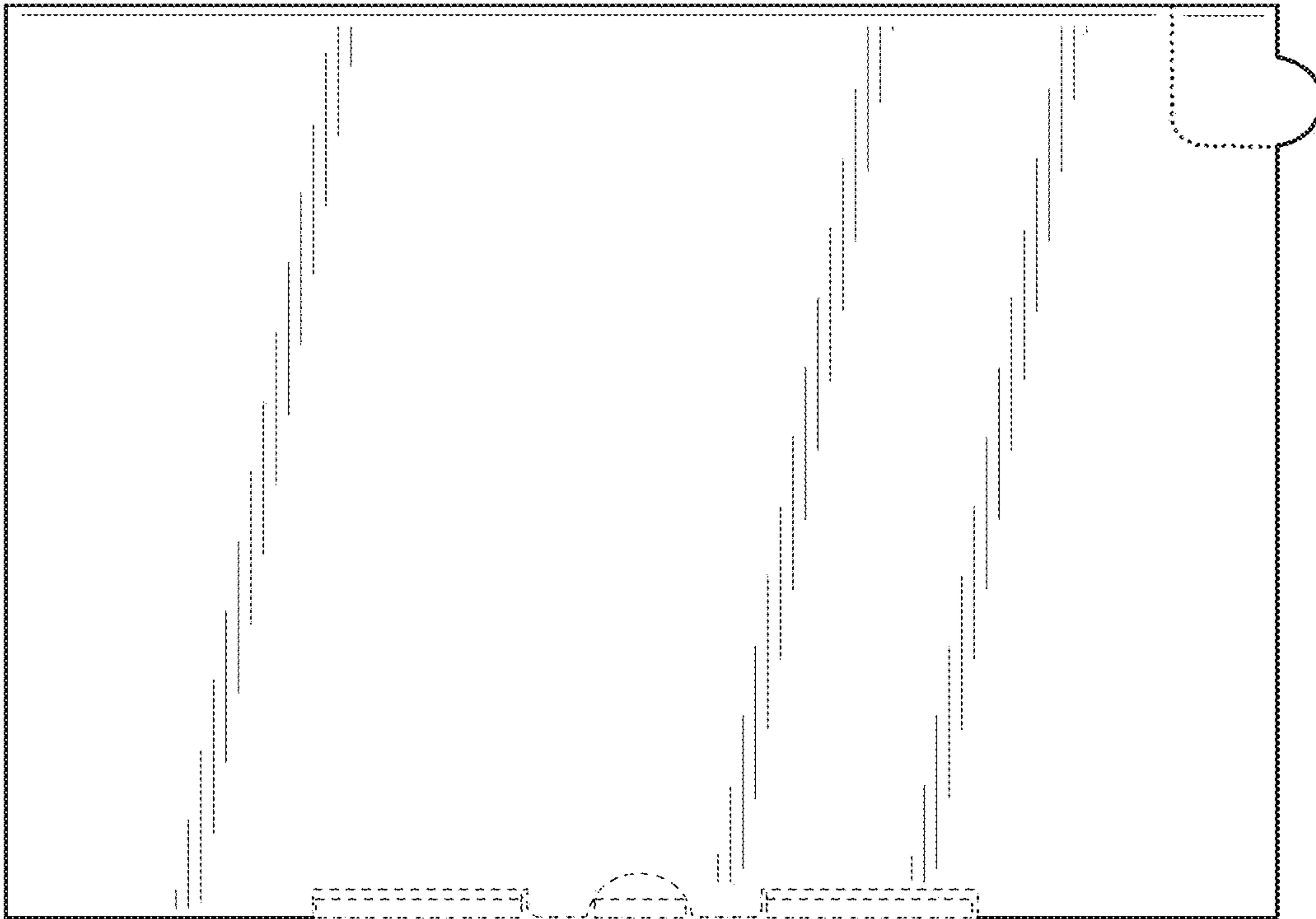

FIG. 7

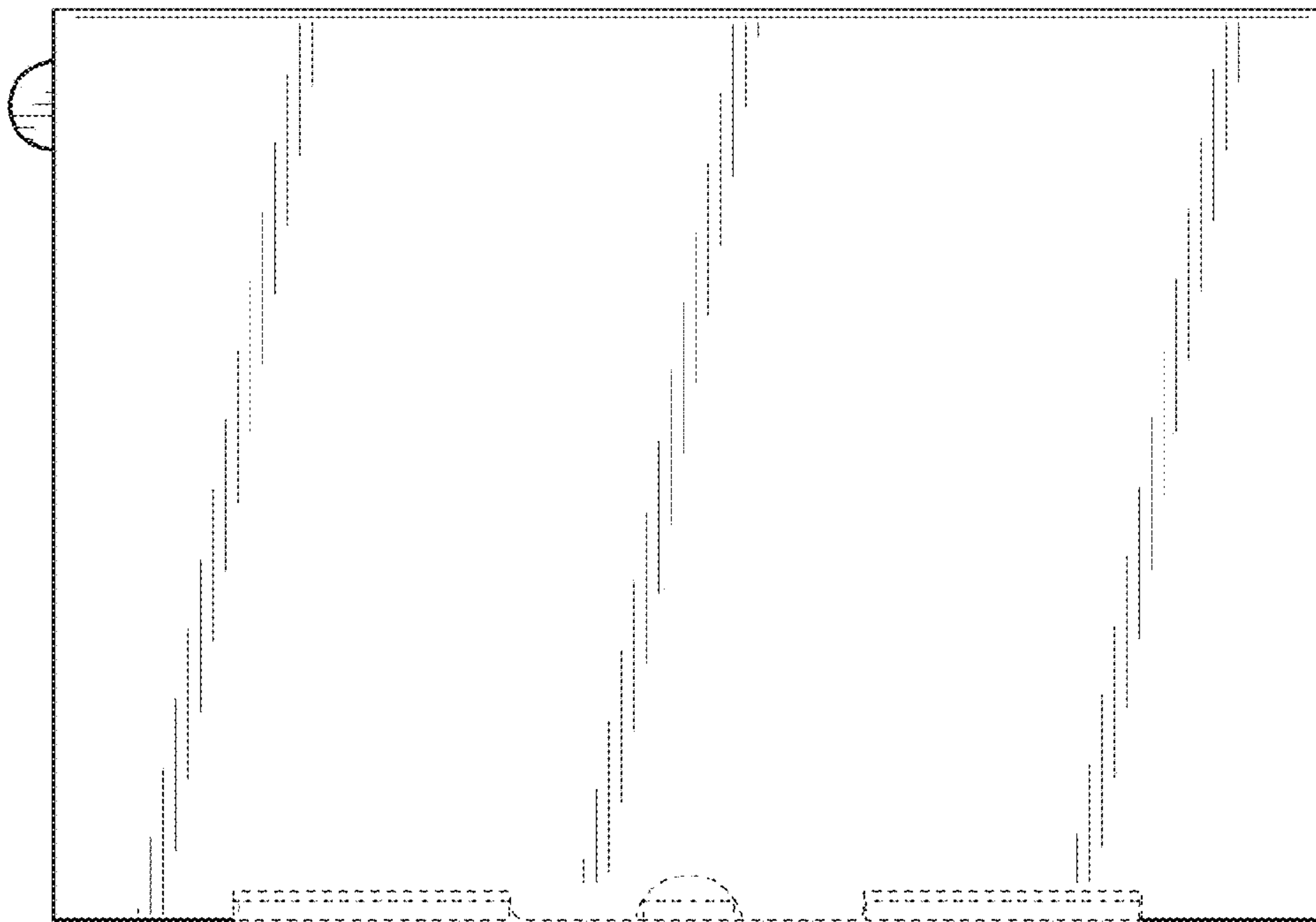

FIG. 8

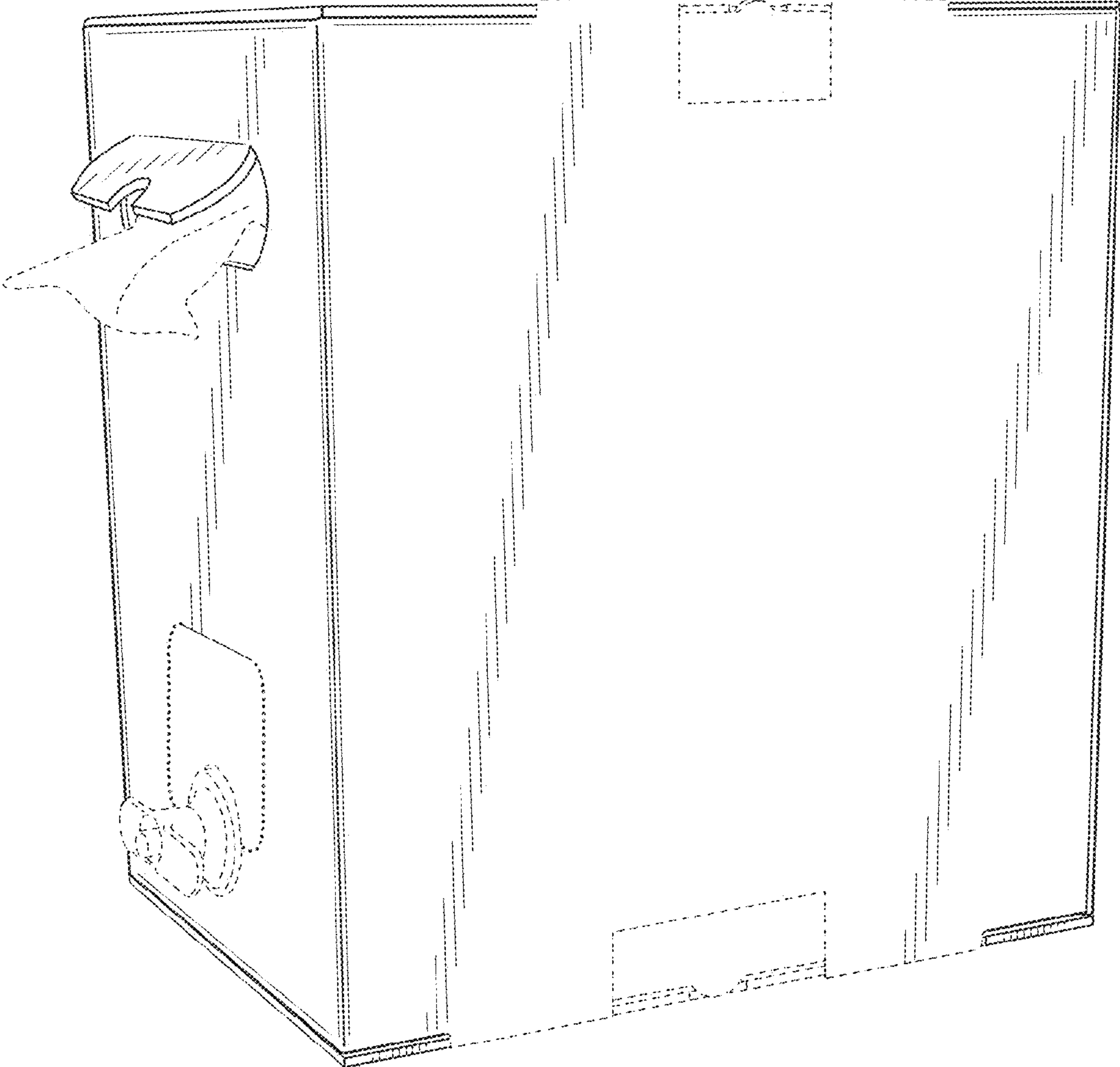

FIG. 9