



US00D683603S

(12) **United States Design Patent**
Ochs

(10) **Patent No.:** **US D683,603 S**
(45) **Date of Patent:** **** Jun. 4, 2013**

(54) **BOTTLE CAP OPENER**

(76) **Inventor:** **Christopher Cullen Ochs**, Minneapolis, MN (US)

(**) **Term:** **14 Years**

(21) **Appl. No.:** **29/418,698**

(22) **Filed:** **Apr. 19, 2012**

(51) **LOC (9) Cl.** **07-99**

(52) **U.S. Cl.**
USPC **D8/40**

(58) **Field of Classification Search**
USPC D8/14, 16-19, 33-43, 88, 89, 105; 7/113, 7/151-156; 30/400-410, 416-430, 433, 434, 30/443, 450; 81/3.07, 3.09, 3.2, 3.27, 3.29, 81/3.31, 3.35, 3.37, 3.4, 3.45, 3.48, 3.49, 81/3.55

See application file for complete search history.

(56) **References Cited**

U.S. PATENT DOCUMENTS

D97,570 S * 11/1935 Trolen D8/34
D293,199 S * 12/1987 Grenley D8/18
D325,499 S * 4/1992 Wilder D8/33

D416,773 S * 11/1999 Cellini D8/42
6,851,147 B2 * 2/2005 Abrahall 7/151
D544,768 S * 6/2007 Book D8/40
D603,667 S * 11/2009 Scott D8/14
D640,519 S * 6/2011 Danias-Borkin D8/33

* cited by examiner

Primary Examiner — Garth Rademaker

(74) *Attorney, Agent, or Firm* — Winthrop & Weinstine, P.A.

(57) **CLAIM**

The ornamental design for a bottle cap opener, as shown and described.

DESCRIPTION

FIG. 1 is a front view of a bottle cap opener showing the design.

FIG. 2 is a back view thereof.

FIG. 3 is a top plan view thereof.

FIG. 4 is a bottom plan view thereof.

FIG. 5 is a left side view thereof.

FIG. 6 is a right side view thereof; and,

FIG. 7 is a perspective view thereof.

The broken lines depict portions of the bottle cap opener which form no part of the claimed design.

1 Claim, 4 Drawing Sheets

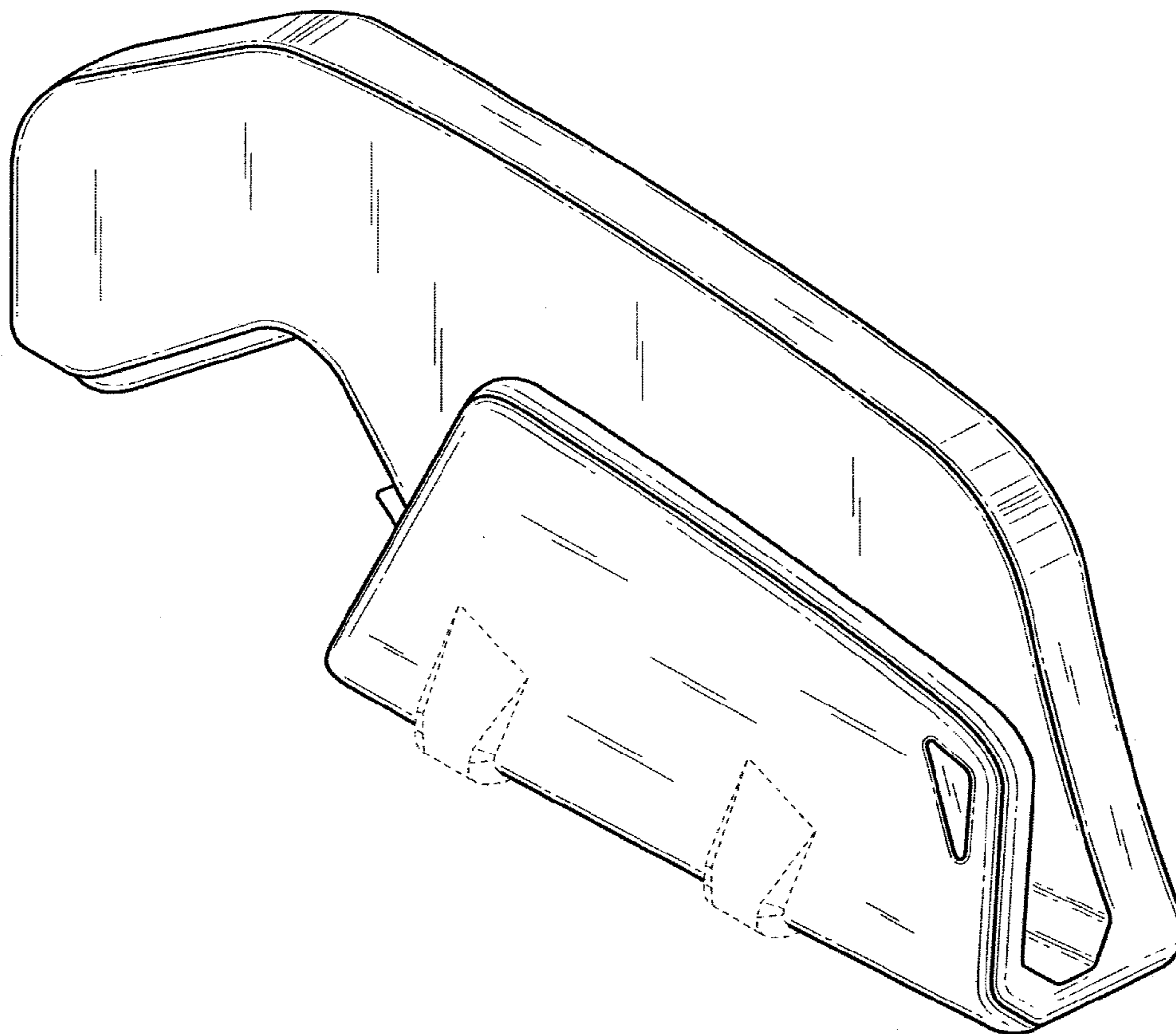

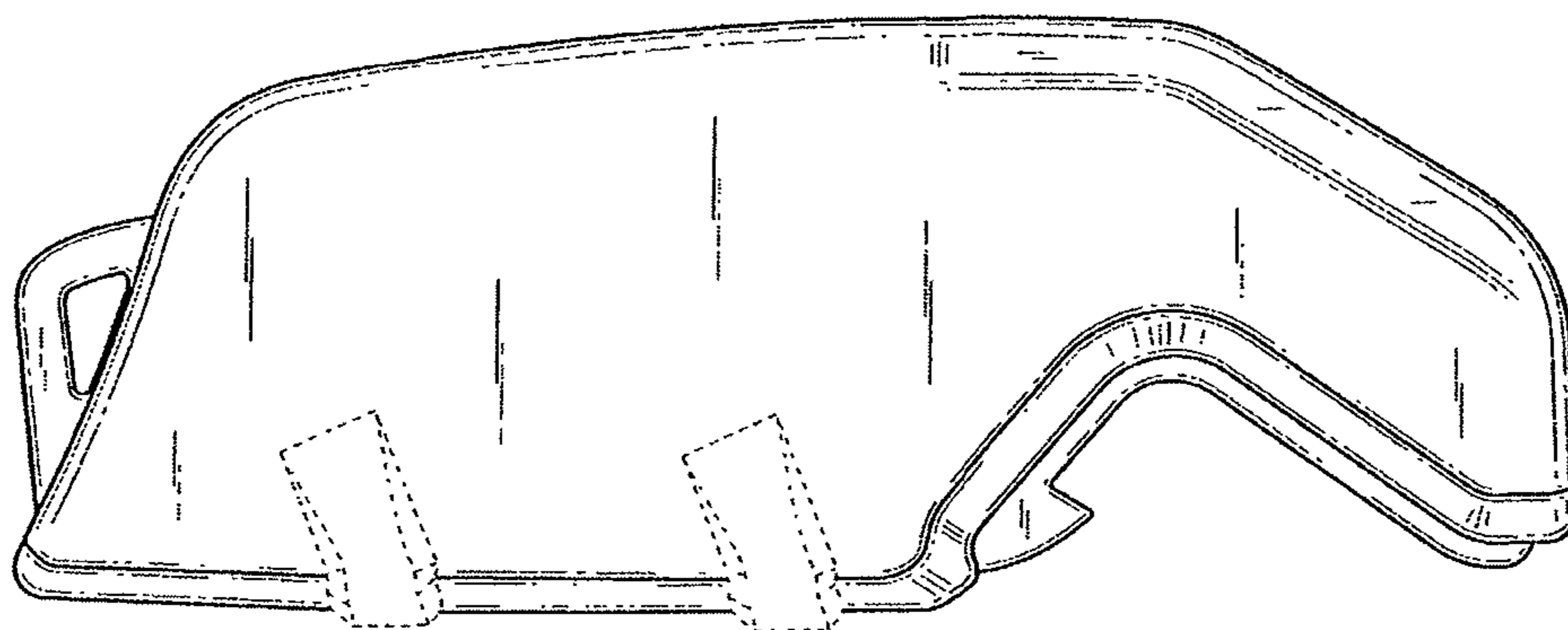

Fig. 1

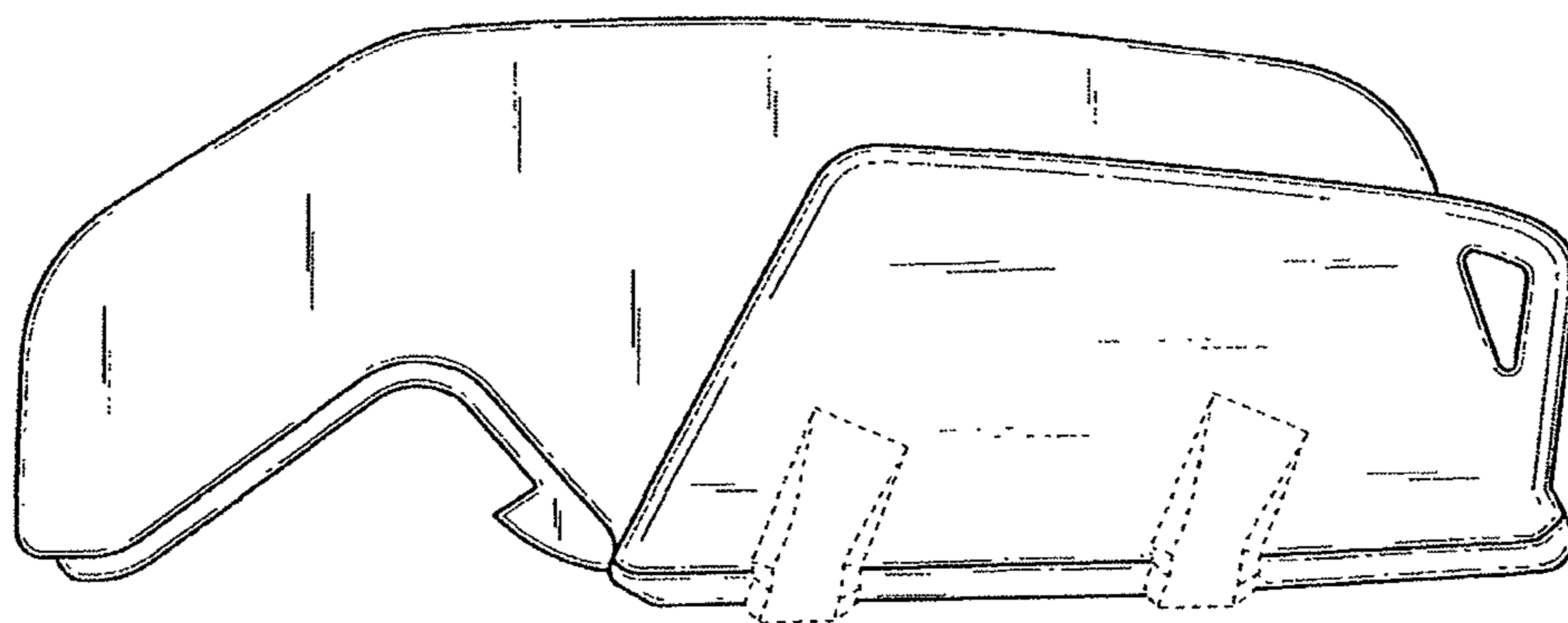

Fig. 2

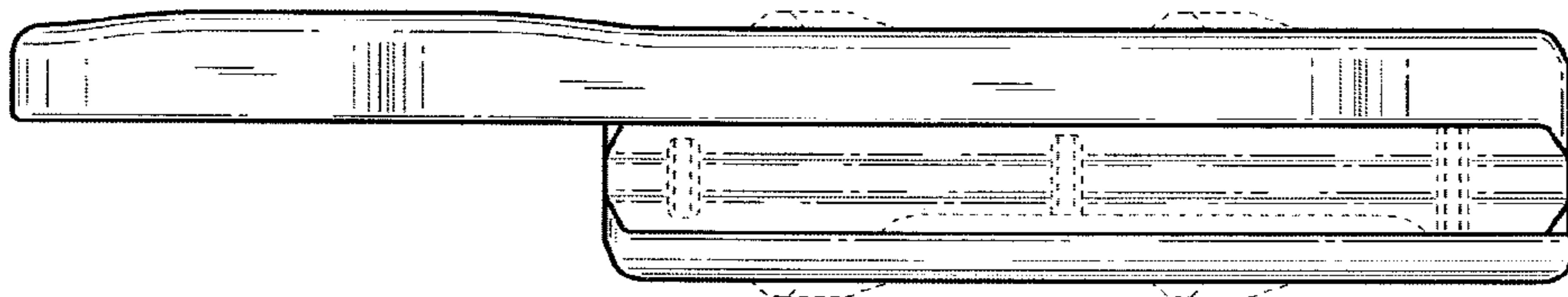

Fig. 3

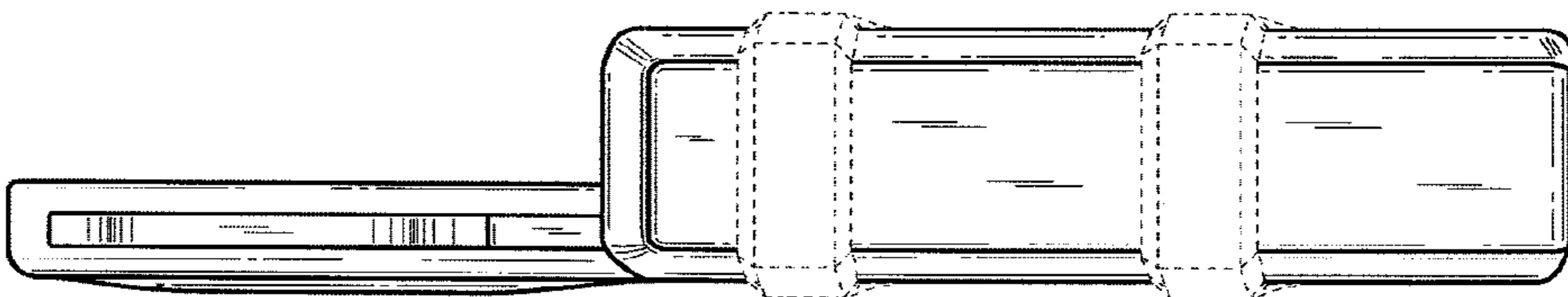

Fig. 4

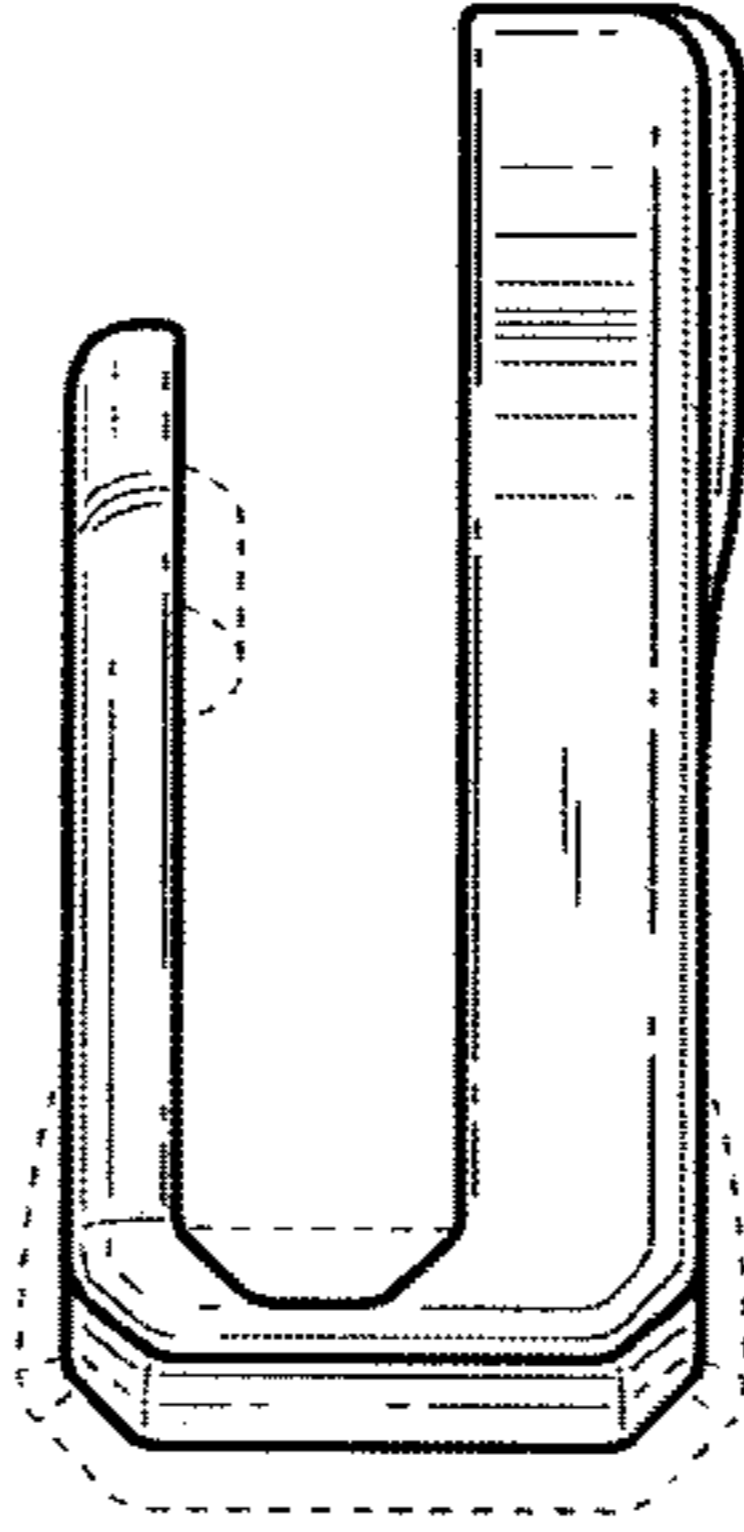

Fig. 5

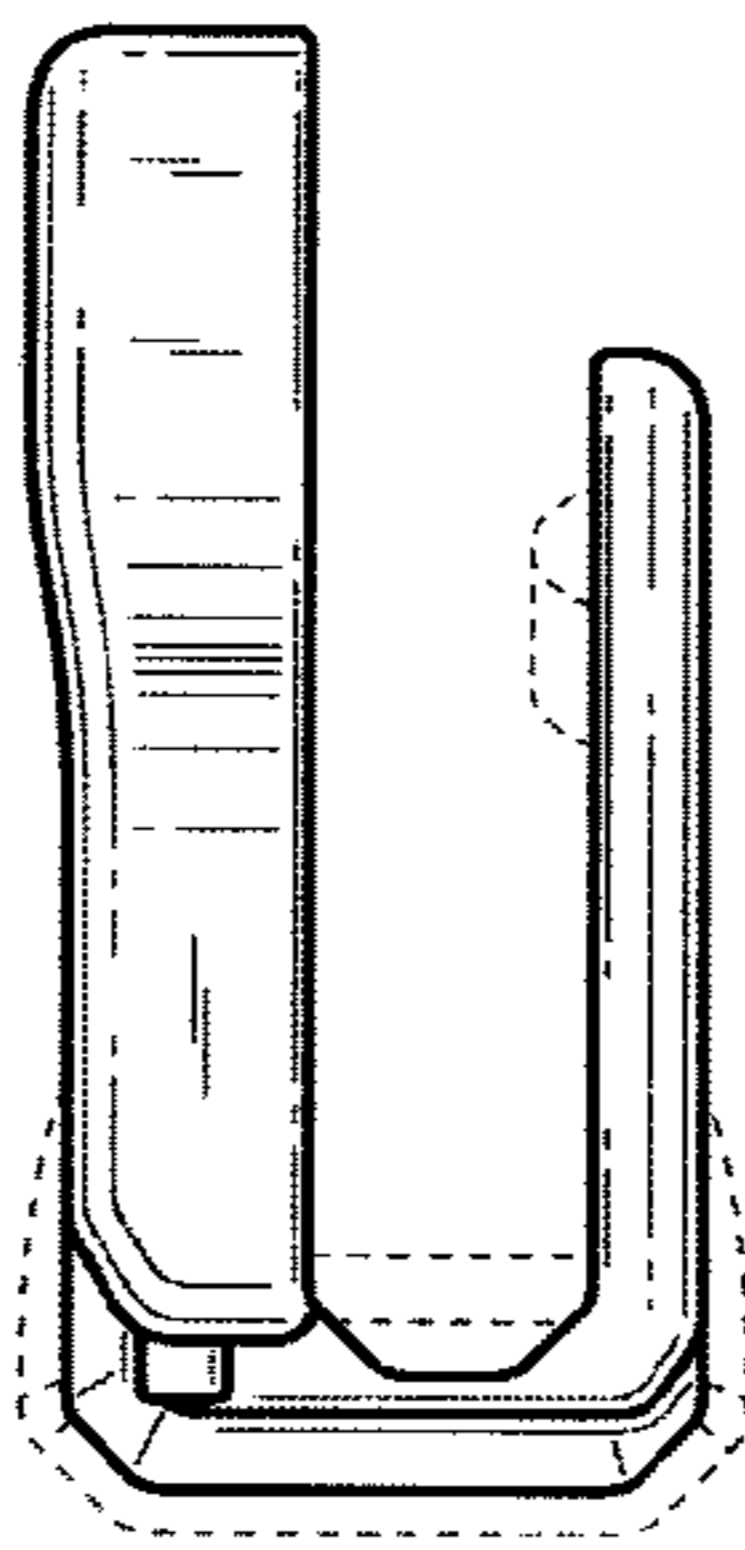

Fig. 6

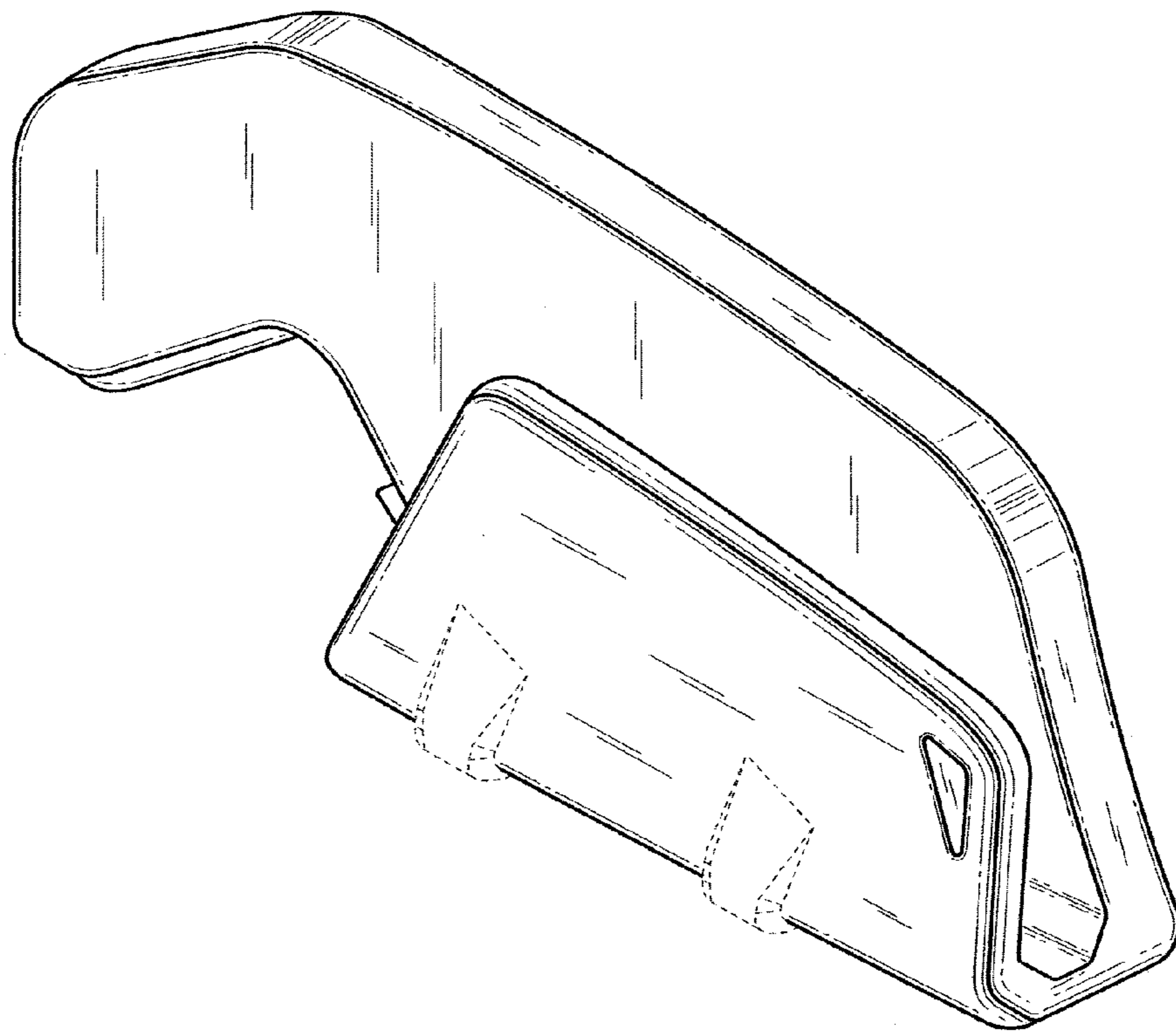

Fig. 7