



US00D683557S

(12) **United States Design Patent**
Block, Jr.

(10) **Patent No.:** **US D683,557 S**
(45) **Date of Patent:** **** Jun. 4, 2013**

- (54) **ECONOMY CART**
- (75) Inventor: **George Peter Block, Jr.**, Harwood Heights, IL (US)
- (73) Assignee: **Carstens, Inc.**, Harwood Heights, IL (US)
- (**) Term: **14 Years**
- (21) Appl. No.: **29/424,567**
- (22) Filed: **Jun. 13, 2012**
- (51) **LOC (9) Cl.** **06-01**
- (52) **U.S. Cl.**
USPC **D6/496**
- (58) **Field of Classification Search**
USPC D6/496, 500–502, 335–338, 340,
D6/349, 354, 355, 509; 297/135, 141, 142,
297/156, 175
See application file for complete search history.

(56) **References Cited**

U.S. PATENT DOCUMENTS

4,077,333	A *	3/1978	Ballas	108/6
4,715,573	A *	12/1987	Liegel	248/129
D296,851	S *	7/1988	Kelley	D6/420
D406,434	S *	3/1999	Boettcher et al.	D34/23
6,240,856	B1 *	6/2001	Paskey et al.	108/146
D548,496	S *	8/2007	Samtani et al.	D6/486
D638,637	S *	5/2011	Foley	D6/429
8,100,061	B2 *	1/2012	Hookway et al.	108/50.01
D656,760	S *	4/2012	Fox	D6/499
2009/0266274	A1 *	10/2009	Berlin et al.	108/6

* cited by examiner

Primary Examiner — Sandra Snapp

(74) *Attorney, Agent, or Firm* — Leydig, Voit & Mayer, Ltd.

(57) **CLAIM**

The ornamental design for an economy cart, as shown and described.

DESCRIPTION

FIG. 1 is an isometric view of an economy cart in a first configuration, with non-essential elements being shown in dotted lines.

FIG. 2 is a top plan view of the economy cart of FIG. 1 in the first configuration, with non-essential elements being shown in dotted lines.

FIG. 3 is a front view of the economy cart of FIG. 1 in the first configuration, with non-essential elements being shown in dotted lines.

FIG. 4 is a left side view of the economy cart of FIG. 1 in the first configuration, with non-essential elements being shown in dotted lines.

FIG. 5 is a right side view of the economy cart of FIG. 1 in the first configuration, with non-essential elements being shown in dotted lines.

FIG. 6 is a bottom view of the economy cart of FIG. 1 in the first configuration, with non-essential elements being shown in dotted lines.

FIG. 7 is an isometric view of the economy cart of FIG. 1 in a second configuration, with non-essential elements being shown in dotted lines.

FIG. 8 is a top plan view of the economy cart of FIG. 1 in the second configuration, with the non-essential elements being shown in dotted lines.

FIG. 9 is an front view of the economy cart of FIG. 1 in the second configuration, with non-essential elements being shown in dotted lines.

FIG. 10 is a left side view of the economy cart of FIG. 1 in the second configuration, with non-essential elements being shown in dotted lines.

FIG. 11 is a right view of the economy cart of FIG. 1 in the second configuration, with non-essential elements being shown in dotted lines; and,

FIG. 12 is a bottom view of the economy cart of FIG. 1 in the second configuration, with non-essential elements being shown in dotted lines.

The dotted lines are for illustrative purposes only and form no part of the claimed design.

1 Claim, 12 Drawing Sheets

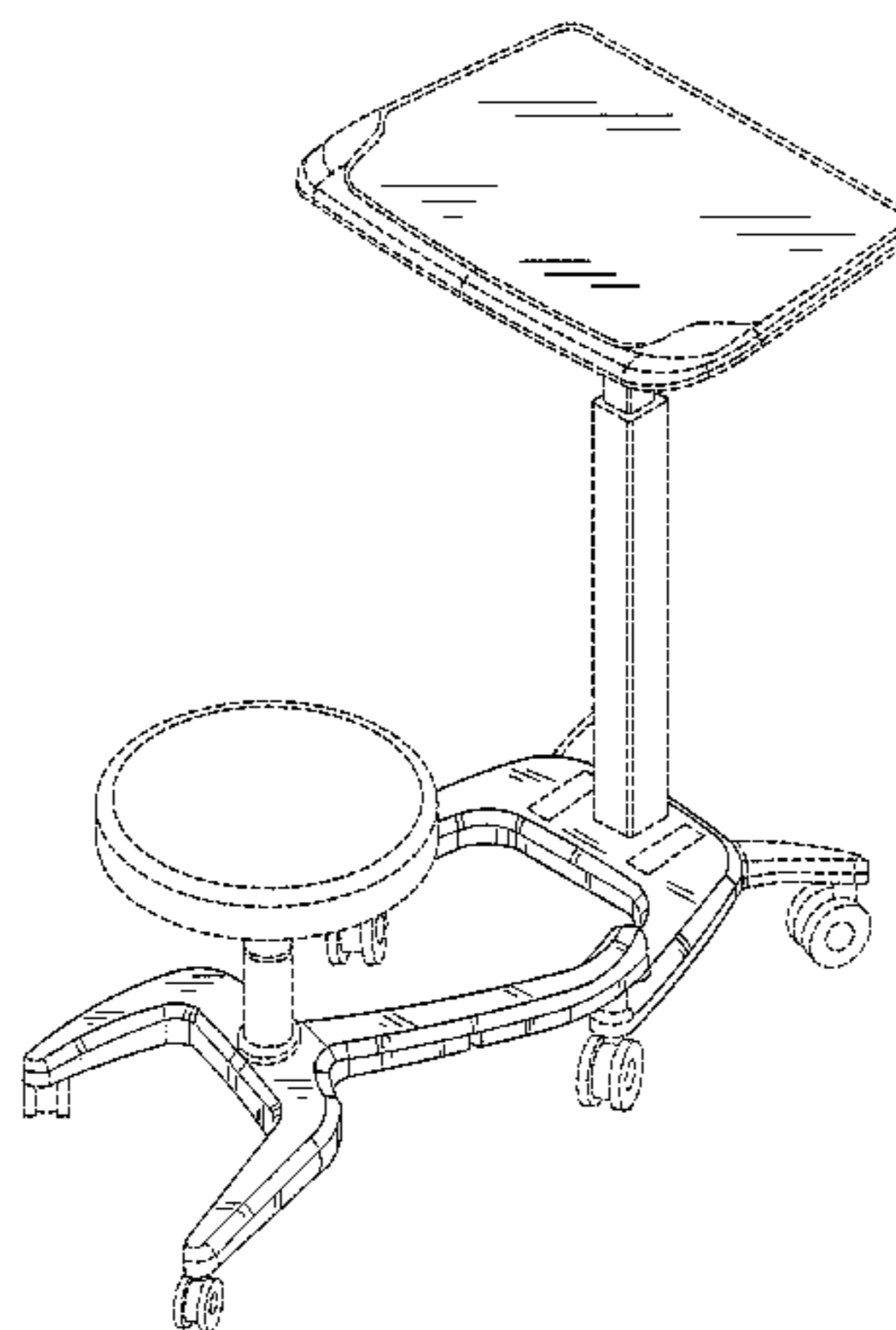

FIG. 1

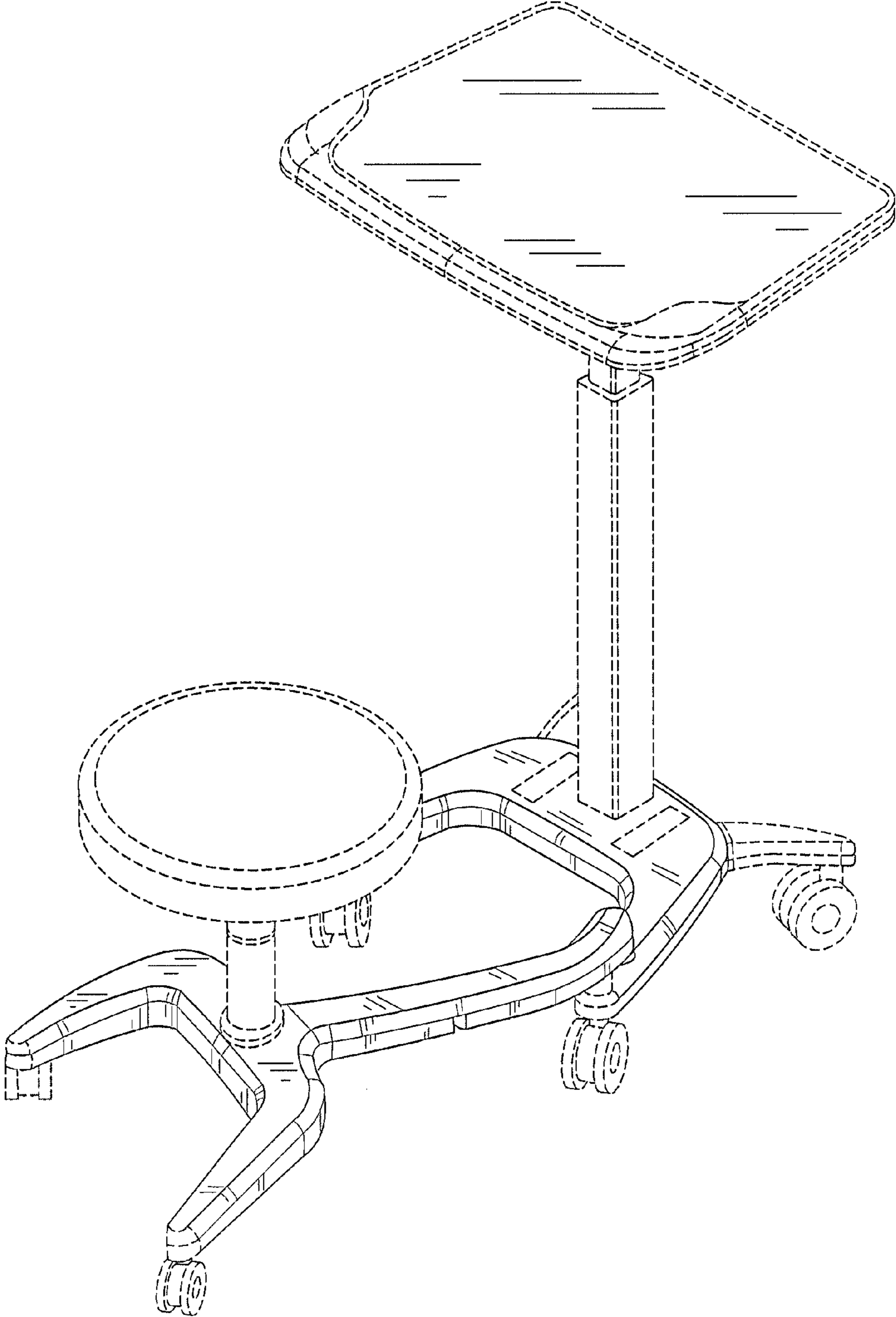

FIG. 2

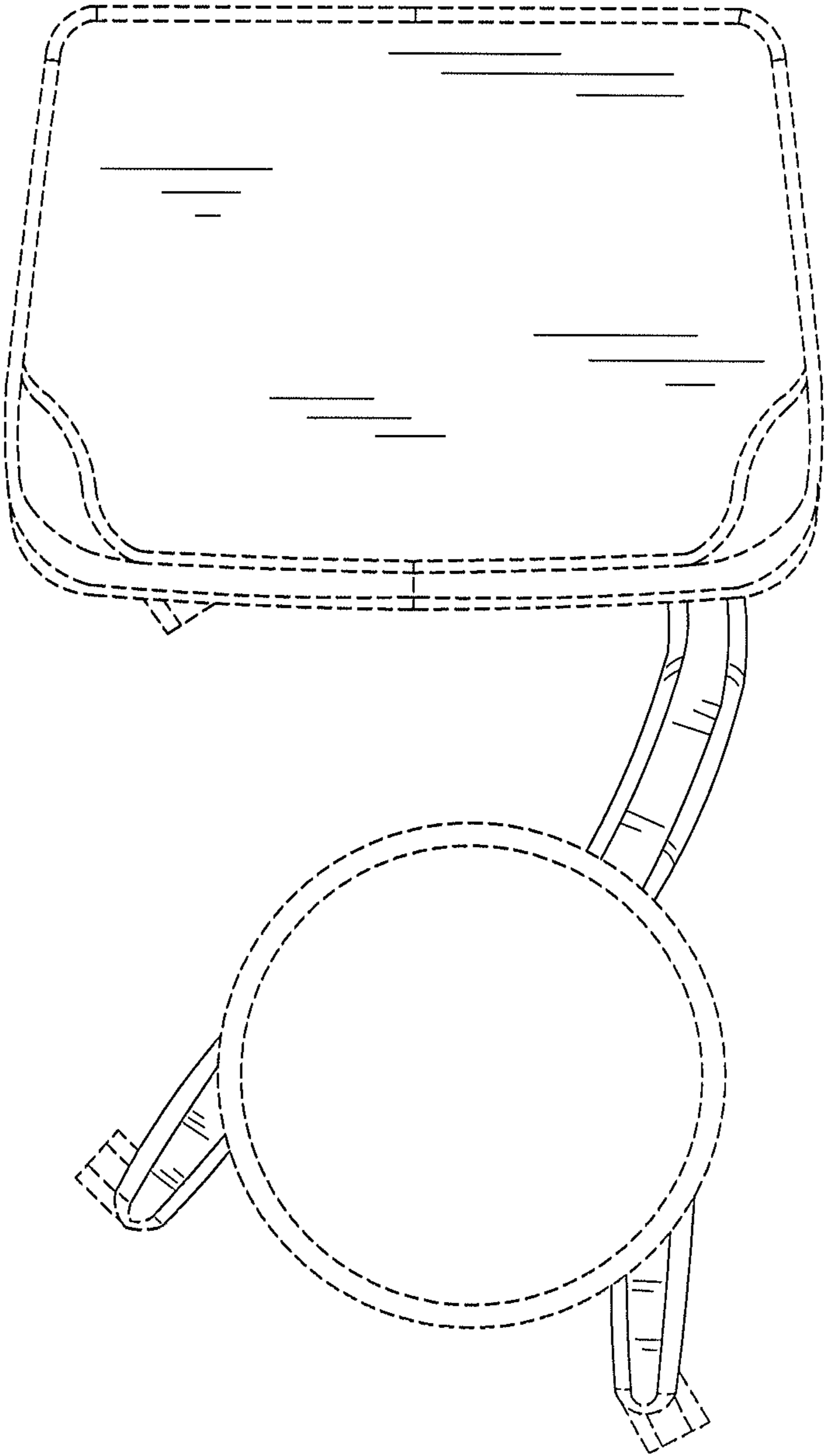

FIG. 3

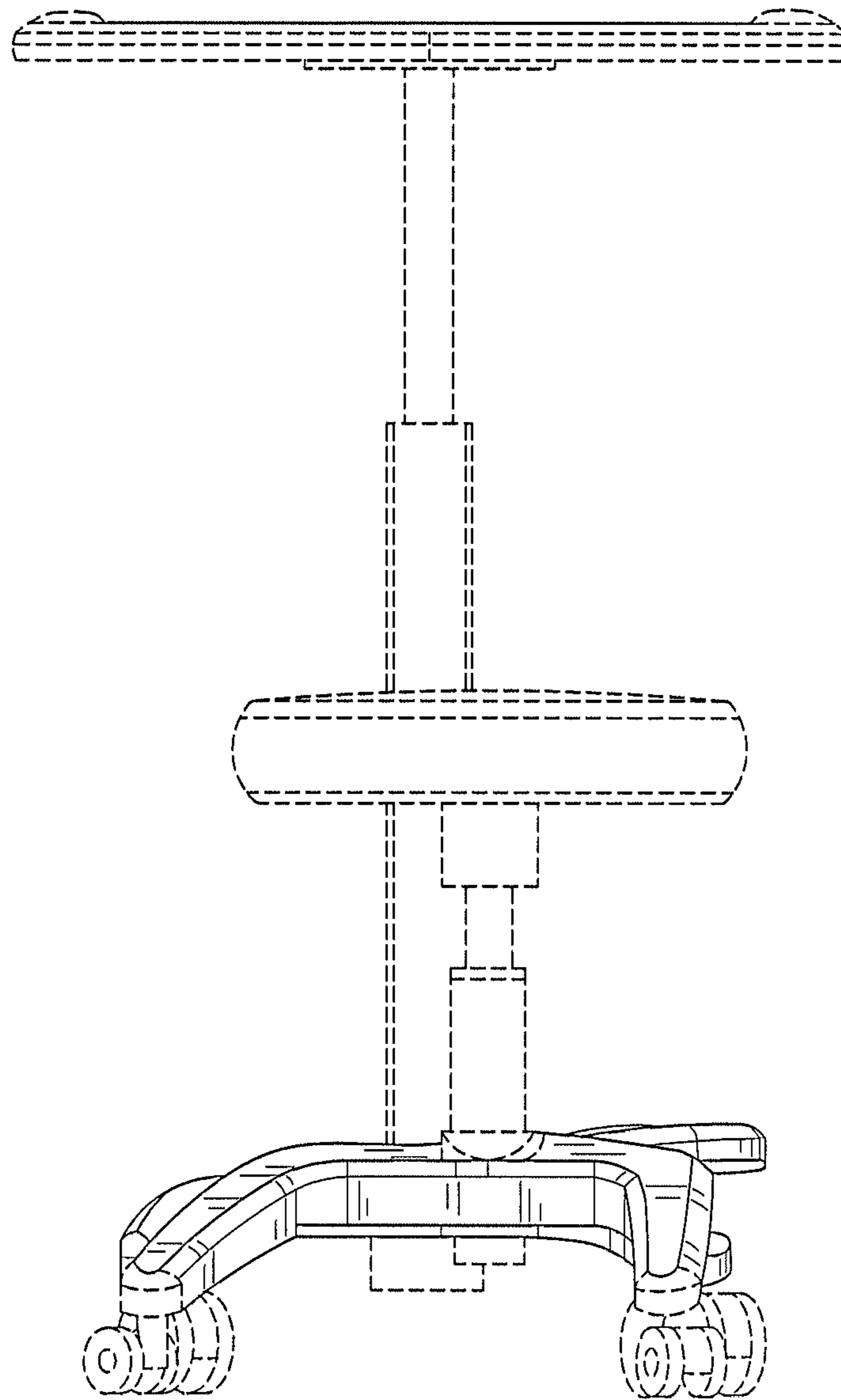

FIG. 4

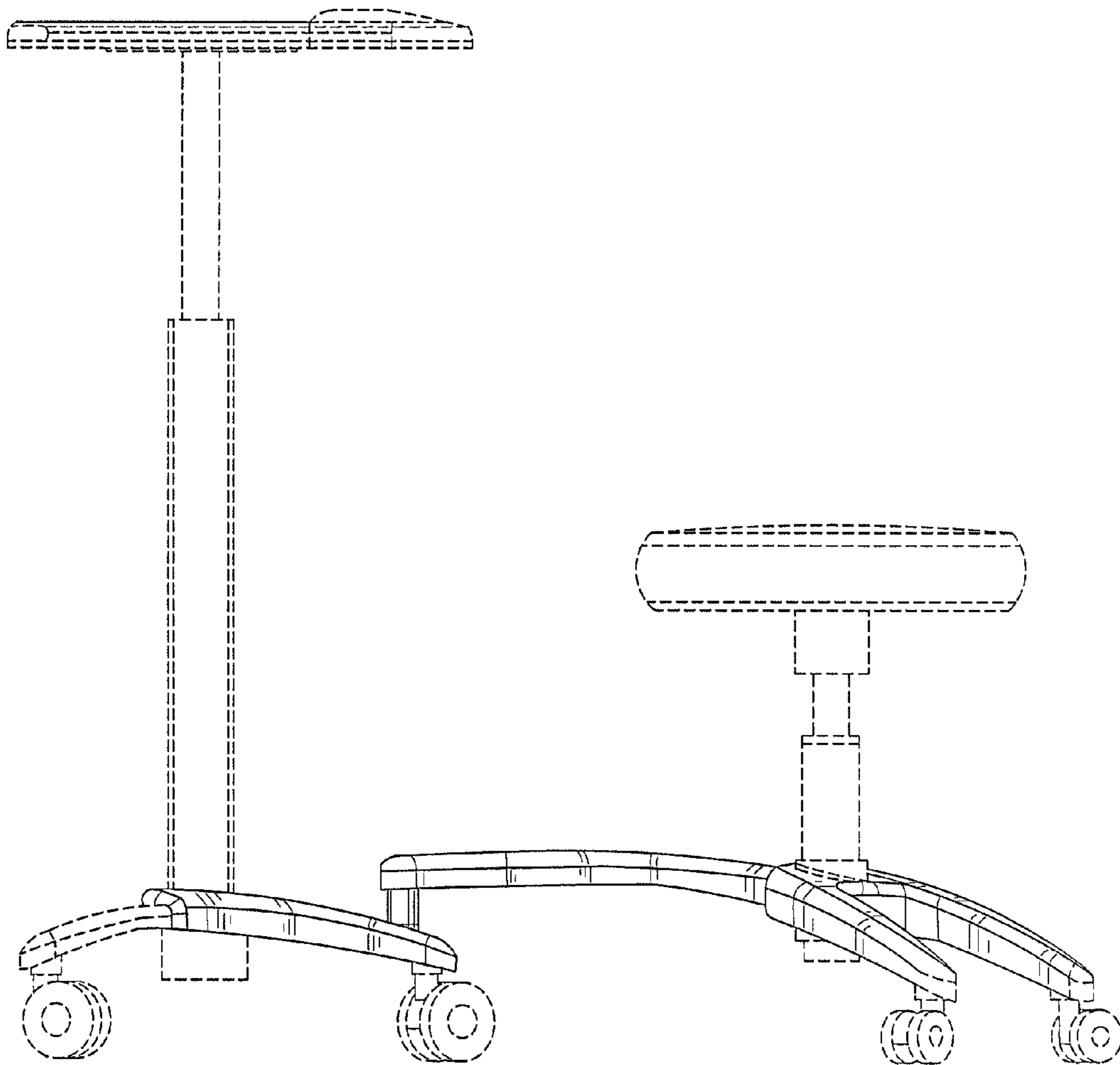

FIG. 5

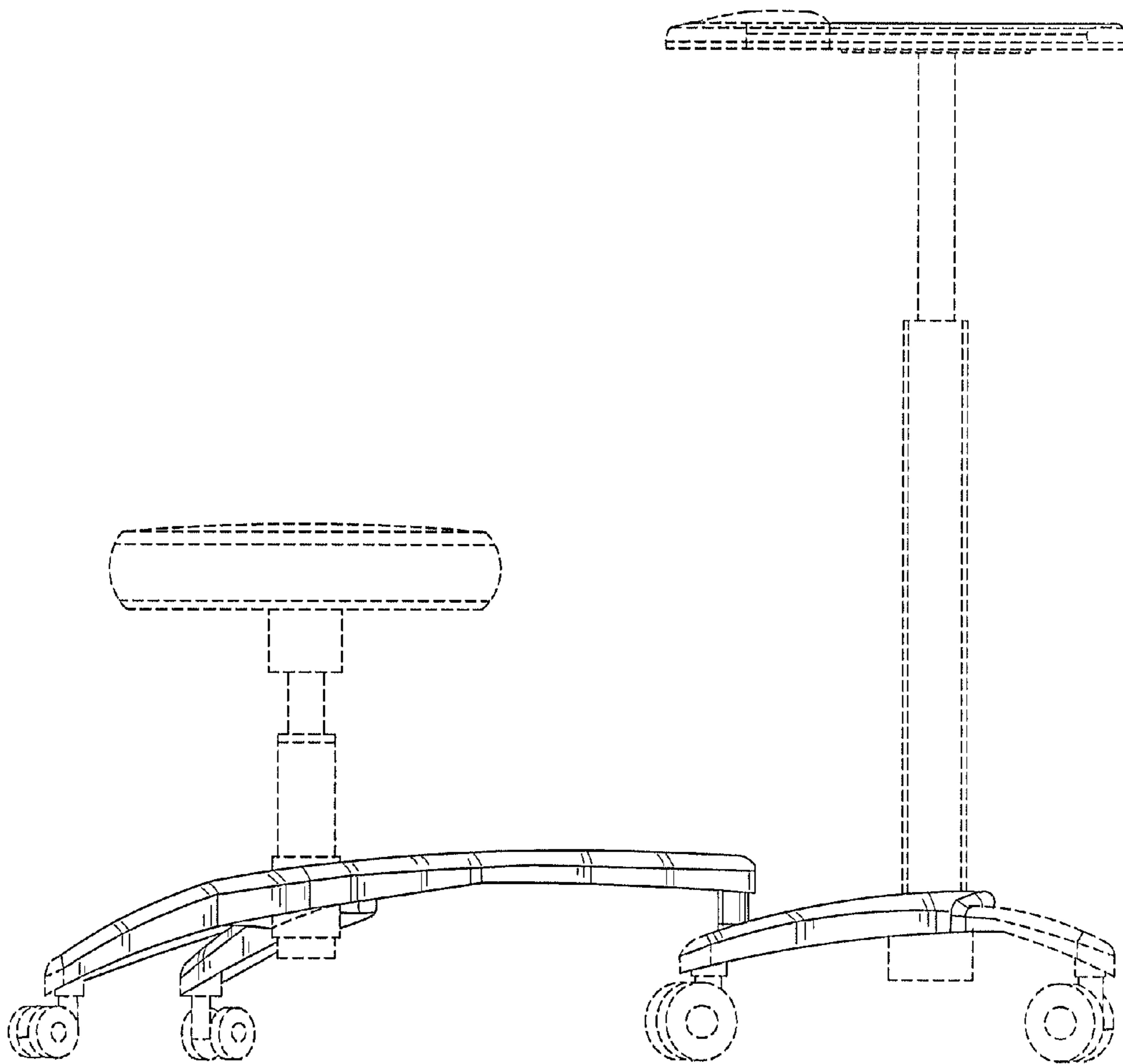

FIG. 6

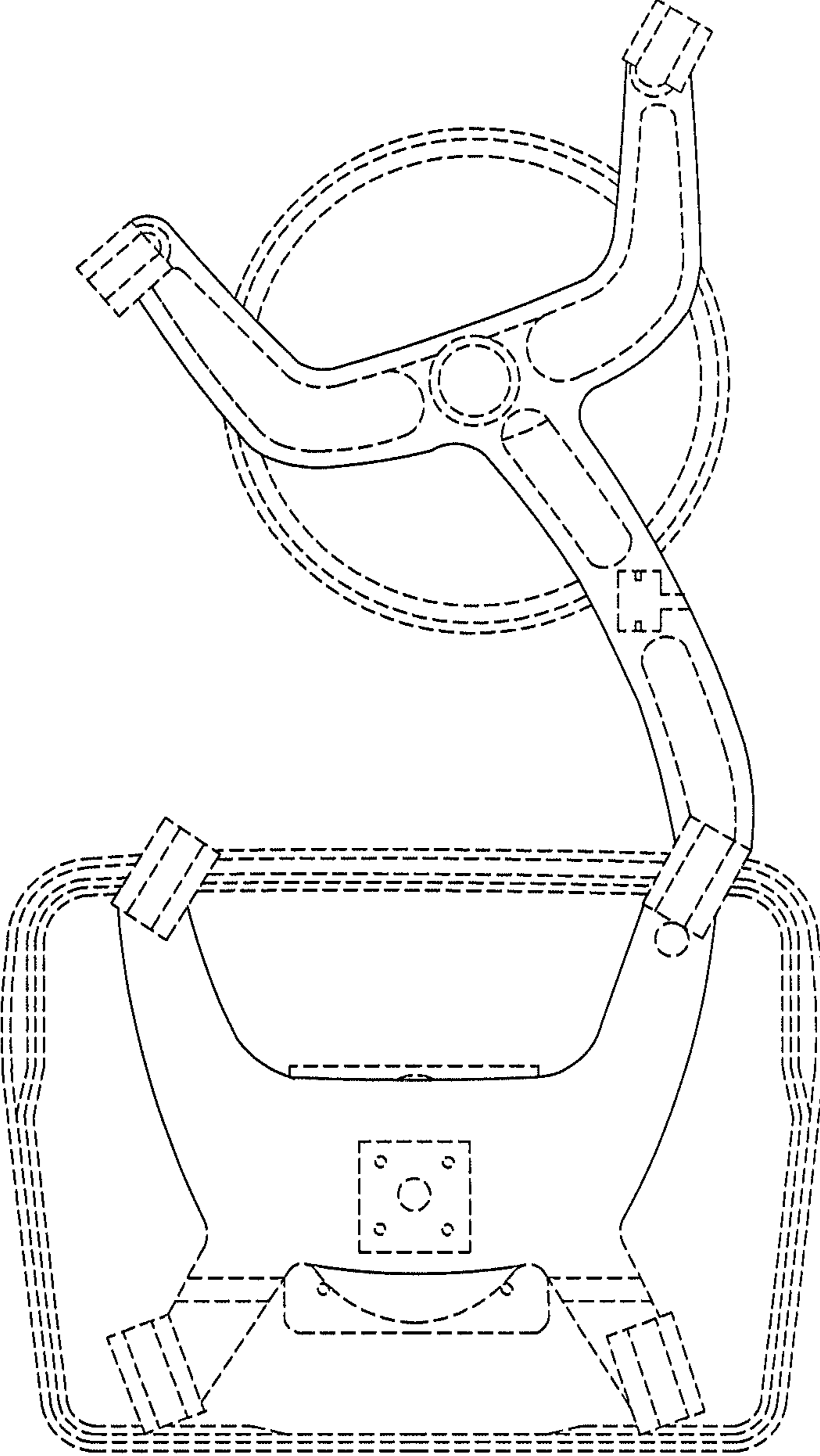

FIG. 7

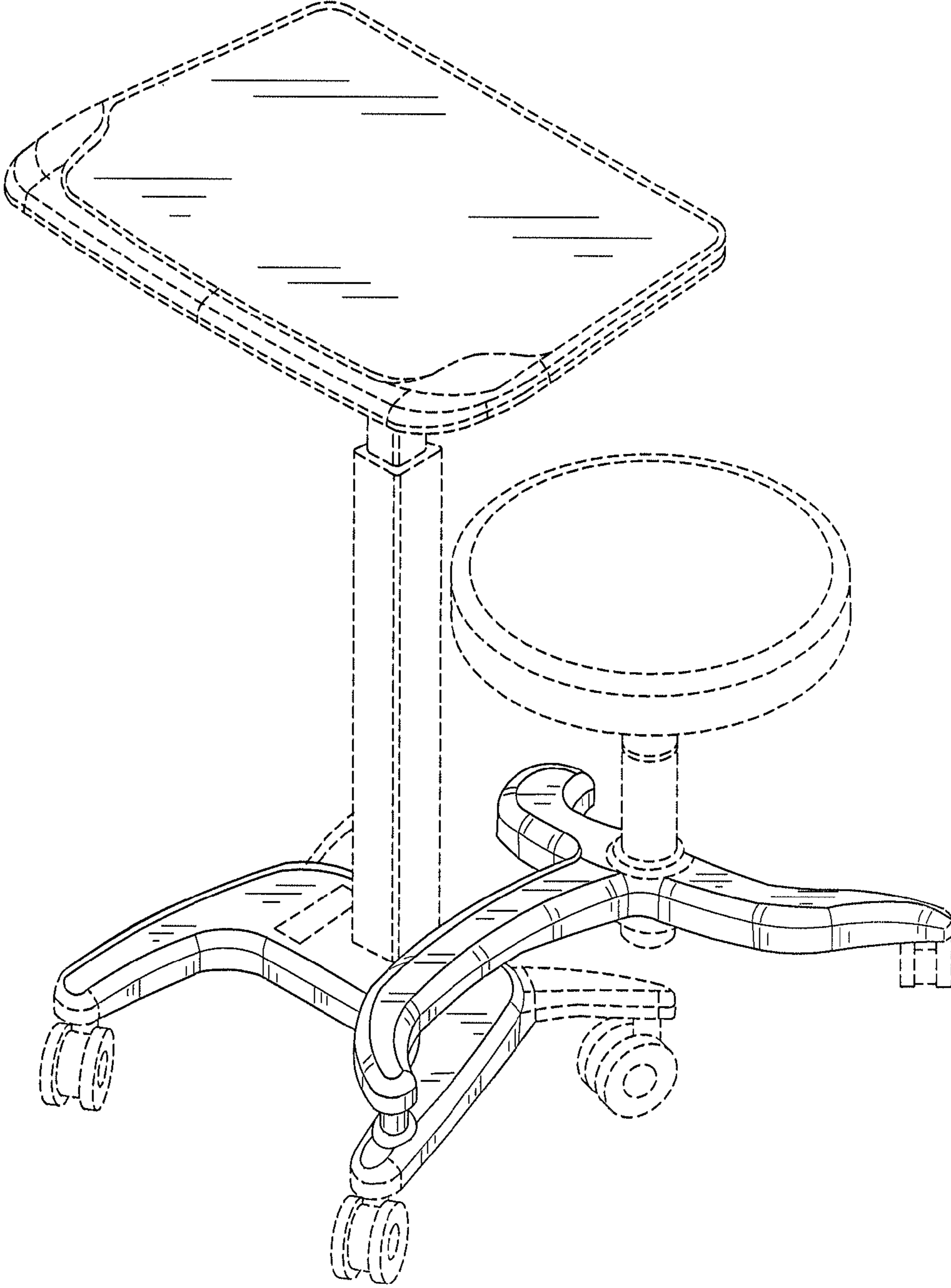

FIG. 8

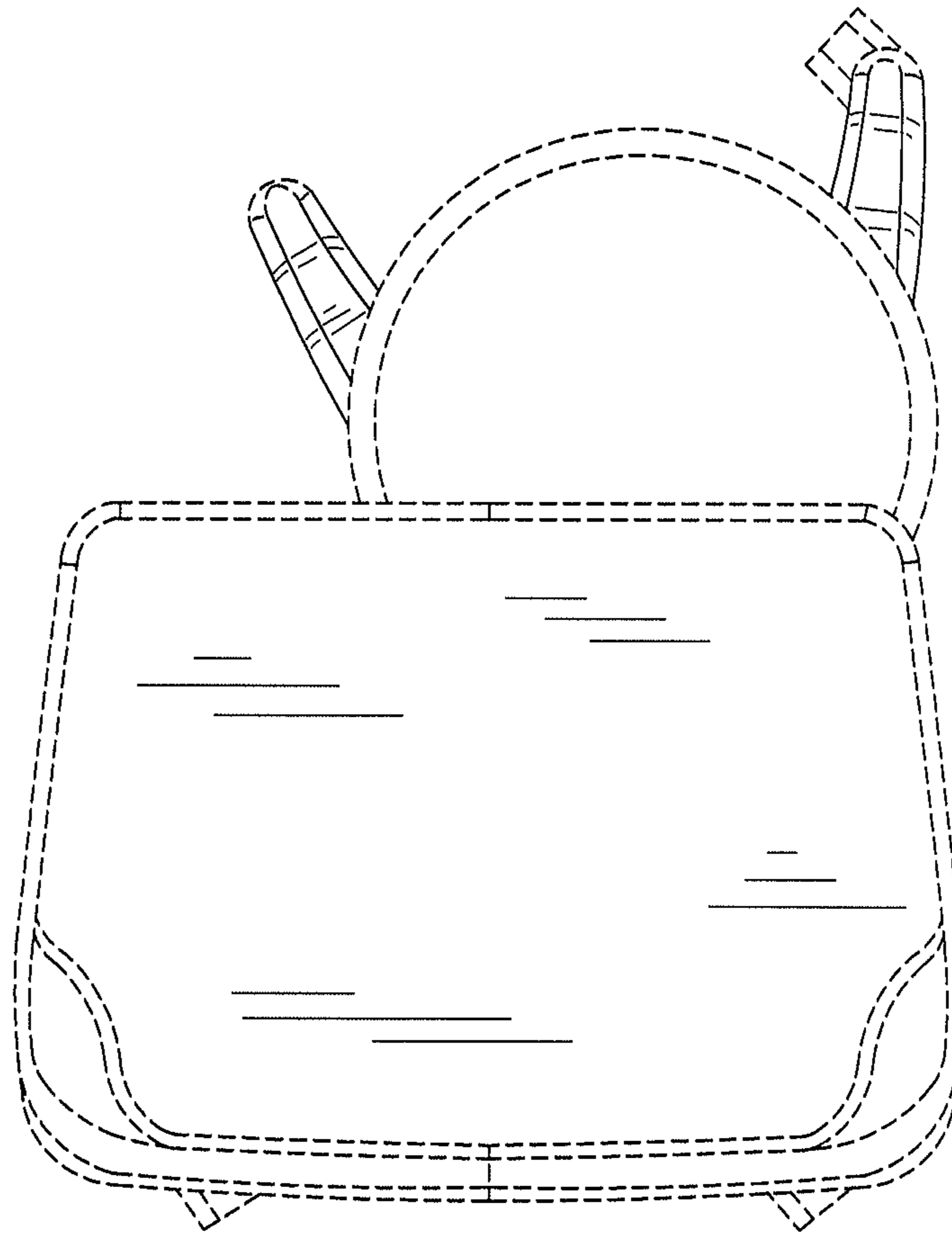

FIG. 9

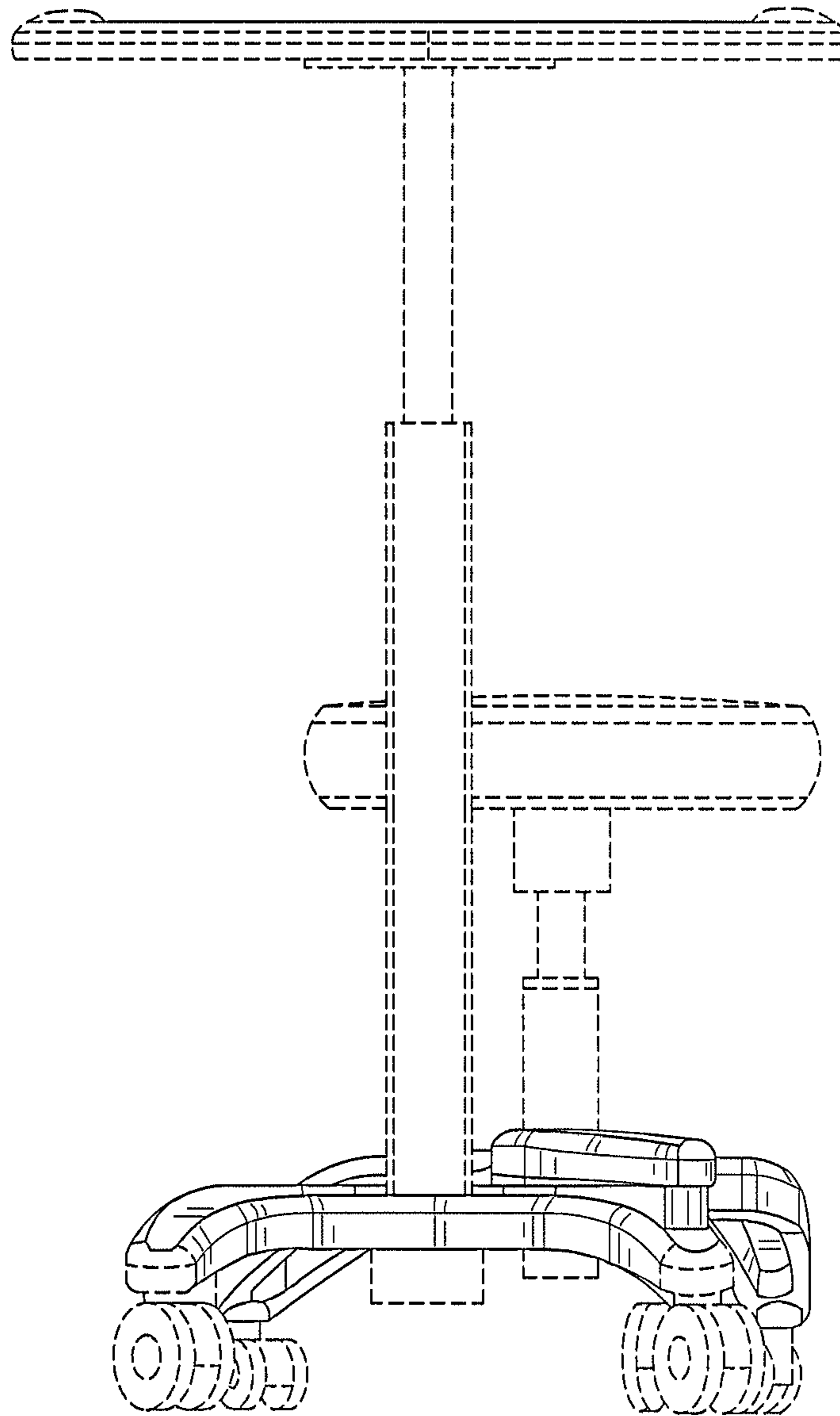

FIG. 10

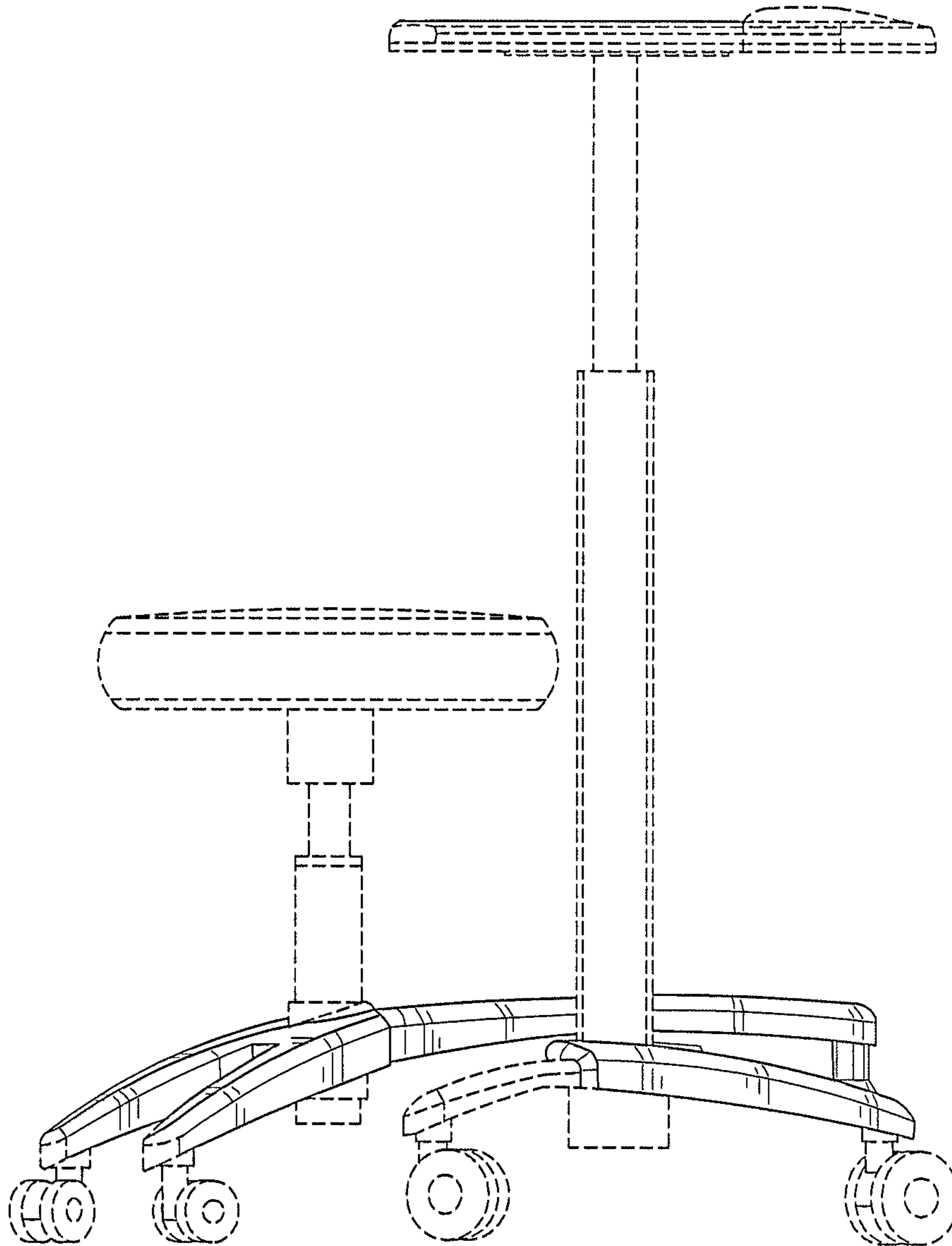

FIG. 11

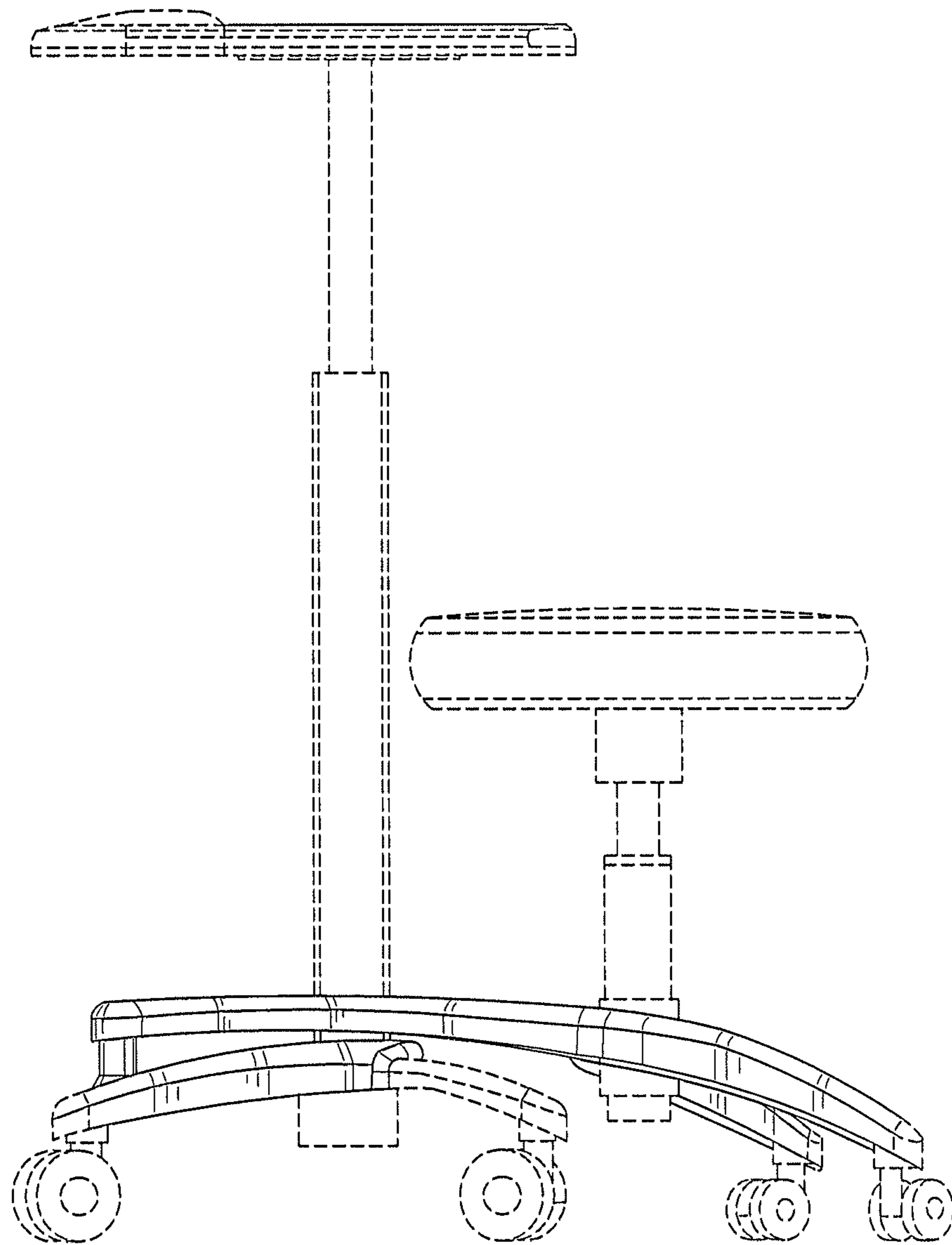

FIG. 12

