



US00D683326S

(12) **United States Design Patent**
Sanlaville

(10) **Patent No.:** **US D683,326 S**

(45) **Date of Patent:** **** May 28, 2013**

(54) **CAR STEREO WITH A TOUCH-SENSITIVE SCREEN**

(75) **Inventor:** **Thierry Sanlaville, Paris (FR)**

(73) **Assignee:** **Parrot, Paris (FR)**

(**) **Term:** **14 Years**

(21) **Appl. No.:** **29/410,352**

(22) **Filed:** **Jan. 6, 2012**

(30) **Foreign Application Priority Data**

Jan. 4, 2012 (EM) 001971300

(51) **LOC (9) Cl.** **14-03**

(52) **U.S. Cl.**
USPC **D14/157**

(58) **Field of Classification Search**
USPC D14/125, 126, 129, 131, 132, 137,
D14/155, 157, 168-171, 188, 194, 197, 198,
D14/239, 257, 258, 496, 498-508, 511;
455/90.1-90.3, 344-355; 369/6-12

See application file for complete search history.

(56) **References Cited**

U.S. PATENT DOCUMENTS

D565,979	S	*	4/2008	Ichikawa et al.	D10/65
D574,796	S	*	8/2008	Yokoyama	D14/132
D582,807	S	*	12/2008	Ichikawa et al.	D10/65
D593,133	S	*	5/2009	Yamamoto	D14/505
D606,095	S	*	12/2009	Tomono	D14/496
D630,184	S	*	1/2011	Tomono et al.	D14/157
D630,185	S	*	1/2011	Tomono et al.	D14/157
D661,692	S	*	6/2012	Sanlaville	D14/240

* cited by examiner

Primary Examiner — Keli L Hill

(74) *Attorney, Agent, or Firm* — Marshall, Gerstein & Borun LLP

(57) **CLAIM**

The ornamental design for a car stereo with a touch-sensitive screen, as shown and described.

DESCRIPTION

FIG. 1 is a front elevation view of a car stereo with a touch-sensitive screen that has the design.
FIG. 2 is a rear elevation view of the article seen in FIG. 1.
FIG. 3 is a top plan view of the article.
FIG. 4 is a left-side elevation view of the article.
FIG. 5 is a right-side elevation view of the article; and,
FIG. 6 is a front, top, and side view of the article.
The broken lines represent parts of the article that form no part of the claimed design.

1 Claim, 6 Drawing Sheets

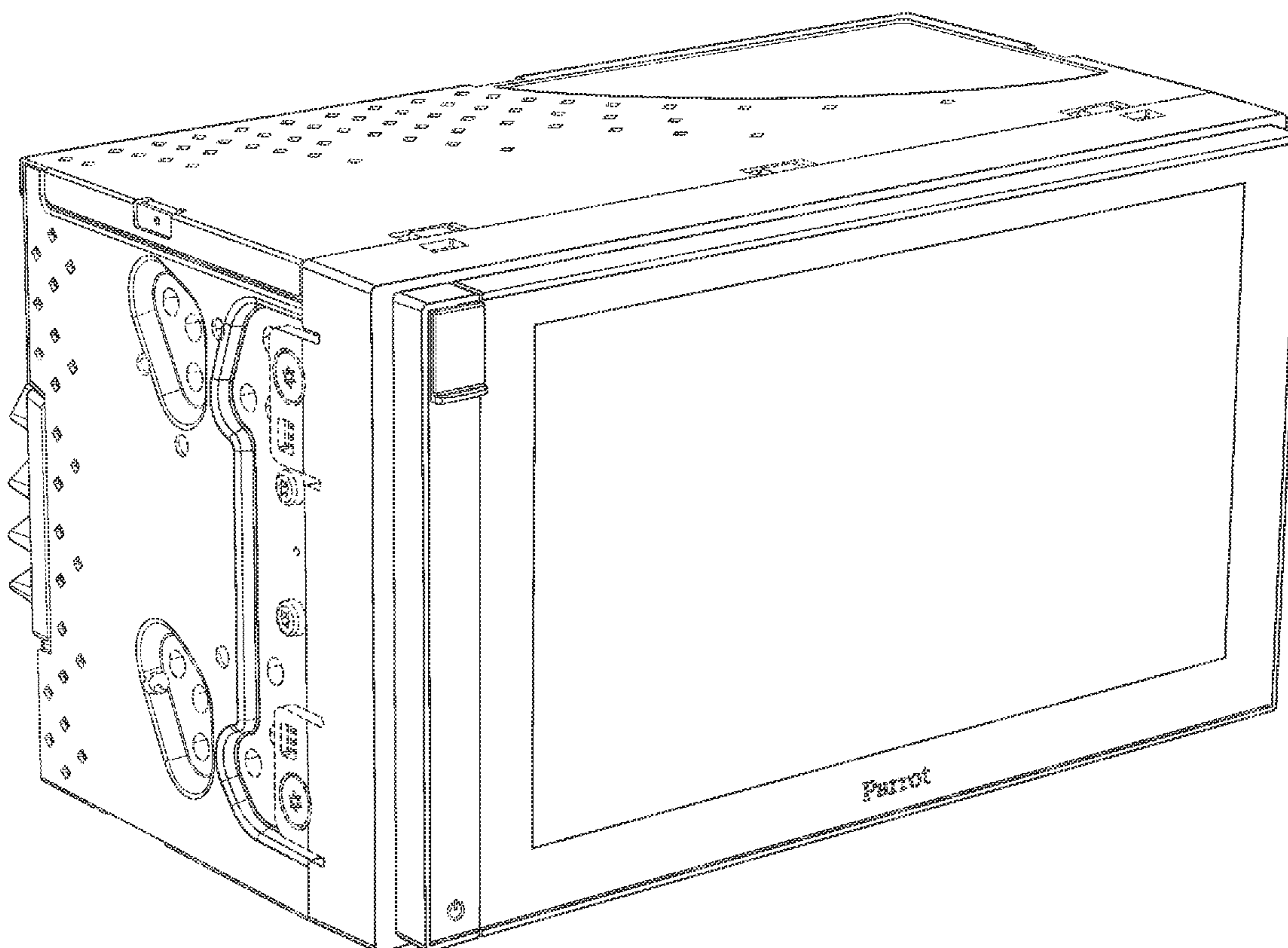

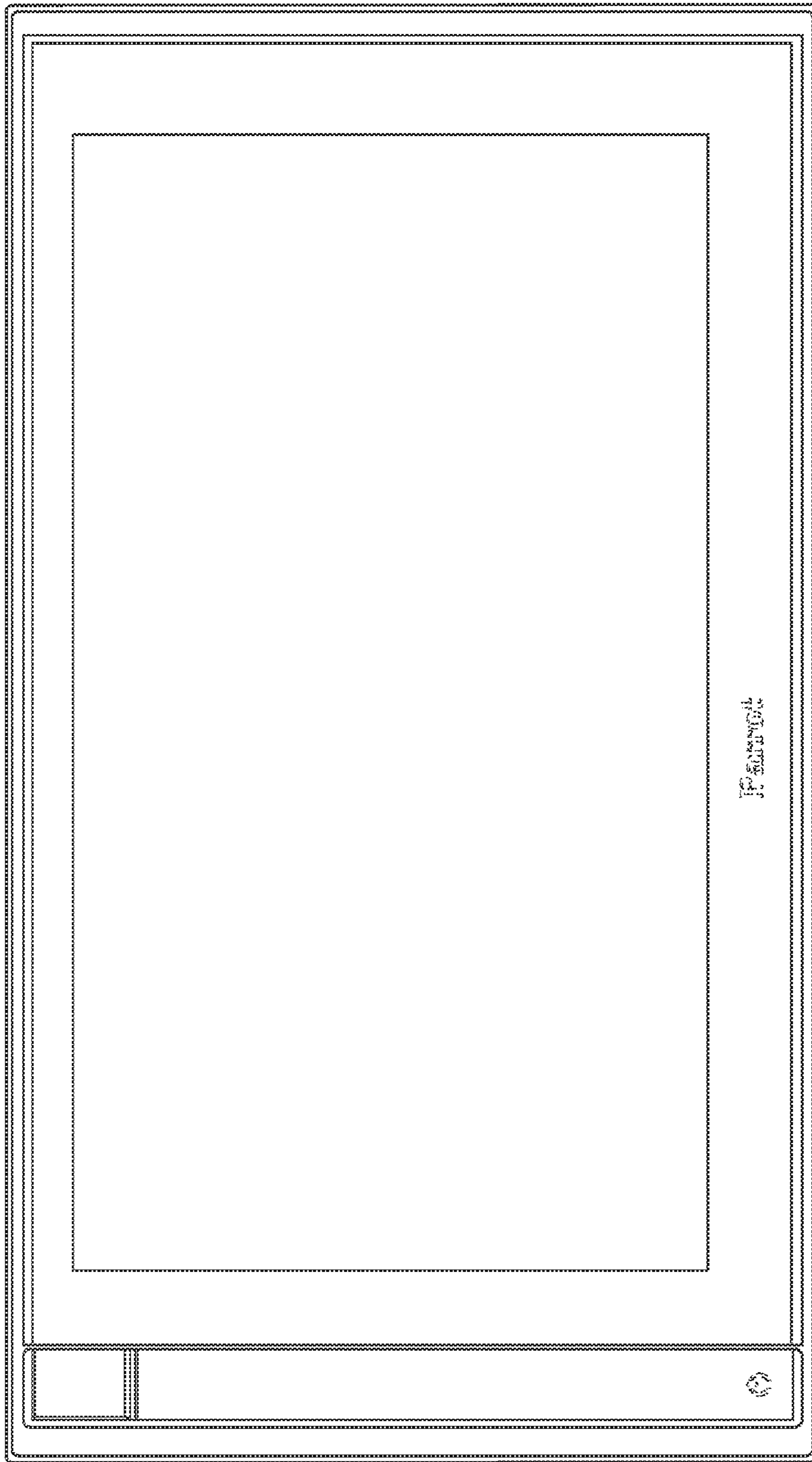

FIG. 1

FIG. 1

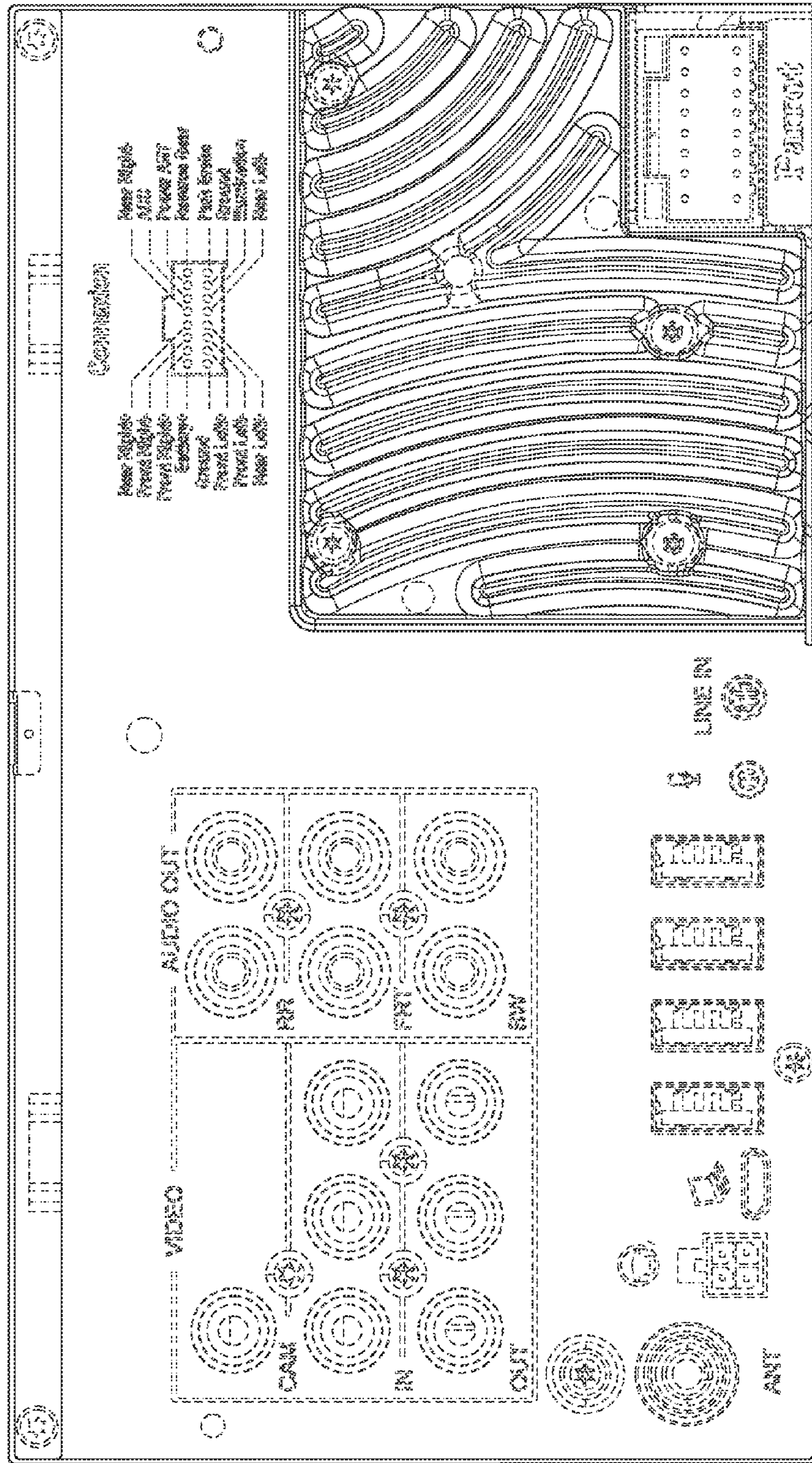

FIG. 2

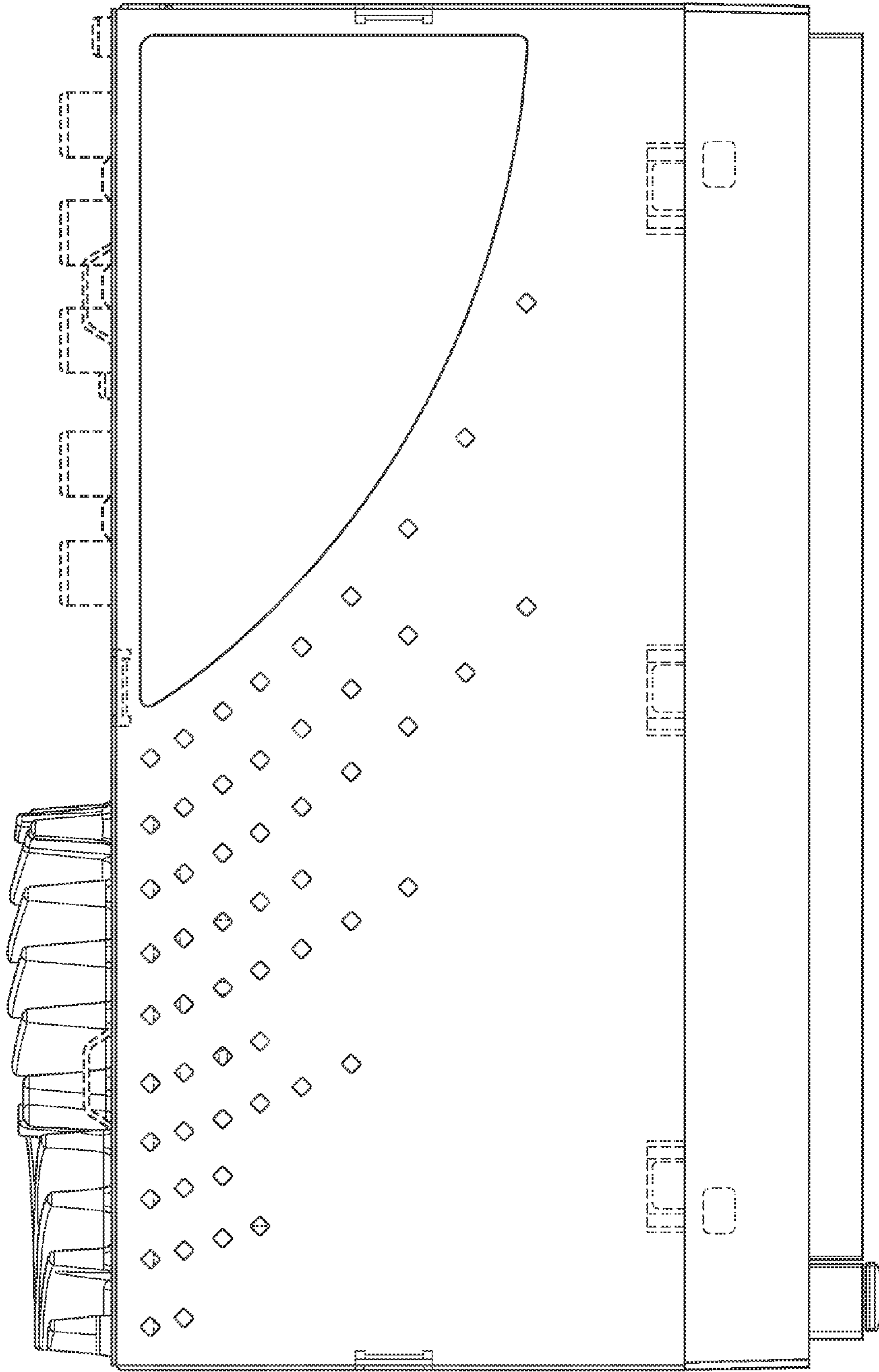

FIG. 3

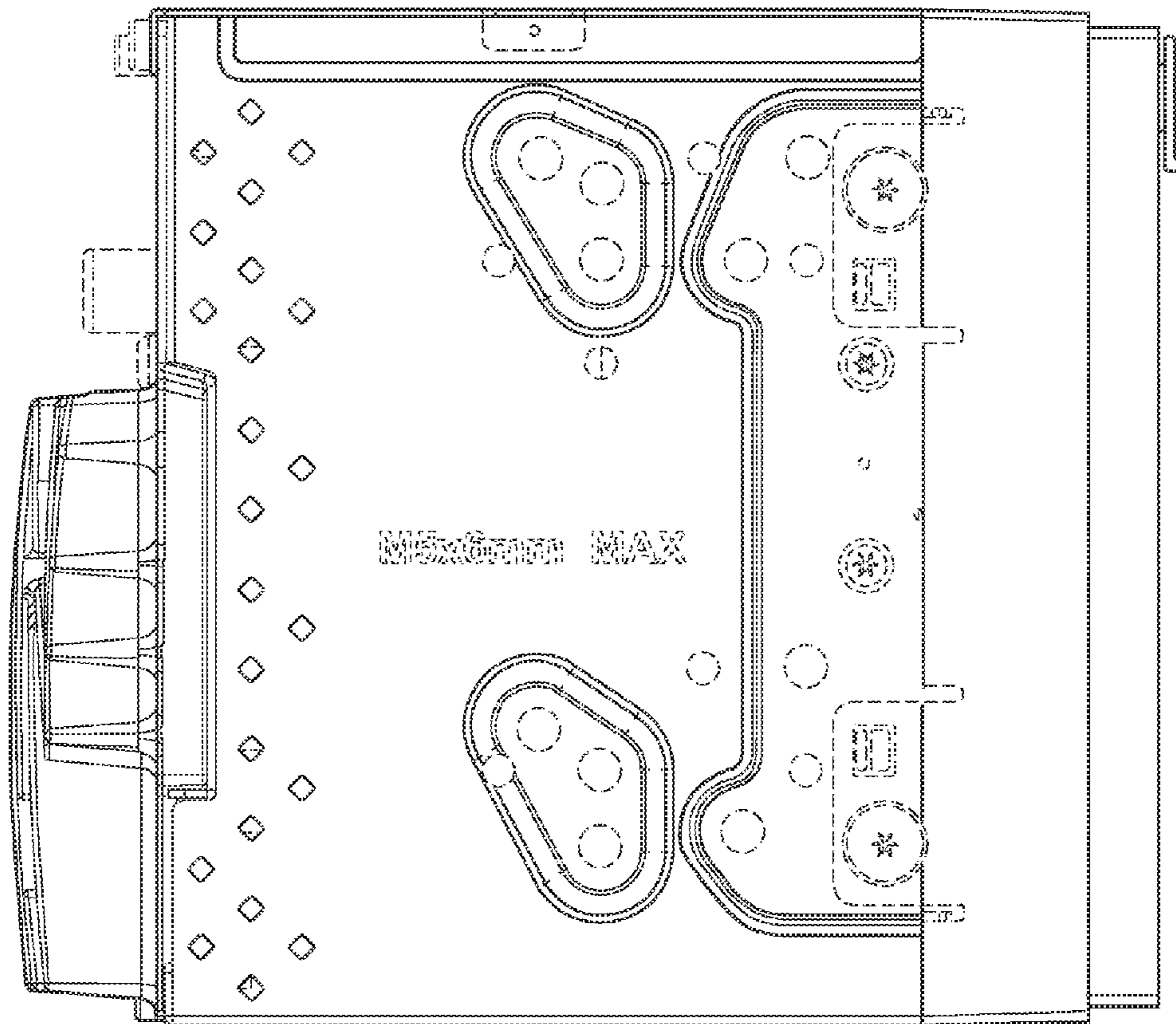

FIG. 4

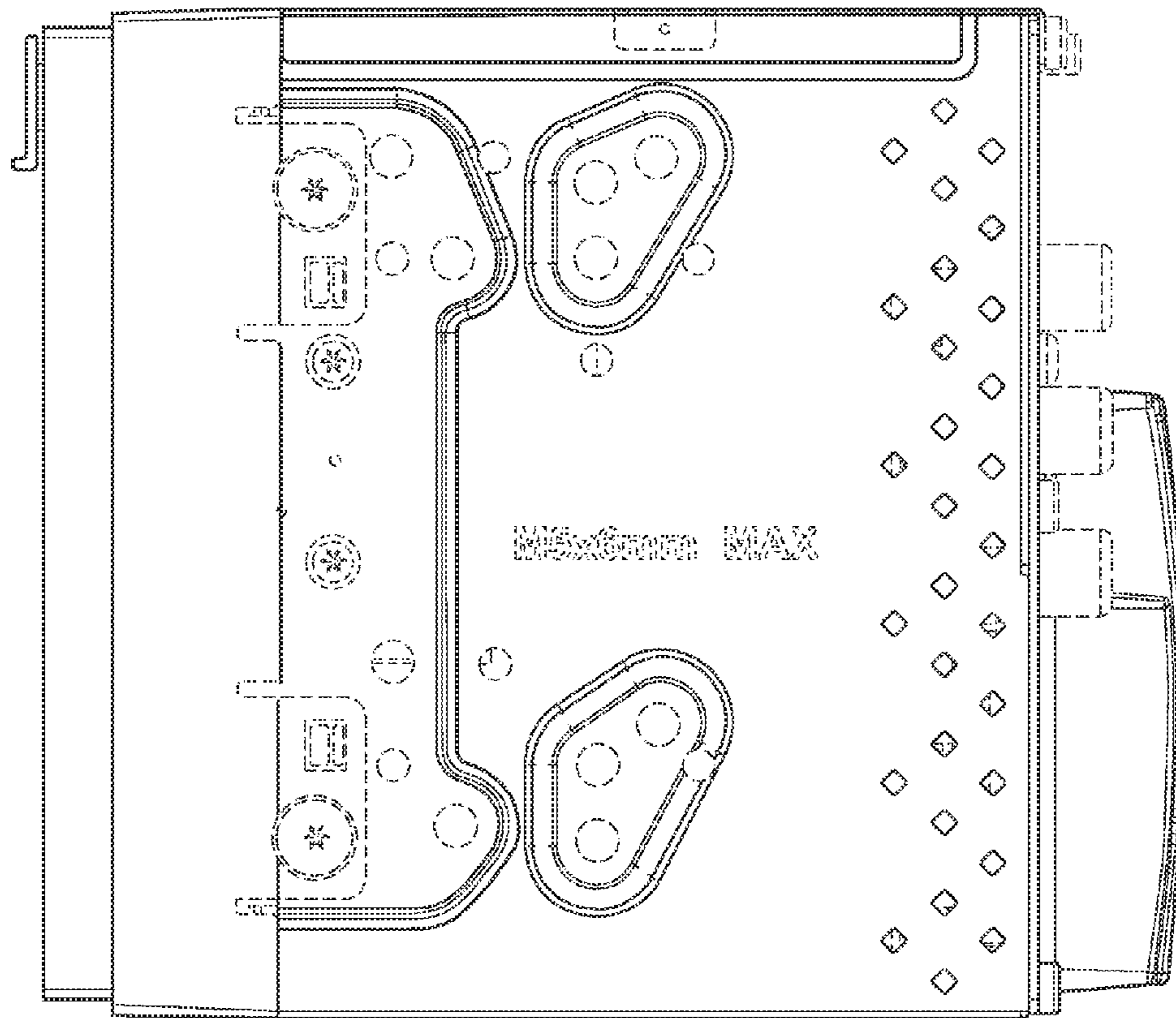

FIG. 5

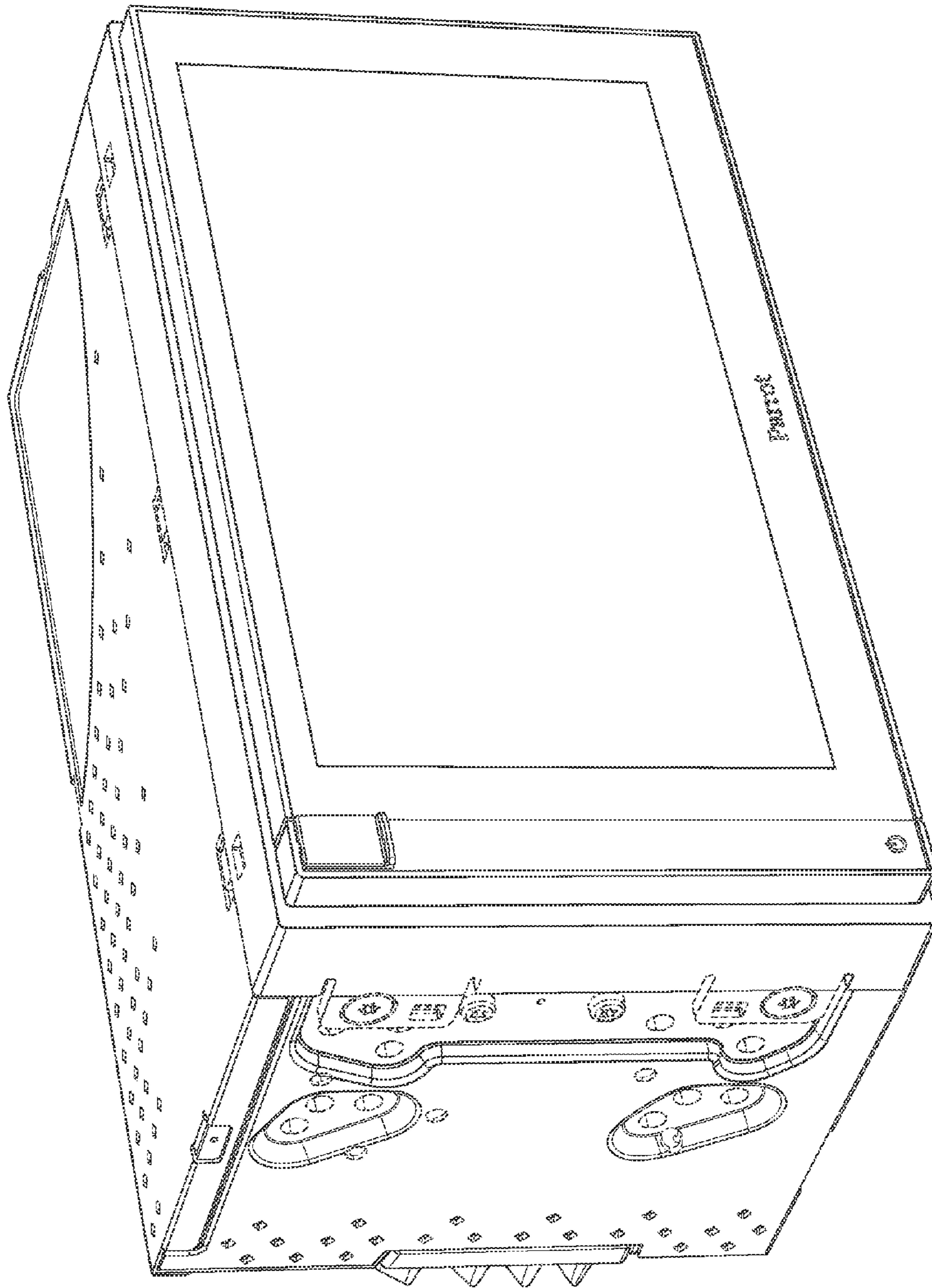

FIG. 6