



US00D681981S

(12) **United States Design Patent**  
**Sharpe et al.**

(10) **Patent No.:** **US D681,981 S**

(45) **Date of Patent:** **\*\* May 14, 2013**

(54) **RETAIL SHELF**

(75) Inventors: **Charles J. Sharpe**, Bella Vista, AR  
(US); **Gregory O C Ota**, Jonesboro, AR  
(US)

(73) Assignee: **L.A. Darling Company LLC**,  
Paragould (AR)

(\*\*) Term: **14 Years**

(21) Appl. No.: **29/404,438**

(22) Filed: **Oct. 20, 2011**

(51) **LOC (9) Cl.** ..... **06-06**

(52) **U.S. Cl.**  
USPC ..... **D6/511**

(58) **Field of Classification Search** ..... D6/317,  
D6/396, 408, 409, 449-450, 454-469, 511,  
D6/566; 211/1, 10, 13.1, 27, 44, 50-53,  
211/59.2, 59.3, 70, 70.1, 86.01, 119.003,  
211/133.5, 134, 153, 163, 181.1, 183-184;  
312/348.3

See application file for complete search history.

(56) **References Cited**

U.S. PATENT DOCUMENTS

4,416,380	A *	11/1983	Flum	.....	211/59.2
D317,094	S *	5/1991	Weinberg et al.	.....	D6/463
5,351,842	A *	10/1994	Remmers	.....	211/90.03
D369,037	S *	4/1996	Wyatt et al.	.....	D6/465
D423,857	S *	5/2000	Shea	.....	D6/566
D437,515	S *	2/2001	Remmers et al.	.....	D6/511

D473,359	S *	4/2003	Joseph	.....	D32/55
D479,930	S *	9/2003	Cook et al.	.....	D6/511
D485,109	S *	1/2004	Oberhaus	.....	D6/574
D489,205	S *	5/2004	Droppers et al.	.....	D6/511
D521,286	S *	5/2006	Colmenares	.....	D6/511
D544,250	S *	6/2007	Daugherty et al.	.....	D6/463
D547,955	S *	8/2007	Johnson et al.	.....	D6/566
D585,216	S *	1/2009	Colin	.....	D6/462
D592,427	S *	5/2009	Meyer et al.	.....	D6/462
D627,180	S *	11/2010	McCombs et al.	.....	D6/511
D630,397	S *	1/2011	Molayem	.....	D32/55
D657,171	S *	4/2012	Chapman et al.	.....	D6/510
2002/0170870	A1 *	11/2002	Callis	.....	211/119.003

\* cited by examiner

*Primary Examiner* — Kelley Donnelly

(74) *Attorney, Agent, or Firm* — DLA Piper US LLP;  
Jennifer E. Lacroix, Esq.

(57) **CLAIM**

The ornamental design for a retail shelf, as shown and described.

**DESCRIPTION**

FIG. 1 is a perspective view of the retail shelf;  
FIG. 2 is a front elevational view of the retail shelf;  
FIG. 3 is a rear elevational view of the retail shelf;  
FIG. 4 is a left side elevational view of the retail shelf, the  
opposite side of which is an identical mirror image;  
FIG. 5 is a top plan view of the retail shelf; and,  
FIG. 6 is a bottom plan view of the retail shelf.

**1 Claim, 4 Drawing Sheets**

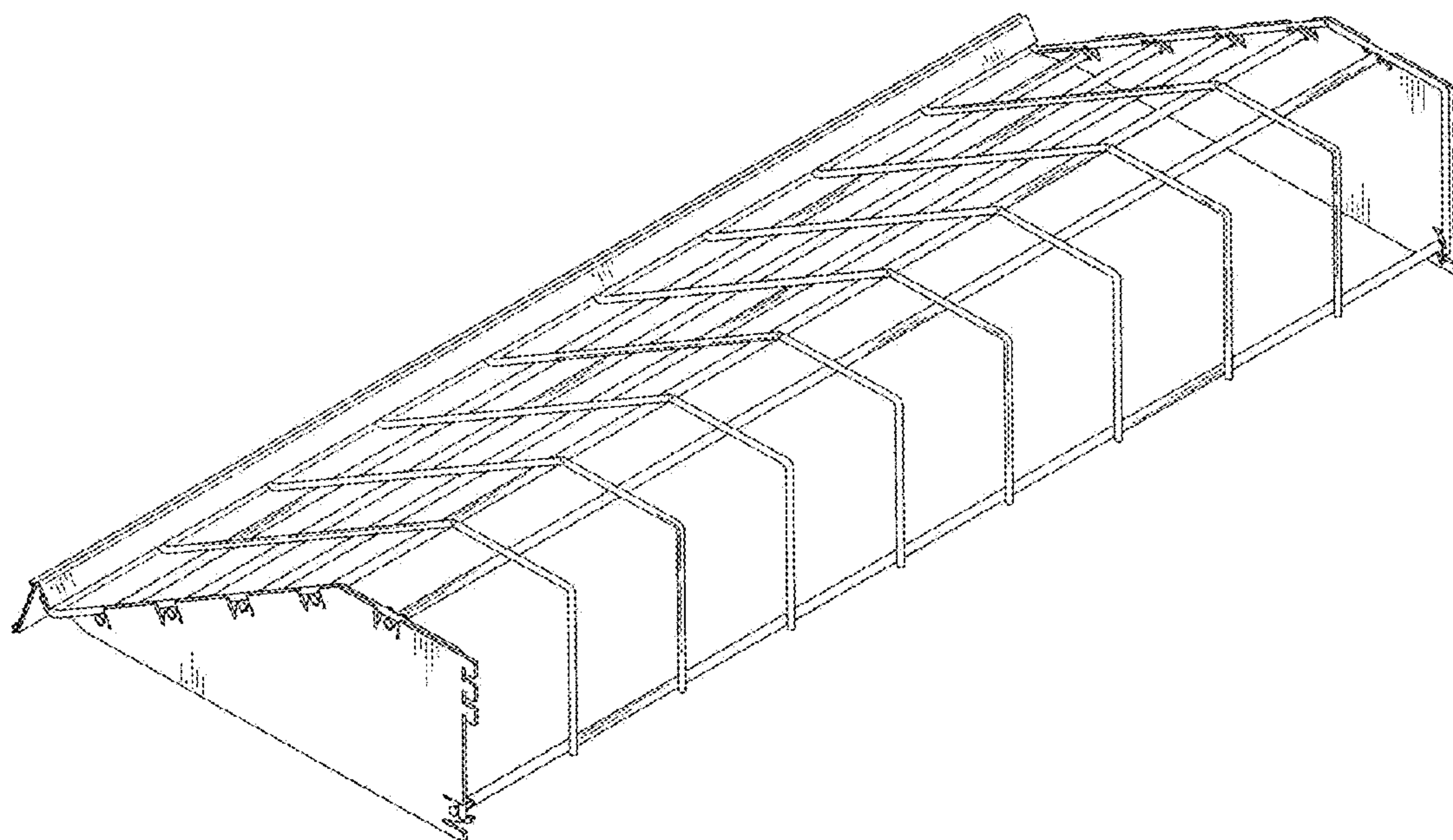

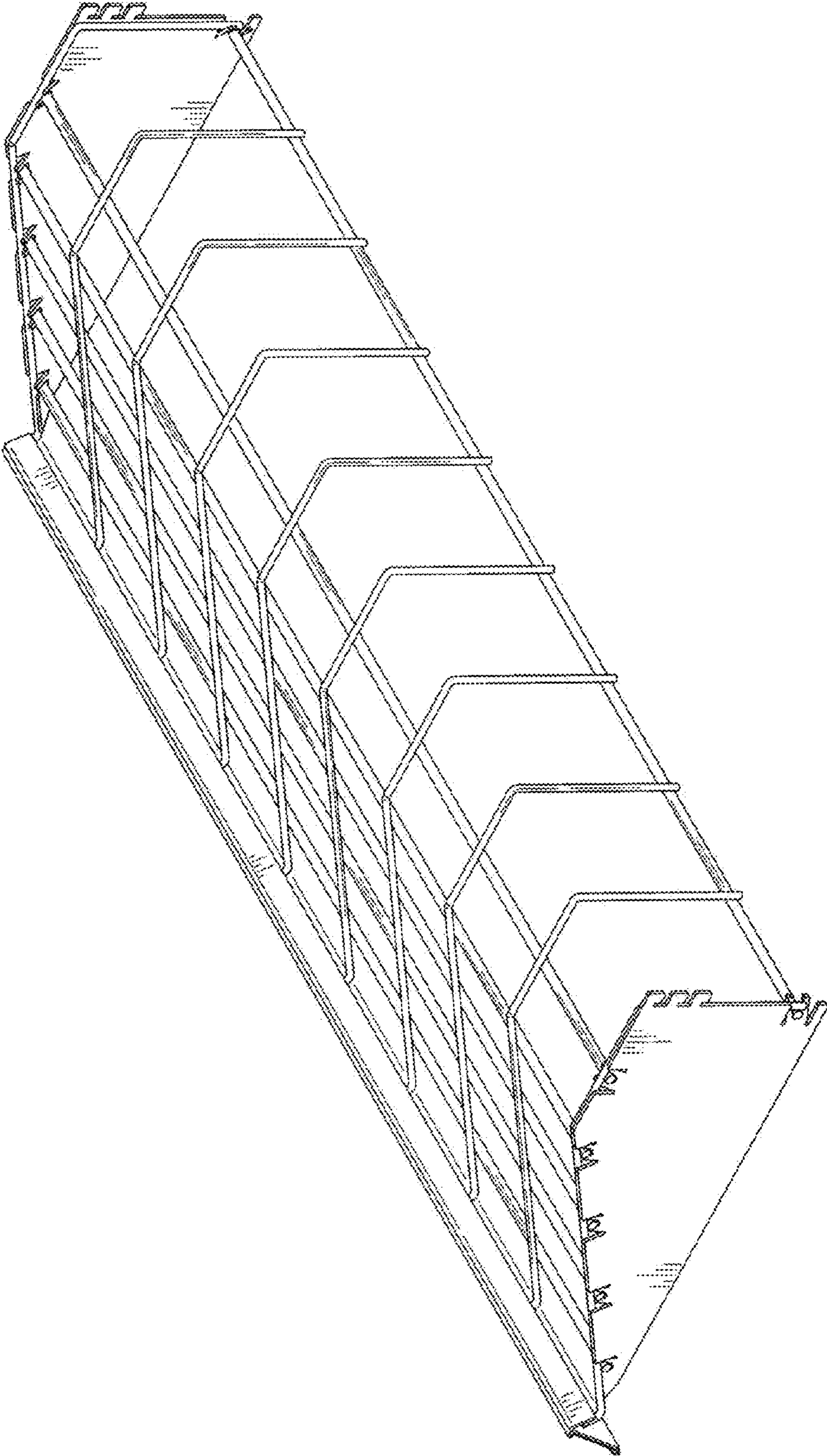

FIG. 1



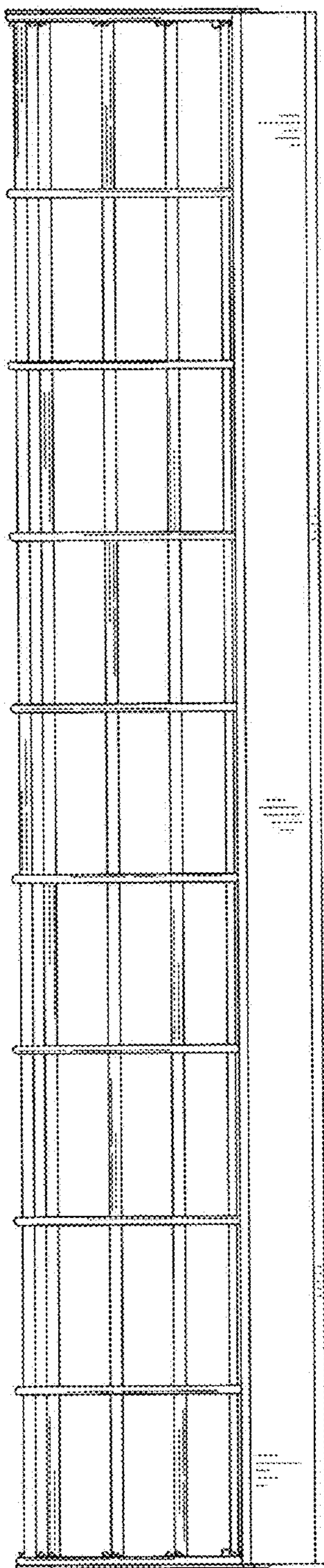

FIG. 2

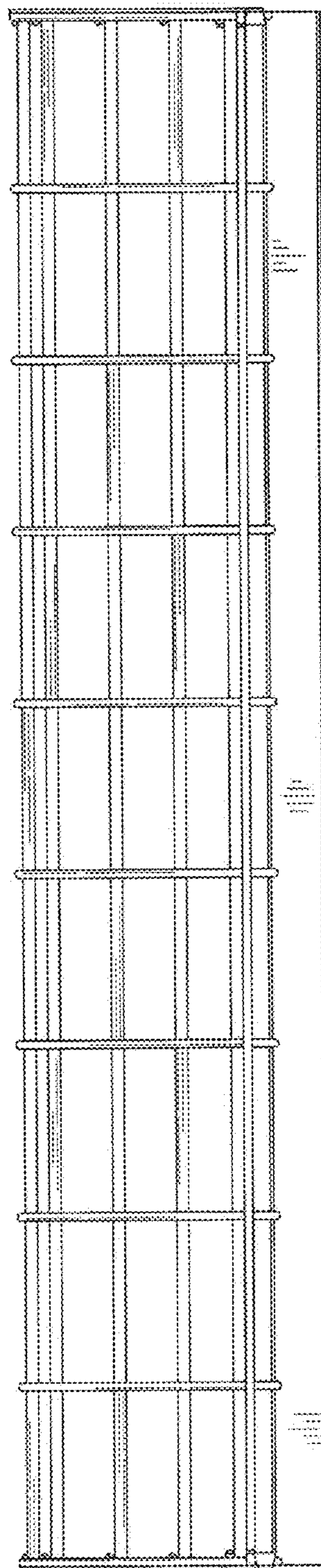

FIG. 3

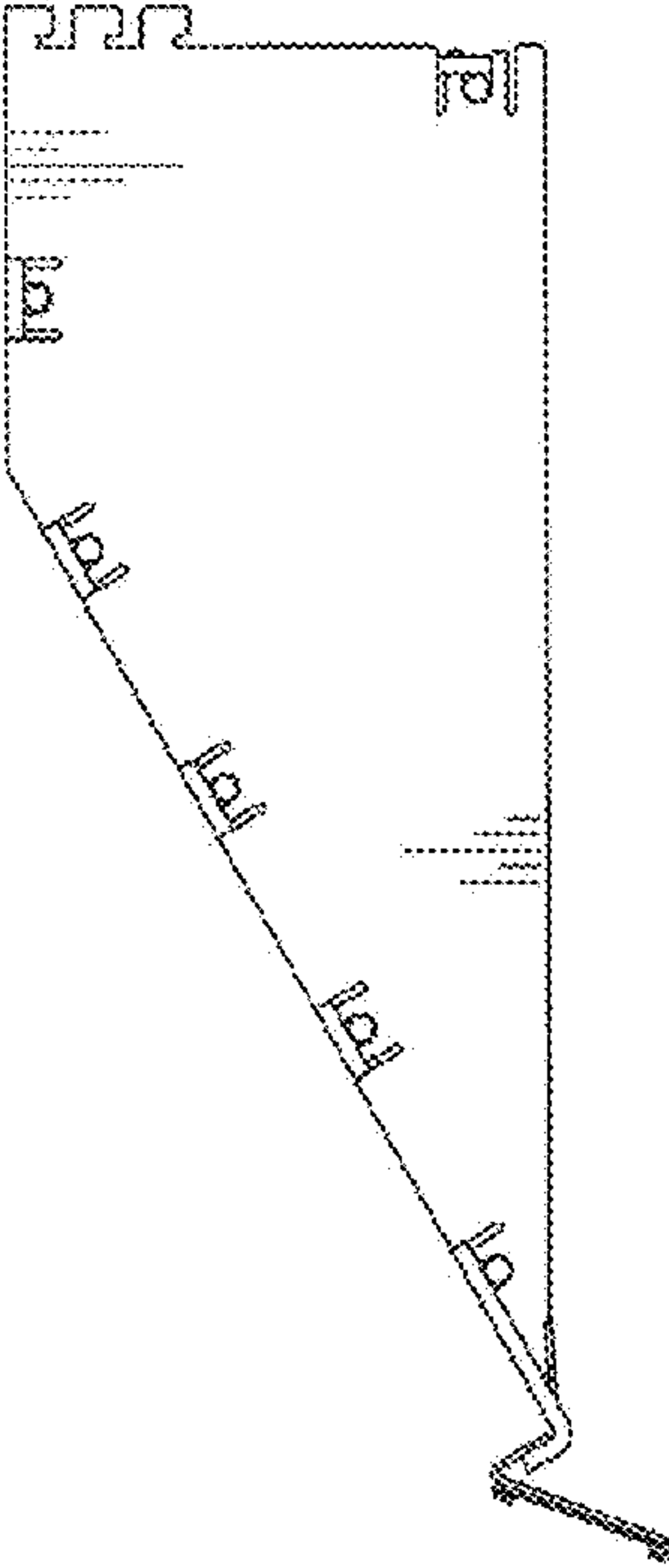

FIG. 4

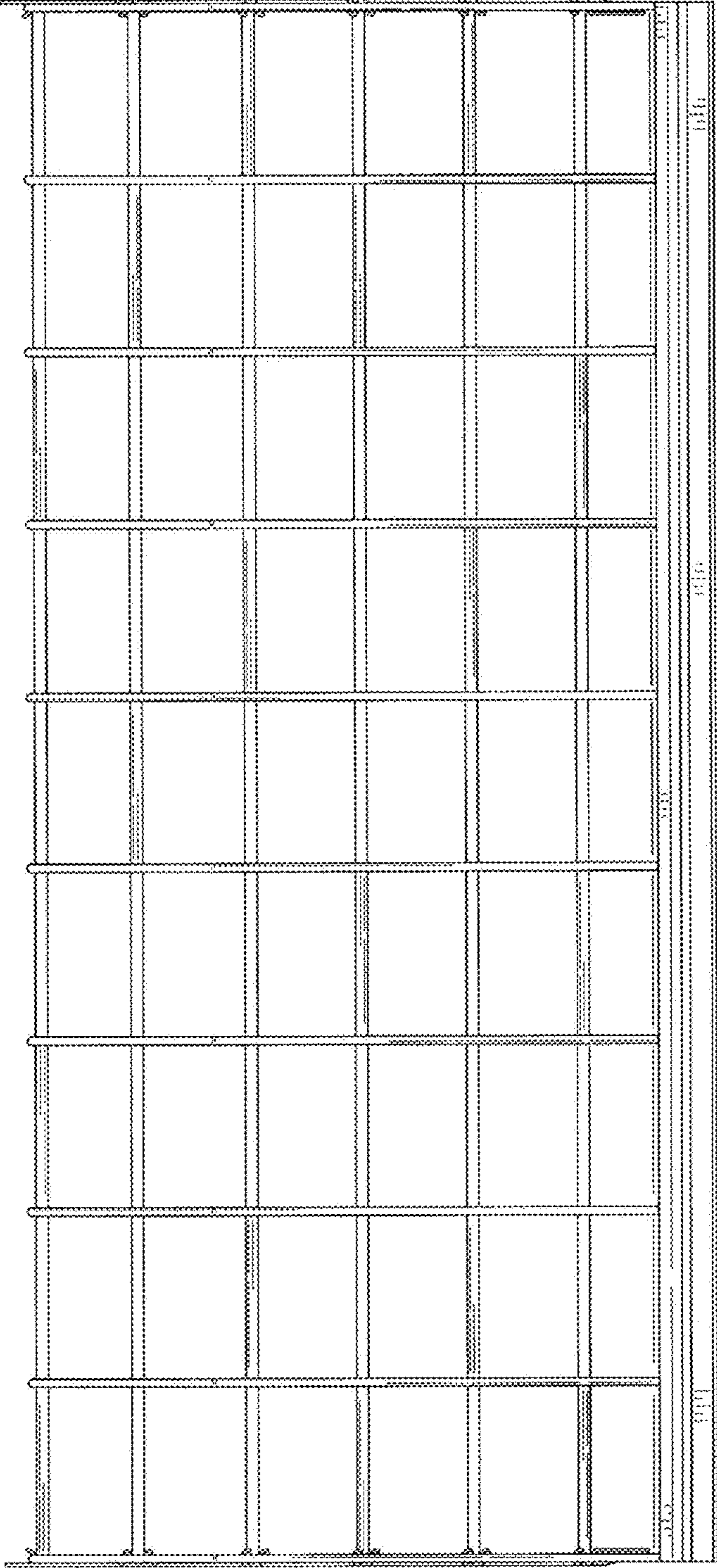

FIG. 5



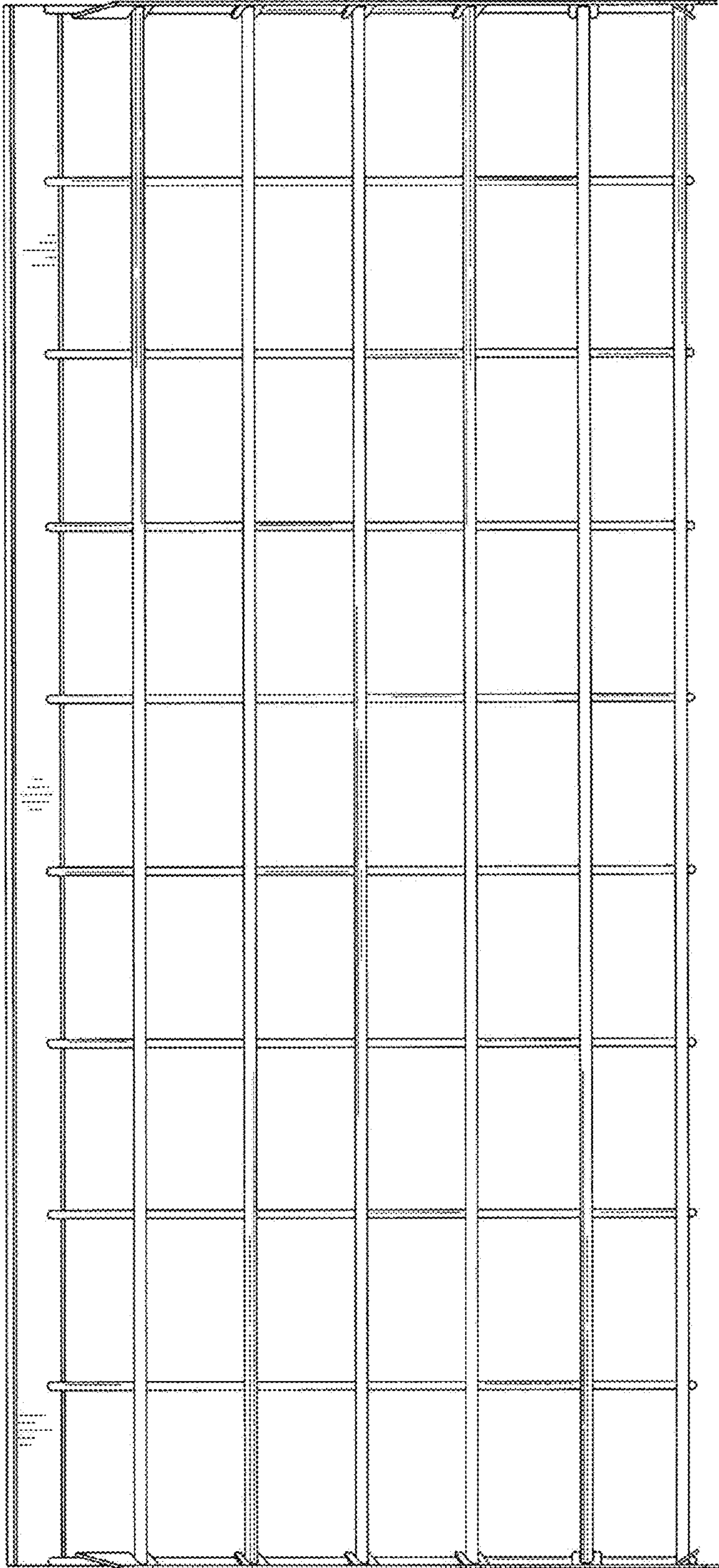

FIG. 6