



US00D681701S

(12) **United States Design Patent**  
**Banjo**

(10) **Patent No.:** **US D681,701 S**  
(45) **Date of Patent:** **\*\* May 7, 2013**

- (54) **LOG SPLITTER BEAM**
- (71) Applicant: **Frictionless World LLC**, Louisville, CO (US)
- (72) Inventor: **Daniel Banjo**, Boulder, CO (US)
- (73) Assignee: **Frictionless World LLC**, Louisville, CO (US)
- (\*\*) Term: **14 Years**
- (21) Appl. No.: **29/436,770**
- (22) Filed: **Nov. 8, 2012**
- (51) **LOC (9) Cl.** ..... **15-09**
- (52) **U.S. Cl.**  
USPC ..... **D15/127**
- (58) **Field of Classification Search** ..... D8/47;  
D15/127, 133, 199; 83/468.1, 471.2, 471.3,  
83/477.2, 486.1, 574, 701, 928; 108/12,  
108/19; 144/193.1-195.8, 286.5, 287, 366;  
254/104; 269/1  
See application file for complete search history.

D544,505 S	6/2007	VanderBurgh et al.	
D585,915 S *	2/2009	Feng .....	D15/127
D617,354 S *	6/2010	Banjo et al. ....	D15/127
7,882,868 B2 *	2/2011	Lessard .....	144/193.1
D648,761 S	11/2011	Banjo et al.	
2004/0250895 A1 *	12/2004	Marx .....	144/193.1
2005/0284540 A1 *	12/2005	Walker et al. ....	144/193.2
2005/0284541 A1 *	12/2005	Walker et al. ....	144/193.2
2007/0000975 A1 *	1/2007	Paradise .....	228/182
2008/0251158 A1 *	10/2008	Koch .....	144/366

\* cited by examiner

*Primary Examiner* — Patricia Palasik

(74) *Attorney, Agent, or Firm* — Marsh Fischmann & Breyfogle LLP

(57) **CLAIM**

The ornamental design for a “log splitter beam”, as shown and described.

**DESCRIPTION**

FIG. 1 is a perspective view of the log splitter beam being attached to a log splitting device; the broken lines are for illustrative purposes only and form no part of the claimed design.

FIG. 2 is a perspective view of the log splitter beam of FIG. 1.

FIG. 3 is a top view of the log splitter beam of FIG. 2.

FIG. 4 is a bottom view of the log splitter beam of FIG. 2.

FIG. 5 is a right side view of the log splitter beam of FIG. 2.

FIG. 6 is a front view of the log splitter beam of FIG. 2; and,

FIG. 7 is a rear view of the log splitter beam of FIG. 2.

**1 Claim, 4 Drawing Sheets**

(56) **References Cited**

U.S. PATENT DOCUMENTS

4,700,759 A	10/1987	Duerr	
4,770,218 A	9/1988	Duerr	
4,782,870 A	11/1988	Duerr	
D326,665 S	6/1992	Greenburg et al.	
5,284,193 A *	2/1994	Mires et al. ....	144/195.1

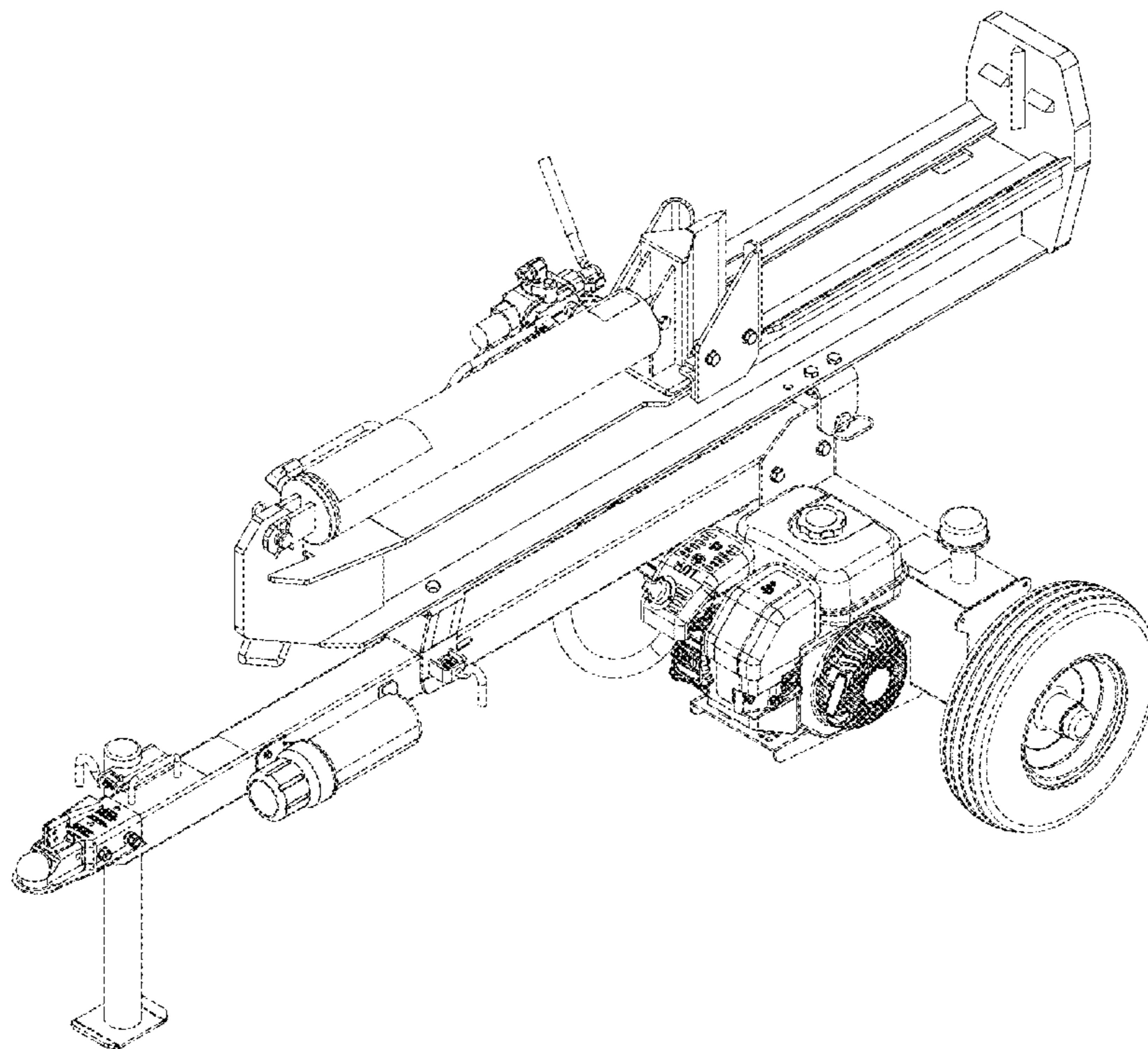

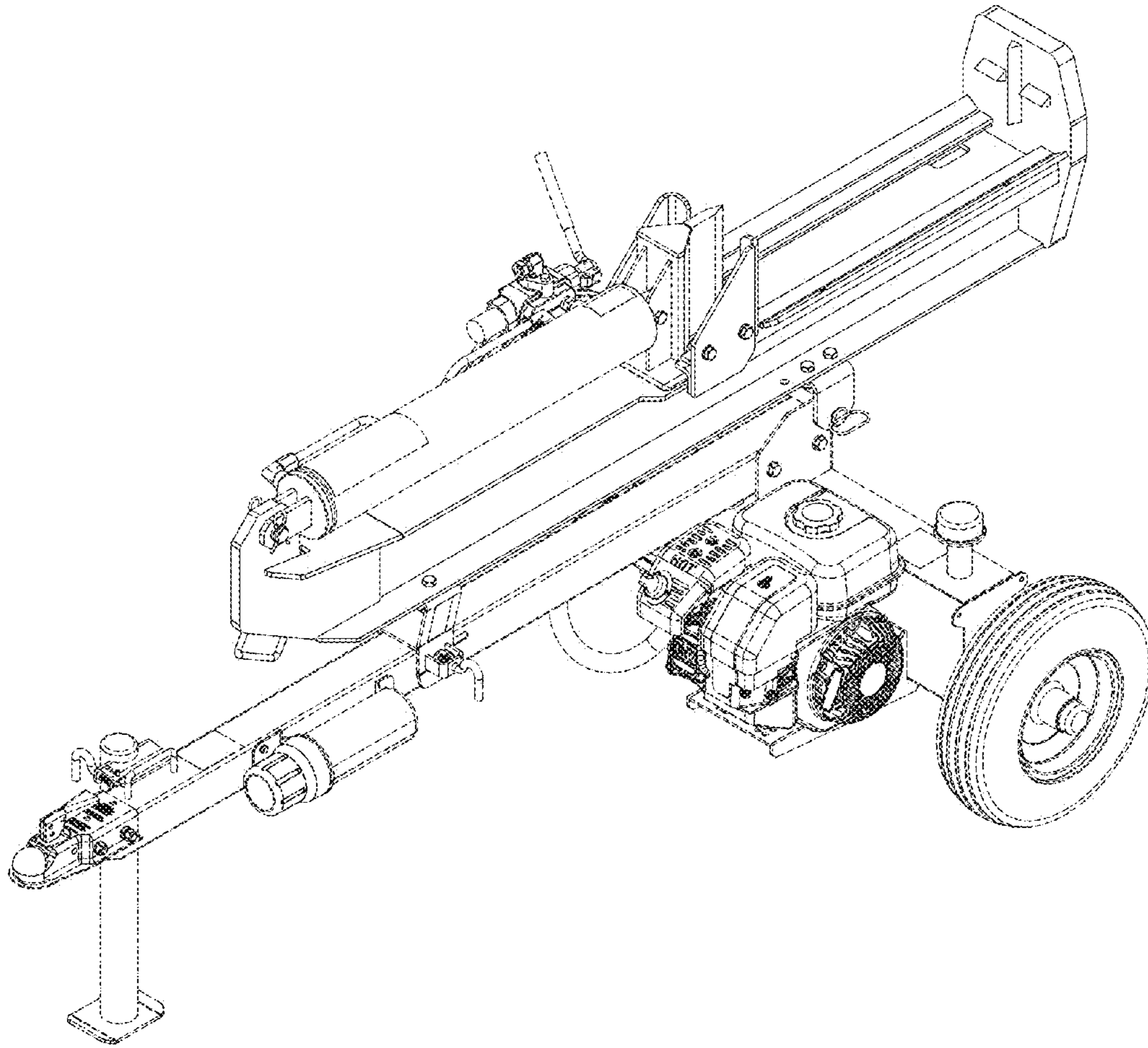

Fig. 1

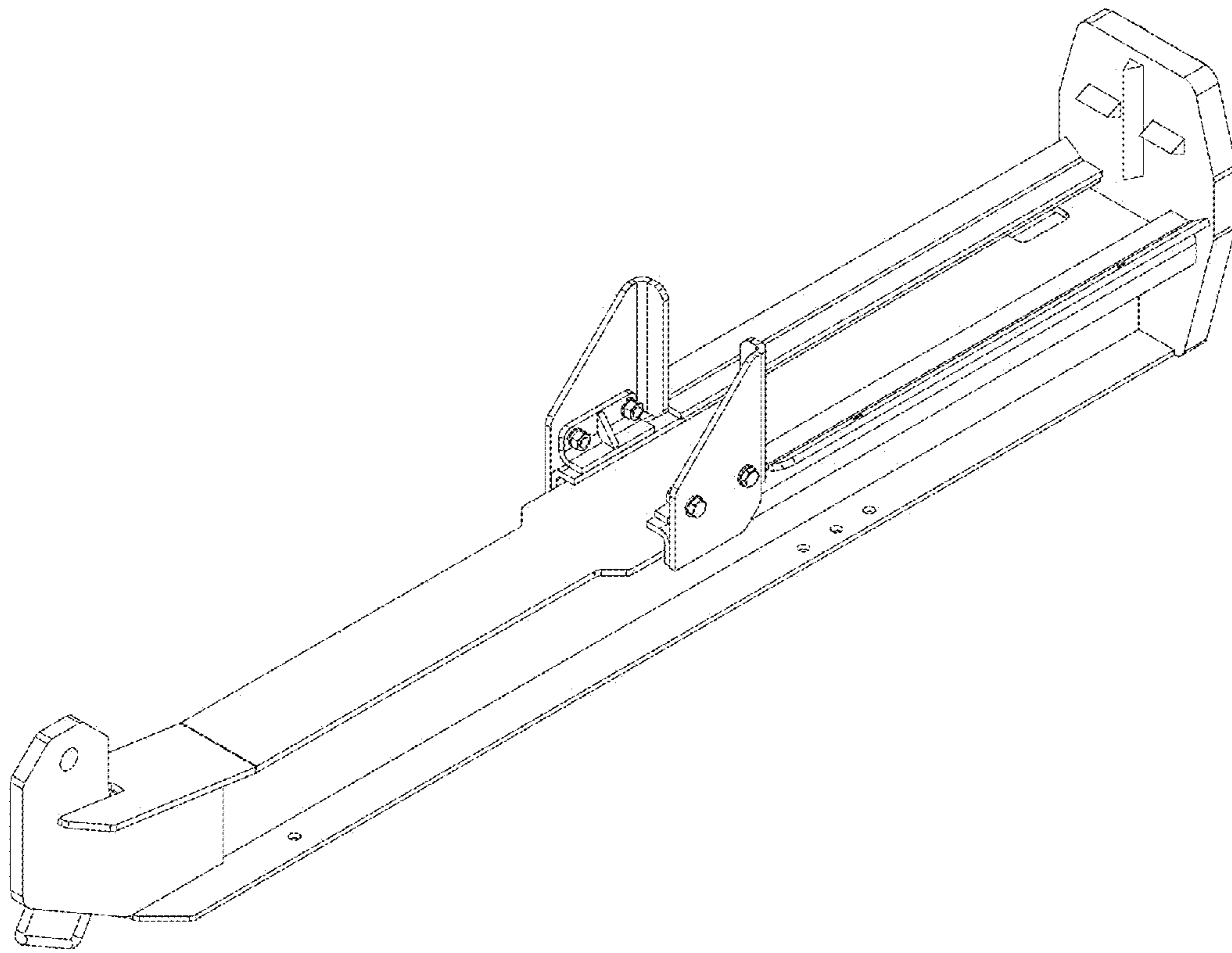

Fig. 2

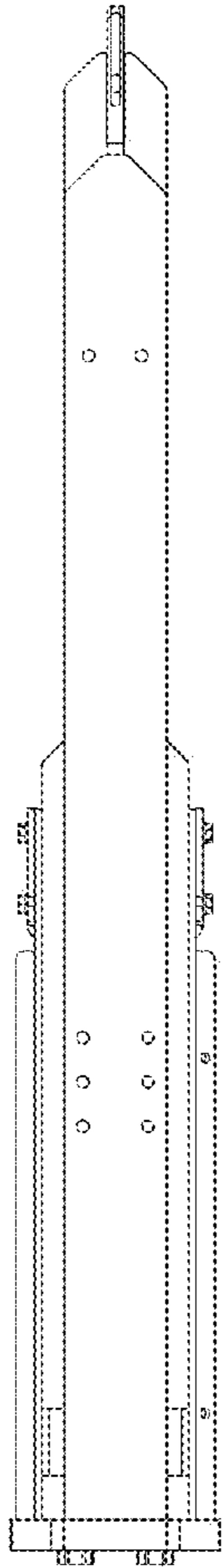

Fig. 4

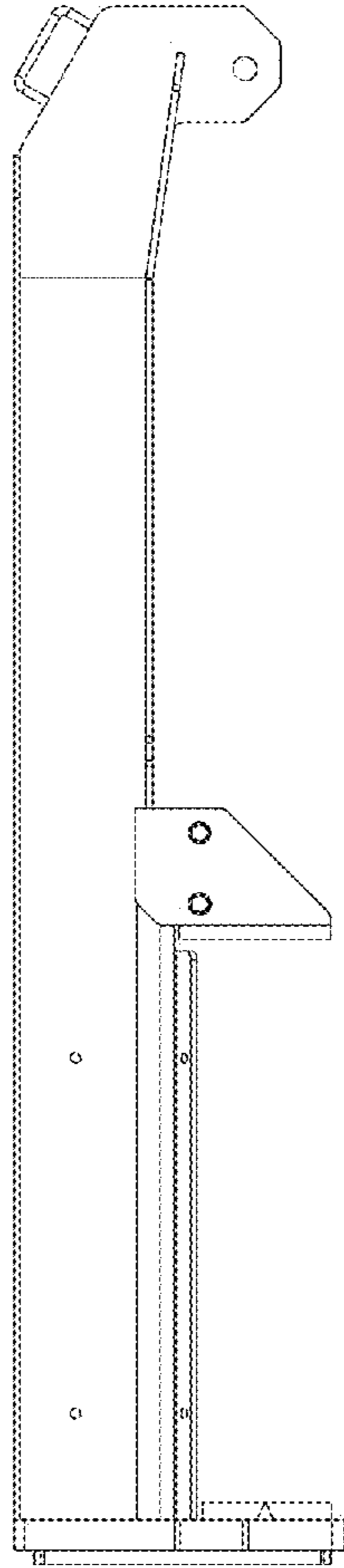

Fig. 5

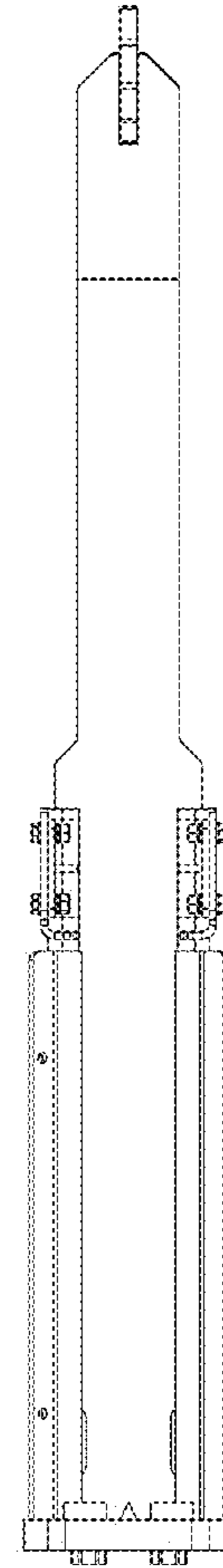

Fig. 3

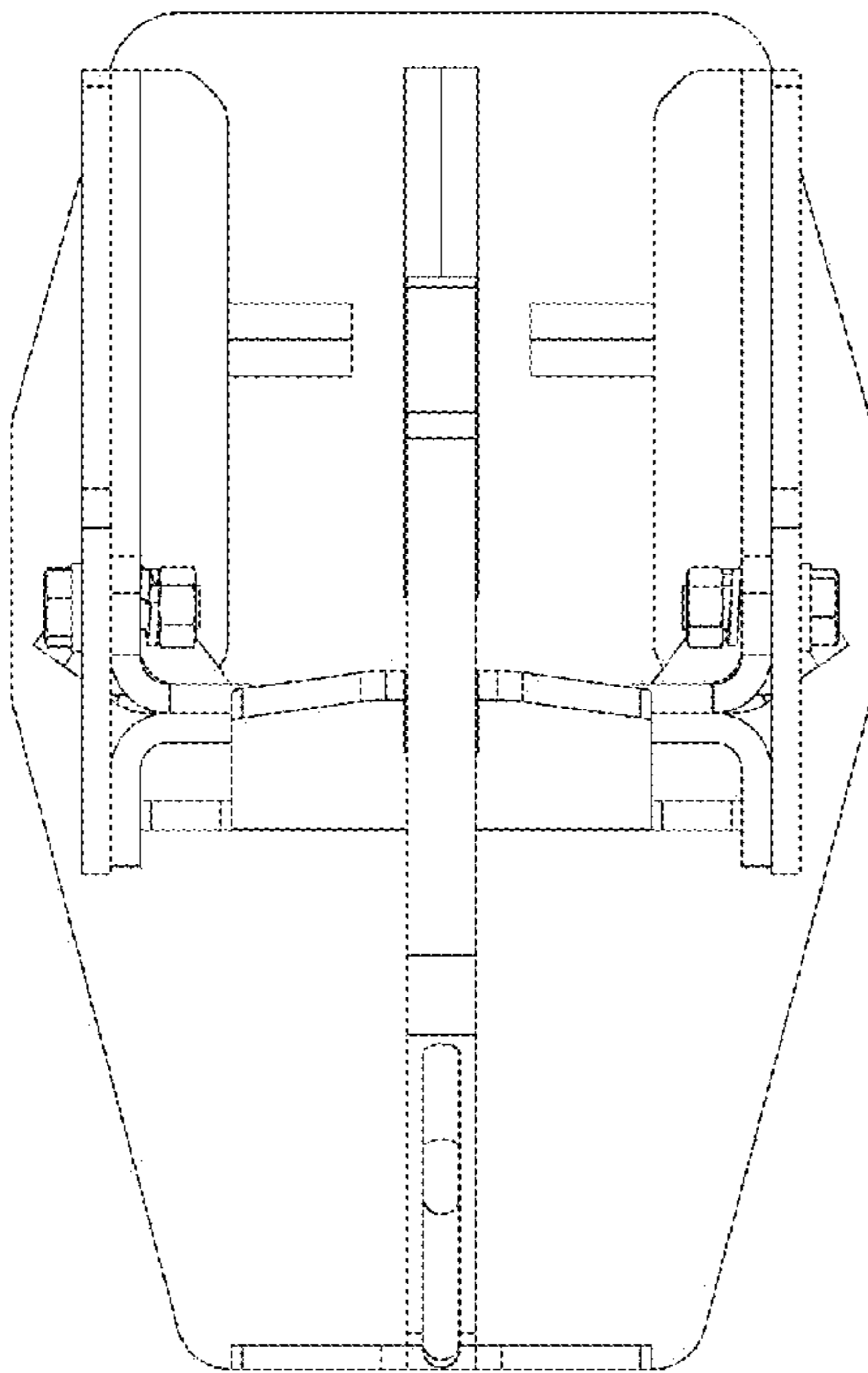

Fig. 6

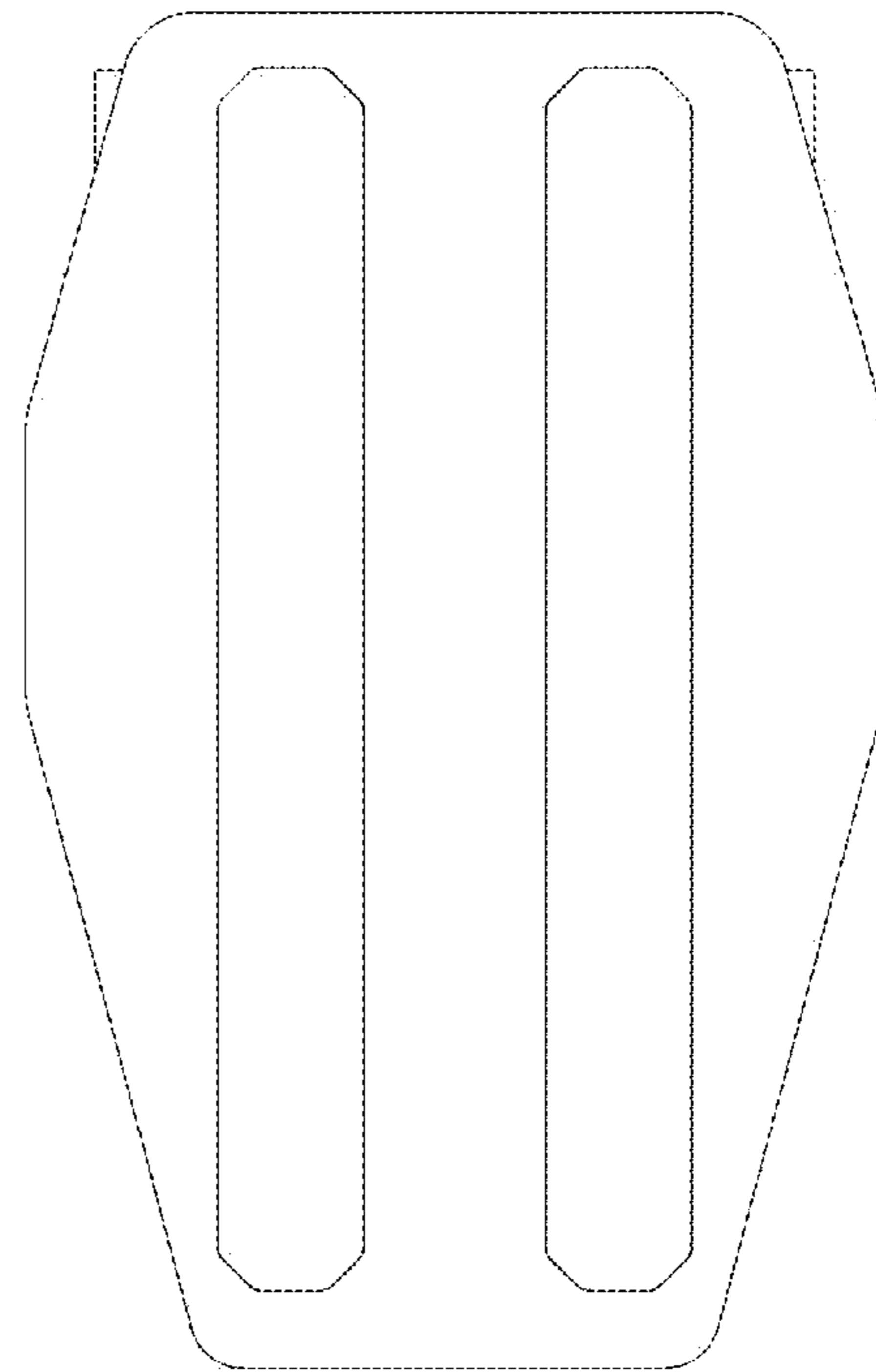

Fig. 7