



US00D681493S

(12) **United States Design Patent**  
**Saikawa et al.**

(10) **Patent No.:** **US D681,493 S**

(45) **Date of Patent:** **\*\* \*May 7, 2013**

(54) **CONTROL PANEL FOR ELEVATOR**

(75) Inventors: **Yoshinori Saikawa**, Chiyoda-Ku (JP);  
**Toshihisa Ogura**, Chiyoda-Ku (JP); **Eiji Yuasa**, Chiyoda-Ku (JP); **Hiroshi Okuda**, Chiyoda-Ku (JP)

(73) Assignee: **Mitsubishi Electric Corporation**, Tokyo (JP)

(\*) Notice: This patent is subject to a terminal disclaimer.

(\*\*) Term: **14 Years**

(21) Appl. No.: **29/402,956**

(22) Filed: **Sep. 29, 2011**

(30) **Foreign Application Priority Data**

Apr. 13, 2011 (JP) ..... 2011-008464  
Apr. 13, 2011 (JP) ..... 2011-008465  
Apr. 13, 2011 (JP) ..... 2011-008466  
Apr. 13, 2011 (JP) ..... 2011-008467  
Apr. 13, 2011 (JP) ..... 2011-008468

(51) **LOC (9) Cl.** ..... **10-05**

(52) **U.S. Cl.**  
USPC ..... **D10/108**; D13/164

(58) **Field of Classification Search** ..... D13/162,  
D13/164; D10/108, 106.95; D14/388, 390;  
187/380, 395, 396, 397

See application file for complete search history.

(56) **References Cited**

**U.S. PATENT DOCUMENTS**

D214,705 S \* 7/1969 Morrison ..... D10/108  
4,149,614 A \* 4/1979 Mandel et al. .... 187/397  
D267,870 S \* 2/1983 Bevilaqua et al. .... D13/164  
D268,668 S \* 4/1983 Bevilaqua et al. .... D13/164  
D283,687 S \* 5/1986 Walser ..... D10/108

D327,856 S \* 7/1992 Loew et al. .... D10/106.95  
D363,247 S \* 10/1995 Raymond ..... D10/108  
5,507,366 A \* 4/1996 Huang ..... 187/395  
5,679,934 A \* 10/1997 Juntunen et al. .... 187/395  
D392,907 S \* 3/1998 Buckley, III ..... D10/108  
5,821,479 A \* 10/1998 Kondo et al. .... 187/395  
5,969,306 A \* 10/1999 Velauthapillai et al. .... 187/395  
6,029,778 A \* 2/2000 Lacarte Estallo ..... 187/414  
6,161,654 A \* 12/2000 Sirigu et al. .... 187/391  
6,321,877 B2 \* 11/2001 Yamakawa ..... 187/391  
6,845,850 B1 \* 1/2005 Schneck ..... 187/395  
6,997,288 B2 \* 2/2006 Kakko et al. .... 187/391

(Continued)

*Primary Examiner* — Selina Sikder

(74) *Attorney, Agent, or Firm* — Sughrue Mion, PLLC

(57) **CLAIM**

The ornamental design for a control panel for elevator, as shown and described.

**DESCRIPTION**

FIG. 1 is a front, top and right side perspective view of a control panel for elevator, showing our new design;  
FIG. 2 is a front elevational view thereof;  
FIG. 3 is a rear elevational view thereof;  
FIG. 4 is a right side elevational view thereof;  
FIG. 5 is a top plan view thereof;  
FIG. 6 is a bottom plan view thereof;  
FIG. 7 is an enlarged cross-sectional view thereof; taken along line 7-7 of FIG. 2, with the internal system omitted;  
FIG. 8 is a reference view showing in use thereof;  
FIG. 9 is an alternate front elevation view of embodiment one thereof;  
FIG. 10 is another alternate front elevation view of embodiment one thereof; and,  
FIG. 11 is yet another alternate front elevation view of embodiment one thereof.

The broken lines shown in FIG. 8 are for the purpose of illustrating environmental structure and form no part of the claimed design.

**1 Claim, 8 Drawing Sheets**

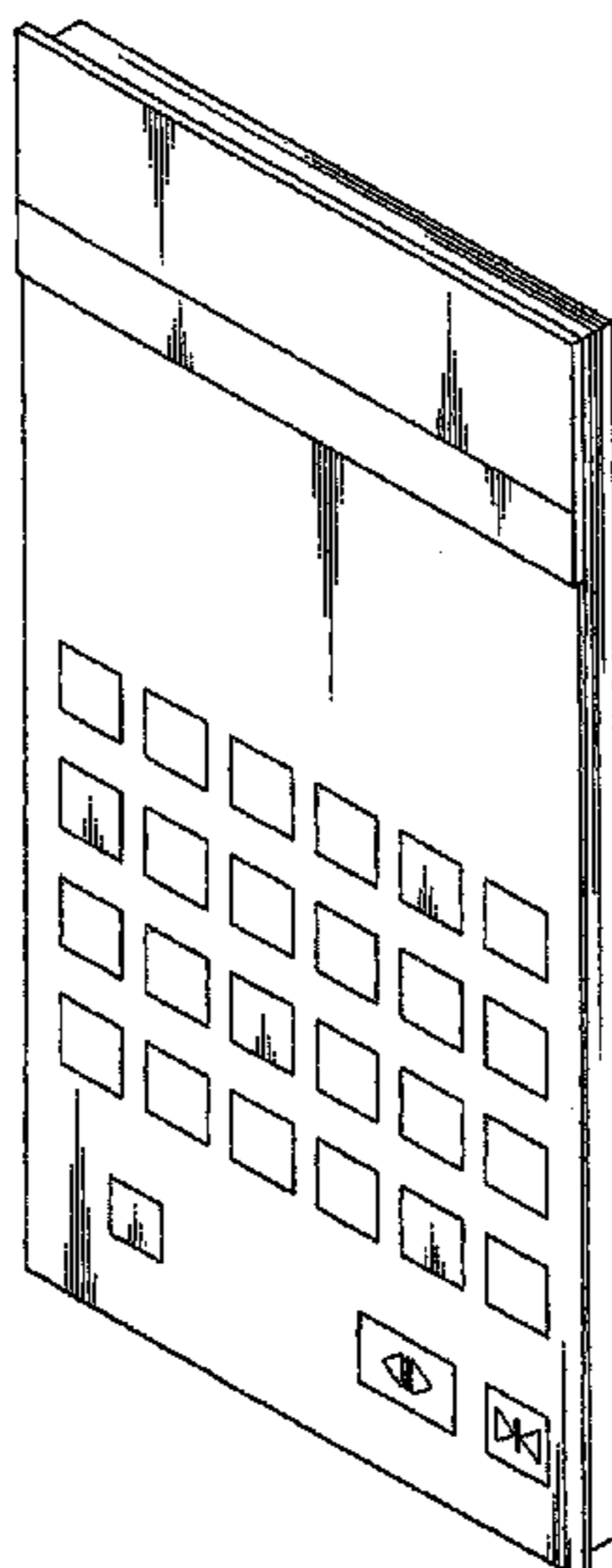

# US D681,493 S

Page 2

---

## U.S. PATENT DOCUMENTS

7,021,428	B2 *	4/2006	Han et al. ....	187/395	D615,896	S *	5/2010	Rusanen et al. ....	D10/108
7,040,458	B2 *	5/2006	Forsythe et al. ....	187/396	D620,455	S *	7/2010	Teixeira Pinto Dias ....	D13/164
D533,894	S *	12/2006	Chan .....	D18/7	D620,457	S *	7/2010	Maurer et al. ....	D13/177
7,284,639	B2 *	10/2007	Sasaki et al. ....	187/395	8,096,388	B2 *	1/2012	Nakamura .....	187/391
7,404,470	B2 *	7/2008	Felder et al. ....	187/395	2003/0164267	A1 *	9/2003	Hikita .....	187/391
7,445,090	B2 *	11/2008	Bodmer et al. ....	187/391	2004/0245052	A1 *	12/2004	Felder .....	187/395
D589,832	S *	4/2009	Ogura et al. ....	D10/108	2005/0224297	A1 *	10/2005	Felder et al. ....	187/395
D596,977	S *	7/2009	Ogura et al. ....	D10/108	2006/0054421	A1 *	3/2006	Ikeda .....	187/395
D598,396	S *	8/2009	Lee .....	D13/162	2011/0024240	A1 *	2/2011	Rusanen et al. ....	187/395

\* cited by examiner

Fig. 1

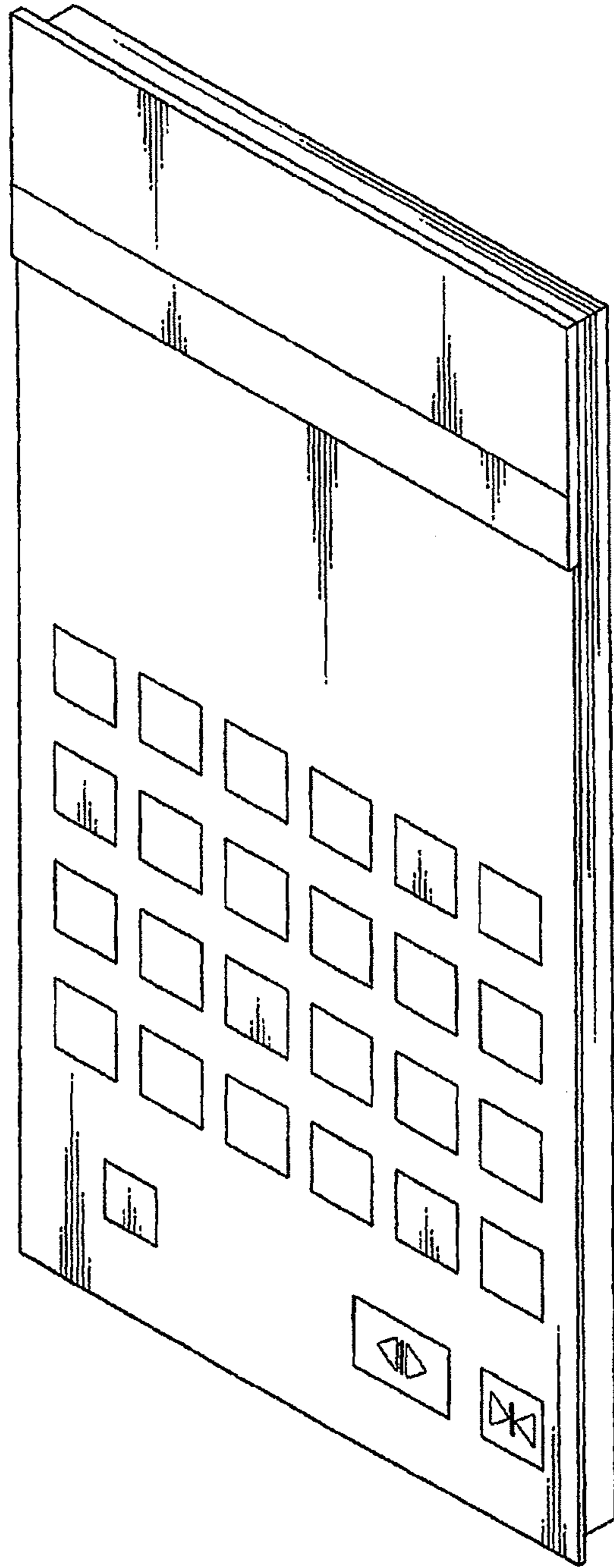

Fig. 2

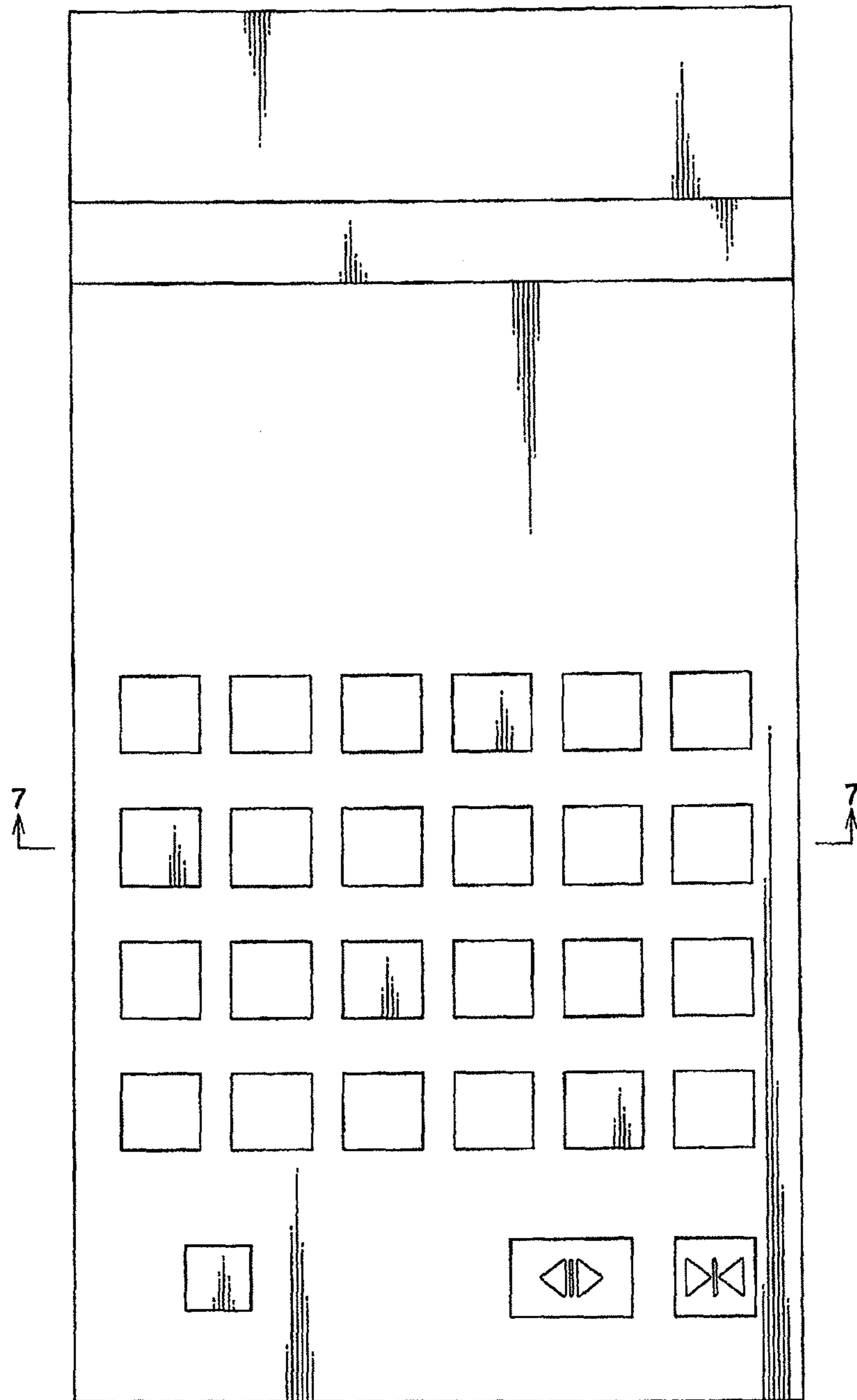

Fig. 3

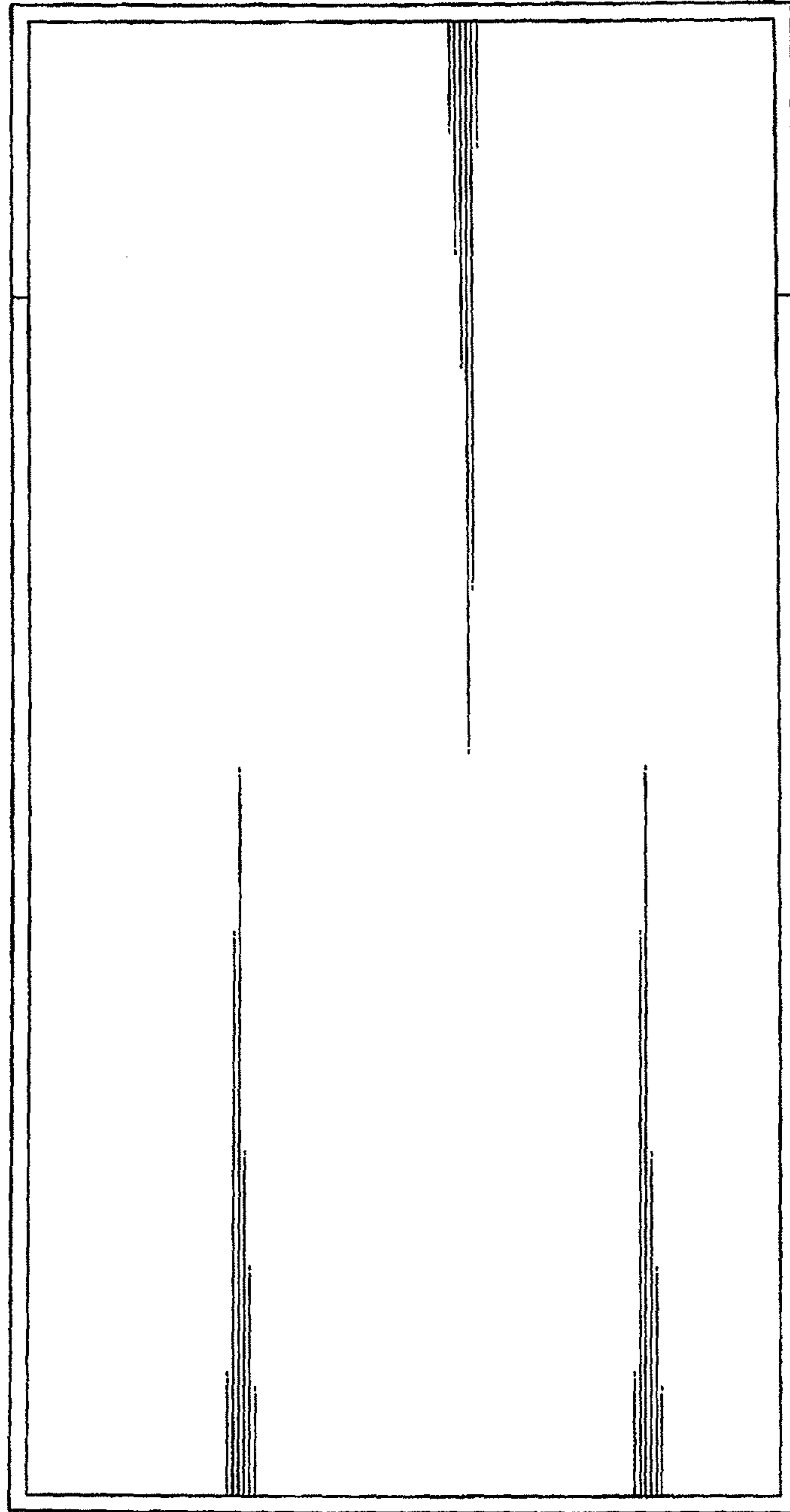

Fig. 4



Fig. 5



Fig. 6



Fig. 7



Fig. 8

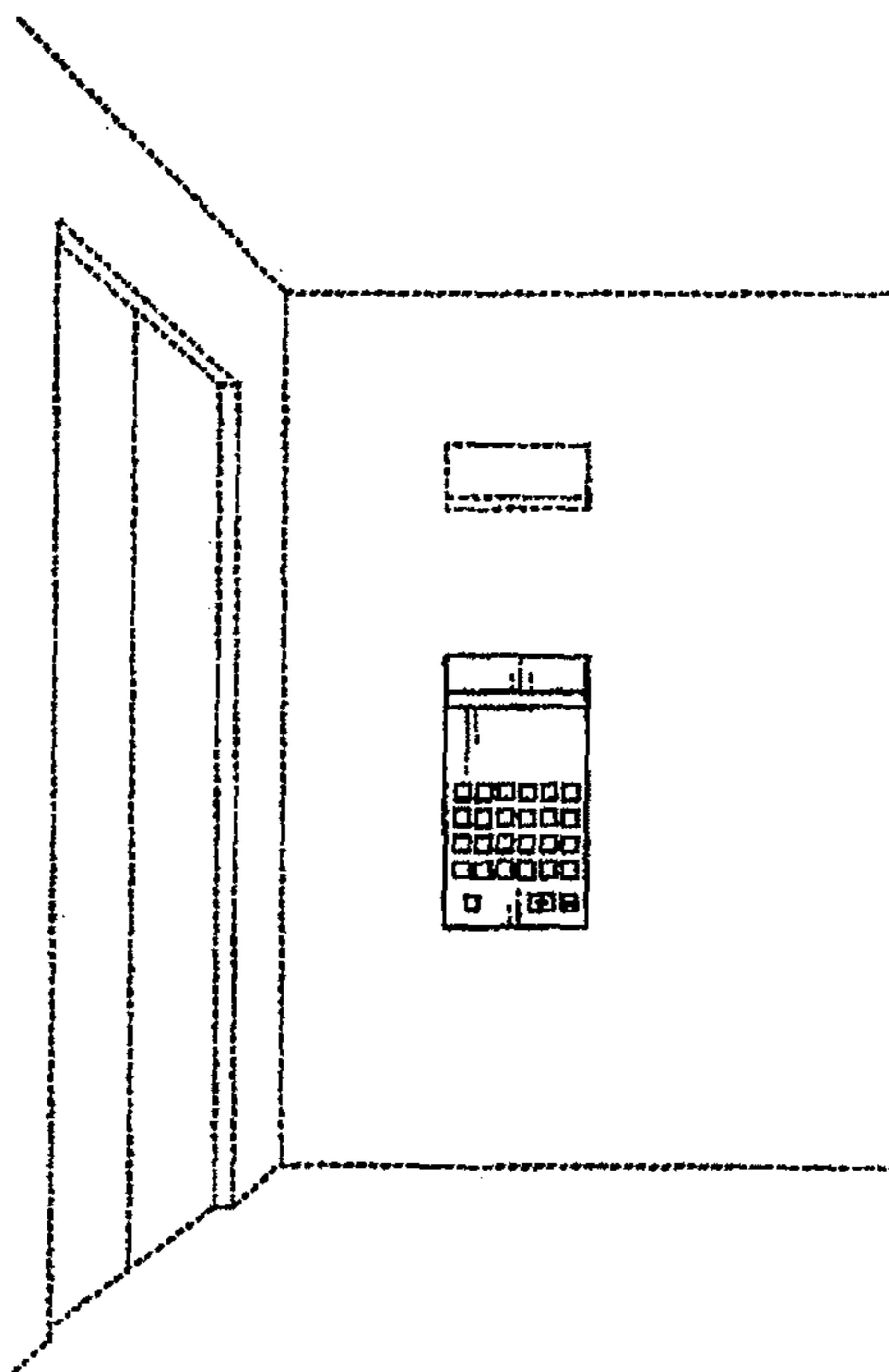

Fig. 9

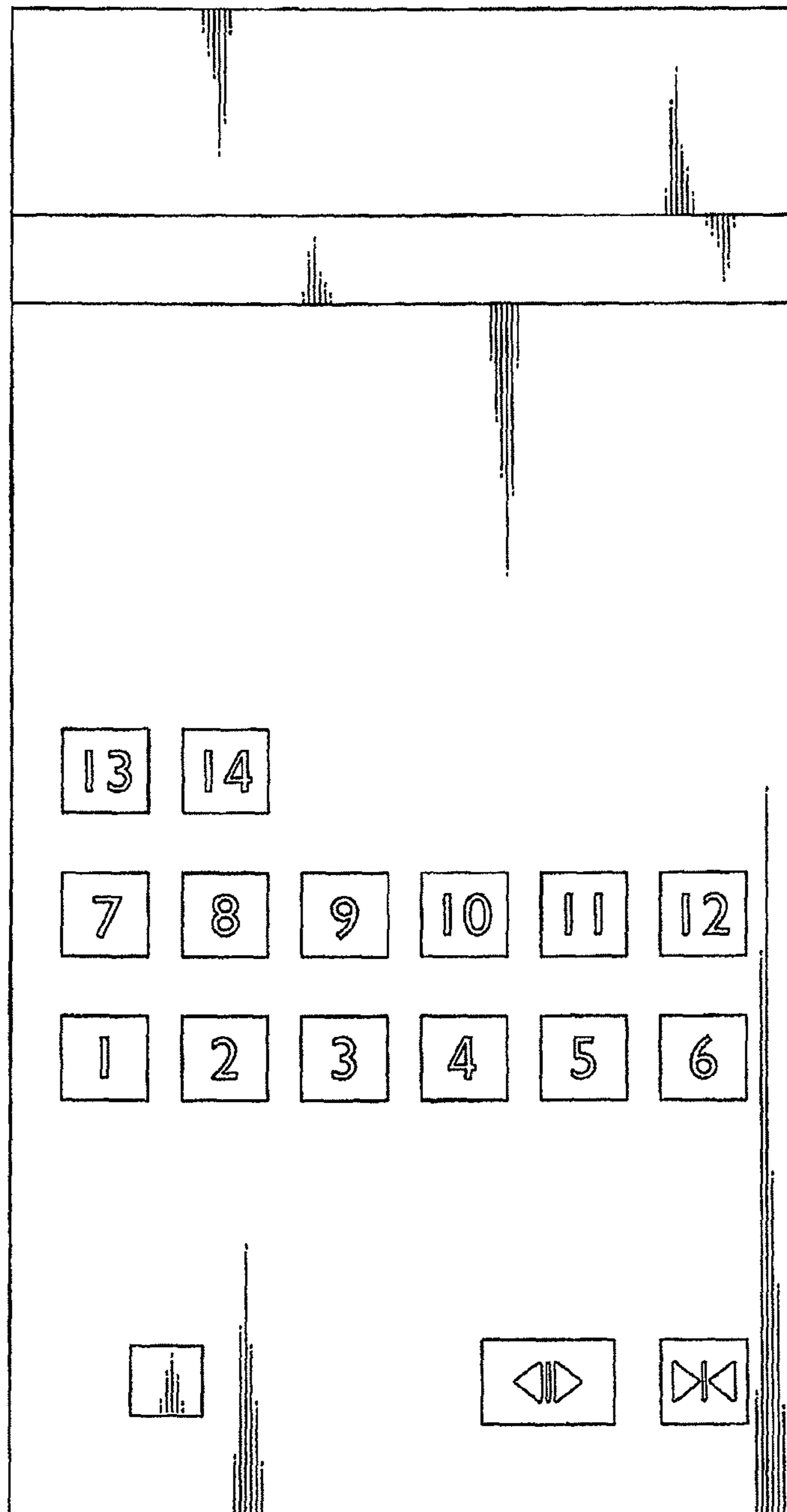



Fig. 10

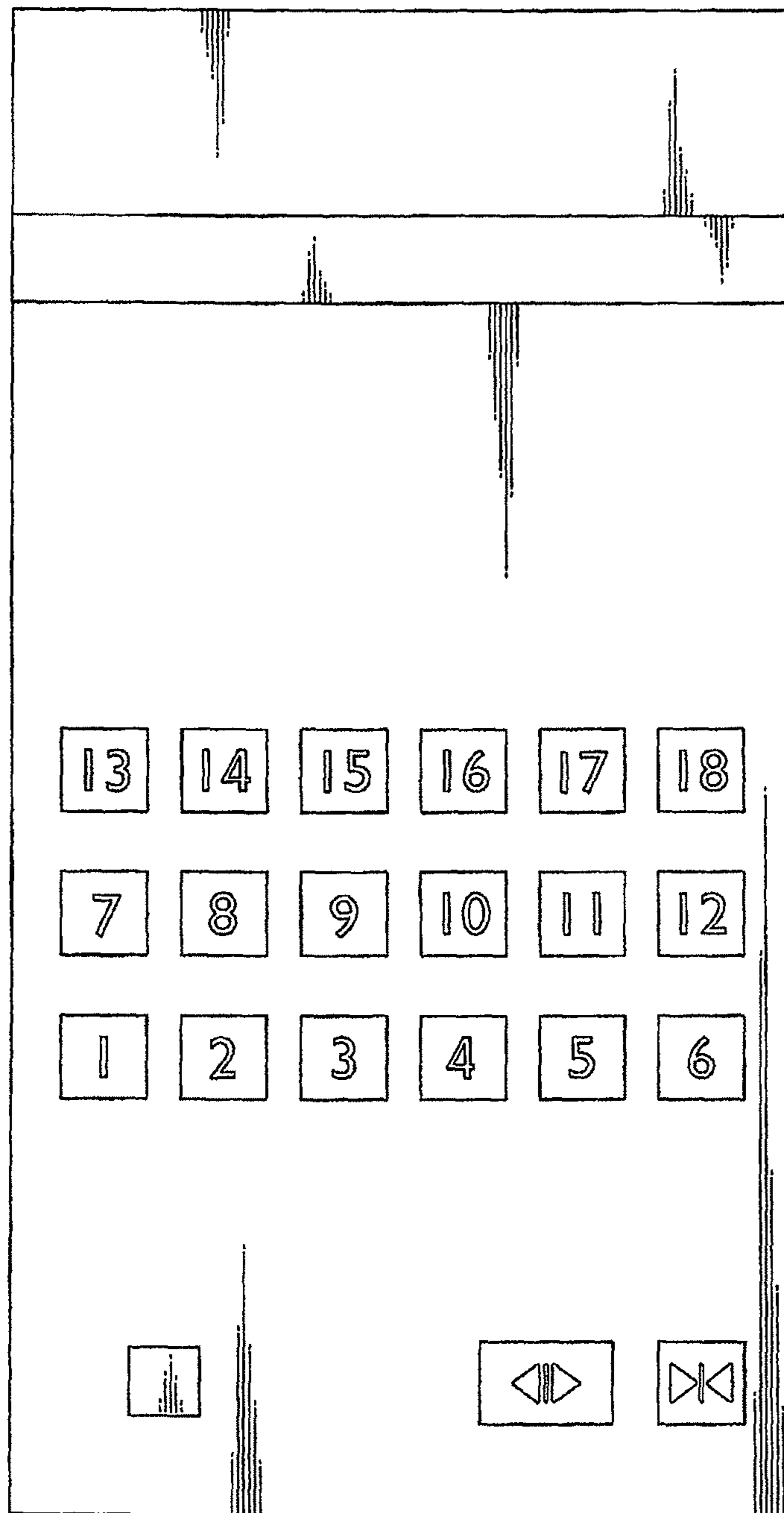

Fig. 11

