



US00D681377S

(12) **United States Design Patent**
Taber

(10) **Patent No.:** **US D681,377 S**

(45) **Date of Patent:** **** May 7, 2013**

(54) **BED**
(75) Inventor: **Robert Thor Taber**, Hickory, NC (US)
(73) Assignee: **Hickory Chair, a division of HDM Furniture Industries, Inc.**, High Point, NC (US)

D368,178 S * 3/1996 Walters et al. D6/393
D435,358 S * 12/2000 Gallien D6/393
D480,889 S * 10/2003 Risdon et al. D6/393
D564,778 S * 3/2008 Juneau D6/393
D660,045 S * 5/2012 Lenney D6/393
D668,074 S * 10/2012 Hoff et al. D6/393

* cited by examiner

(**) Term: **14 Years**

Primary Examiner — Janice Seeger

(21) Appl. No.: **29/421,038**

(74) *Attorney, Agent, or Firm* — Kilpatrick Townsend & Stockton LLP

(22) Filed: **May 8, 2012**

(51) **LOC (9) Cl.** **06-06**

(52) **U.S. Cl.**
USPC **D6/505**

(58) **Field of Classification Search** D6/382–384,
D6/388, 393–395, 505–508, 397; 5/53.1,
5/279.1, 280, 281, 907, 2.1
See application file for complete search history.

(57) **CLAIM**
The ornamental design for a bed, as shown and described.

DESCRIPTION

FIG. 1 is an orthogonal view of a bed.
FIG. 2 is a front view of the bed of FIG. 1.
FIG. 3 is a right side view of the bed of FIG. 1; and,
FIG. 4 is a top view of the bed of FIG. 1.
The broken lines illustrate environment and/or boundaries of the claimed design, and form no part of the claimed design.

(56) **References Cited**

U.S. PATENT DOCUMENTS

D309,387 S * 7/1990 Marshall D6/394

1 Claim, 4 Drawing Sheets

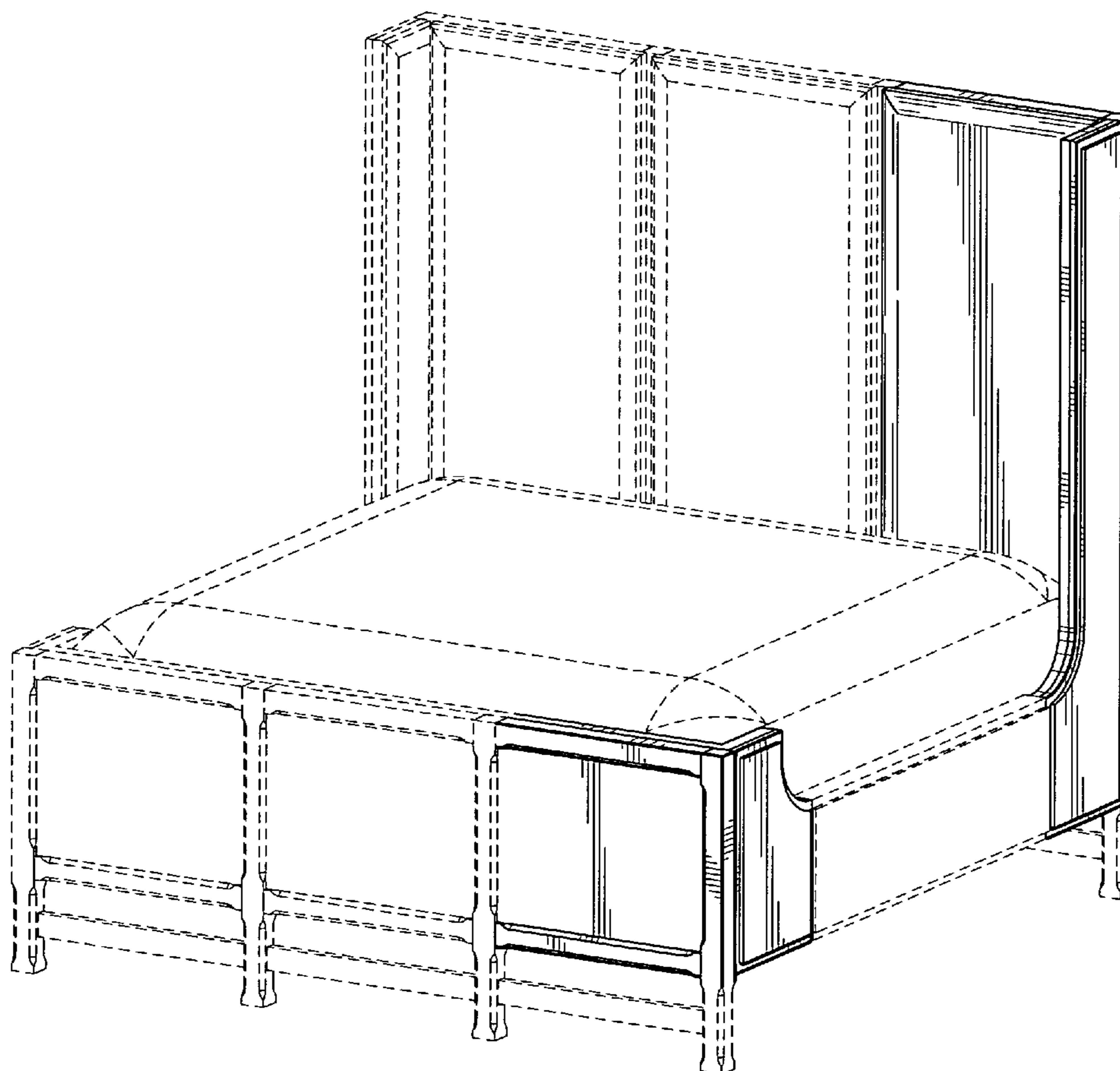

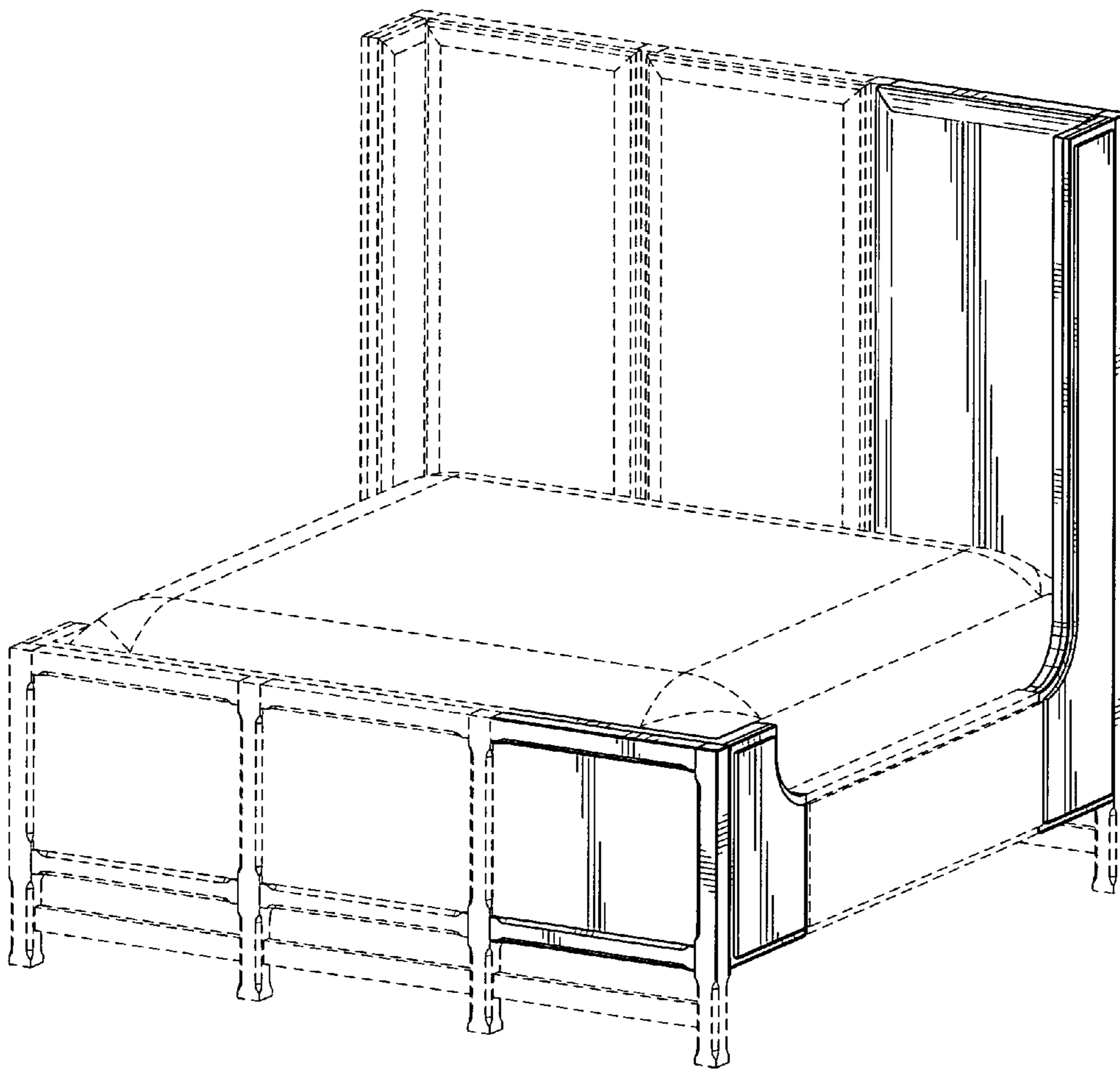

FIG. 1

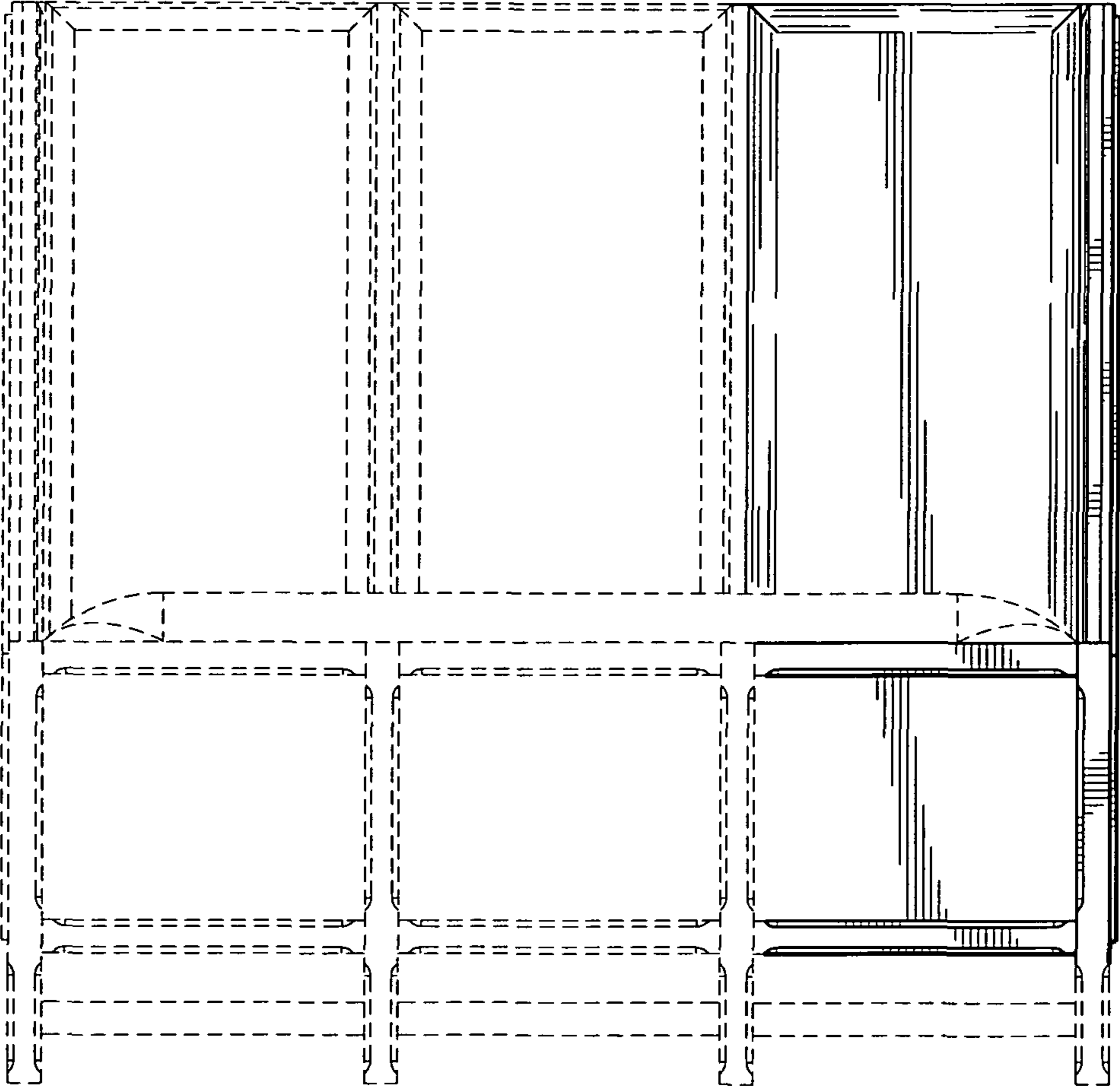

FIG. 2

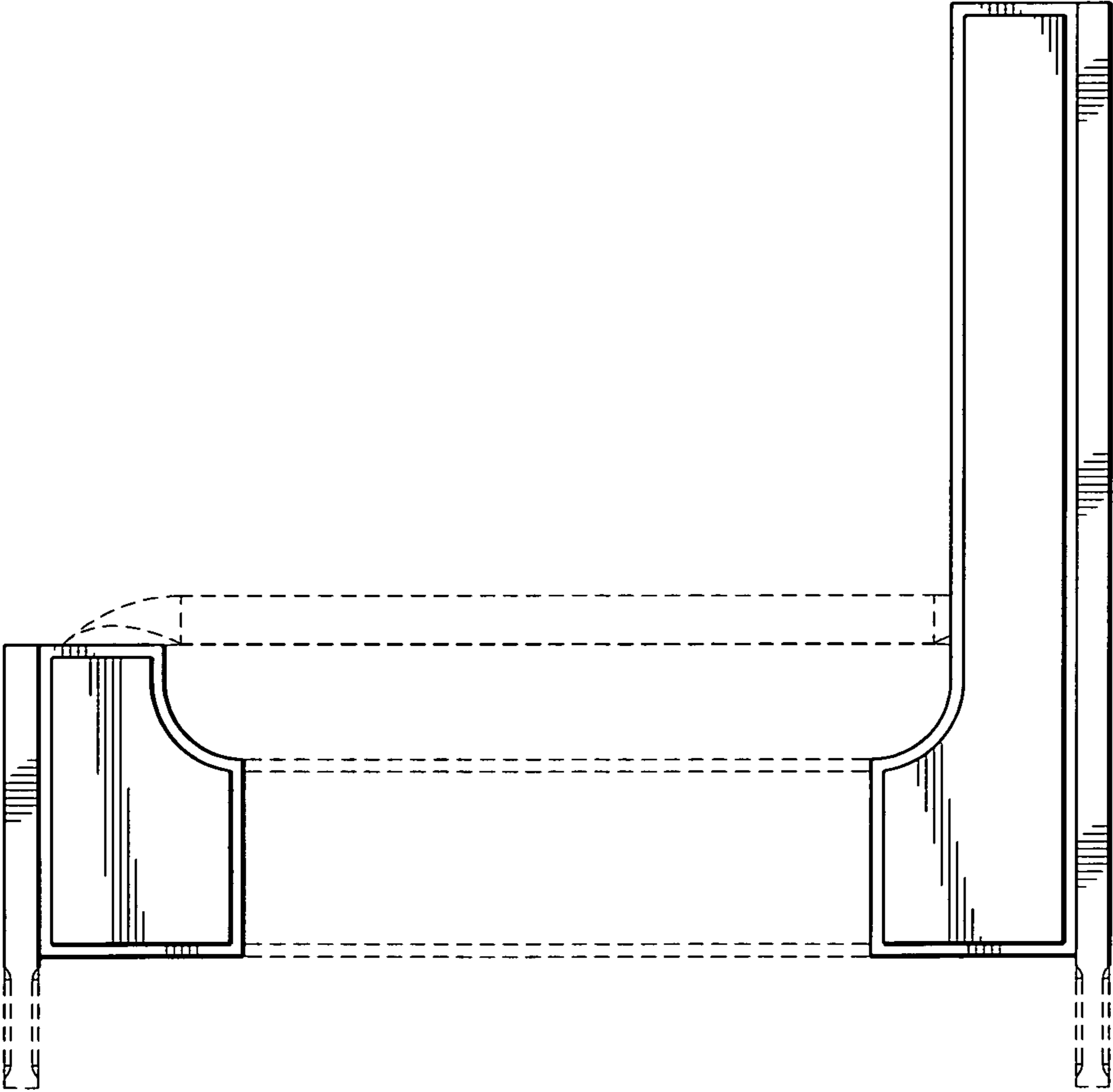

FIG. 3

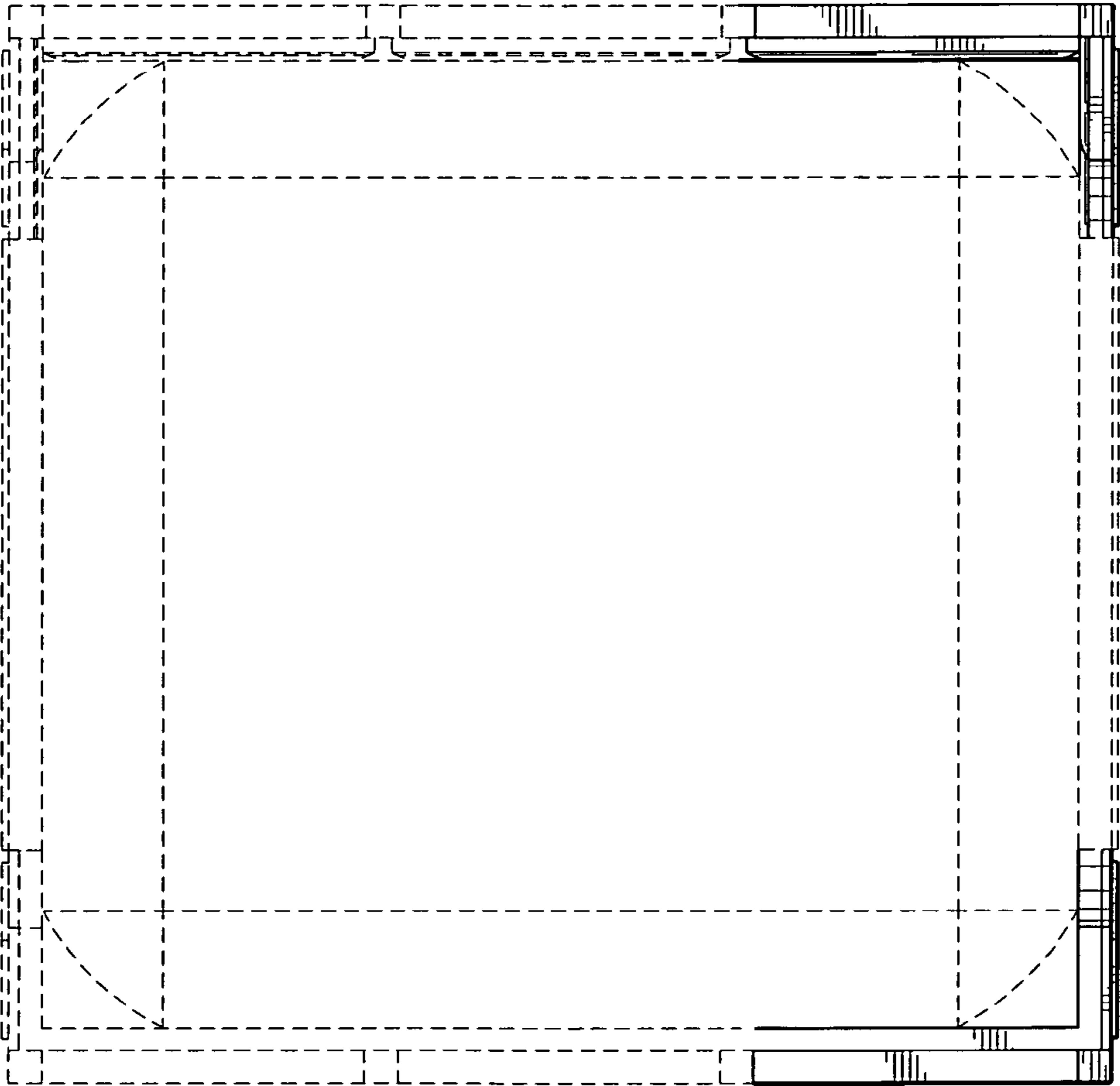

FIG. 4