



US00D679317S

(12) **United States Design Patent**
Ono et al.

(10) **Patent No.:** **US D679,317 S**

(45) **Date of Patent:** **** Apr. 2, 2013**

(54) **ROLLER STAMP**

(75) Inventors: **Satoru Ono**, Tokyo (JP); **Hideyuki Kitamura**, Tokyo (JP); **Shoichi Soma**, Tokyo (JP)

(73) Assignee: **Plus Corporation**, Tokyo (JP)

(**) Term: **14 Years**

(21) Appl. No.: **29/427,673**

(22) Filed: **Jul. 20, 2012**

(30) **Foreign Application Priority Data**

May 11, 2012 (JP) 2012-011024

(51) **LOC (9) Cl.** **19-02**

(52) **U.S. Cl.** **D18/15**

(58) **Field of Classification Search** D18/15,
D18/14, 16-18, 50; D19/65-68, 70, 71;
D9/521; 101/103, 327-334, 335, 337, 348,
101/375; 400/470; 118/264-270

See application file for complete search history.

(56) **References Cited**

U.S. PATENT DOCUMENTS

D178,686	S	*	9/1956	Mitchell	D18/15
4,996,921	A	*	3/1991	Hong	101/333
D339,819	S	*	9/1993	Chen	D18/15
5,505,133	A	*	4/1996	Chen	101/375
5,778,776	A	*	7/1998	Fuwa et al.	101/125
D399,245	S	*	10/1998	Harden	D18/15
D446,805	S	*	8/2001	Suto	D18/15
D507,593	S	*	7/2005	Kida et al.	D18/15

D508,072	S	*	8/2005	Kida et al.	D18/15
D580,479	S	*	11/2008	Hanazato	D18/15
D585,932	S	*	2/2009	Kida et al.	D18/15
D668,713	S	*	10/2012	Kitamura et al.	D18/15
2006/0201354	A1	*	9/2006	Suda	101/327

* cited by examiner

Primary Examiner — Bridget L Eland

(74) *Attorney, Agent, or Firm* — William J. Sapone

(57) **CLAIM**

We claim the ornamental design for a roller stamp, as shown and described.

DESCRIPTION

FIG. 1 is a front view of the roller stamp, showing our new design;

FIG. 2 is a top view thereof;

FIG. 3 is a bottom view thereof;

FIG. 4 is a right side view thereof, the left side being a mirror image thereof;

FIG. 5 is a front view of the roller stamp with an end cap removed to expose the roller for stamping;

FIG. 6 is a top view thereof with the end cap removed;

FIG. 7 is a bottom view thereof with the end cap removed

FIG. 8 is a right side view thereof with the end cap removed, the left side being a mirror image thereof;

FIG. 9 is a perspective view of the roller stamp of FIG. 1;

FIG. 10 is a perspective view of the roller stamp of FIG. 5, with the end cap removed;

FIG. 11 is a cross sectional view taken along line A-A of FIG. 1;

FIG. 12 is a cross sectional view taken along the line B-B of FIG. 4; and,

FIG. 13 is an exploded view of the roller stamp of FIG. 1.

1 Claim, 4 Drawing Sheets

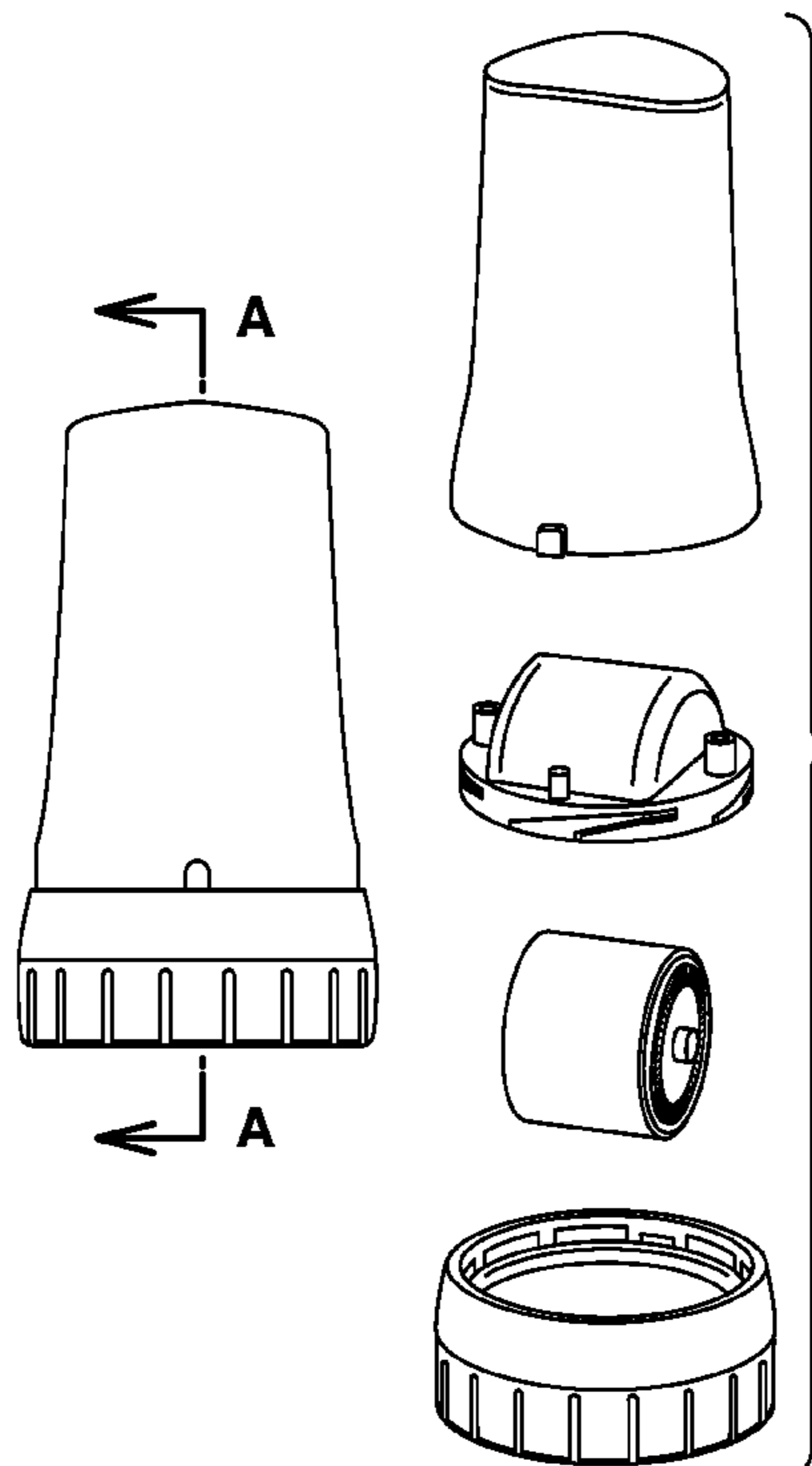

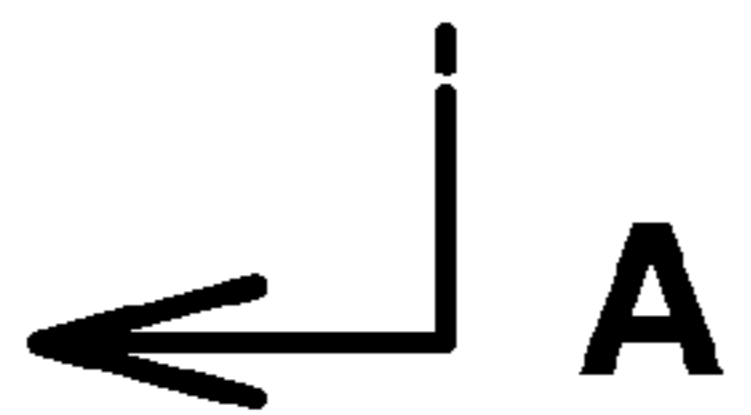
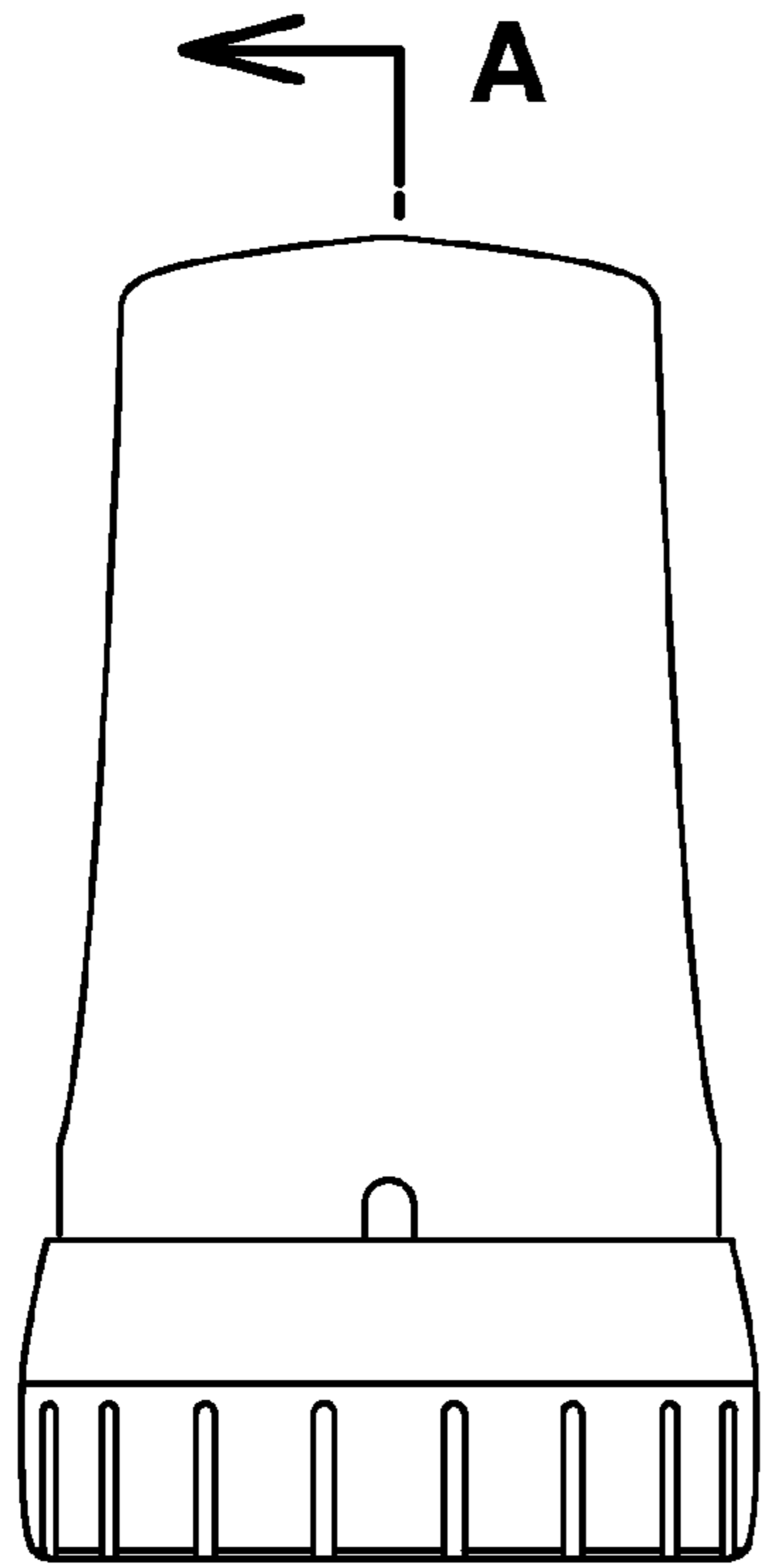

Fig. 1

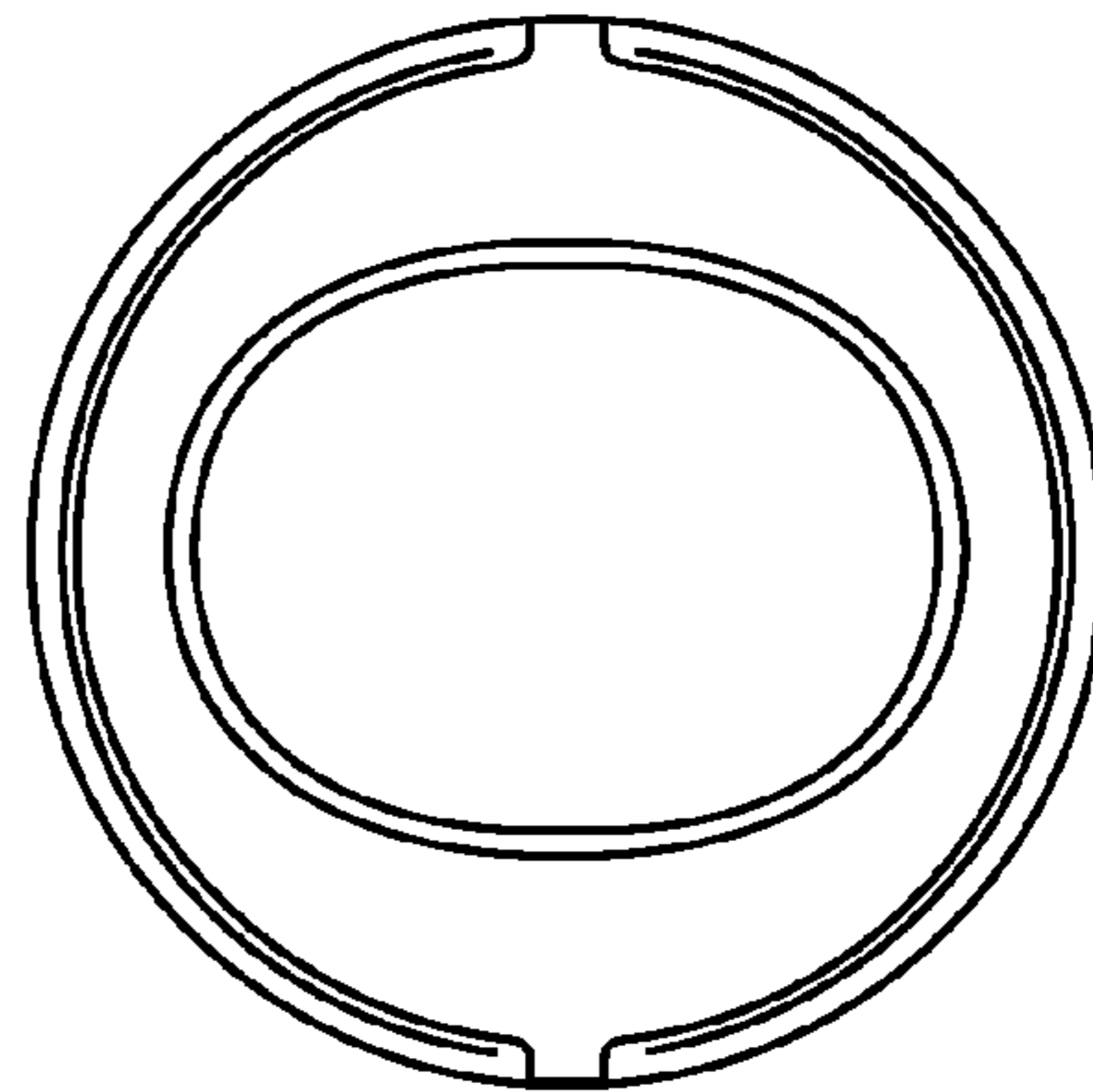

Fig. 2

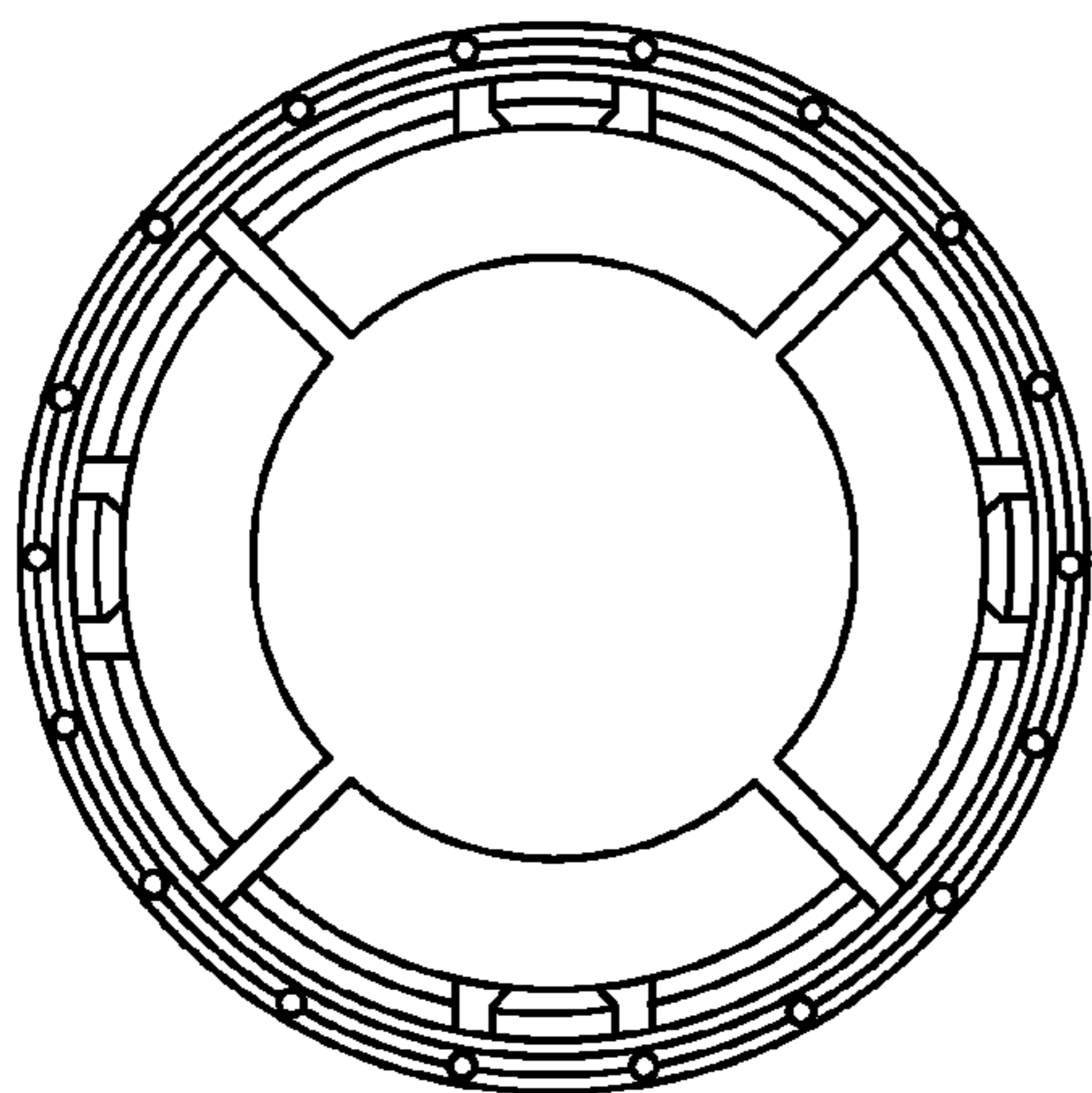

Fig. 3

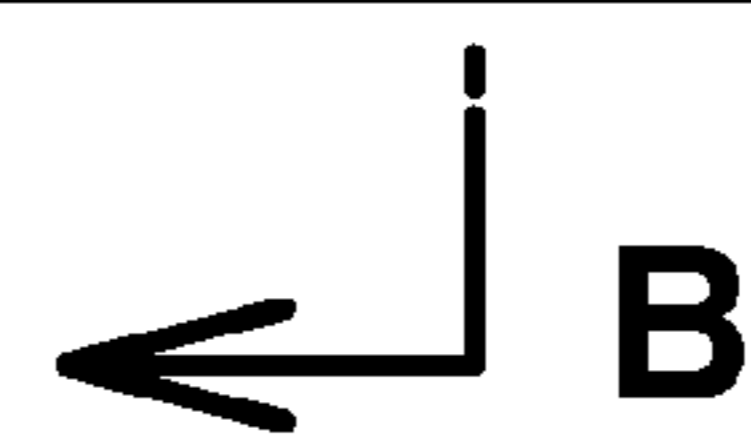
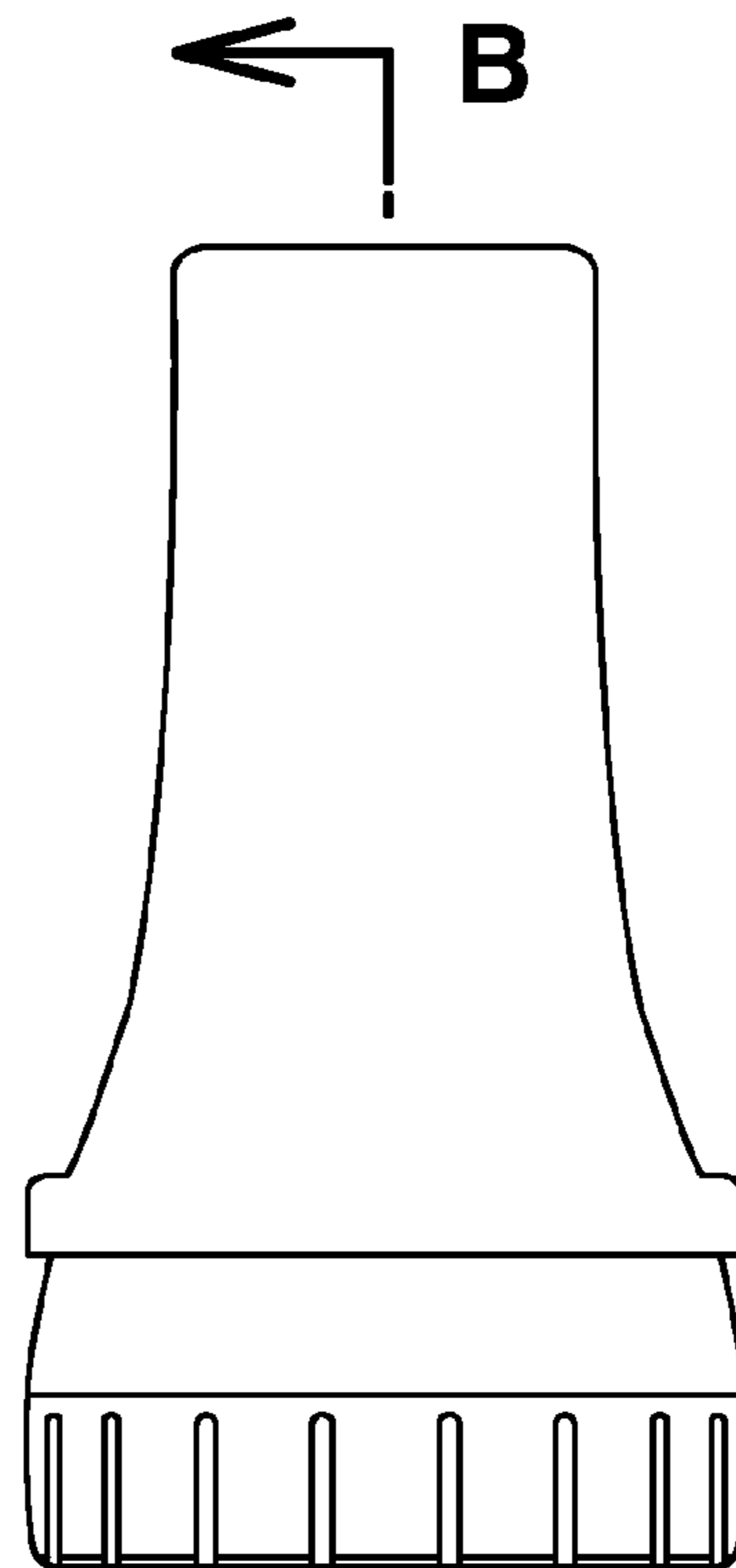

Fig. 4

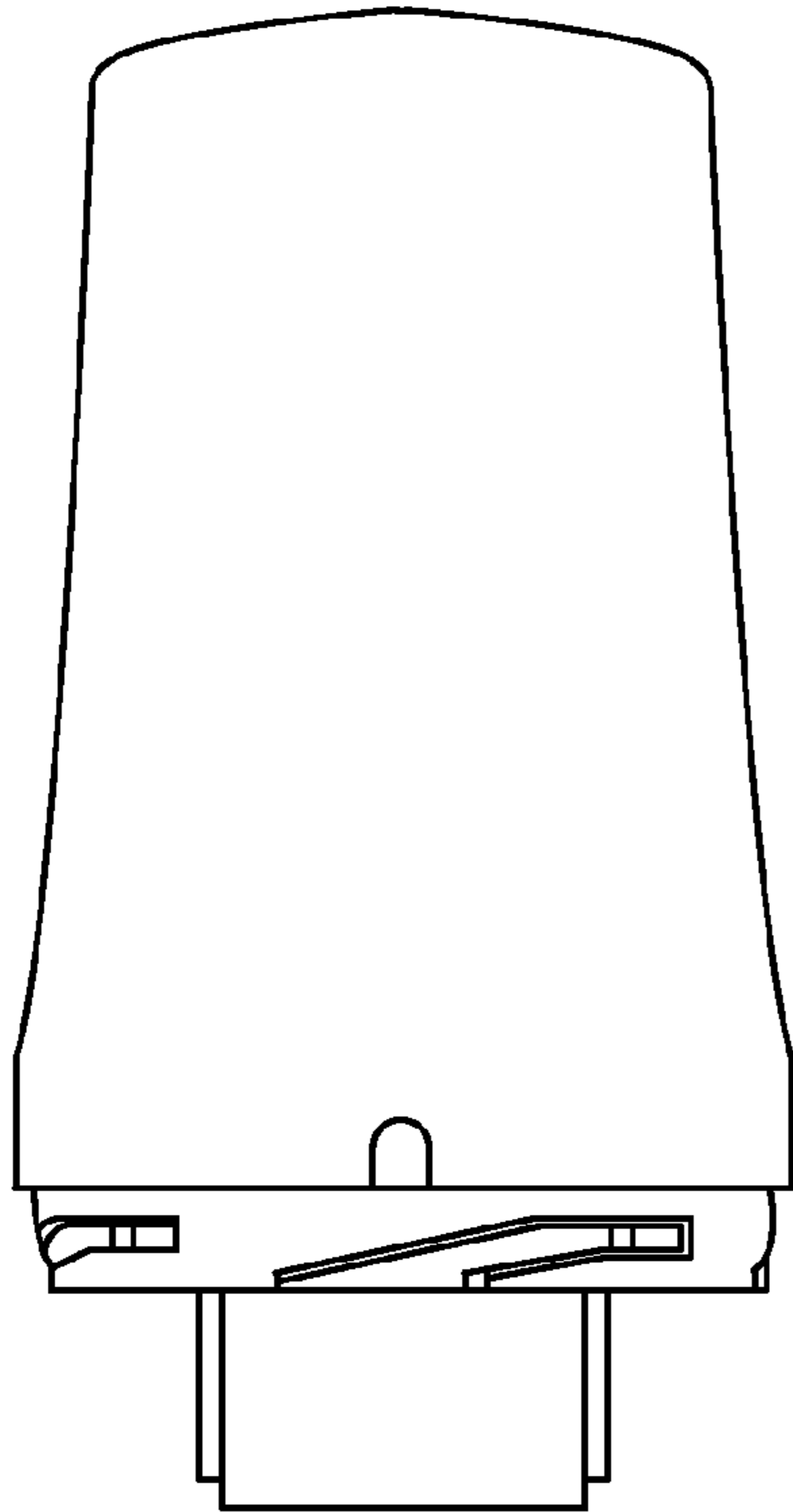

Fig. 5

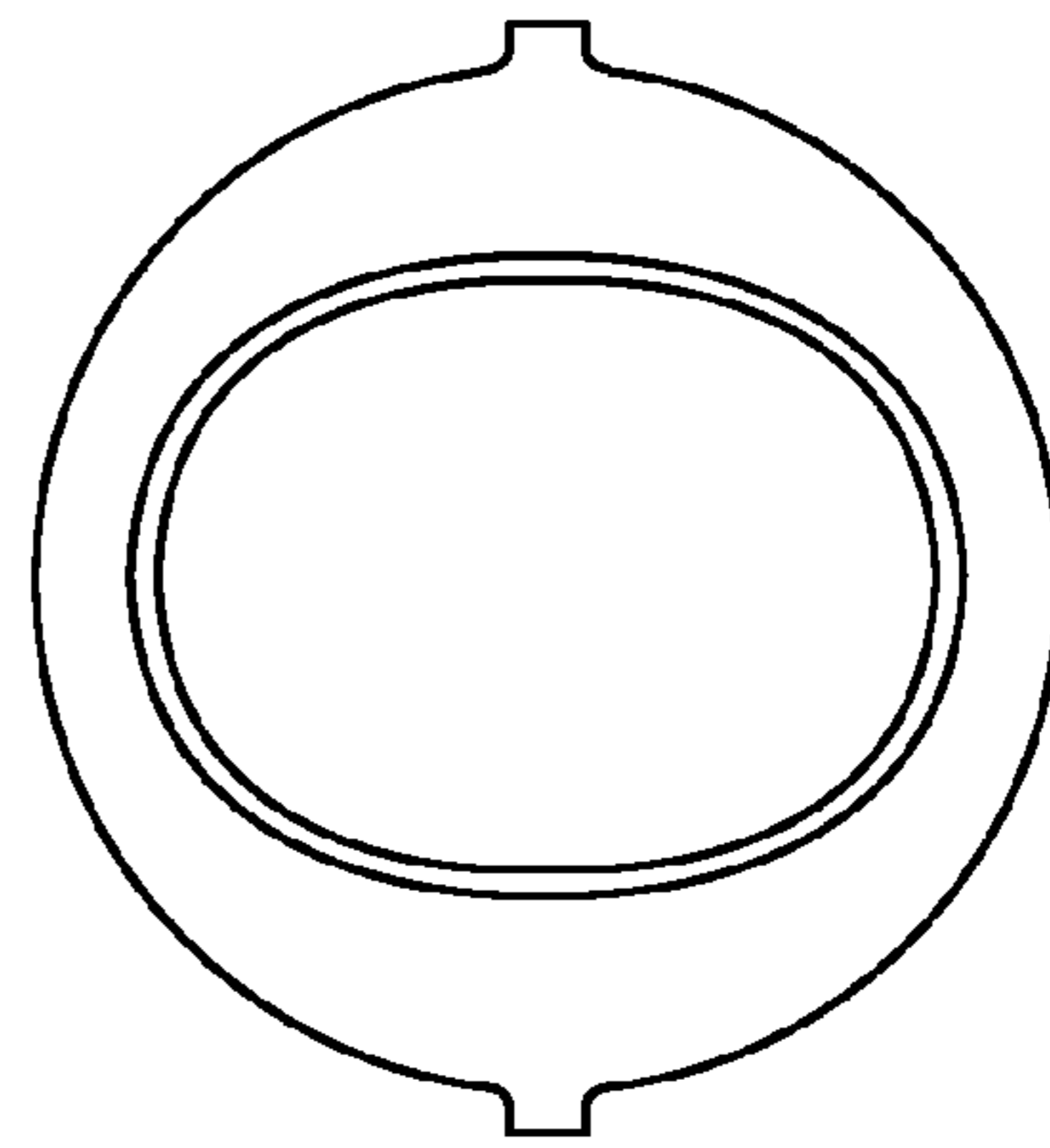

Fig. 6

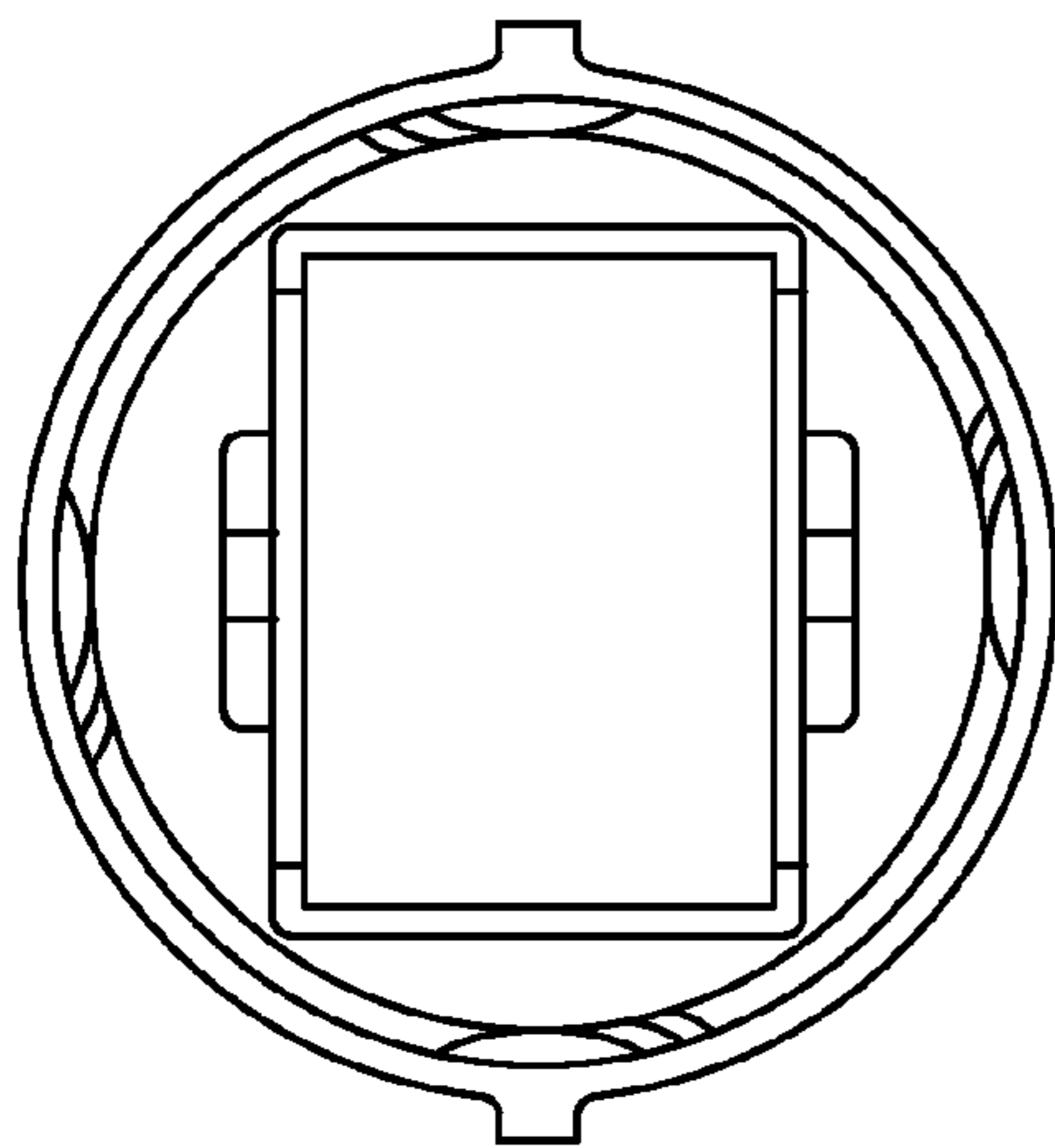

Fig. 7

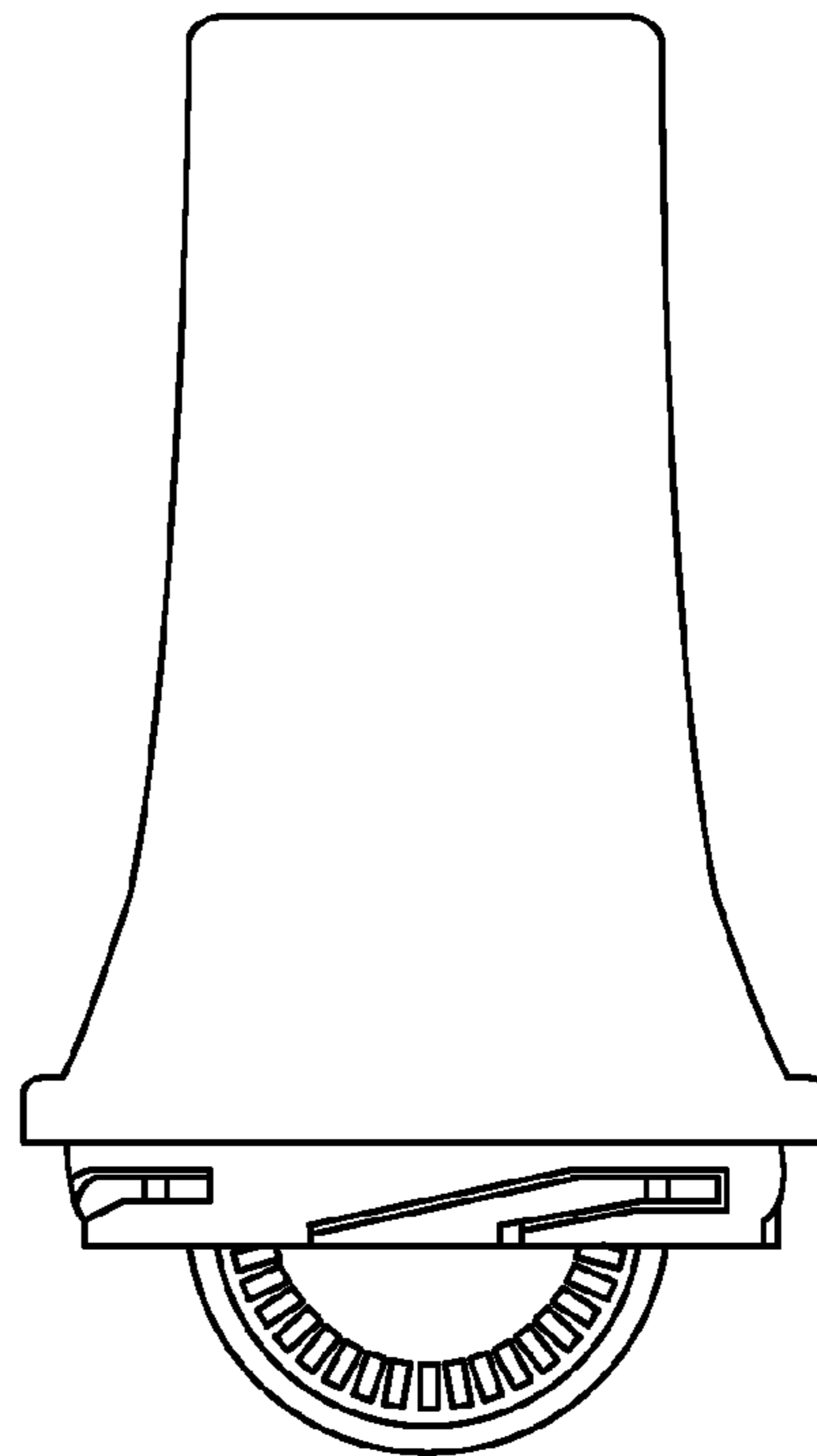

Fig. 8

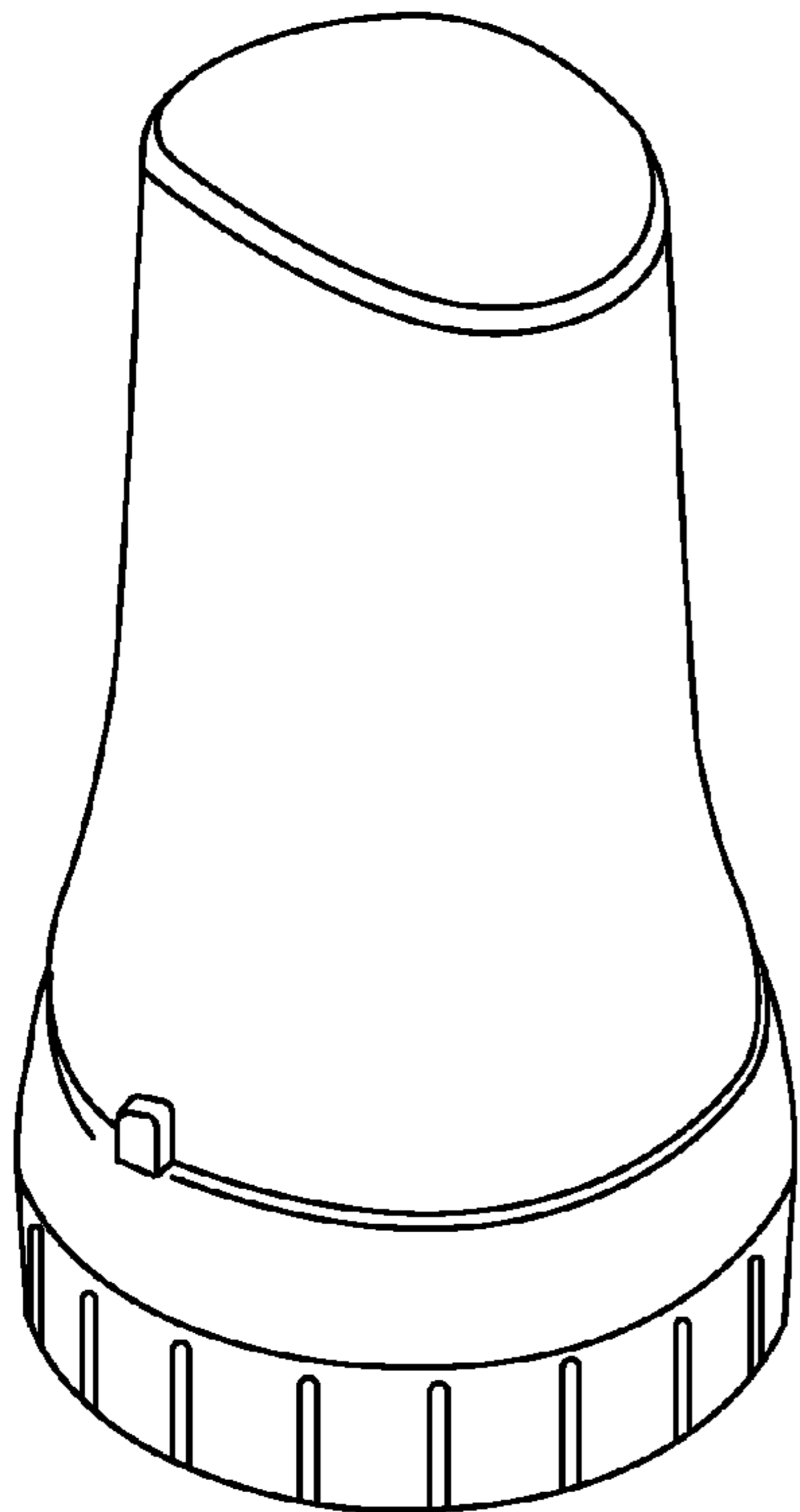

Fig. 9

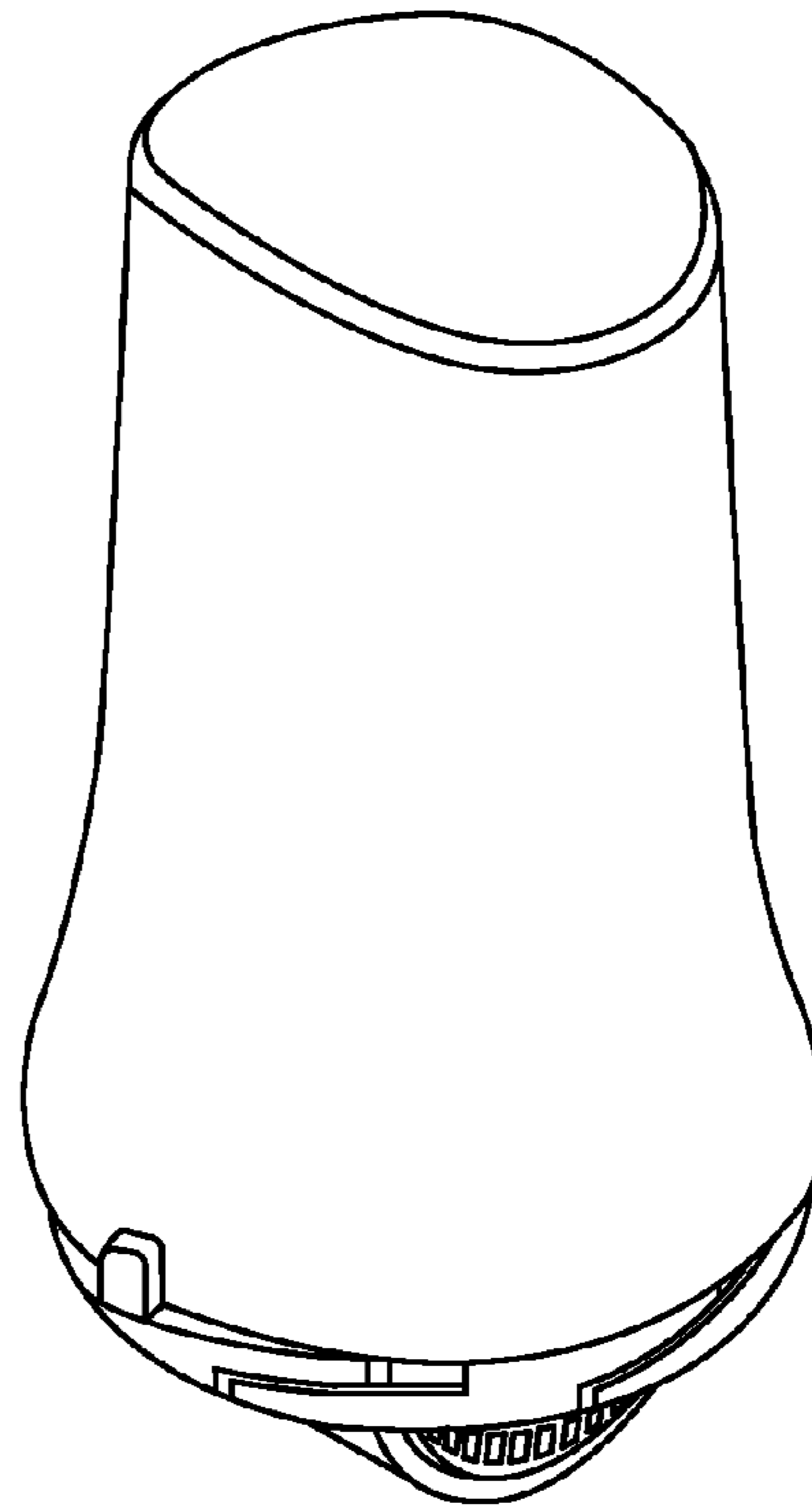

Fig. 10

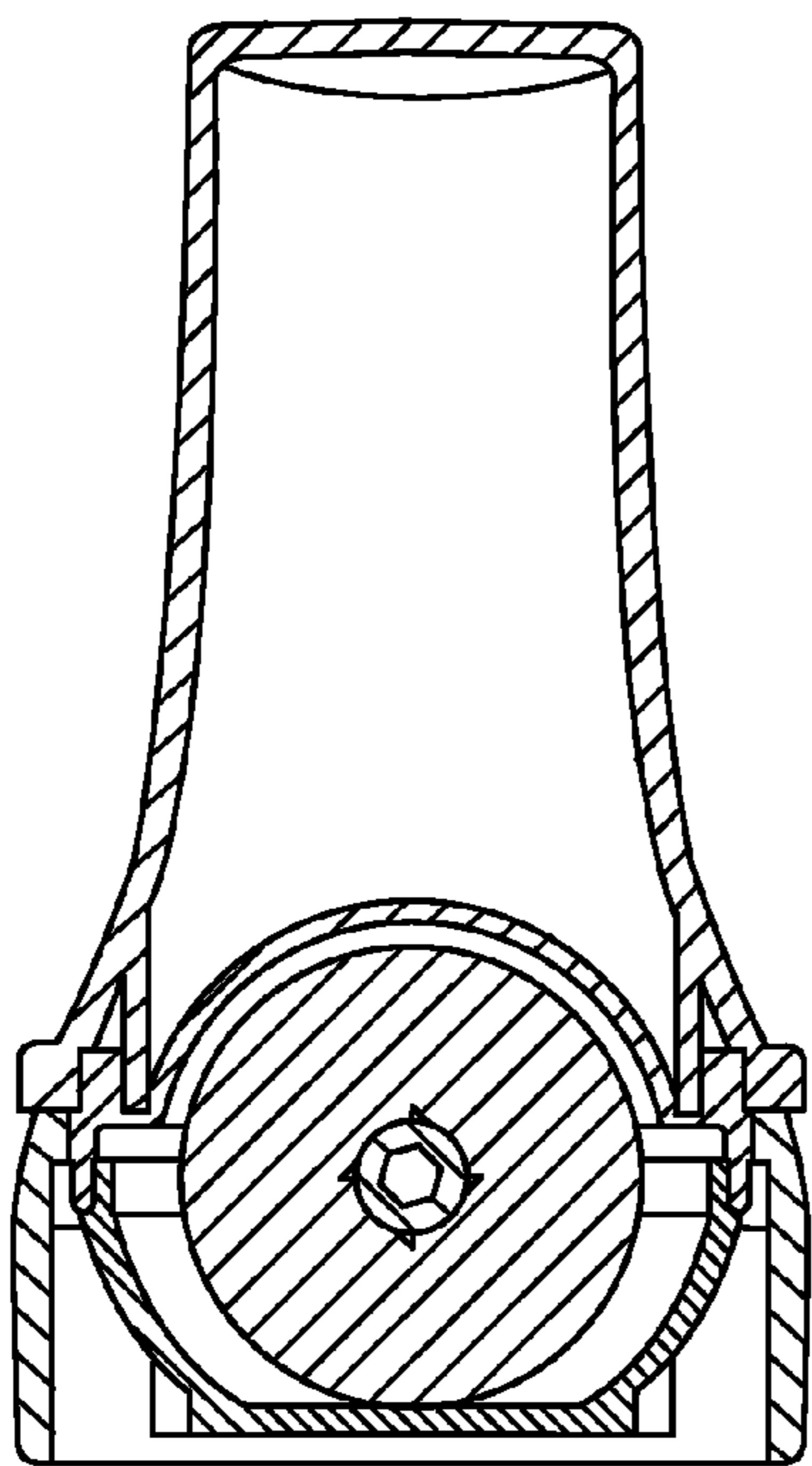

Fig. 11

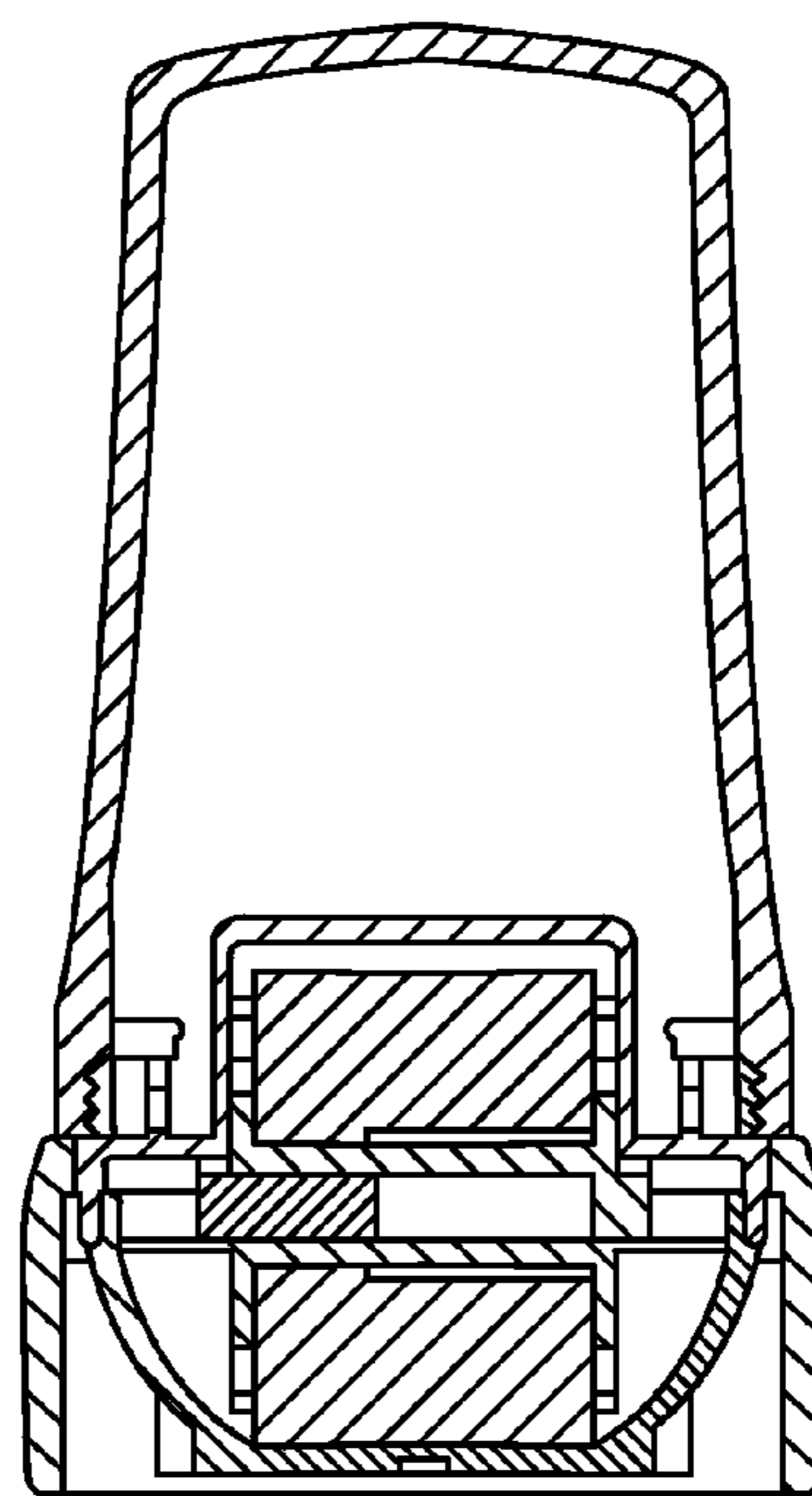

Fig. 12

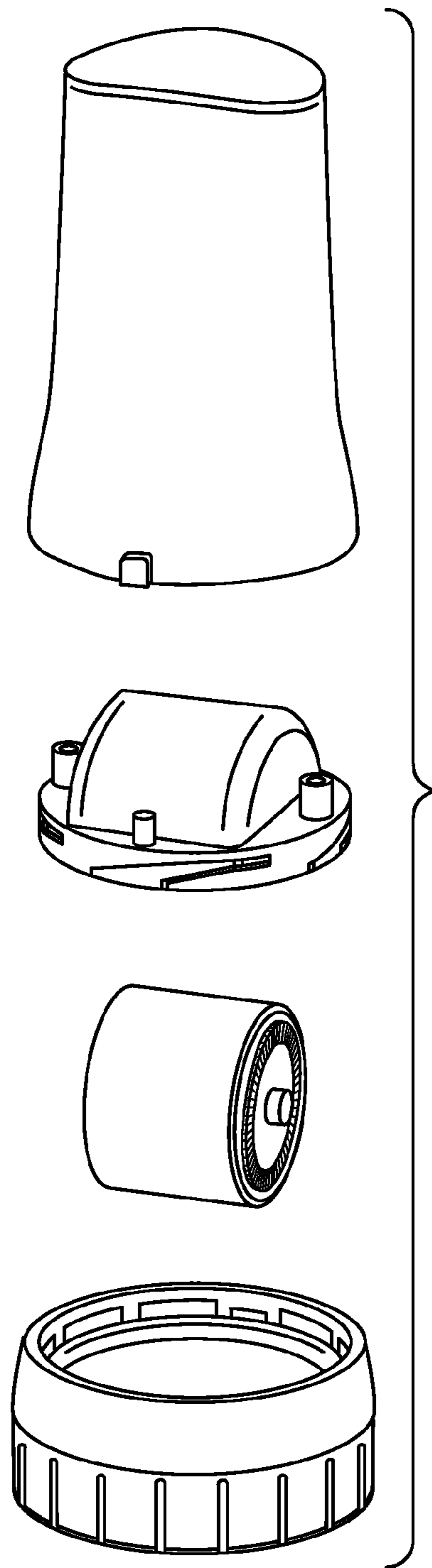

Fig. 13