



US00D678852S

(12) **United States Design Patent**
Marshall

(10) **Patent No.:** **US D678,852 S**

(45) **Date of Patent:** **** Mar. 26, 2013**

(54) **HEAT SINK**

(75) Inventor: **Aaron Marshall**, Richmond (AU)

(73) Assignee: **Astral Pool Australia Pty Ltd**, Nobel Park (AU)

(**) Term: **14 Years**

(21) Appl. No.: **29/419,765**

(22) Filed: **May 1, 2012**

(30) **Foreign Application Priority Data**

Nov. 1, 2011 (AU) 201114910

(51) **LOC (9) Cl.** **13-03**

(52) **U.S. Cl.** **D13/179**

(58) **Field of Classification Search** D13/179;
165/80.3, 104.26, 104.33, 122, 151, 185;
257/706, 707, 718-722; 361/695, 697, 700,
361/702, 704, 709, 710, 711, 719

See application file for complete search history.

(56) **References Cited**

U.S. PATENT DOCUMENTS

D458,228 S *	6/2002	Jacobson	D13/152
6,736,195 B2 *	5/2004	Busch et al.	165/109.1
D556,702 S *	12/2007	Laufer et al.	D13/179
7,403,394 B2 *	7/2008	Chen	361/704
7,551,442 B2 *	6/2009	Stefanoski	361/700
7,626,821 B1 *	12/2009	Buffington	361/719

D638,376 S *	5/2011	Herrmann et al.	D13/179
2002/0174980 A1 *	11/2002	DiBene et al.	165/185
2003/0196779 A1 *	10/2003	Horng et al.	165/80.3
2005/0274490 A1 *	12/2005	Larson	165/80.3
2009/0151900 A1 *	6/2009	Huang	165/80.3
2009/0242170 A1 *	10/2009	Weber	165/80.3
2010/0296247 A1 *	11/2010	Chang et al.	361/699

* cited by examiner

Primary Examiner — Selina Sikder

(74) *Attorney, Agent, or Firm* — Oblon, Spivak, McClelland, Maier & Neustadt, L.L.P.

(57) **CLAIM**

The ornamental design for a heat sink, as shown and described.

DESCRIPTION

FIG. 1 is a front elevational view of a heat sink;
FIG. 2 is a rear elevational view thereof;
FIG. 3 is a left side elevational view thereof;
FIG. 4 is a right side elevational view thereof;
FIG. 5 is a bottom plan view thereof;
FIG. 6 is a front, bottom, and right side perspective view thereof;
FIG. 7 is a rear, bottom, and left side perspective view thereof;
and,
FIG. 8 is a rear, bottom, and right side perspective view thereof.

Any portion of the top of the heat sink not shown in the drawings forms no part of the claimed design.

The broken lines in the drawings depict environmental subject matter only and form no part of the claimed design.

1 Claim, 8 Drawing Sheets

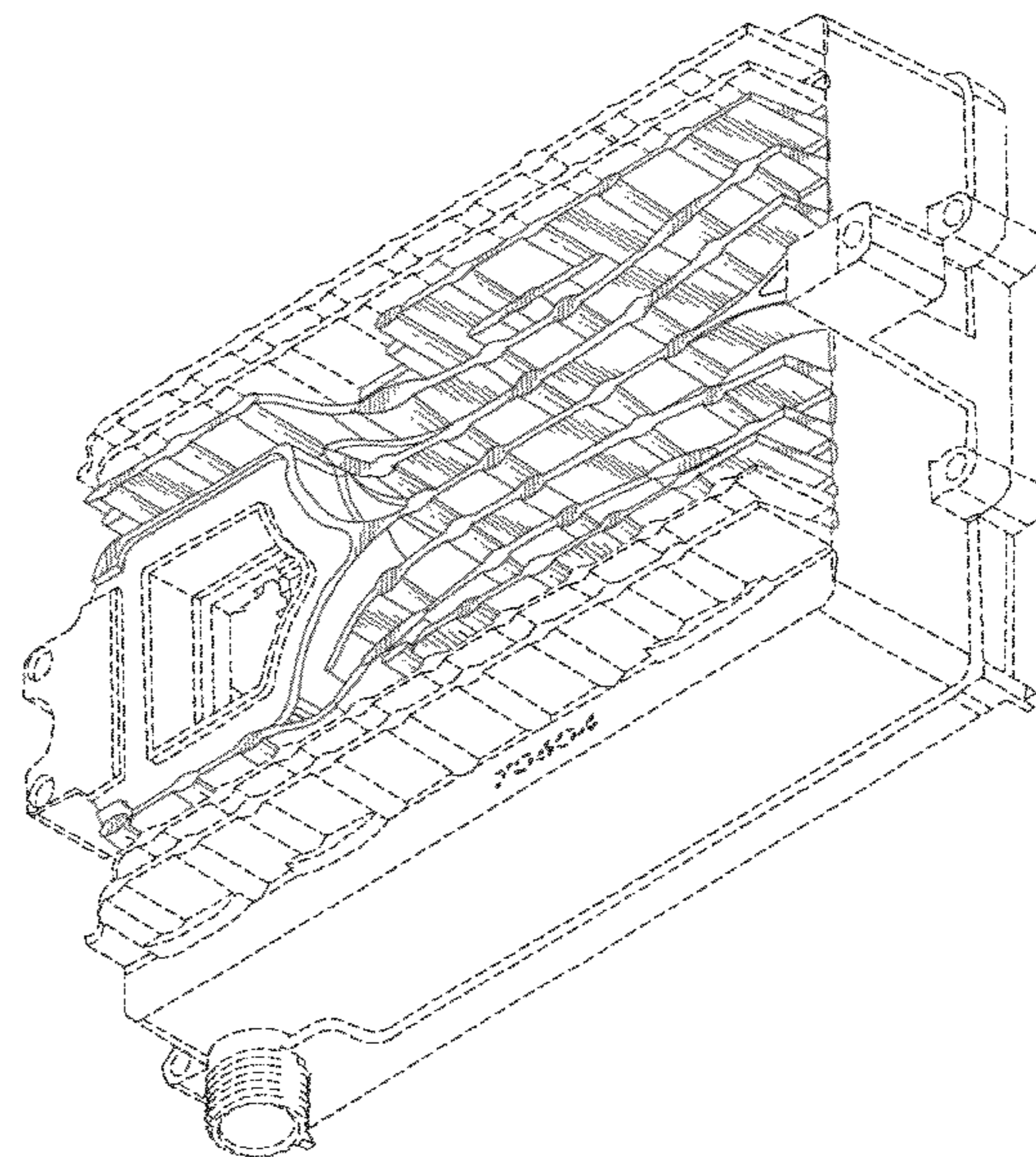
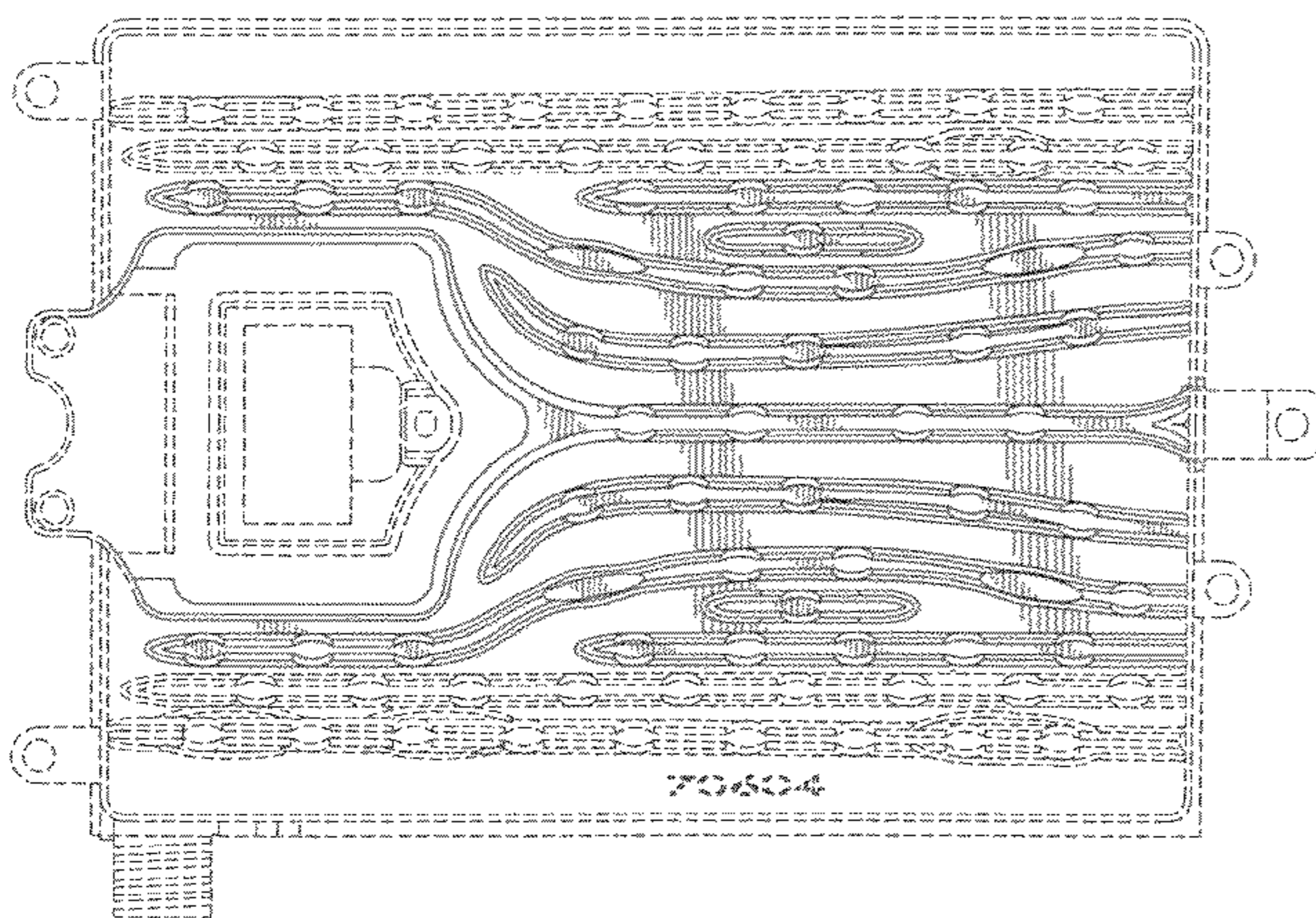

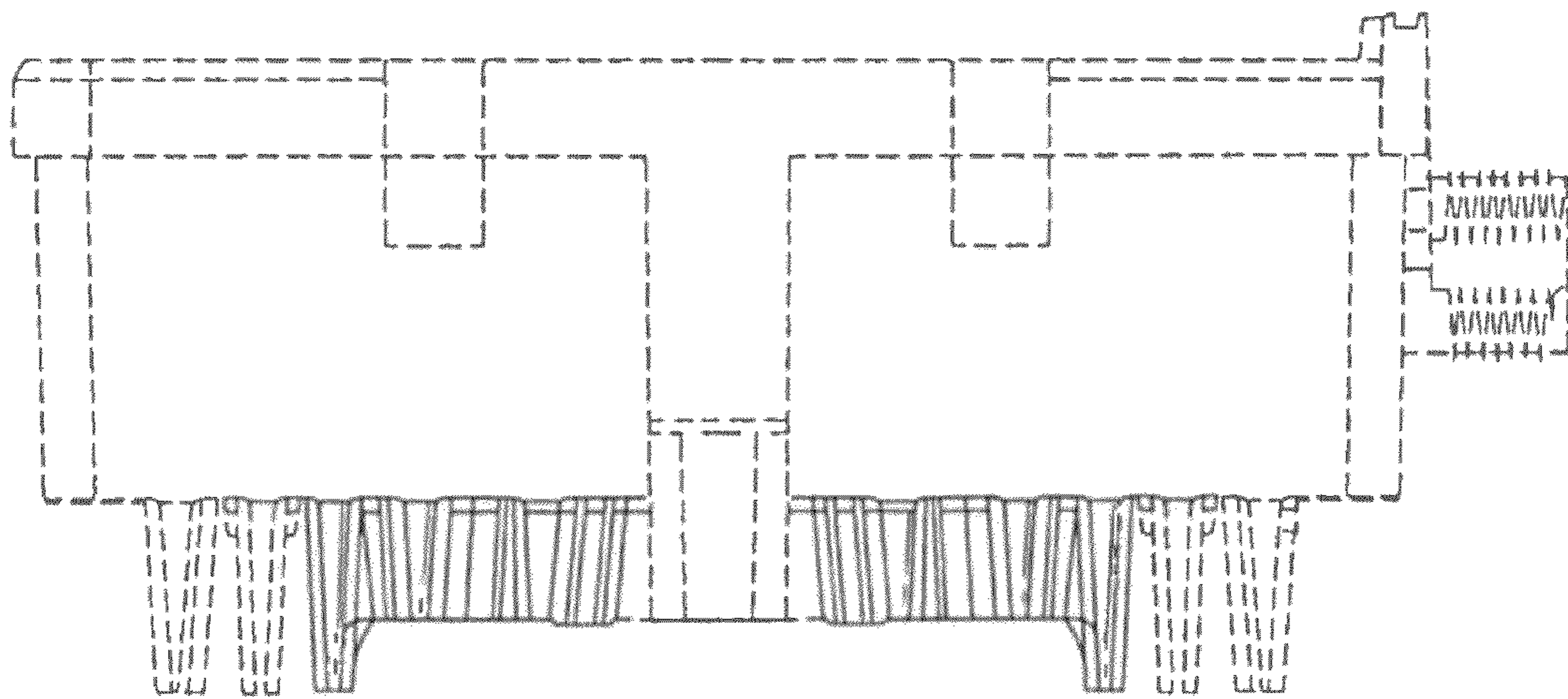

Fig. 1

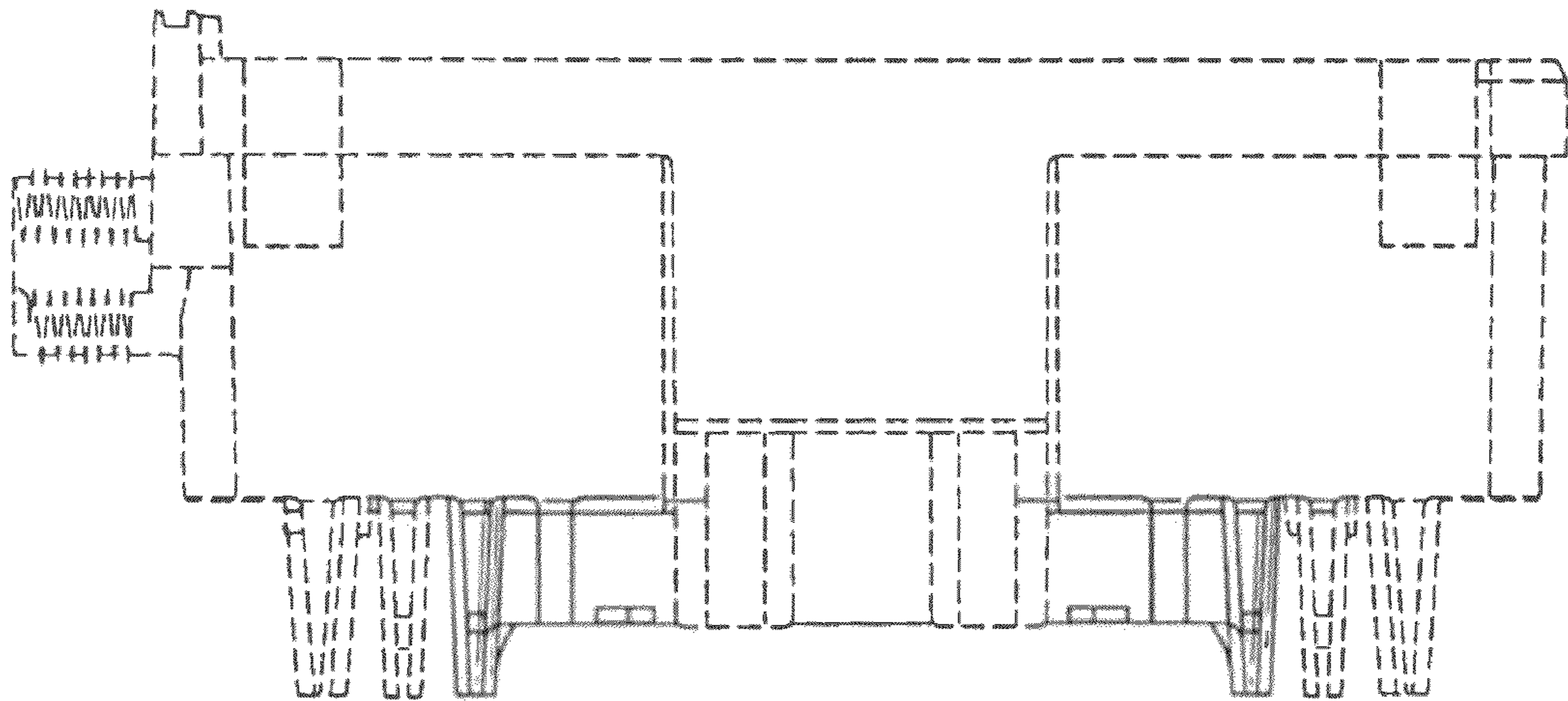

Fig. 2

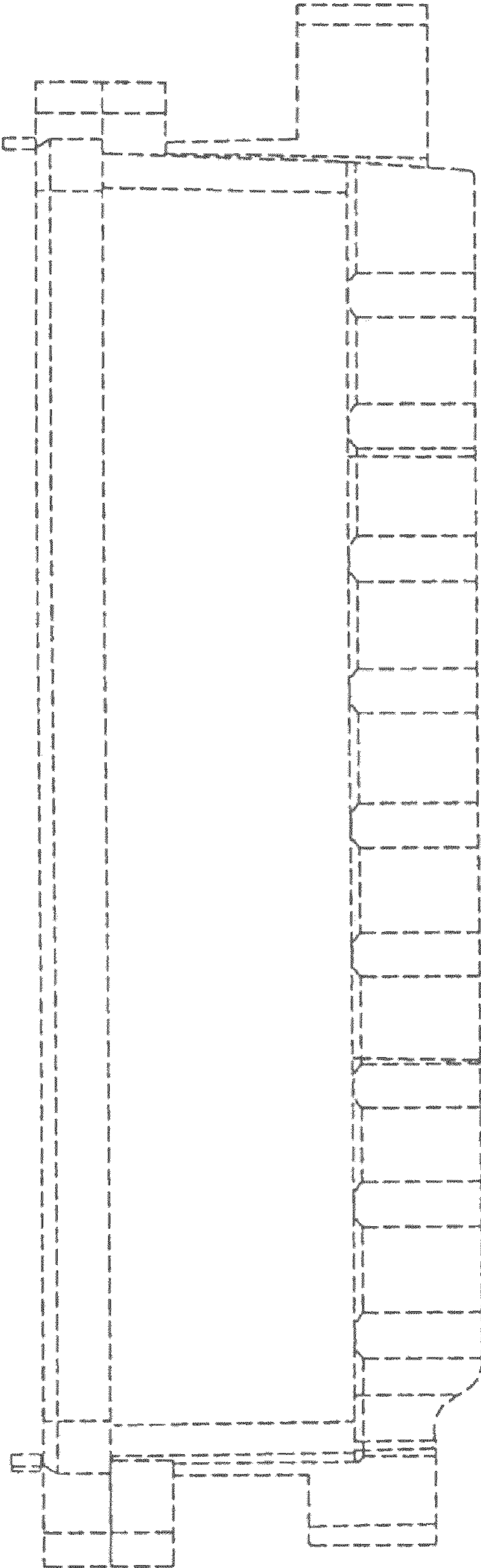

Fig. 3

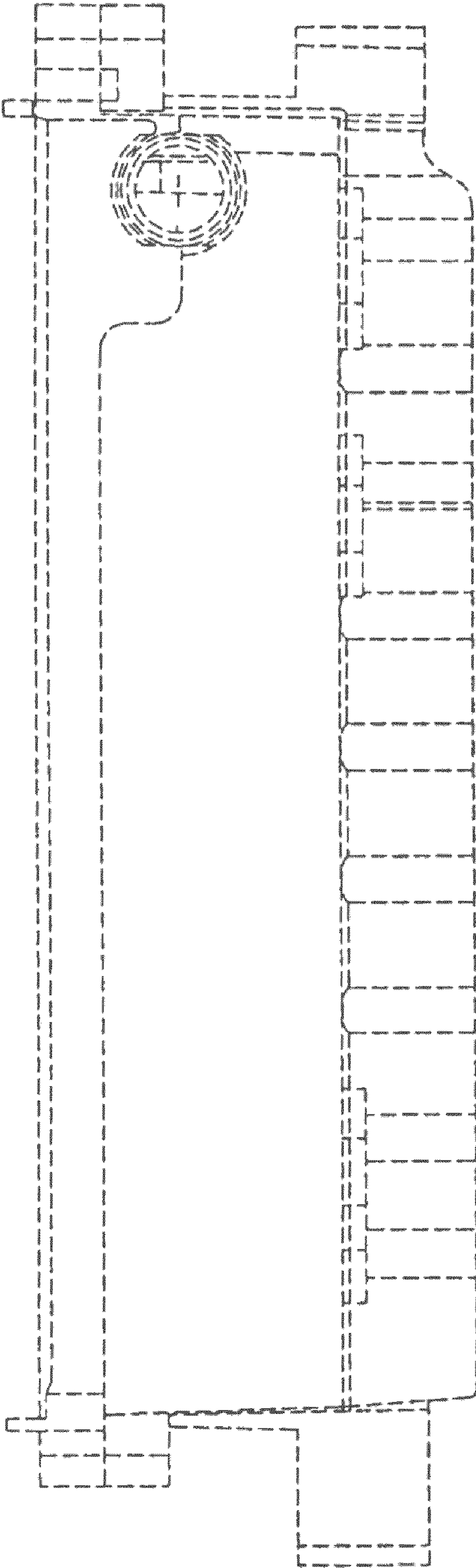

Fig. 4

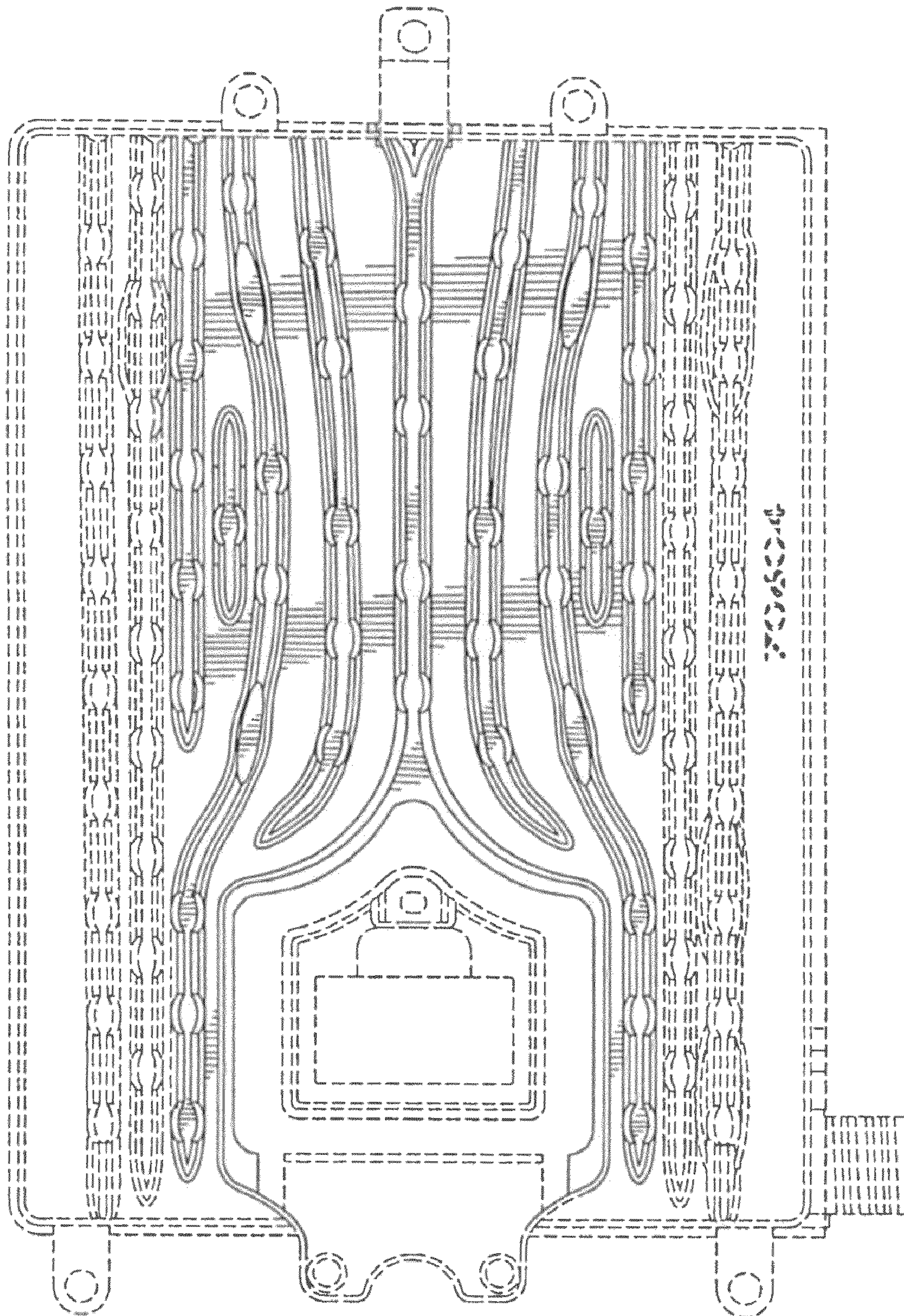

Fig. 5

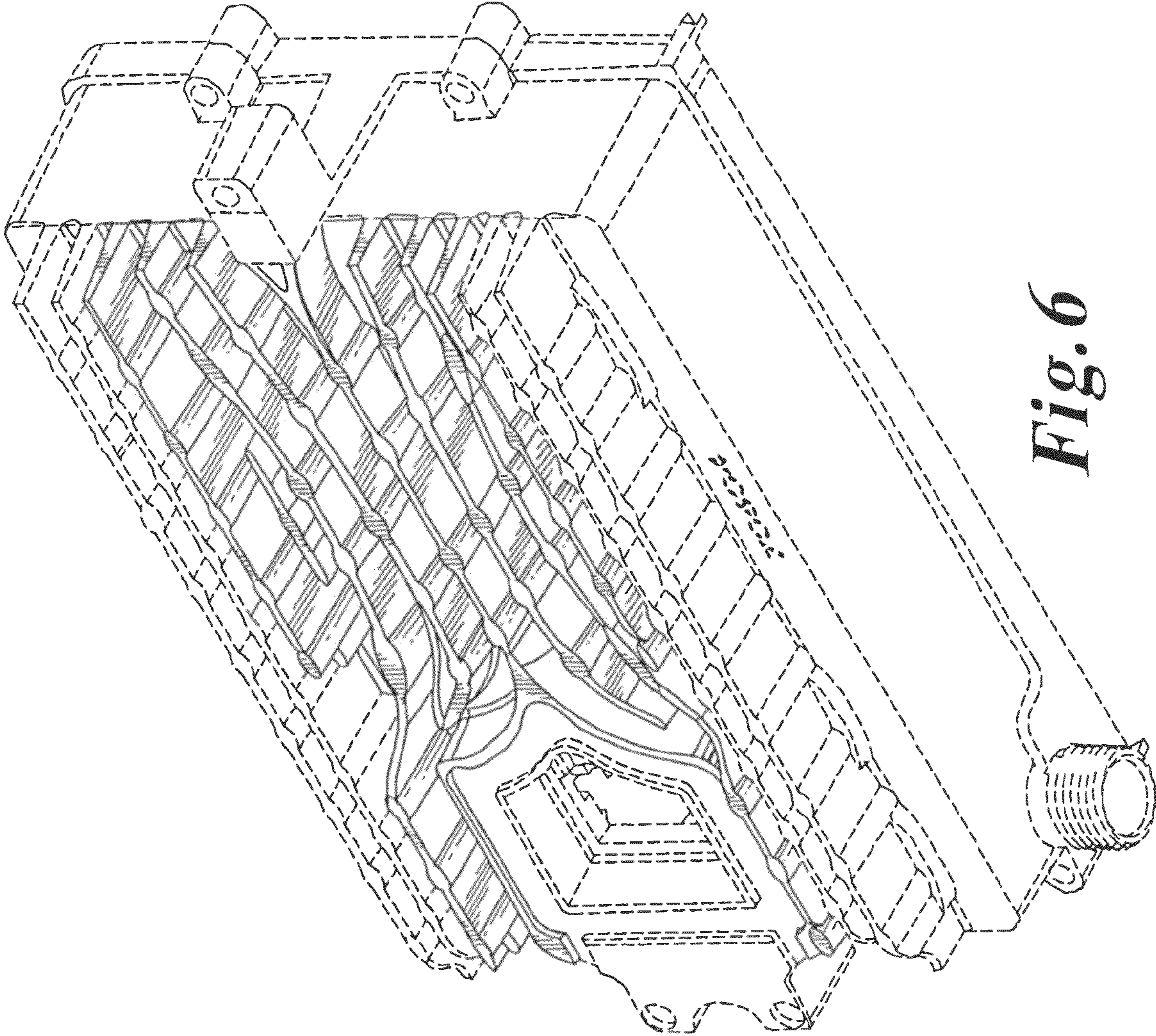

Fig. 6

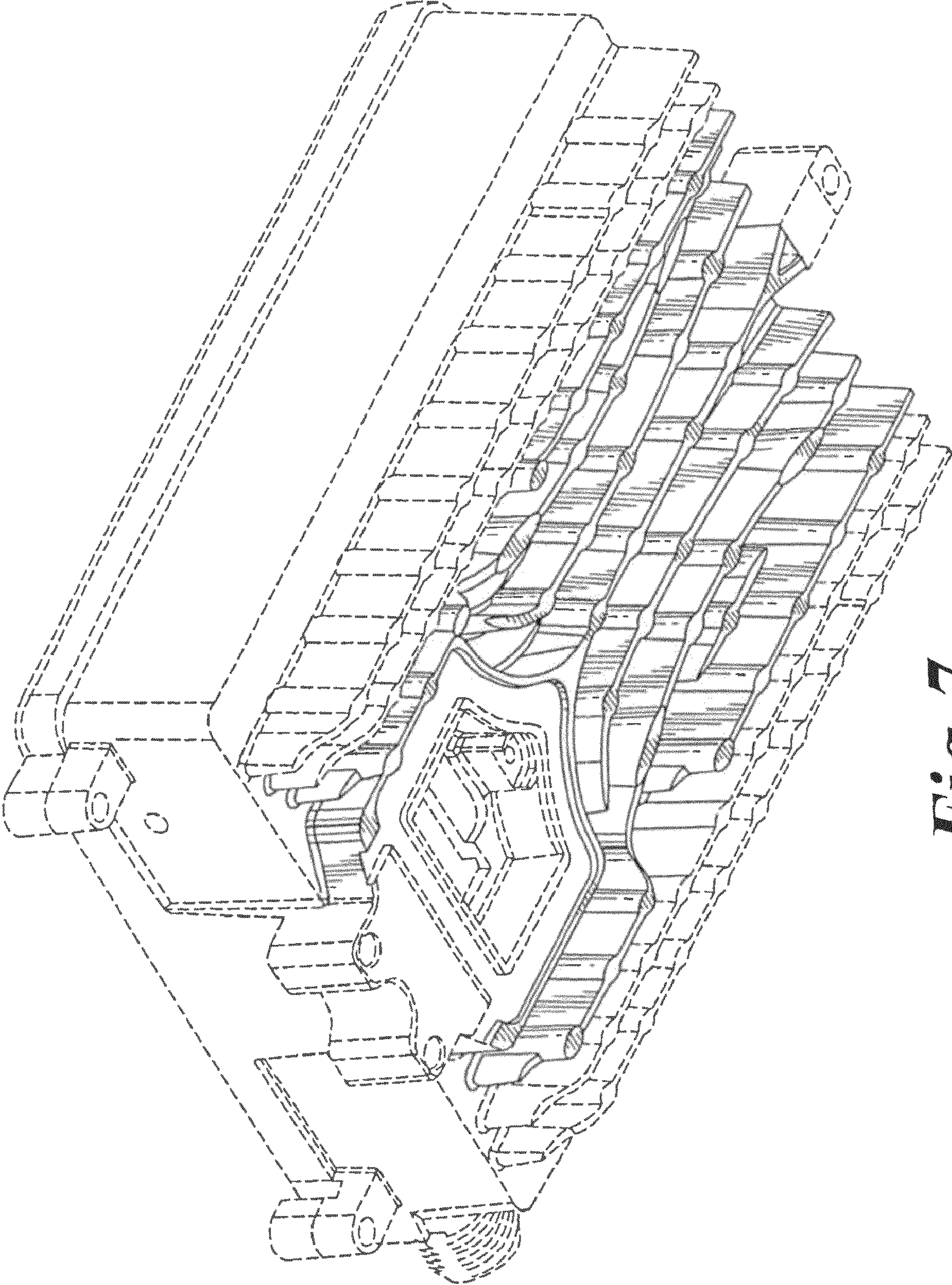

Fig. 7

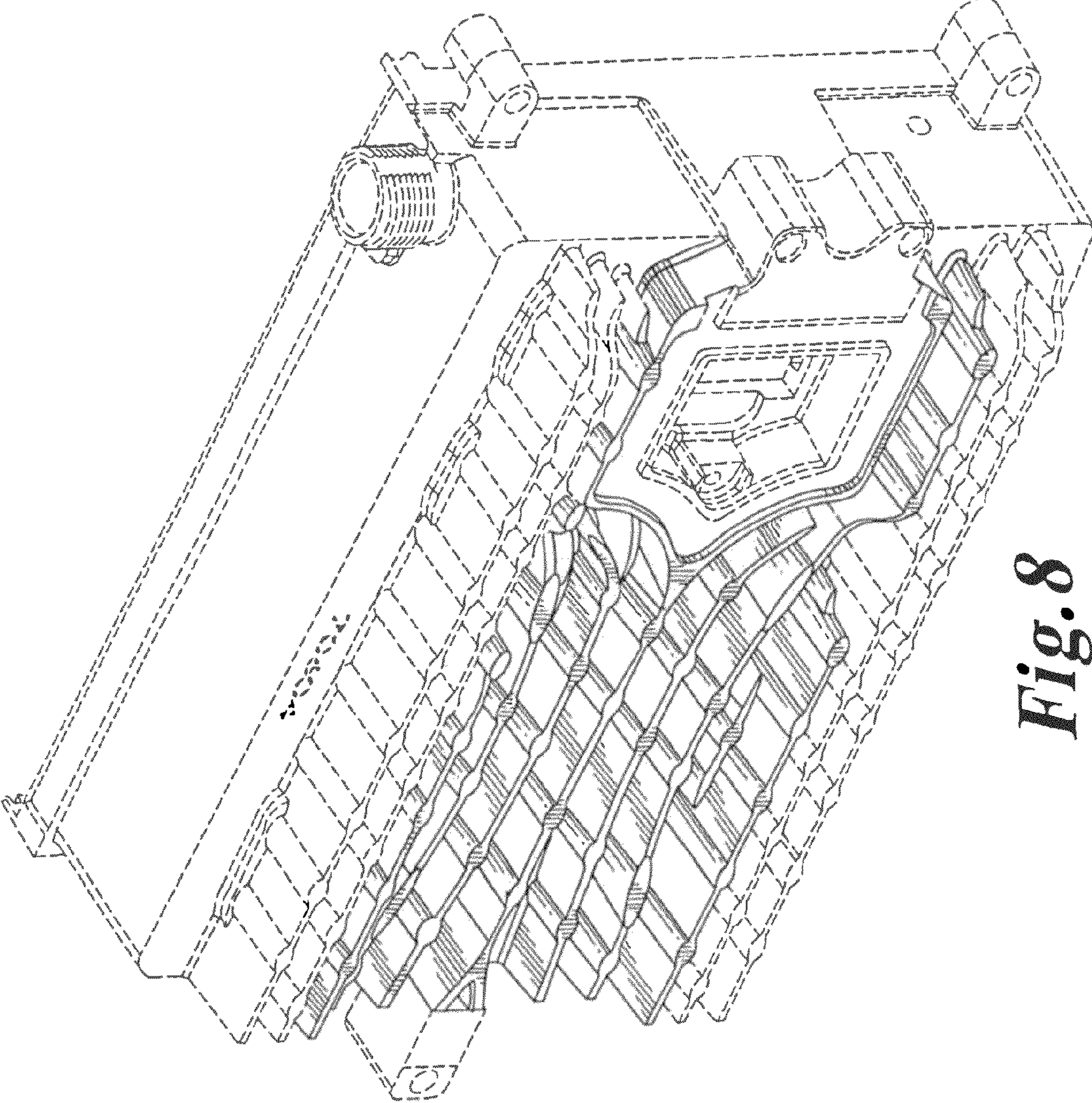

Fig. 8