



US00D678407S

(12) **United States Design Patent**
Yonekawa et al.

(10) **Patent No.:** **US D678,407 S**
(45) **Date of Patent:** **** Mar. 19, 2013**

(54) **INK CARTRIDGE**

(75) Inventors: **Masahiro Yonekawa**, Machida (JP);
Tetsu Morino, Zama (JP); **Tsunehiko**
Ishi, Setagaya-ku (JP)

(73) Assignee: **Ricoh Company, Ltd.**, Tokyo (JP)

(**) Term: **14 Years**

(21) Appl. No.: **29/410,985**

(22) Filed: **Jan. 13, 2012**

(51) **LOC (9) Cl.** **18-02**

(52) **U.S. Cl.** **D18/56**

(58) **Field of Classification Search** D18/12,
D18/40, 43, 56; 347/86-67

See application file for complete search history.

(56) **References Cited**

U.S. PATENT DOCUMENTS

D281,333	S	*	11/1985	Nibley et al.	D18/56
D298,255	S	*	10/1988	Hirata	D18/43
D492,962	S	*	7/2004	Suzuki et al.	D18/56
D526,009	S	*	8/2006	Sasaki et al.	D18/56
D538,337	S	*	3/2007	Hattori et al.	D18/56
D641,400	S	*	7/2011	Hattori	D18/56
D656,987	S	*	4/2012	Kanbe et al.	D18/56
2008/0291251	A1	*	11/2008	Hattori	347/86

OTHER PUBLICATIONS

U.S. Appl. No. 29/410,973, filed Jan. 13, 2012, Yonekawa, et al.
U.S. Appl. No. 29/204,766, filed May 5, 2004, Katsuyama.
U.S. Appl. No. 29/204,764, filed May 5, 2004, Katsuyama.
U.S. Appl. No. 29/204,765, filed May 5, 2004, Katsuyama.

* cited by examiner

Primary Examiner — Cathy A MacCormac

(74) *Attorney, Agent, or Firm* — Oblon, Spivak,
McClelland, Maier & Neustadt, L.L.P.

(57) **CLAIM**

The ornamental design for an ink cartridge, as shown and described.

DESCRIPTION

FIG. 1 is a top plan view of an ink cartridge;
FIG. 2 is a bottom plan view thereof;
FIG. 3 is a front elevational view thereof;
FIG. 4 is a rear elevational view thereof;
FIG. 5 is a right side elevational view thereof;
FIG. 6 is a left side elevational view thereof; and,
FIG. 7 is a front, top, and right side perspective view thereof.
The broken lines in the drawings depict environmental subject matter only and form no part of the claimed design.

1 Claim, 5 Drawing Sheets

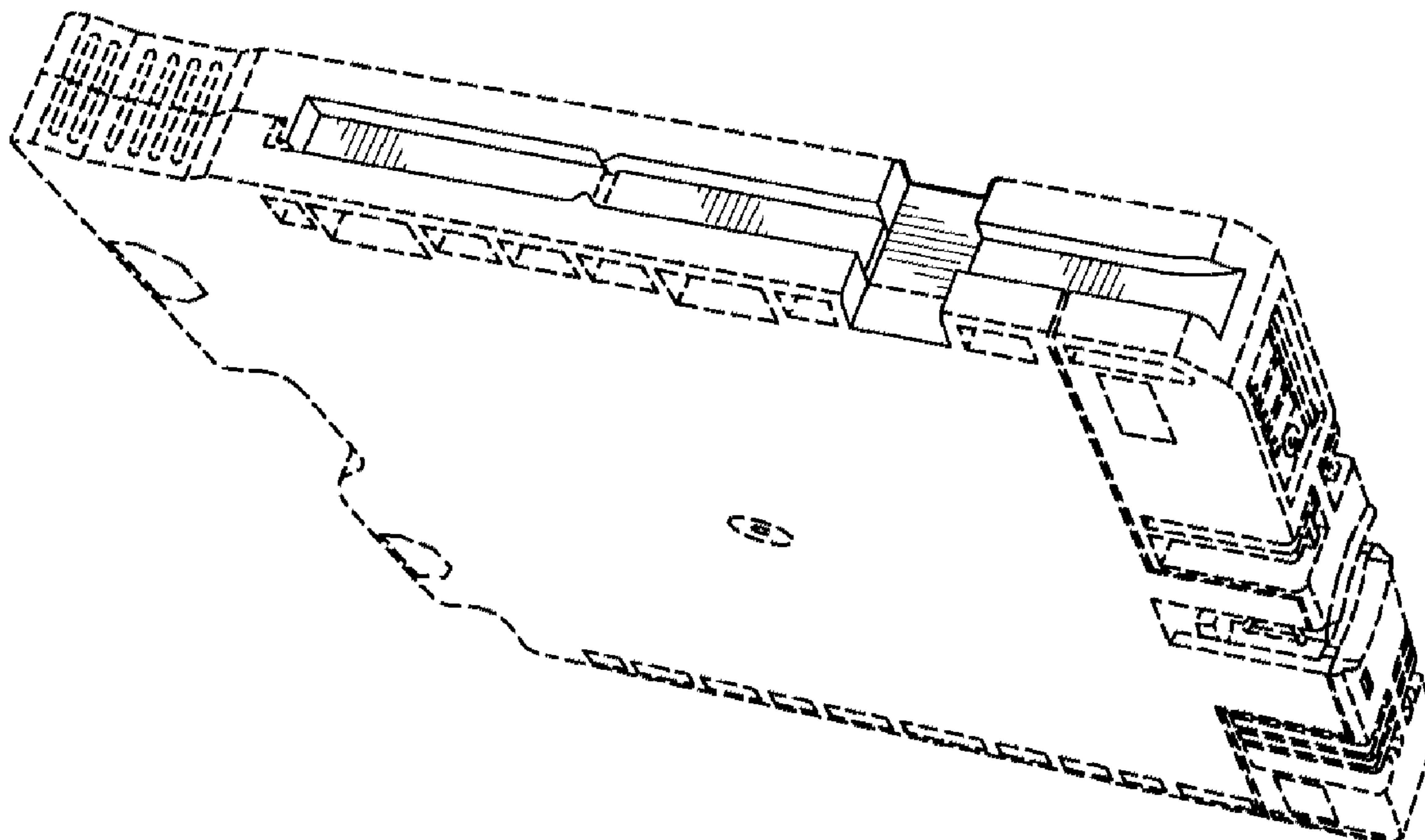

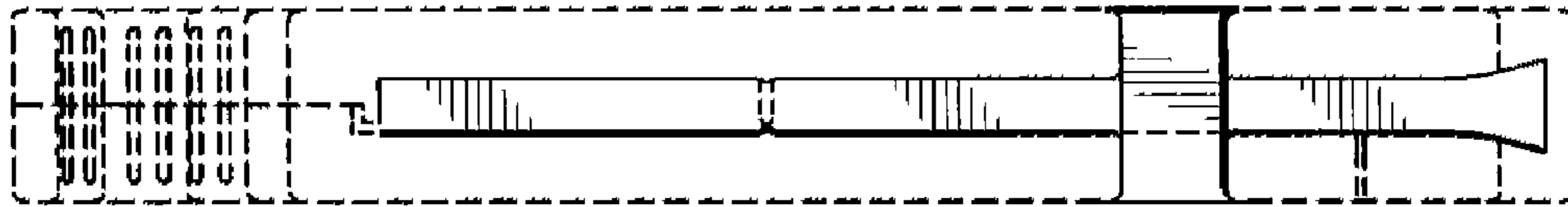

Fig. 1

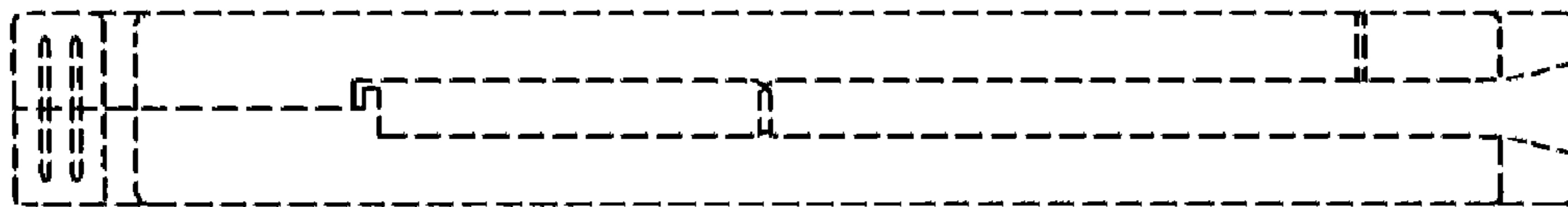

Fig. 2

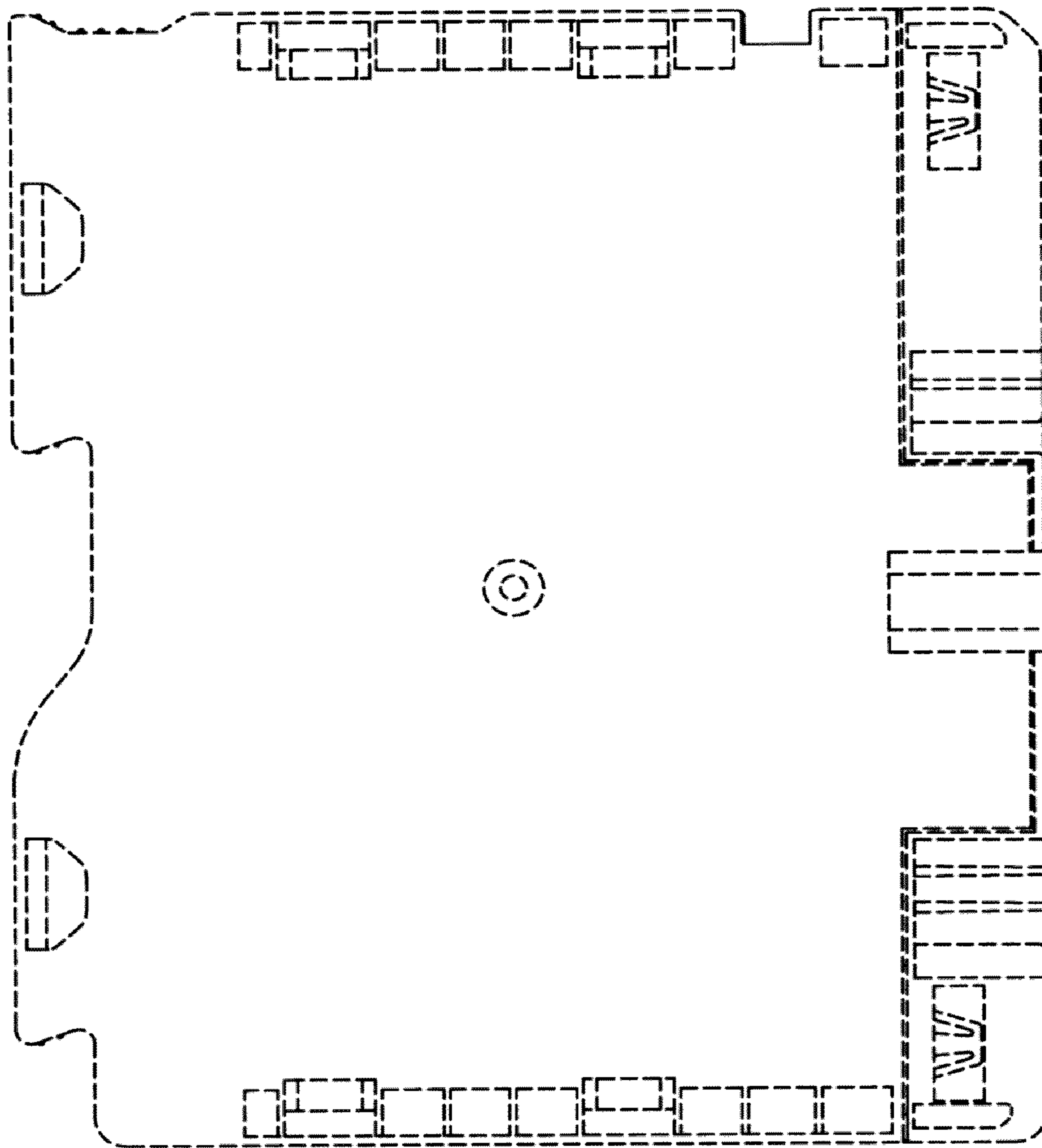

Fig. 3

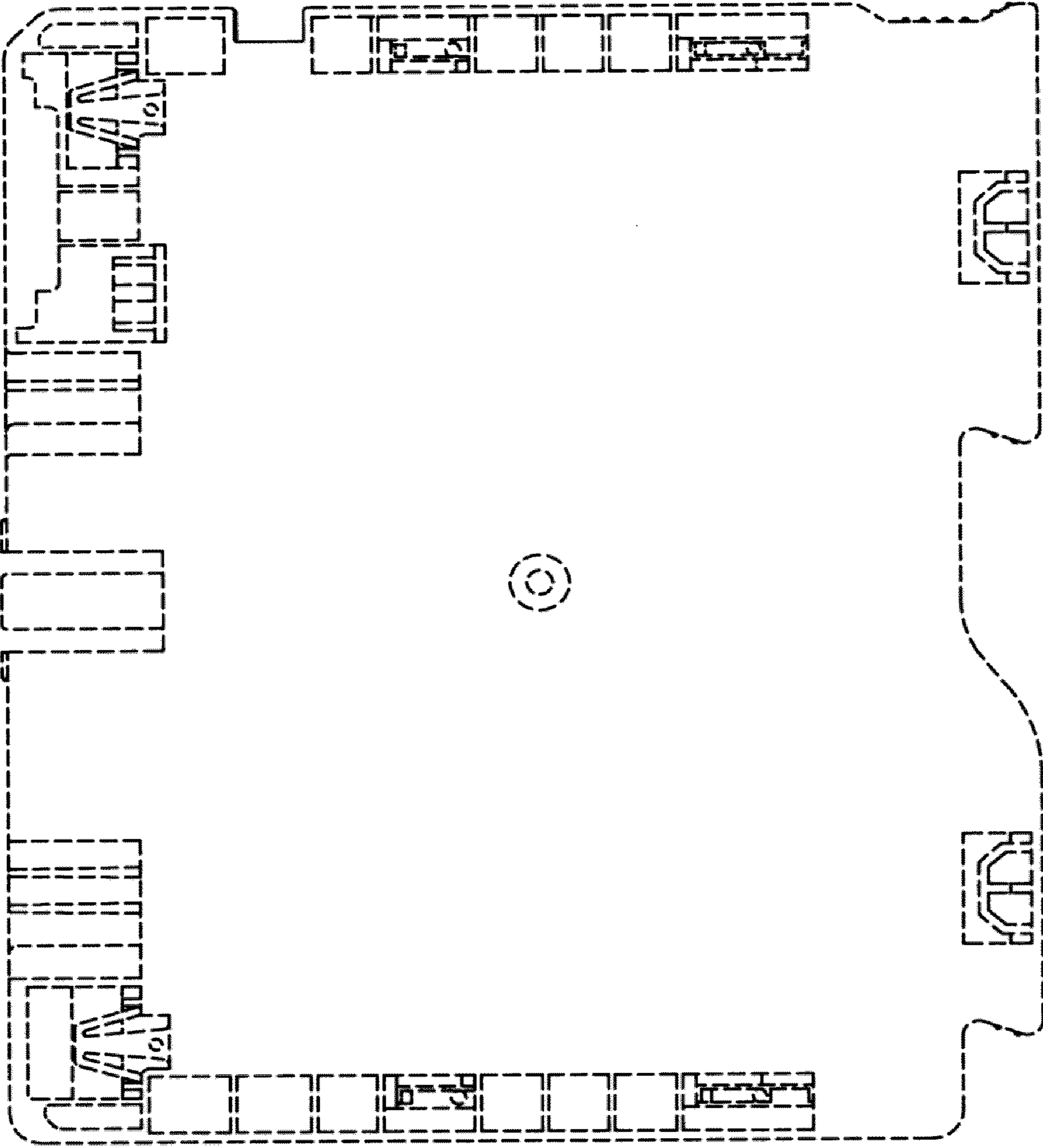

Fig. 4

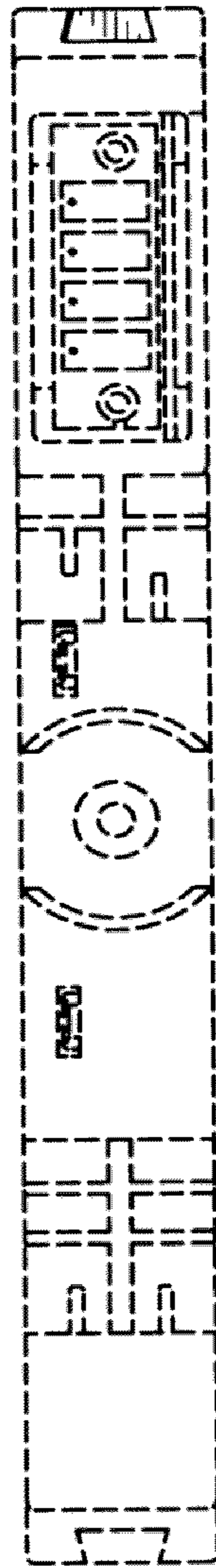

Fig. 5

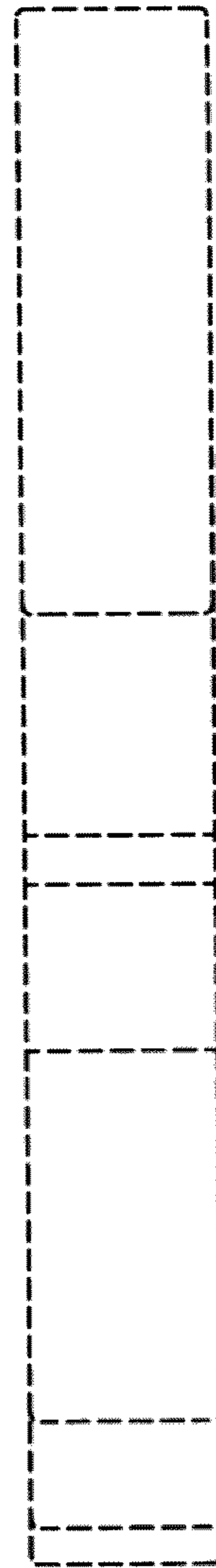

Fig. 6

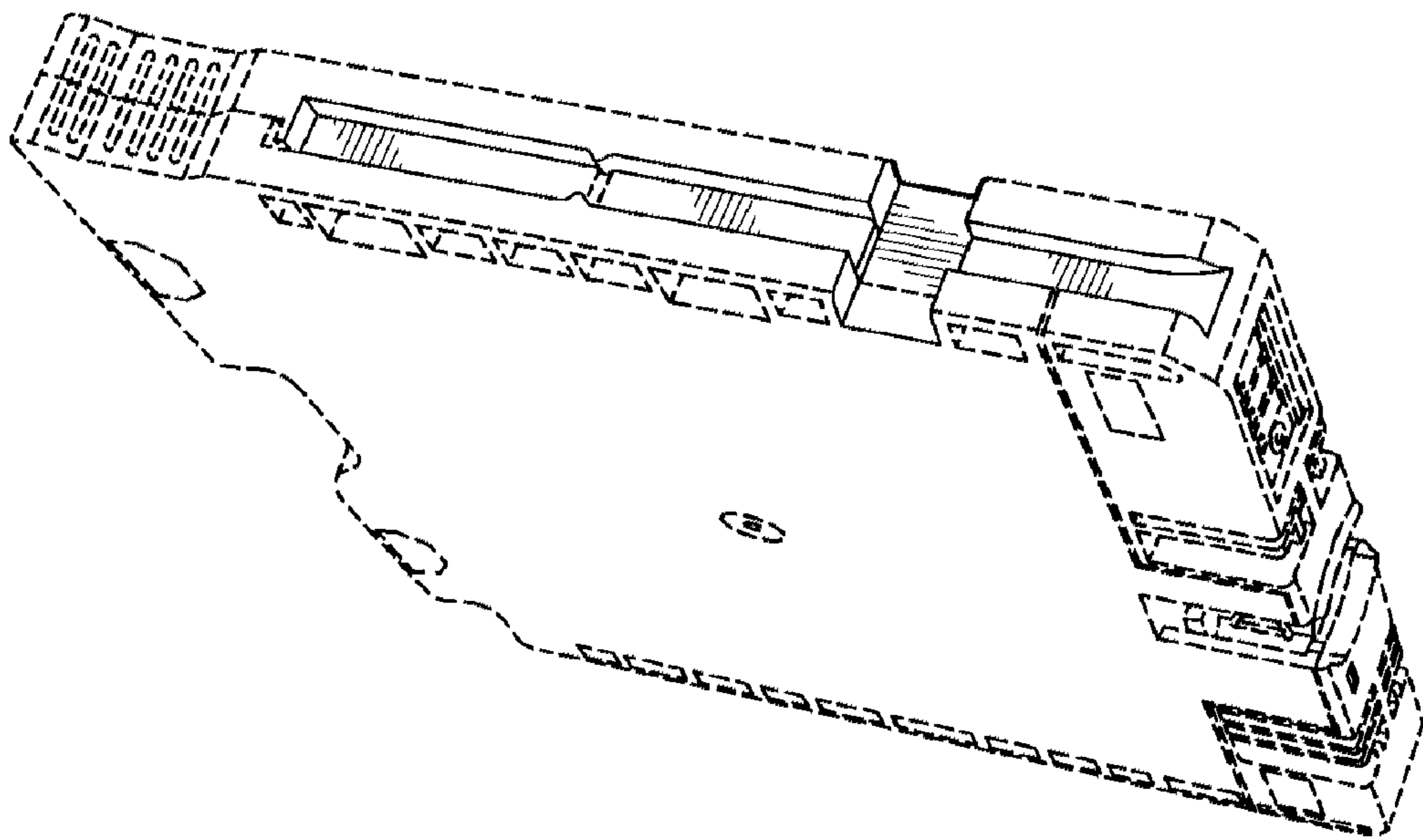

Fig. 7

UNITED STATES PATENT AND TRADEMARK OFFICE
CERTIFICATE OF CORRECTION

PATENT NO. : D678,407 S
APPLICATION NO. : 29/410985
DATED : March 19, 2013
INVENTOR(S) : Masahiro Yonekawa et al.

Page 1 of 1

It is certified that error appears in the above-identified patent and that said Letters Patent is hereby corrected as shown below:

Item (75), Inventors, change "Ishi" to --Ishii--.

Signed and Sealed this
Third Day of September, 2013



Teresa Stanek Rea
Acting Director of the United States Patent and Trademark Office