



US00D678189S

(12) **United States Design Patent**
Fitch et al.

(10) **Patent No.:** **US D678,189 S**

(45) **Date of Patent:** **** Mar. 19, 2013**

(54) **CHARGER**

(75) Inventors: **Jonathan A Fitch**, Syracuse, NY (US);
Donwoong Kang, Camillus, NY (US)

(73) Assignee: **Eveready Battery Company, Inc.**, St.
Louis, MO (US)

(**) Term: **14 Years**

(21) Appl. No.: **29/361,327**

(22) Filed: **May 10, 2010**

(51) **LOC (9) Cl.** **13-02**

(52) **U.S. Cl.** **D13/107**

(58) **Field of Classification Search** D13/107–110,
D13/118–119, 184, 199; D14/251, 253,
D14/432, 434, 488, 490, 492; 320/107–115;
D18/26; D10/77

See application file for complete search history.

(56) **References Cited**

U.S. PATENT DOCUMENTS

D156,569 S *	12/1949	Simpson	D10/80
D238,102 S *	12/1975	Dolan	D18/26
D276,844 S *	12/1984	Eaton	D24/165
D281,789 S *	12/1985	Albert	D18/26
D328,763 S *	8/1992	Laviana et al.	D20/12
D368,493 S *	4/1996	Boes et al.	D14/257
D444,122 S *	6/2001	Krieger et al.	D13/107
D570,902 S *	6/2008	Petersen	D18/26
D570,903 S *	6/2008	Petersen	D18/26
D571,722 S *	6/2008	Kang et al.	D13/107
D616,814 S *	6/2010	Weinberg et al.	D13/107
D625,329 S *	10/2010	Guarino	D14/492
D625,330 S *	10/2010	Guarino	D14/492

D632,648 S *	2/2011	Yang	D13/108
D634,269 S *	3/2011	Griffin, Jr.	D13/108
D637,612 S *	5/2011	Batchelder et al.	D14/488
D649,557 S *	11/2011	Duchene	D14/488

* cited by examiner

Primary Examiner — Rosemary K Tarcza

(74) *Attorney, Agent, or Firm* — Russell H. Toye, Jr.

(57) **CLAIM**

We claim the ornamental design for a charger, as shown and described.

DESCRIPTION

FIG. 1 is a front perspective view of the charger.
 FIG. 2 is a top view of the charger.
 FIG. 3 is a bottom view of the charger.
 FIG. 4 is a right side view of the charger. The left side view is a mirror image of the right side view.
 FIG. 5 is a front view of the charger.
 FIG. 6 is a rear view of the charger.
 FIG. 7 is an enlarged top plan view of the charger's graphic display area showing the first charging state.
 FIG. 8 is a view of the graphic display area thereof showing a second charging state.
 FIG. 9 is a view of the graphic display area showing a third charging state.
 FIG. 10 is a view of the graphic display area showing a fourth charging state; and,
 FIG. 11 is a view of the graphic display area showing a fifth charging state.
 The dash-dash broken lines illustrate portions of the charger that form no part of the claimed design. The long and short dashed lines circumscribe the enlarged display area and form no part of the claimed design.

1 Claim, 5 Drawing Sheets

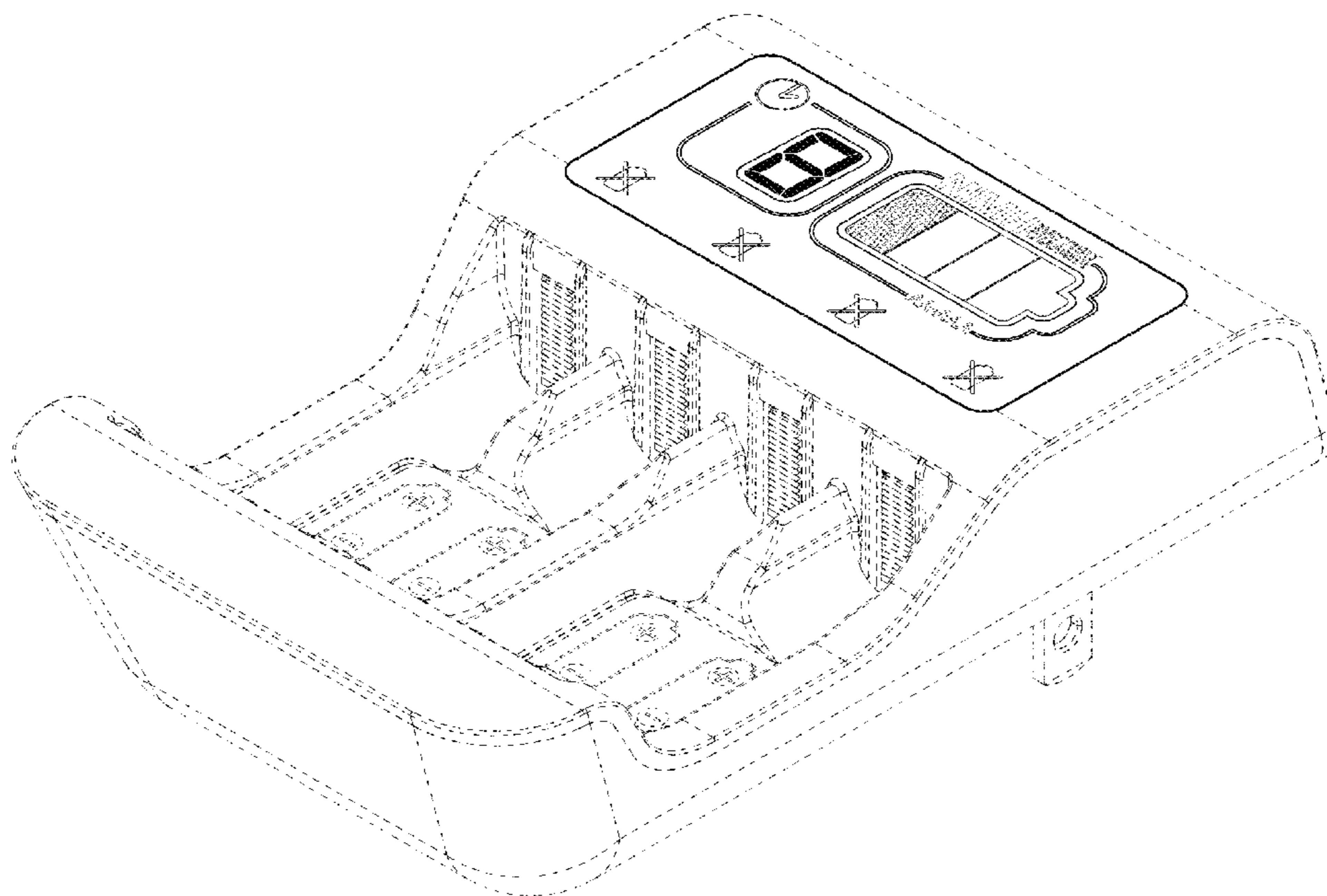

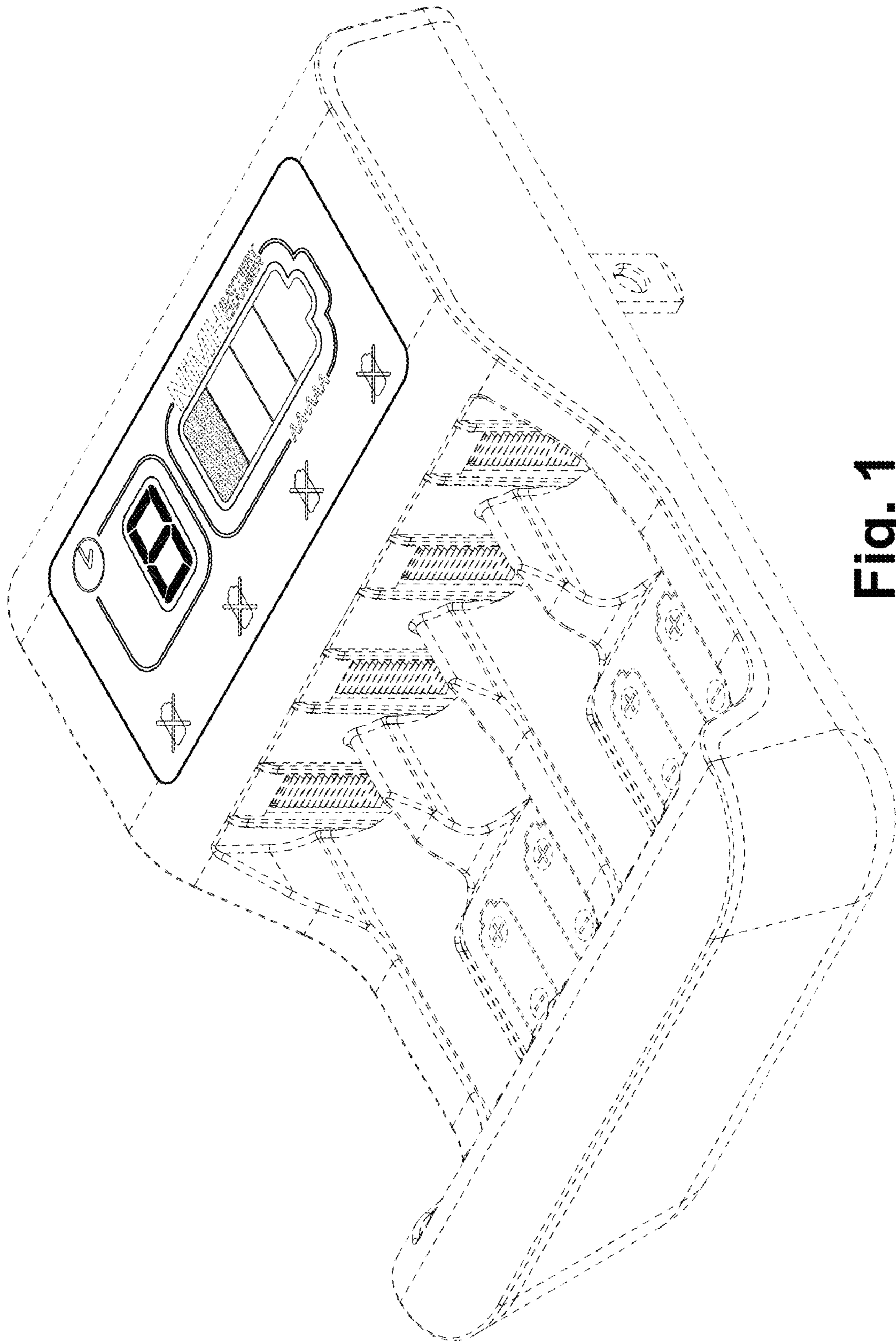

Fig. 1

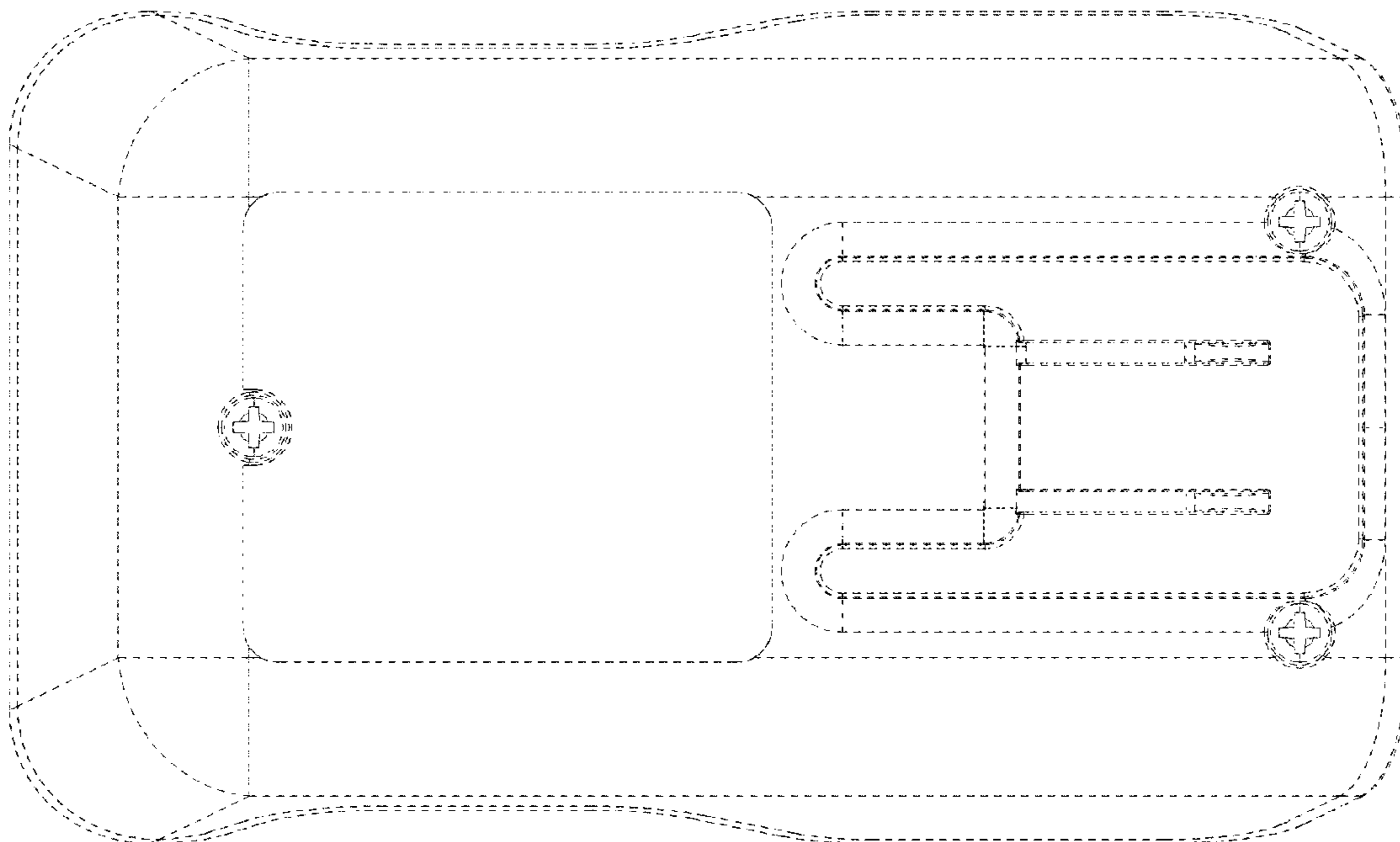

Fig 3

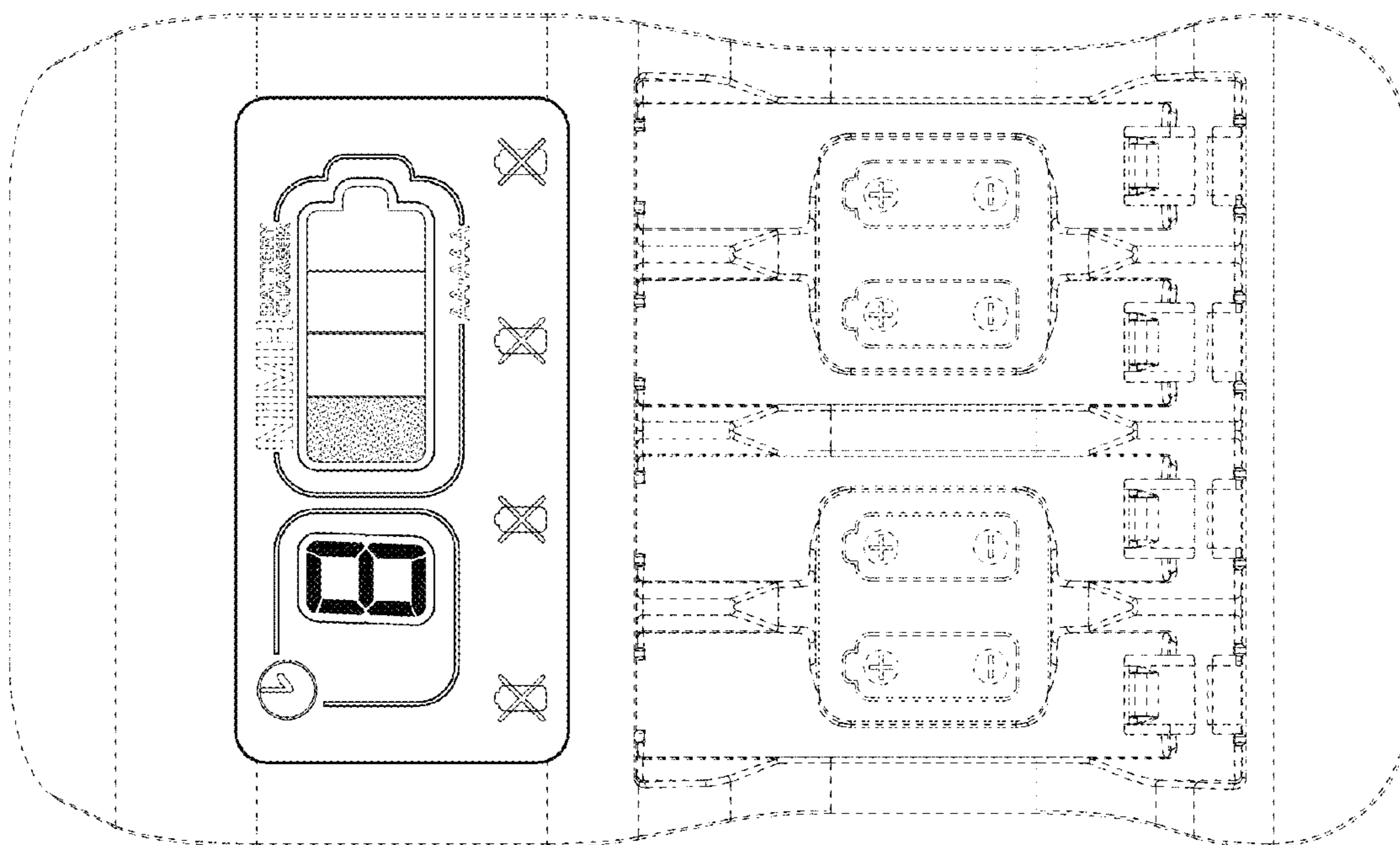

Fig 2

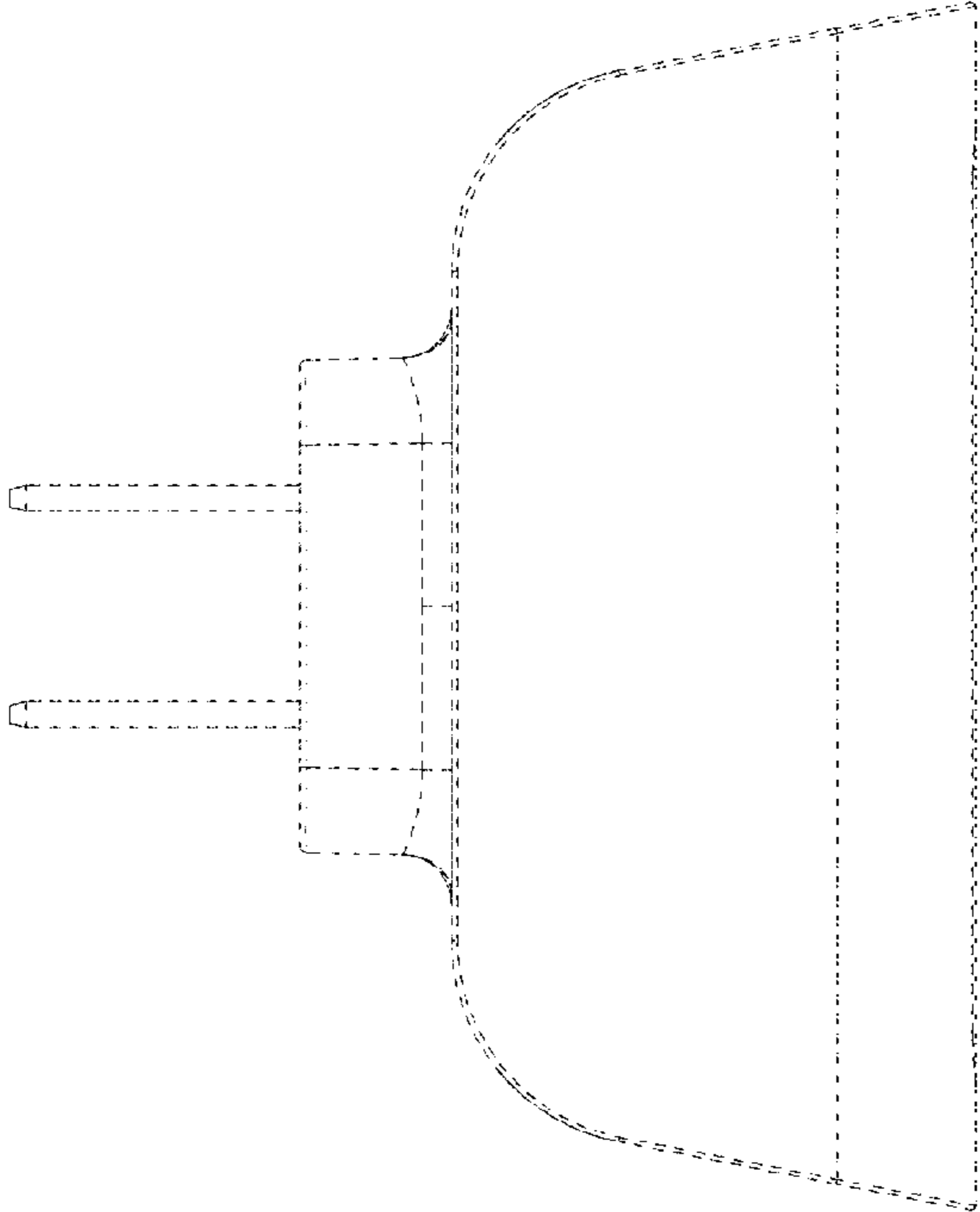

Fig 5

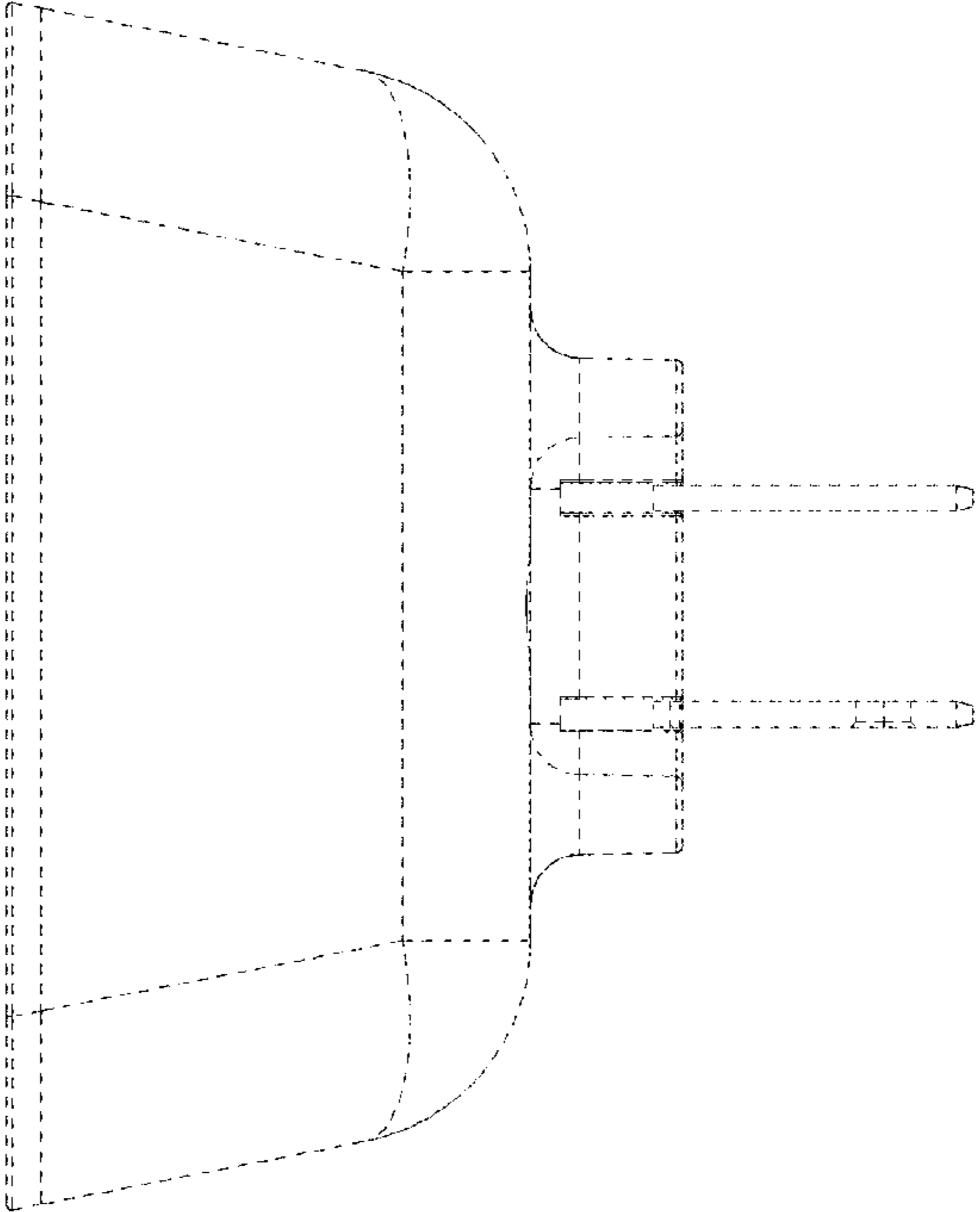

Fig 6

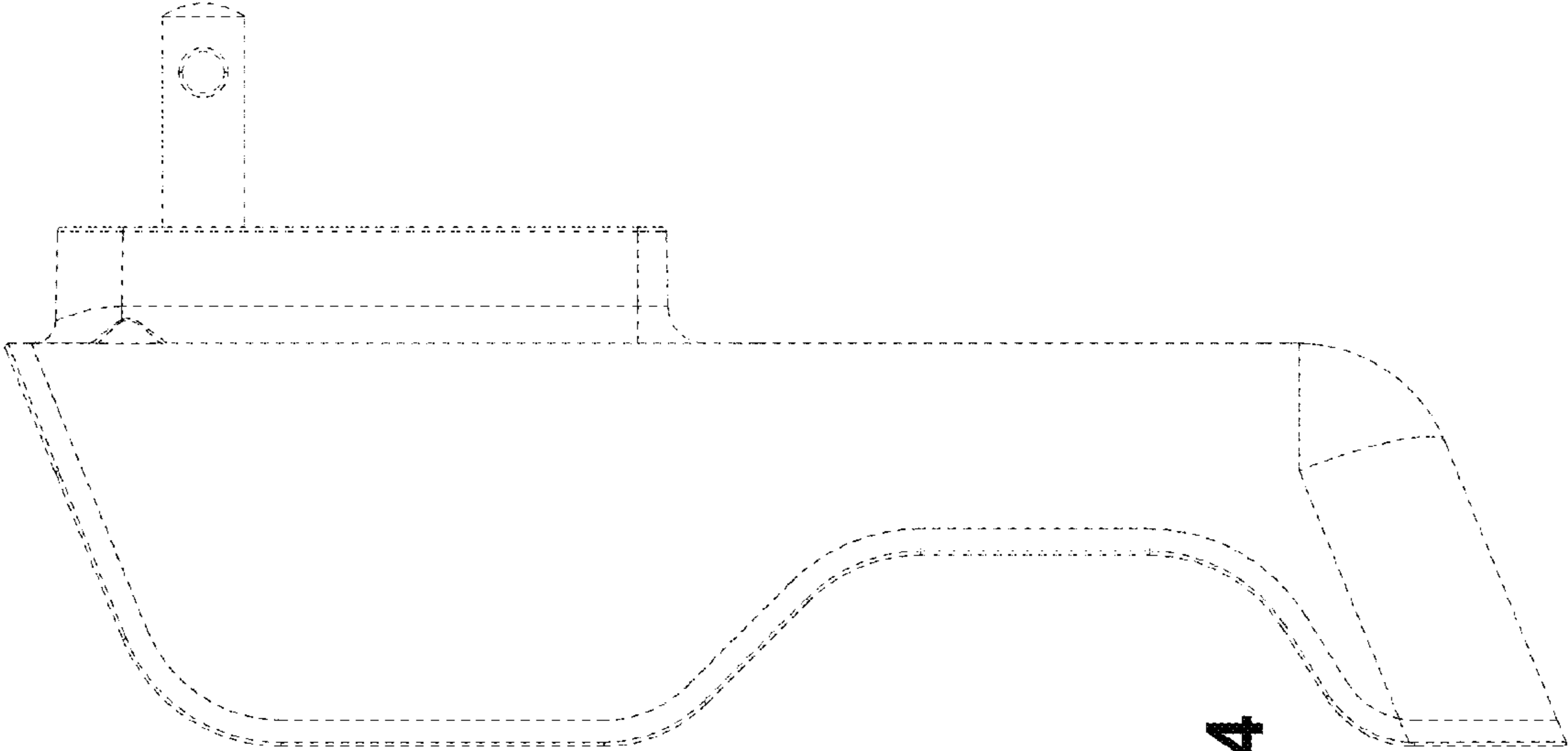

Fig 4

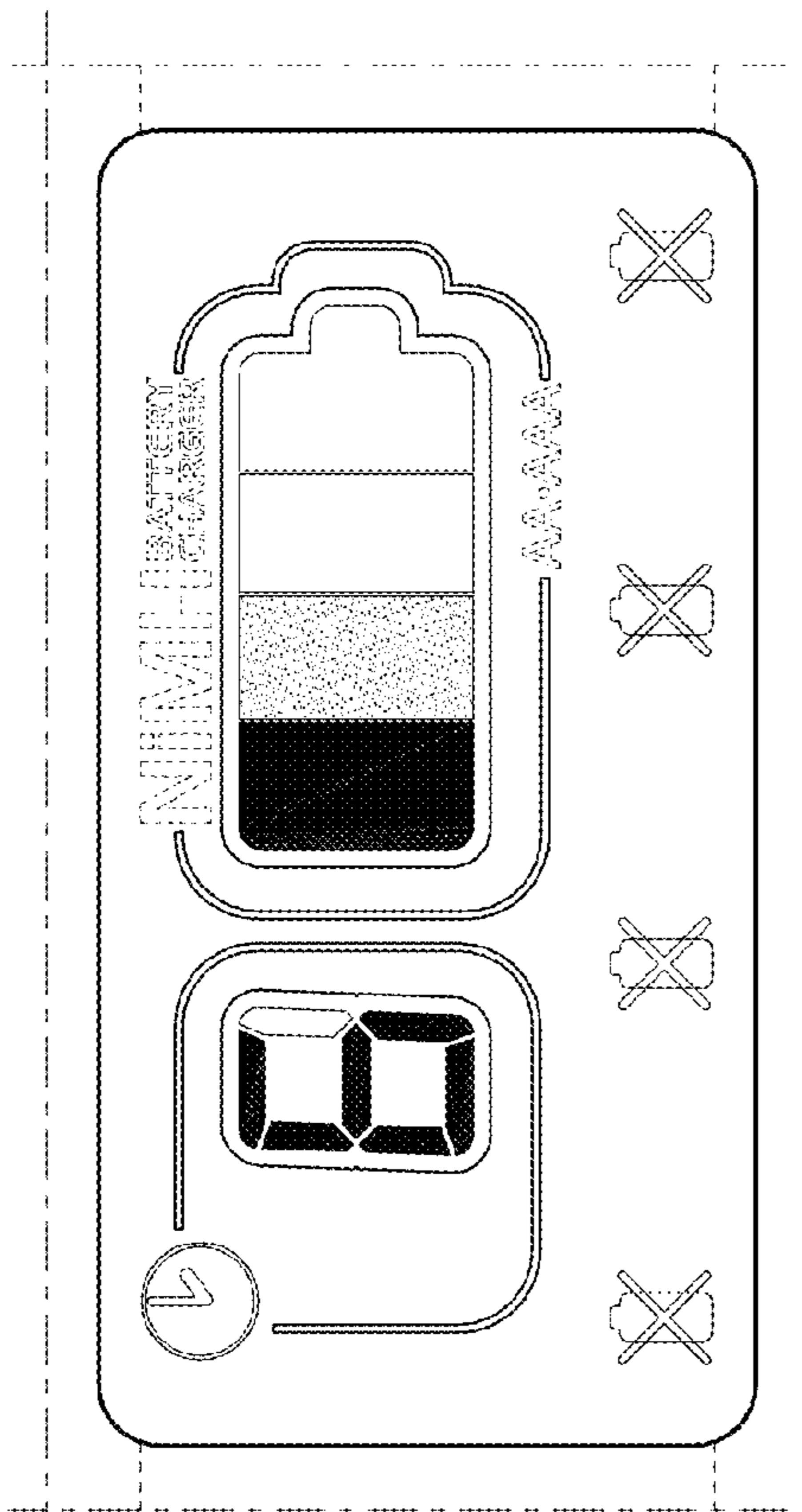

Fig 7

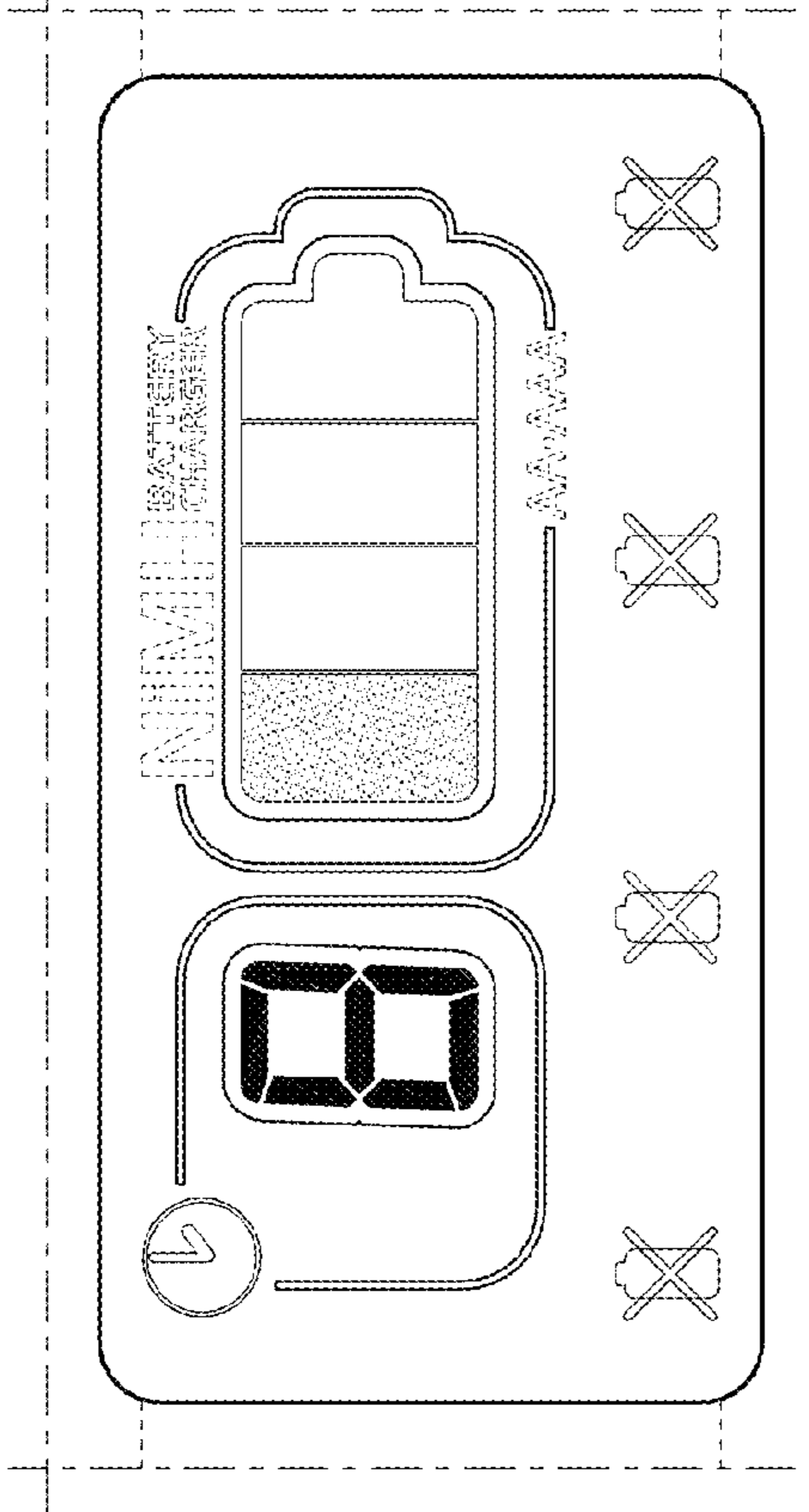

Fig 8

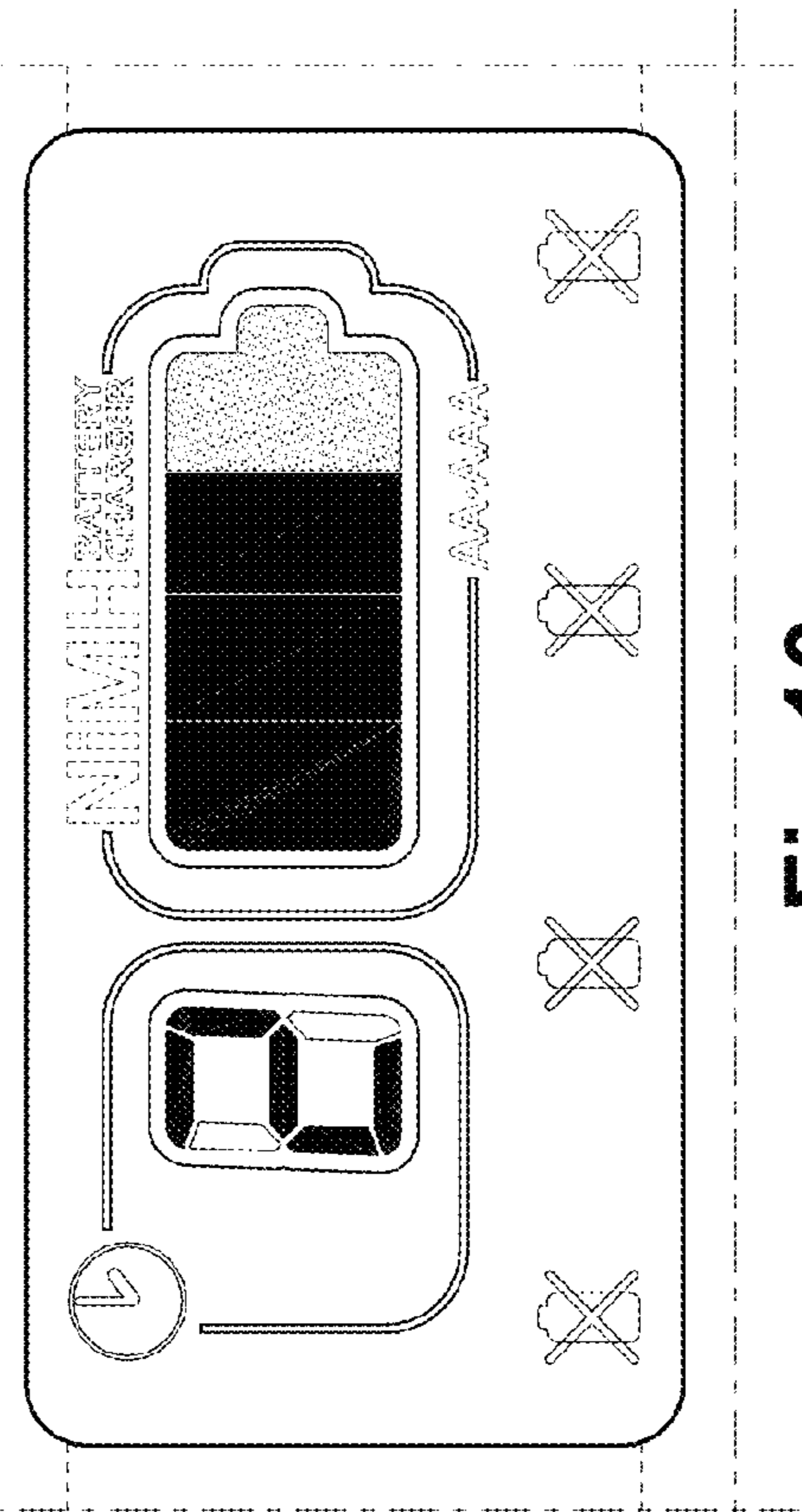

Fig 9

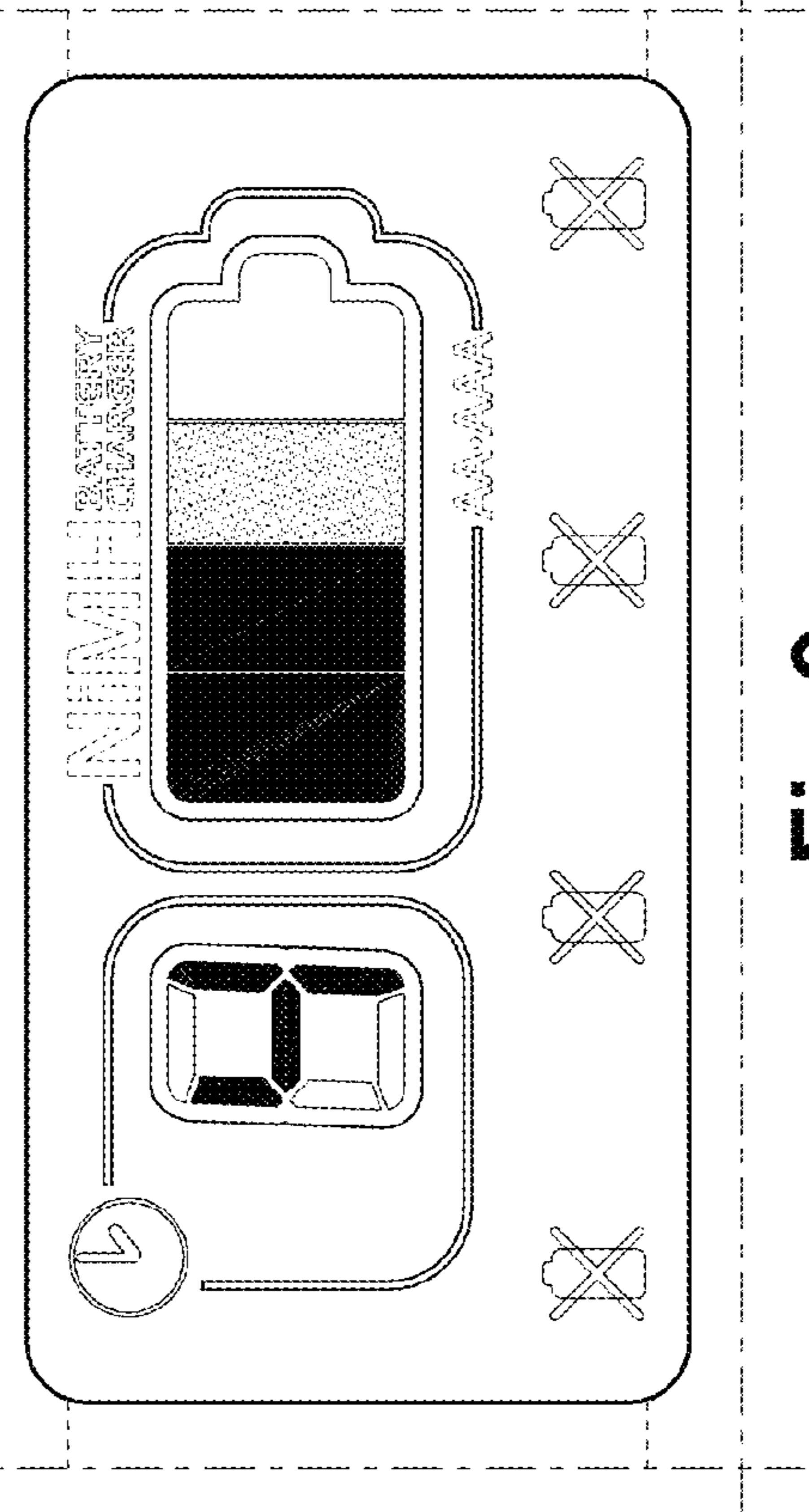

Fig 10

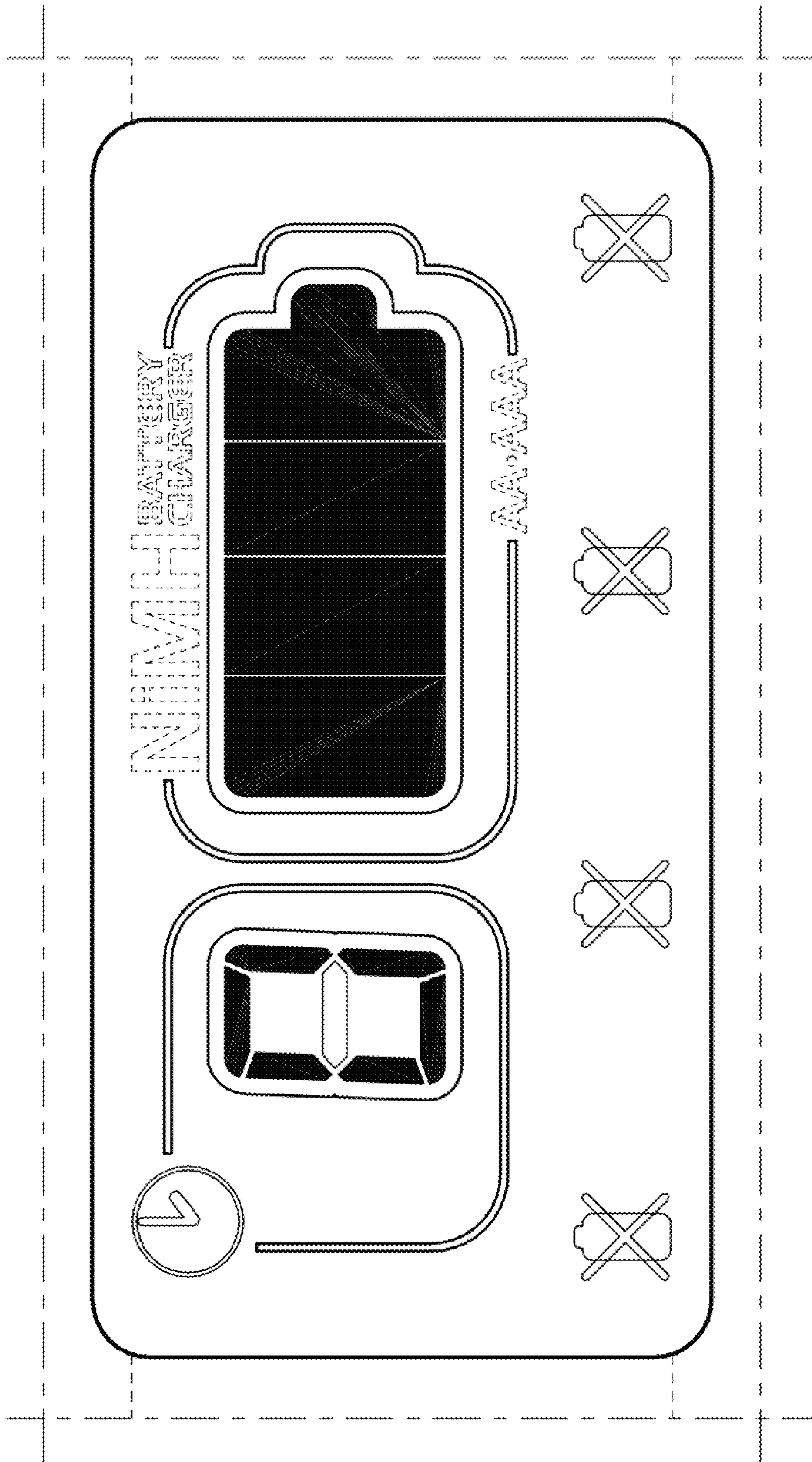

Fig 11