



US00D676940S

(12) **United States Design Patent**
Kluss et al.

(10) **Patent No.:** **US D676,940 S**

(45) **Date of Patent:** **** Feb. 26, 2013**

(54) **PIPE COUPLING**

(76) Inventors: **Bill Kluss**, Forest Lake (AU); **Greg Morwood**, Burnley (AU)

(**) Term: **14 Years**

(21) Appl. No.: **29/410,706**

(22) Filed: **Jan. 11, 2012**

(51) **LOC (9) Cl.** **23-01**

(52) **U.S. Cl.** **D23/262**

(58) **Field of Classification Search** D23/259,
D23/262; 285/369, 372, 373, 417, 133.11,
285/133.3, 133.21, 133.4–133.6

See application file for complete search history.

(56) **References Cited**

U.S. PATENT DOCUMENTS

| | | | | |
|----------------|---------|--------------------|-------|---------|
| D270,935 S * | 10/1983 | Logsdon | | D23/262 |
| D296,816 S * | 7/1988 | Budzinski et al. | | D23/263 |
| D319,287 S * | 8/1991 | Baumstark et al. | | D23/207 |
| 6,231,090 B1 * | 5/2001 | Fukao et al. | | 285/340 |
| D453,552 S * | 2/2002 | Sato et al. | | D23/262 |
| D483,094 S * | 12/2003 | Wilk et al. | | D23/262 |
| D483,095 S * | 12/2003 | Snyder et al. | | D23/262 |
| D483,441 S * | 12/2003 | Dole et al. | | D23/262 |
| D493,214 S | 7/2004 | Snyder, Sr. et al. | | |

| | | | | |
|--------------|--------|----------------|-------|---------|
| D493,512 S * | 7/2004 | Dole et al. | | D23/262 |
| D495,404 S * | 8/2004 | Wilk et al. | | D23/262 |
| D517,665 S * | 3/2006 | Wilk et al. | | D23/262 |
| D524,427 S * | 7/2006 | Wilk et al. | | D23/262 |
| D559,362 S * | 1/2008 | Zeppetbauer | | D23/262 |
| D623,277 S * | 9/2010 | Guzzoni et al. | | D23/262 |

* cited by examiner

Primary Examiner — Eric Goodman

(74) *Attorney, Agent, or Firm* — Kenneth M. Bush; Gerald M. Walsh; Bush Intellectual Property Law

(57) **CLAIM**

We claim the ornamental design for a pipe coupling, as shown and described.

DESCRIPTION

FIG. 1 is a front, right, perspective view of a pipe coupling showing our new design;

FIG. 2 is a front elevational view thereof, the opposite rear elevational view being identical thereto; and,

FIG. 3 is a right side elevational view thereof, the left side elevational view, the top plan view, and the bottom plan view being identical thereto.

In the drawings, the broken line showing is to illustrate portions of the article and form no part of the claimed design.

1 Claim, 2 Drawing Sheets

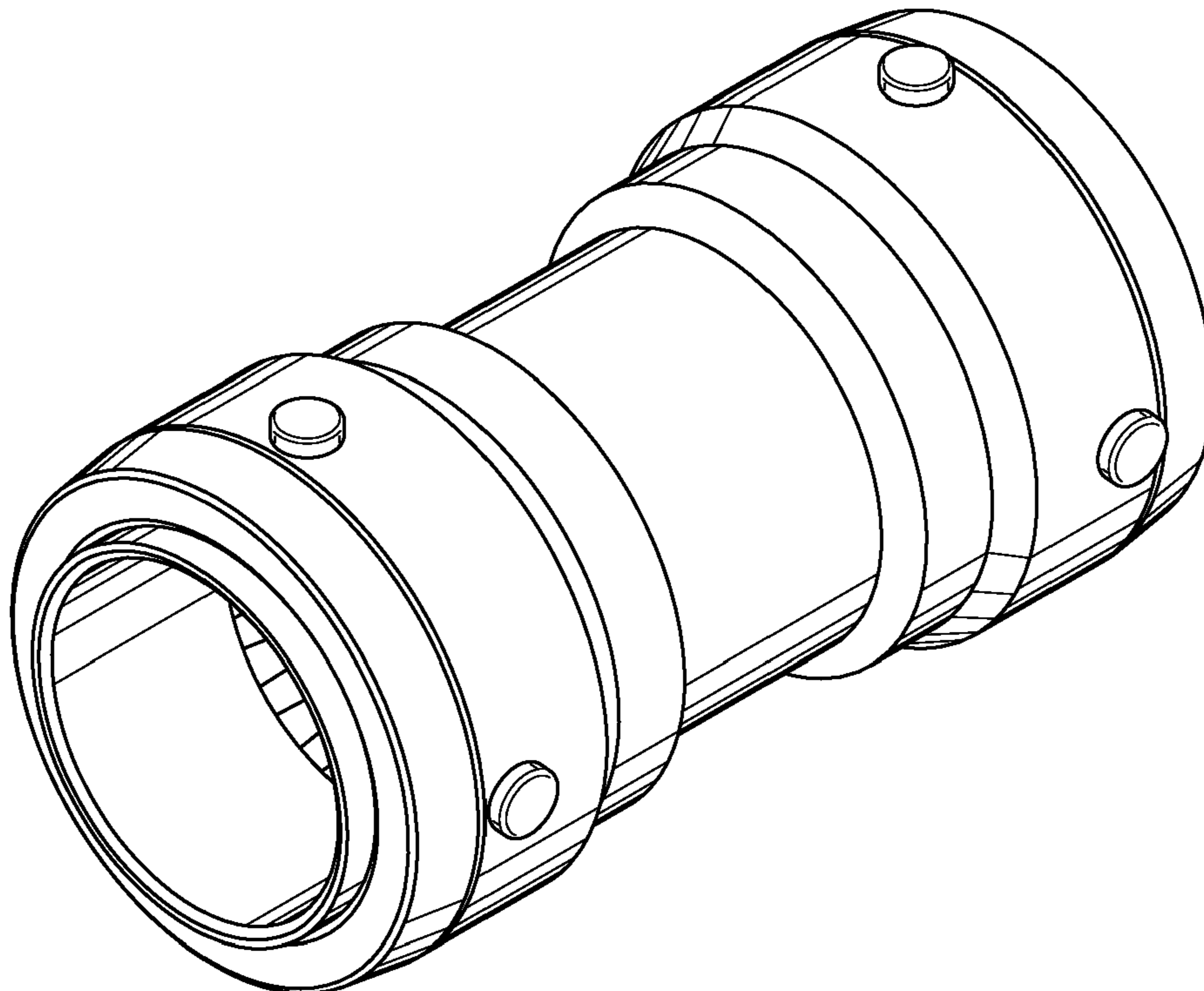

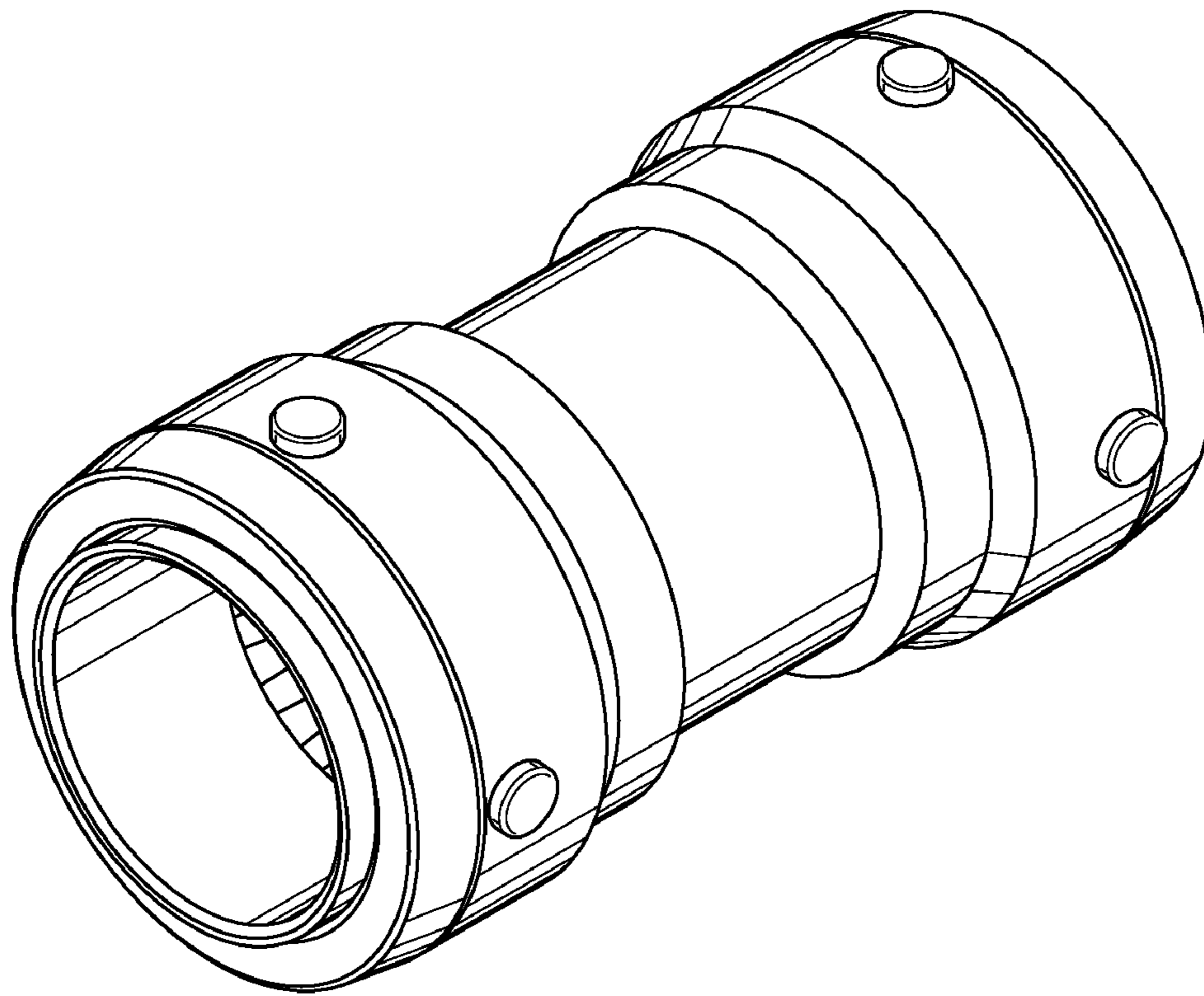

FIG. 1

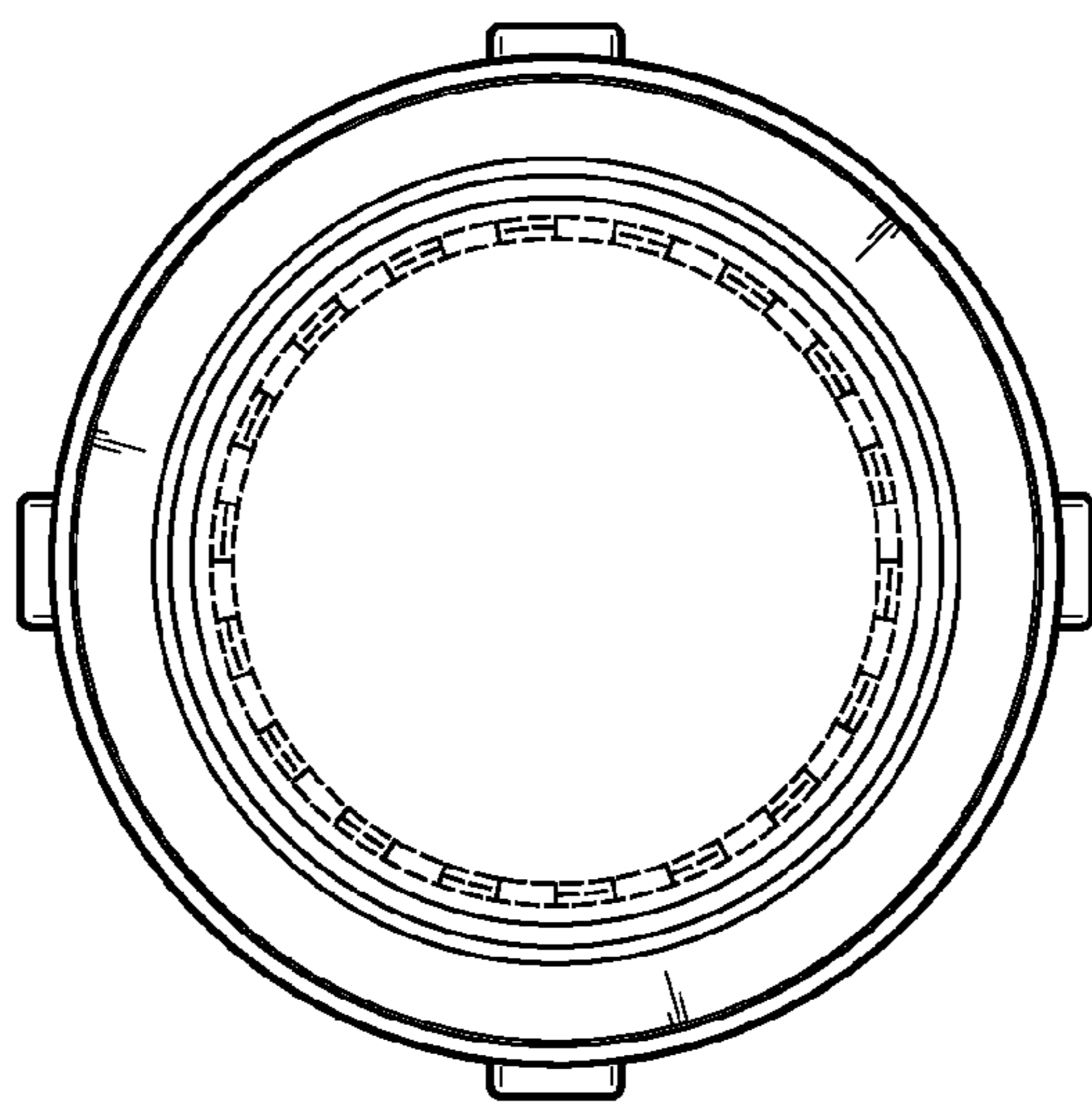

FIG. 2

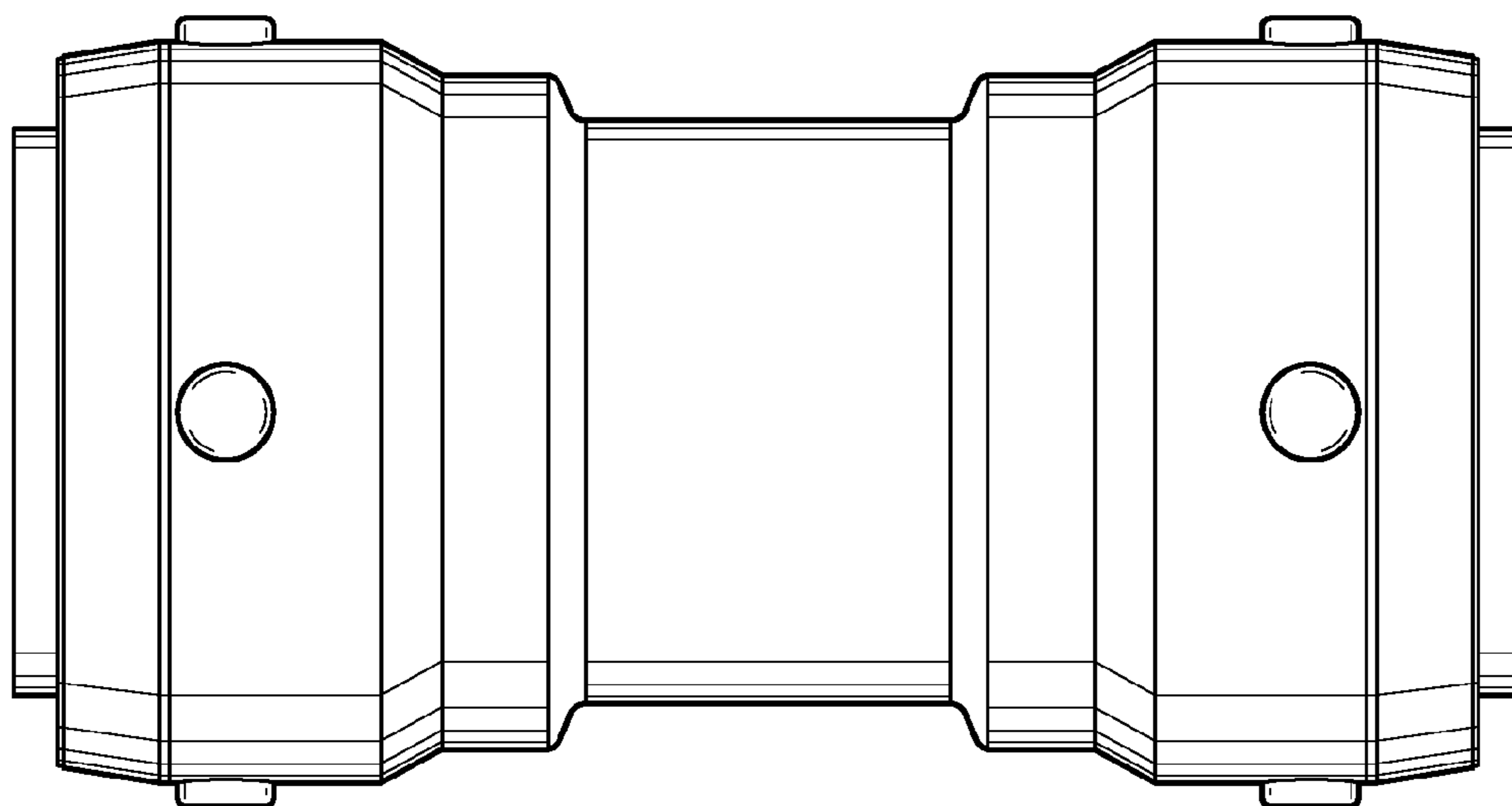

FIG. 3