



US00D675066S

(12) **United States Design Patent**  
**Conlin et al.**

(10) **Patent No.:** **US D675,066 S**  
(45) **Date of Patent:** **\*\* Jan. 29, 2013**

(54) **BEVERAGE CAN INSULATOR**

(76) Inventors: **Ryan Joseph Conlin**, Easton, PA (US);  
**Patrick Joseph Vrabel**, Bethlehem, PA  
(US); **Austin Benton**, Philadelphia, PA  
(US)

(\*\*) Term: **14 Years**

(21) Appl. No.: **29/397,918**

(22) Filed: **Jul. 22, 2011**

(51) **LOC (9) Cl.** ..... **07-01**

(52) **U.S. Cl.** ..... **D7/608**

(58) **Field of Classification Search** ..... D7/619.1,  
D7/605, 608, 607, 624.2, 601, 602, 624.1,  
D7/606, 510, 511; D9/772, 444, 455; D34/4;  
62/457.4; 248/310, 311.2; 220/930, 739,  
220/257.2, 258.2; 215/395, 396

See application file for complete search history.

(56) **References Cited**

**U.S. PATENT DOCUMENTS**

|               |         |              |       |           |
|---------------|---------|--------------|-------|-----------|
| D271,854 S *  | 12/1983 | Berry        | ..... | D9/772    |
| D301,821 S *  | 6/1989  | Bartolo      | ..... | D7/608    |
| D313,026 S *  | 12/1990 | Evans        | ..... | D15/83    |
| 5,108,003 A * | 4/1992  | Granofsky    | ..... | 220/257.2 |
| 5,139,163 A * | 8/1992  | Diaz         | ..... | 220/258.2 |
| D347,973 S *  | 6/1994  | McBride      | ..... | D7/619.2  |
| D349,218 S *  | 8/1994  | Evans        | ..... | D7/628    |
| D360,340 S *  | 7/1995  | Hitch et al. | ..... | D7/604    |
| 5,467,891 A * | 11/1995 | Perry        | ..... | 220/739   |
| D371,075 S *  | 6/1996  | Stonehouse   | ..... | D9/772    |
| D396,916 S *  | 8/1998  | Ochs, Sr.    | ..... | D34/4     |
| D404,974 S *  | 2/1999  | Kristinik    | ..... | D7/608    |
| D421,719 S *  | 3/2000  | Wells et al. | ..... | D9/438    |
| 6,123,220 A * | 9/2000  | Williams     | ..... | 220/737   |

|                |         |                |       |         |
|----------------|---------|----------------|-------|---------|
| D441,172 S *   | 4/2001  | Snyder         | ..... | D99/37  |
| 6,604,649 B1 * | 8/2003  | Campi          | ..... | 220/739 |
| D519,313 S *   | 4/2006  | Ringuet        | ..... | D7/313  |
| D519,788 S *   | 5/2006  | Ringuet        | ..... | D7/606  |
| D522,880 S *   | 6/2006  | Fuller et al.  | ..... | D9/729  |
| D526,308 S *   | 8/2006  | Kasden         | ..... | D14/207 |
| D617,969 S *   | 6/2010  | Sung           | ..... | D34/4   |
| D640,141 S *   | 6/2011  | Chapin         | ..... | D9/772  |
| D640,852 S *   | 6/2011  | Warlick et al. | ..... | D34/4   |
| D650,234 S *   | 12/2011 | Tseng          | ..... | D7/510  |
| D651,853 S *   | 1/2012  | Eyal           | ..... | D7/510  |
| D666,873 S *   | 9/2012  | Gluck          | ..... | D7/510  |

\* cited by examiner

*Primary Examiner* — Jeffrey D Asch

(74) *Attorney, Agent, or Firm* — QuickPatents, Inc.; Kevin Prince

(57) **CLAIM**

We claim the ornamental design for a beverage can insulator, as shown and described.

**DESCRIPTION**

FIG. 1 is a perspective view of a beverage can insulator, showing our new design;

FIG. 2 is a front elevational view thereof, the rear elevational view being a mirror image thereof;

FIG. 3 is a left-side elevational view thereof, the right-side elevational view being a mirror image thereof;

FIG. 4 is a top plan view thereof;

FIG. 5 is a bottom plan view thereof;

FIG. 6 is an exploded top perspective view thereof; and,

FIG. 7 is an exploded bottom perspective view thereof.

The broken lines showing a can in FIGS. 6 and 7 depict environmental matter and form no part of the claimed design.

**1 Claim, 3 Drawing Sheets**

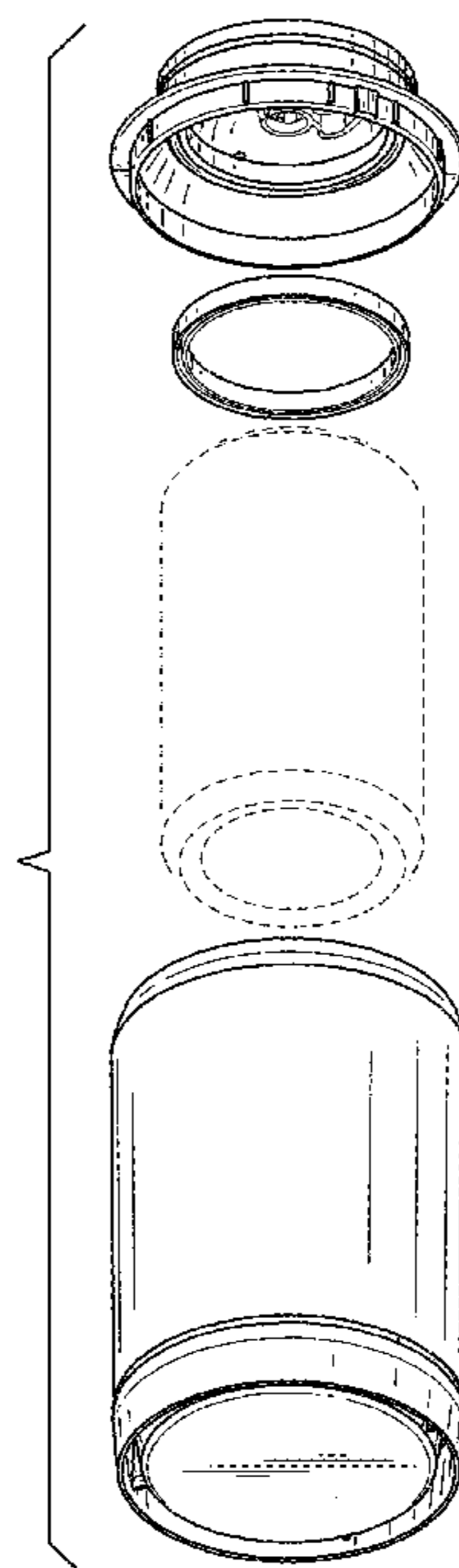
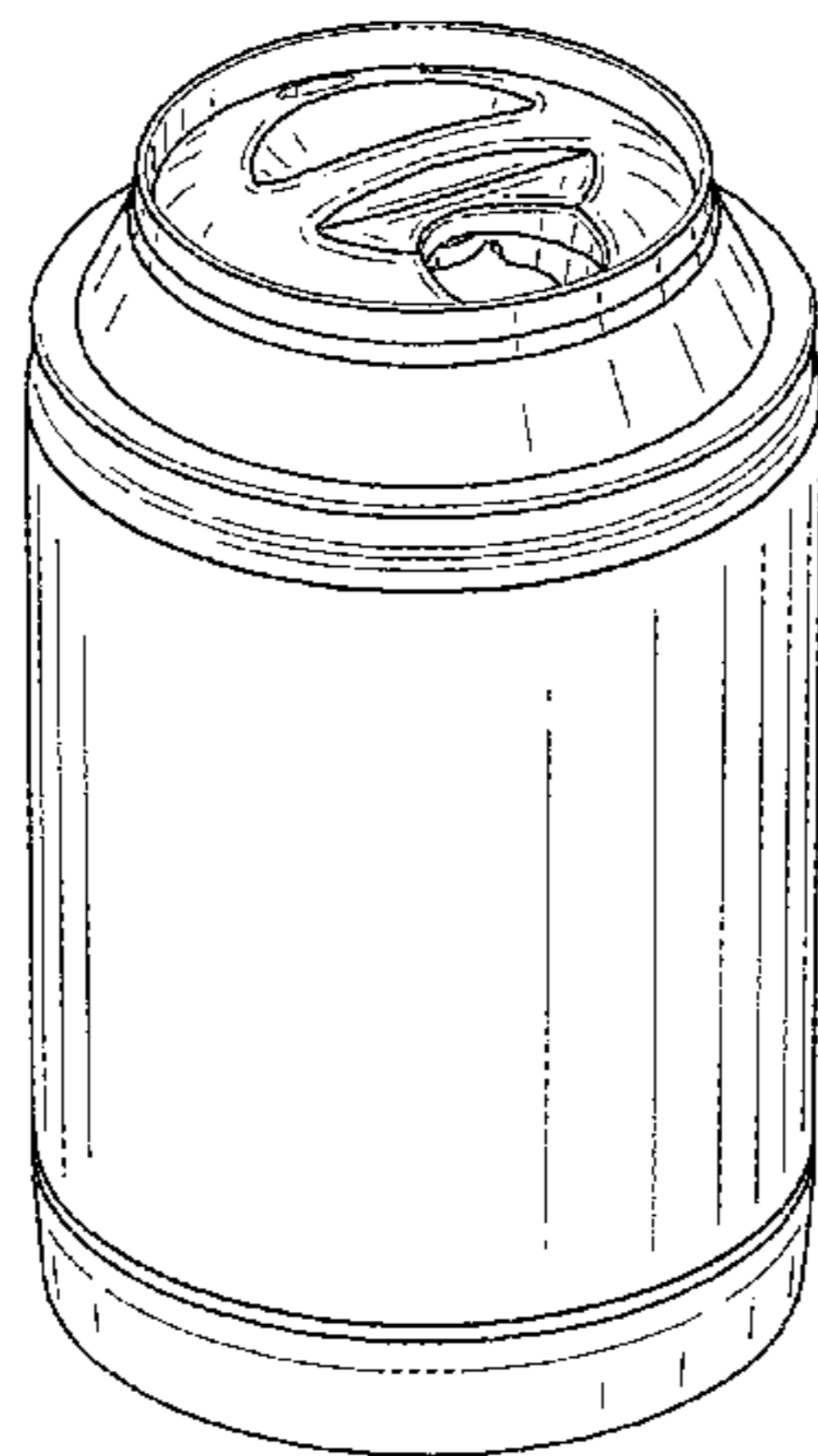

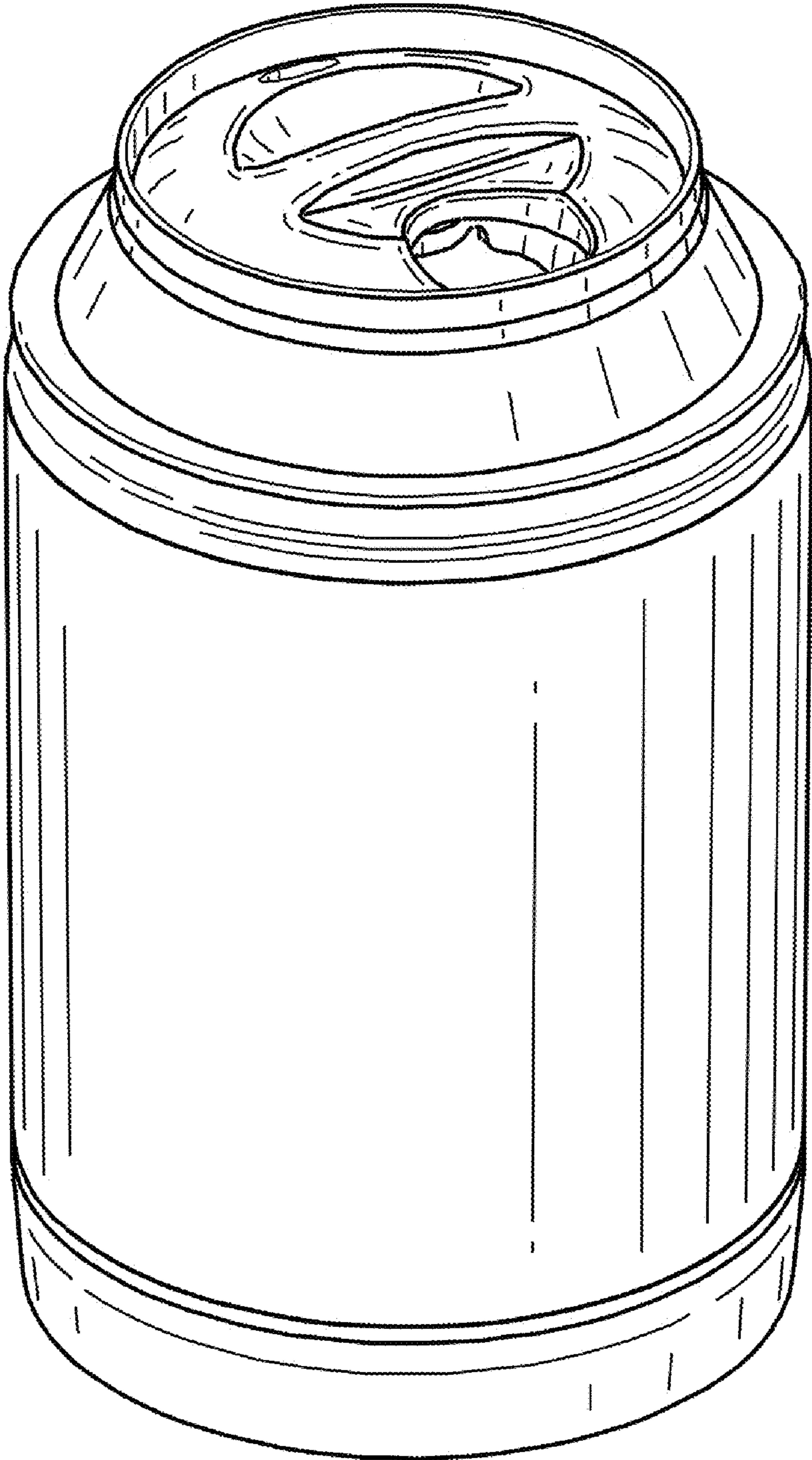

FIG. 1

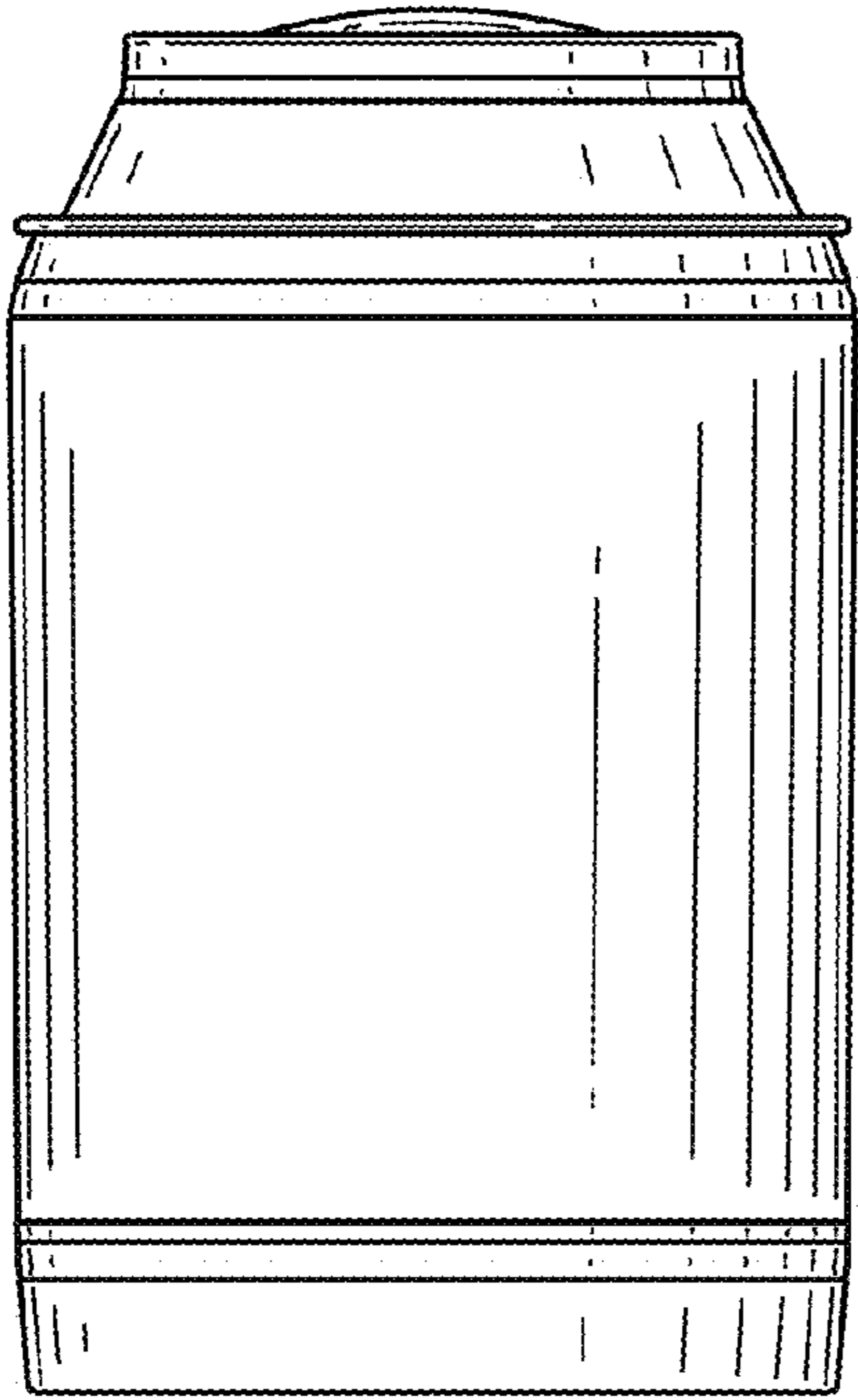

FIG. 2

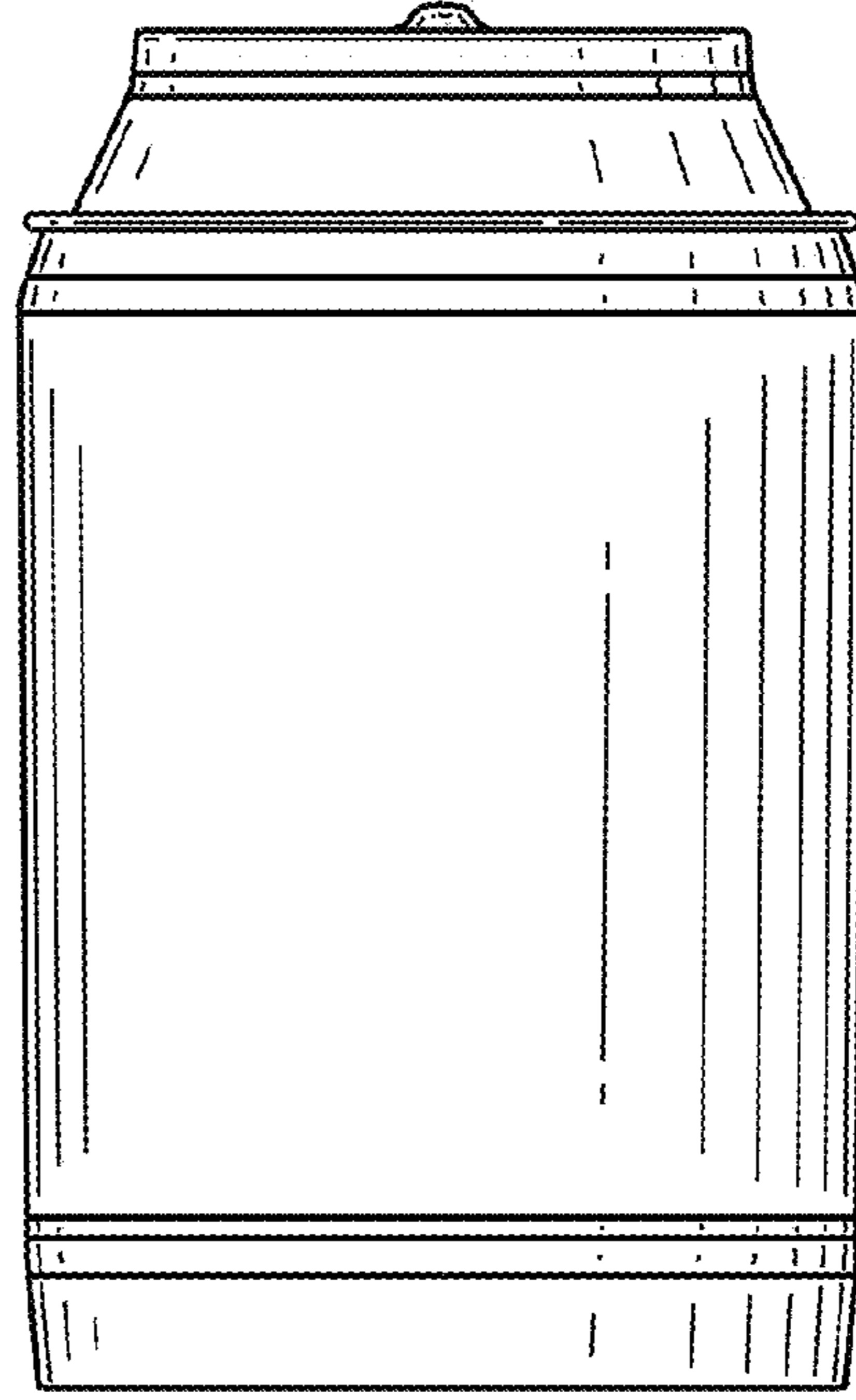

FIG. 3

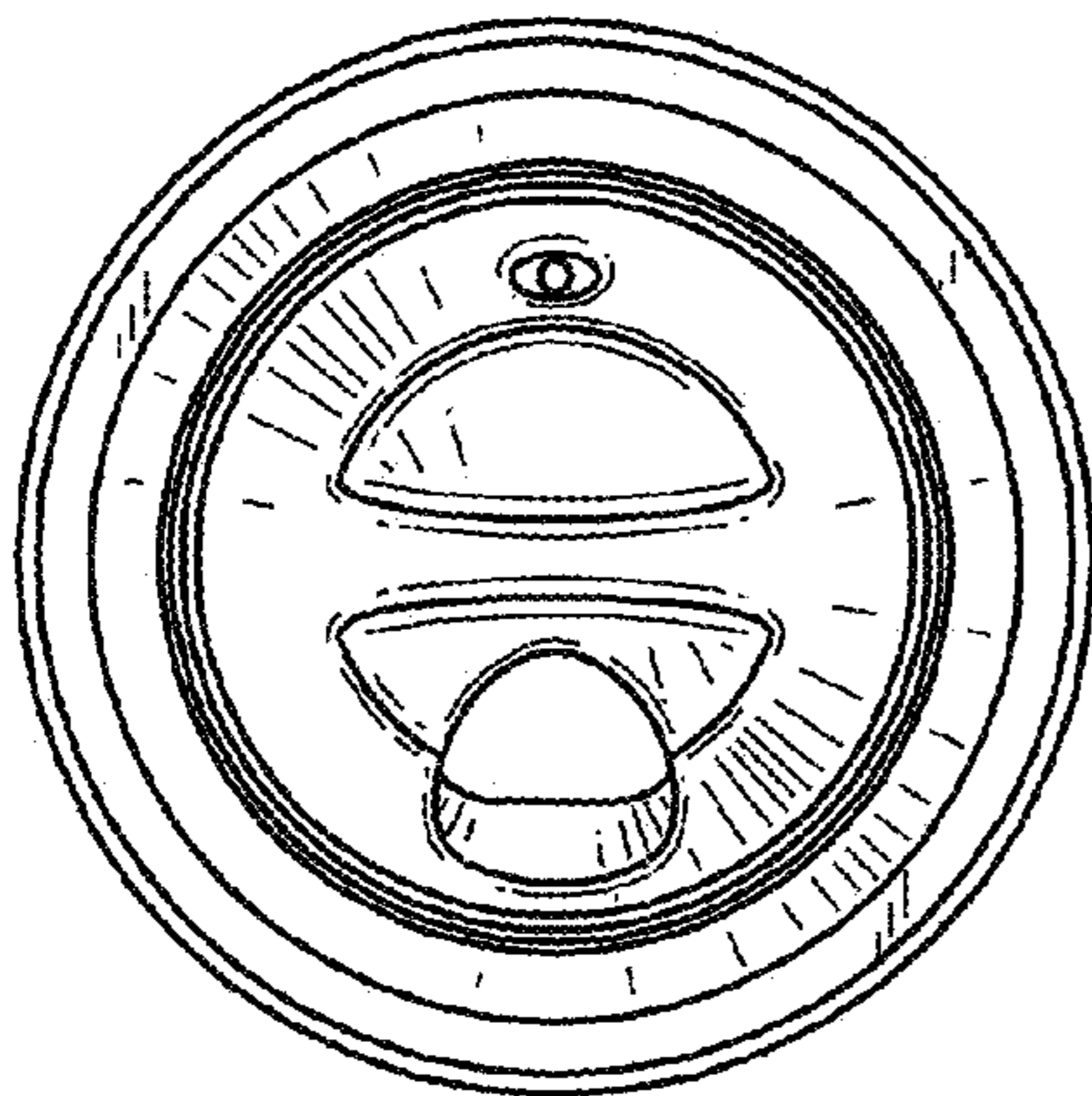

FIG. 4

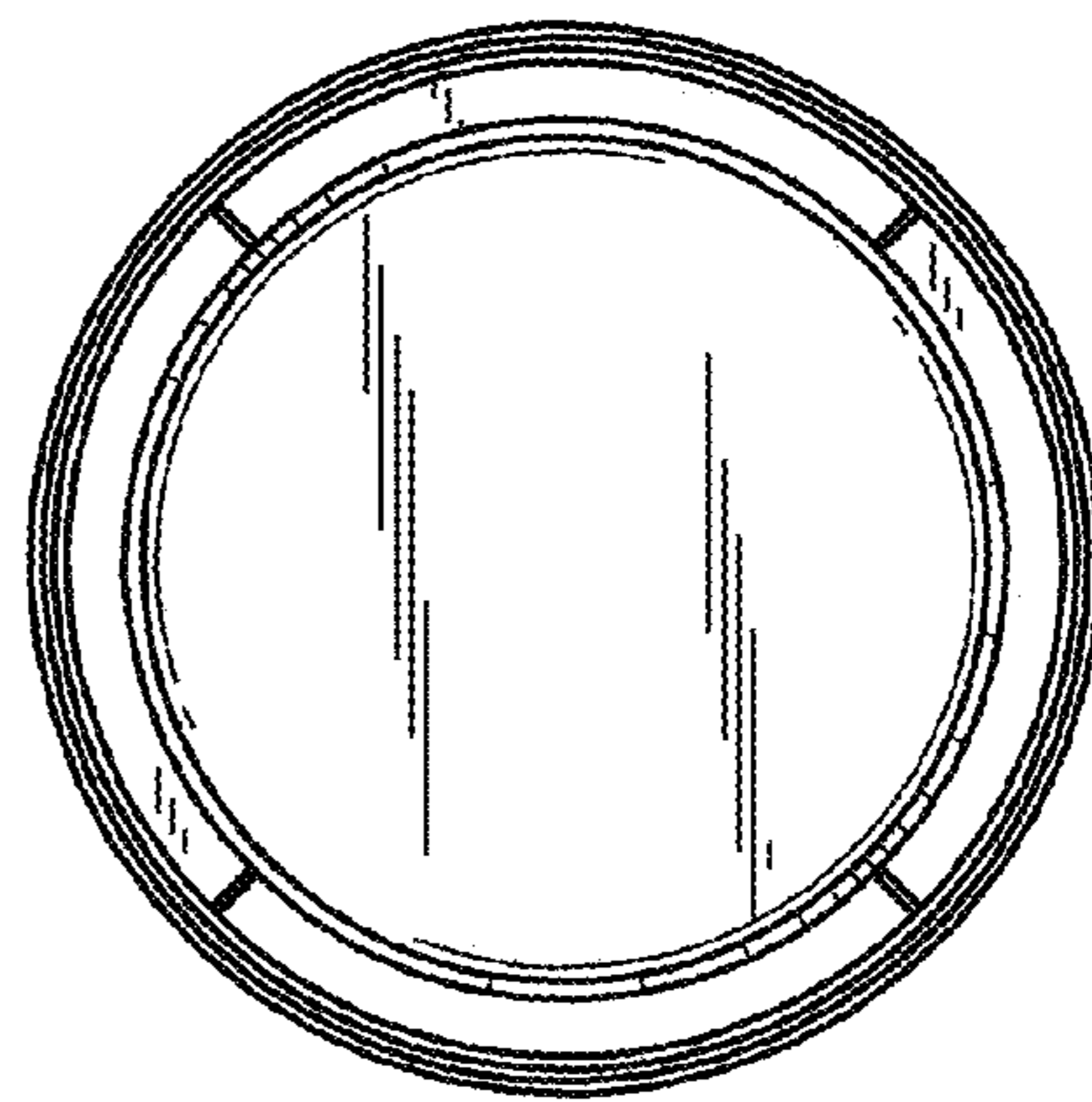

FIG. 5

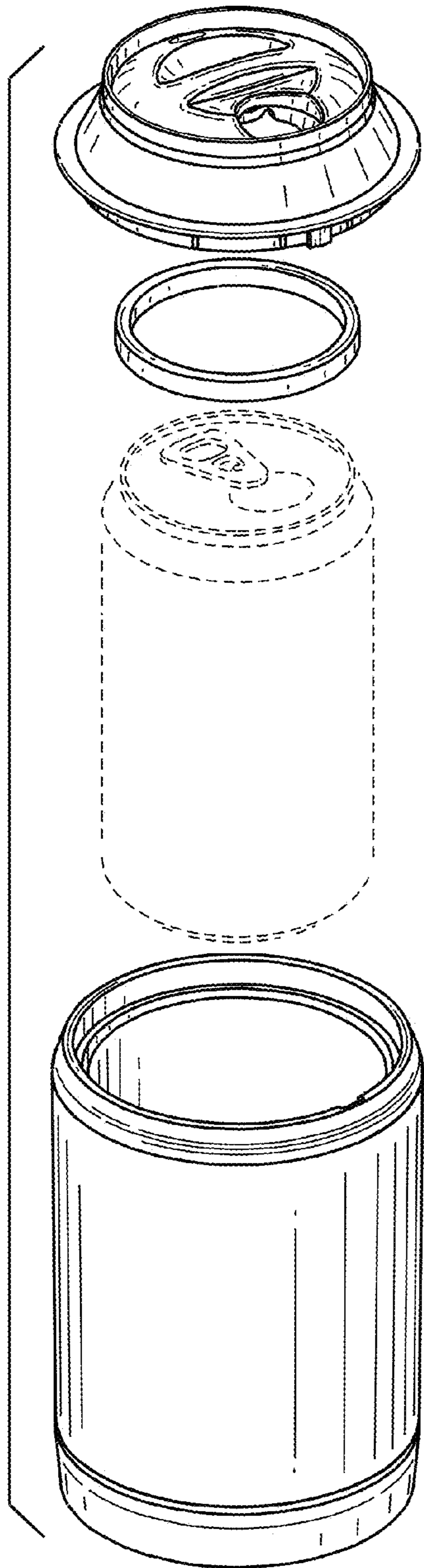

FIG. 6

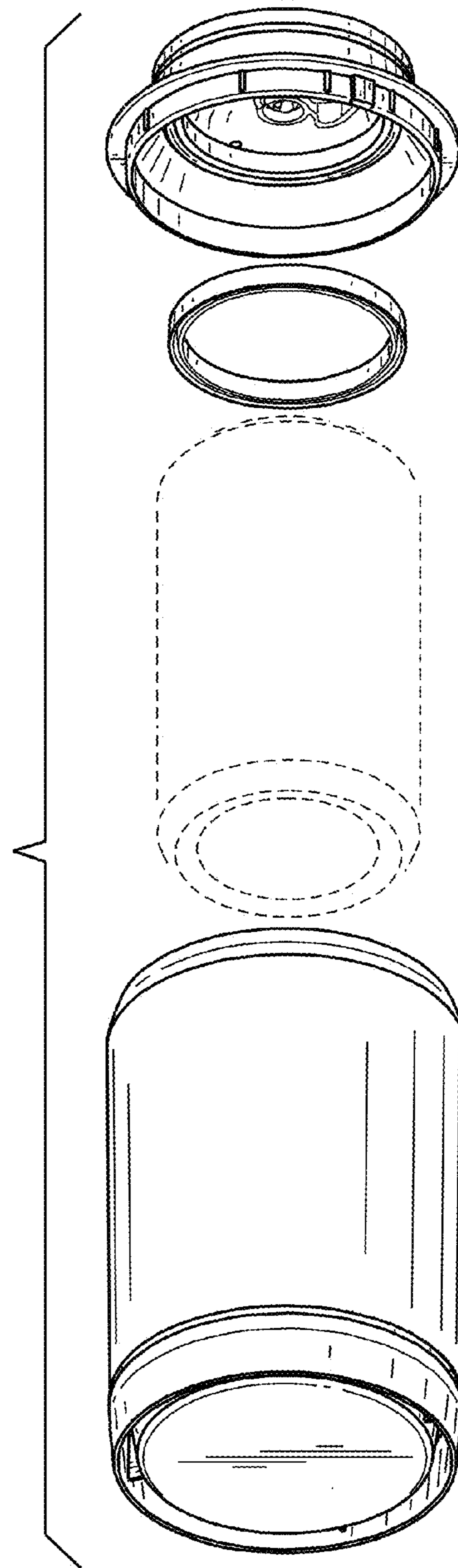

FIG. 7