



US00D674458S

(12) **United States Design Patent**  
**Mowery et al.**

(10) **Patent No.:** **US D674,458 S**  
(45) **Date of Patent:** **\*\* Jan. 15, 2013**

(54) **QUIVER HOOD WITH DETACHABLE FACEPLATE**

(75) Inventors: **Richard F. Mowery**, Atlanta, MI (US);  
**Don Robert Harris**, Cadillac, MI (US)

(73) Assignee: **Bohning Company, Ltd.**, Lake City, MI (US)

(\*\*) Term: **14 Years**

(21) Appl. No.: **29/369,315**

(22) Filed: **Sep. 7, 2010**

(51) **LOC (9) Cl.** ..... **22-01**

(52) **U.S. Cl.** ..... **D22/107**

(58) **Field of Classification Search** ..... D22/107,  
D22/199; 124/23.1, 25.6, 86, 88; D21/572  
See application file for complete search history.

(56) **References Cited**

U.S. PATENT DOCUMENTS

D139,201	S	*	10/1944	Yarcho	.....	D3/302
3,209,740	A	*	10/1965	Hauch	.....	124/25.7
3,366,101	A	*	1/1968	Saunders	.....	124/88
3,591,062	A	*	7/1971	Karbo	.....	124/88
D223,353	S	*	4/1972	Admas	.....	D22/107
3,777,734	A	*	12/1973	Rose	.....	124/25.5
D248,040	S	*	5/1978	Stinson	.....	D22/107
4,156,496	A	*	5/1979	Stinson	.....	124/25.7
4,252,101	A	*	2/1981	Spitzke	.....	124/45
4,621,606	A	*	11/1986	Toth	.....	124/24.1
4,685,438	A	*	8/1987	Larson	.....	124/25.7
4,805,584	A	*	2/1989	Stinson	.....	124/86
D311,641	S	*	10/1990	Martin	.....	D3/302
4,995,372	A	*	2/1991	Topel	.....	124/25.5

(Continued)

*Primary Examiner* — Michael A Pratt

(74) *Attorney, Agent, or Firm* — Smith Risley Tempel Santos LLC; Gregory Scott Smith; Matthew T. Hoots

(57) **CLAIM**

The ornamental design for a quiver hood with detachable faceplate, as shown and described.

**DESCRIPTION**

FIG. 1 is a perspective view of our new ornamental design for a quiver hood with detachable faceplate, shown with the faceplate attached;

FIG. 2 is a left-side plan view of the quiver hood with detachable faceplate shown in FIG. 1;

FIG. 3 is a right-side plan view of the quiver hood with detachable faceplate shown in FIG. 1;

FIG. 4 is a front-side plan view of the quiver hood with detachable faceplate shown in FIG. 1;

FIG. 5 is a back-side plan view of the quiver hood with detachable faceplate shown in FIG. 1;

FIG. 6 is a top plan view of the quiver hood with detachable faceplate shown in FIG. 1;

FIG. 7 is a bottom plan view of the quiver hood with detachable faceplate shown in FIG. 1;

FIG. 8 is a perspective view of our new ornamental design for a quiver hood with detachable faceplate, shown with the faceplate detached;

FIG. 9 is a left-side plan view of the quiver hood with detachable faceplate shown in FIG. 8;

FIG. 10 is a right-side plan view of the quiver hood with detachable faceplate shown in FIG. 8;

FIG. 11 is a front-side plan view of the quiver hood with detachable faceplate shown in FIG. 8;

FIG. 12 is a back-side plan view of the quiver hood with detachable faceplate shown in FIG. 8;

FIG. 13 is a top plan view of the quiver hood with detachable faceplate shown in FIG. 8; and,

FIG. 14 is a bottom plan view of the quiver hood with detachable faceplate shown in FIG. 8.

One illustrative embodiment is provided. The illustrated embodiment shows the structure of a quiver hood with detachable faceplate. The broken lines in the drawings are for illustrative purposes only and form no part of the claimed design.

**1 Claim, 10 Drawing Sheets**

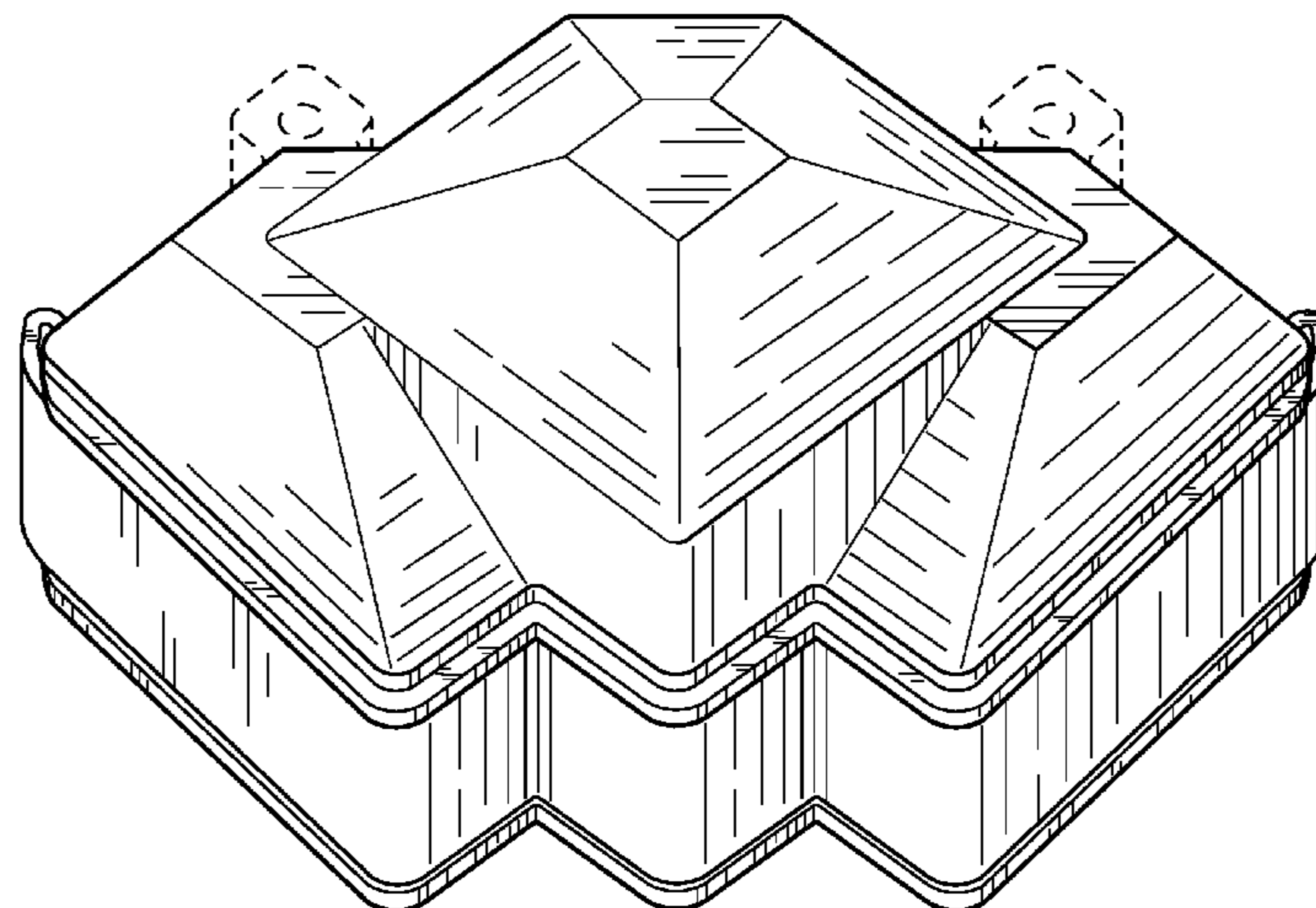

# US D674,458 S

Page 2

---

## U.S. PATENT DOCUMENTS

5,005,554	A *	4/1991	Shepley et al. ....	124/24.1	D613,809	S *	4/2010	Barnes et al. ....	D22/107
5,190,022	A *	3/1993	Larson .....	124/25.7	2011/0174284	A1 *	7/2011	Hunt .....	124/44.6
D339,184	S *	9/1993	Warner .....	D22/107	2011/0283982	A1 *	11/2011	McPherson .....	124/23.1
6,006,734	A *	12/1999	Sodaro .....	124/86					

\* cited by examiner

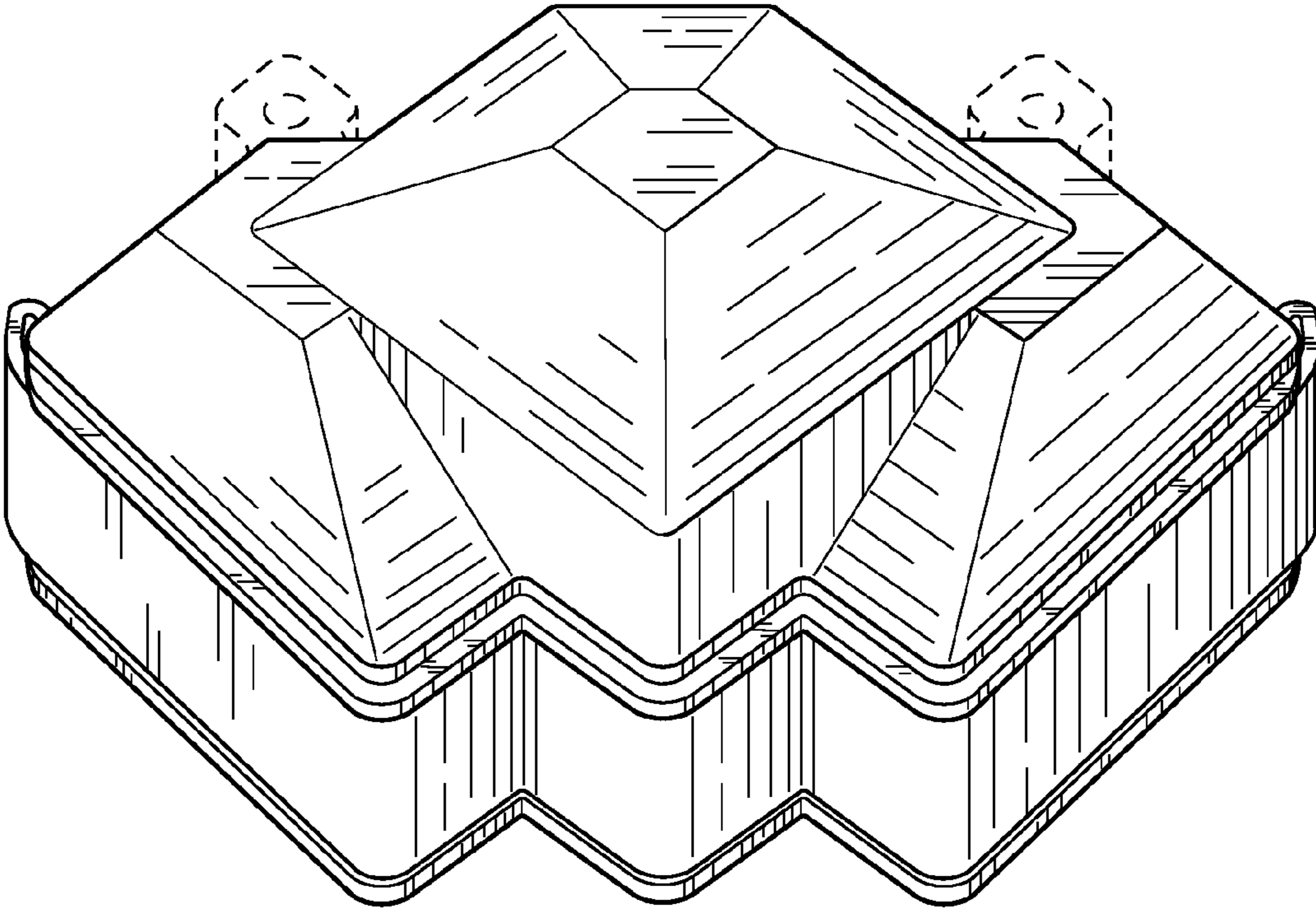

Fig. 1

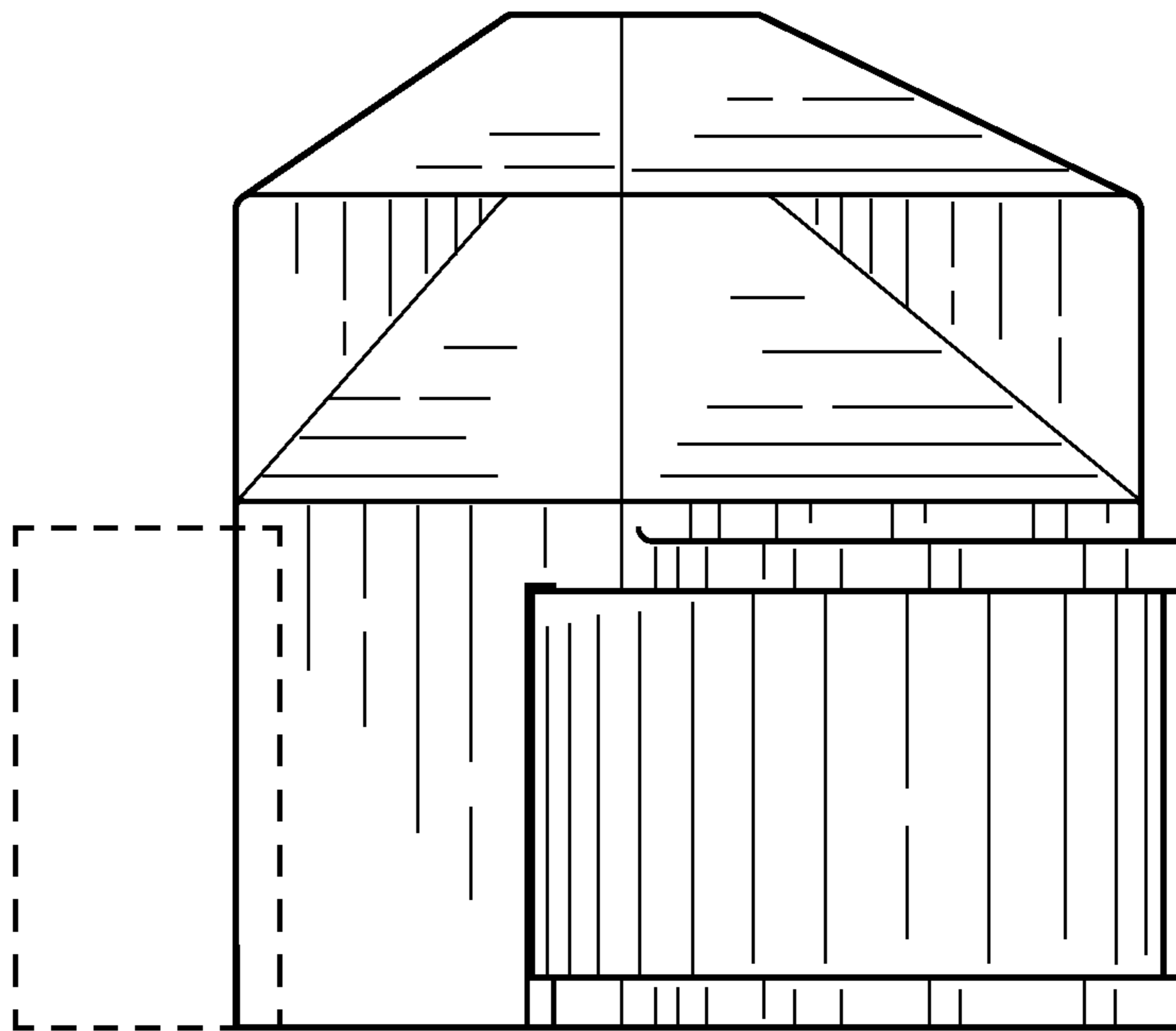

Fig. 2

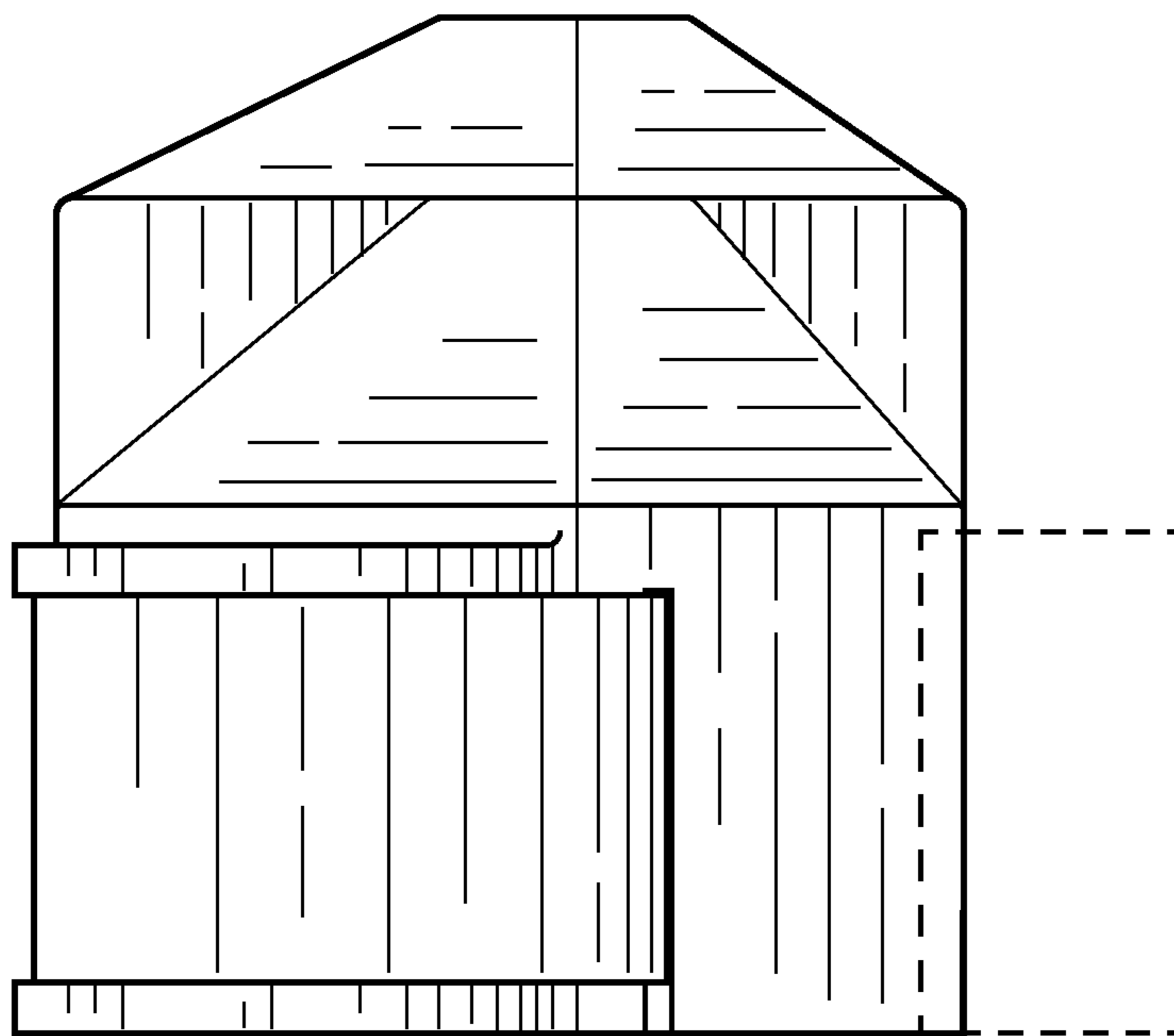

Fig. 3

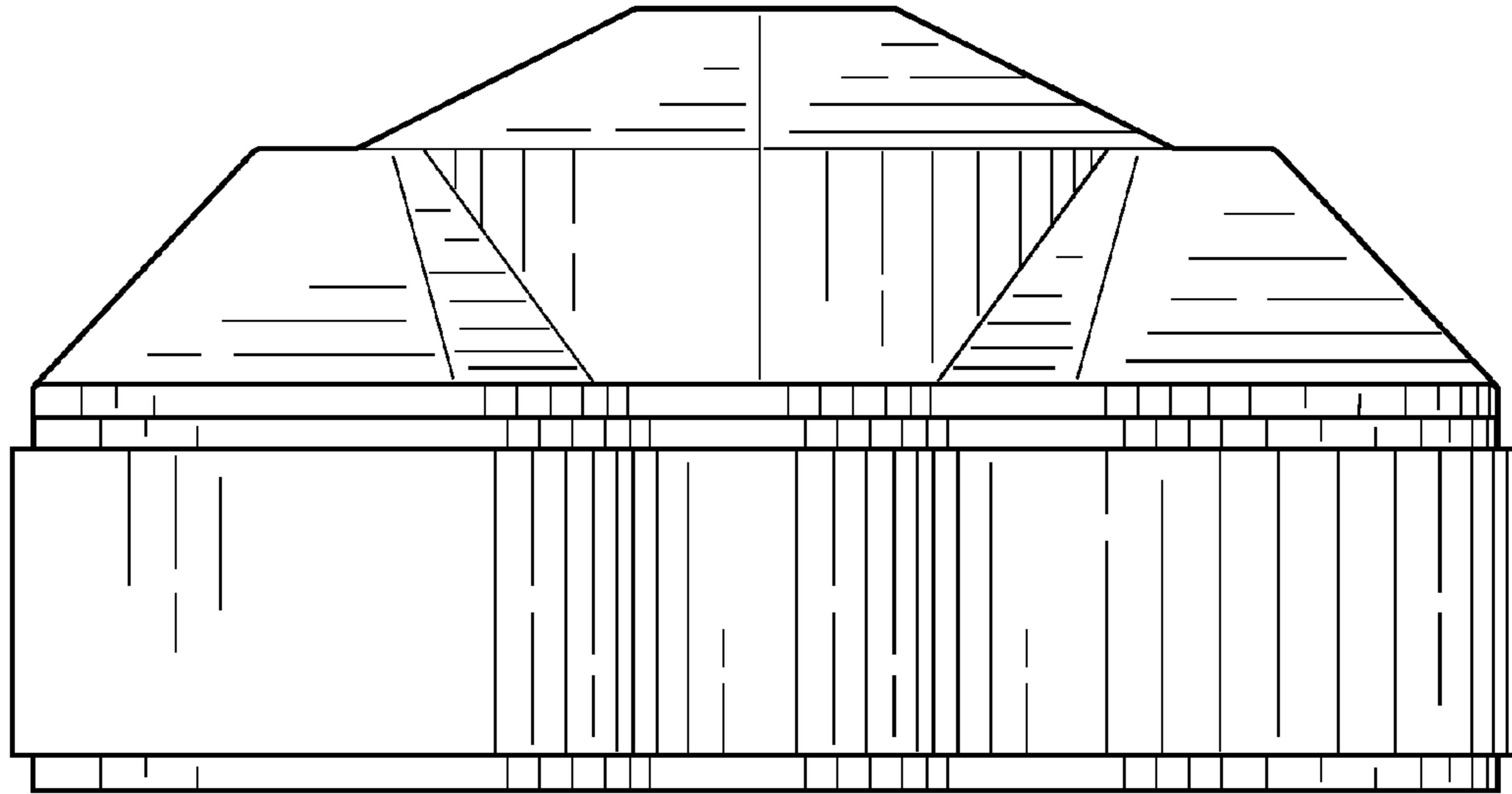

Fig. 4

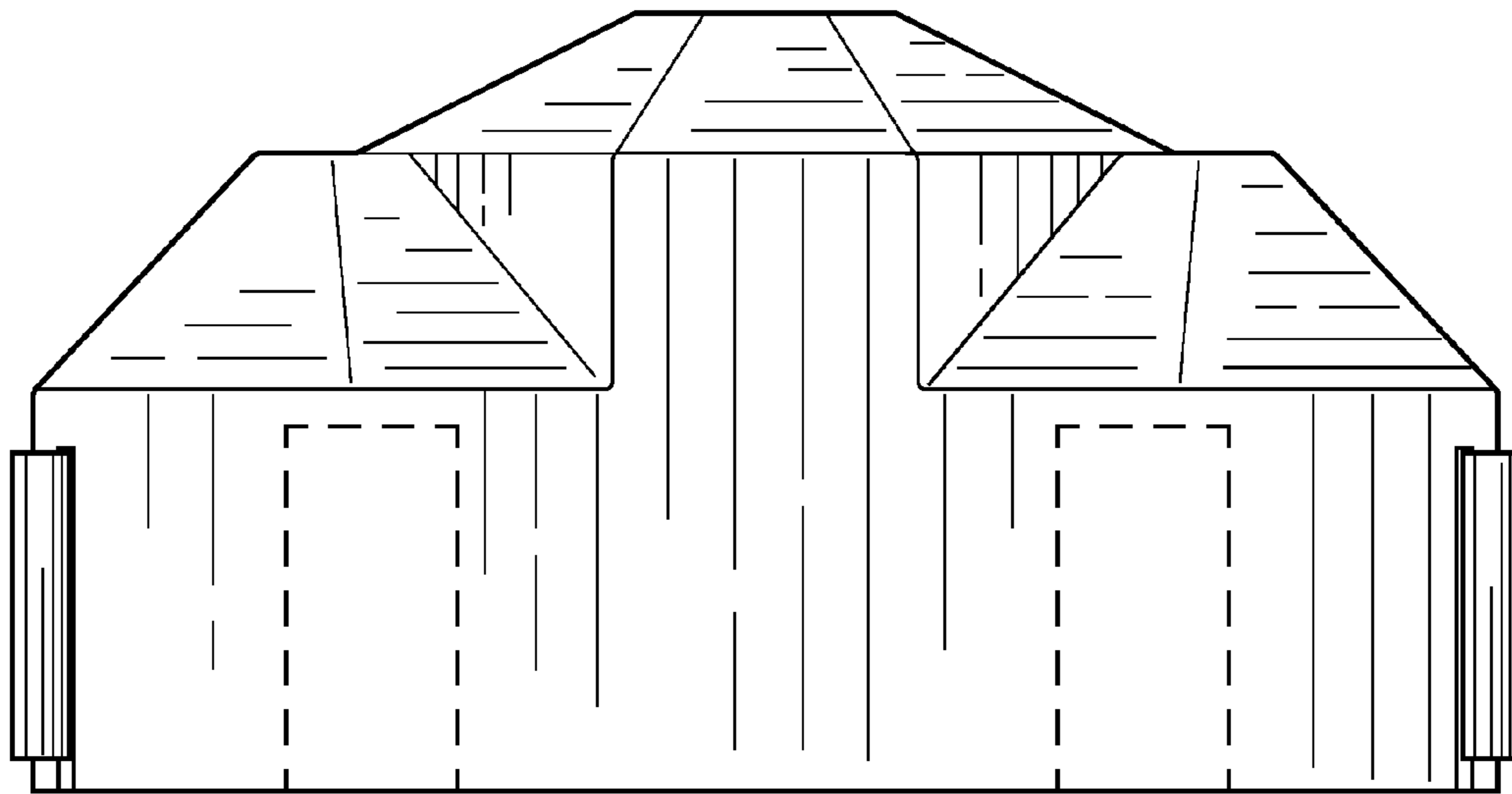

Fig. 5

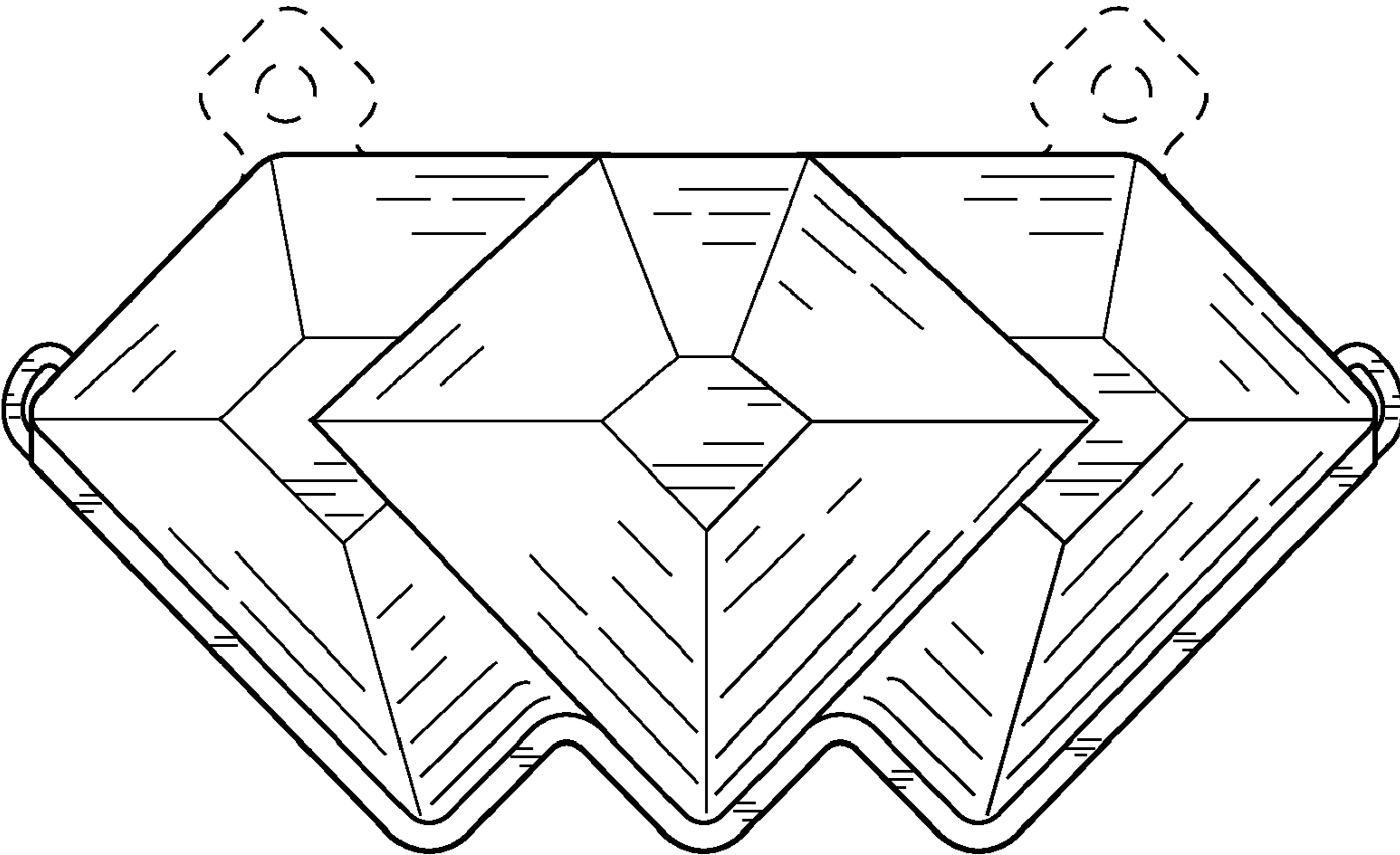

Fig. 6

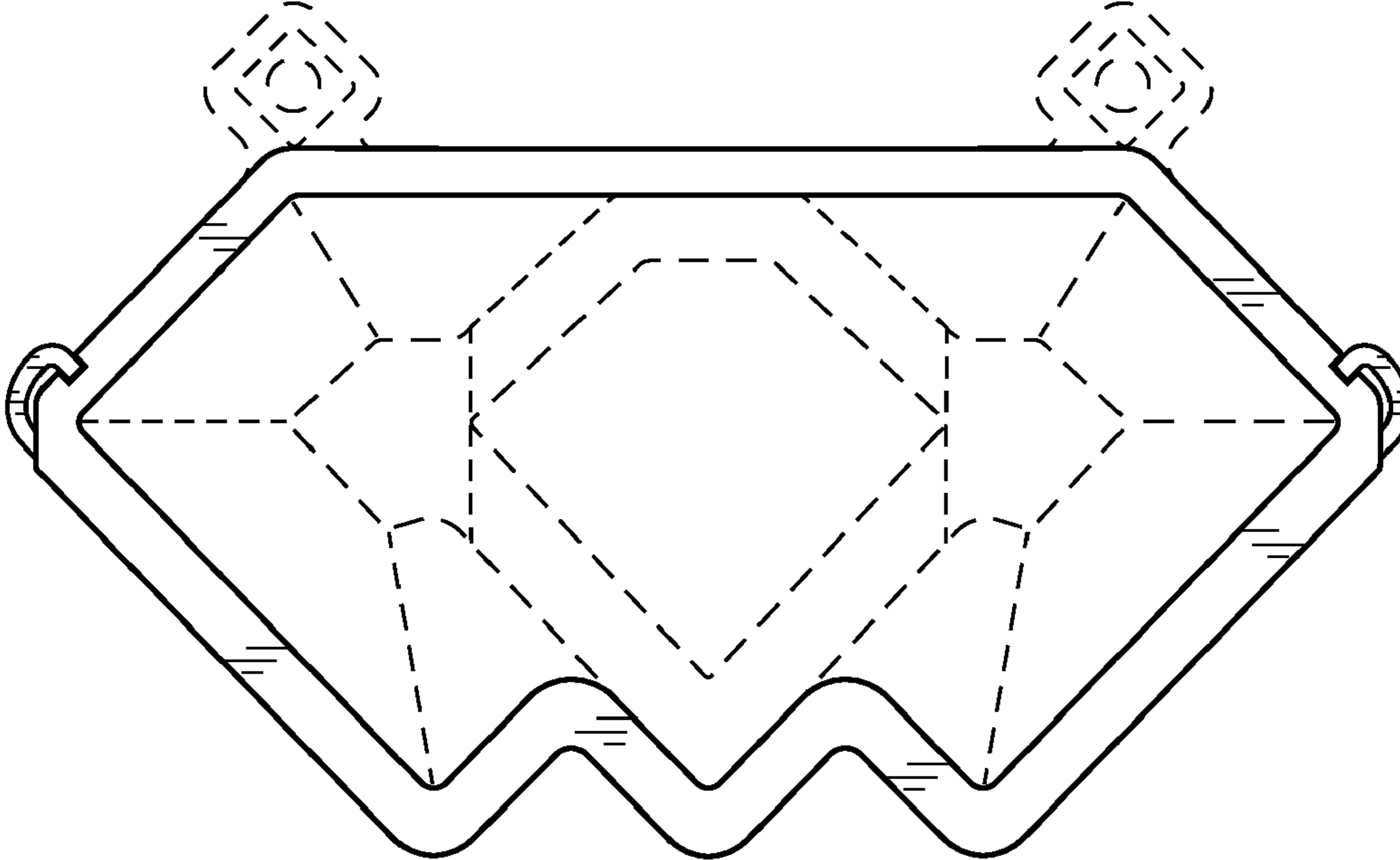

Fig. 7

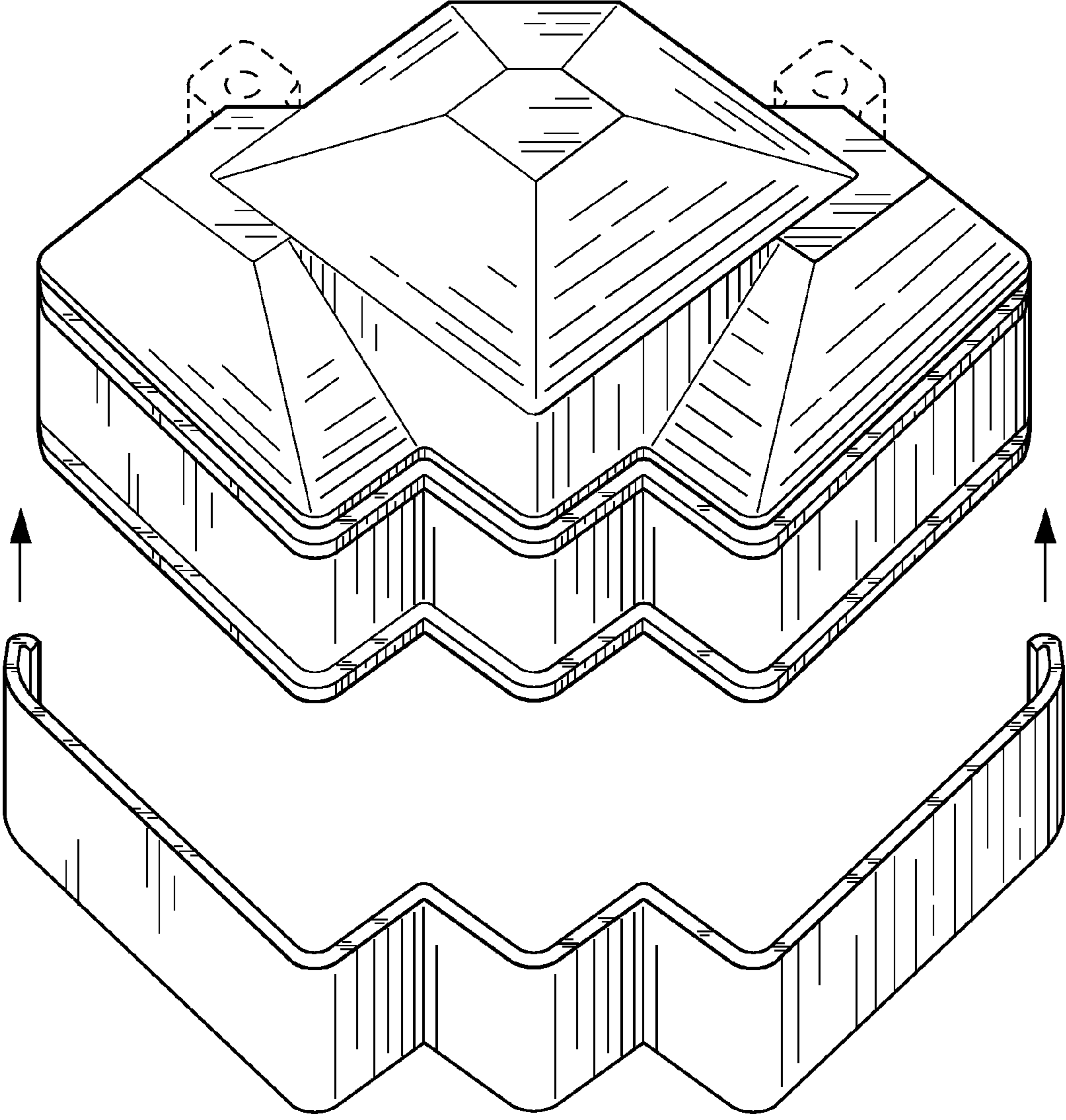

Fig. 8

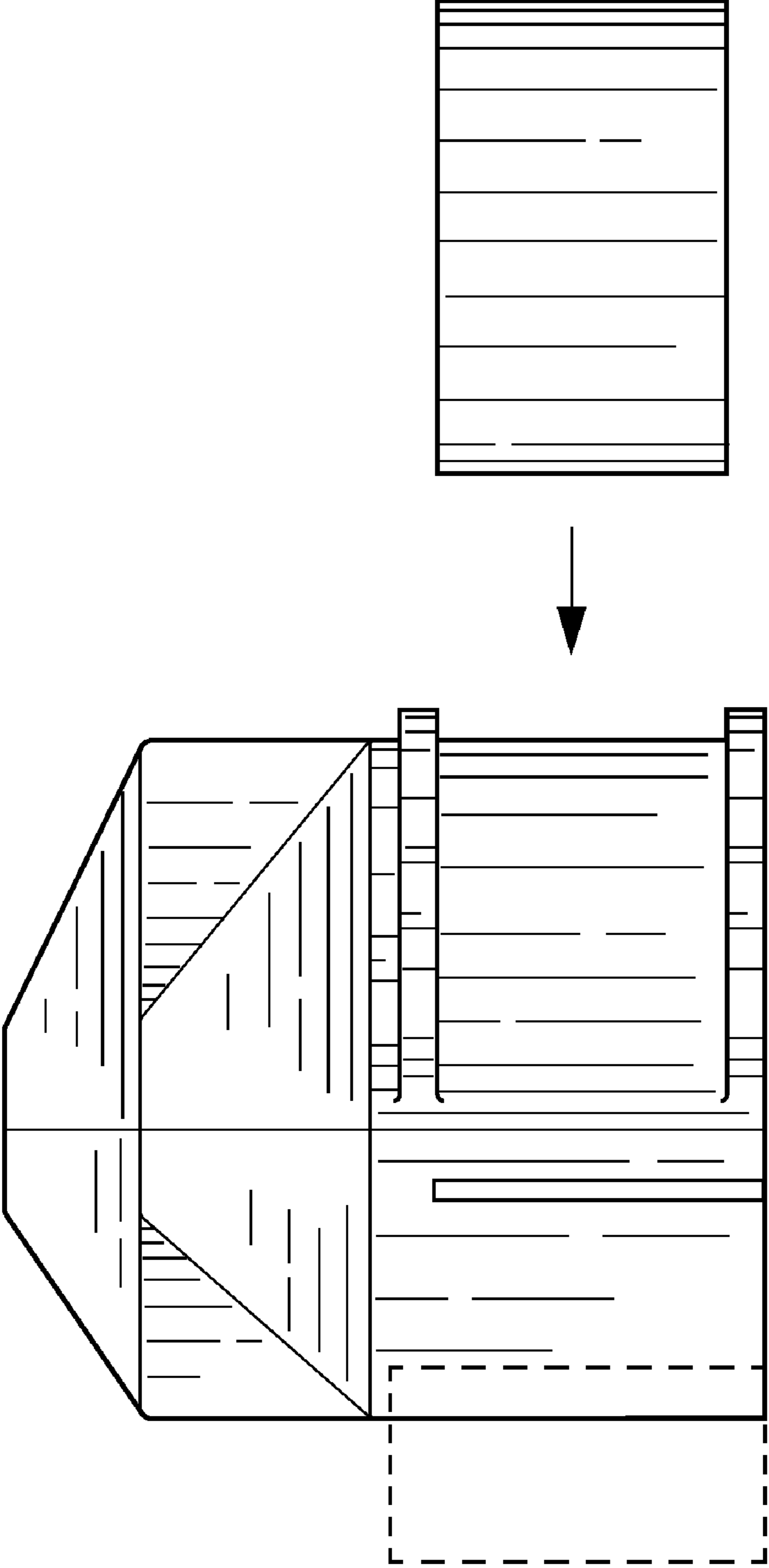

Fig. 9



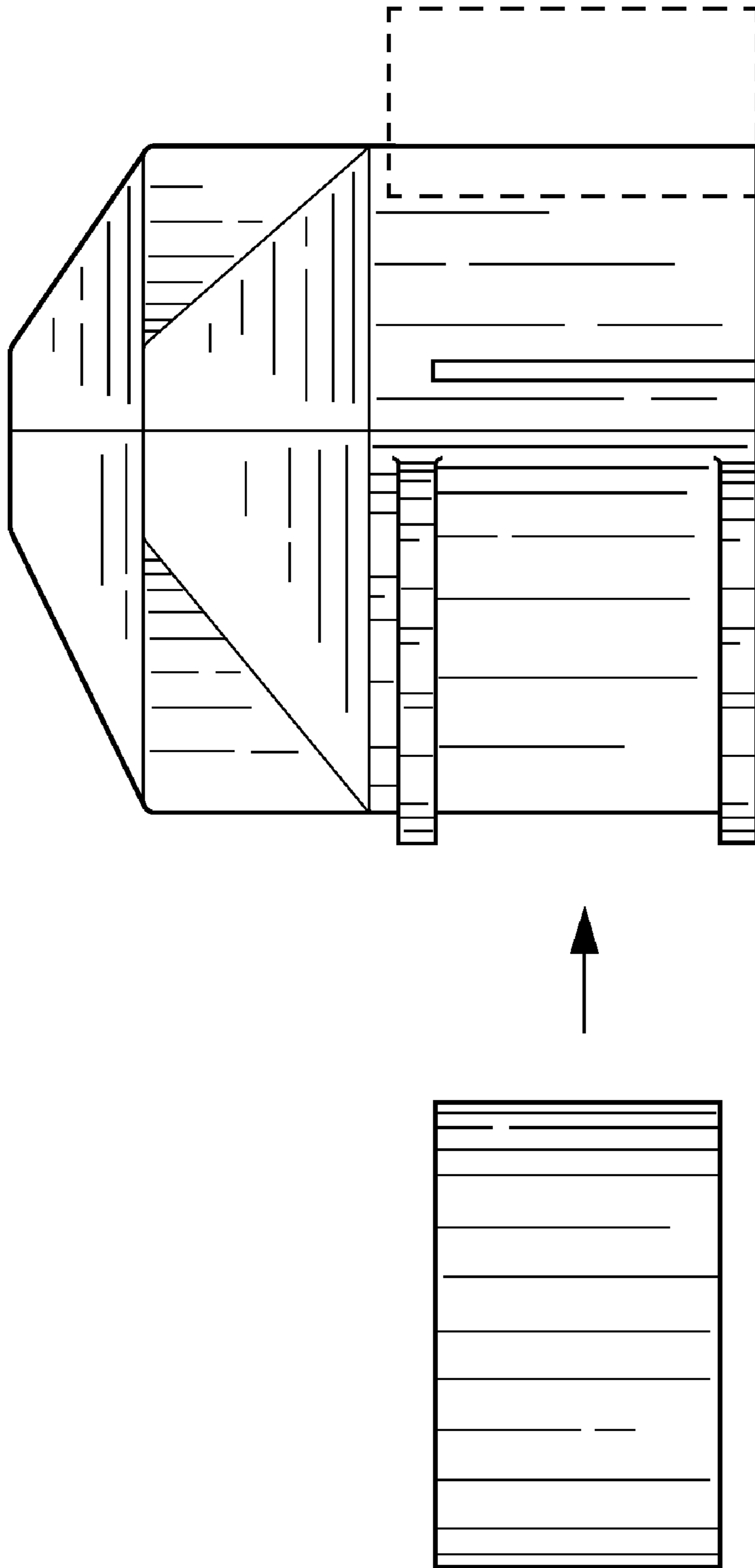

Fig. 10

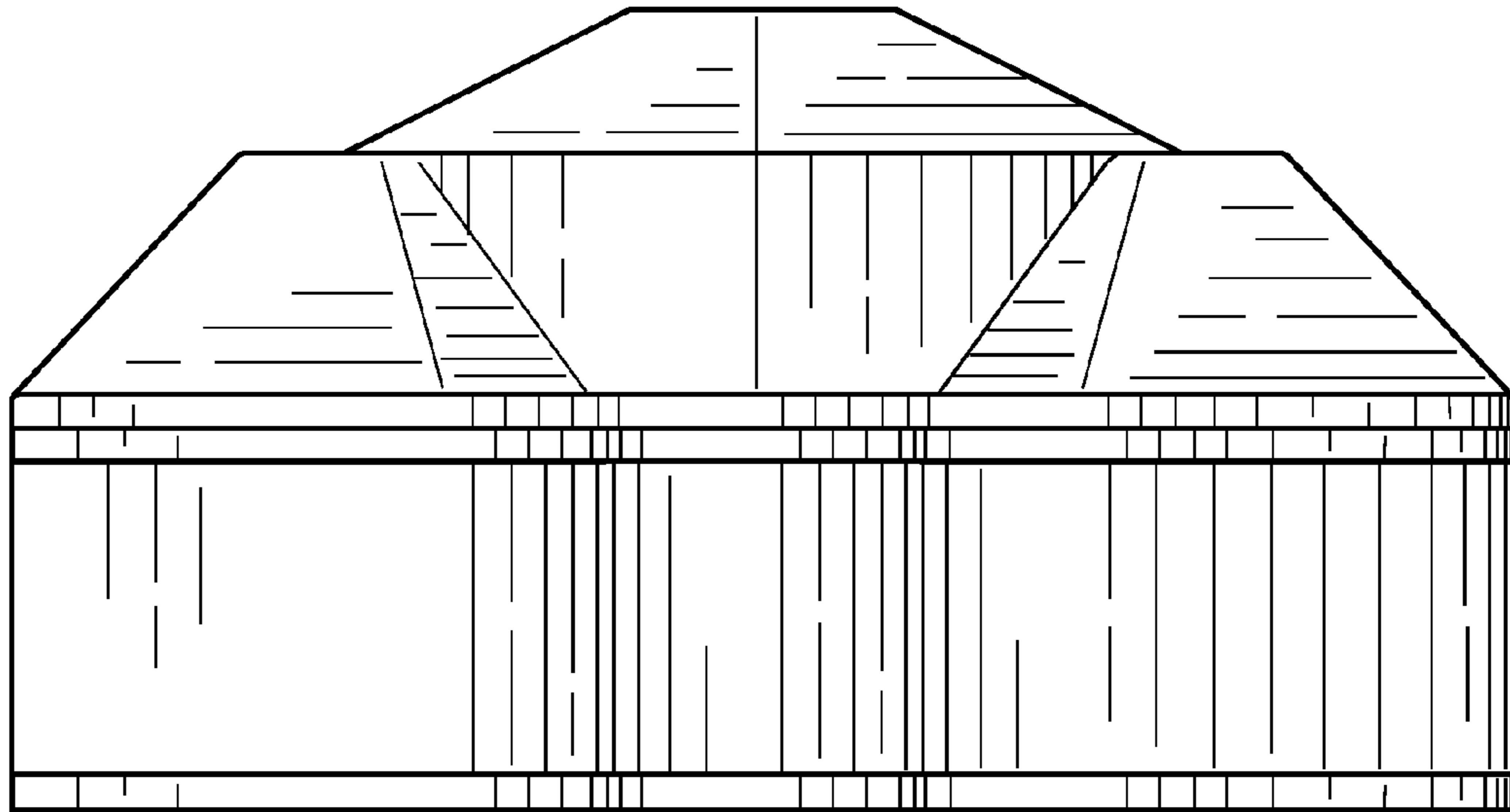

Fig. 11

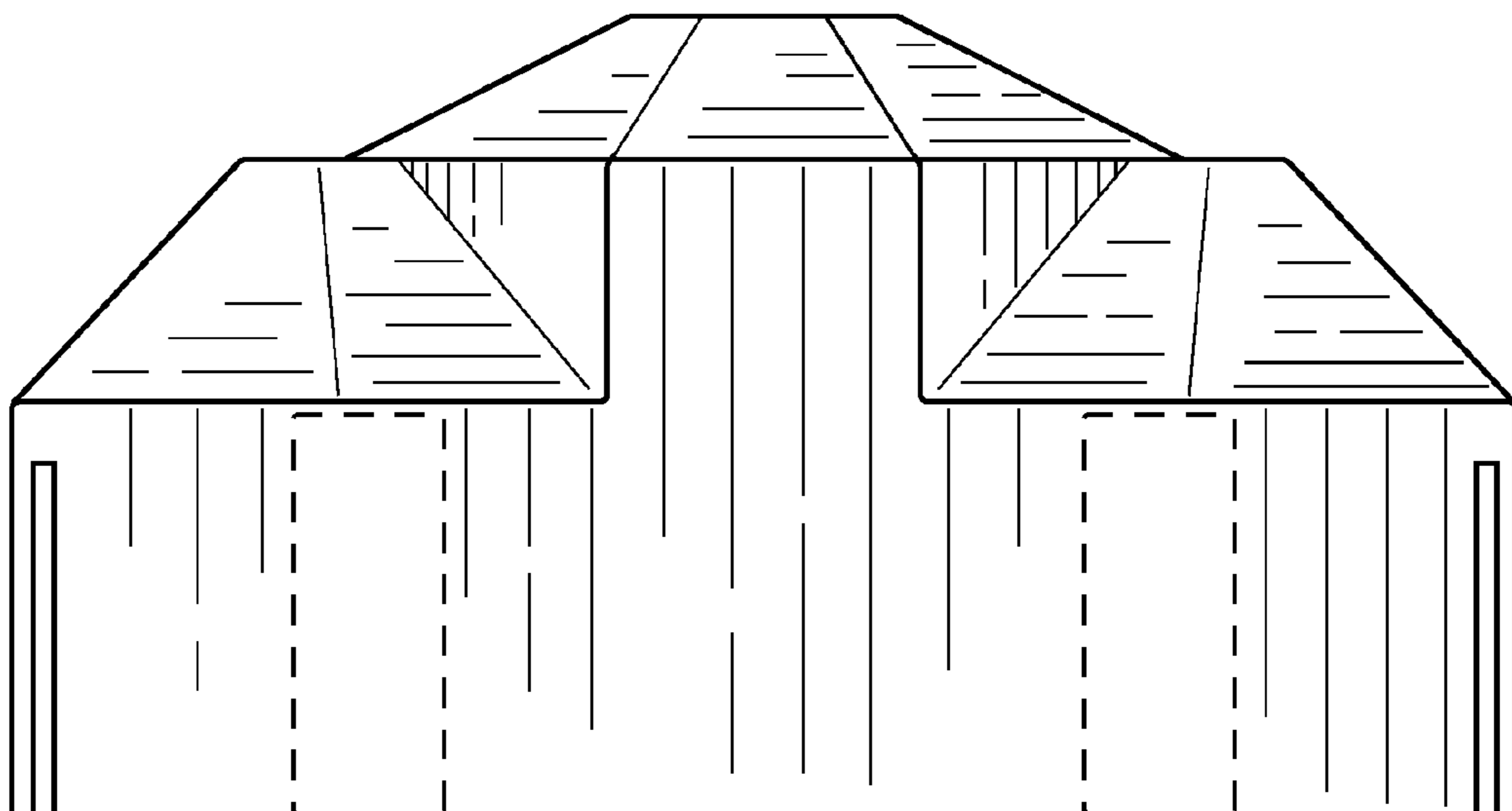

Fig. 12

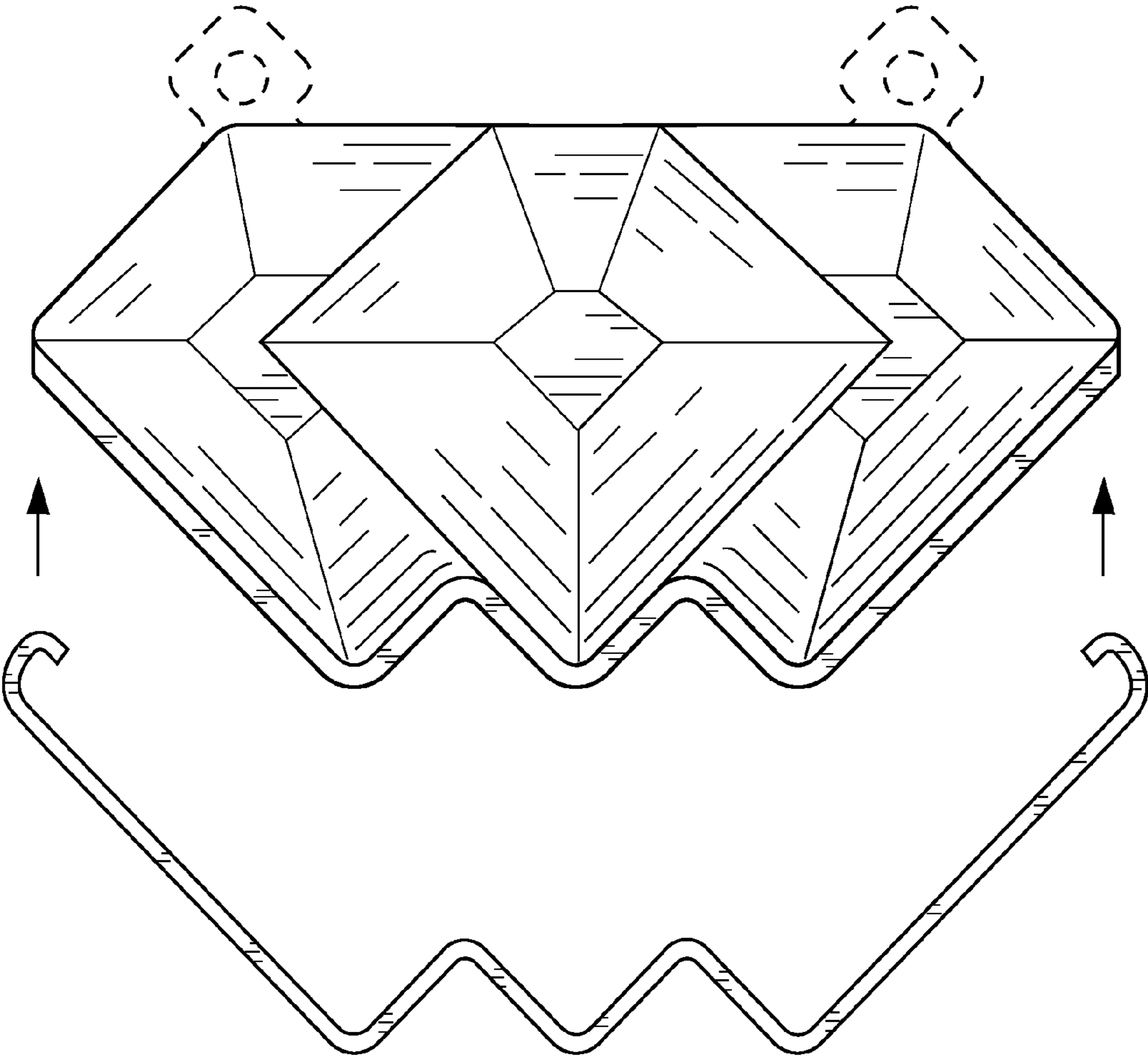

Fig. 13

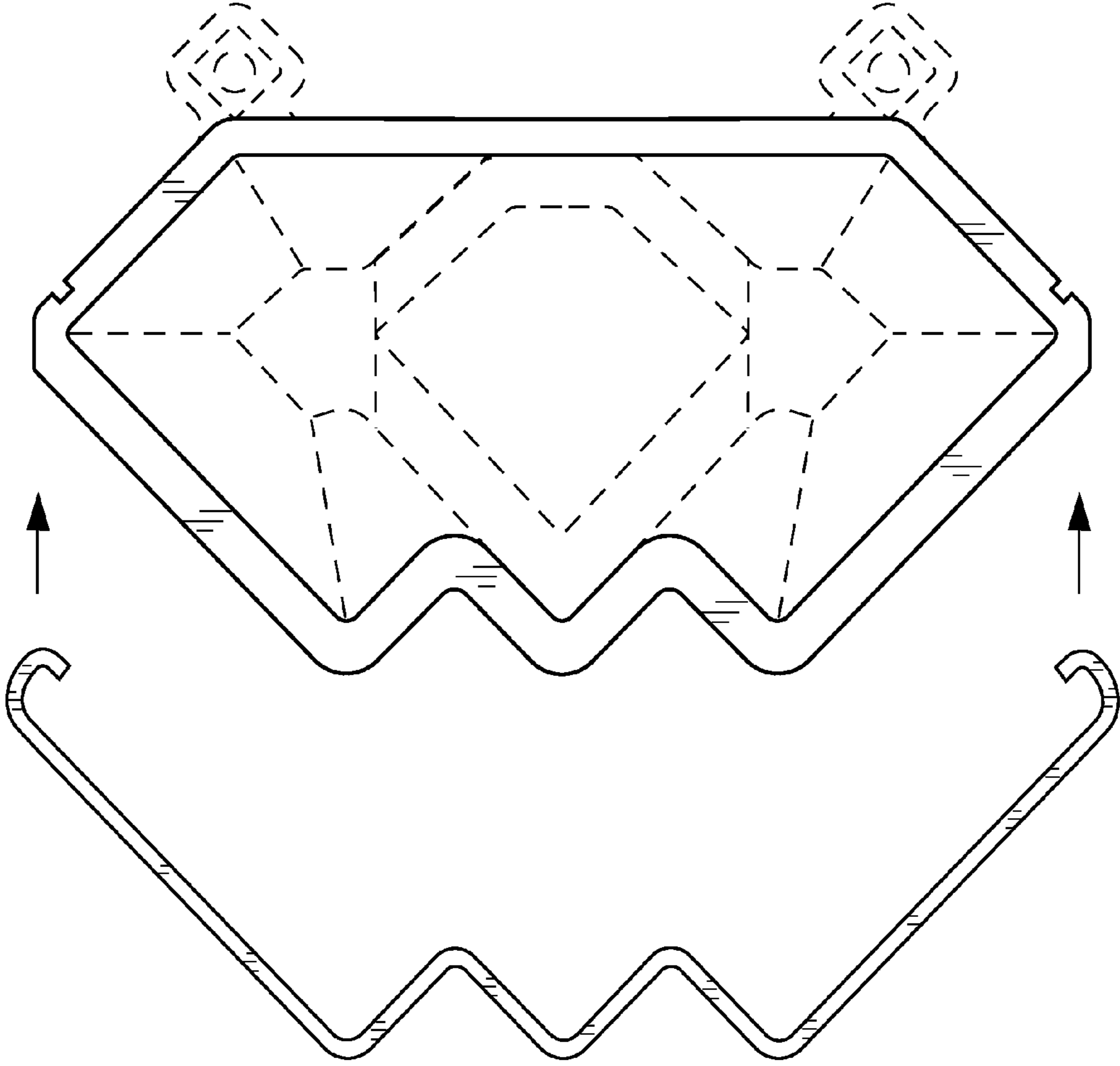

Fig. 14