



US00D674395S

(12) **United States Design Patent**
Haarburger

(10) **Patent No.:** **US D674,395 S**
(45) **Date of Patent:** **** Jan. 15, 2013**

(54) **LOW PROFILE ELECTRONIC DEVICE
STAND PAIR**

(75) Inventor: **Daniel J. Haarburger**, Boulder, CO
(US)

(73) Assignee: **Ethic LLC**, Boulder, CO (US)

(**) Term: **14 Years**

(21) Appl. No.: **29/400,915**

(22) Filed: **Sep. 2, 2011**

(51) **LOC (9) Cl.** **08-07**

(52) **U.S. Cl.** **D14/447**

(58) **Field of Classification Search** D14/447,
D14/432, 433, 434, 439, 440, 451, 452, 457,
D14/239, 251, 253, 217, 374, 375, 376, 377,
D14/902, 216, 209.1, 204; D12/415, 416;
D3/218, 274, 318, 321, 328; D6/406.3, 406.4;
190/117; 361/679.03, 679.09, 679.05, 679.26,
361/679.3, 679.55, 679.56, 679.27; 248/176.1,
248/917, 918, 919, 920, 921, 922, 923, 924,
248/682, 689, 690, 691, 692, 441.1, 444,
248/447, 451, 460, 463, 118, 118.5, 149,
248/150, 166, 434, 177.1; D10/113.4; D16/242,
D16/244, 245; 108/42, 152

See application file for complete search history.

(56) **References Cited**

U.S. PATENT DOCUMENTS

D296,212	S	*	6/1988	Arney	D14/457
D510,358	S	*	10/2005	Ezure	D14/447
D513,875	S	*	1/2006	Licsko	D3/318
D589,962	S	*	4/2009	Maruyama et al.	D14/432
D603,840	S	*	11/2009	Lee et al.	D14/217
D616,431	S	*	5/2010	Hijmans	D14/253
D618,692	S	*	6/2010	Deutsch et al.	D14/447
D628,203	S	*	11/2010	Noble	D14/447
D633,040	S	*	2/2011	Le et al.	D13/108
D640,708	S	*	6/2011	Lee	D14/447
D661,309	S	*	6/2012	Murrer et al.	D14/447
D663,735	S	*	7/2012	Musselman	D14/447
2010/0294908	A1	*	11/2010	Mish et al.	248/451

* cited by examiner

Primary Examiner — Angela J Lee

(74) *Attorney, Agent, or Firm* — Perkins Coie LLP

(57) **CLAIM**

The ornamental design for a low profile electronic device stand pair, as shown and described.

DESCRIPTION

FIG. 1 is a perspective view of a low profile electronic device stand pair.

FIG. 2 is a right side view thereof.

FIG. 3 is a left side view thereof.

FIG. 4 is a front view thereof.

FIG. 5 is a back view thereof.

FIG. 6 is a top view thereof; and,

FIG. 7 is a bottom view thereof.

The broken lines form no part of the claimed design.

1 Claim, 4 Drawing Sheets

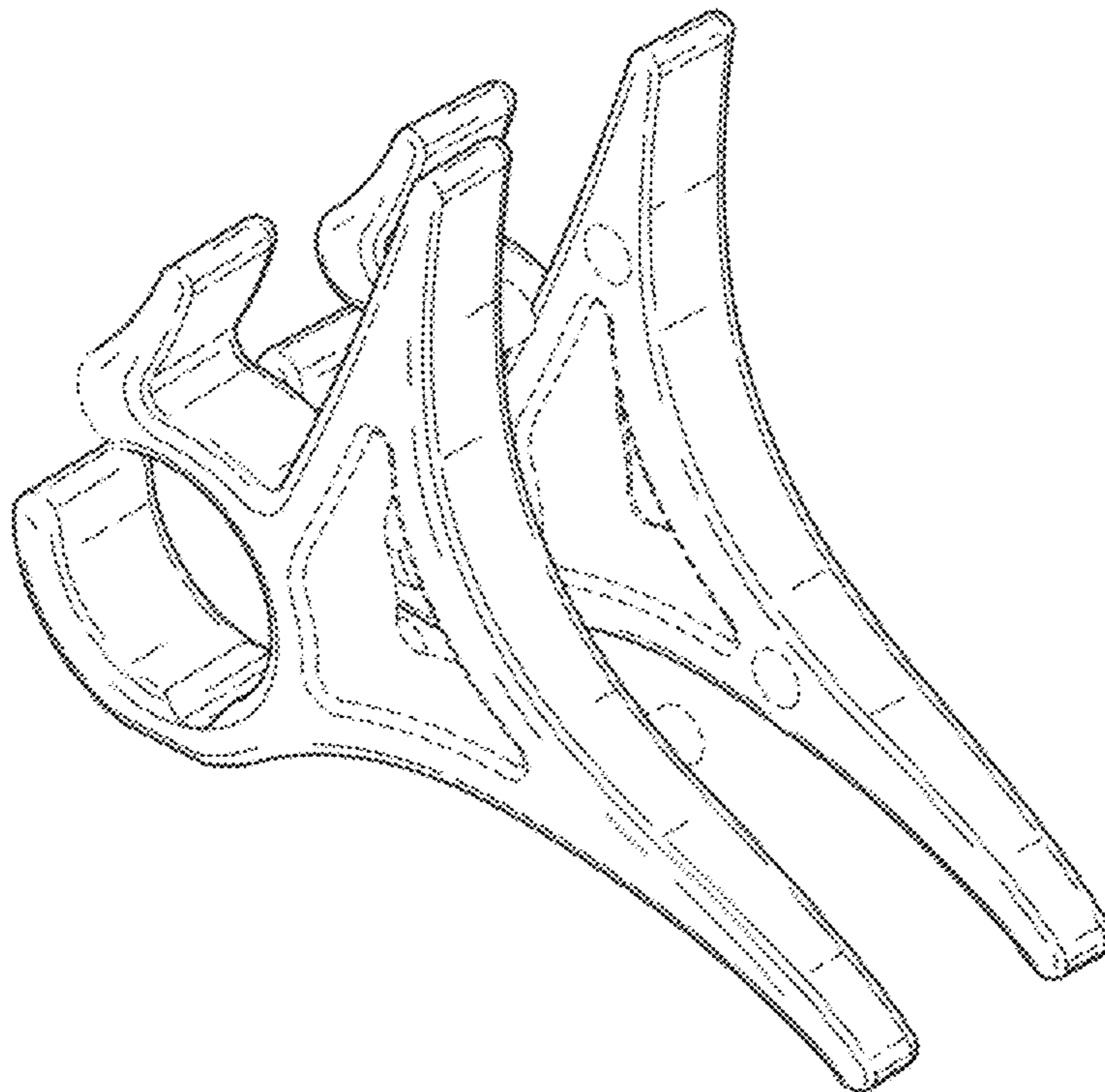

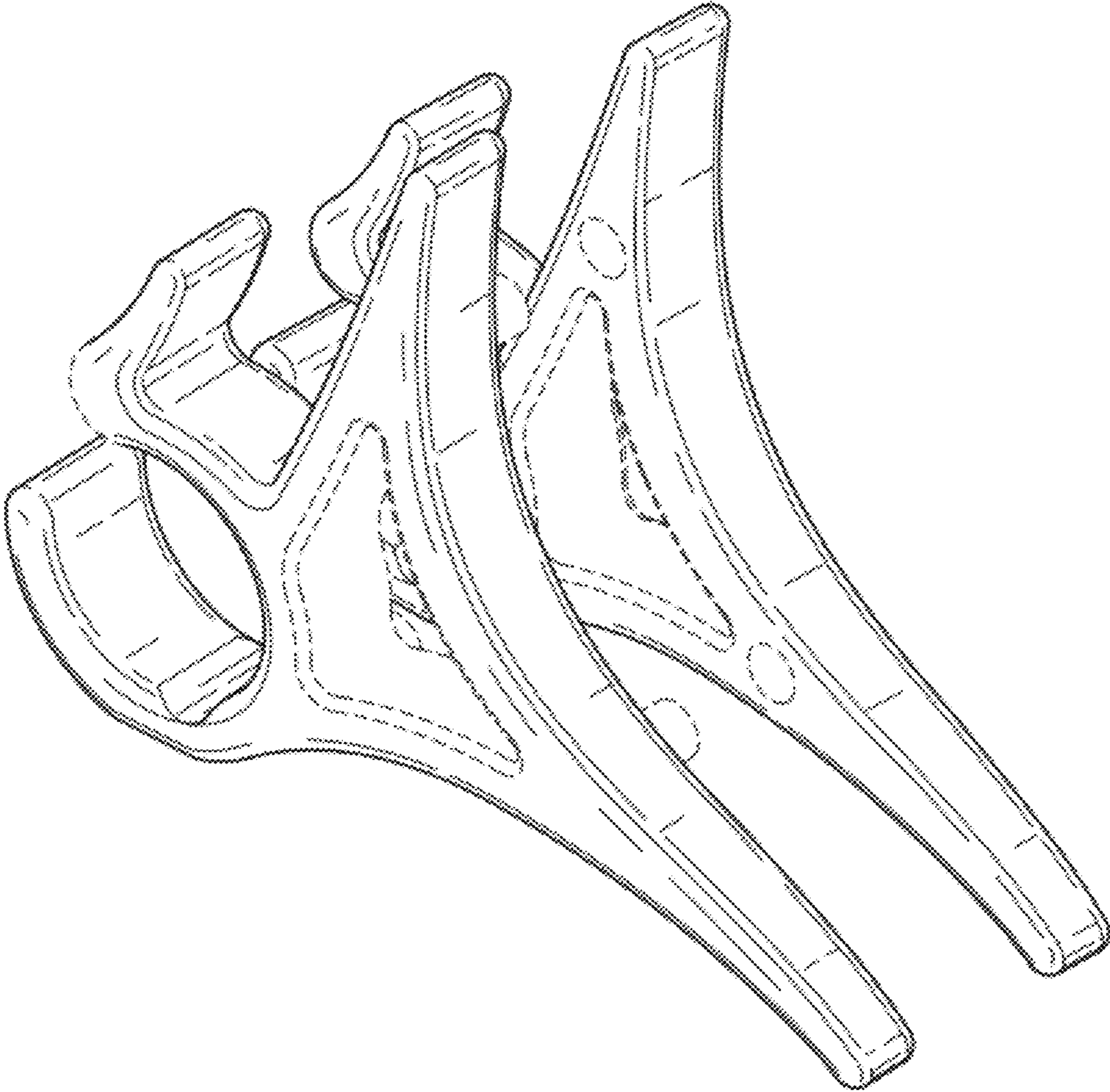

Fig. 1

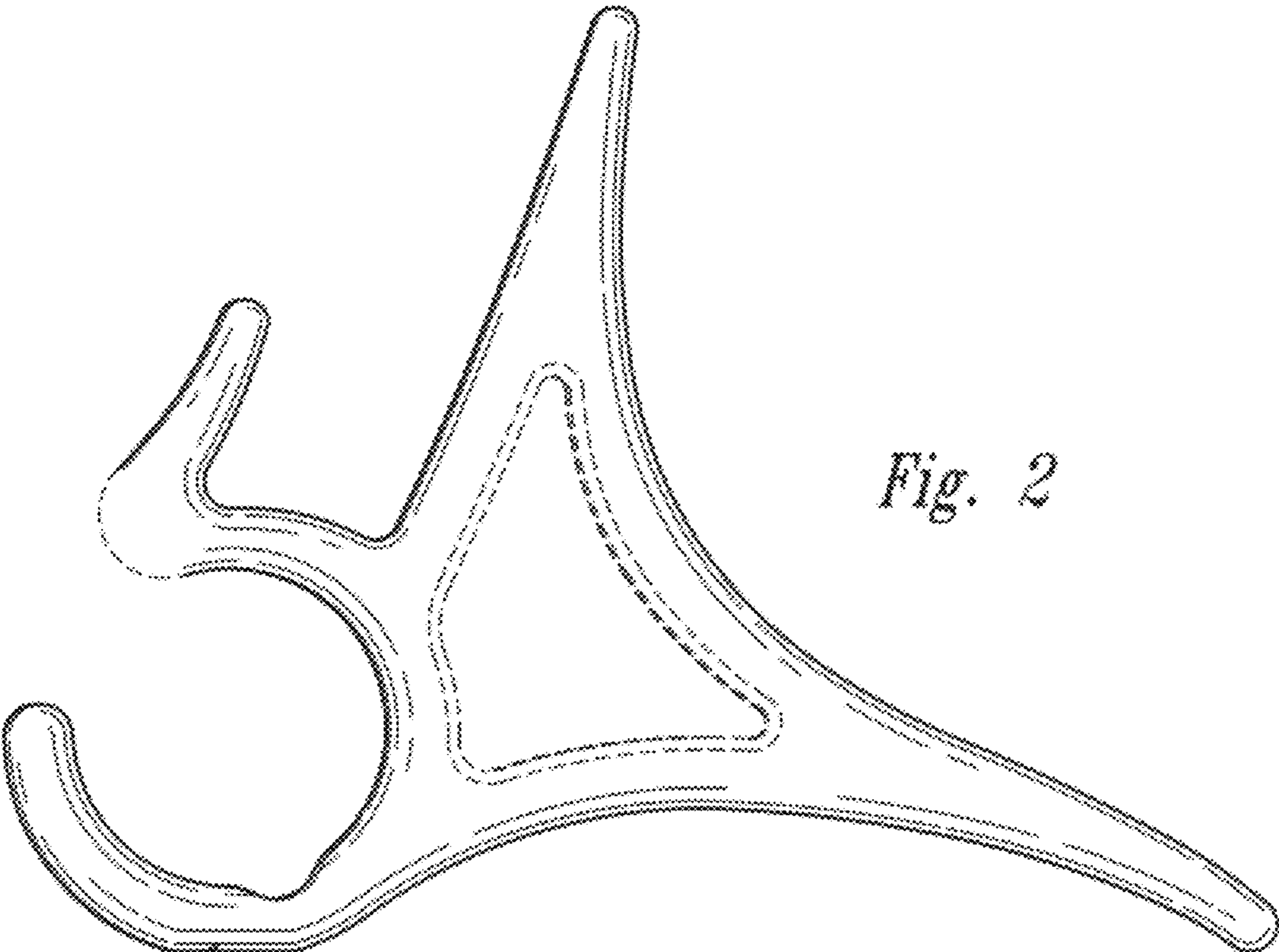

Fig. 2

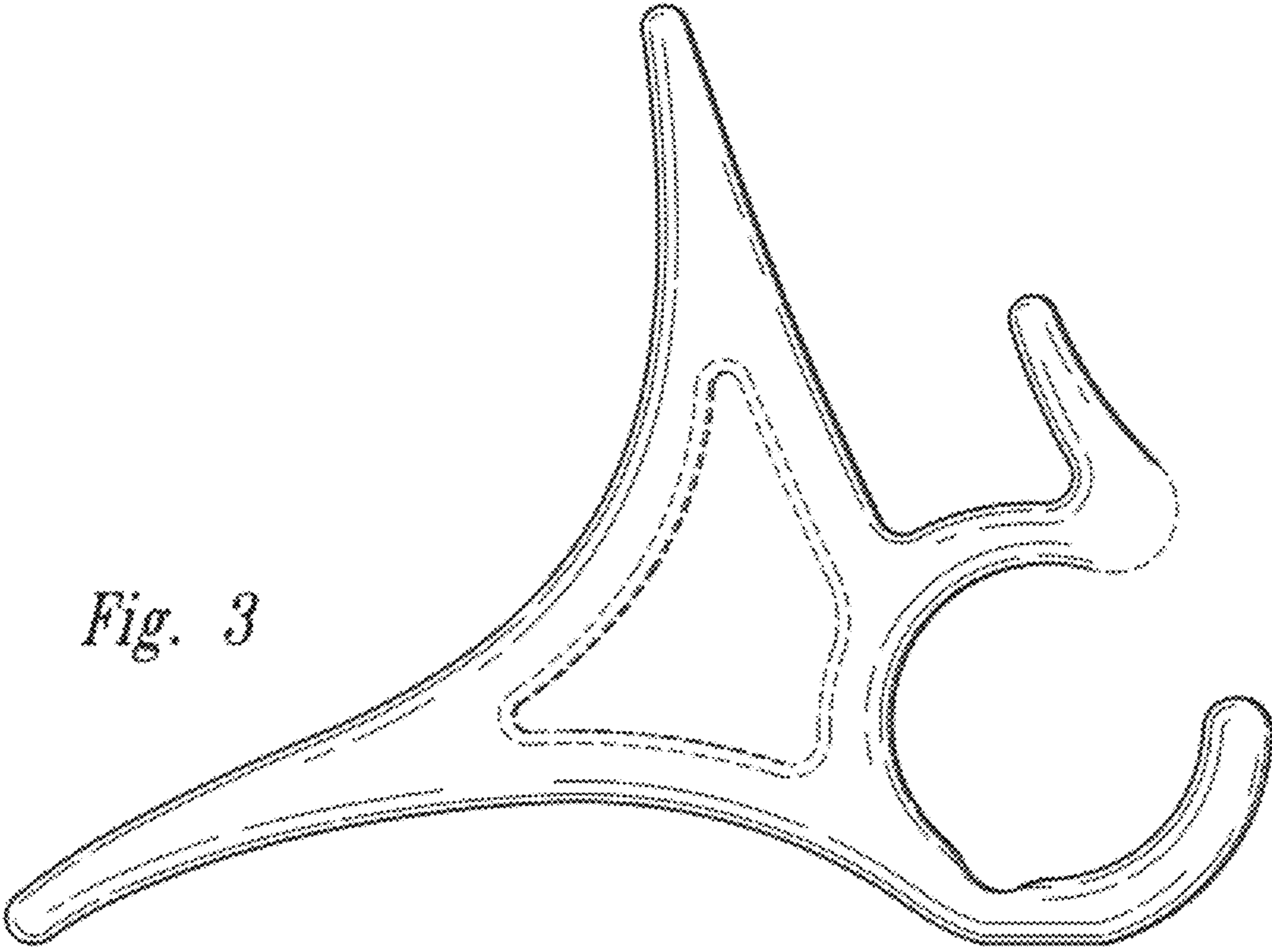

Fig. 3

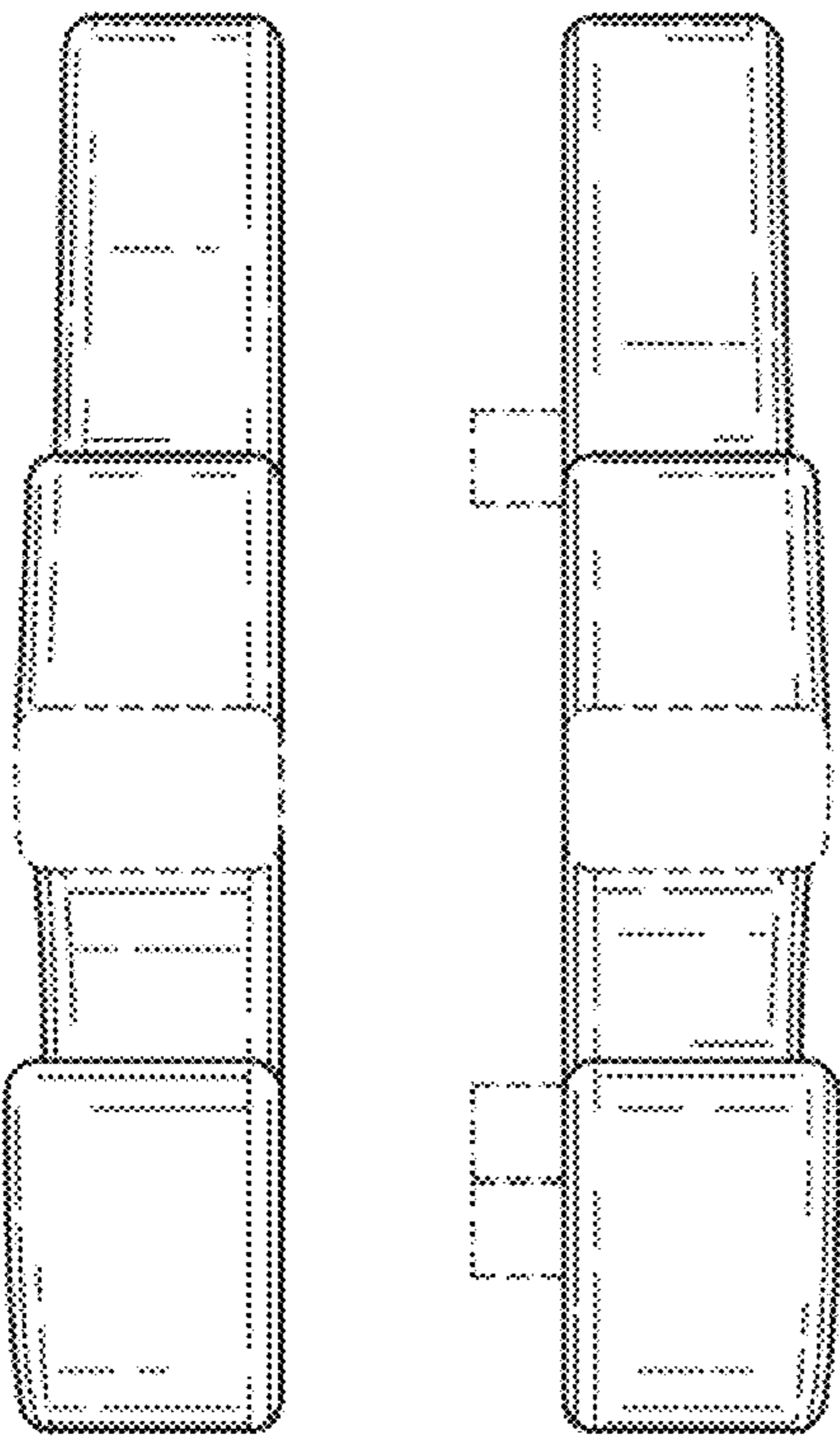

Fig. 4

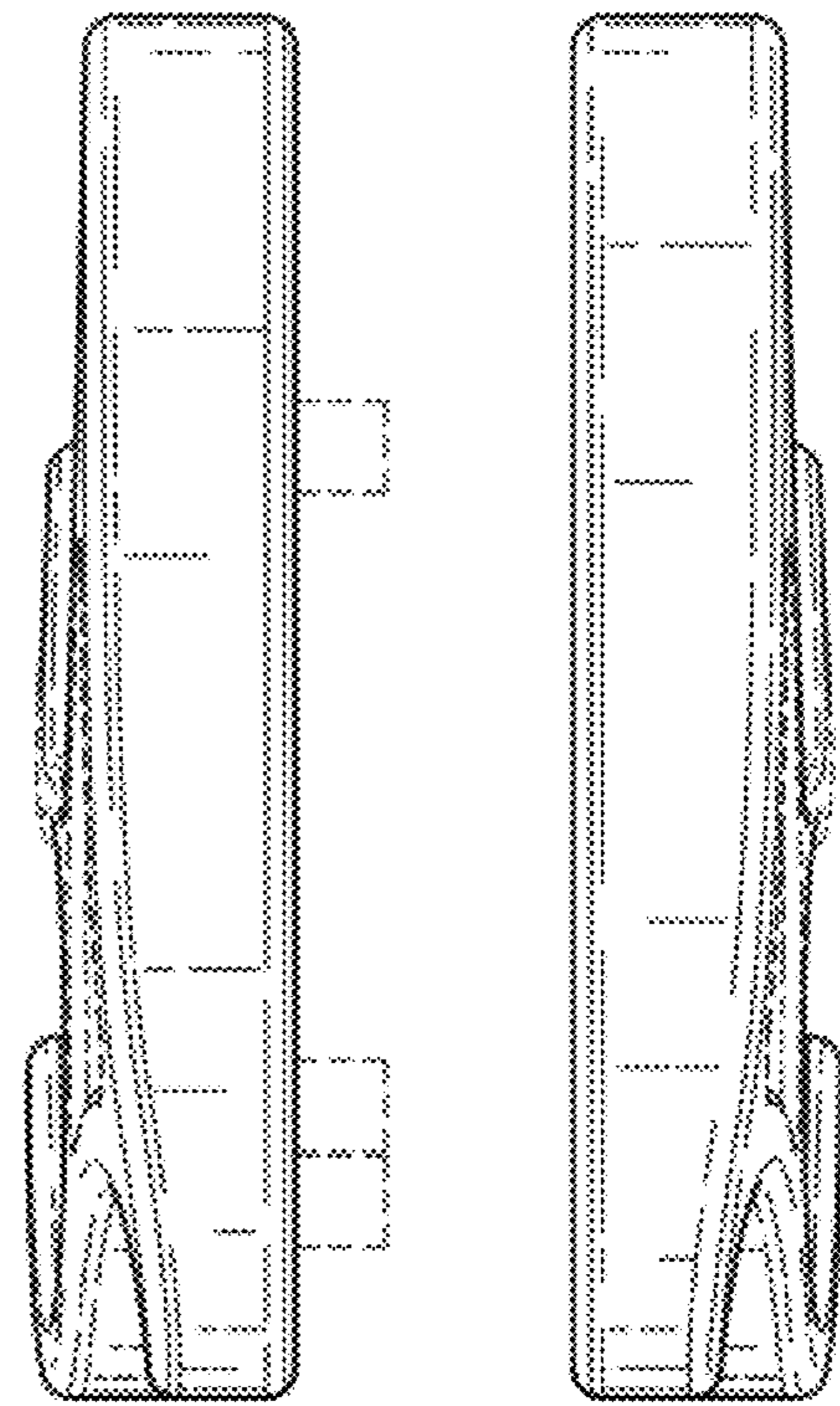

Fig. 5

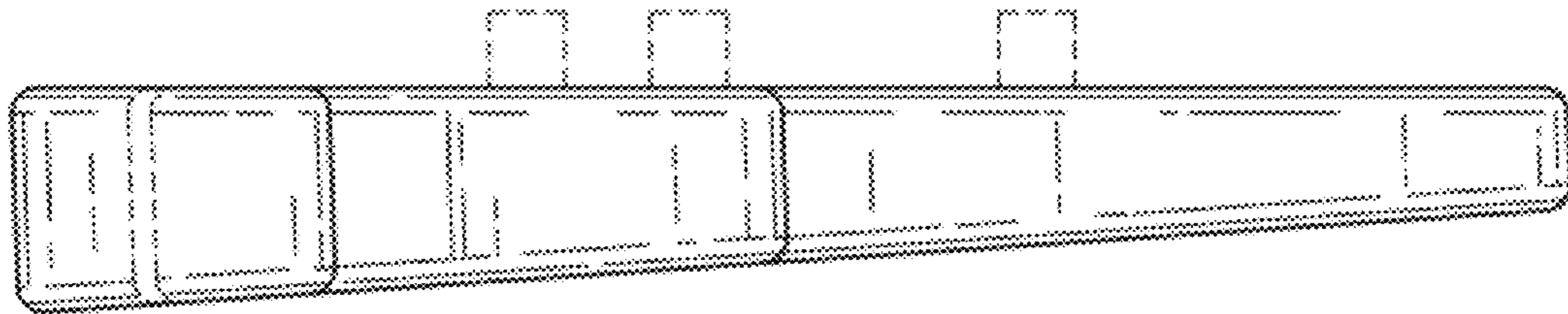
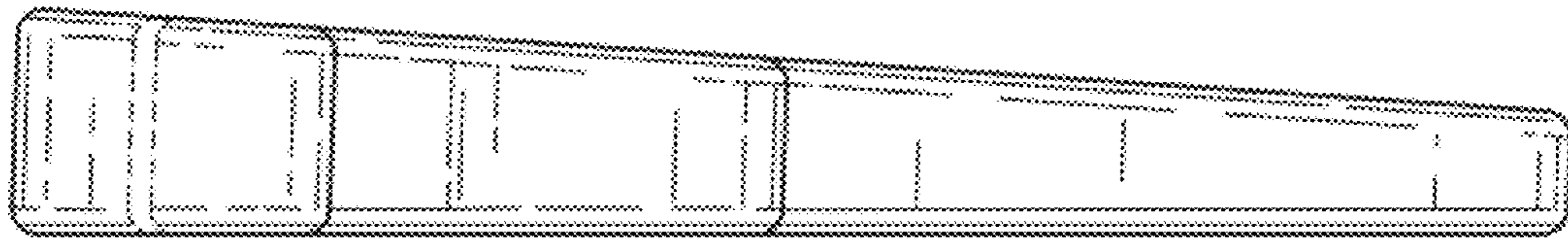

Fig. 6

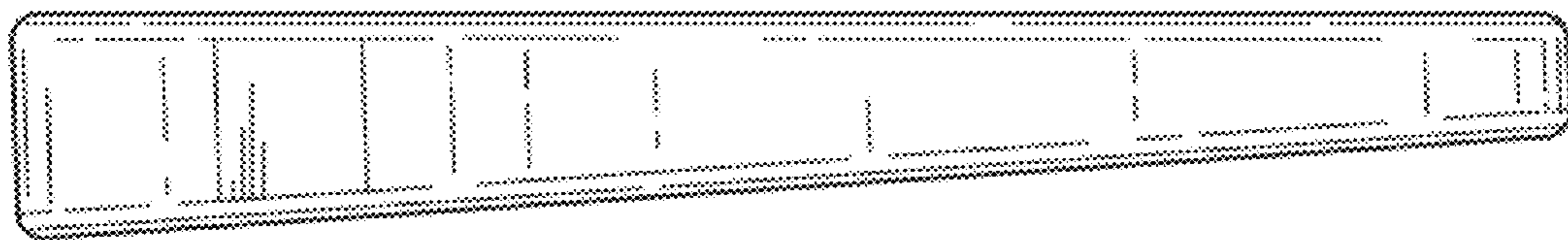
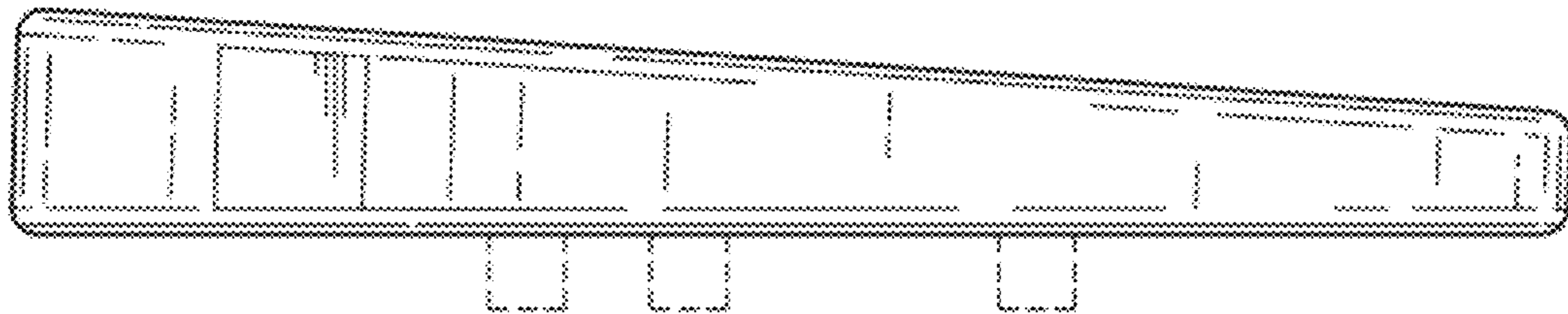

Fig. 7