



US00D673264S

(12) **United States Design Patent**
Kunze

(10) **Patent No.:** **US D673,264 S**

(45) **Date of Patent:** **** *Dec. 25, 2012**

(54) **INJECTOR**

(75) Inventor: **Katja Kunze**, Stockholm (SE)

(73) Assignee: **SHL Group AB**, Nacka Strand (SE)

(*) Notice: This patent is subject to a terminal disclaimer.

(**) Term: **14 Years**

(21) Appl. No.: **29/354,032**

(22) Filed: **Jan. 19, 2010**

(51) **LOC (9) Cl.** **24-02**

(52) **U.S. Cl.** **D24/113**

(58) **Field of Classification Search** D24/112–114,
D24/133, 186, 104, 130, 127; 606/181, 185;
604/232, 187, 158, 164.08, 192, 263, 163,
604/181, 184, 198, 227; D19/41, 43, 51;
D9/686, 688–691

See application file for complete search history.

(56) **References Cited**

U.S. PATENT DOCUMENTS

D191,650	S	*	10/1961	Kruck	D9/686
5,709,662	A	*	1/1998	Olive et al.	604/187
D408,592	S	*	4/1999	Litton	D19/51
D430,666	S	*	9/2000	Cseke et al.	D24/130
D448,407	S	*	9/2001	Huang	D19/43
D479,748	S	*	9/2003	Tyce	D24/114
D488,506	S	*	4/2004	Mandel et al.	D19/51
6,726,649	B2	*	4/2004	Swenson et al.	604/263
D538,851	S	*	3/2007	Sandel et al.	D24/133

D545,364	S	*	6/2007	Ternovits	D19/43
D566,762	S	*	4/2008	Qiu	D19/43
D584,960	S	*	1/2009	Sherwood	D9/686
D623,755	S	*	9/2010	Ikegame	D24/186

* cited by examiner

Primary Examiner — David Muller

(74) *Attorney, Agent, or Firm* — Potomac Patent Group PLLC

(57) **CLAIM**

The ornamental design for an injector, as shown and described.

DESCRIPTION

FIG. 1 is a side elevational view of an assembled injector showing my new design;
 FIG. 2 is a side perspective view thereof;
 FIG. 3 is a side elevational view of an unextended first part of a disassembled injector showing my new design;
 FIG. 4 is a rotated side elevational view of an extended first part and a second part of a disassembled injector showing my new design;
 FIG. 5 is a side perspective view thereof;
 FIG. 6 is a rotated elevational view thereof;
 FIG. 7 is an enlarged plan view of the first part of an injector showing my new design; and,
 FIG. 8 is an enlarged plan view of the second part of an injector showing my new design.

1 Claim, 6 Drawing Sheets

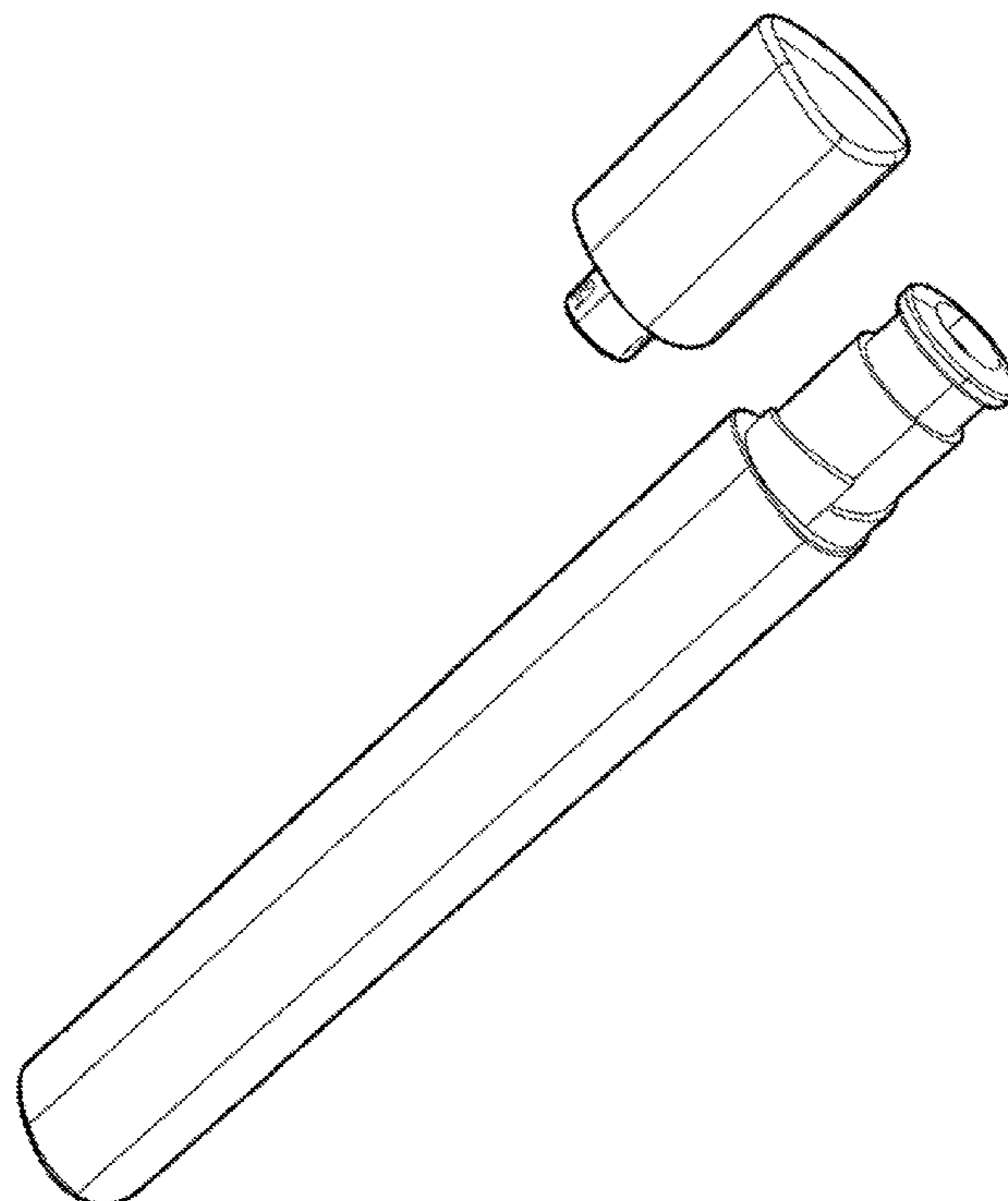

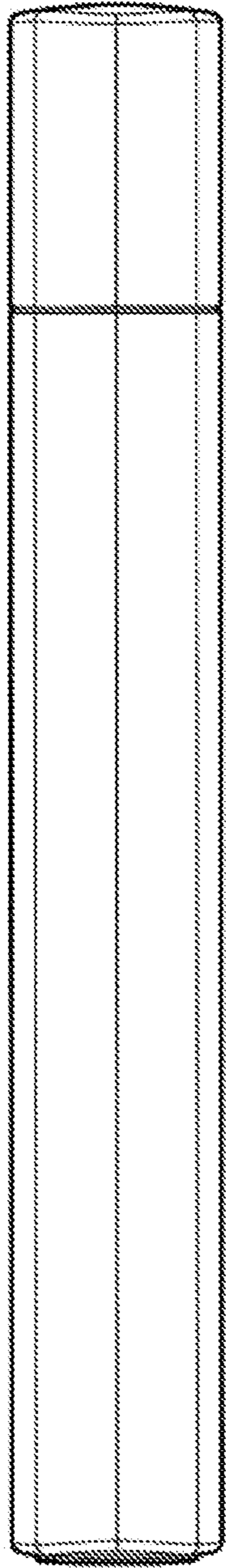

FIG. 1

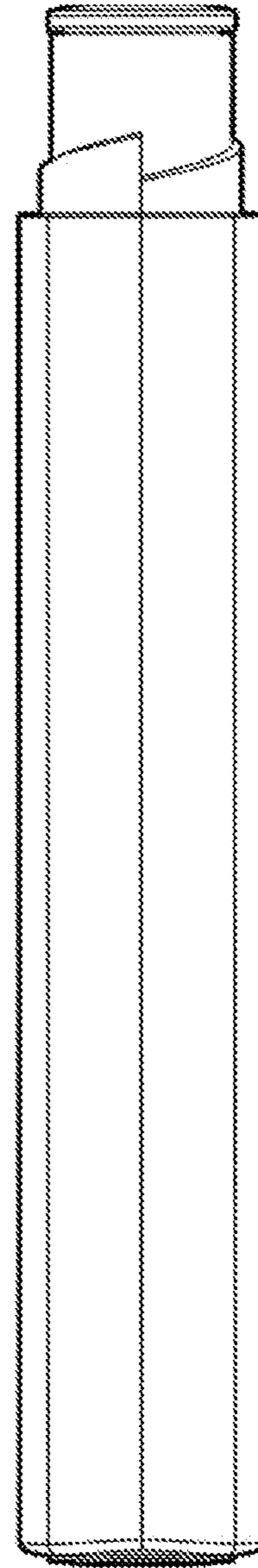

FIG. 3

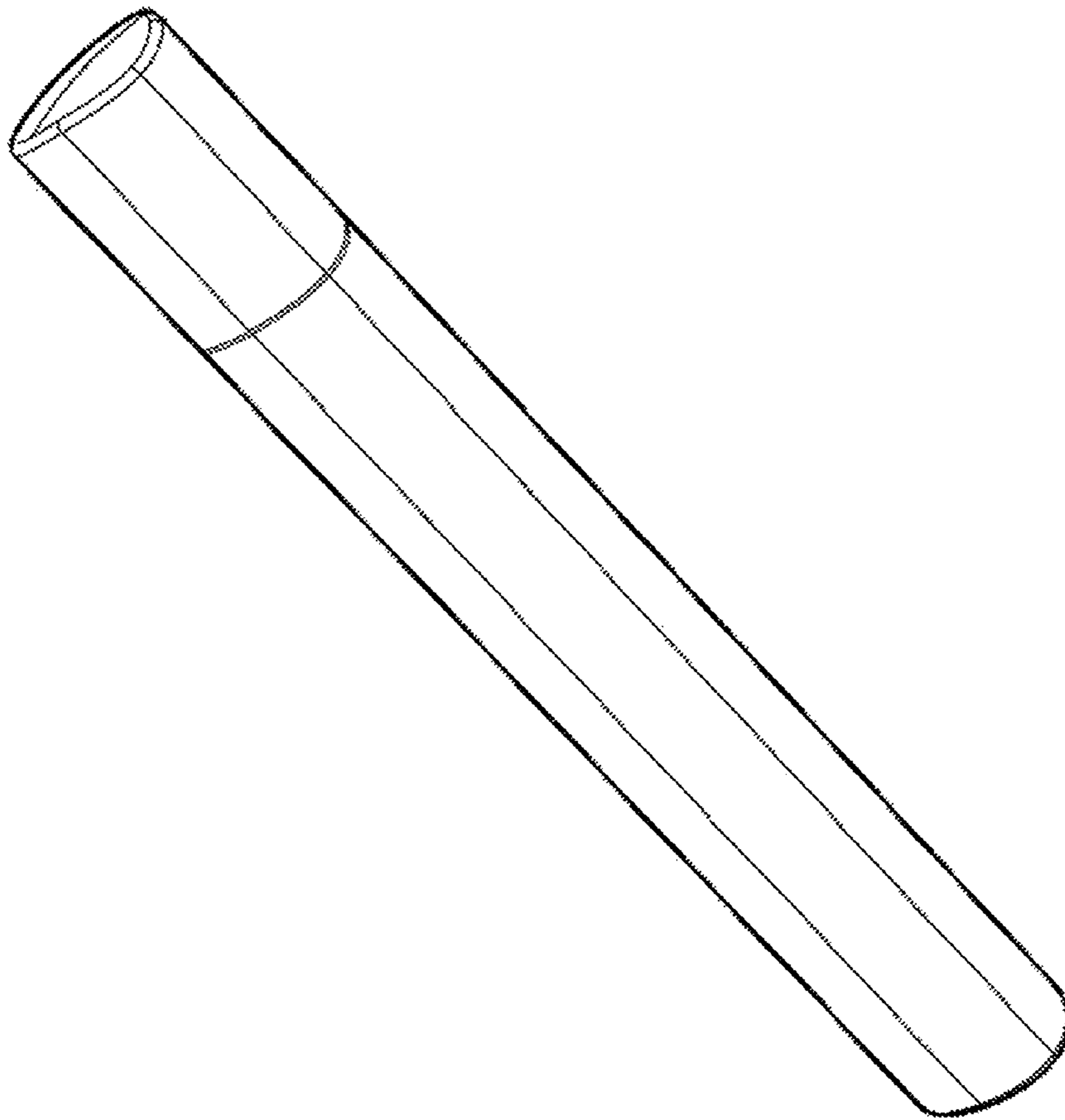

FIG. 2

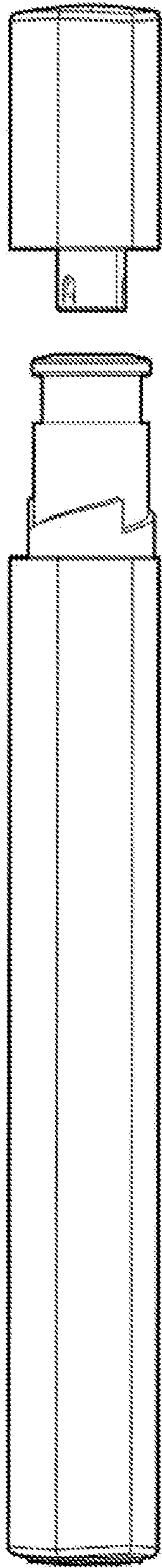

FIG. 4

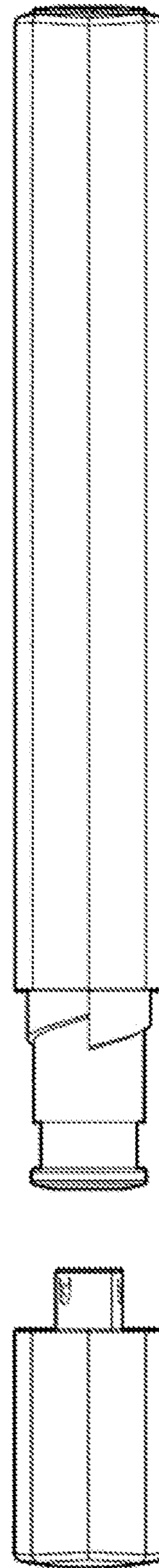

FIG. 6

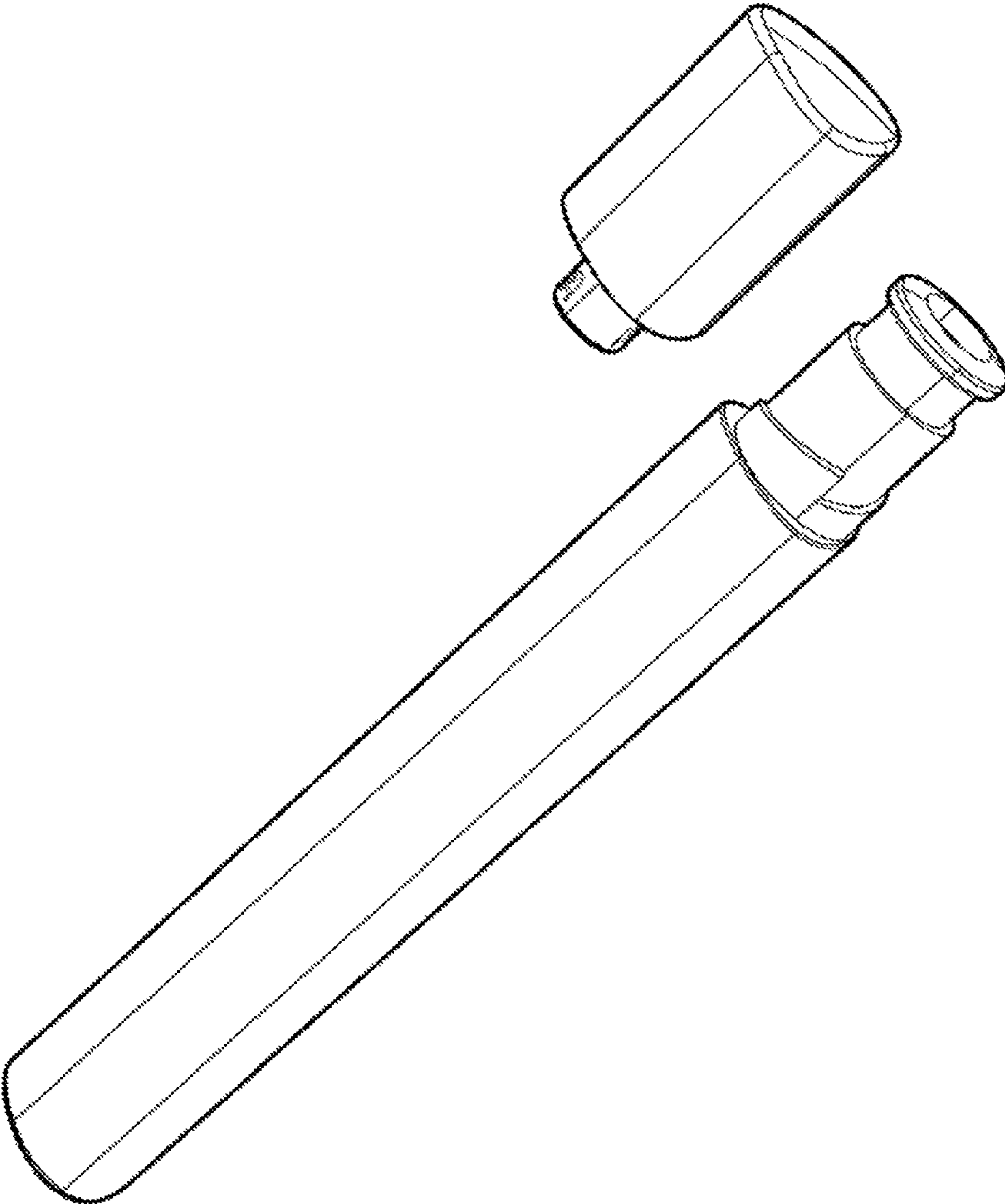

FIG. 5

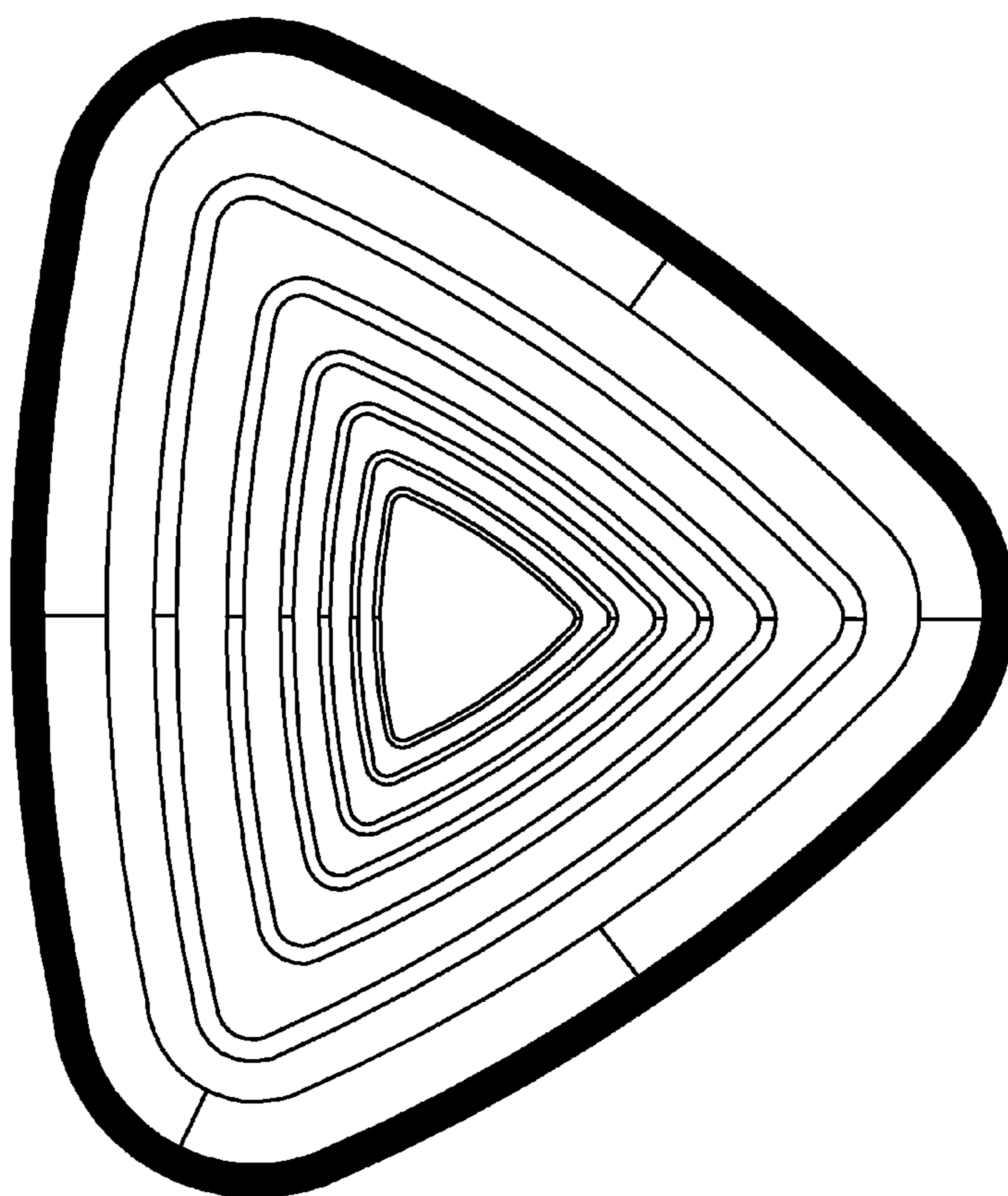

FIG. 7

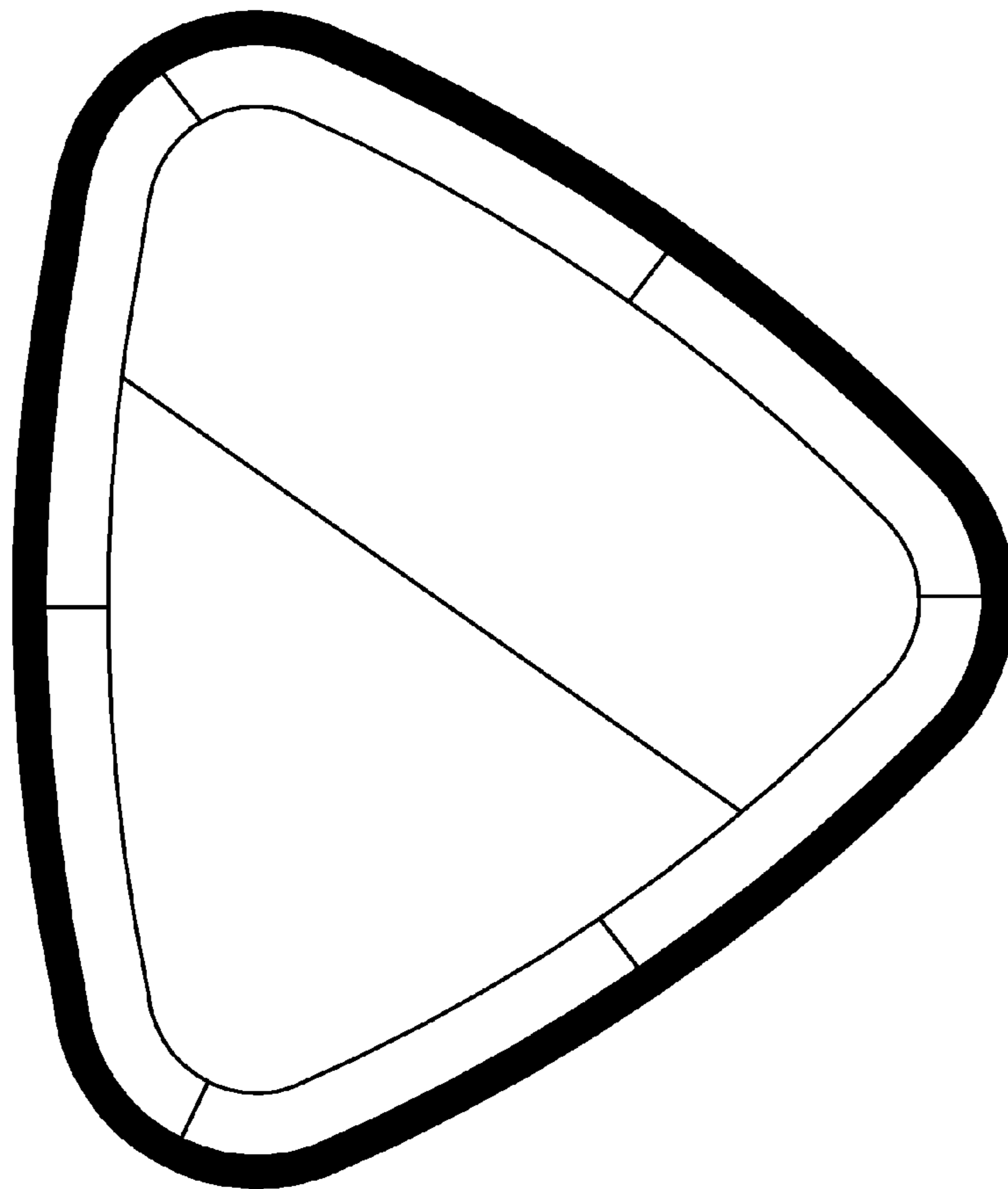

FIG. 8