



US00D672725S

(12) **United States Design Patent**
Svelnis et al.

(10) **Patent No.:** **US D672,725 S**
(45) **Date of Patent:** **** Dec. 18, 2012**

(54) **MID POWER INLINE PLUG**

(75) Inventors: **Christine M Svelnis**, Boylston, MA
(US); **Charles L York**, Townsend, MA
(US)

(73) Assignee: **Anderson Power Products, Inc.**,
Sterling, MA (US)

(**) Term: **14 Years**

(21) Appl. No.: **29/419,346**

(22) Filed: **Apr. 27, 2012**

(51) **LOC (9) Cl.** **13-03**

(52) **U.S. Cl.** **D13/151**

(58) **Field of Classification Search** D13/151,
D13/123, 133, 150, 153, 154, 156, 184, 199;
439/97, 98, 105, 108, 207, 208, 304, 310,
439/325, 338, 344, 345, 347, 350, 367, 370,
439/374, 527, 532, 533, 620.15, 894, 901,
439/903

See application file for complete search history.

(56) **References Cited**

U.S. PATENT DOCUMENTS

6,773,306 B2 * 8/2004 Plishner 439/620.15
7,395,166 B2 * 7/2008 Plishner 702/108

D581,364 S * 11/2008 Cummings et al. D13/151
D613,246 S * 4/2010 Muecke et al. D13/133
D627,733 S * 11/2010 Stutz D13/147
D636,346 S * 4/2011 Svelnis et al. D13/154
D662,892 S * 7/2012 Giefers et al. D13/151

* cited by examiner

Primary Examiner — Derrick Holland

(74) *Attorney, Agent, or Firm* — Maine Cernota & Rardin

(57) **CLAIM**

The ornamental design for a mid power inline plug, as shown and described.

DESCRIPTION

FIG. 1 is a front elevation view of a mid power inline plug, showing our new design;
FIG. 2 is a right side elevation view thereof;
FIG. 3 is a left side elevation view thereof;
FIG. 4 is a top plan view thereof;
FIG. 5 is a bottom plan view thereof;
FIG. 6 is a back elevation view thereof;
FIG. 7 is a front, top and right side perspective view thereof;
FIG. 8 is a back, bottom and left side perspective view thereof; and,
FIG. 9 is a cross sectional view taken along line 9-9 of FIG. 4.

1 Claim, 9 Drawing Sheets

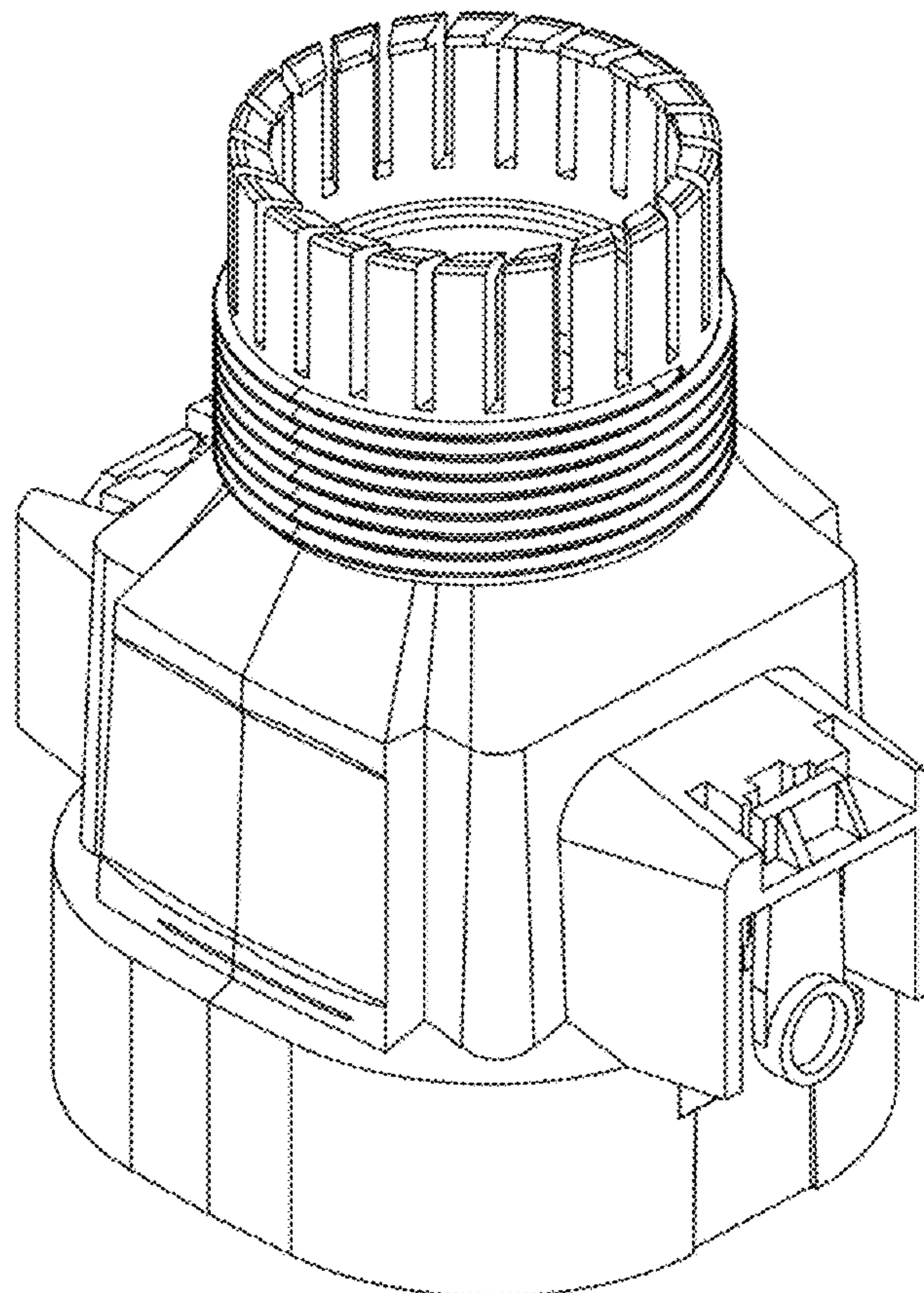

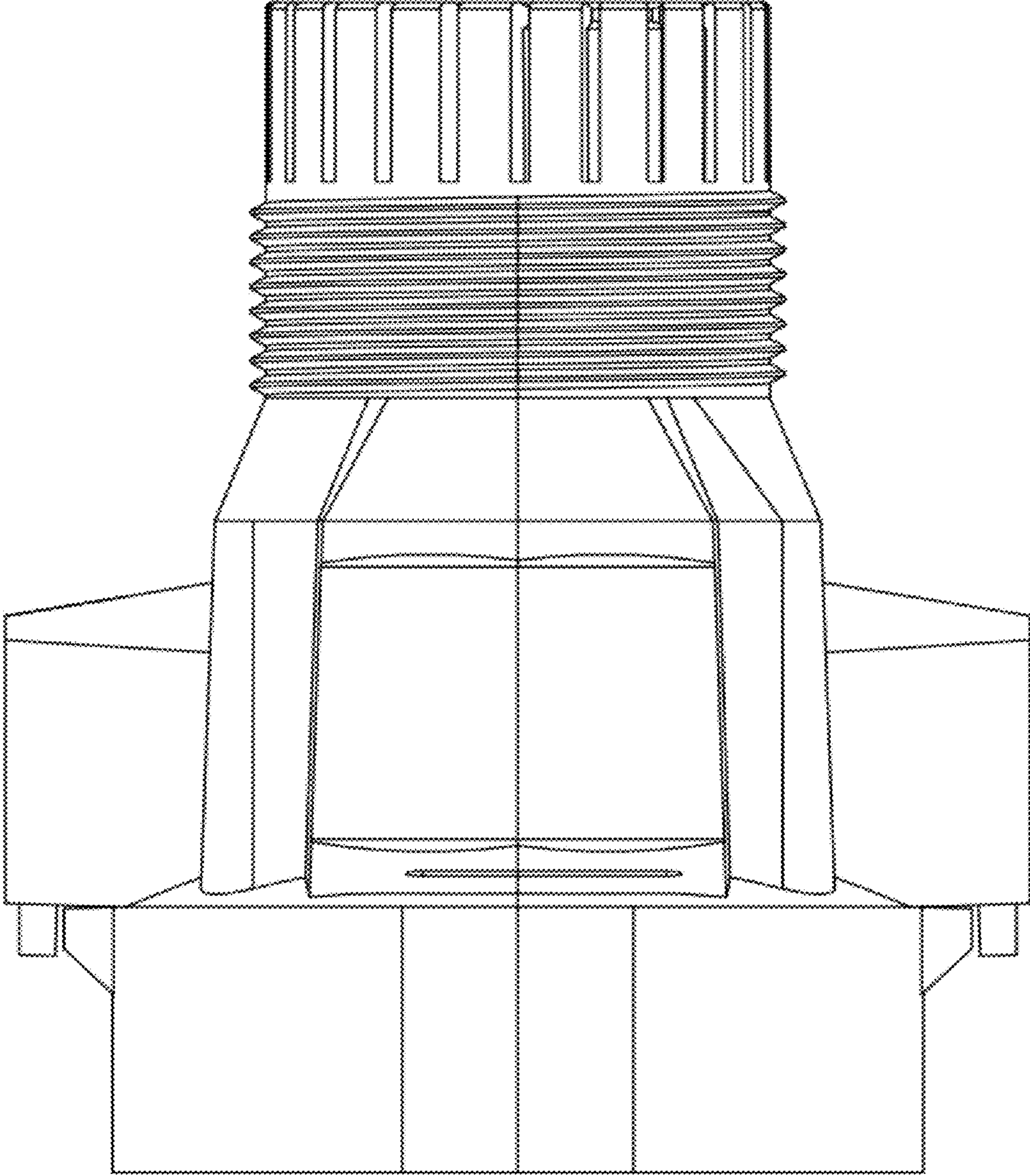

FIG. 1

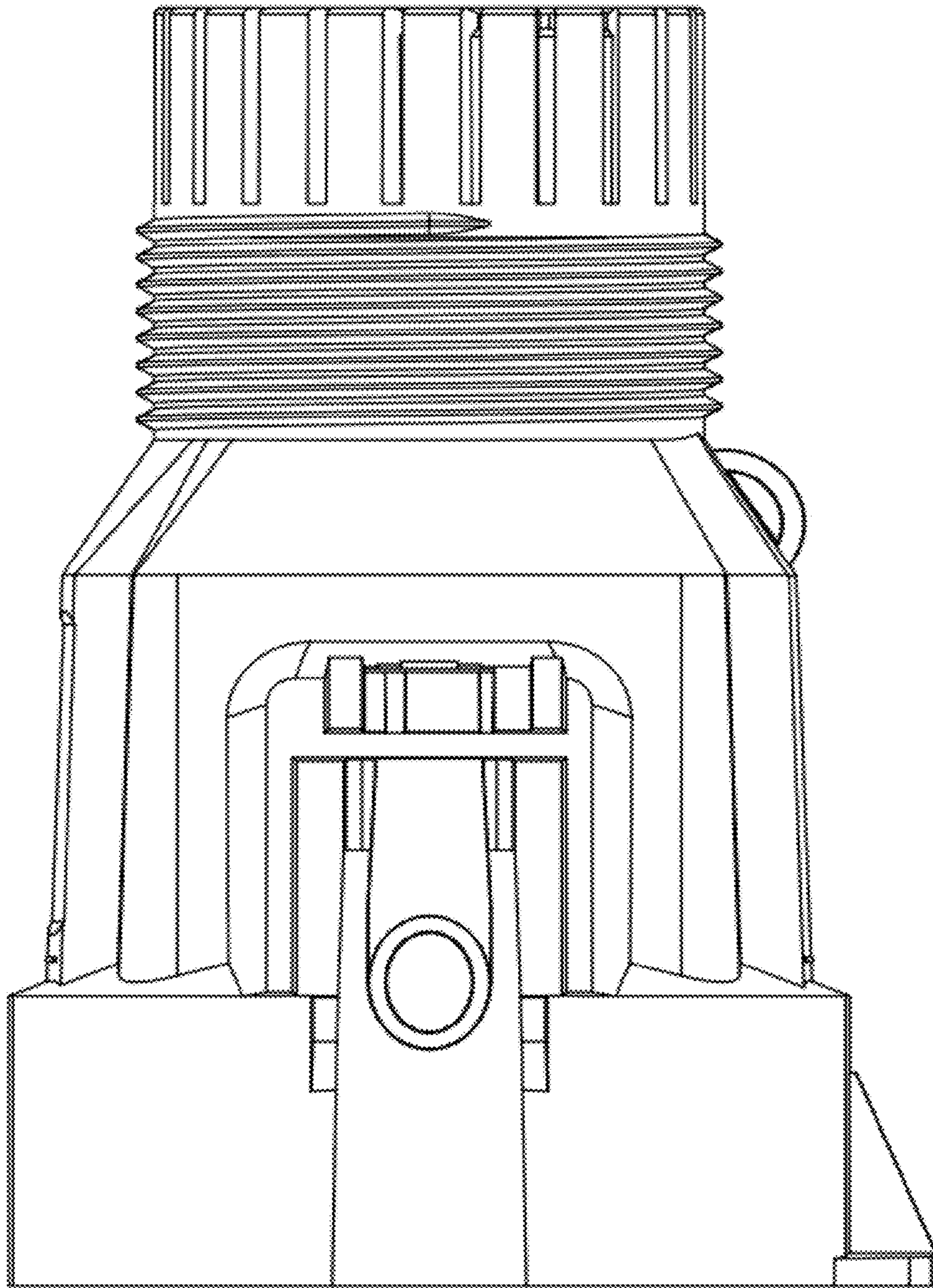

FIG. 2

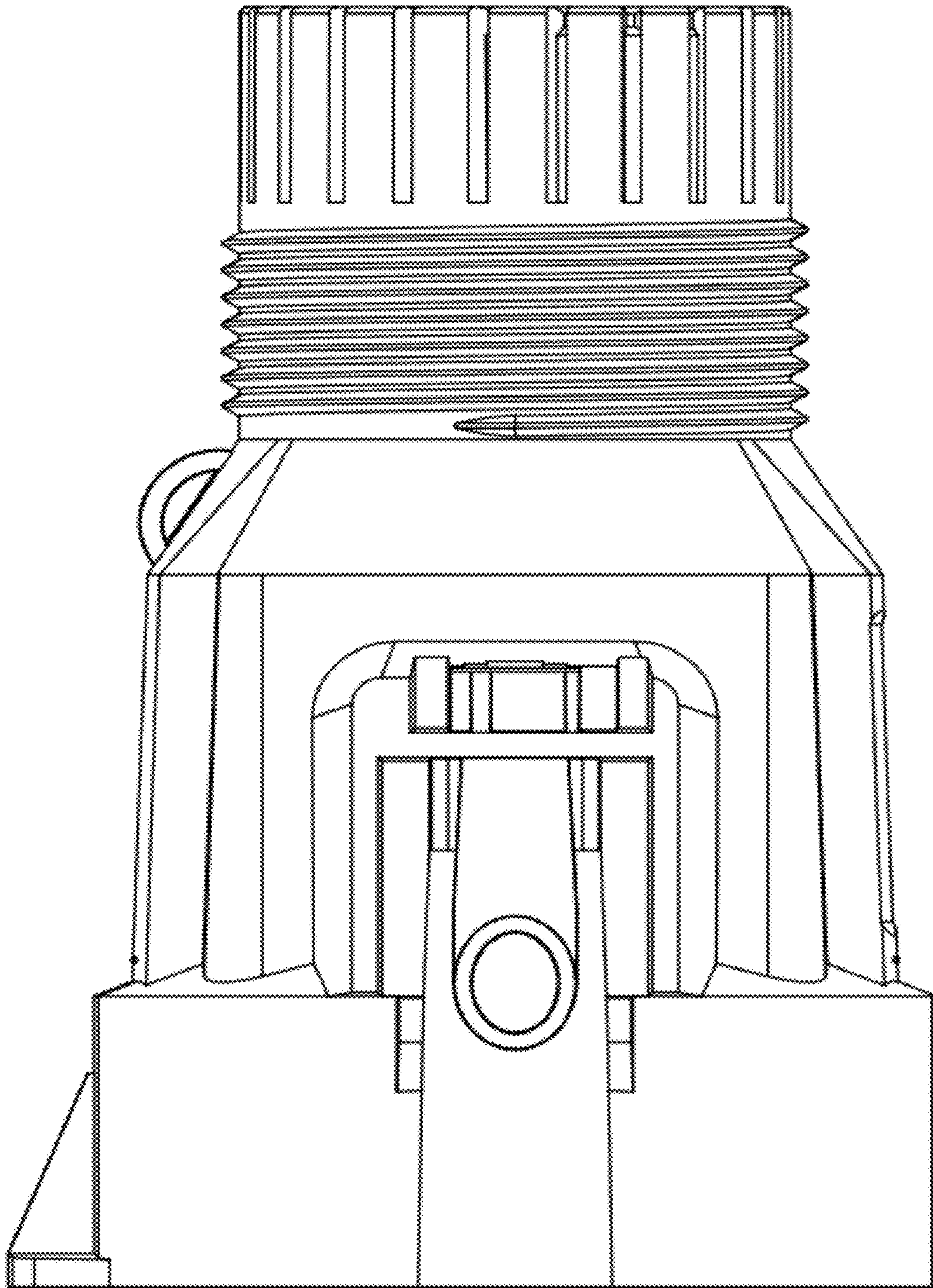

FIG. 3

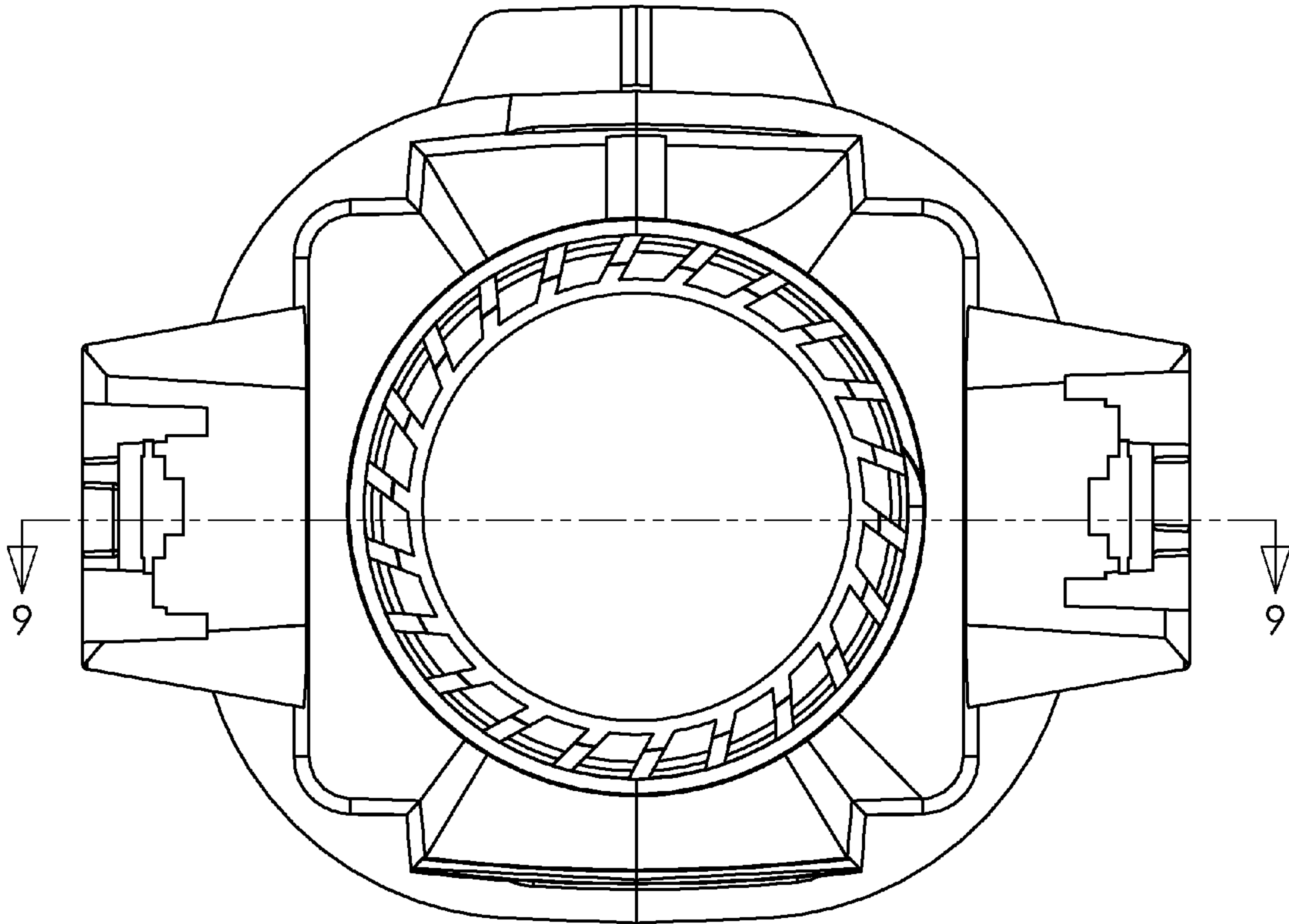

FIG. 4

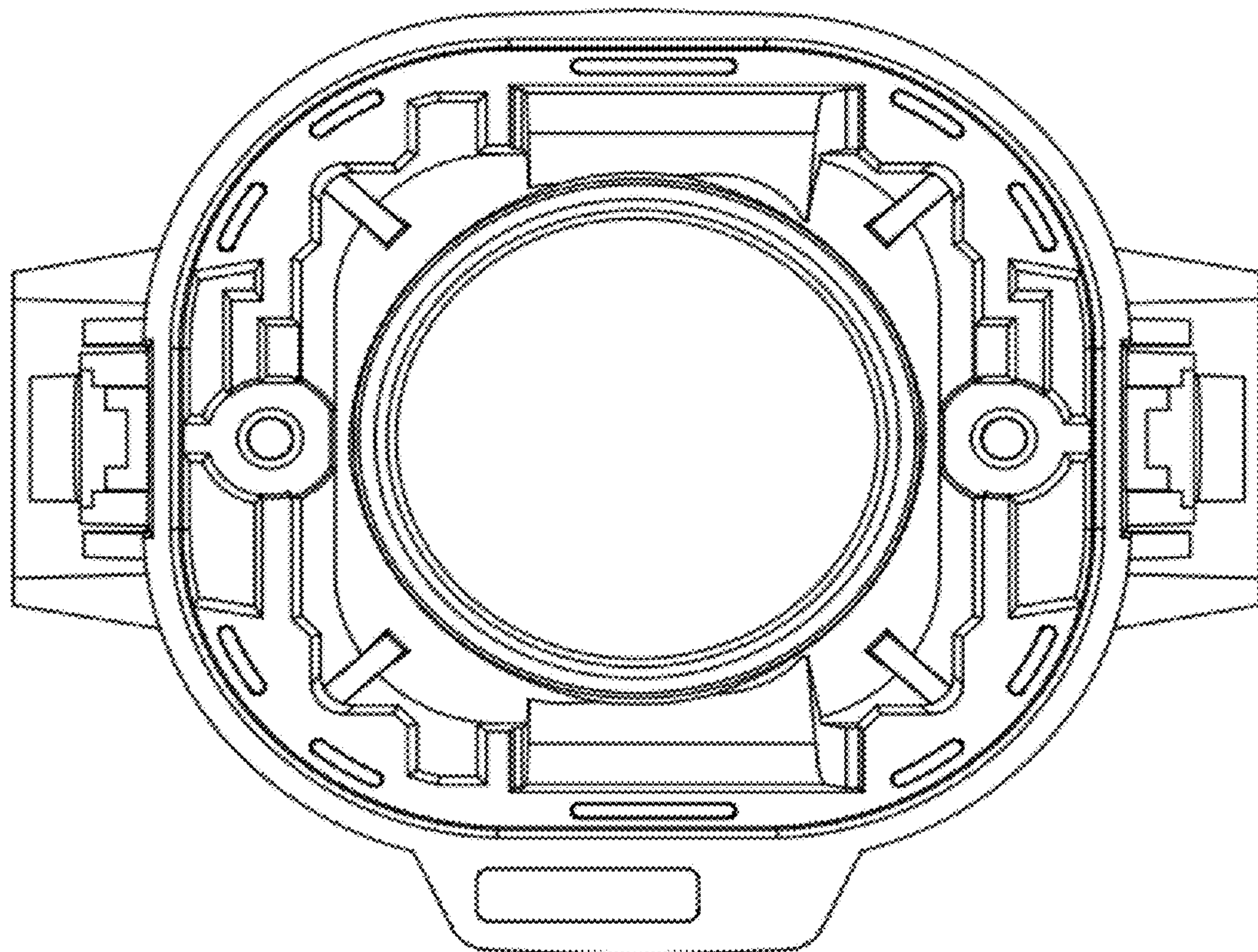

FIG. 5

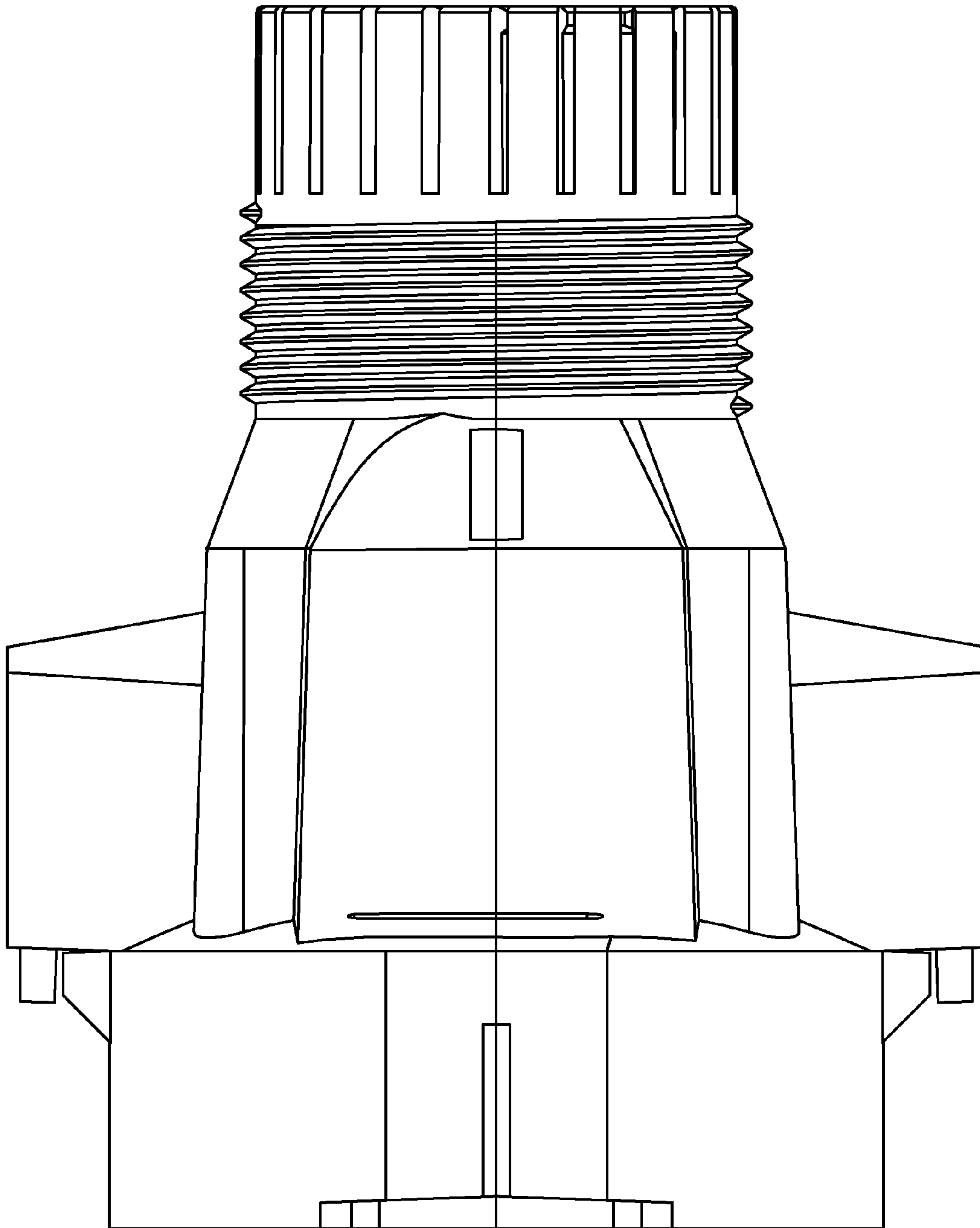

FIG. 6

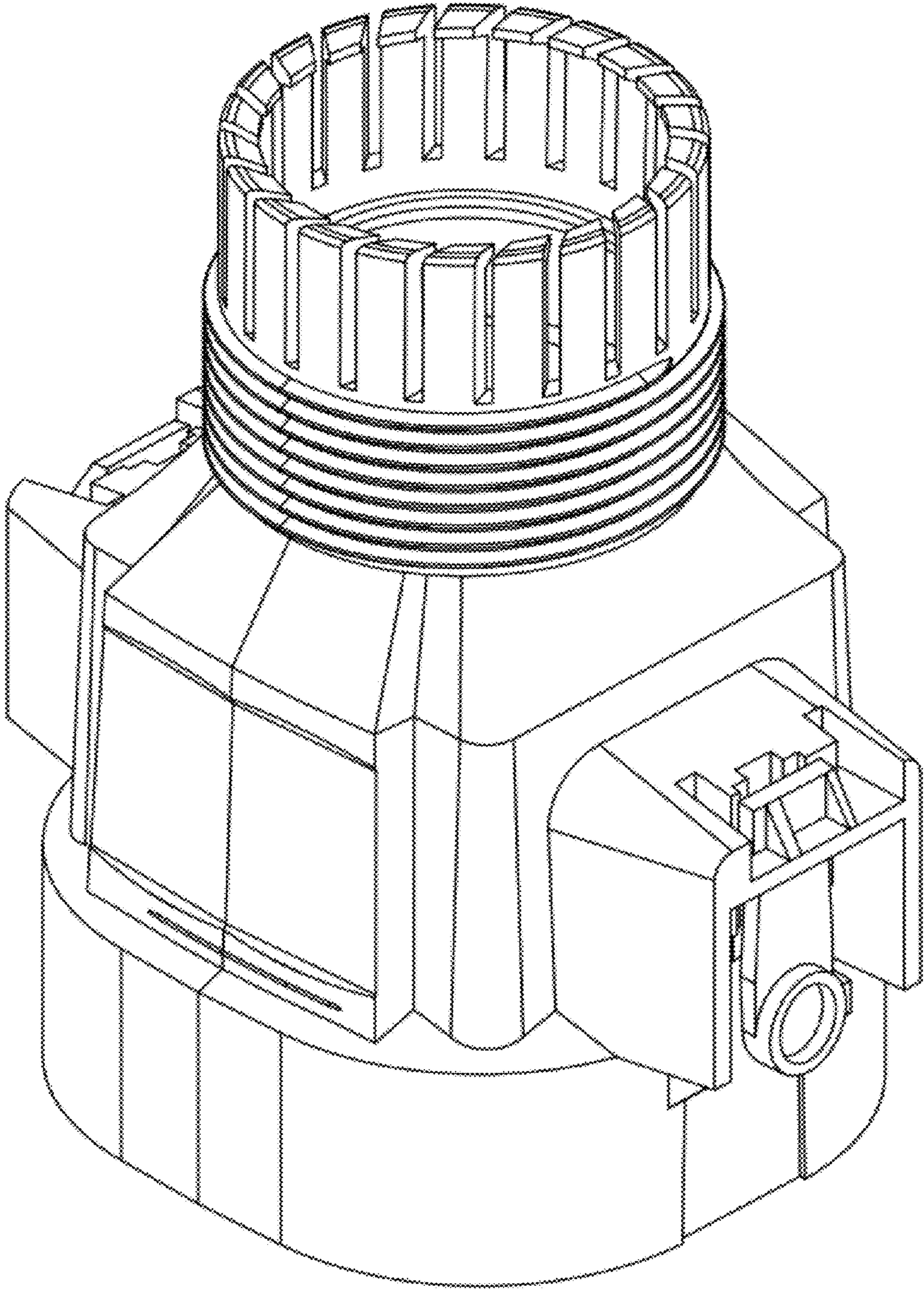

FIG. 7

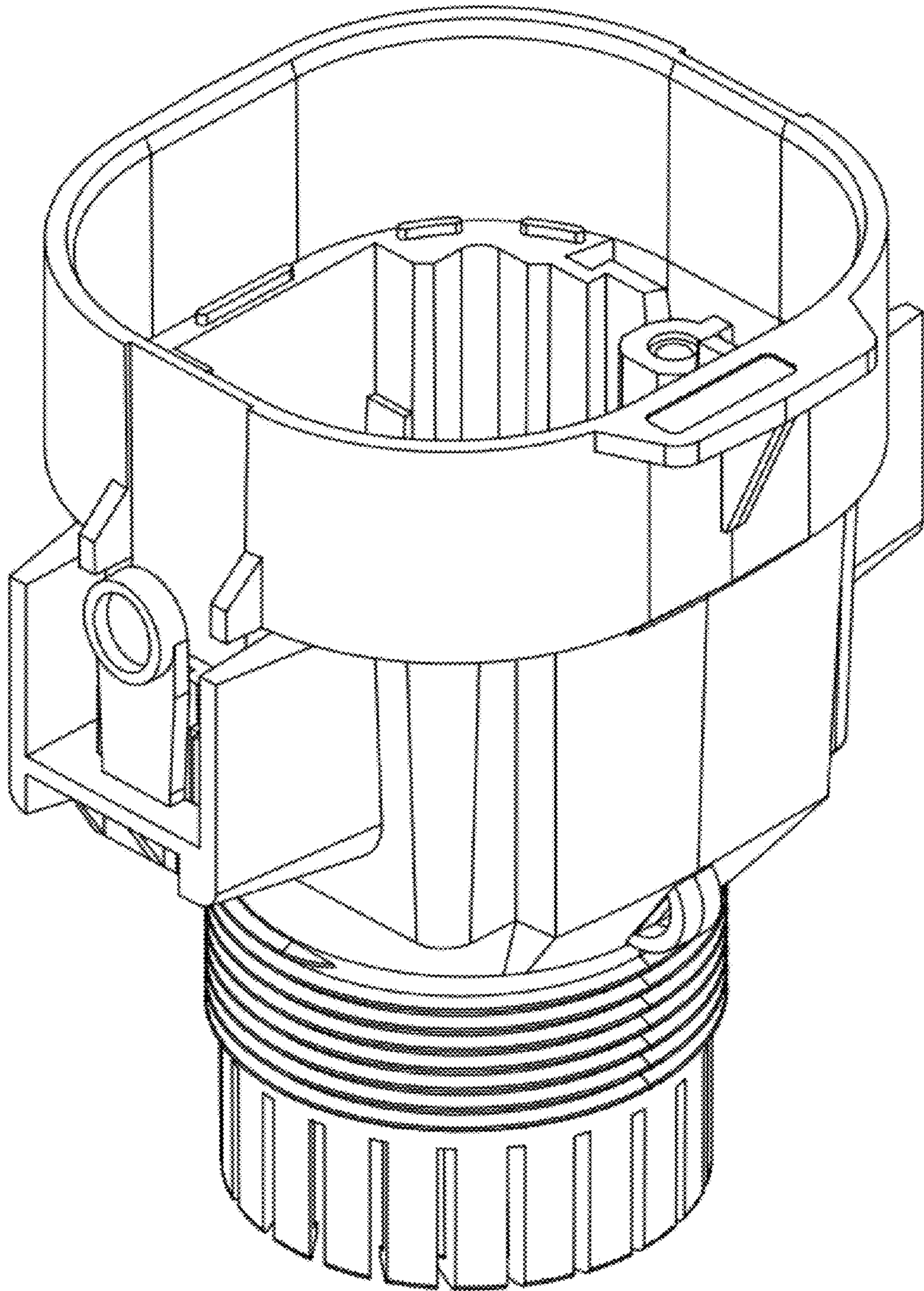

FIG. 8

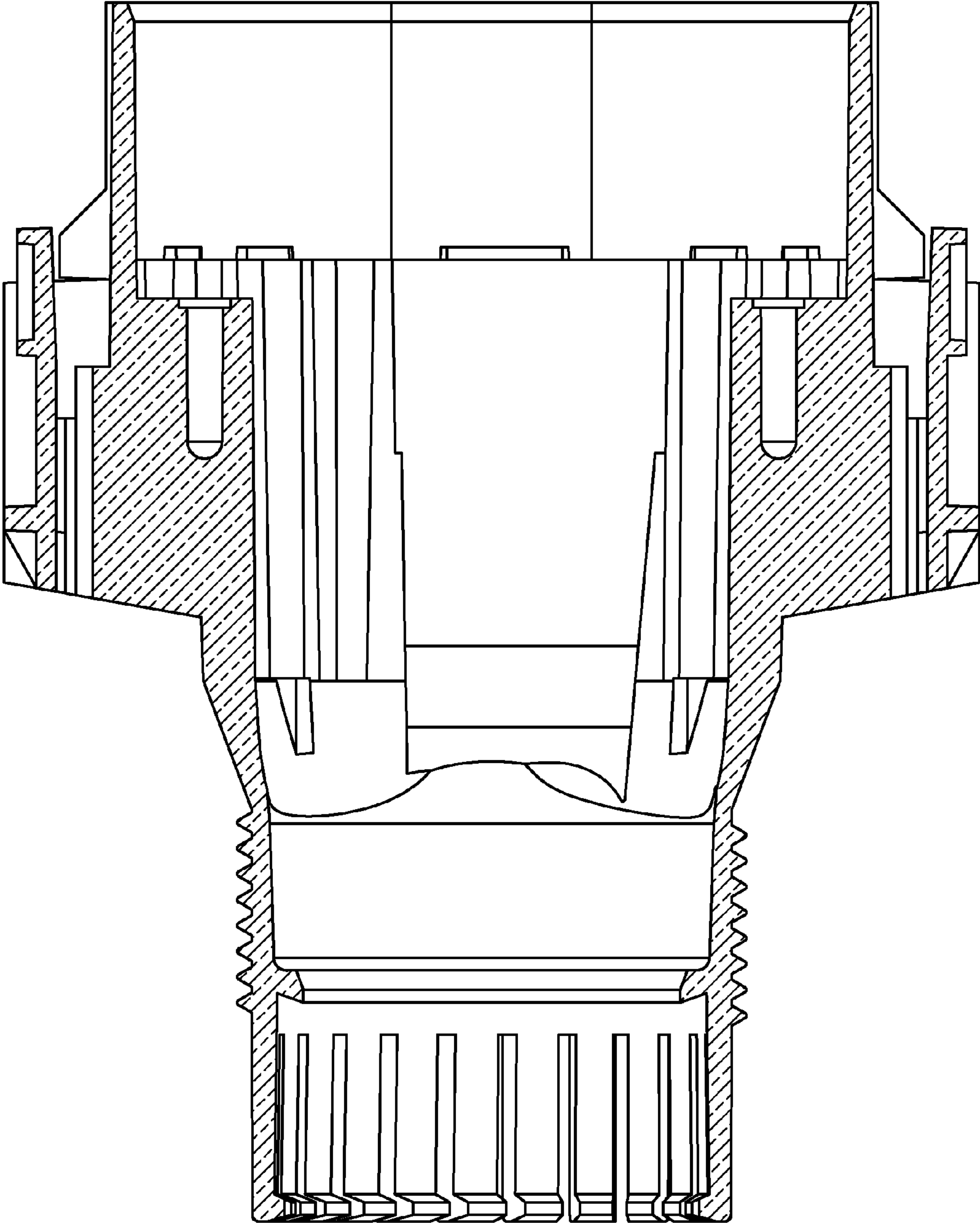

FIGURE 9