



US00D672606S

(12) **United States Design Patent**
Dietz et al.

(10) **Patent No.:** **US D672,606 S**
(45) **Date of Patent:** **** Dec. 18, 2012**

(54) **BLENDER JAR LID**
(75) Inventors: **Phillip Dietz**, Saint George, UT (US);
Steven L Cottam, Ivins, UT (US)
(73) Assignee: **Kitchen Resource LLC**, Salt Lake City,
UT (US)
(**) Term: **14 Years**

6,983,862	B2 *	1/2006	Nottingham et al.	222/109
D586,620	S *	2/2009	Sands	D7/507
7,988,005	B2 *	8/2011	Wagner	220/23.88
8,142,068	B2 *	3/2012	McGill	366/347
8,210,391	B2 *	7/2012	Luburic	220/635
2001/0036124	A1 *	11/2001	Rubenstein	366/205
2004/0042337	A1 *	3/2004	Yiu et al.	366/199
2004/0118847	A1 *	6/2004	Giraud	220/254.3
2005/0068847	A1 *	3/2005	Sands	366/205
2006/0261066	A1 *	11/2006	Boozer et al.	220/254.7

* cited by examiner

(21) Appl. No.: **29/415,481**

Primary Examiner — Ricky Pham

(22) Filed: **Mar. 11, 2012**

(74) *Attorney, Agent, or Firm* — Zachary D. Renstrom

(51) **LOC (9) Cl.** **07-02**

(52) **U.S. Cl.** **D7/412; D7/376; D7/378**

(58) **Field of Classification Search** D7/301–313,
D7/316–319, 356–357, 368, 372–386, 391–398,
D7/412–415, 507, 665, 679, 693; 99/326,
99/337, 348, 492, 508–512; 220/23.88, 254.3,
220/254.7, 635; 222/109; 241/30–37.5,
241/101.01–101.2, 166–169.1, 172, 285.1–285.3,
241/291, 292.1; 366/64–67, 98, 129, 142–144,
366/197–211, 241–254, 262, 279–292, 325.8,
366/325.92, 341–347; 416/75–77, 70 R,
416/163

See application file for complete search history.

(56) **References Cited**

U.S. PATENT DOCUMENTS

D327,812	S *	7/1992	Thomas et al.	D7/413
6,629,492	B1 *	10/2003	Li	99/337
D500,633	S *	1/2005	Sands	D7/396.2

(57) **CLAIM**

The ornamental design for a blender jar lid, as shown and described.

DESCRIPTION

FIG. 1 is an enlarged bottom perspective view of a blender jar lid of our new design;
FIG. 2 is an enlarged top perspective view thereof;
FIG. 3 is a bottom perspective view thereof;
FIG. 4 is a top perspective view thereof;
FIG. 5 is a side elevational view thereof;
FIG. 6 is an enlarged cross-sectional view taken along the line 6-6 of FIG. 5; and,
FIG. 7 is an enlarged exploded bottom perspective view thereof.

The broken lines shown in the drawings are for illustrative purposes only and form no part of the claimed design.

1 Claim, 5 Drawing Sheets

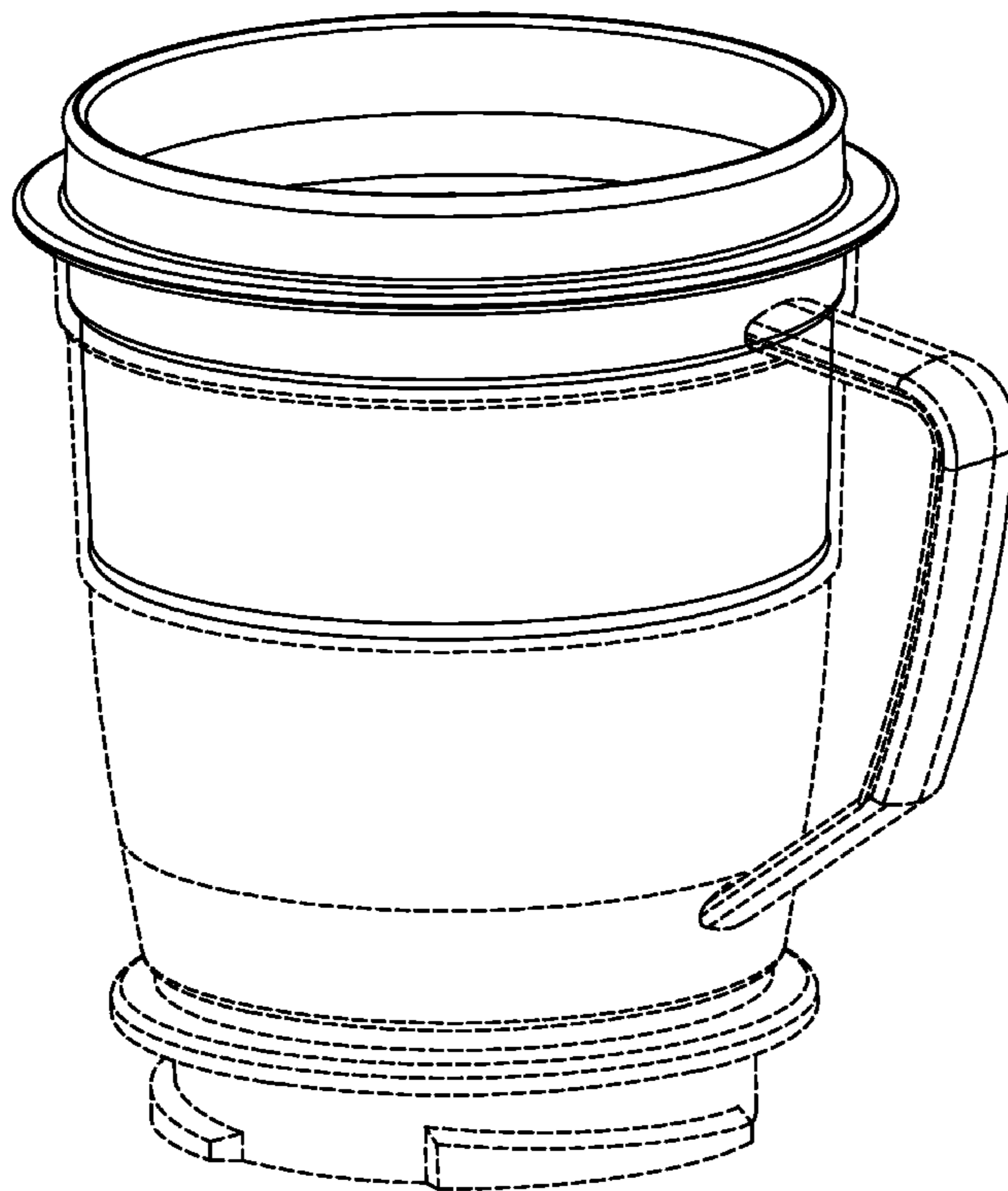

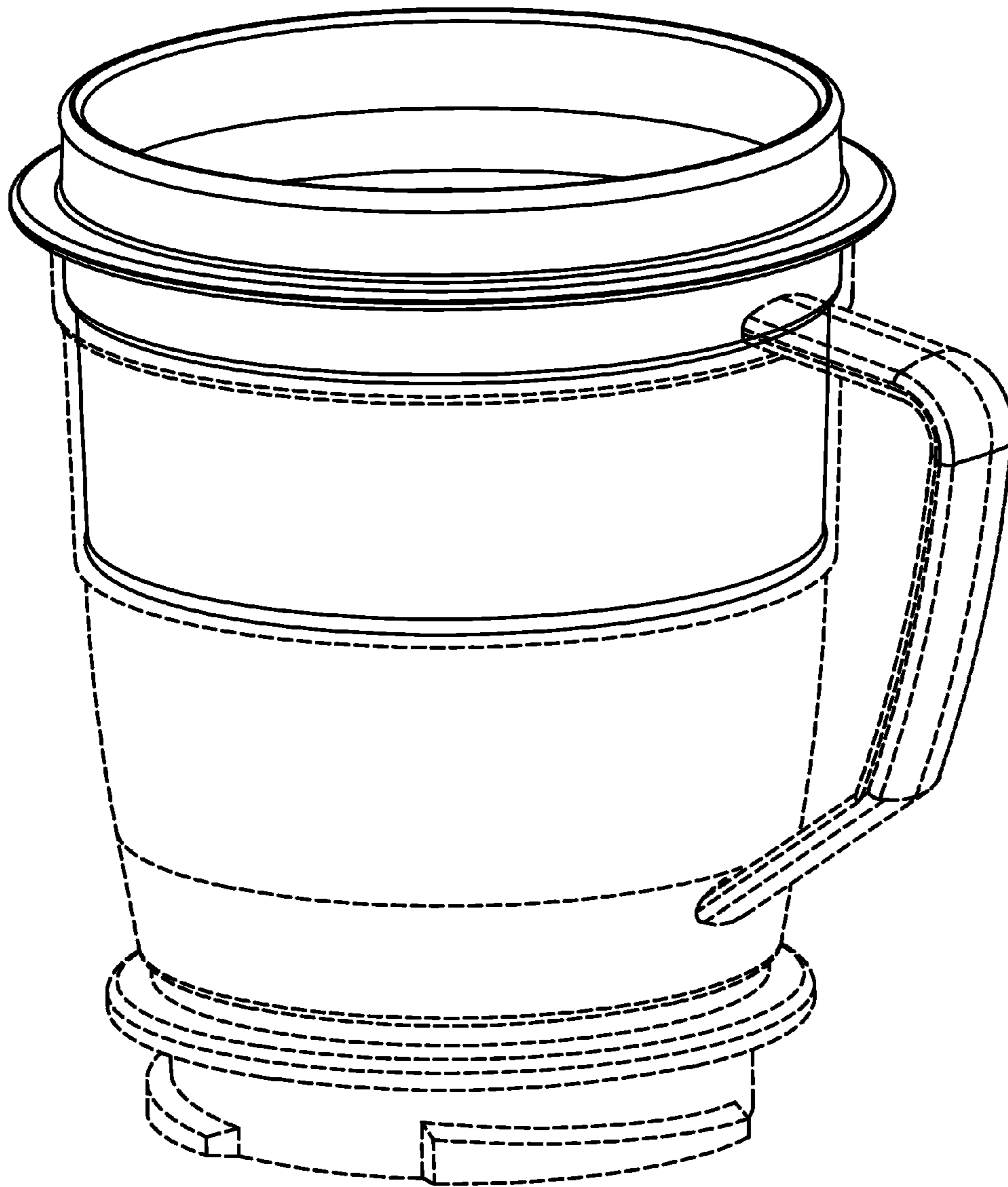

FIG. 1

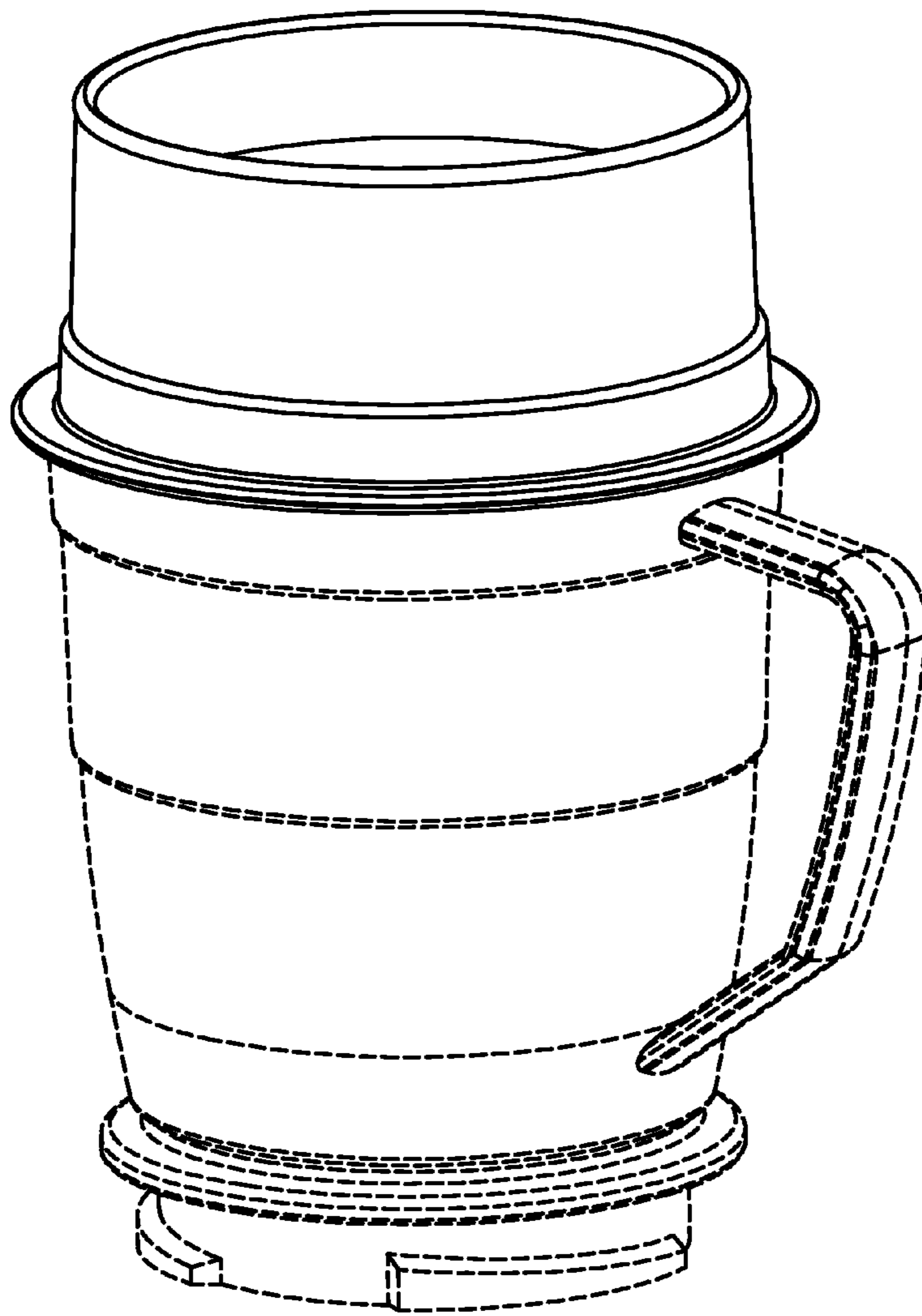

FIG. 2

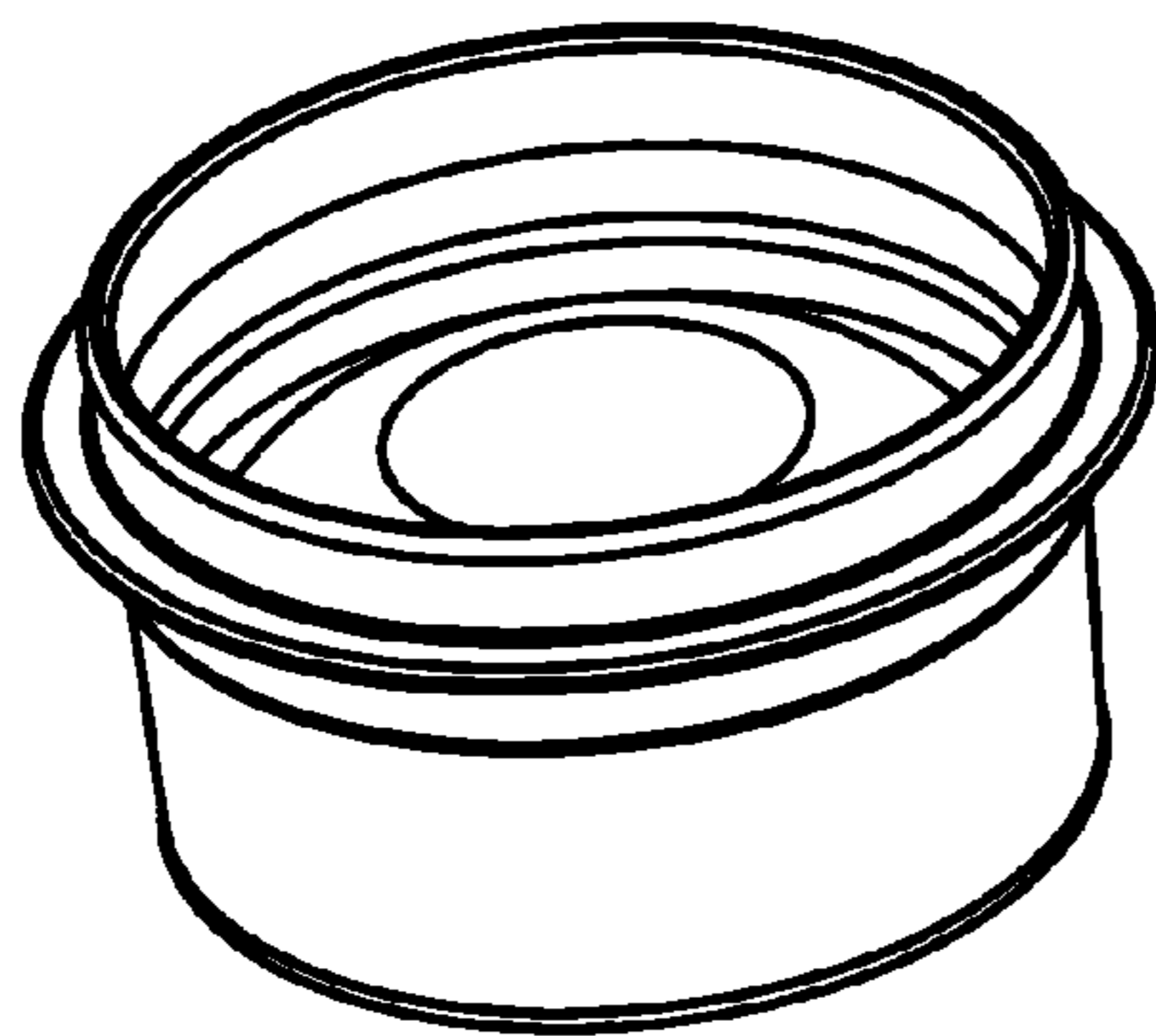

FIG. 3

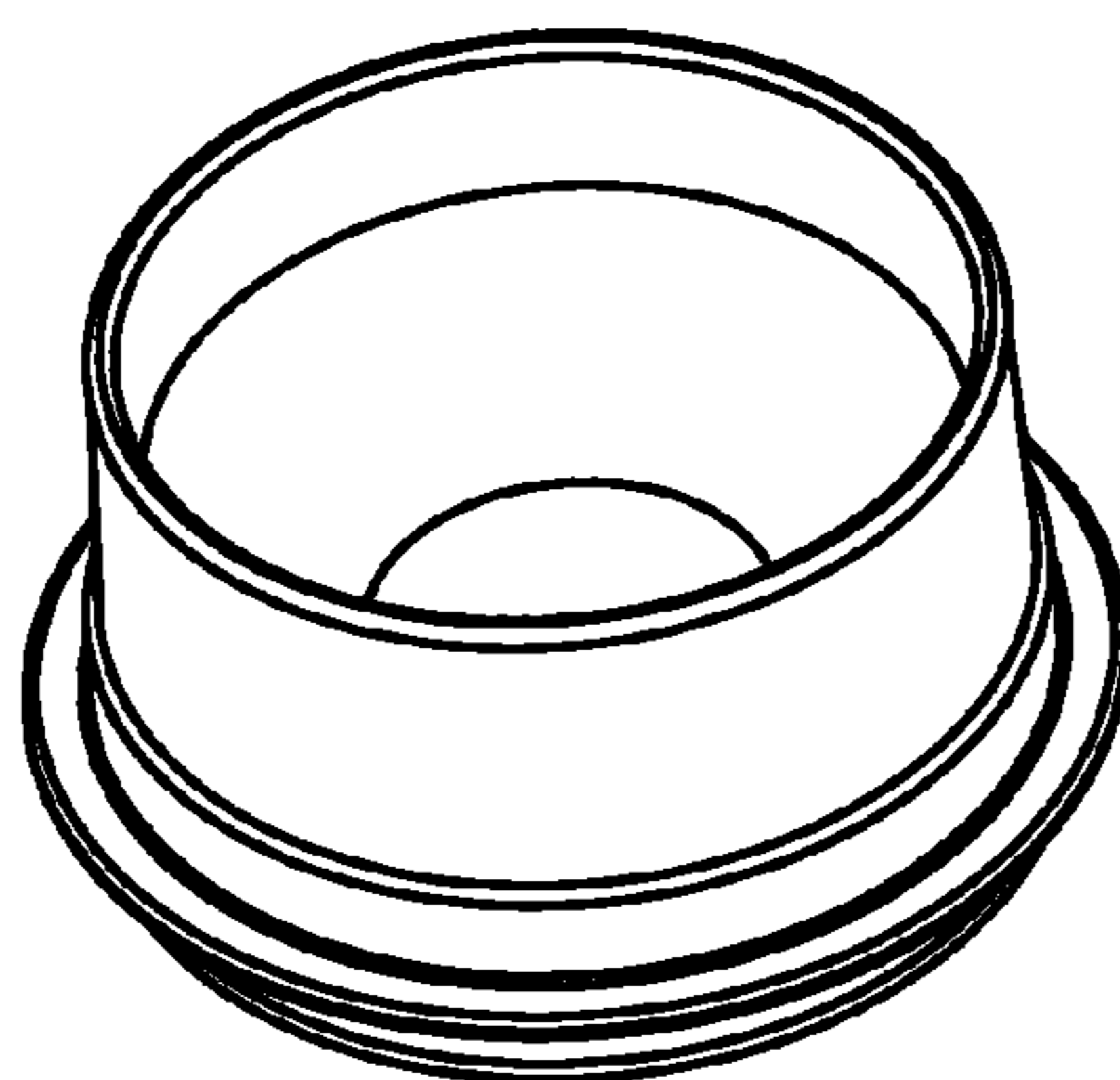

FIG. 4

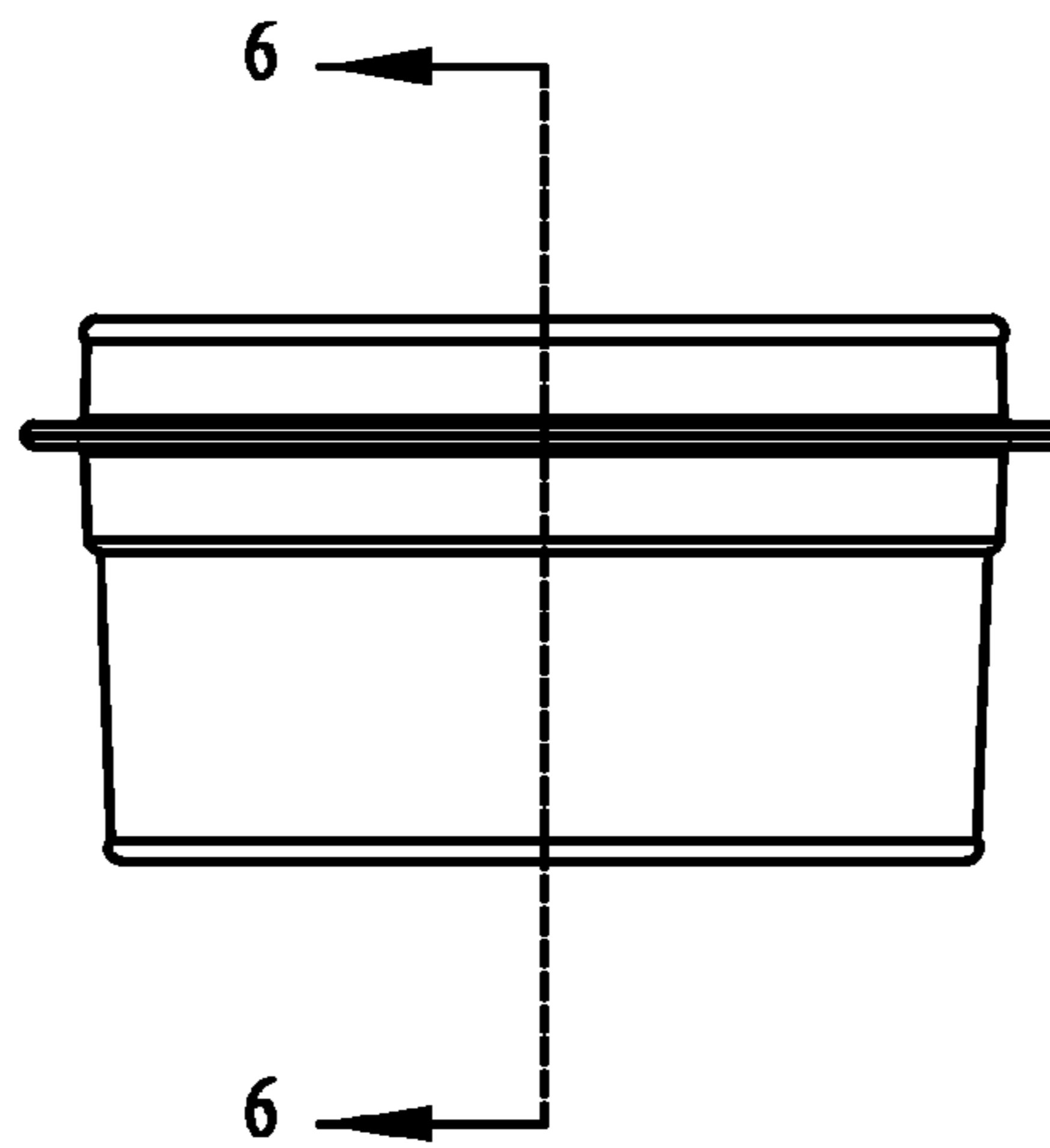

FIG. 5

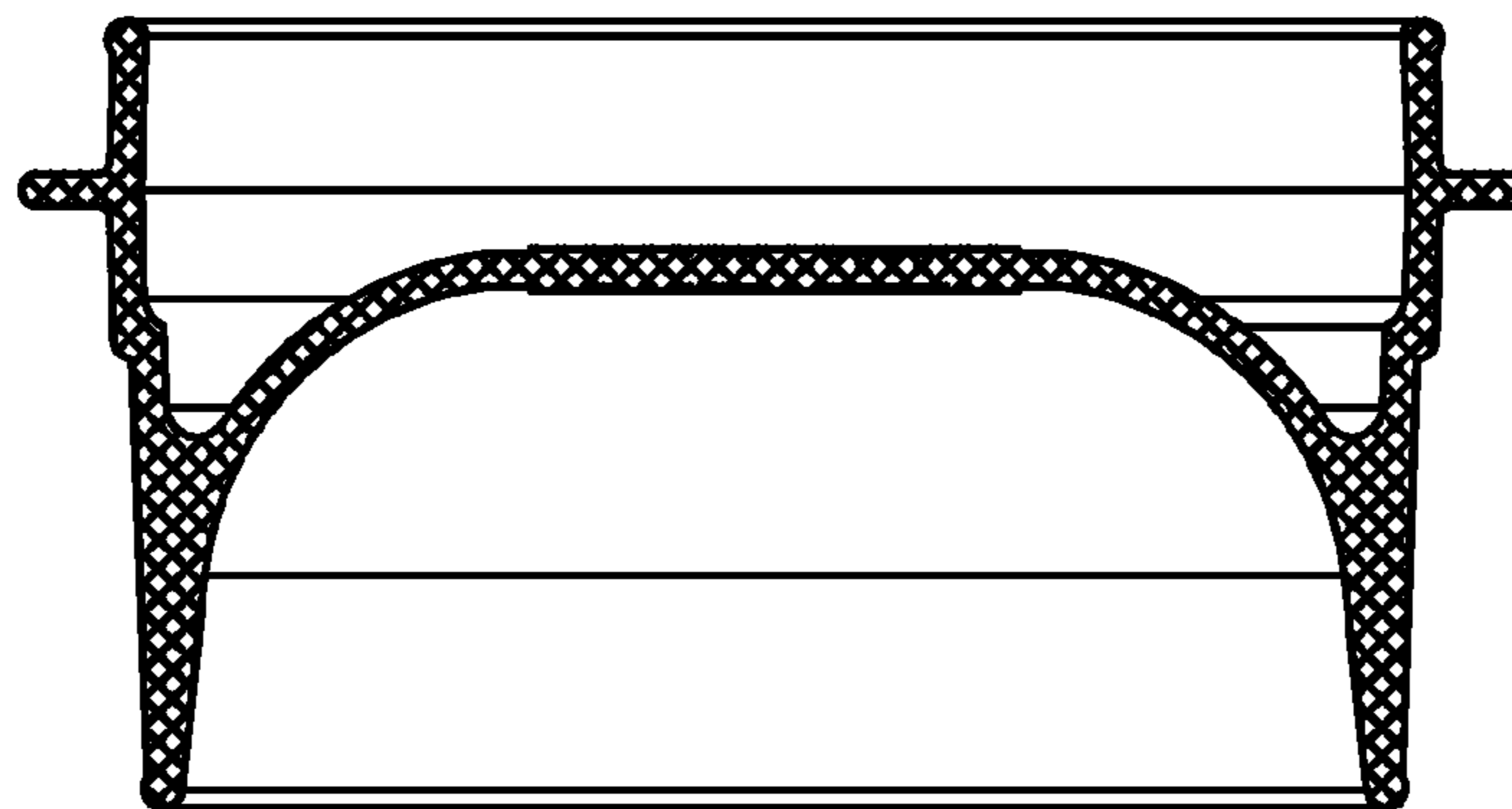

FIG. 6

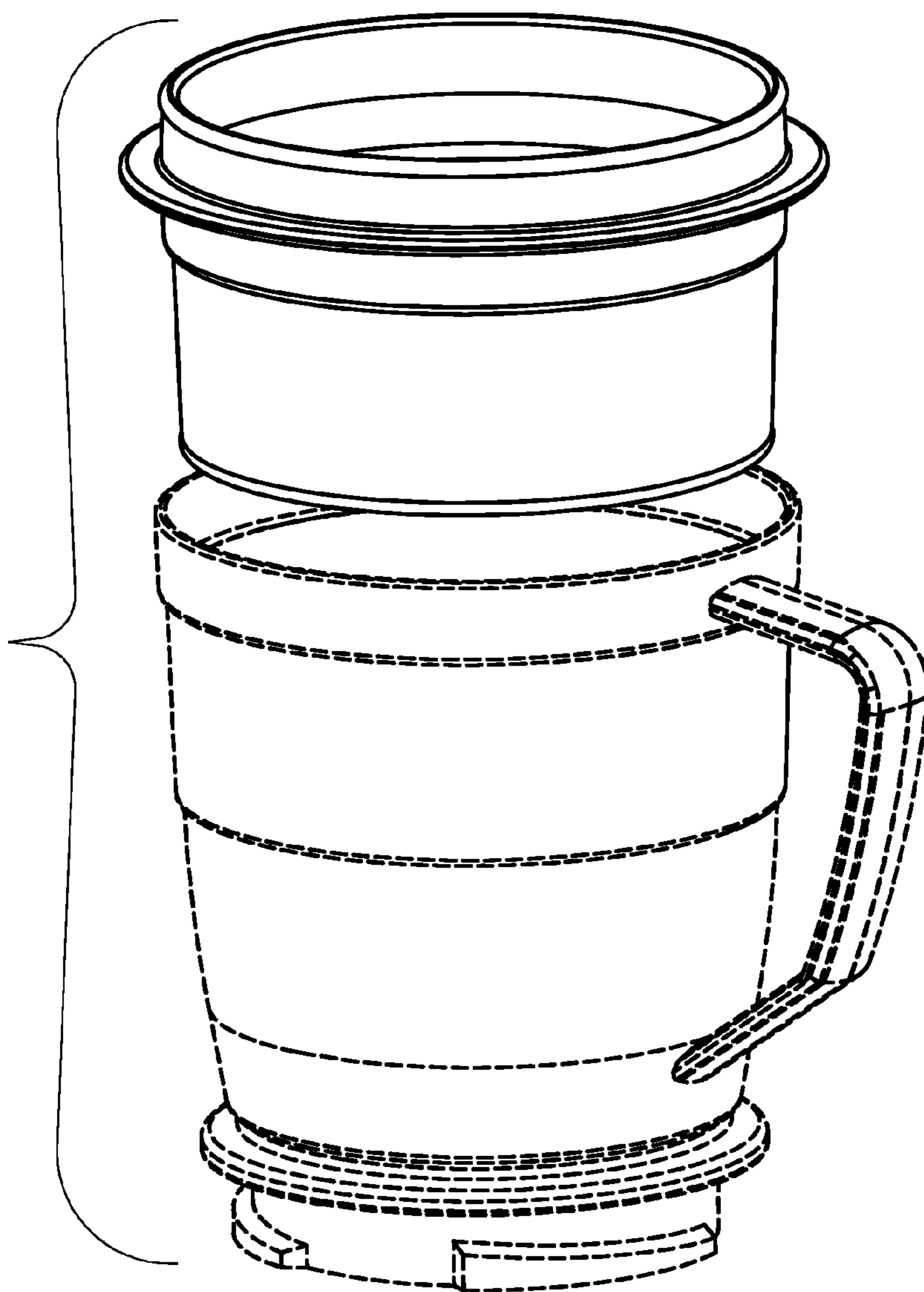

FIG. 7