



US00D671872S

(12) **United States Design Patent**  
**Tago et al.**

(10) **Patent No.:** **US D671,872 S**  
(45) **Date of Patent:** **\*\* Dec. 4, 2012**

(54) **FRONT DOOR TRIM PANEL FOR  
AUTOMOBILE**

(75) Inventors: **Hideki Tago**, Kanagawa (JP); **Tomihisa Igarashi**, Kanagawa (JP); **Sadao Ooki**, Kanagawa (JP)

(73) Assignee: **Nissan Motor Co., Ltd.**, Yokohama (JP)

(\*\*) Term: **14 Years**

(21) Appl. No.: **29/407,543**

(22) Filed: **Nov. 30, 2011**

(30) **Foreign Application Priority Data**

Jul. 13, 2011 (JP) ..... 2011-016031

(51) **LOC (9) Cl.** ..... **12-08**

(52) **U.S. Cl.** ..... **D12/195**

(58) **Field of Classification Search** ..... D12/195,  
D12/193, 414, 190, 196; 180/190; 280/750-752;  
296/190.01-191, 70, 193.08, 145, 153, 37.1-37.13,  
296/149, 146.1; D15/17, 28; D10/46, 98,  
D10/102-103; 49/501-502; D8/302-303

See application file for complete search history.

(56) **References Cited**

**U.S. PATENT DOCUMENTS**

D382,528 S \* 8/1997 Hellhake et al. .... D12/195  
(Continued)

**FOREIGN PATENT DOCUMENTS**

JP D1310787 S 9/2007  
(Continued)

**OTHER PUBLICATIONS**

[http://www.netcarshow.com/infiniti/2011-m35h/1024x768/wallpaper\\_2a.htm](http://www.netcarshow.com/infiniti/2011-m35h/1024x768/wallpaper_2a.htm).

*Primary Examiner* — Katrina A Betton

(74) *Attorney, Agent, or Firm* — Global IP Counselors, LLP

(57) **CLAIM**

The ornamental design for a front door trim panel for an automobile, as shown and described.

**DESCRIPTION**

FIG. 1 is a front elevational view of a front door trim panel for an automobile in accordance with our new design;

FIG. 2 is a top plan view of the front door trim panel in accordance with our new design of FIG. 1;

FIG. 3 is a bottom plan view of the front door trim panel in accordance with our new design of FIGS. 1 to 2;

FIG. 4 is a left side elevational view of the front door trim panel in accordance with our new design of FIGS. 1 to 3;

FIG. 5 is a right side elevational view of the front door trim panel in accordance with our new design of FIGS. 1 to 4;

FIG. 6 is a front, left and bottom side perspective view of the front door trim panel in accordance with our new design of FIGS. 1 to 5;

FIG. 7 is a front, right and top side perspective view of the front door trim panel in accordance with our new design of FIGS. 1 to 5; and,

FIG. 8 is a cross sectional view of the front door trim panel in accordance with our new design as seen along section line 8-8' of FIG. 1.

The rear view of the front door trim panel forms no part of the claimed design.

The cross sectional view of FIG. 8 is provided to clarify the exact contour or configuration of the exterior surface of the front door trim panel, and no attempt is made to illustrate features of internal construction.

**1 Claim, 8 Drawing Sheets**

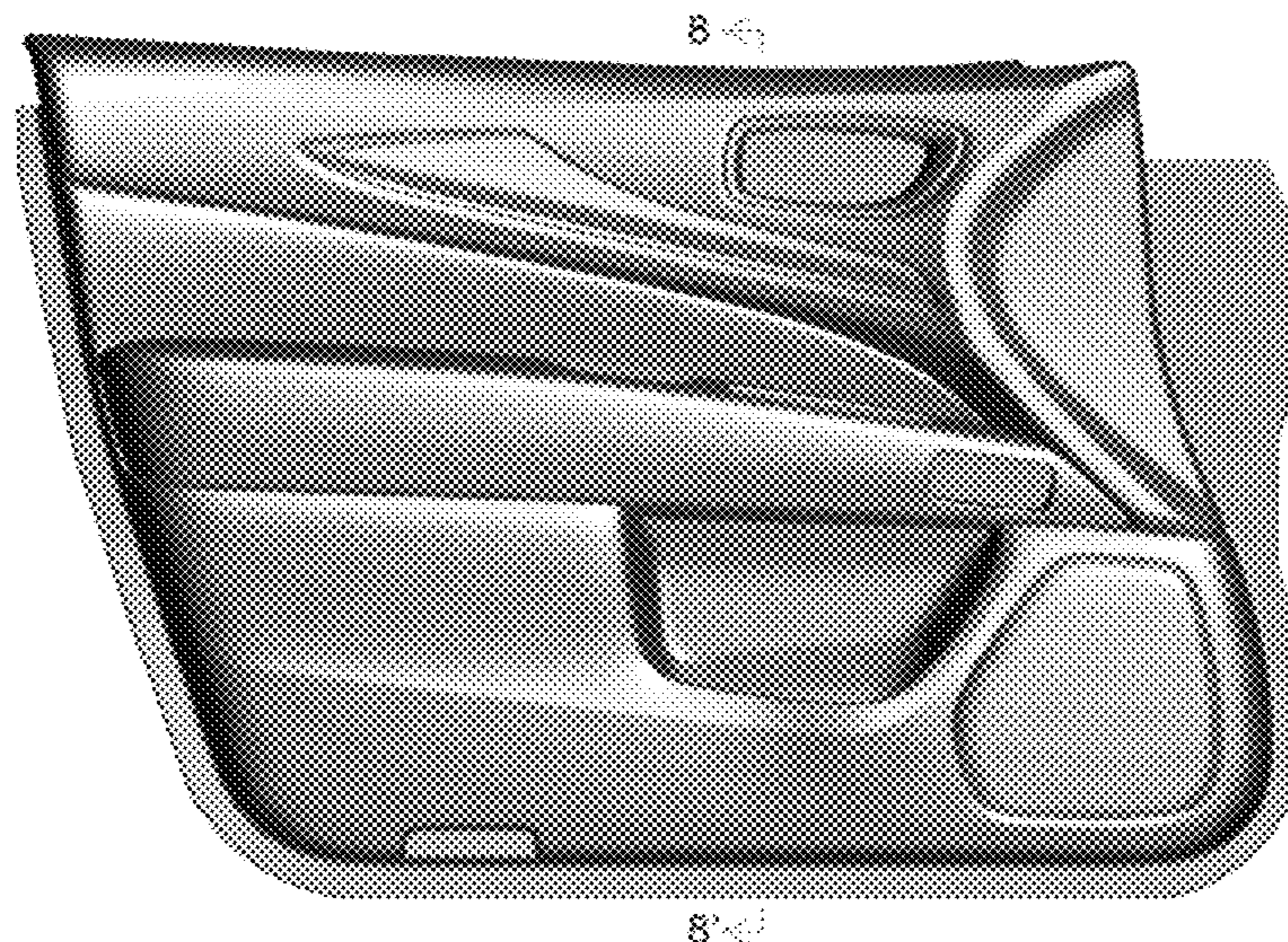

# US D671,872 S

Page 2

---

## U.S. PATENT DOCUMENTS

D497,337 S \* 10/2004 Takagi et al. .... D12/195  
D519,896 S \* 5/2006 Sudo ..... D12/195  
D529,850 S \* 10/2006 Yu et al. .... D12/195  
D531,101 S \* 10/2006 Yu et al. .... D12/195  
D533,821 S \* 12/2006 Tamagawa et al. .... D12/195  
D534,470 S \* 1/2007 Tsuchiya et al. .... D12/195  
D534,849 S \* 1/2007 Tamagawa et al. .... D12/195  
D536,650 S \* 2/2007 Young et al. .... D12/195  
D577,645 S \* 9/2008 Wyszogrod et al. .... D12/195

D577,646 S \* 9/2008 Wyszogrod et al. .... D12/195  
D607,802 S \* 1/2010 Collins et al. .... D12/195  
D615,017 S \* 5/2010 Smith ..... D12/195  
D616,348 S \* 5/2010 Rosenbohm ..... D12/195  
D633,022 S \* 2/2011 Hwang et al. .... D12/195  
D633,023 S \* 2/2011 Hwang et al. .... D12/195

## FOREIGN PATENT DOCUMENTS

JP D1341443 S 10/2008

\* cited by examiner

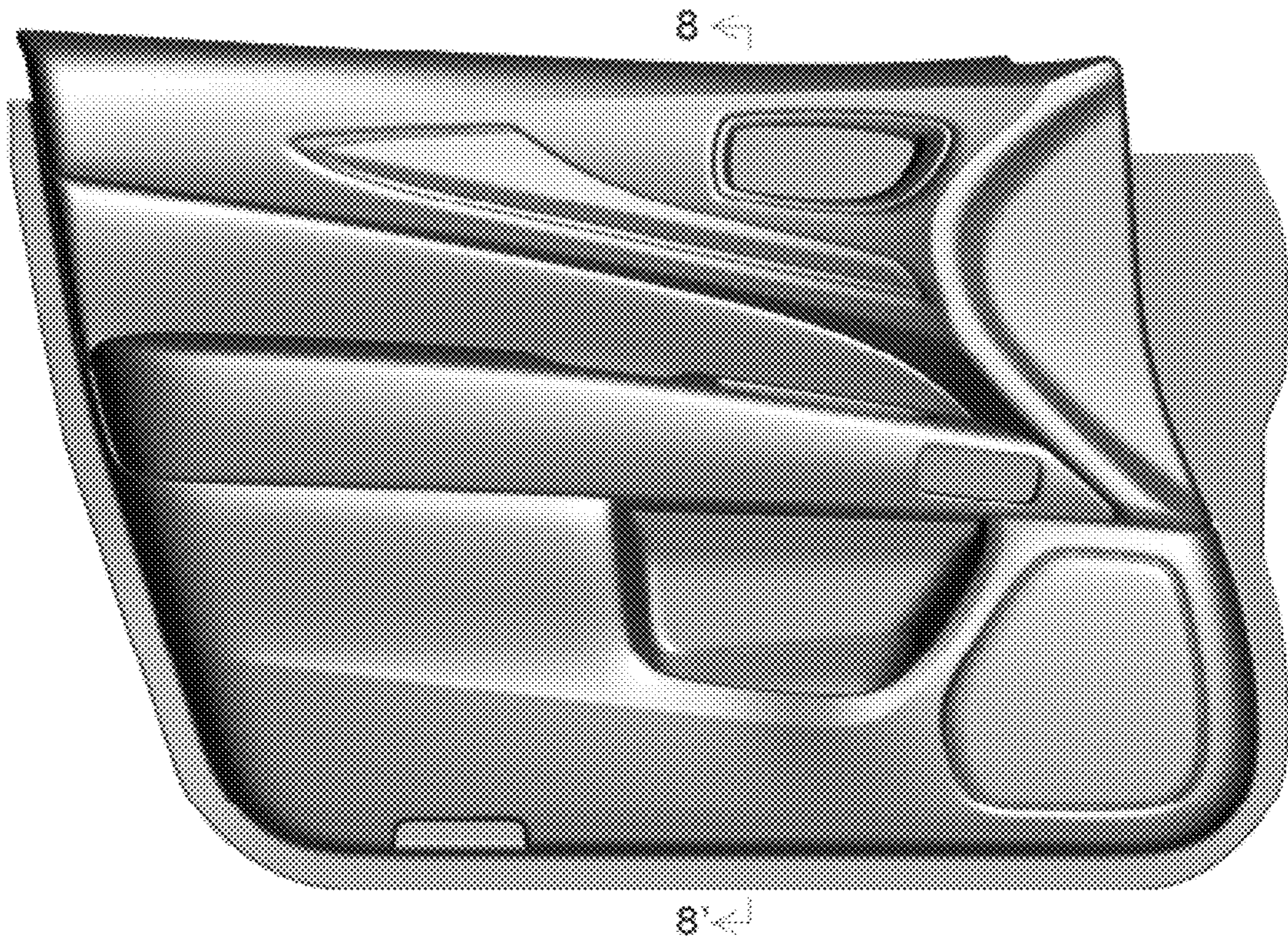

FIG. 1

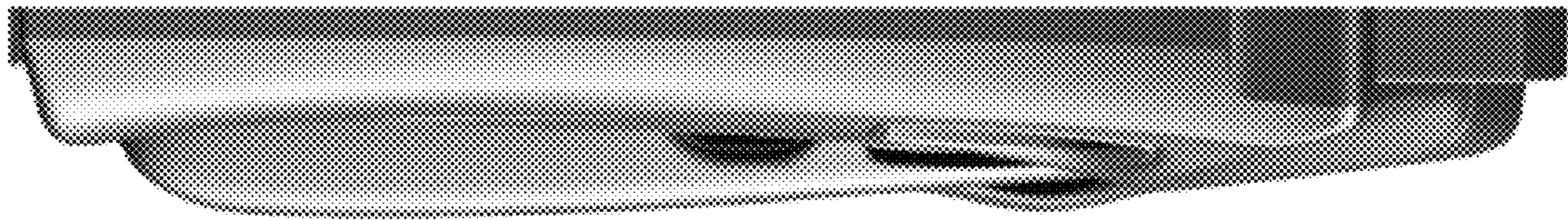

FIG. 2

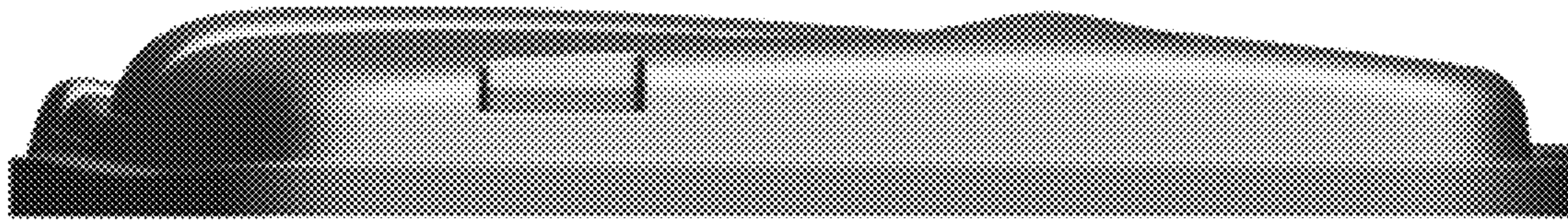

FIG. 3

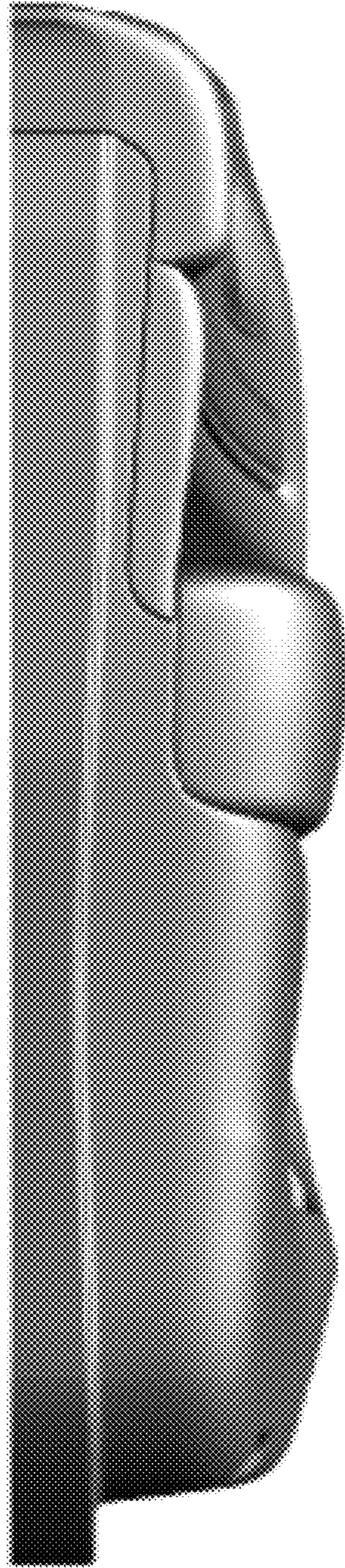

FIG. 4

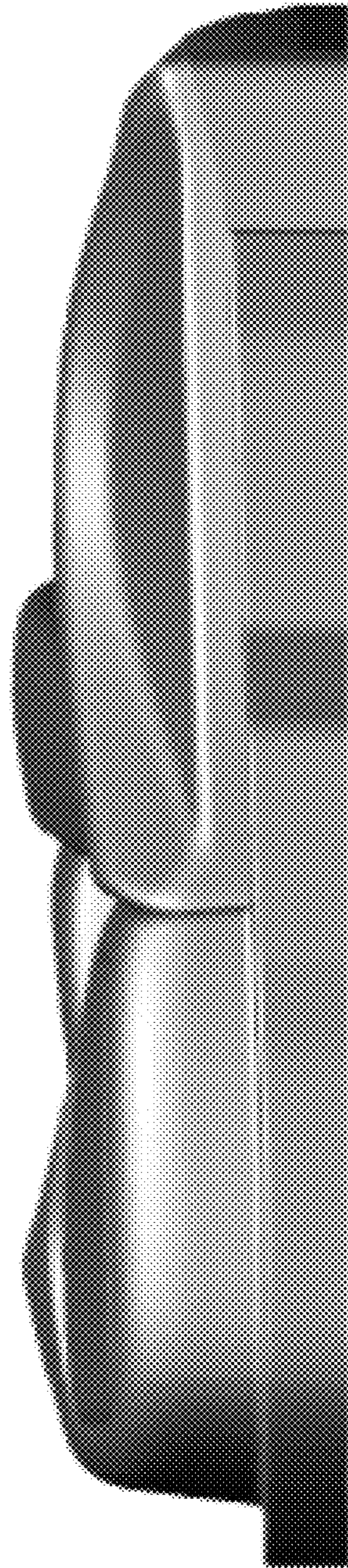

FIG. 5



FIG. 6



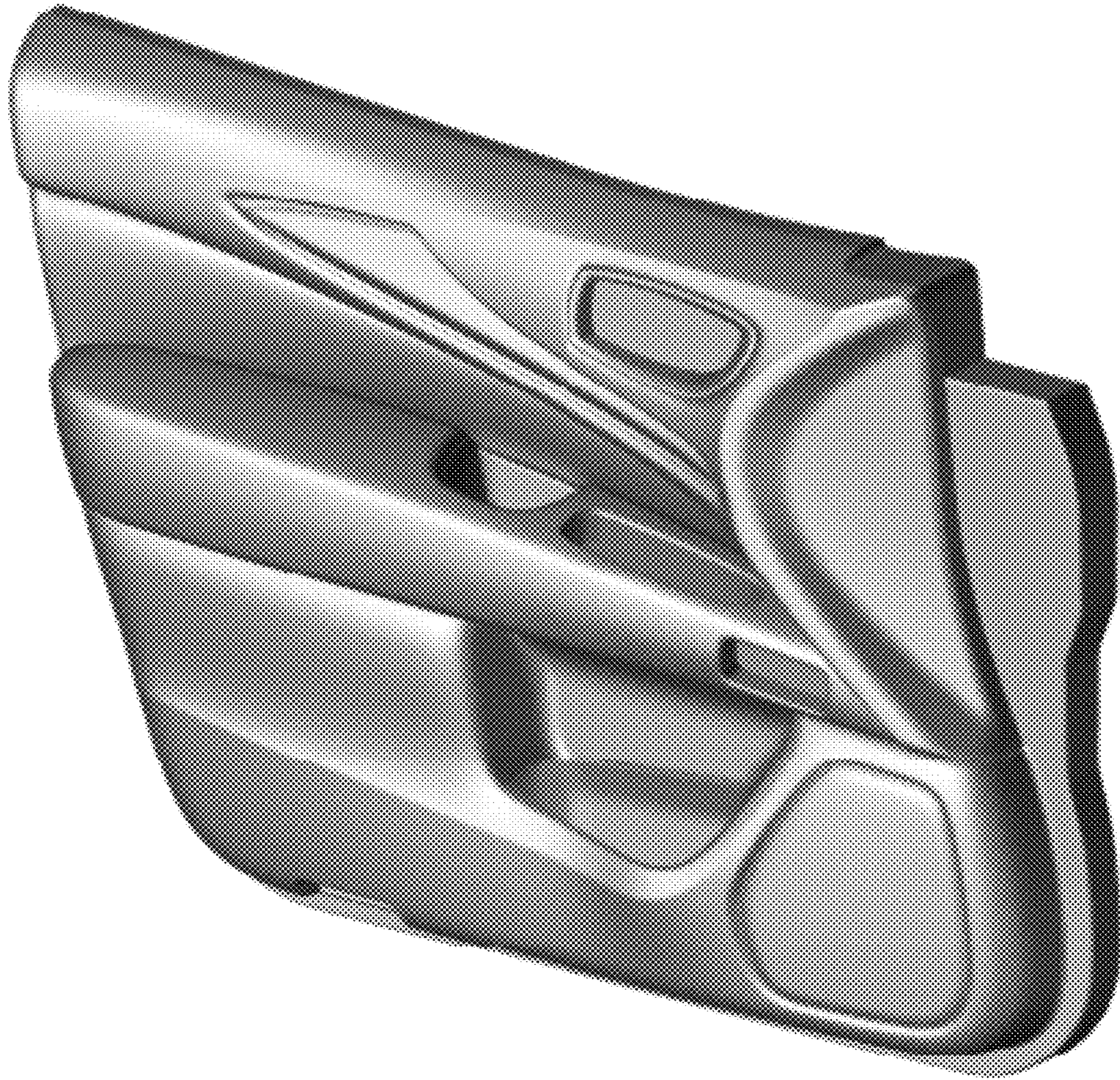

FIG. 7

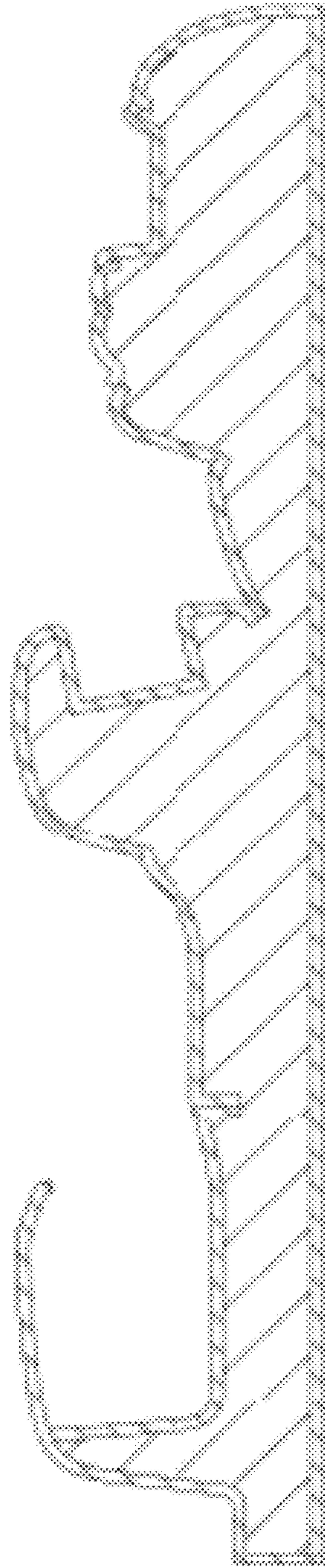

FIG. 8