

US00D671871S

(12) **United States Design Patent**
Ohkoshi

(10) **Patent No.:** **US D671,871 S**
(45) **Date of Patent:** **** Dec. 4, 2012**

(54) **FRONT FENDER FOR AUTOMOBILE**

(75) Inventor: **Naoyuki Ohkoshi**, Kawasaki (JP)

(73) Assignee: **Nissan Motor Co., Ltd.**, Yokohama (JP)

(**) Term: **14 Years**

(21) Appl. No.: **29/403,885**

(22) Filed: **Oct. 12, 2011**

(30) **Foreign Application Priority Data**

Apr. 13, 2011 (JP) 2011-008523

(51) **LOC (9) Cl.** **12-16**

(52) **U.S. Cl.** **D12/184**

(58) **Field of Classification Search** D12/184,
D12/196, 90-92; 280/152.1, 847-849, 851;
296/181.1, 181.5

See application file for complete search history.

(56) **References Cited**

U.S. PATENT DOCUMENTS

D507,514 S *	7/2005	Nagura et al.	D12/196
D561,667 S *	2/2008	Platto et al.	D12/184
D561,668 S *	2/2008	Suzuki et al.	D12/184
D572,182 S *	7/2008	Deane	D12/184
D598,346 S *	8/2009	Buduo	D12/184
D600,614 S *	9/2009	Lamm	D12/184
D603,773 S *	11/2009	Schiavone et al.	D12/184
D604,681 S *	11/2009	Nakamura	D12/184

D607,797 S *	1/2010	Walter et al.	D12/184
D615,012 S *	5/2010	Ectors et al.	D12/181
D630,985 S *	1/2011	Matei et al.	D12/181
D631,413 S *	1/2011	Kuze	D12/181
D659,616 S *	5/2012	Matsumoto et al.	D12/184
D660,214 S *	5/2012	Cartabiano et al.	D12/196

OTHER PUBLICATIONS

<http://www.netcarshow.com/infiniti/2009-fx37/1024x768/wallpaper05.htm>.

<http://www.netcarshow.com/infiniti/2009-fx37/1024x768/wallpaper07.htm>.

* cited by examiner

Primary Examiner — Melody N Brown

(74) *Attorney, Agent, or Firm* — Global IP Counselors, LLP

(57) **CLAIM**

The ornamental design for a front fender for an automobile, as shown and described.

DESCRIPTION

FIG. 1 is a front elevational view of a front bumper for an automobile showing my new design;

FIG. 2 is a rear elevational view thereof;

FIG. 3 is a top plan view thereof;

FIG. 4 is a bottom plan view thereof;

FIG. 5 is a right side elevational view thereof;

FIG. 6 is a left side elevational view thereof;

FIG. 7 is a left, front perspective view thereof; and,

FIG. 8 is a right, front perspective view thereof.

1 Claim, 8 Drawing Sheets

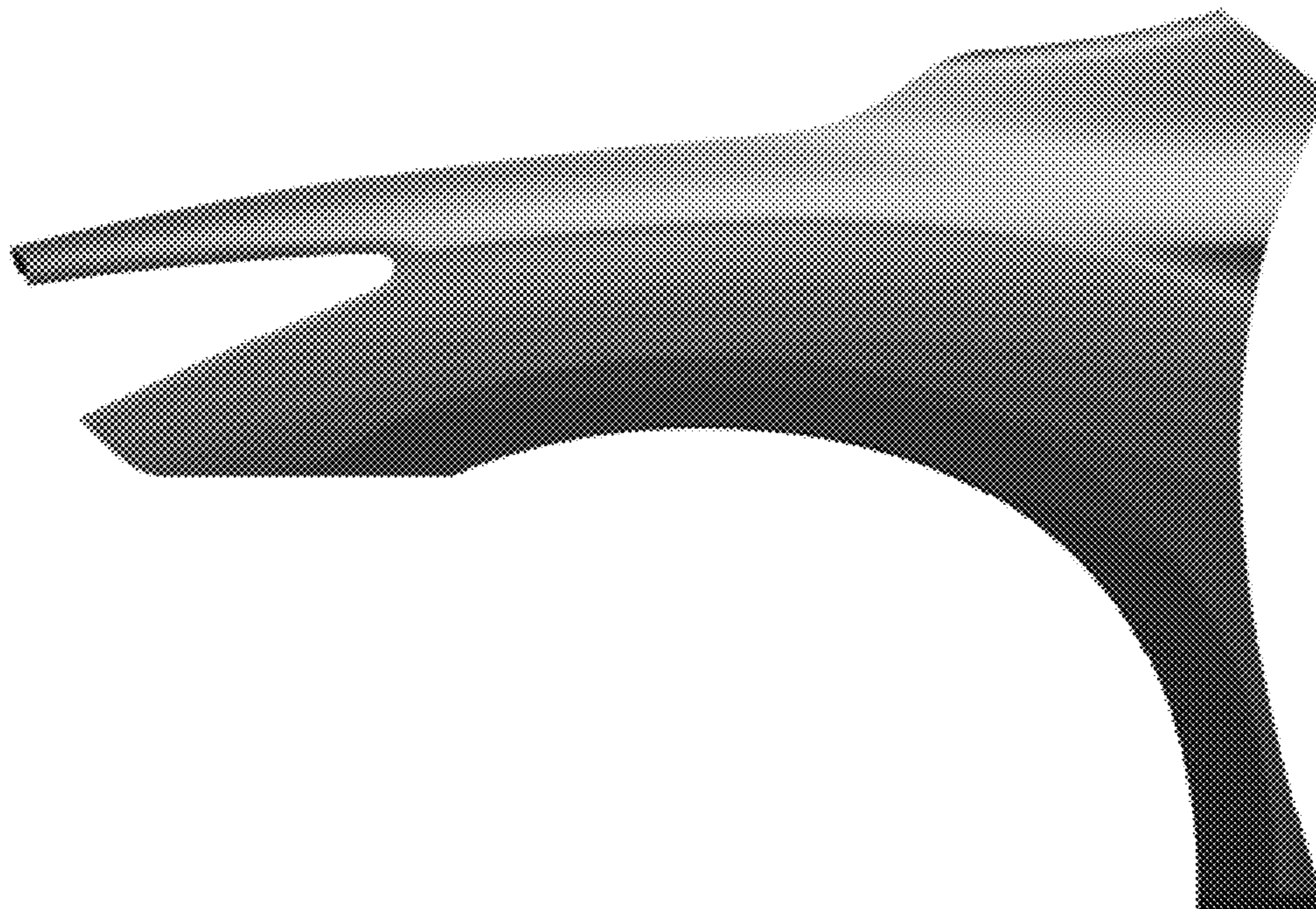

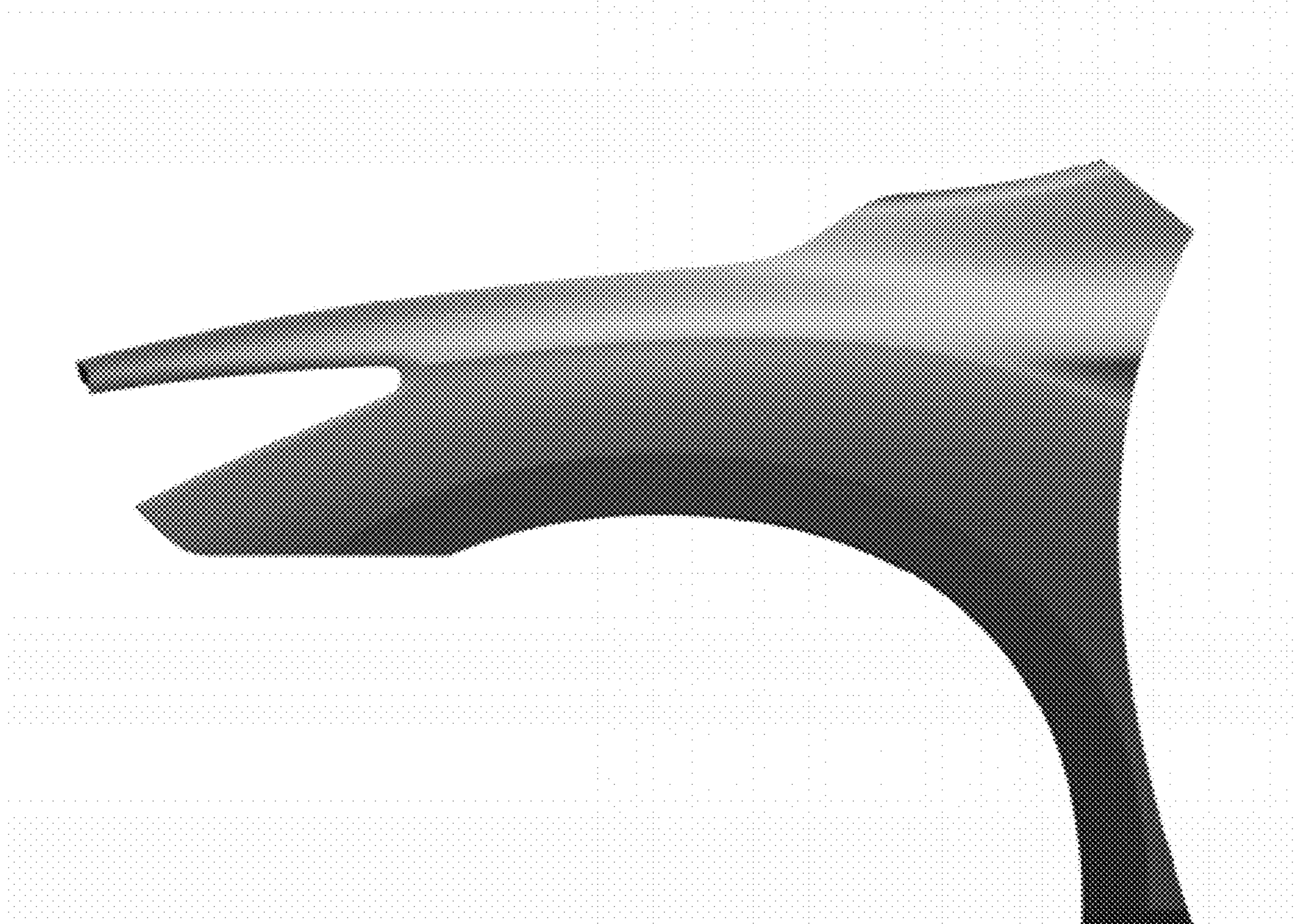

FIG. 1

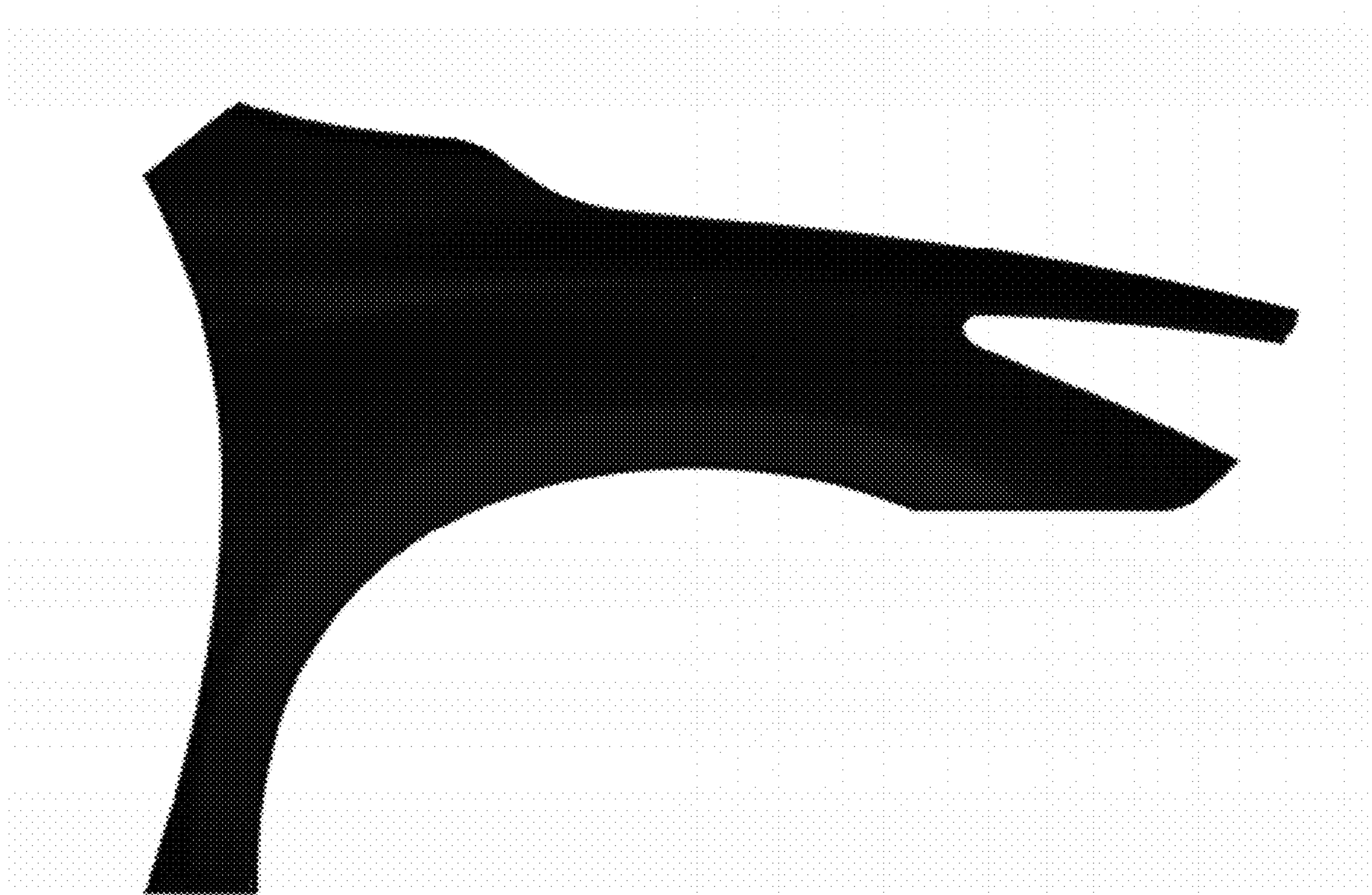

FIG. 2

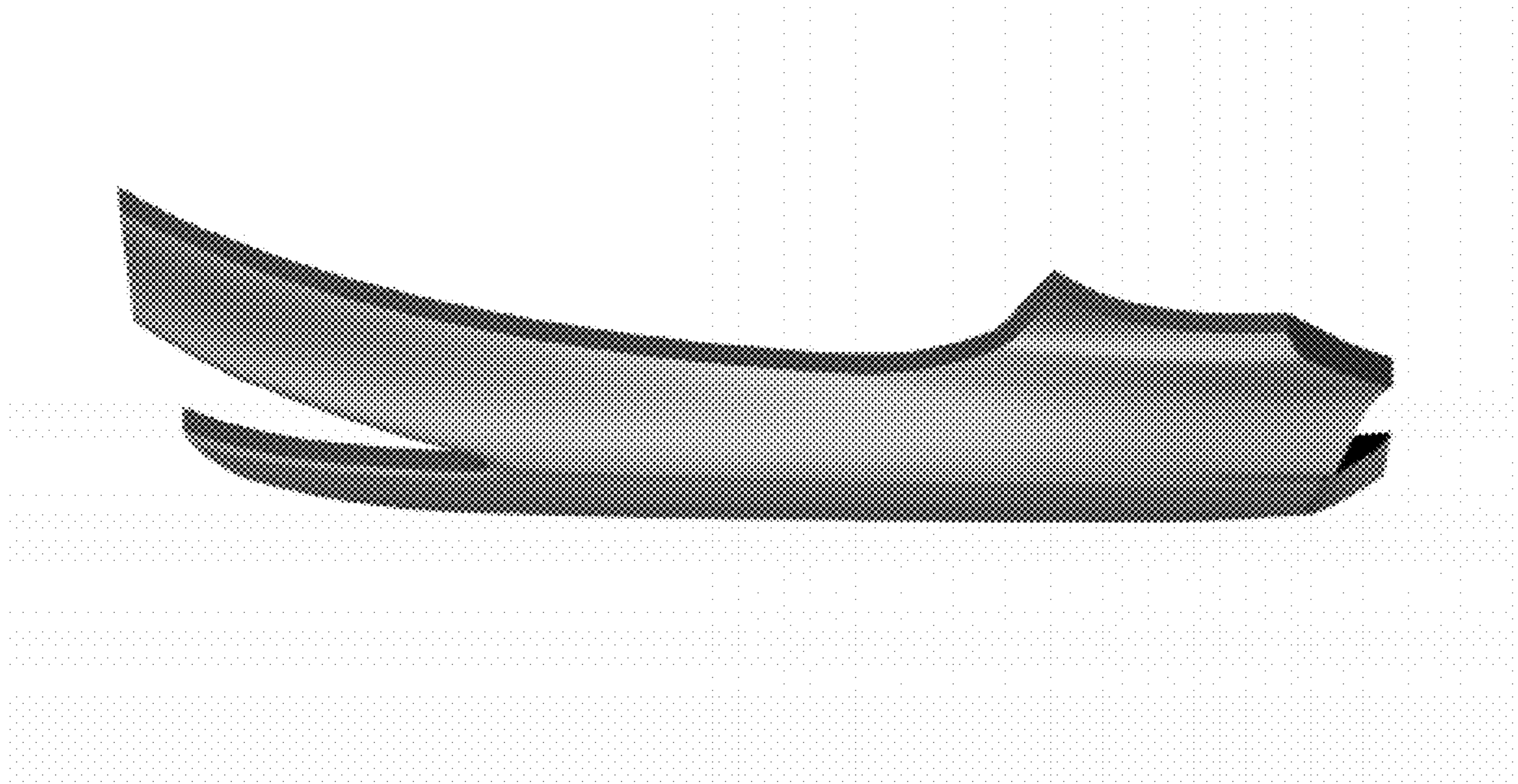

FIG. 3

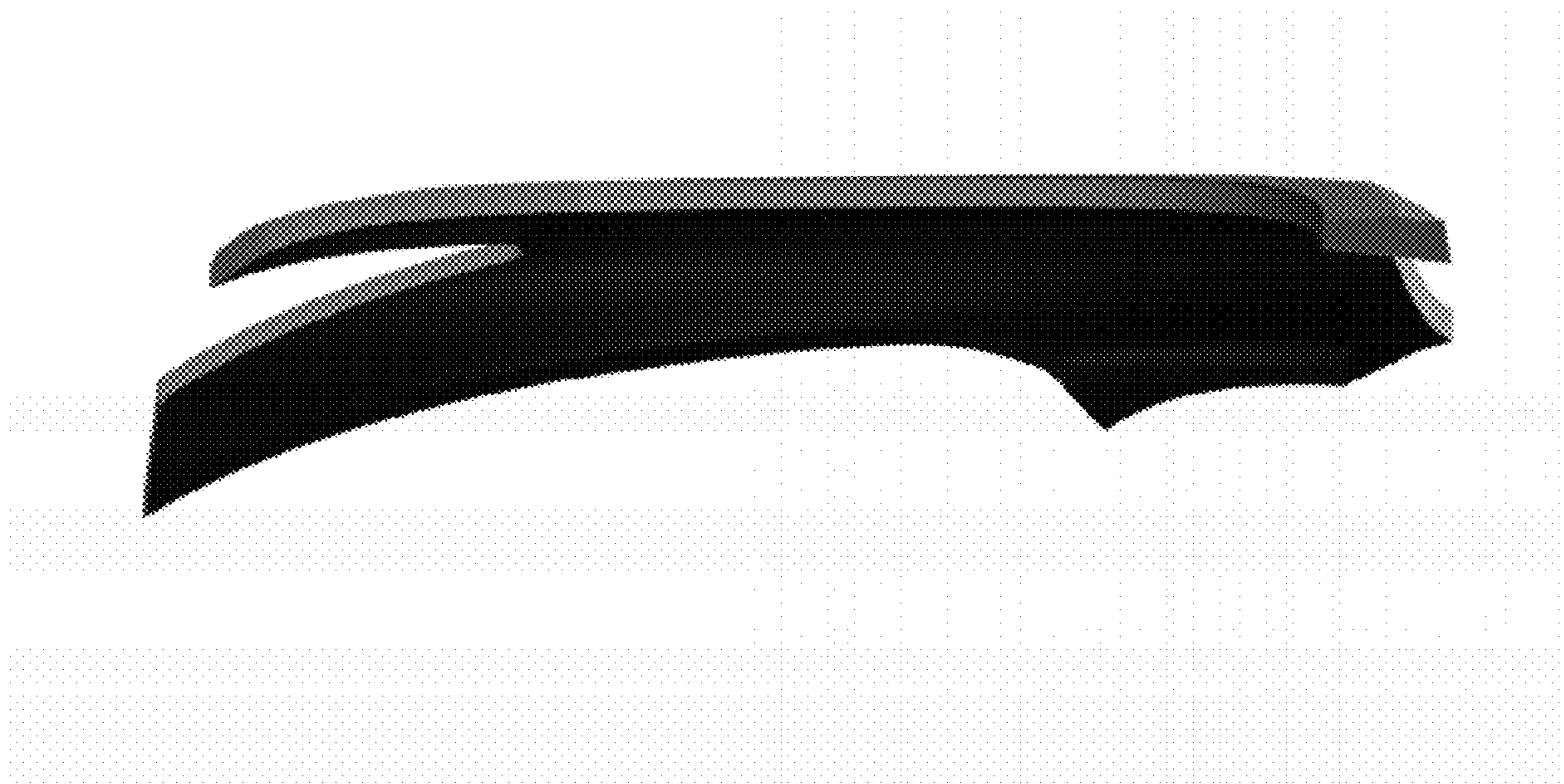

FIG. 4



FIG. 5

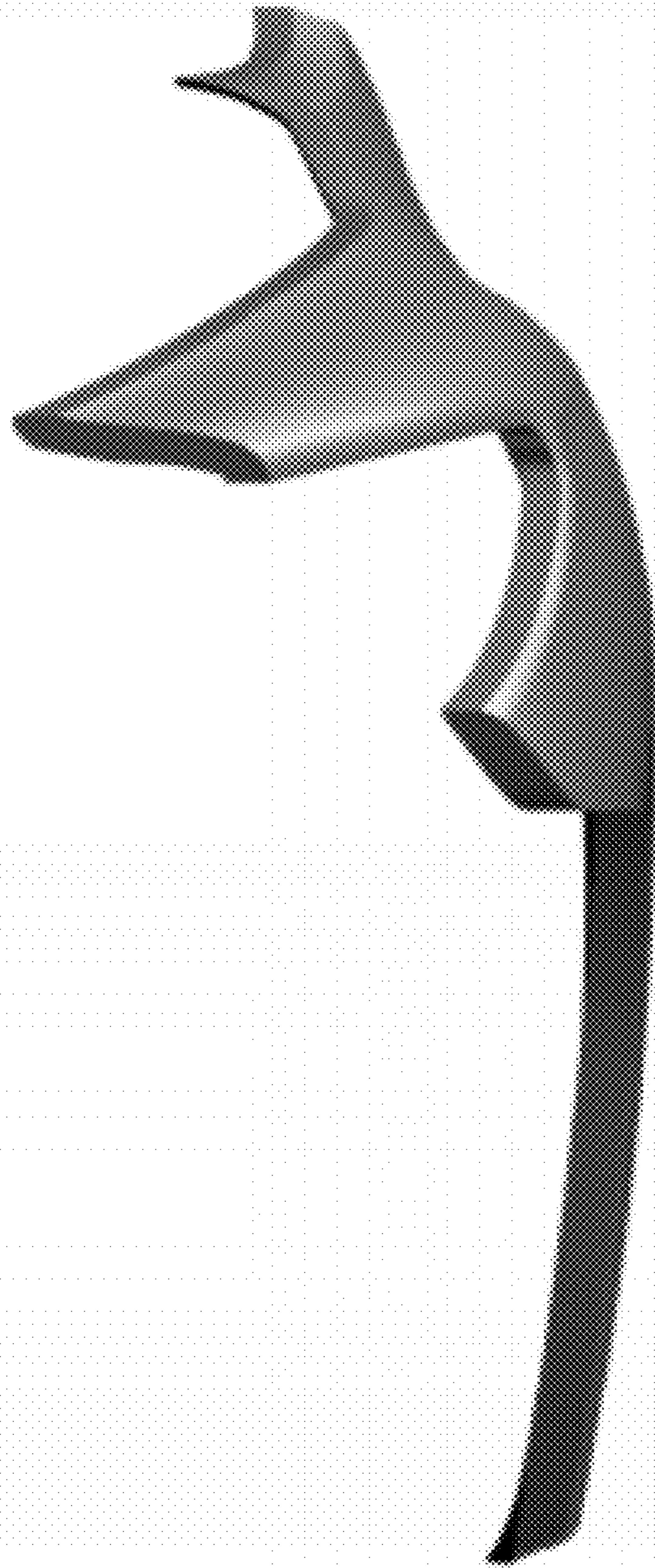

FIG. 6

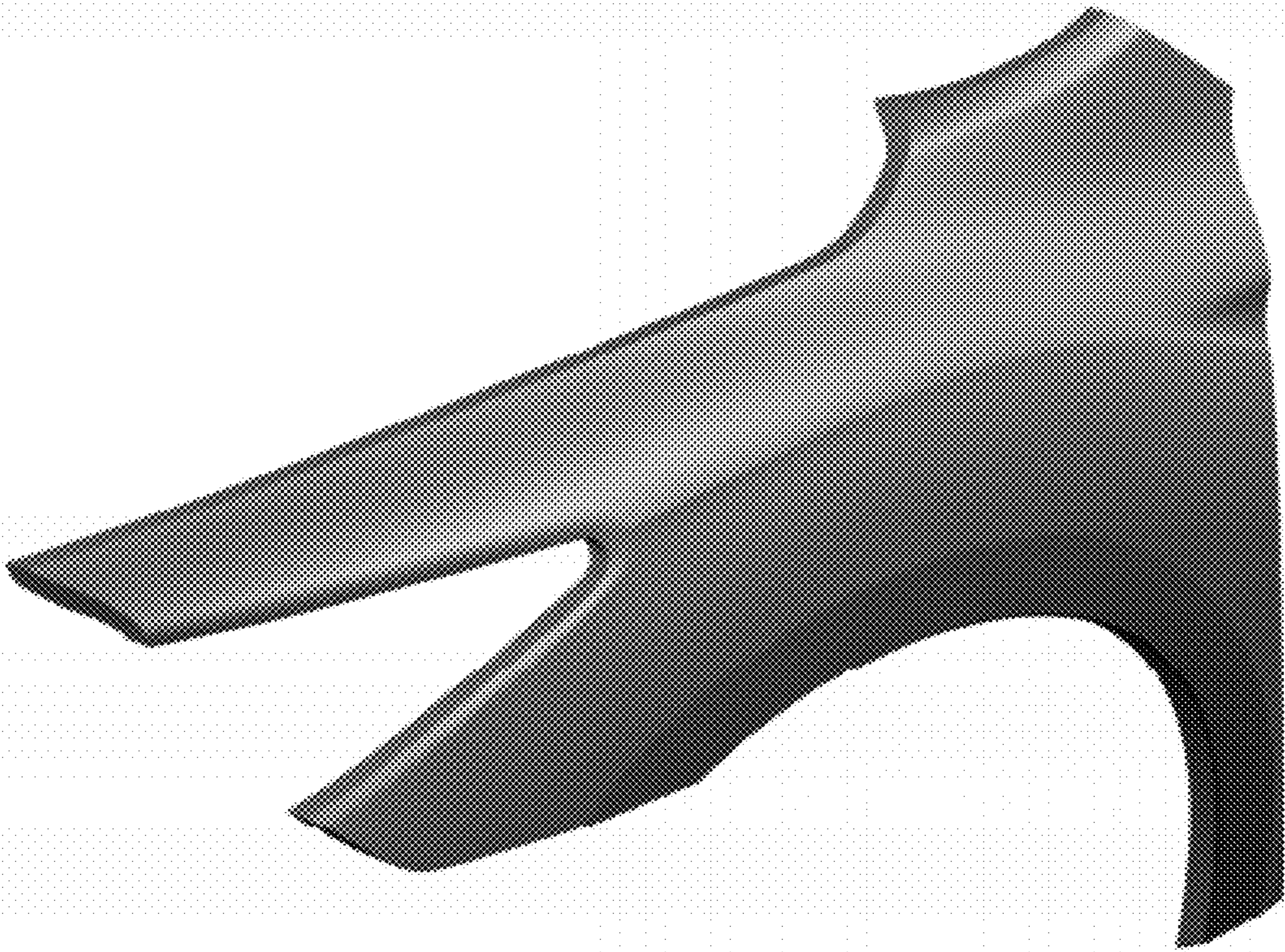

FIG. 7



FIG. 8