



US00D670828S

(12) **United States Design Patent**
Li

(10) **Patent No.:** **US D670,828 S**

(45) **Date of Patent:** **** Nov. 13, 2012**

(54) **TILE PATTERN**

(75) Inventor: **Zong Li**, Farmingdale, NY (US)

(73) Assignee: **P&L Marble, Inc.**, Farmingdale, NY (US)

(**) Term: **14 Years**

(21) Appl. No.: **29/385,926**

(22) Filed: **Feb. 22, 2011**

(51) **LOC (9) Cl.** **25-01**

(52) **U.S. Cl.** **D25/151**

(58) **Field of Classification Search** D25/113,
D25/151, 157, 158, 160; 52/385, 605, 596,
52/608, 574, 609; 404/36, 39, 42
See application file for complete search history.

(56) **References Cited**

U.S. PATENT DOCUMENTS

5,108,219	A *	4/1992	Hair	404/41
6,055,784	A *	5/2000	Geiger	52/302.1
D439,990	S *	4/2001	Abbrancati	D25/113
6,647,684	B1 *	11/2003	Gank	52/385
D510,146	S *	9/2005	Attebery et al.	D25/151
7,244,076	B2 *	7/2007	Whitson	404/73

D598,577	S *	8/2009	Li	D25/138
D604,431	S *	11/2009	Thomassen	D25/113
7,850,393	B2 *	12/2010	Hamel	404/36
2001/0033771	A1 *	10/2001	Schmitz	404/41
2008/0025793	A1 *	1/2008	Dupuis	404/42

* cited by examiner

Primary Examiner — Doris Clark

(74) *Attorney, Agent, or Firm* — Steptoe & Johnson LLP

(57) **CLAIM**

I claim, the ornamental design for a tile pattern, as shown and described.

DESCRIPTION

FIG. 1 is a perspective view, depicting a tile pattern a portion;
 FIG. 2 is a top view, depicting the tile pattern of FIG. 1;
 FIG. 3 is a side view, depicting the tile pattern of FIG. 1;
 FIG. 4 is another side view, depicting the tile pattern of FIG. 1;
 FIG. 5 is another side view, depicting the tile pattern of FIG. 1; and,
 FIG. 6 is another side view, depicting the tile pattern of FIG. 1.
 The broken lines are for illustrative purposes only and form no part of the claimed design.

1 Claim, 2 Drawing Sheets

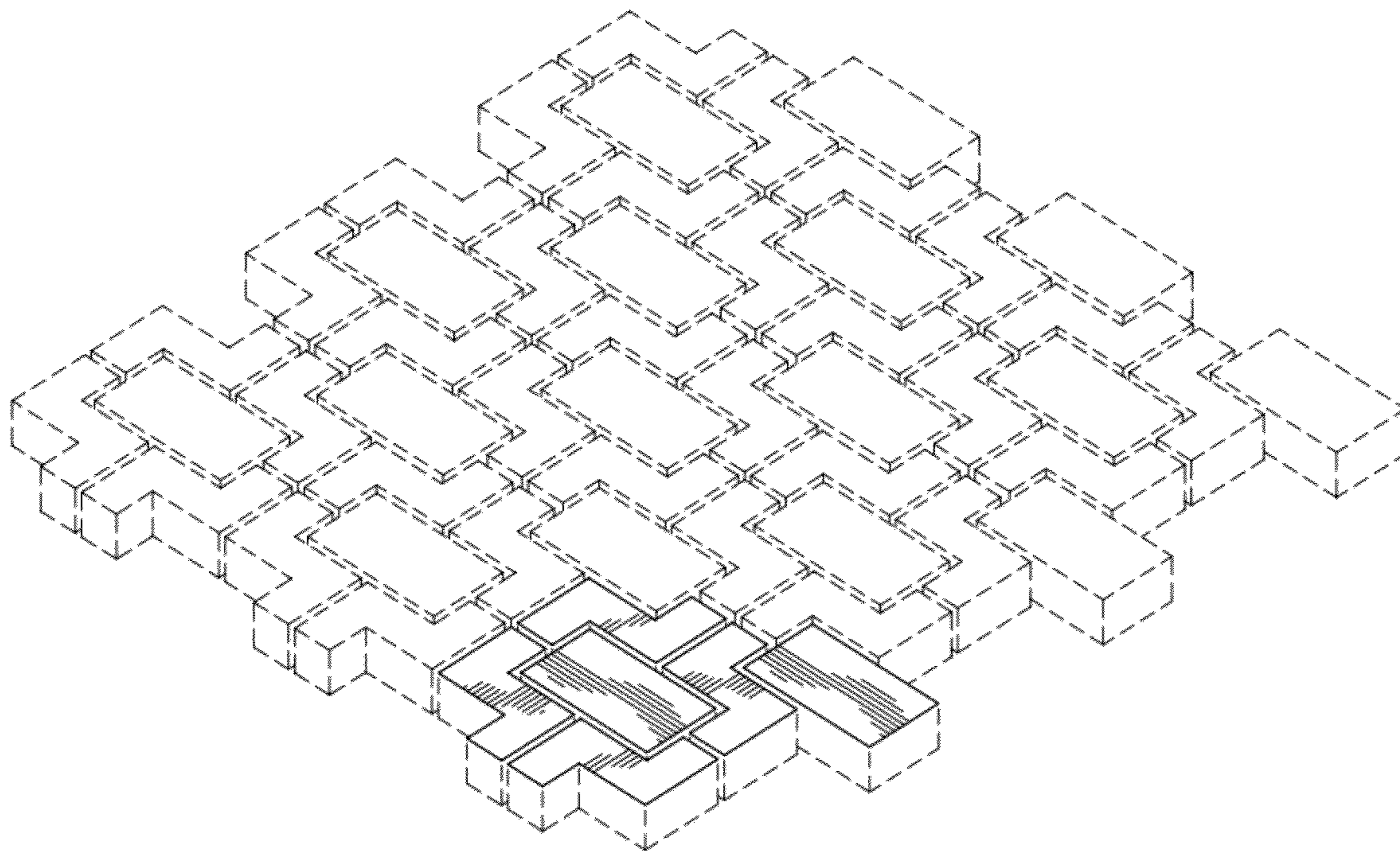

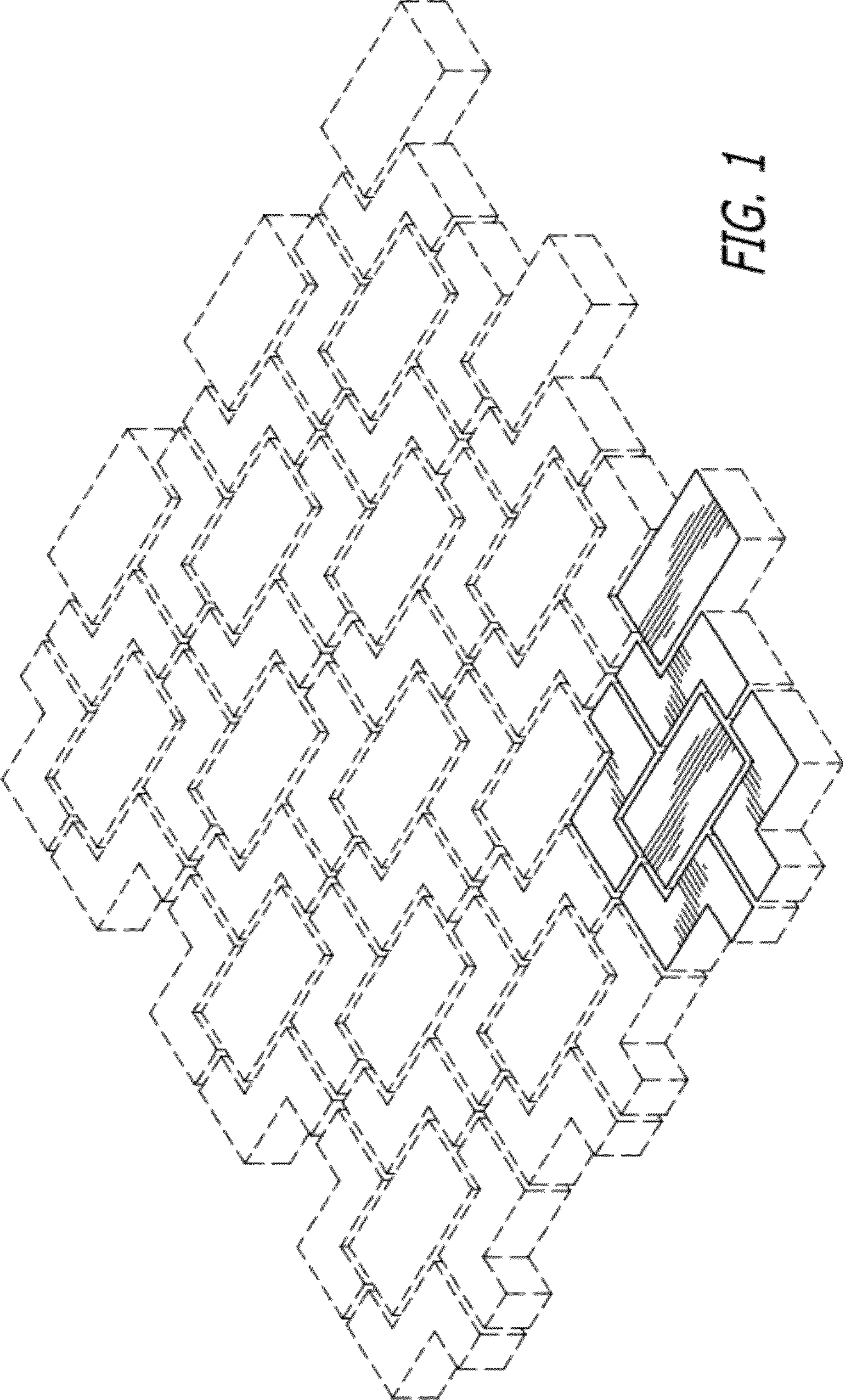

FIG. 1

FIG. 2

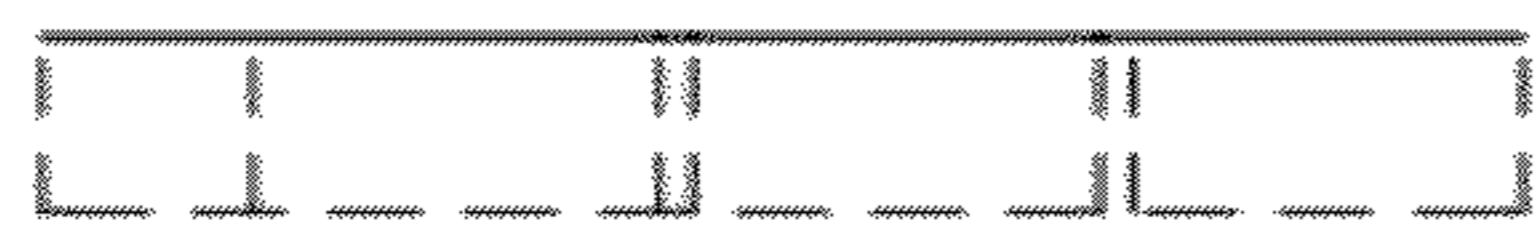
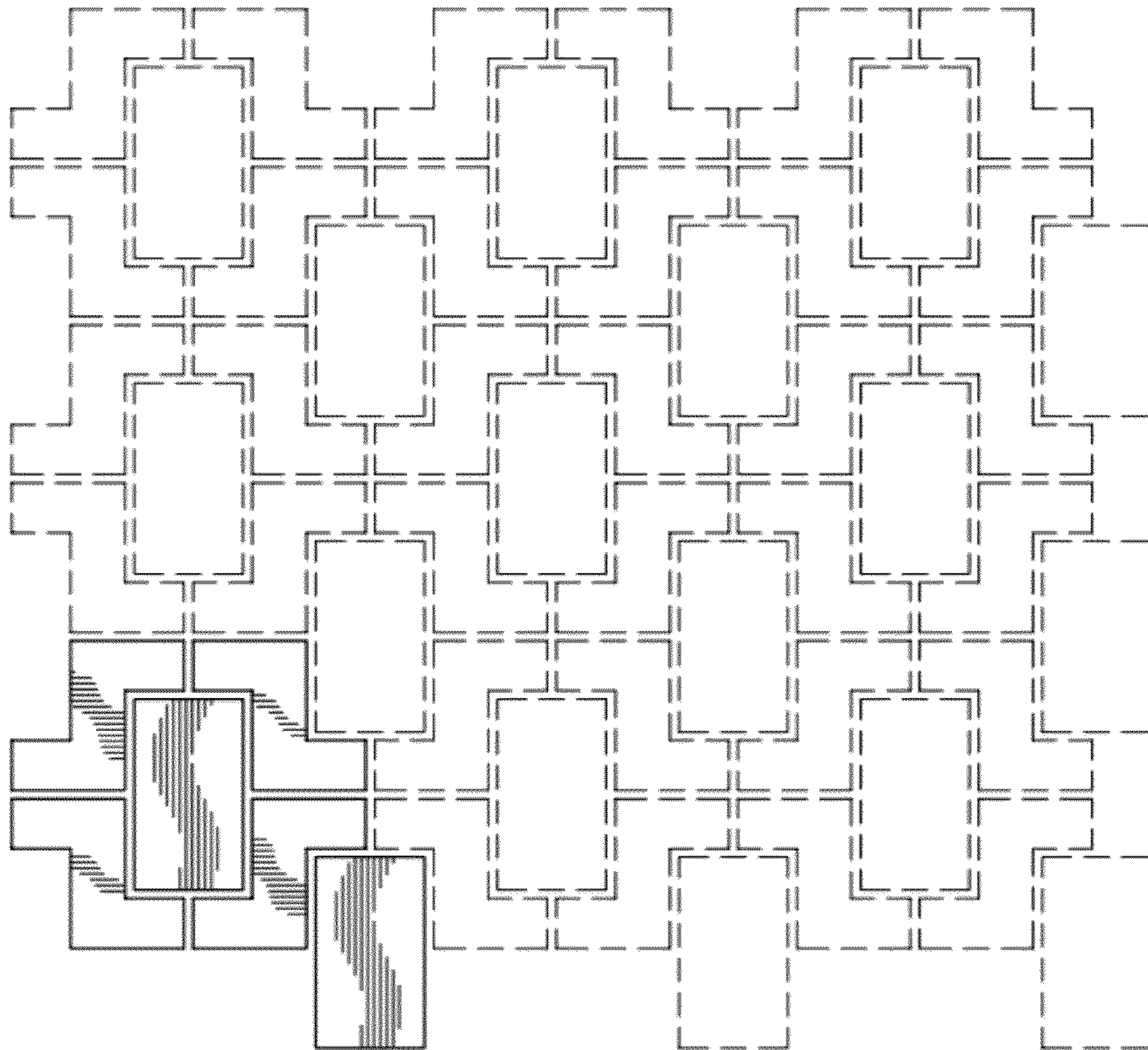

FIG. 3



FIG. 4

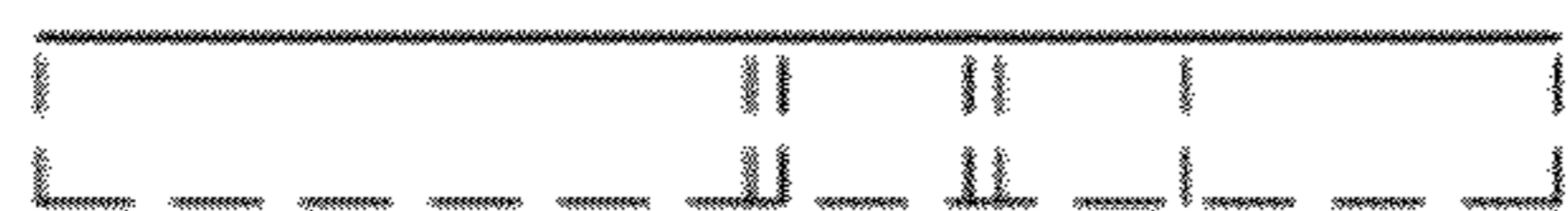

FIG. 5

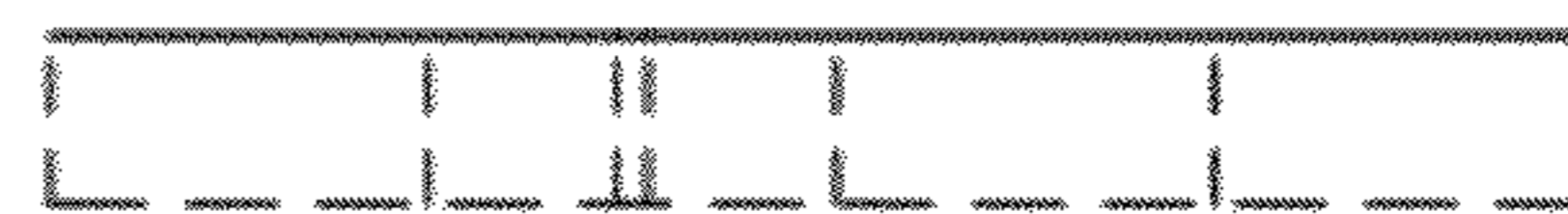

FIG. 6