



US00D666755S

(12) **United States Design Patent**
Minami et al.

(10) **Patent No.:** **US D666,755 S**
(45) **Date of Patent:** **** Sep. 4, 2012**

(54) **REAR COMBINATION LAMP FOR AN AUTOMOBILE**

(75) Inventors: **Takahiro Minami**, Kanagawa-ken (JP);
Noriyuki Nakamura, Shizuoka-ken (JP)

(73) Assignee: **Toyota Jidosha Kabushiki Kaisha**,
Toyota-shi (JP)

(**) Term: **14 Years**

(21) Appl. No.: **29/405,123**

(22) Filed: **Oct. 28, 2011**

(51) **LOC (9) Cl.** **26-06**

(52) **U.S. Cl.** **D26/28**

(58) **Field of Classification Search** D26/28-36;
362/459-468, 475-478, 485-487

See application file for complete search history.

(56) **References Cited**

U.S. PATENT DOCUMENTS

D476,759 S *	7/2003	Lin	D26/28
D483,890 S *	12/2003	Lin	D26/28
D497,018 S *	10/2004	Lin	D26/28
D541,445 S *	4/2007	Lin	D26/28
D542,445 S *	5/2007	Matsunami	D26/28
D550,380 S *	9/2007	Lin	D26/28
D562,477 S *	2/2008	Hsu	D26/28
D570,015 S *	5/2008	Hsu	D26/28

OTHER PUBLICATIONS

Volkswagen Golf Variant, <http://221616.comcorism/articles/0000101758>, Feb. 1, 1011.

Corolla Fielder, minkara.carview.co.jp, Feb. 1, 2011.

* cited by examiner

Primary Examiner — Marcus Jackson

(74) *Attorney, Agent, or Firm* — Finnegan, Henderson, Farabow, Garrett & Dunner, LLP

(57) **CLAIM**

The ornamental design for a rear combination lamp for an automobile, as shown and described.

DESCRIPTION

FIG. 1 is a front perspective view of a rear combination lamp for an automobile of our new design;

FIG. 2 is a front view thereof;

FIG. 3 is a rear view thereof;

FIG. 4 is a top plan view thereof;

FIG. 5 is a bottom view thereof;

FIG. 6 is a right side view thereof; and,

FIG. 7 is a left side view thereof.

The claimed design includes a mirror image of the embodiment depicted.

1 Claim, 4 Drawing Sheets



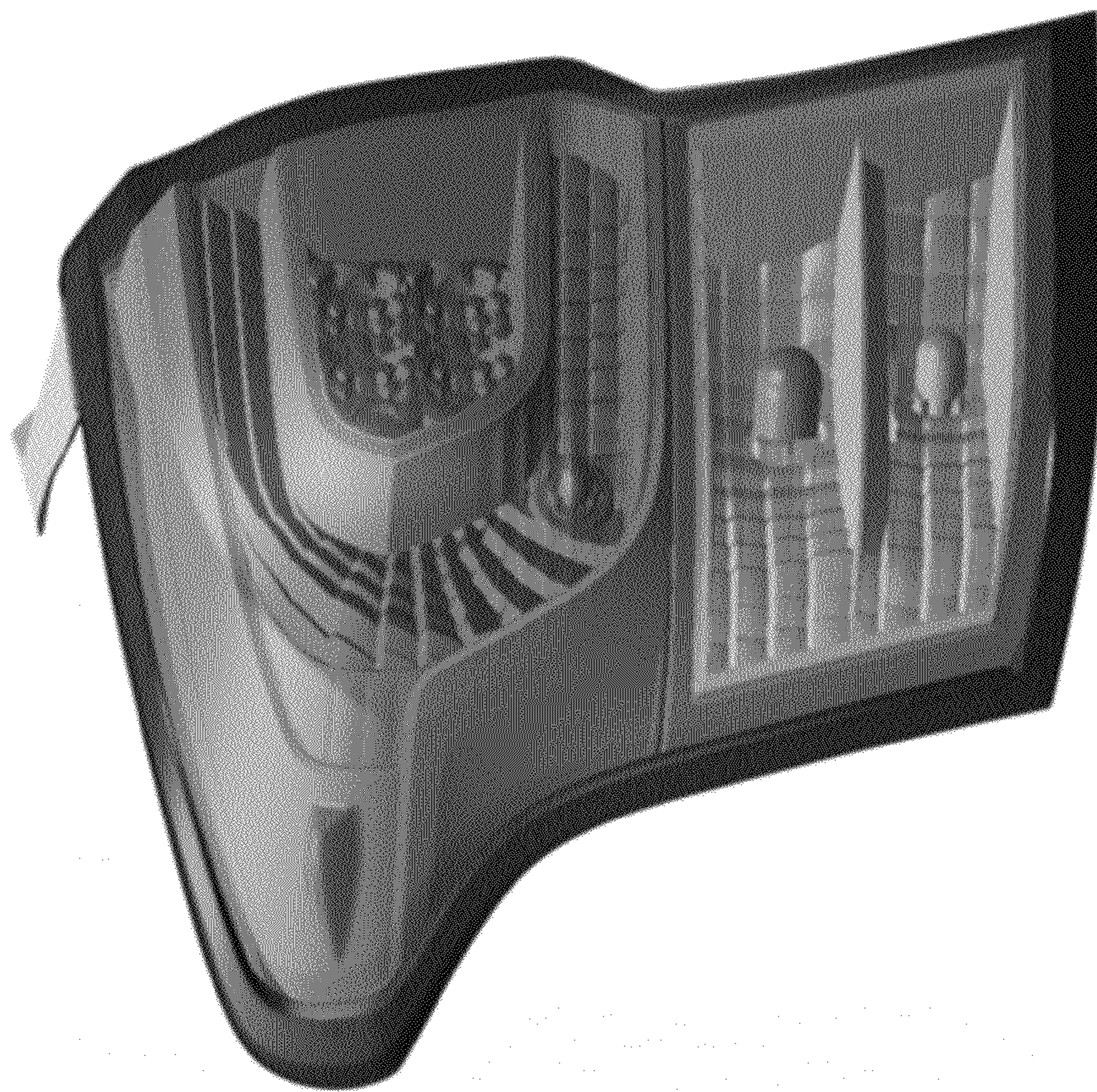

FIG. 1

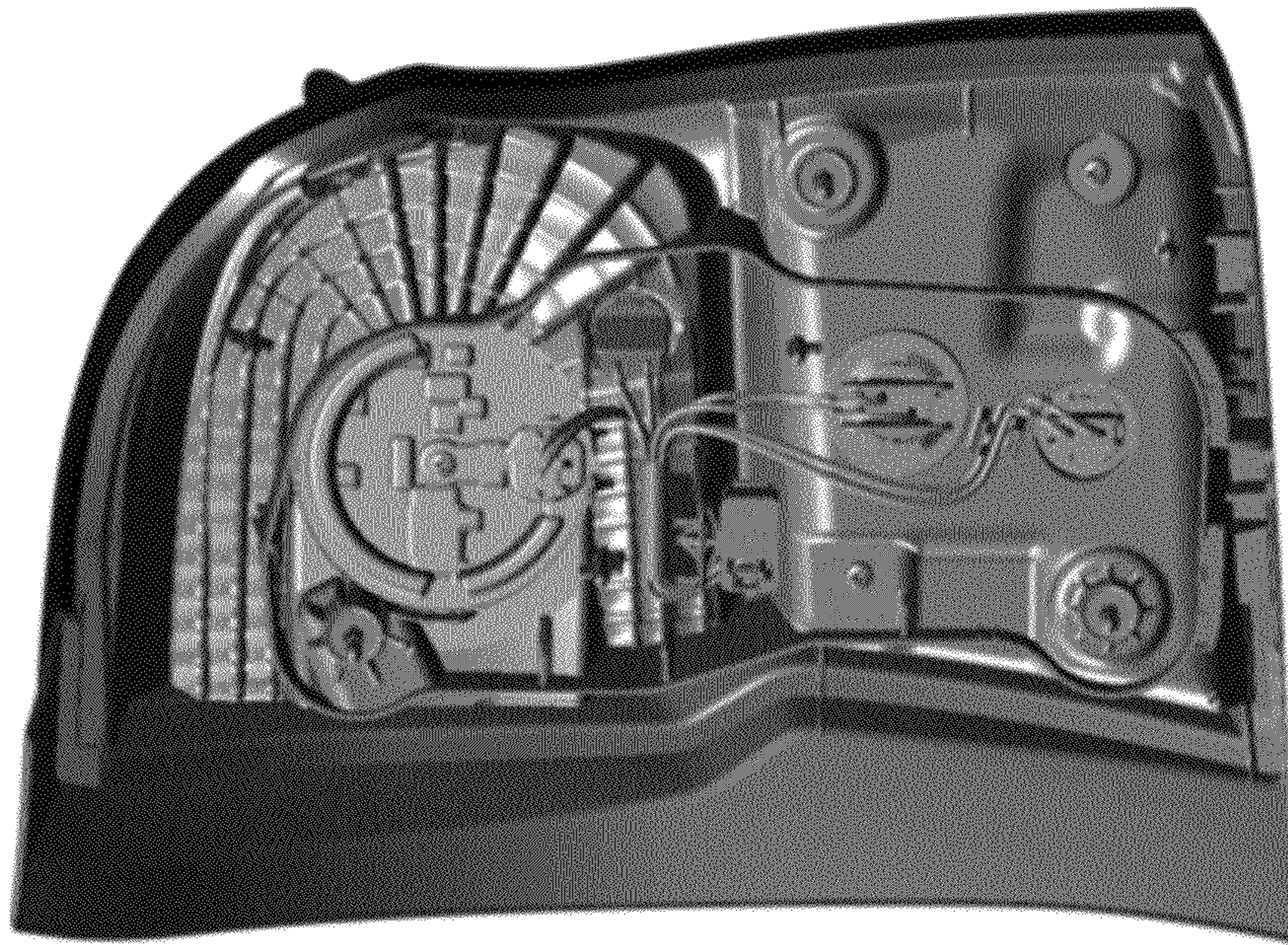

FIG. 3

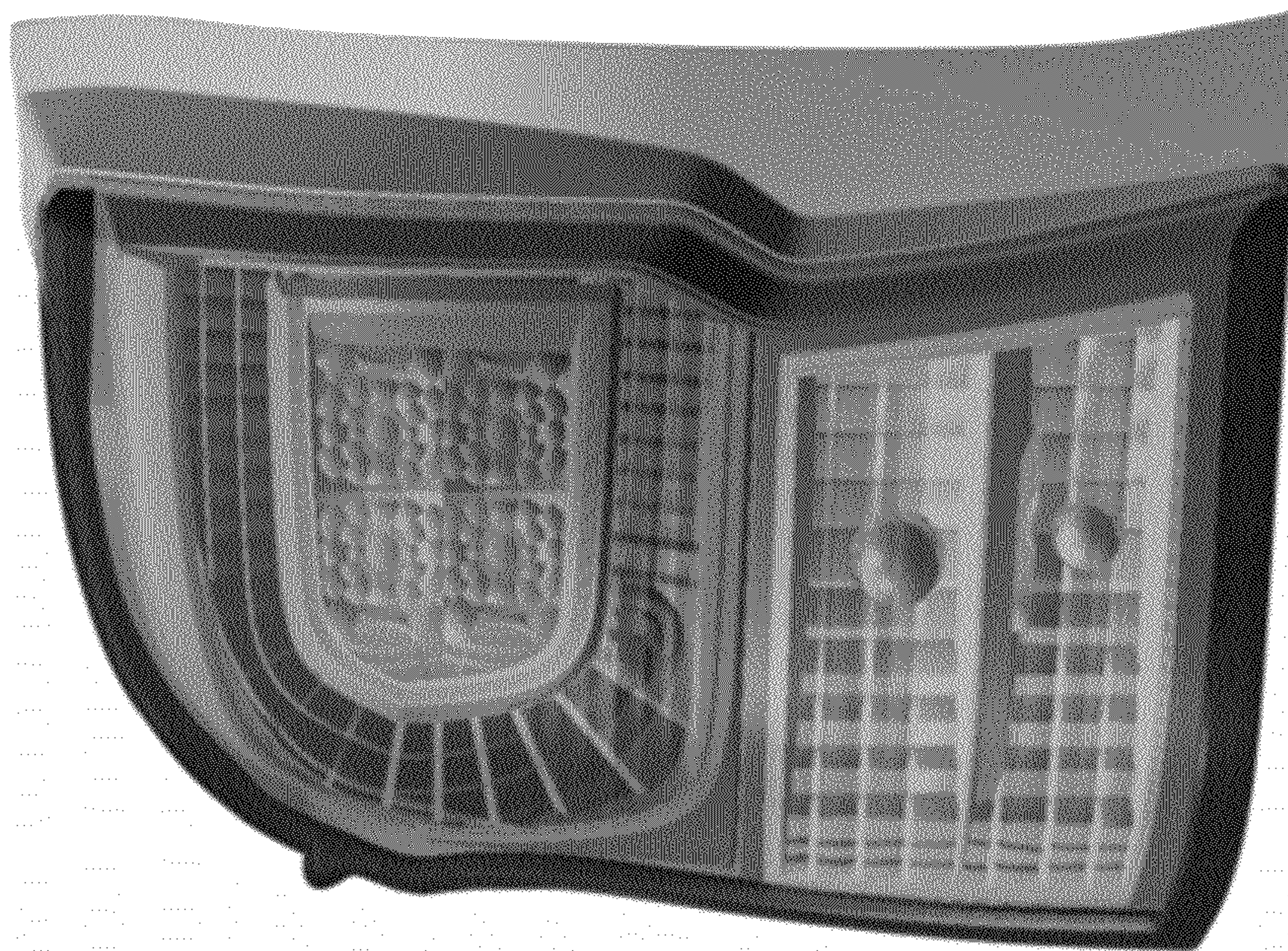

FIG. 2

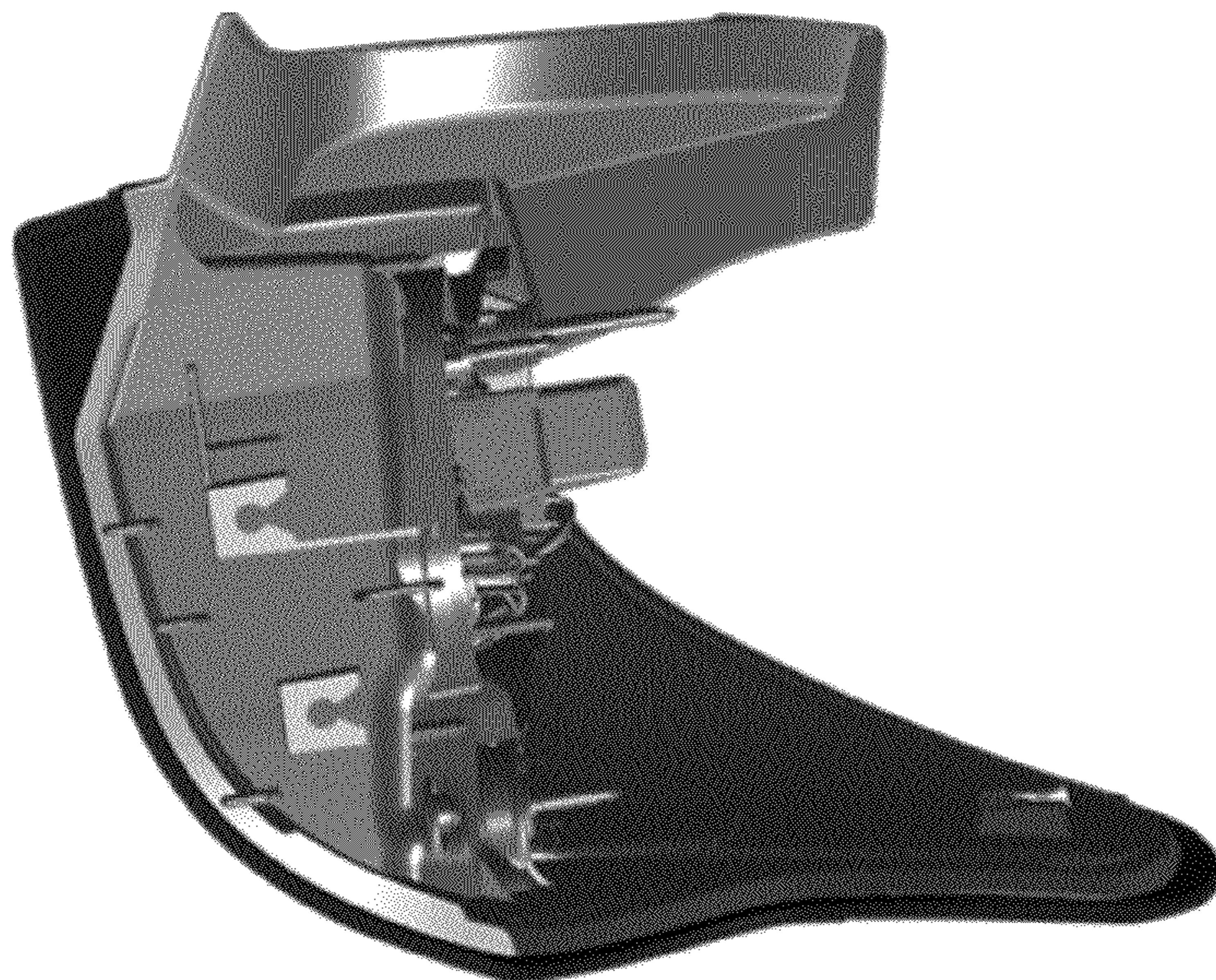

FIG. 4



FIG. 5

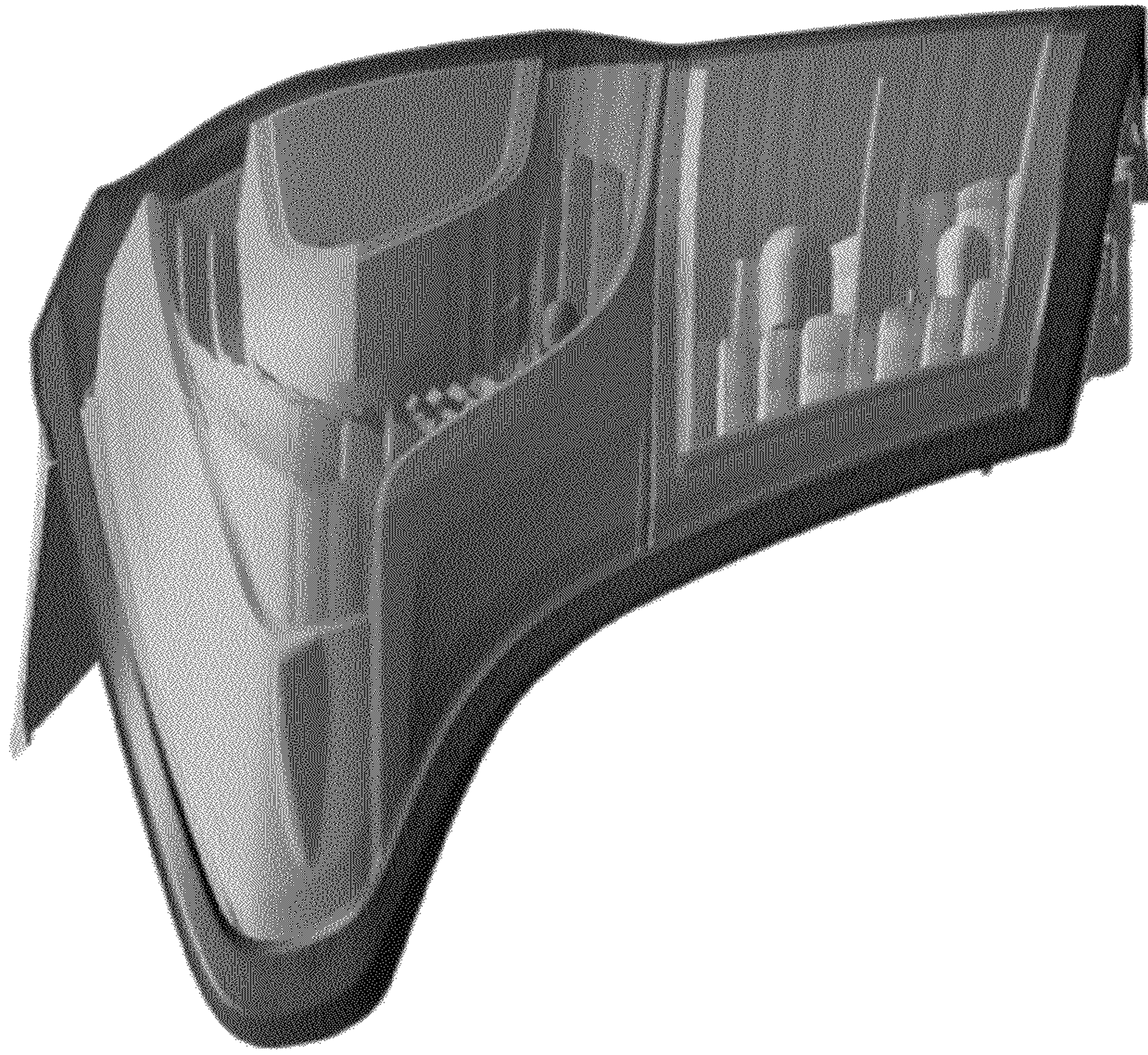

FIG. 7

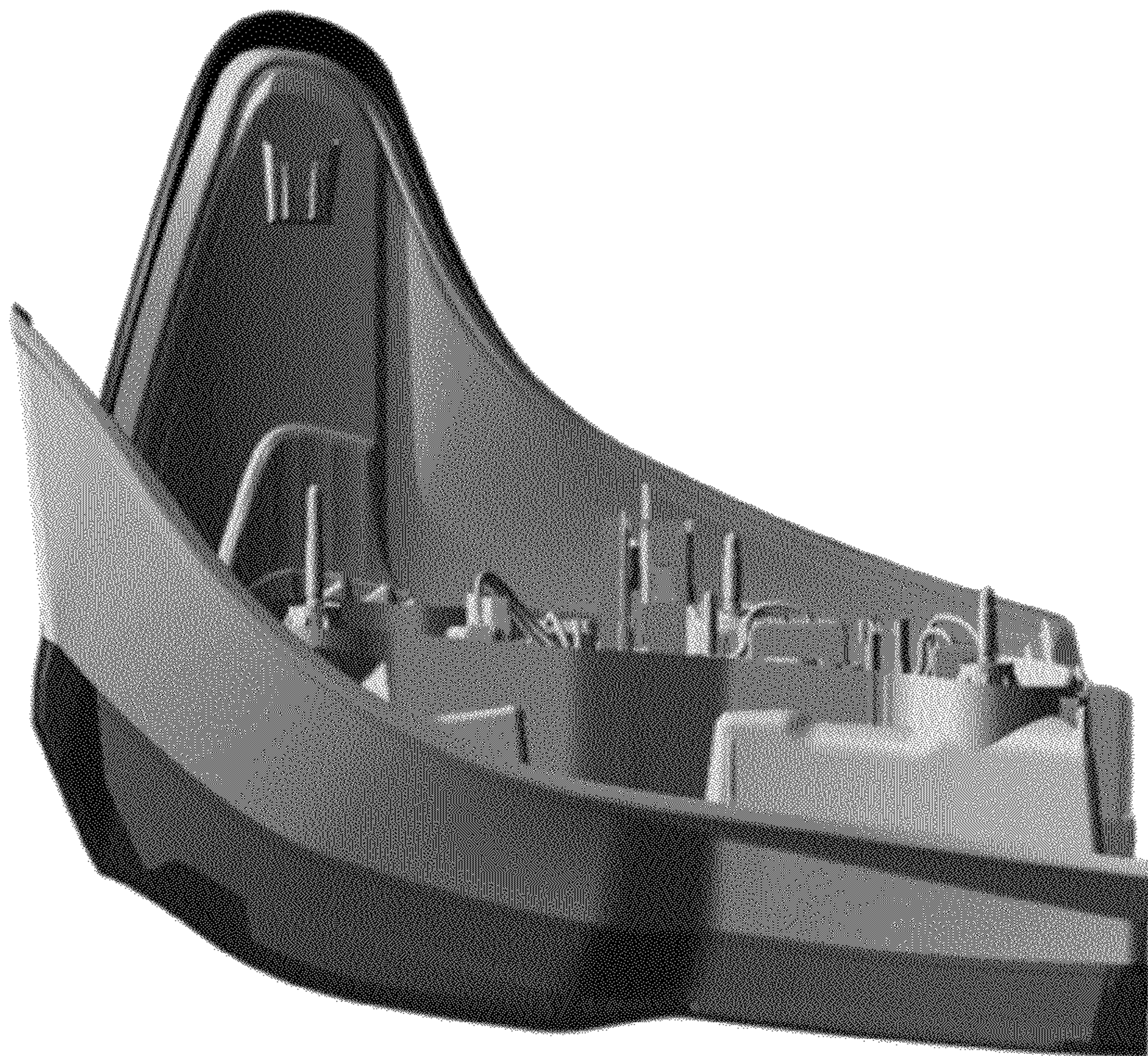

FIG. 6