



US00D663250S

(12) **United States Design Patent**  
**Chien**

(10) **Patent No.:** **US D663,250 S**  
(45) **Date of Patent:** **\*\* Jul. 10, 2012**

- (54) **WINDSHIELD WIPER**
- (75) Inventor: **Ching Chuan Chien**, Taipei (TW)
- (73) Assignee: **Unipoint Electric Mfg. Co., Ltd.**, Taipei (TW)
- (\*\*) Term: **14 Years**
- (21) Appl. No.: **29/379,820**
- (22) Filed: **Nov. 24, 2010**
- (51) **LOC (9) Cl.** ..... **12-06**
- (52) **U.S. Cl.** ..... **D12/219**
- (58) **Field of Classification Search** ..... D12/219-220;  
15/246, 247, 250.001, 250.4, 250.361, 250.19,  
15/250.48, 250.03, 250.31-250.33, 250.351,  
15/250.38, 250.201, 250.451, 250.458, 250.04,  
15/250.07, 250.44  
See application file for complete search history.

- D490,763 S \* 6/2004 Kim ..... D12/219
- D565,493 S \* 4/2008 Kim ..... D12/219
- D579,401 S \* 10/2008 Garrastacho et al. .... D12/219
- D598,359 S \* 8/2009 Kim ..... D12/219

\* cited by examiner

*Primary Examiner* — Caron D Veynar  
*Assistant Examiner* — Katrina A Betton  
(74) *Attorney, Agent, or Firm* — Rabin & Berdo, PC

(57) **CLAIM**

The ornamental design for a windshield wiper, as shown and described.

**DESCRIPTION**

FIG. 1 is a perspective view of a windshield wiper, showing our new design;  
FIG. 2 is a front view thereof;  
FIG. 3 is a rear view thereof;  
FIG. 4 is a left side view thereof;  
FIG. 5 is a right side view thereof;  
FIG. 6 is a top plan view thereof;  
FIG. 7 is a bottom plan view thereof; and,  
FIG. 8 is a demonstration of the assembling of the windshield wiper.

**1 Claim, 8 Drawing Sheets**

(56) **References Cited**

U.S. PATENT DOCUMENTS

- D442,537 S \* 5/2001 Kim ..... D12/219
- D464,012 S \* 10/2002 Hussaini et al. .... D12/219
- D474,143 S \* 5/2003 Ho ..... D12/219
- D487,047 S \* 2/2004 Kim ..... D12/219

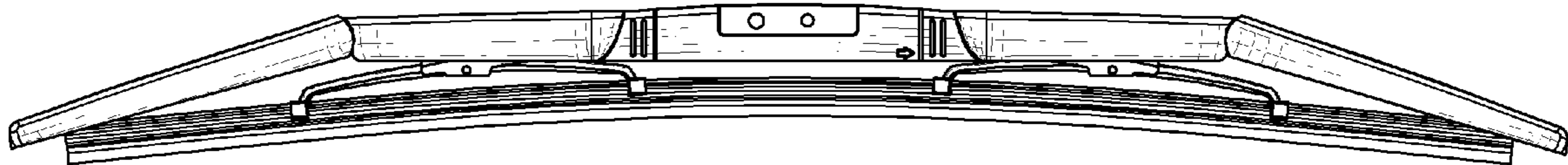

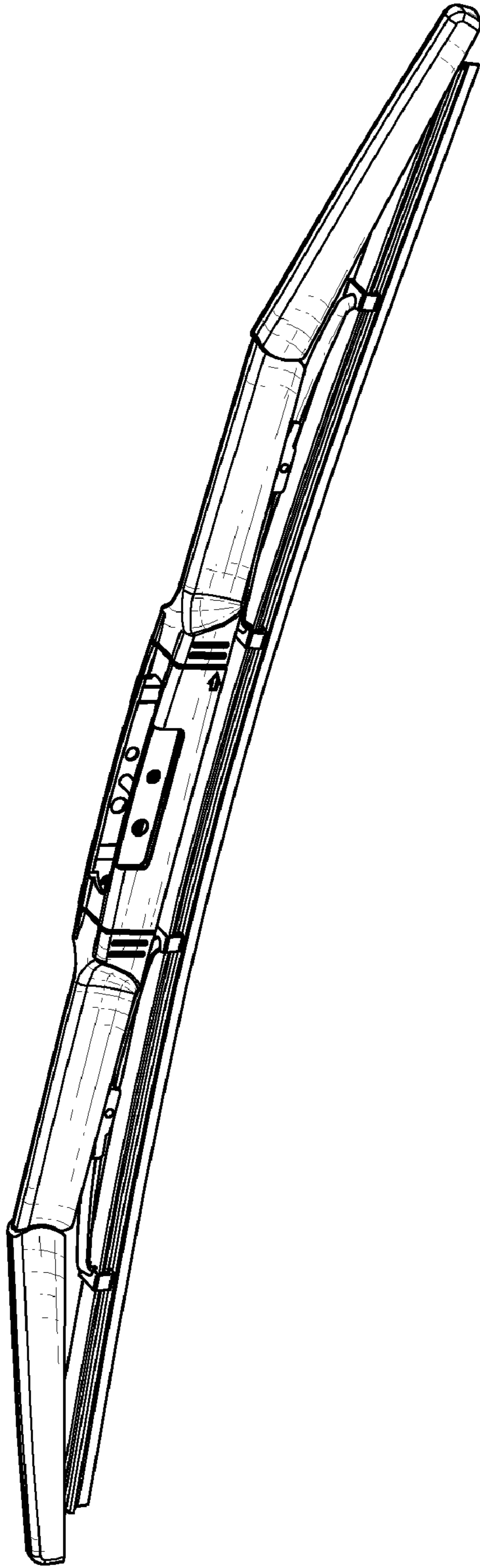

FIG. 1

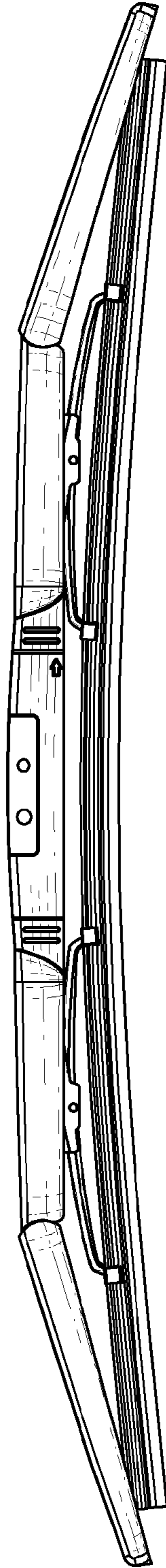

FIG. 2

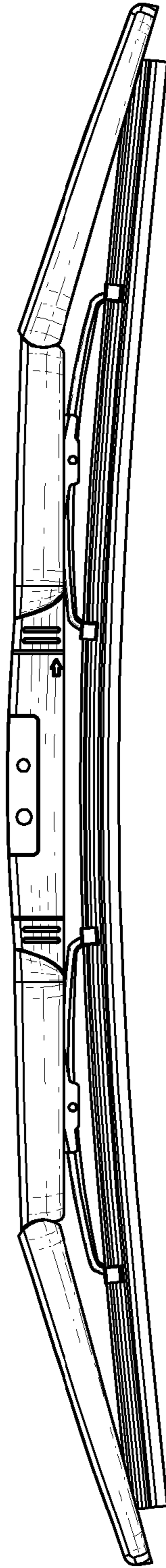

FIG. 3

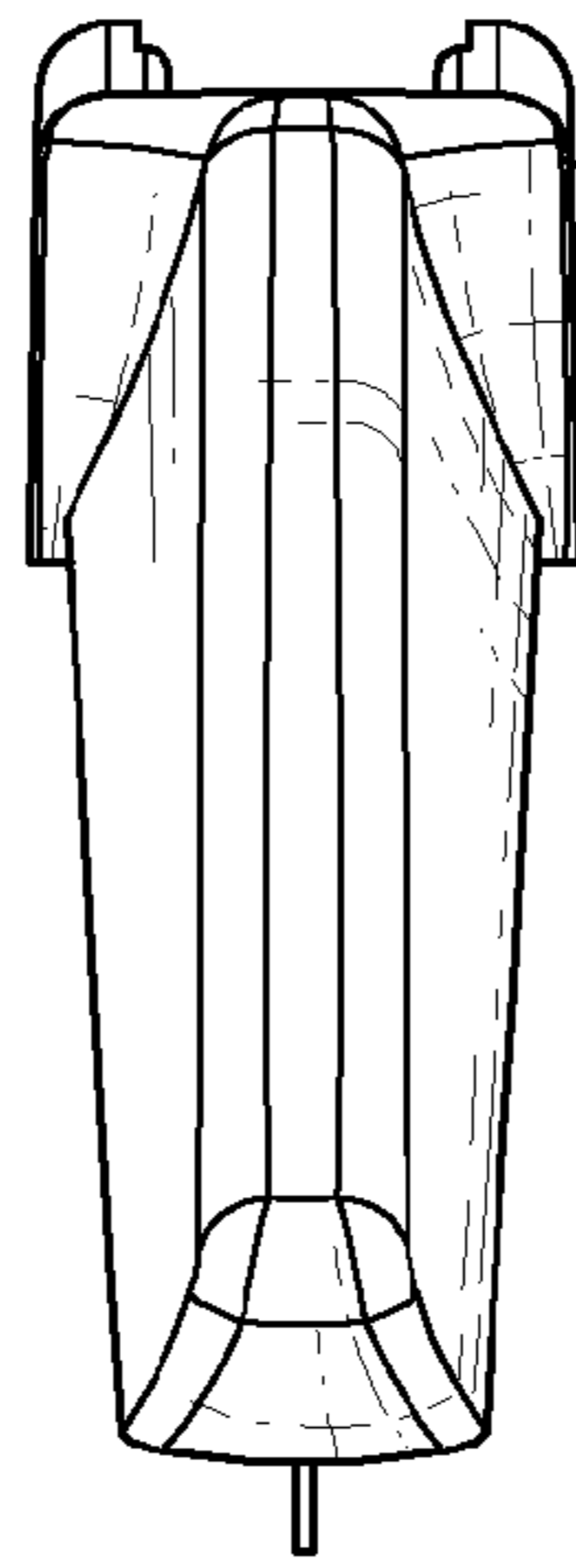

FIG. 4

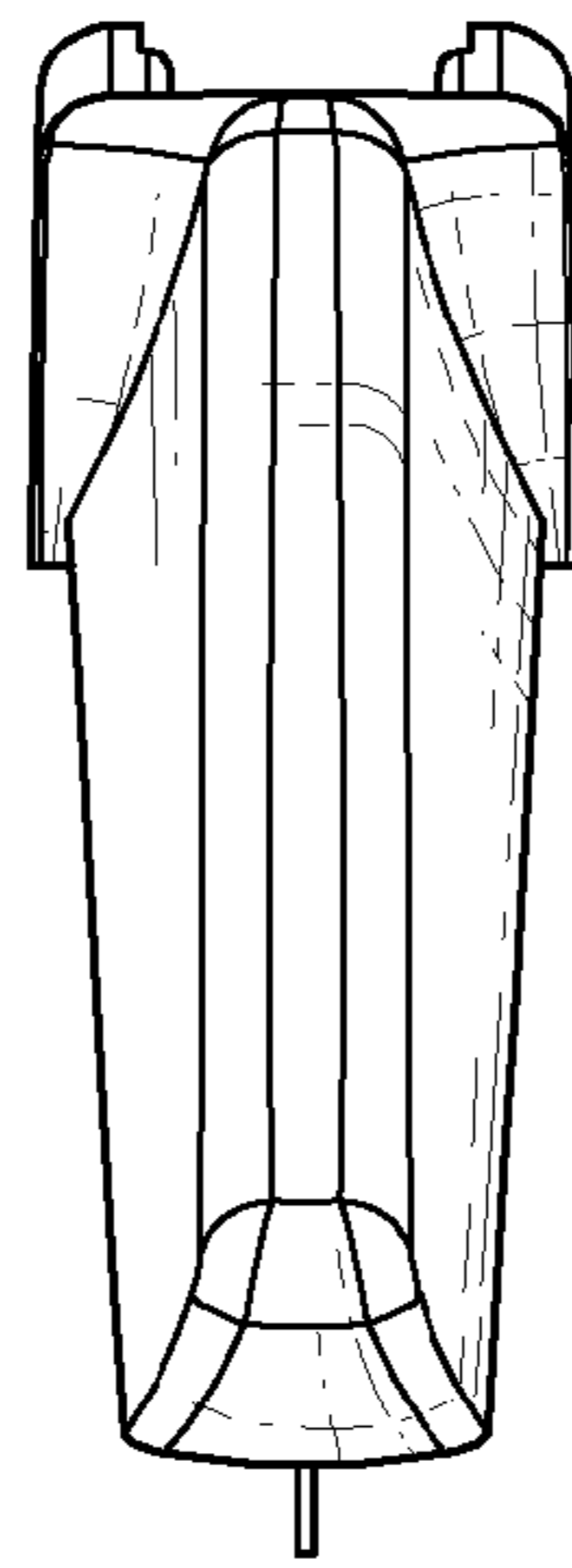

FIG. 5



FIG. 6

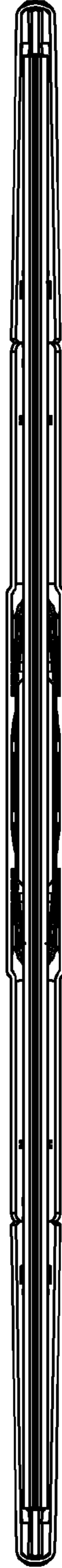

FIG. 7



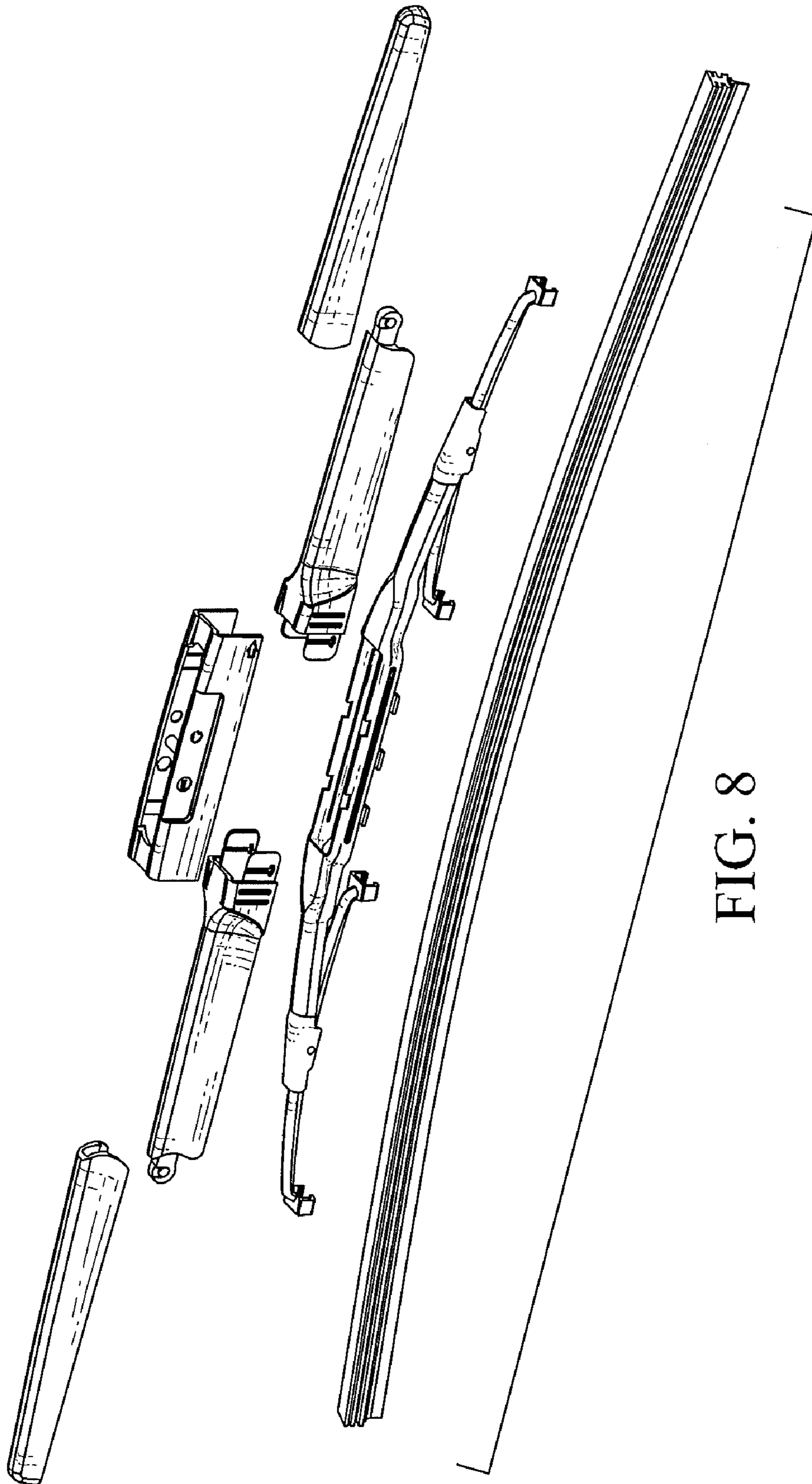

FIG. 8