

US00D662091S

(12) **United States Design Patent**
Loponen

(10) **Patent No.:** **US D662,091 S**

(45) **Date of Patent:** **** Jun. 19, 2012**

(54) **COMMUNICATION DEVICE**

(75) **Inventor:** **Tapio Loponen**, Espoo (FI)

(73) **Assignee:** **ABB Oy**, Helsinki (FI)

(**) **Term:** **14 Years**

(21) **Appl. No.:** **29/371,780**

(22) **Filed:** **Sep. 22, 2011**

(30) **Foreign Application Priority Data**

Apr. 1, 2011 (EM) 001270102-0001
Apr. 1, 2011 (EM) 001270102-0002

(51) **LOC (9) Cl.** **14-03**

(52) **U.S. Cl.** **D14/240**

(58) **Field of Classification Search** D14/240,
D14/242, 357, 358, 140-140.2, 140.5, 155,
D14/137, 348, 349, 351, 354, 355; 375/222;
455/557; 709/203, 217-250; 725/111
See application file for complete search history.

(56) **References Cited**

U.S. PATENT DOCUMENTS

D310,825 S * 9/1990 Crease et al. D14/355
D376,138 S * 12/1996 Moon D14/358
D381,319 S * 7/1997 Nogas D14/313
D393,251 S * 4/1998 Kurokawa D14/358
D441,729 S * 5/2001 Fujikura et al. D14/140.2

6,546,521 B2 * 4/2003 Boggs et al. 714/800
D485,829 S * 1/2004 Lee D14/240
D495,311 S * 8/2004 Taniguchi et al. D14/140.1
D542,284 S * 5/2007 Kim D14/240
2005/0070162 A1 * 3/2005 Espenshade et al. 439/620

* cited by examiner

Primary Examiner — Bridget L Eland

(74) *Attorney, Agent, or Firm* — Dykema Gossett PLLC

(57) **CLAIM**

The ornamental design for a communication device, as shown and described.

DESCRIPTION

FIG. 1 is a perspective top, front and right side view of a communication device showing my new design;

FIG. 2 is a front view thereof;

FIG. 3 is a rear view thereof;

FIG. 4 is a left side view thereof;

FIG. 5 is a right side view thereof;

FIG. 6 is a top view thereof;

FIG. 7 is a bottom view thereof;

FIG. 8 is a perspective top, front and left side view thereof;

FIG. 9 is a perspective bottom, front and right side view thereof; and,

FIG. 10 is a perspective bottom, front and left side view thereof.

The broken lines shown form no part of the claimed design.

1 Claim, 10 Drawing Sheets

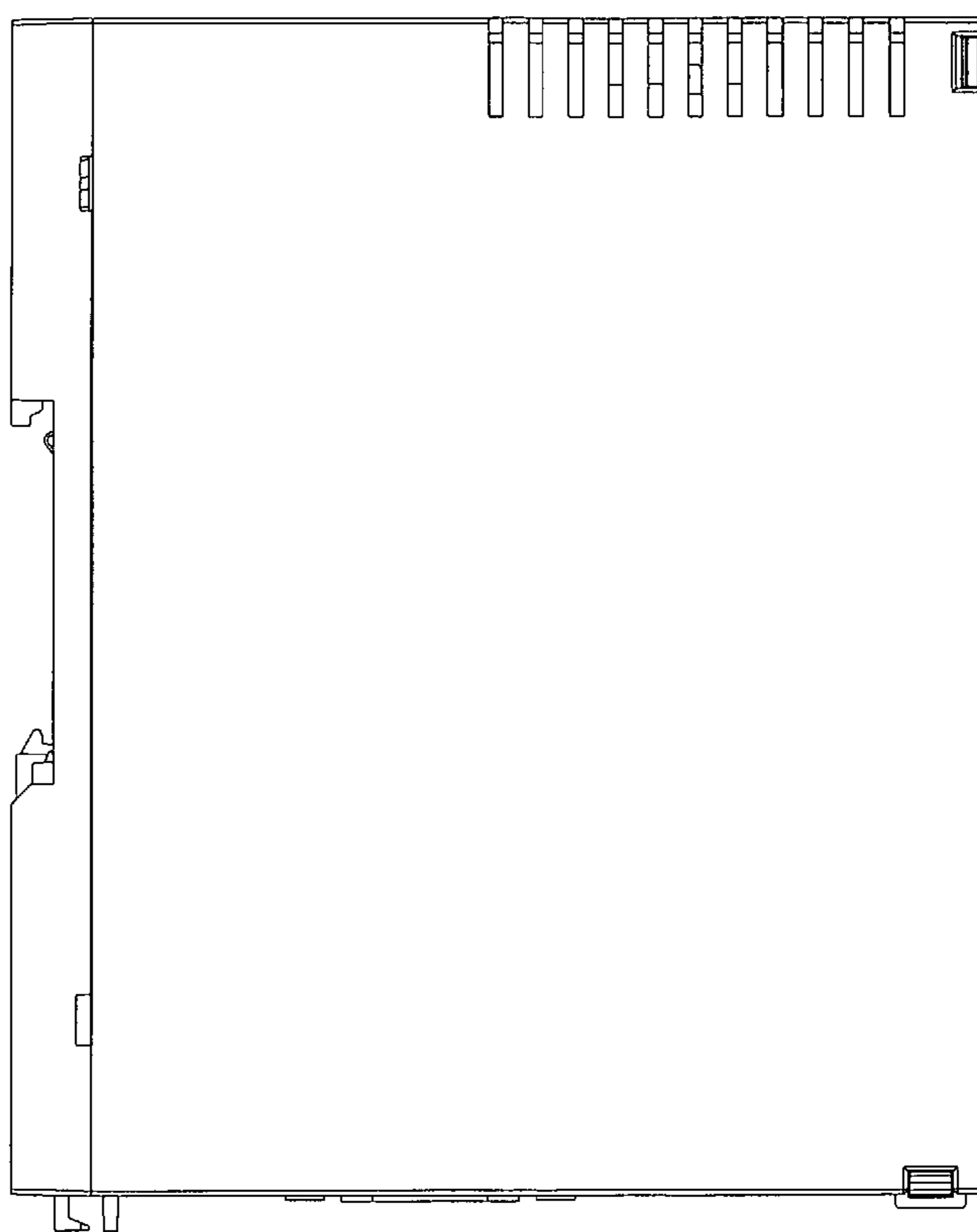
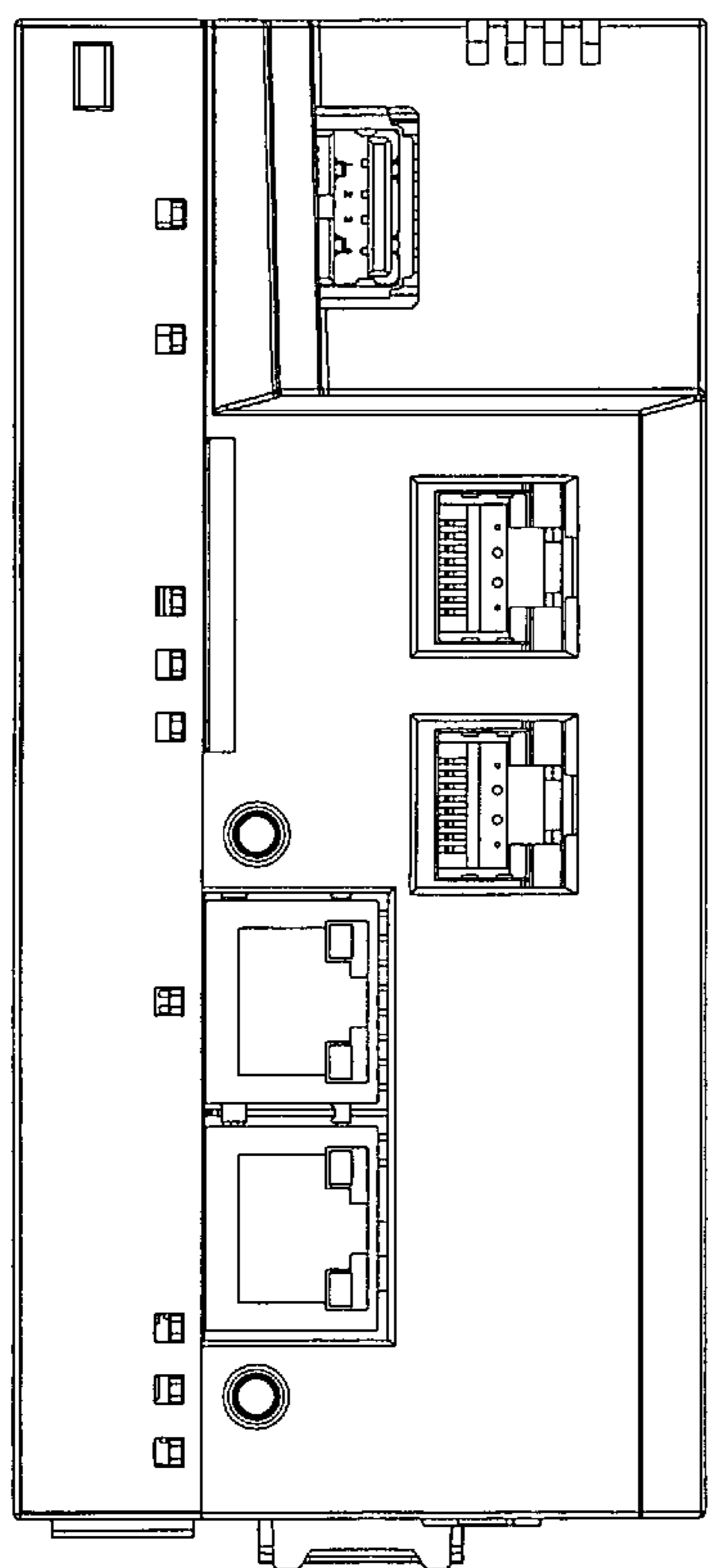

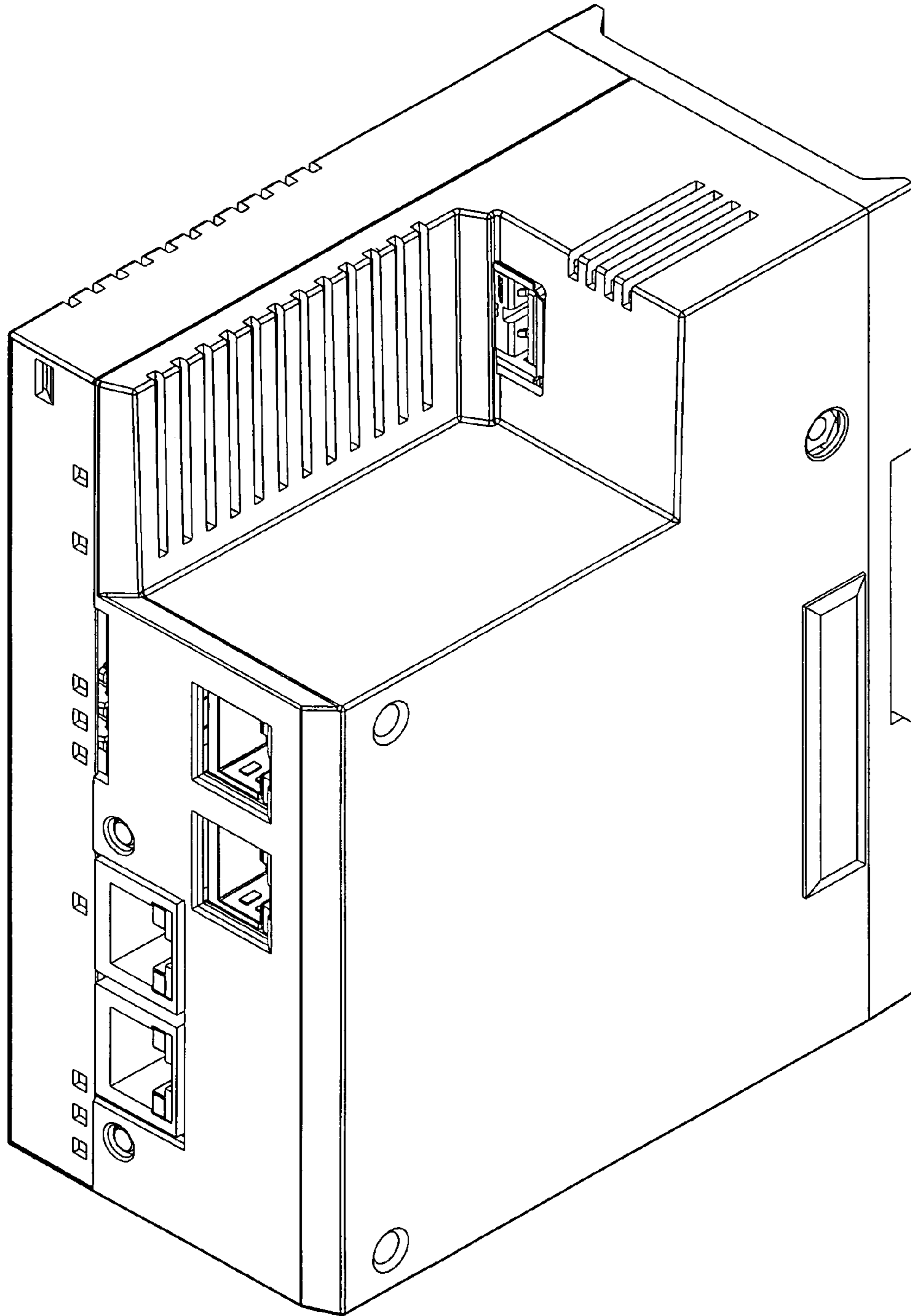

FIG.1

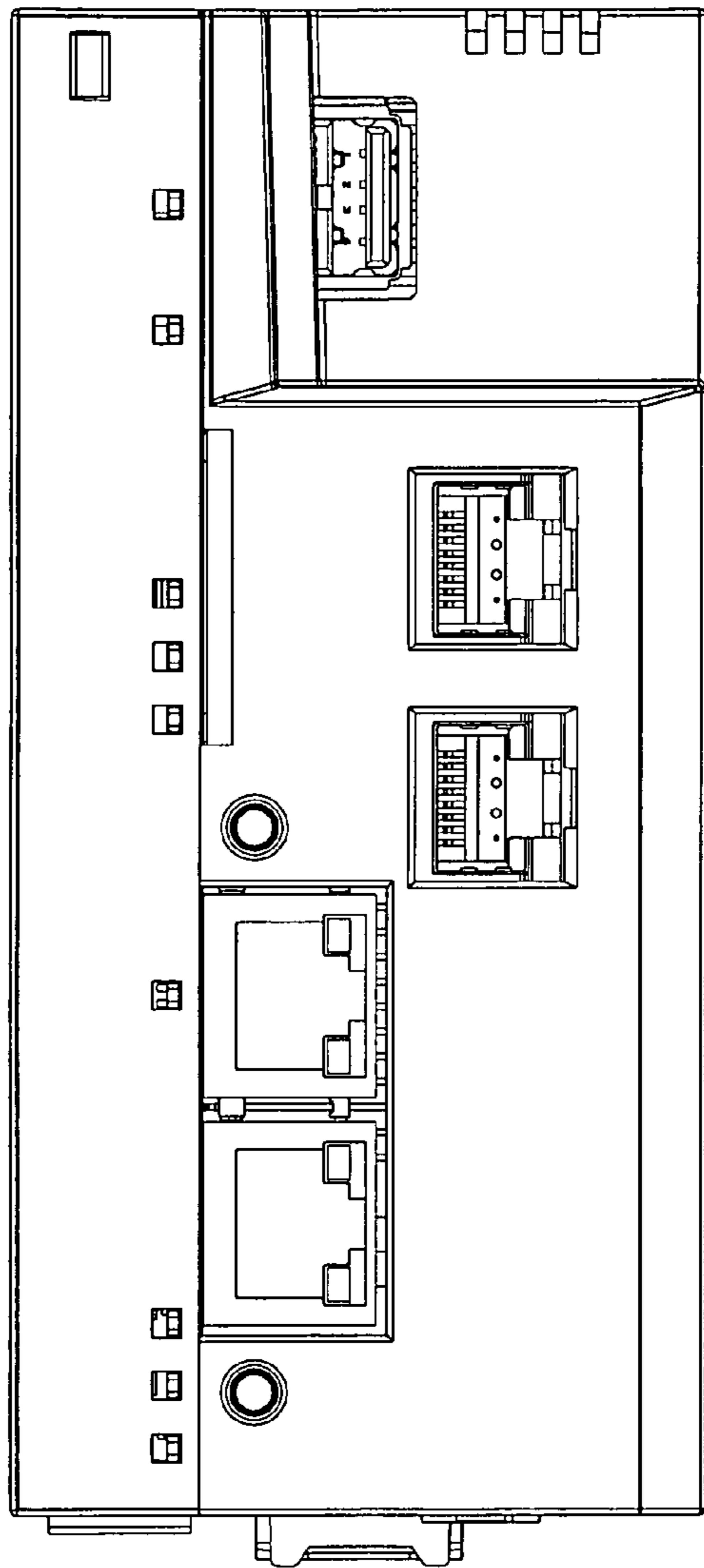

FIG.2

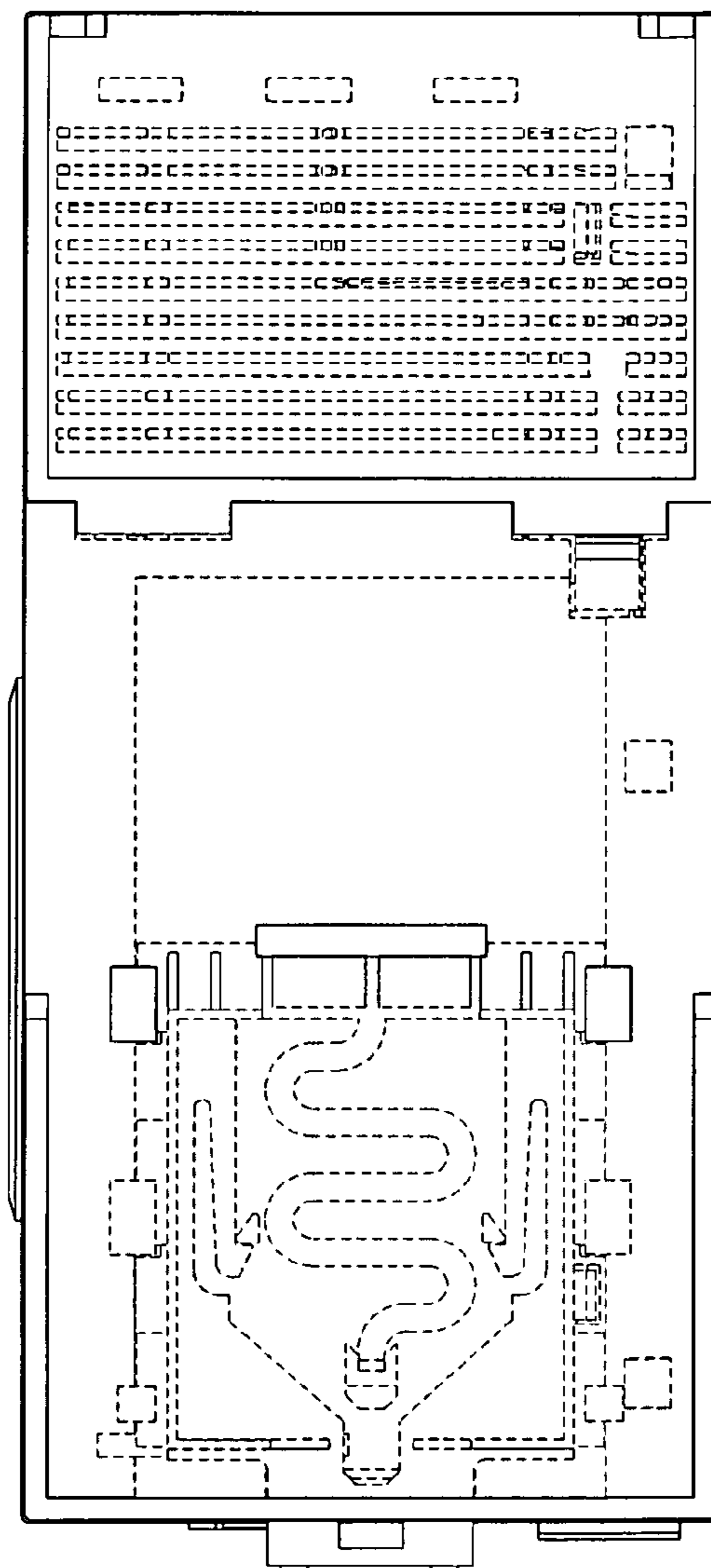

FIG.3

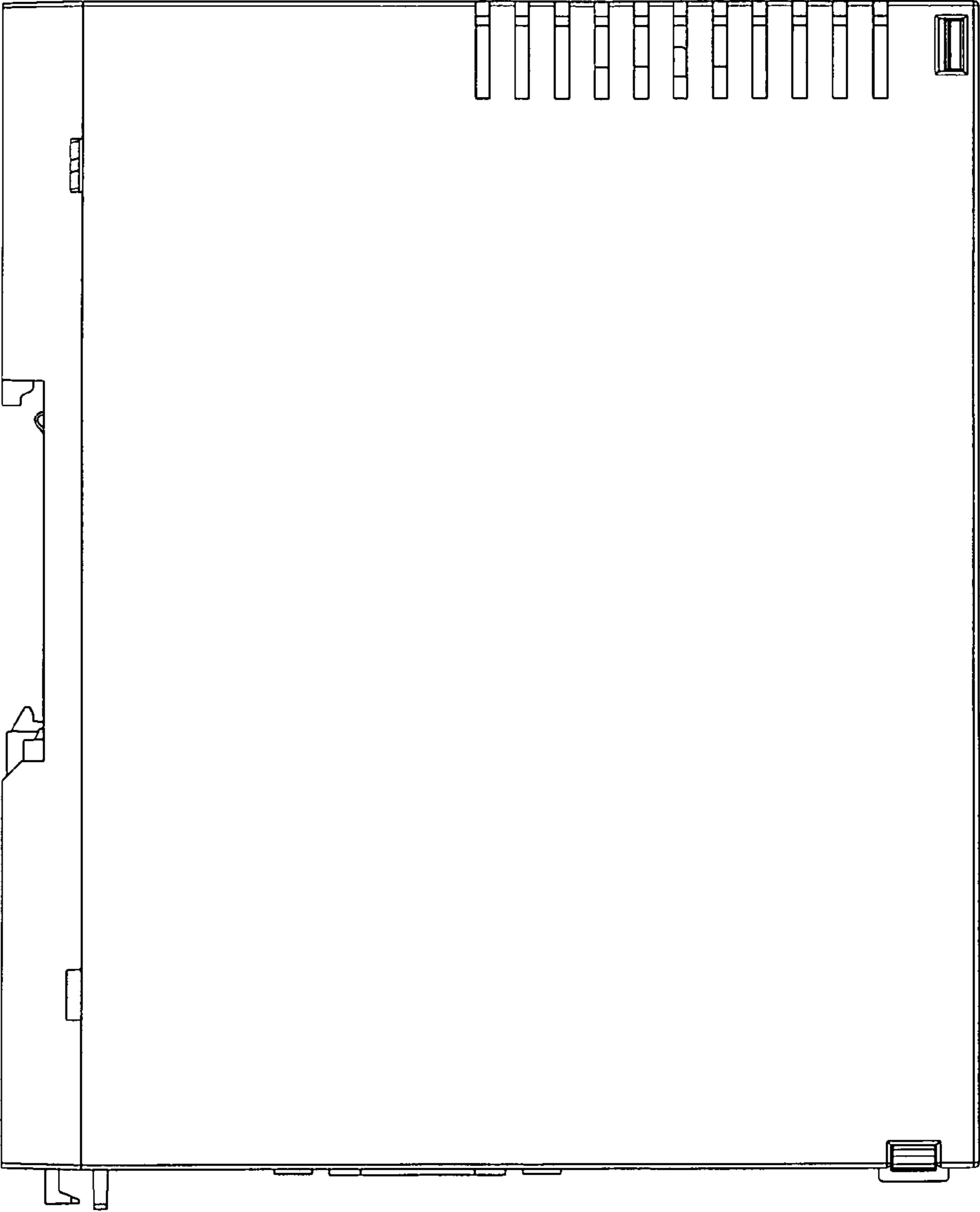

FIG.4

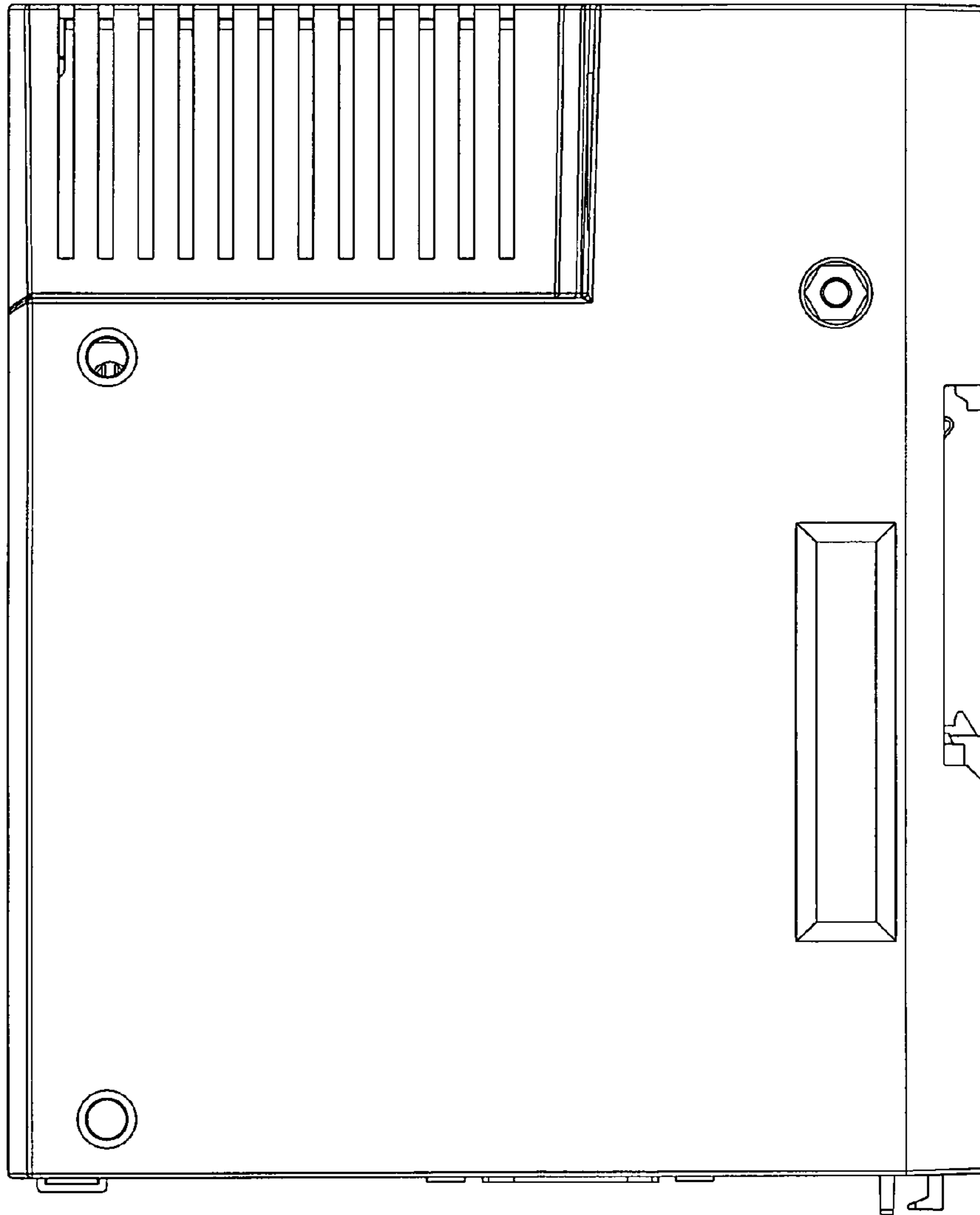

FIG.5

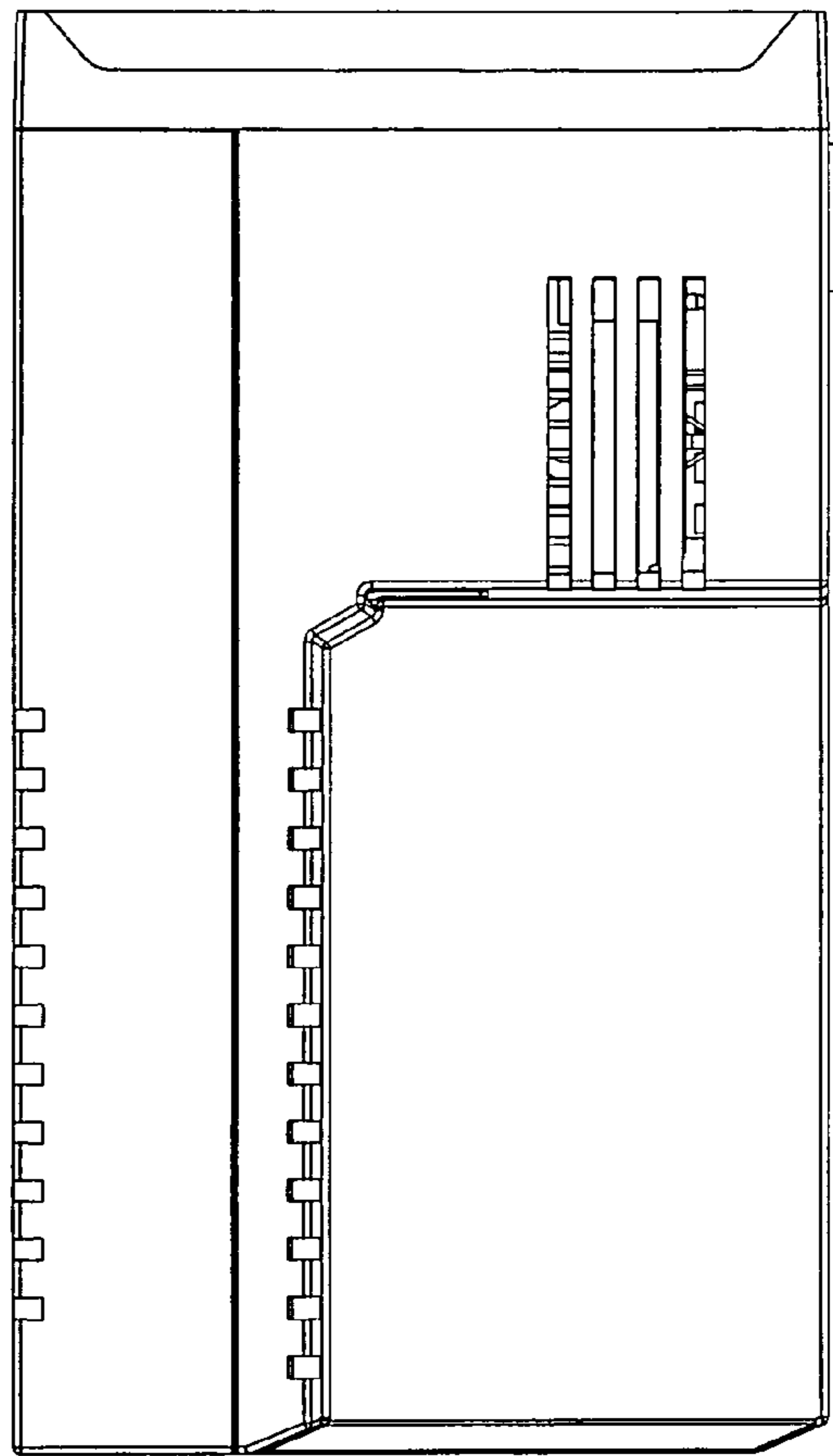

FIG. 6

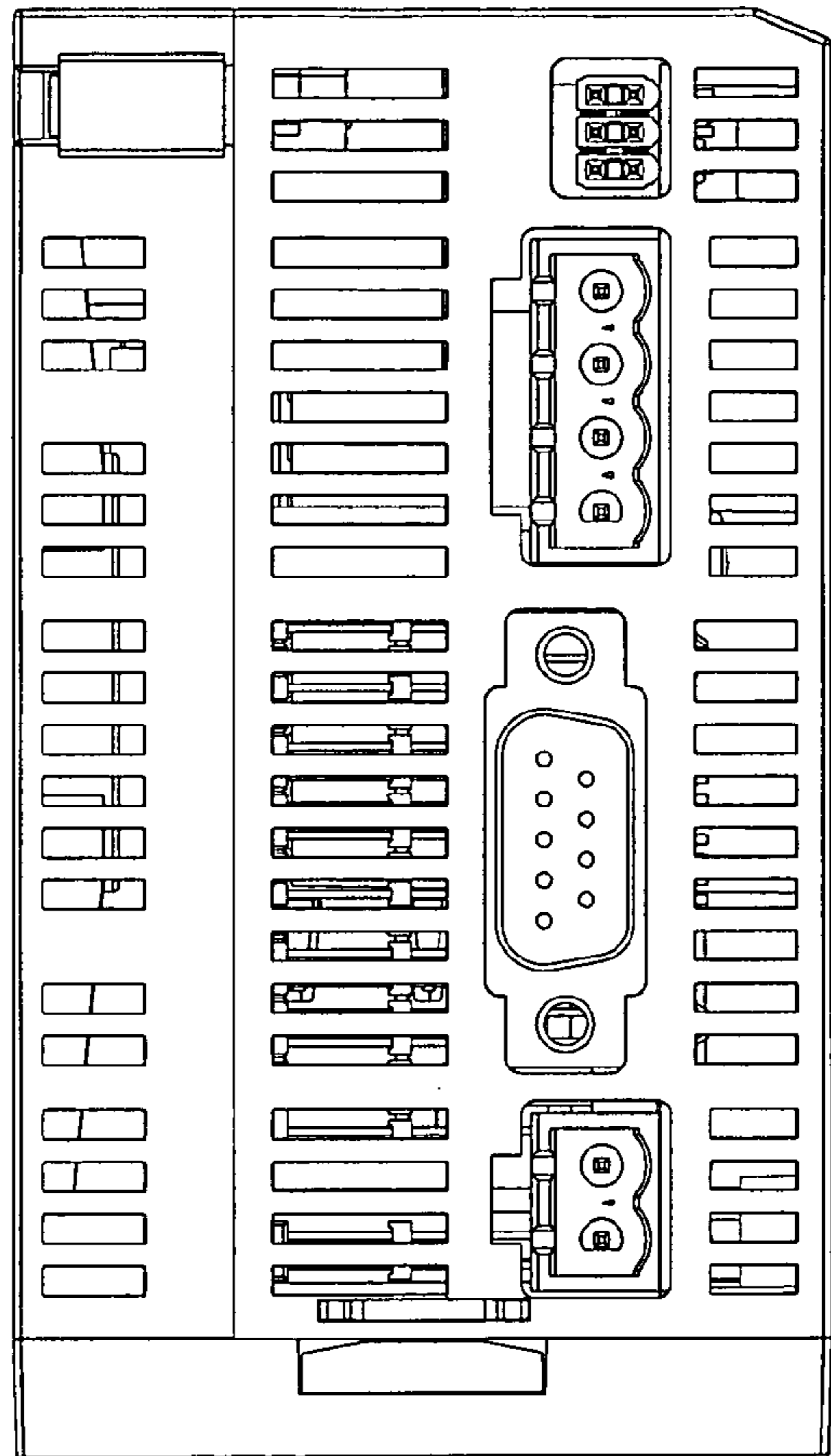

FIG.7

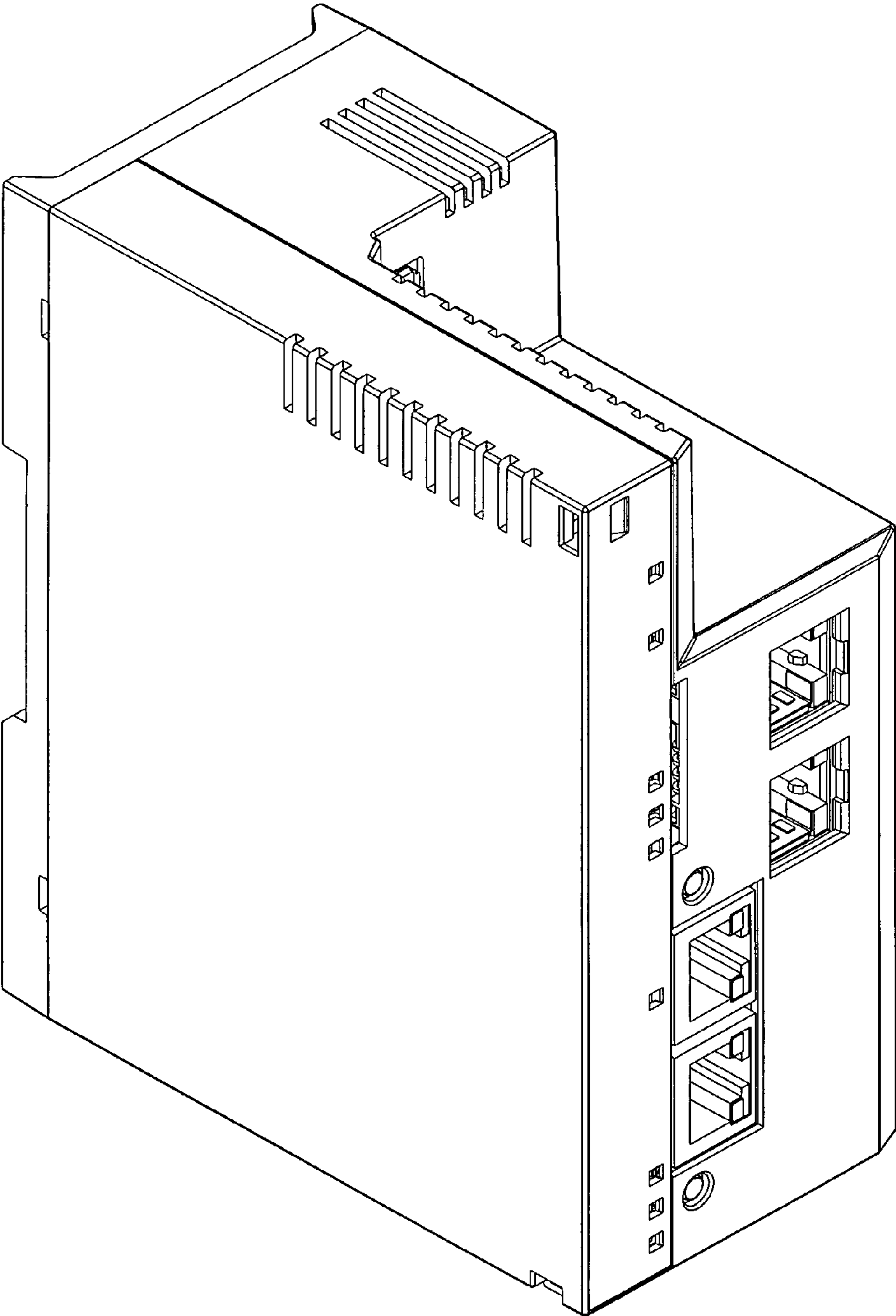

FIG.8

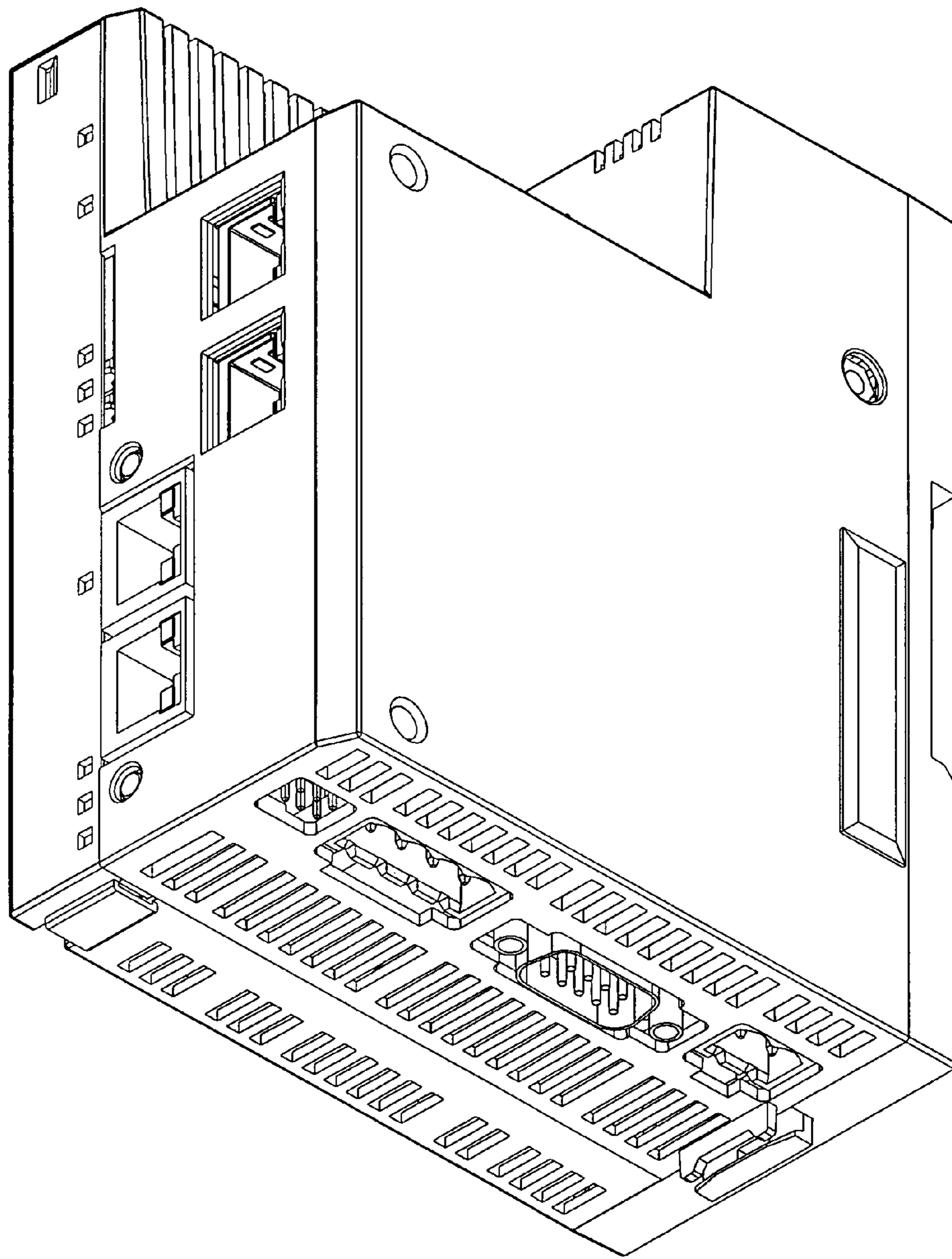

FIG.9

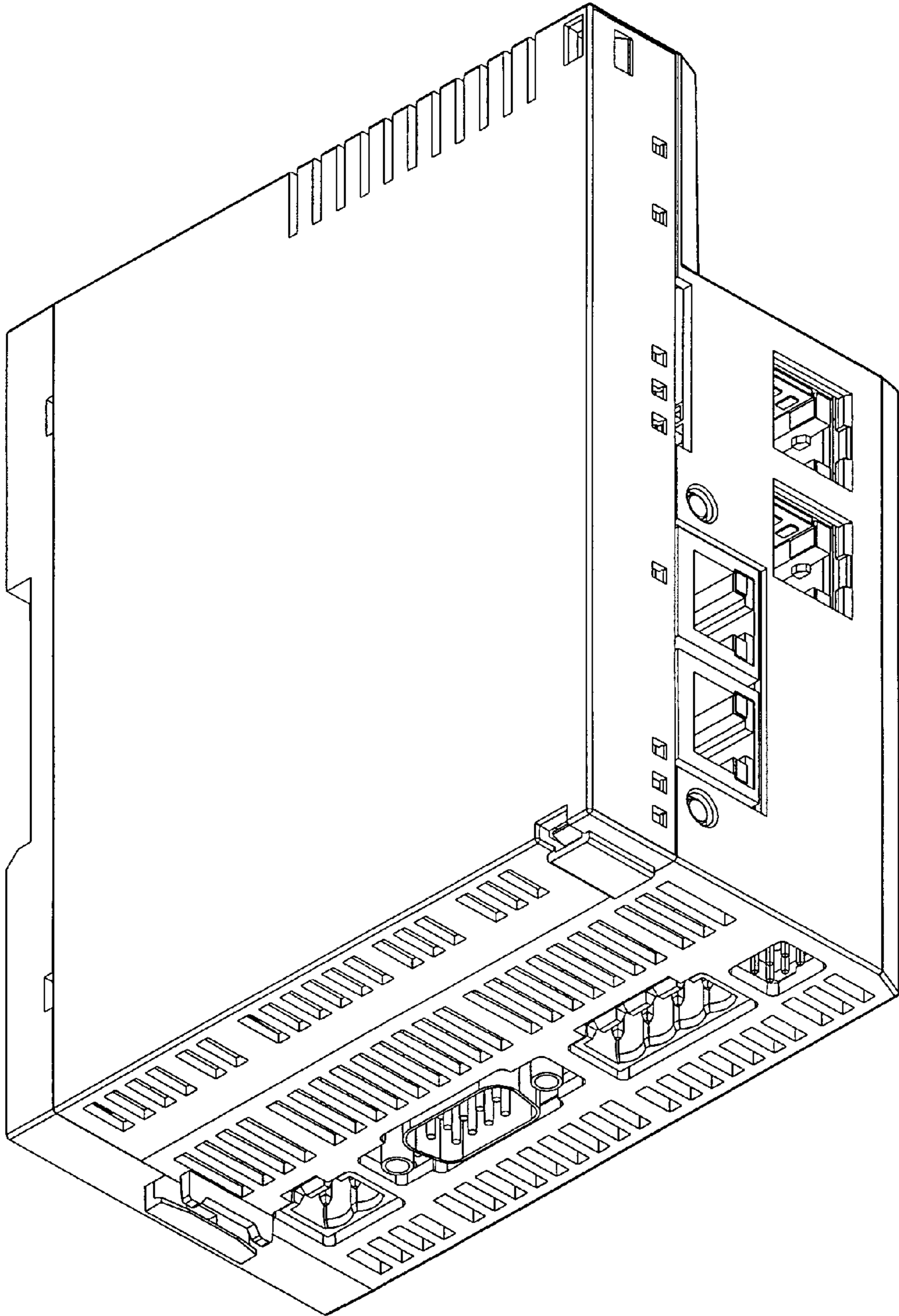

FIG.10