



US00D661815S

(12) **United States Design Patent**  
**Tobbe**

(10) **Patent No.:** **US D661,815 S**  
(45) **Date of Patent:** **\*\* Jun. 12, 2012**

(54) **INSULATION BARRIER FOR CEILING  
HATCH OPENINGS**

7,337,584 B2 \* 3/2008 Viens ..... 52/20  
D586,473 S \* 2/2009 Copeland ..... D25/48  
7,926,229 B2 \* 4/2011 Melesky ..... 52/19

(76) Inventor: **Norbert Tobbe**, Chagrin Falls, OH (US)

\* cited by examiner

(\*\*) Term: **14 Years**

*Primary Examiner* — Robert Delehanty

(21) Appl. No.: **29/378,731**

(74) *Attorney, Agent, or Firm* — Pradip K. Sahu

(22) Filed: **Nov. 9, 2010**

(57) **CLAIM**

The ornamental design for an insulation barrier for ceiling hatch openings, as shown and described.

(51) **LOC (9) Cl.** ..... **23-02**

(52) **U.S. Cl.** ..... **D25/60**

(58) **Field of Classification Search** ..... 52/39, 220.1,  
52/220.8, 302.1, 19, 202, 404.3, 404.4, 404.5,  
52/407.3, 407.4, 646, 64; D25/55, 60, 62,  
D25/68-69, 47-48, 56, 58

**DESCRIPTION**

See application file for complete search history.

FIG. 1 is a top perspective, exploded view of a first embodiment of the present insulation barrier for ceiling hatch openings;

FIG. 2 is a bottom perspective, partially exploded view of same;

FIG. 3 is a top, partially exploded view of the dam shown in FIG. 2;

FIG. 4 is a bottom view of same;

FIG. 5 is a left side view of same;

FIG. 6 is a right side view of same; and,

FIG. 7 is a top view of the fully assembled insulation barrier for ceiling hatch openings.

(56) **References Cited**

U.S. PATENT DOCUMENTS

4,281,743	A *	8/1981	Fuller	.....	182/46
4,312,423	A *	1/1982	Helbig	.....	182/46
4,344,505	A *	8/1982	Waters et al.	.....	182/47
5,161,329	A *	11/1992	Brown	.....	D25/48
5,628,151	A *	5/1997	Monat	.....	52/404.4
6,966,153	B2 *	11/2005	Panetta et al.	.....	52/19

**1 Claim, 4 Drawing Sheets**

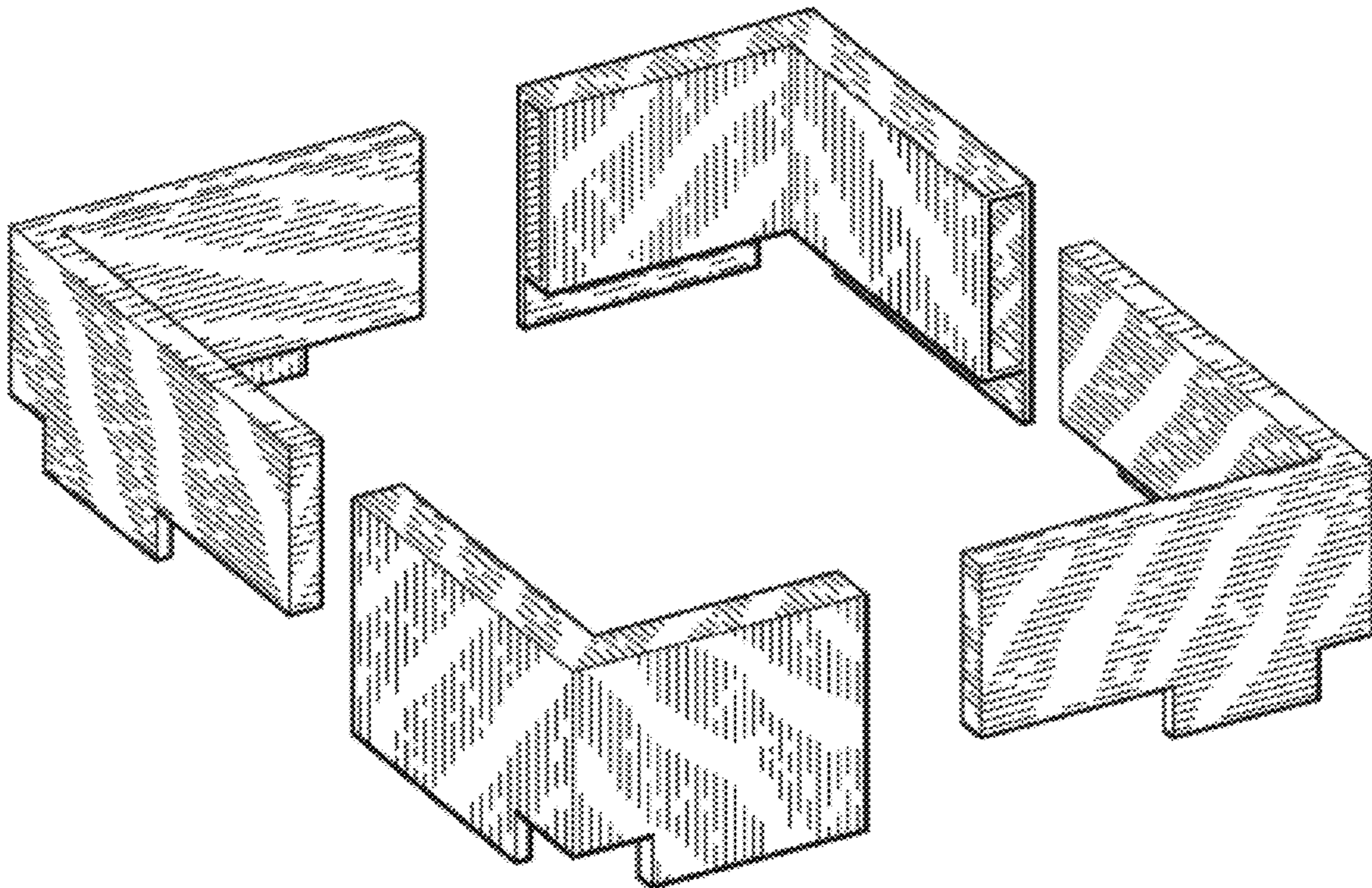

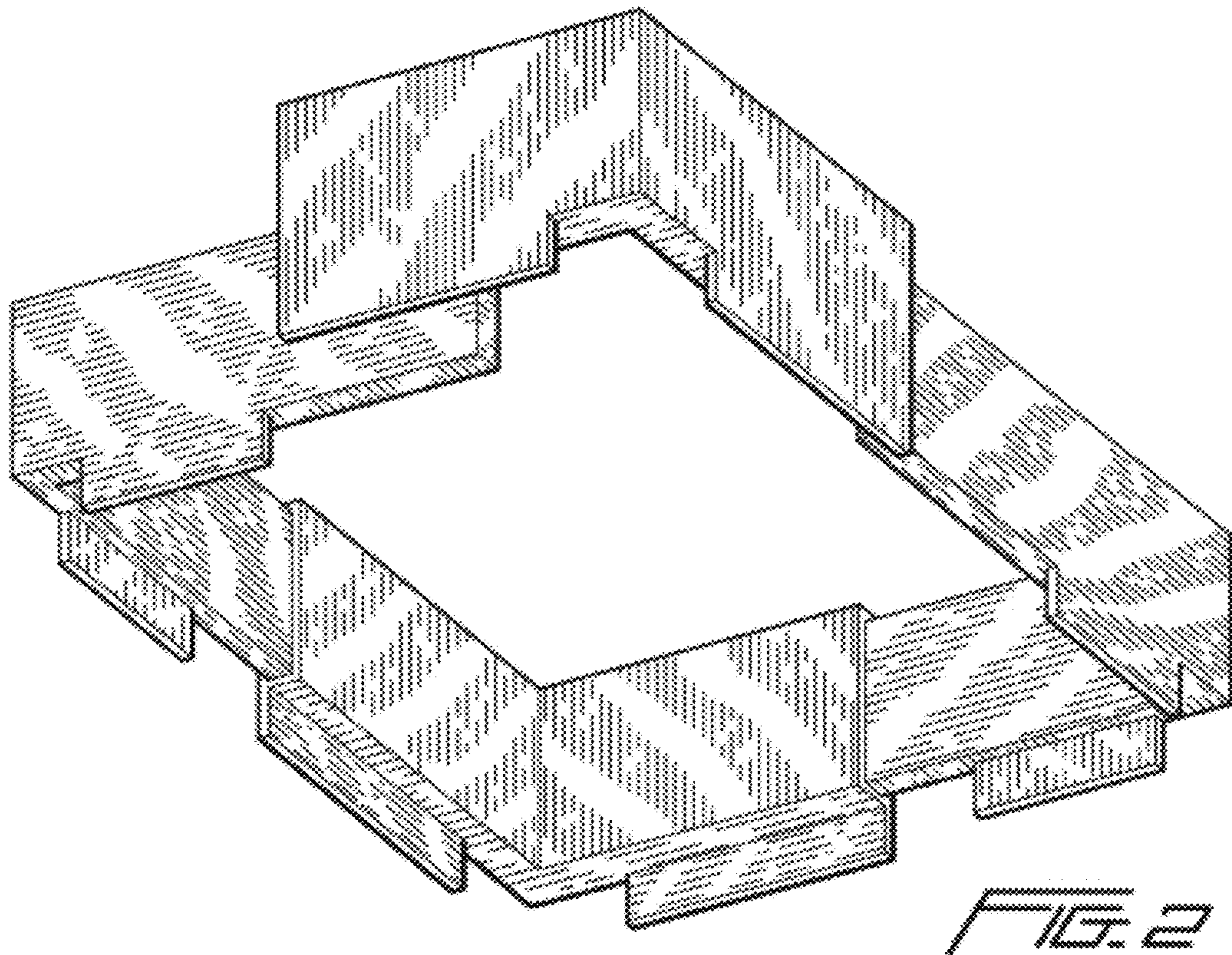
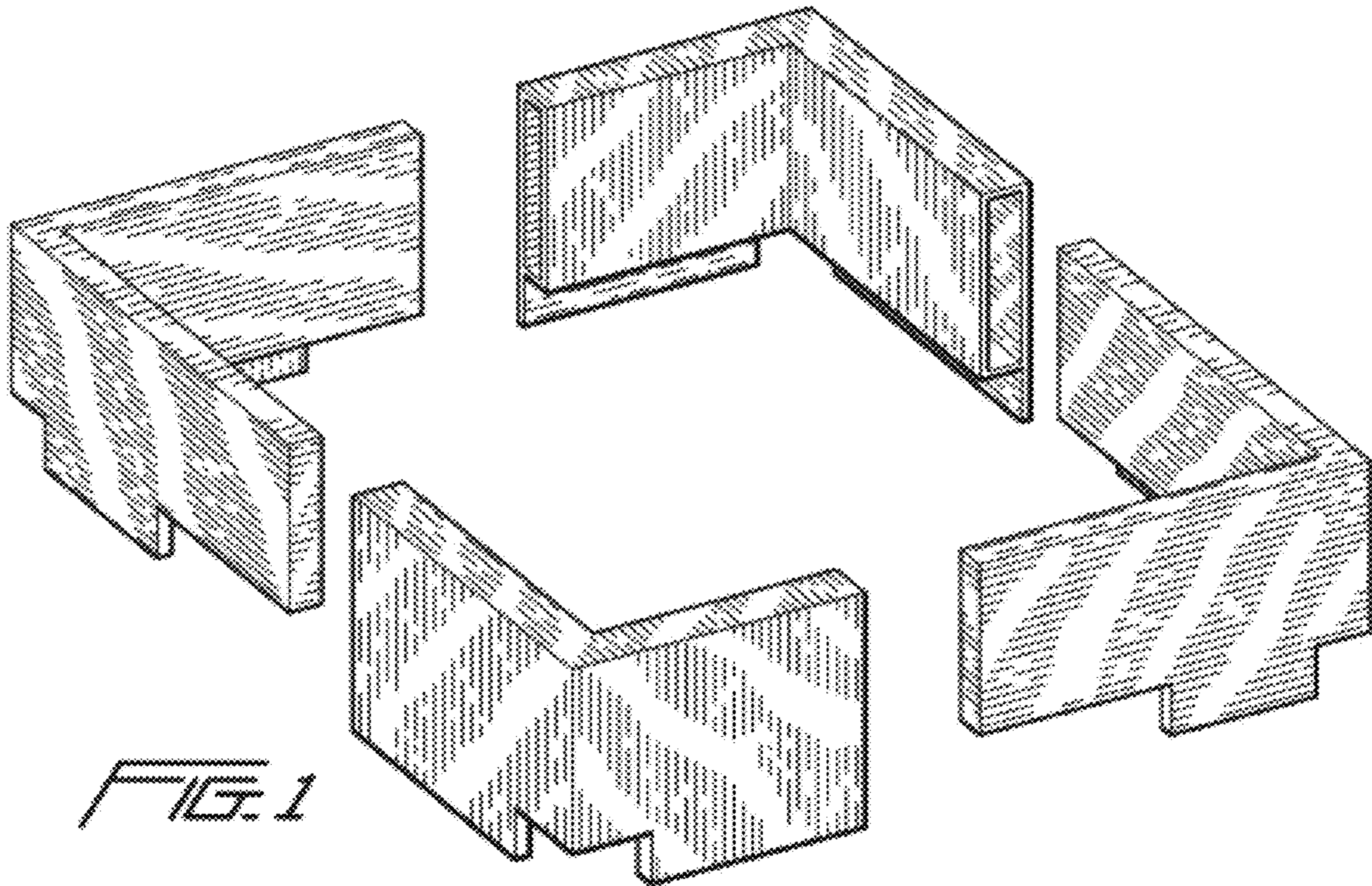

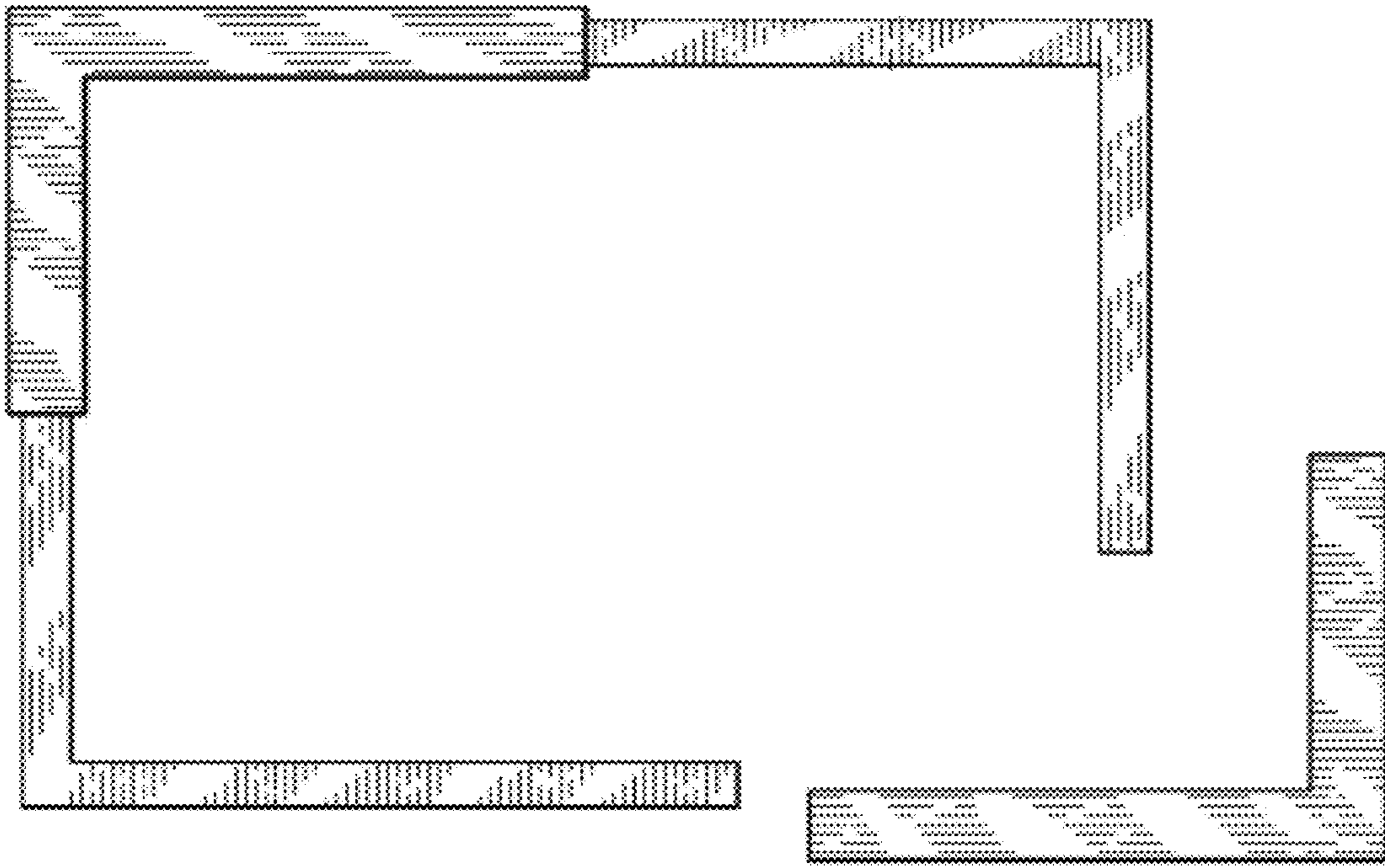

FIG. 3

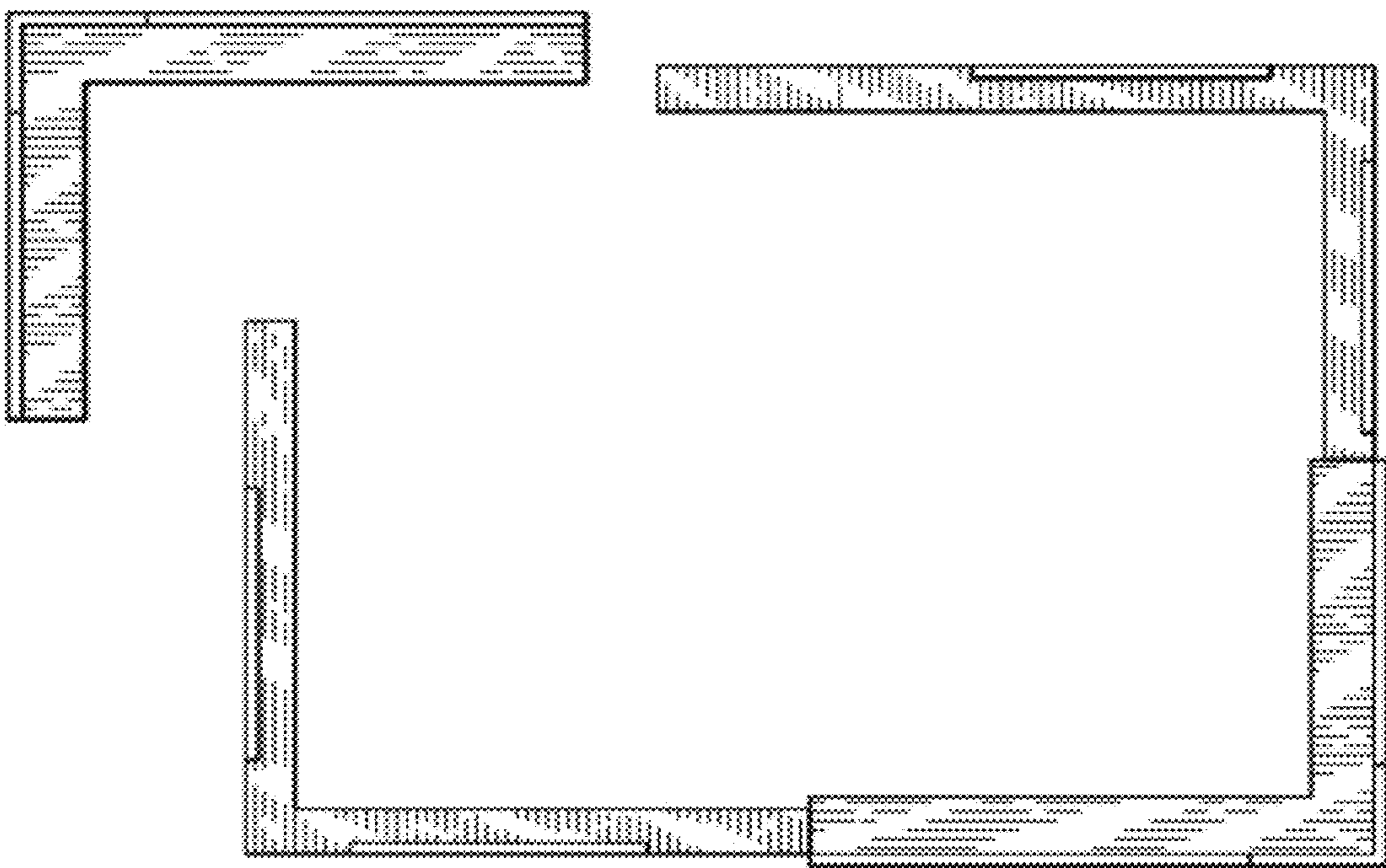

FIG. 4

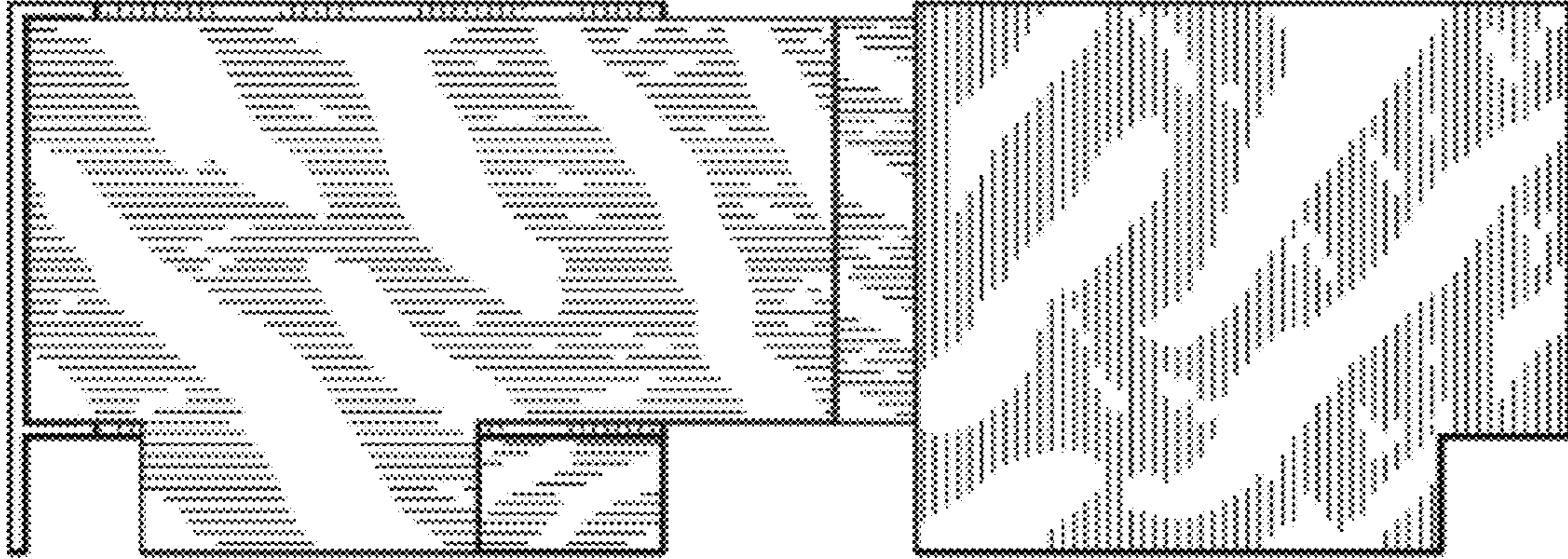

FIG. 5

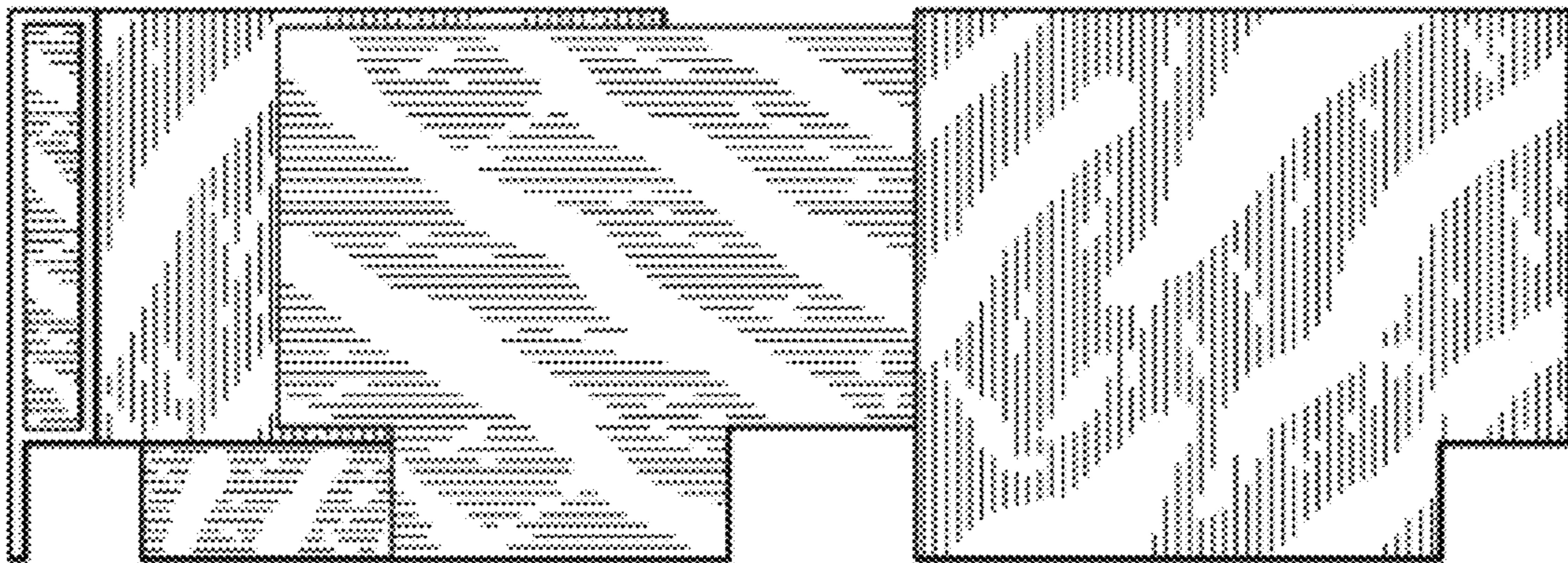

FIG. 6

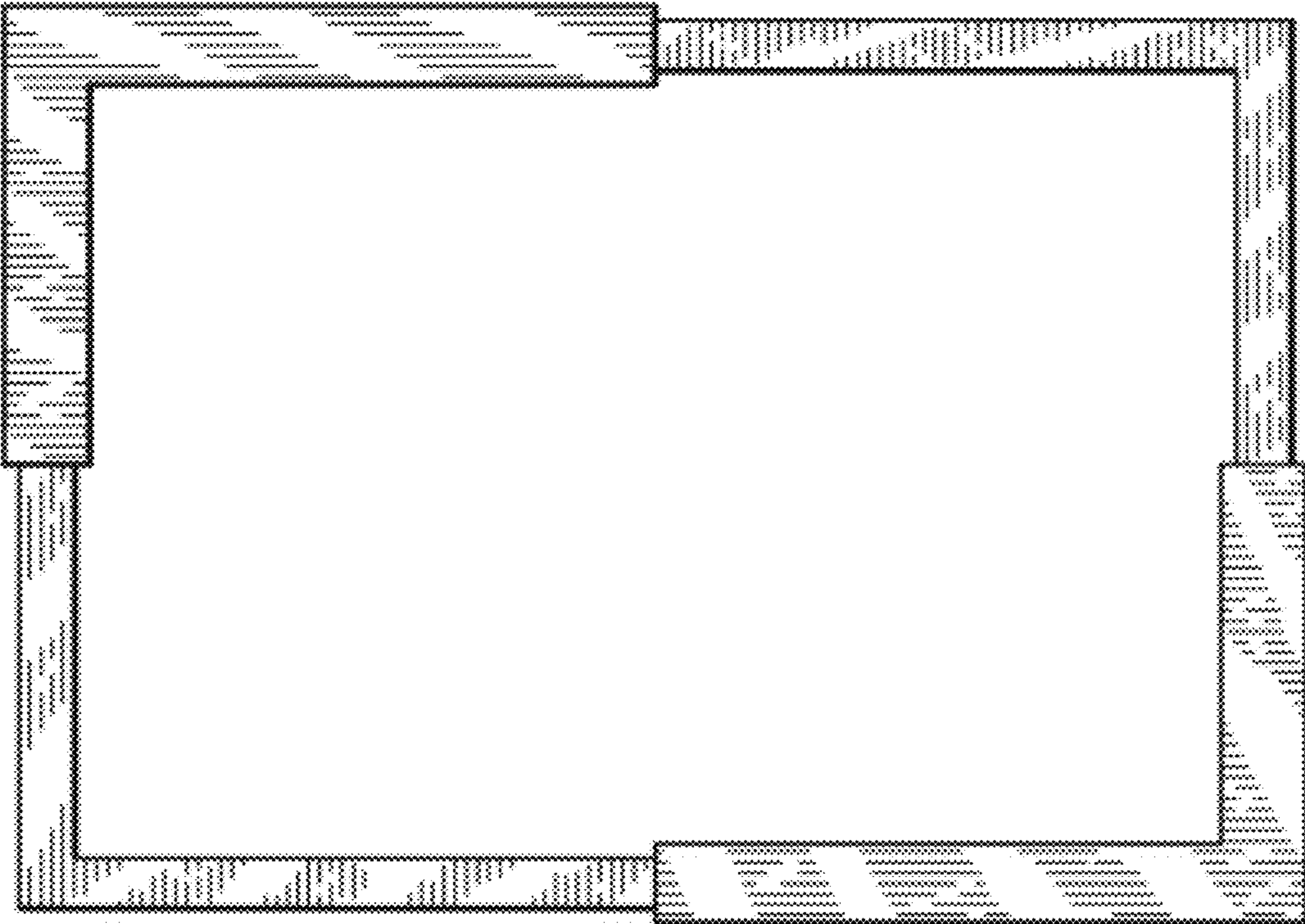

FIG. 7