

US00D661808S

(12) **United States Design Patent**
Kang

(10) **Patent No.:** **US D661,808 S**
(45) **Date of Patent:** **** Jun. 12, 2012**

- (54) **FEMORAL COMPONENT OF AN ARTIFICIAL KNEE JOINT**
- (76) Inventor: **H. Wook Kang**, Seongnam-si (KR)
- (**) Term: **14 Years**
- (21) Appl. No.: **29/408,338**
- (22) Filed: **Dec. 9, 2011**
- (51) **LOC (9) Cl.** **24-02**
- (52) **U.S. Cl.** **D24/155**
- (58) **Field of Classification Search** D24/155, D24/156, 140; 623/20.14–20.17, 20.21, 623/20.27, 20.31, 20.35, 23.56
See application file for complete search history.

- D649,639 S * 11/2011 Bertoni et al. D24/140
- D651,315 S * 12/2011 Bertoni et al. D24/140
- 8,070,821 B2 * 12/2011 Roger 623/20.17
- 2007/0260323 A1 * 11/2007 Earl et al. 623/20.35
- 2009/0125115 A1 * 5/2009 Popoola et al. 623/20.14
- 2010/0016987 A1 * 1/2010 Scrafton et al. 623/23.56
- 2010/0076567 A1 * 3/2010 Justin et al. 623/20.35

* cited by examiner

Primary Examiner — Ian Simmons
Assistant Examiner — Charles Hanson
(74) *Attorney, Agent, or Firm* — IPLA P.A.; James E. Bame

(57) **CLAIM**
The ornamental design for a femoral component of an artificial knee joint, as shown and described.

DESCRIPTION

FIG. 1 is a perspective view of my new design; FIG. 2 is a front elevational view thereof; FIG. 3 is a rear elevational view thereof; FIG. 4 is a left side elevational view thereof; FIG. 5 is a right side elevational view thereof; FIG. 6 is a top plan view there; and, FIG. 7 is a bottom plan view thereof.

1 Claim, 4 Drawing Sheets

- (56) **References Cited**
- U.S. PATENT DOCUMENTS
- 4,659,331 A * 4/1987 Matthews et al. 623/20.21
- D291,003 S * 7/1987 Huckstep D24/155
- 4,959,071 A * 9/1990 Brown et al. 623/20.27
- D374,078 S * 9/1996 Johnson et al. D24/155
- 6,344,059 B1 * 2/2002 Krakovits et al. 623/20.31
- D473,307 S * 4/2003 Cooke D24/155
- D625,415 S * 10/2010 Otto et al. D24/155
- 7,892,288 B2 * 2/2011 Blaylock et al. 623/20.15

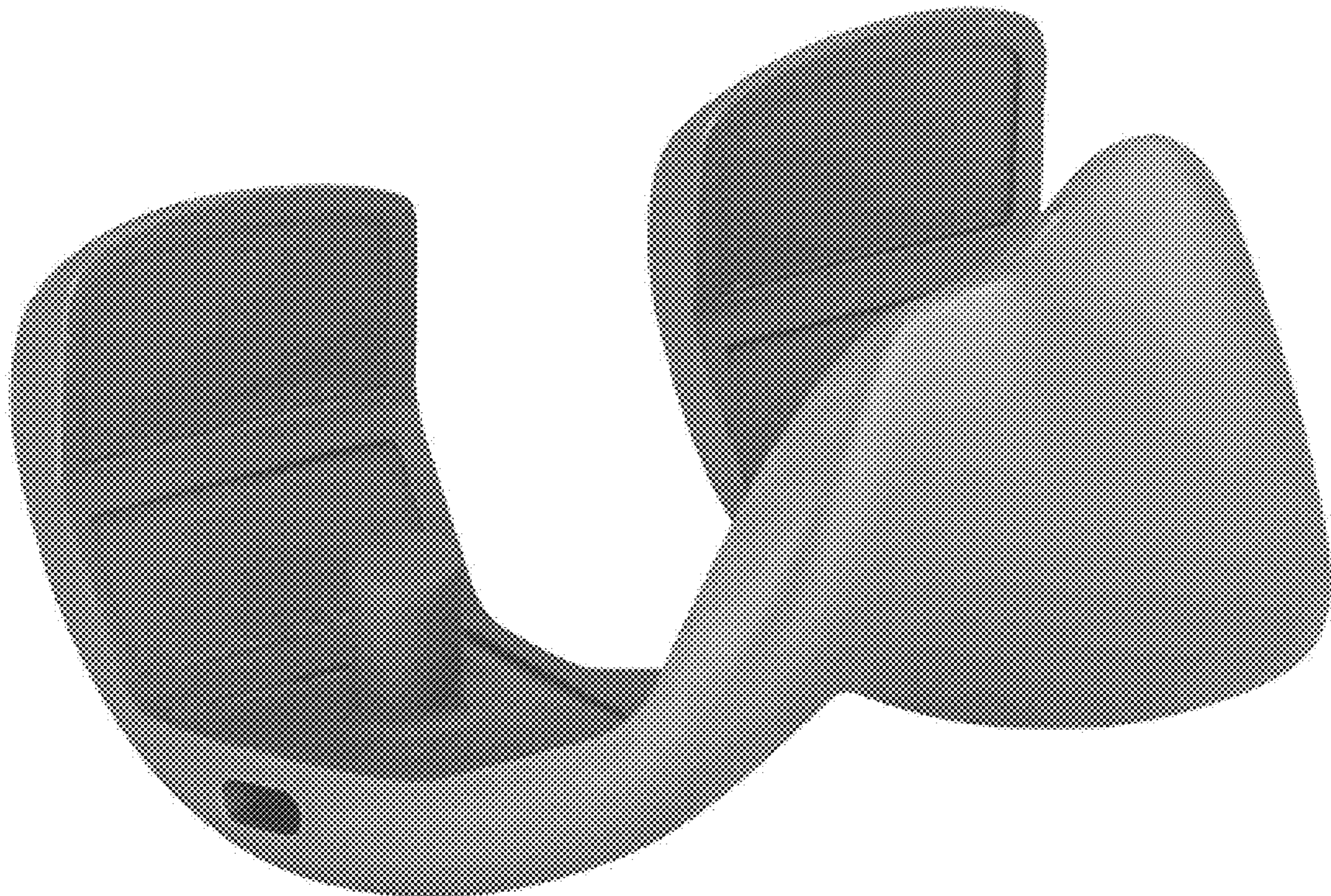

FIG. 1



FIG. 2

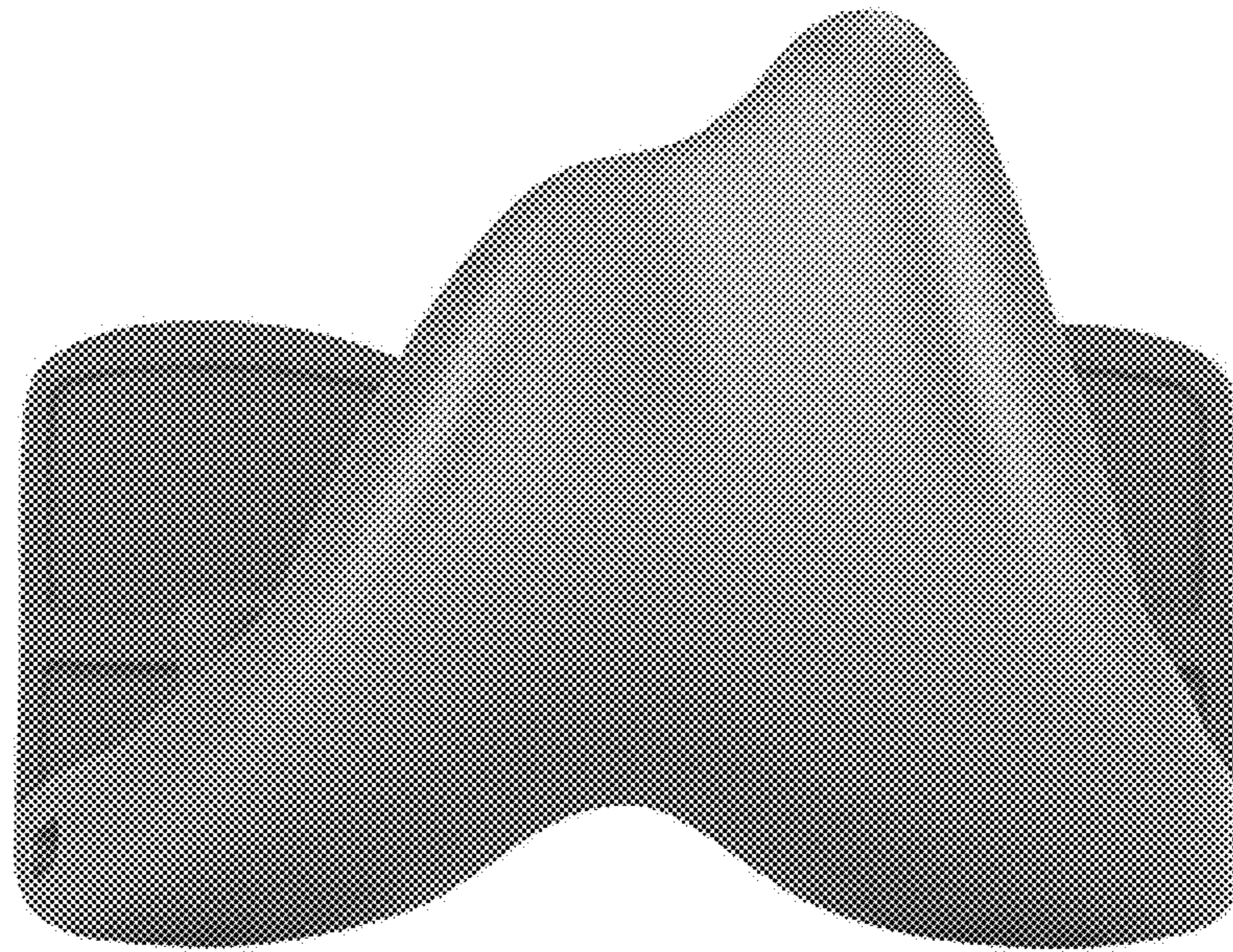

FIG. 3

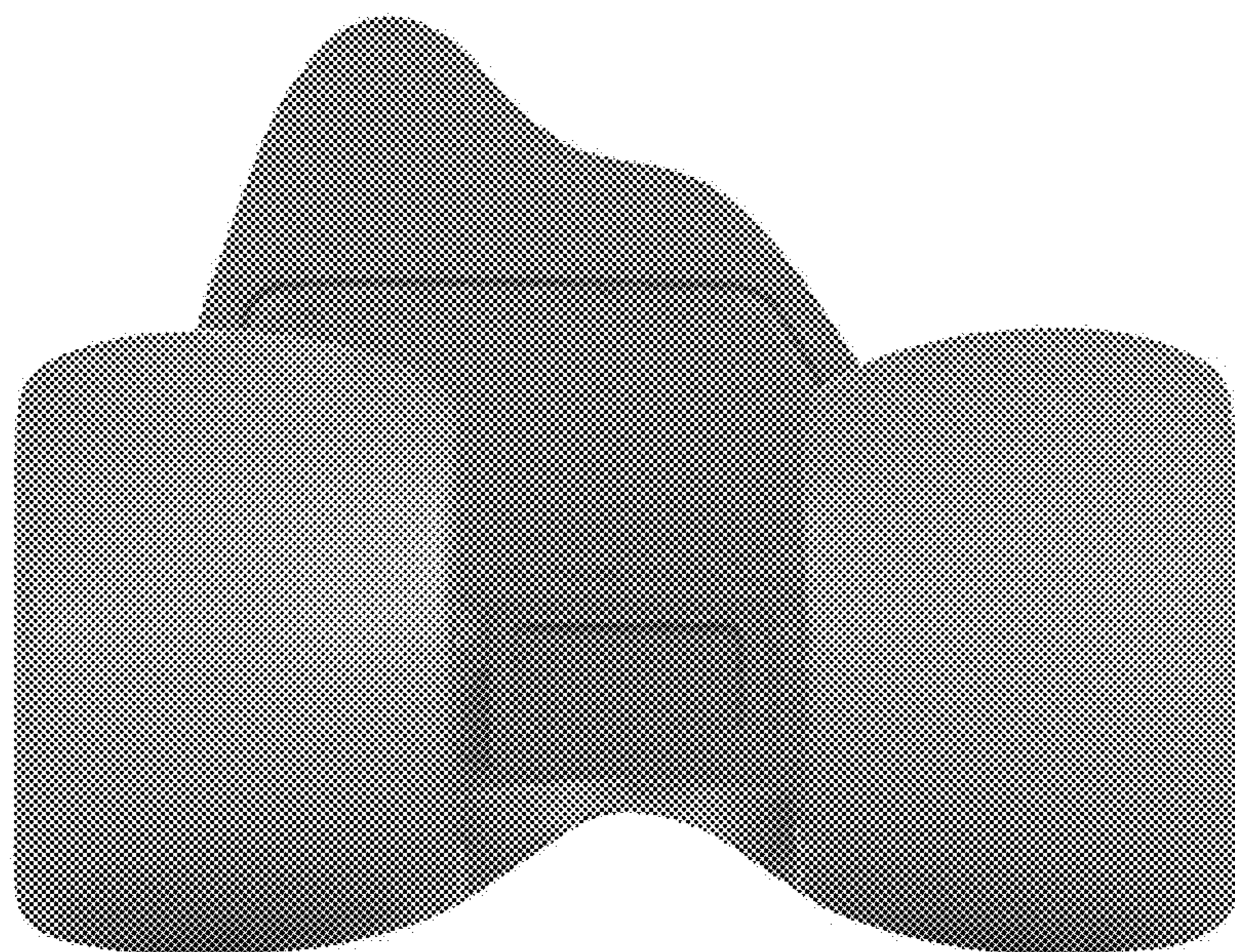

FIG. 4

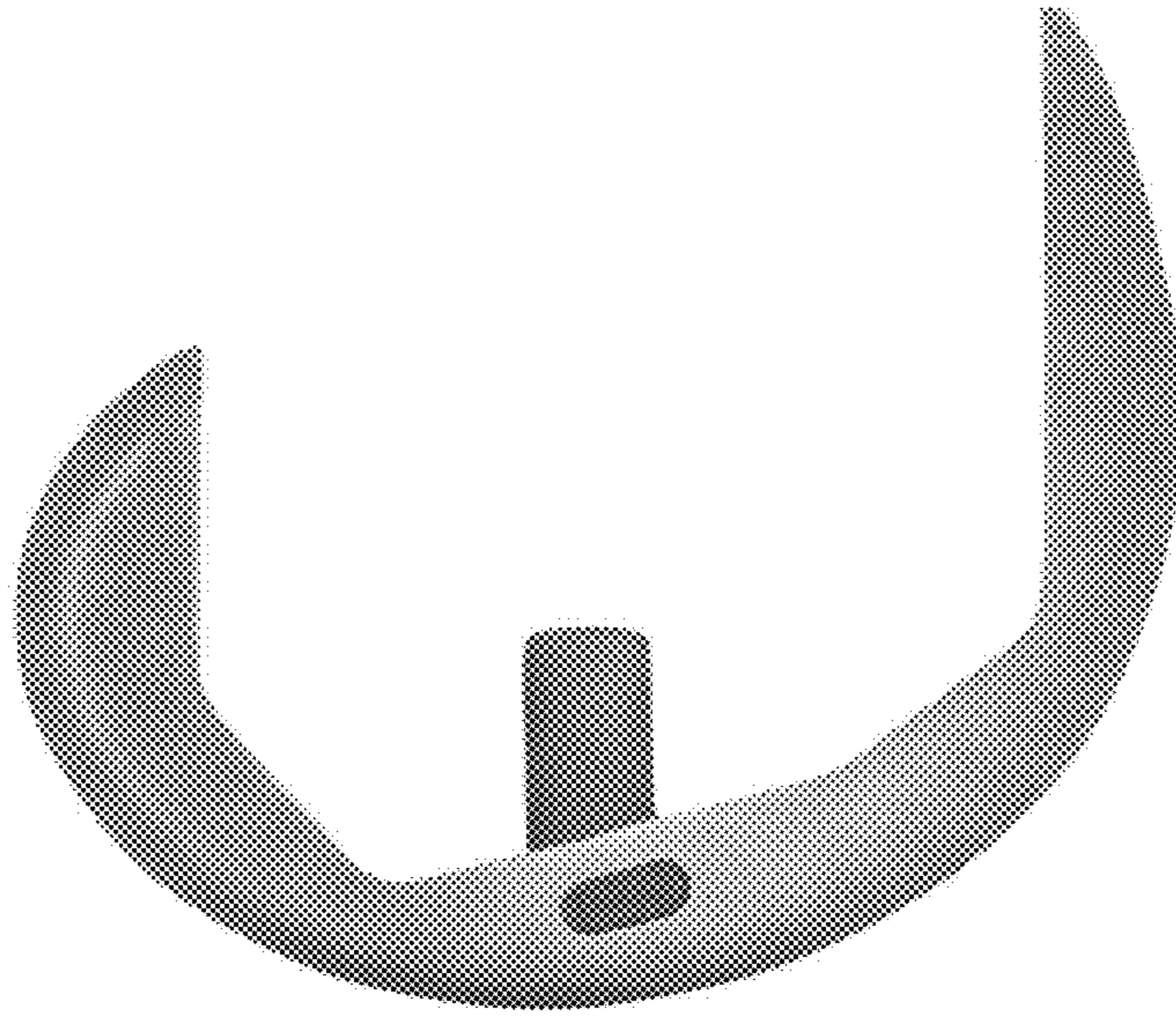

FIG. 5

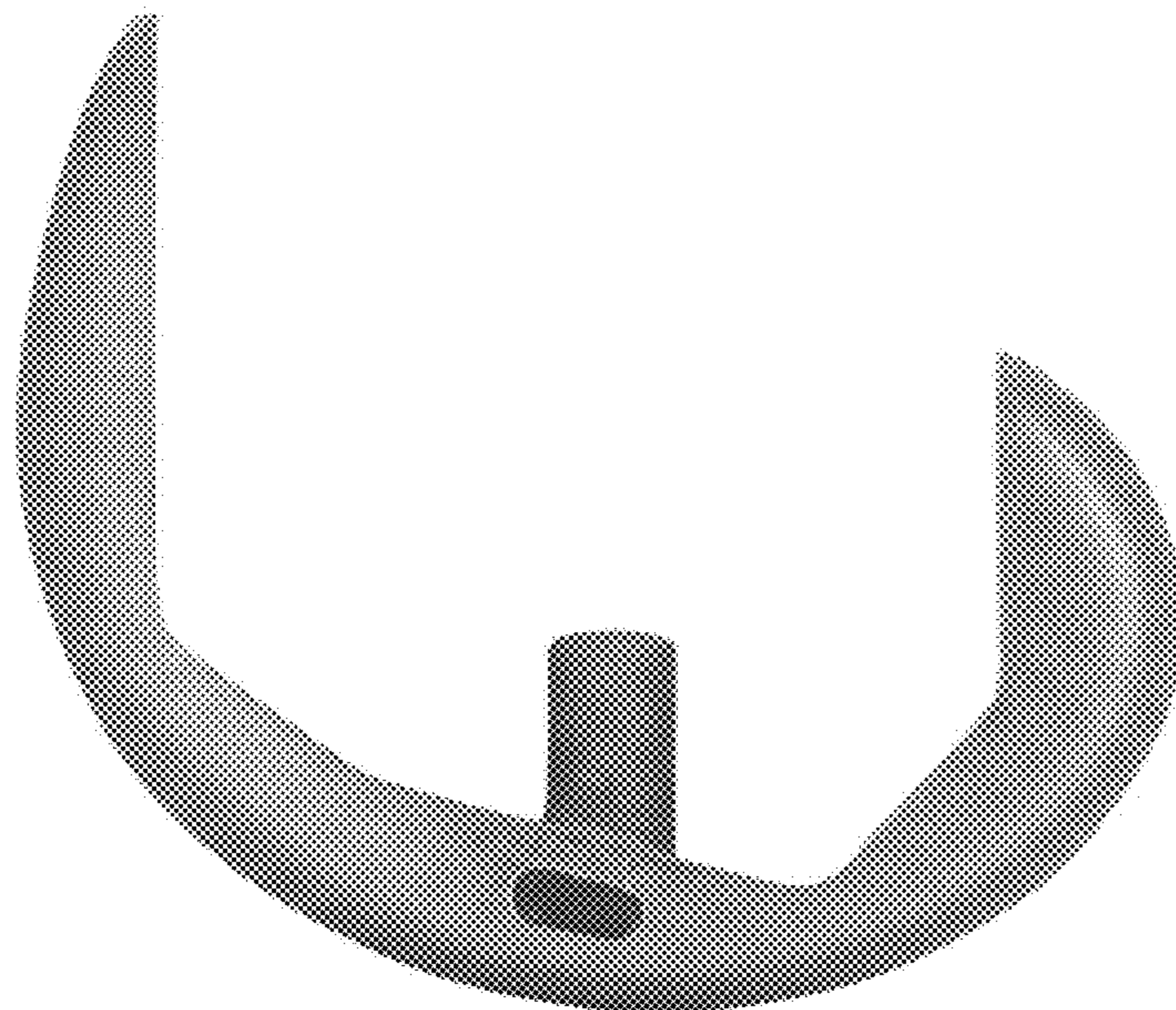

FIG. 6



FIG. 7

