



US00D661786S

(12) **United States Design Patent**
Johnson

(10) **Patent No.:** **US D661,786 S**
(45) **Date of Patent:** **** *Jun. 12, 2012**

- (54) **DISPENSING CONNECTOR COLLAR WITH A DOUBLE BARB**
 - (75) Inventor: **James Johnson**, Delaware, OH (US)
 - (73) Assignee: **Liqui-Box Corporation**, Worthington, OH (US)
 - (*) Notice: This patent is subject to a terminal disclaimer.
 - (**) Term: **14 Years**
 - (21) Appl. No.: **29/379,023**
 - (22) Filed: **Nov. 12, 2010**
 - (51) **LOC (9) Cl.** **23-01**
 - (52) **U.S. Cl.** **D23/262**
 - (58) **Field of Classification Search** D23/259–268;
137/614.03; 141/346–351, 383–385; 251/149.6,
251/149.1
- See application file for complete search history.

- 6,347,785 B1 * 2/2002 Copp et al. 251/149.6
- 6,375,157 B1 * 4/2002 Van de Lande 251/327
- 6,637,725 B2 10/2003 Davis et al.
- 6,648,016 B2 * 11/2003 Farrenkopf et al. 137/588
- 6,779,556 B2 * 8/2004 Roethel 137/614.03
- D501,673 S * 2/2005 Bressler et al. D23/262
- D508,111 S * 8/2005 Karasawa D23/262
- 6,953,070 B1 * 10/2005 Labinski et al. 141/351

(Continued)

FOREIGN PATENT DOCUMENTS

CA 2371239 A1 12/2000

(Continued)

Primary Examiner — T. Chase Nelson
Assistant Examiner — Eric Goodman
(74) *Attorney, Agent, or Firm* — Potter Anderson Corroon LLP; Rakesh H. Mehta, Esq

(57) **CLAIM**
The ornamental design for dispensing connector collar with a double barb, as shown and described.

DESCRIPTION

FIG. 1 is a top perspective view of a dispensing connector collar with a double barb.
FIG. 2 is a bottom perspective view of the dispensing connector collar with a double barb.
FIG. 3 is a side view of the dispensing connector collar with a double barb.
FIG. 4 is a back side view of the dispensing connector collar with a double barb.
FIG. 5 is a top view of the dispensing connector collar with a double barb; and,
FIG. 6 is a bottom view of the dispensing connector collar with a double barb.
The broken line showing in FIG. 6 is included for the purpose of illustrating portions of the article and forms no part of the claimed design.

1 Claim, 6 Drawing Sheets

(56) **References Cited**

U.S. PATENT DOCUMENTS

- 3,495,057 A * 2/1970 Golota 218/88
- 4,286,636 A 9/1981 Credle
- 4,421,146 A * 12/1983 Bond et al. 141/349
- 4,445,551 A * 5/1984 Bond et al. 141/349
- 4,564,132 A 1/1986 Lloyd-Davies
- 5,031,662 A * 7/1991 Roethel 137/614.03
- 5,095,962 A * 3/1992 Lloyd-Davies et al. 141/346
- 5,680,970 A * 10/1997 Smith et al. 222/514
- 5,697,410 A * 12/1997 Rutter et al. 141/346
- 5,746,247 A * 5/1998 Schlecht et al. 137/625.45
- D397,767 S * 9/1998 Gustafsson D23/237
- 5,823,224 A * 10/1998 Gomez 137/240
- 5,832,737 A * 11/1998 Moilanen 62/228.5
- 5,901,761 A * 5/1999 Rutter et al. 141/346
- 5,950,665 A * 9/1999 Claus 137/384.2
- 5,983,964 A * 11/1999 Zielinski et al. 141/346
- D421,098 S * 2/2000 Wrigley et al. D23/249

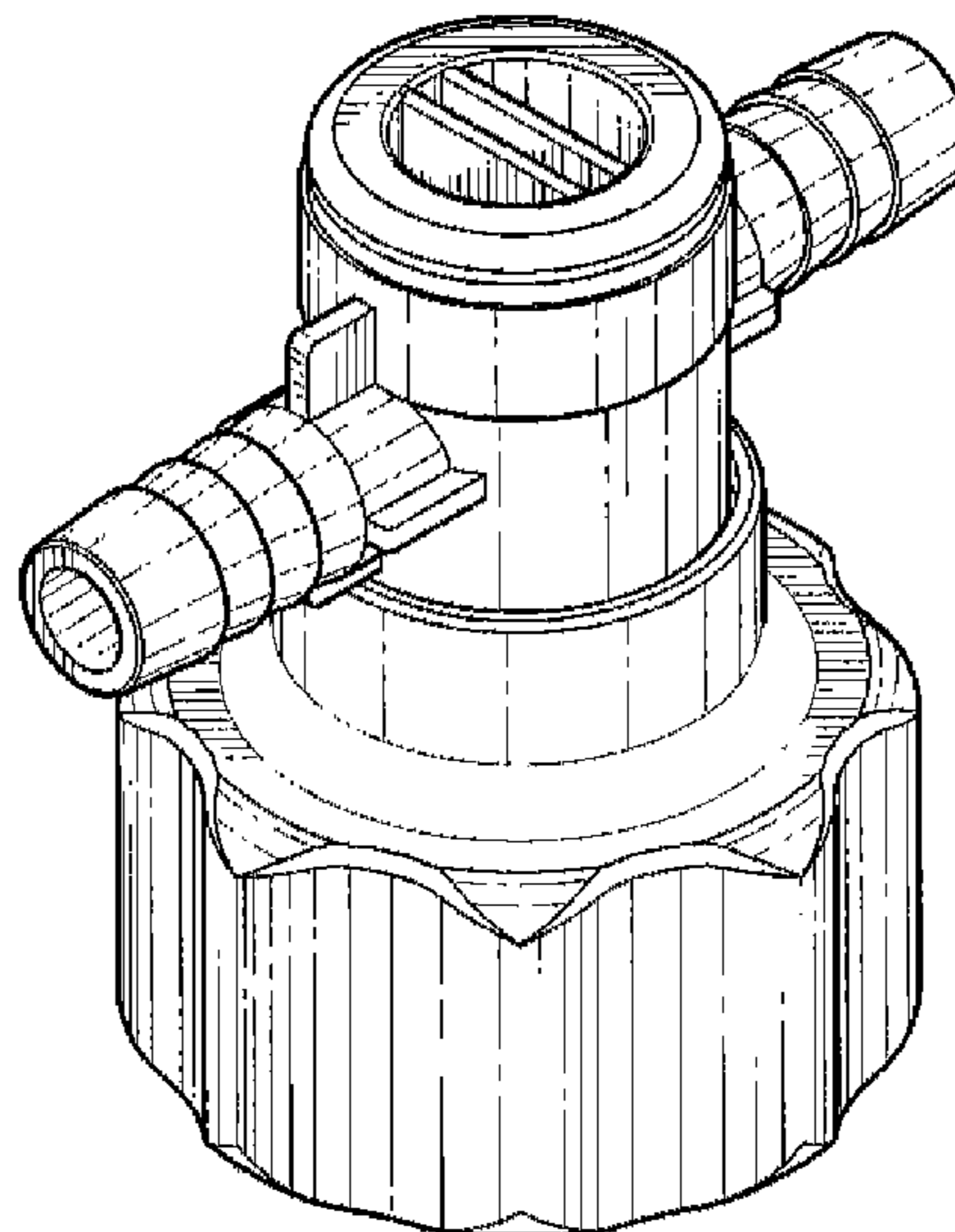

US D661,786 S

Page 2

U.S. PATENT DOCUMENTS

D511,203 S * 11/2005 Bressler et al. D23/262
7,487,951 B2 * 2/2009 Johnson 251/149.1
D607,090 S * 12/2009 Johnson D23/262
D617,880 S * 6/2010 Johnson D23/262
D618,763 S * 6/2010 Johnson D23/237
2002/0139423 A1 * 10/2002 Roethel 137/614.03

2004/0256424 A1* 12/2004 Johnson 222/518
2008/0053568 A1* 3/2008 Johnson 141/383

FOREIGN PATENT DOCUMENTS

CA 2554832 8/2005
WO WO 2004/085283 7/2004

* cited by examiner

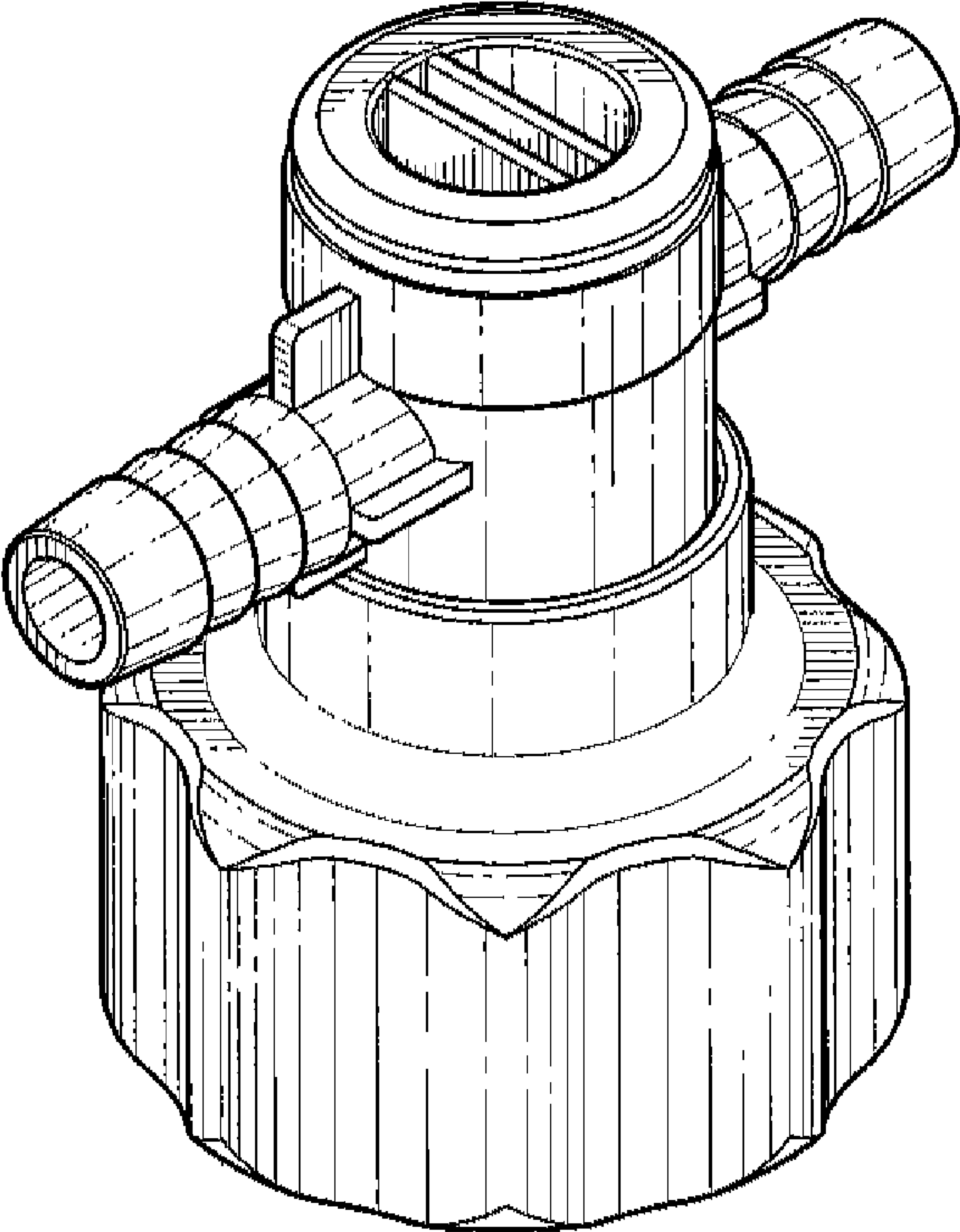

FIG. 1

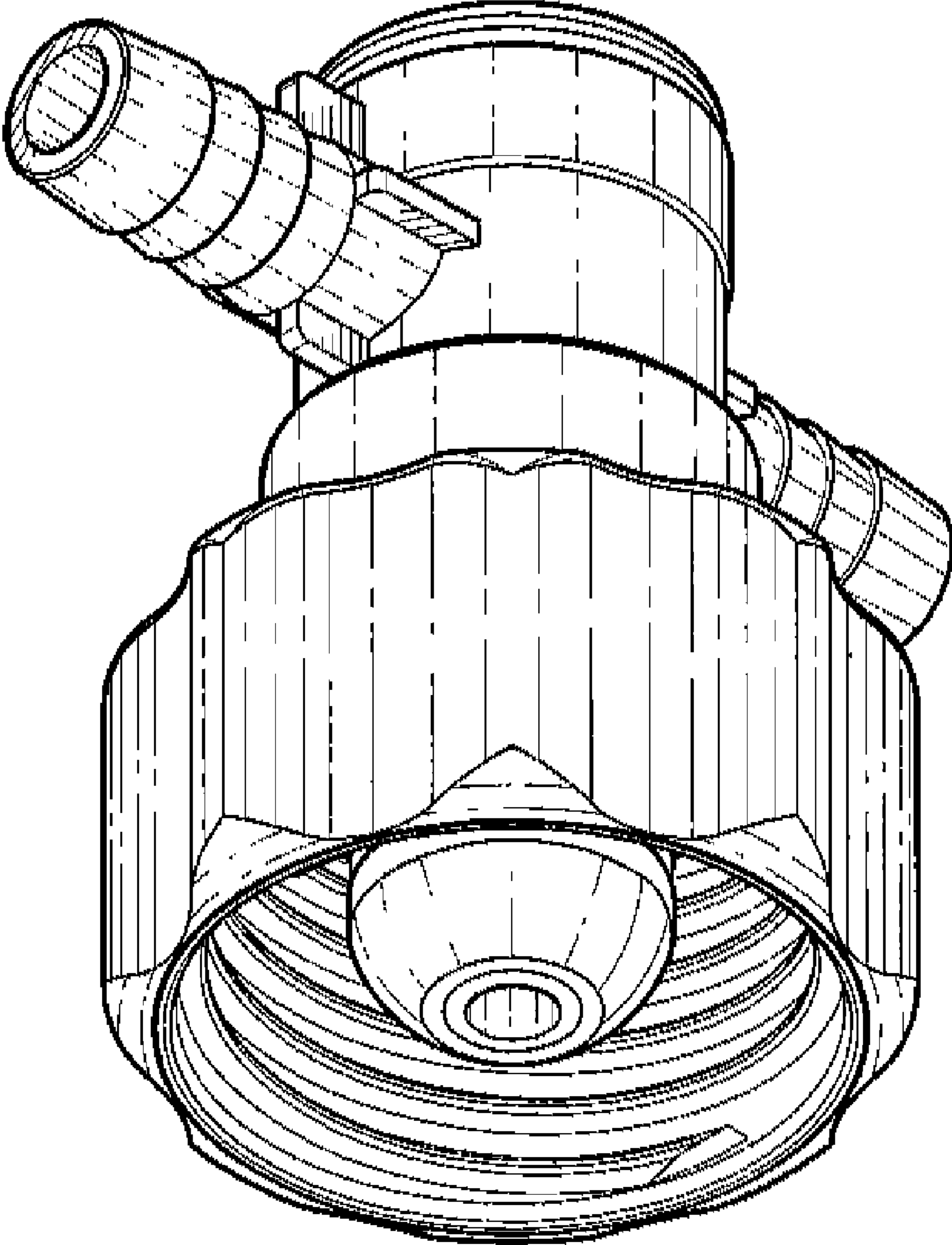

FIG. 2

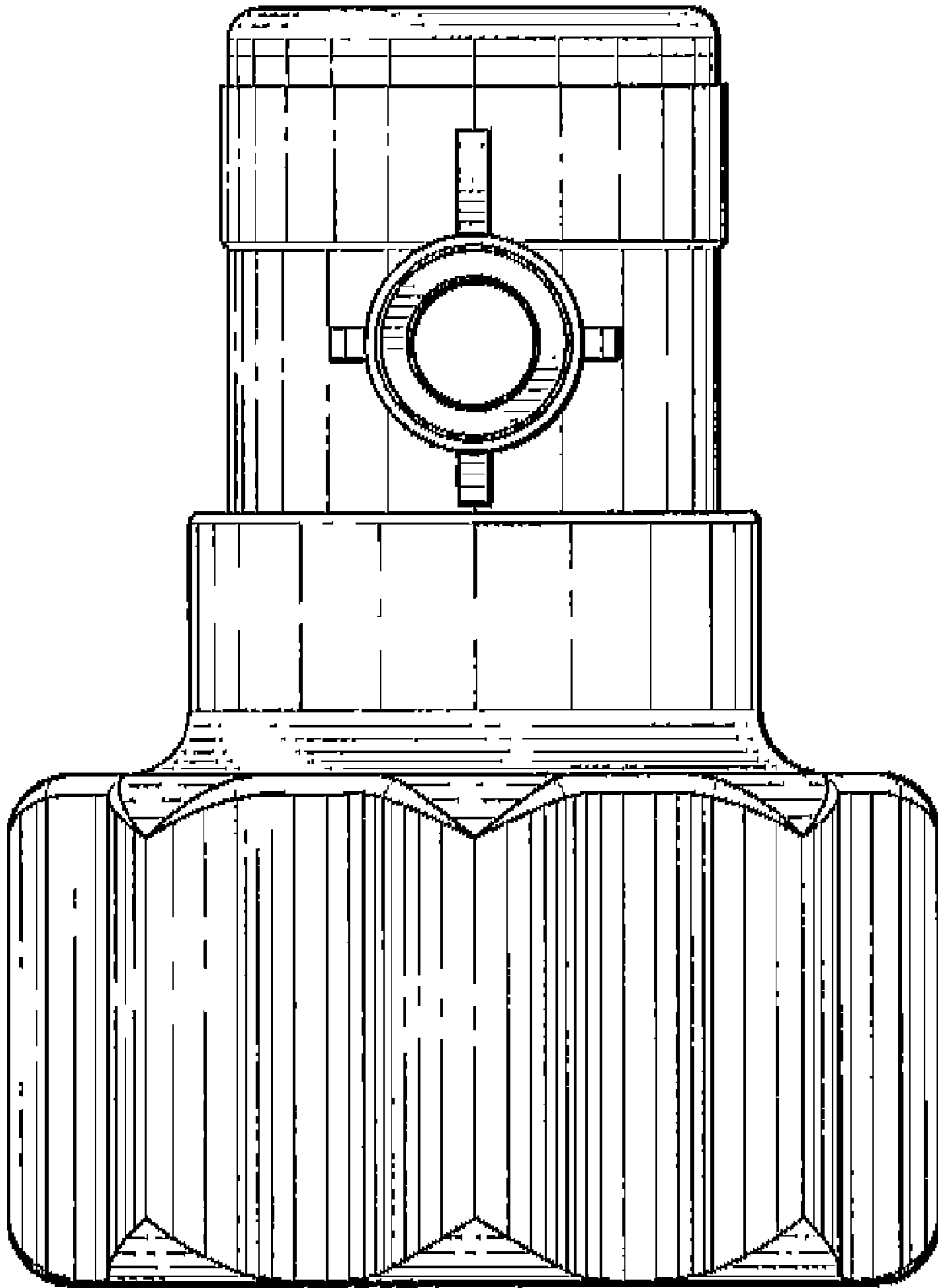

FIG. 3

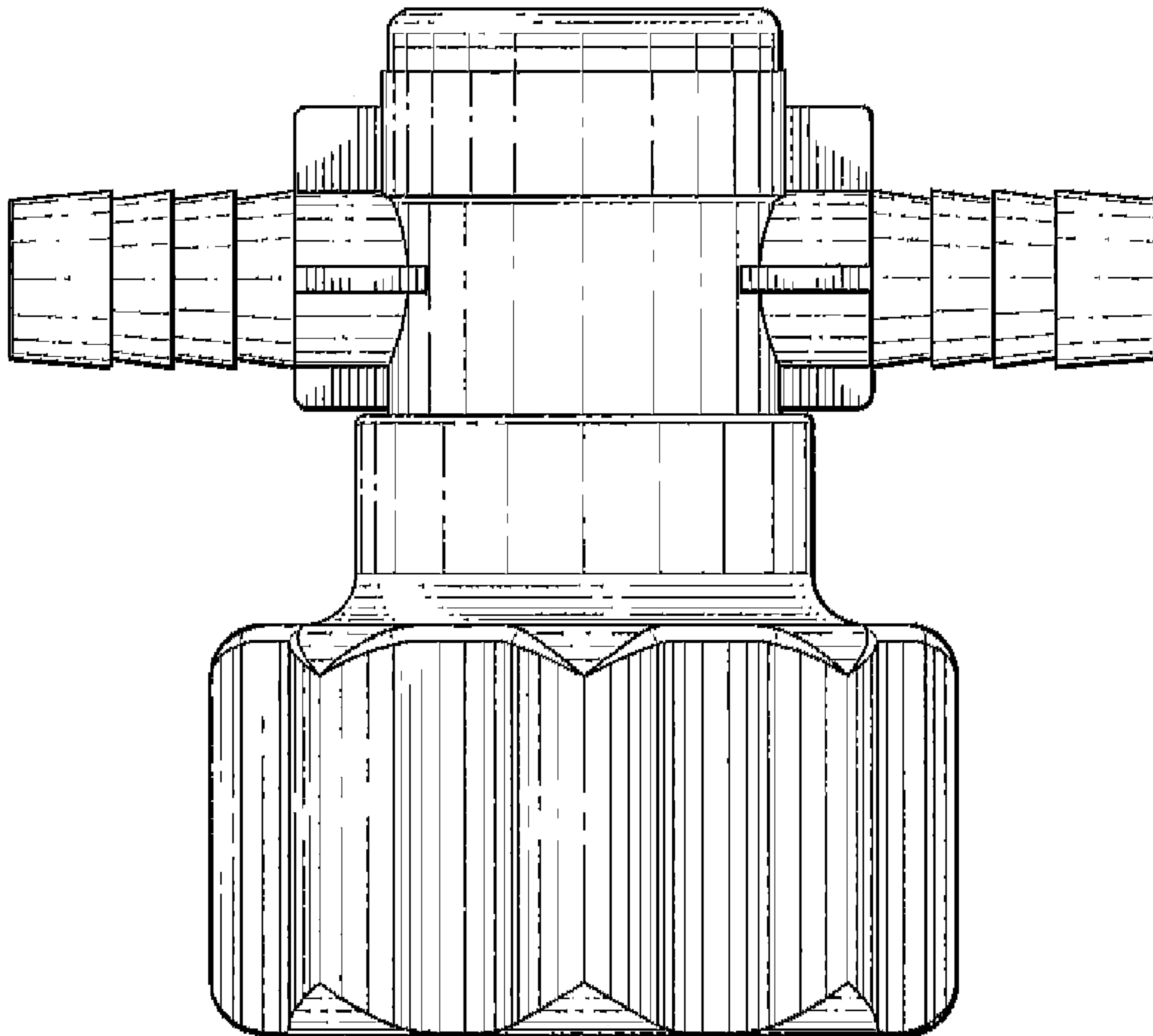

FIG. 4

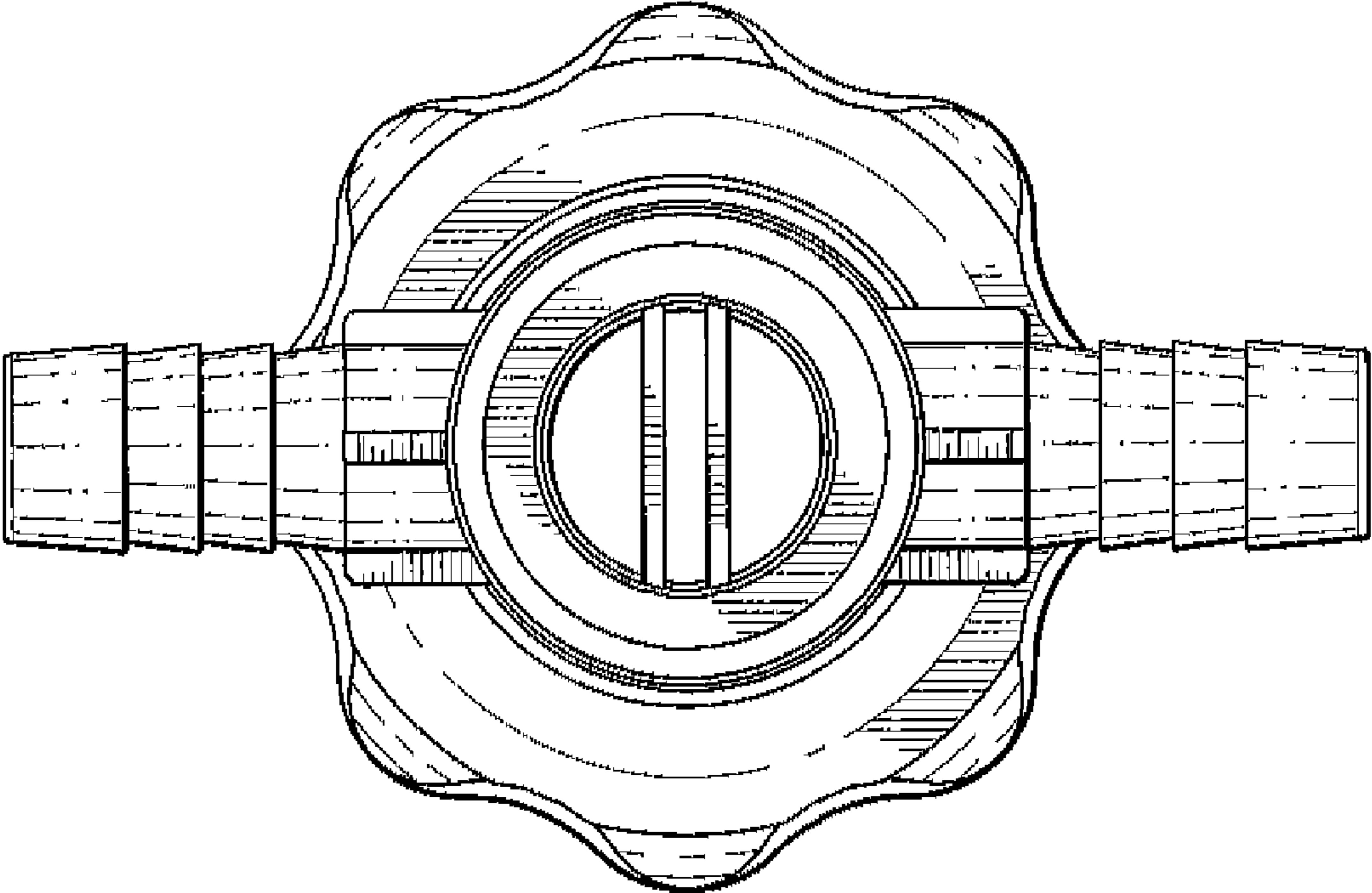

FIG. 5

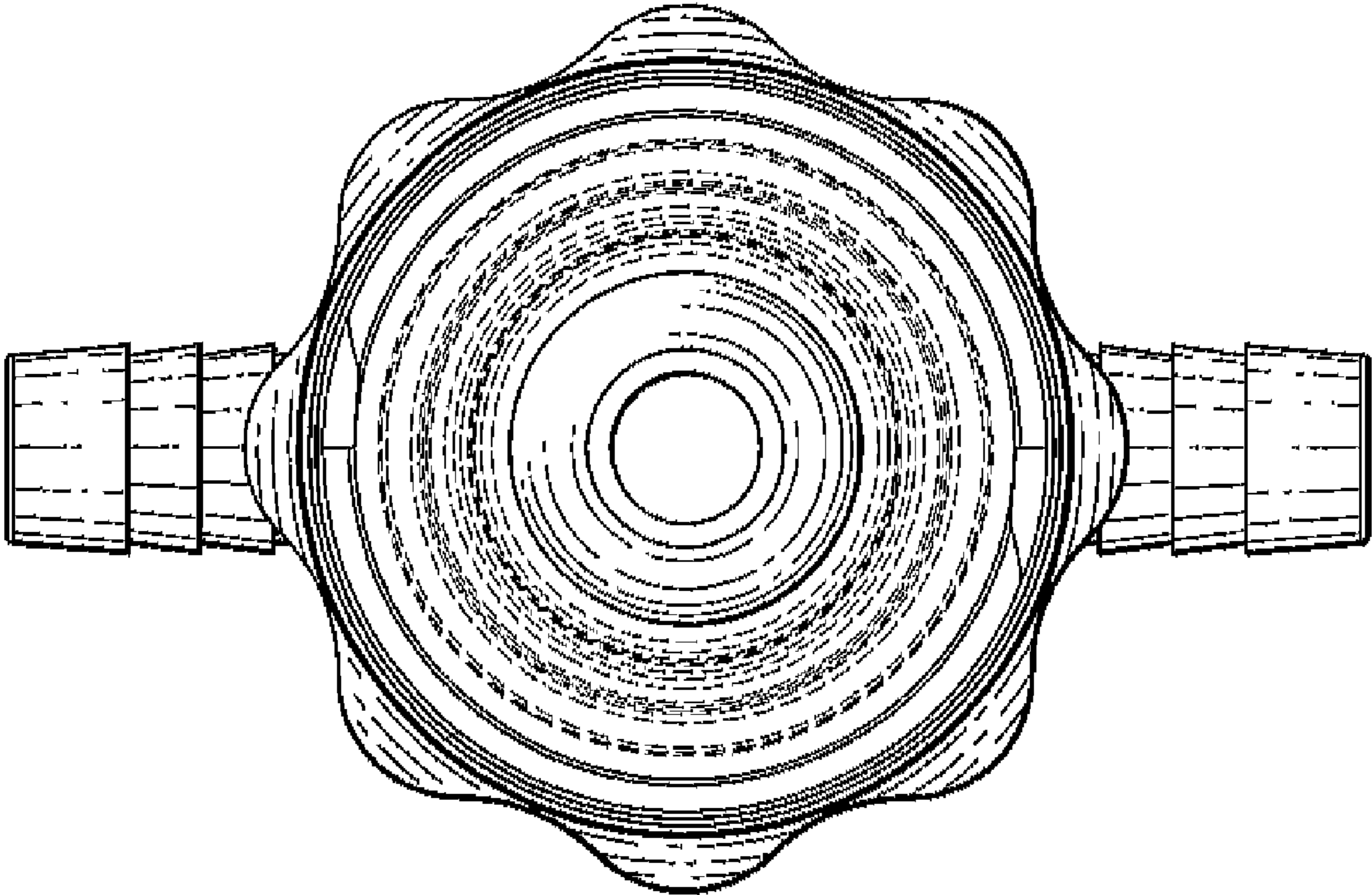

FIG. 6