



US00D659848S

(12) **United States Design Patent**
TerMaat et al.

(10) **Patent No.:** **US D659,848 S**

(45) **Date of Patent:** **** May 15, 2012**

(54) **SAMPLE TUBE**

(75) Inventors: **Joel TerMaat**, Lincoln, NE (US);
Matthew Robert Kreifels, Omaha, NE
(US); **Hendrik Viljoen**, Lincoln, NE
(US); **Scott Whitney**, Lincoln, NE (US)

(73) Assignee: **Streck, Inc.**, LaVista, NE (US)

(**) Term: **14 Years**

(21) Appl. No.: **29/390,267**

(22) Filed: **Apr. 22, 2011**

(51) **LOC (9) Cl.** **24-01**

(52) **U.S. Cl.** **D24/224**

(58) **Field of Classification Search** D24/216-232,
D24/186, 107, 108, 121; D3/201, 203.1,
D3/203.2, 202; D10/81; D9/435, 436, 439,
D9/420, 423, 516, 519, 520, 529, 544, 545,
D9/549; 422/500, 547, 554, 556; 356/246;
215/224, 305, 306; 435/288.1, 288.2, 304.1,
435/304.2

See application file for complete search history.

(56) **References Cited**

U.S. PATENT DOCUMENTS

D225,526 S * 12/1972 Baum et al. D24/224
D256,053 S * 7/1980 Steigerwald D24/224

4,528,187 A * 7/1985 Truglio 422/549
4,674,640 A * 6/1987 Asa et al. 215/230
D330,428 S * 10/1992 Lewis et al. D24/224
D337,261 S * 7/1993 Sherman D24/224
D425,625 S * 5/2000 Niermann D24/224
D621,520 S * 8/2010 Talmer et al. D24/224
D621,951 S * 8/2010 Bucholtz et al. D24/224
D640,795 S * 6/2011 Jackson et al. D24/216
2007/0051739 A1 * 3/2007 Giraud 220/839

FOREIGN PATENT DOCUMENTS

WO 2011/086497 A2 7/2011

* cited by examiner

Primary Examiner — Anhdao Doan

(74) *Attorney, Agent, or Firm* — Dobrusin & Thennisch PC

(57) **CLAIM**

The ornamental design for a sample tube, as shown and described.

DESCRIPTION

FIG. 1 is a perspective view of a sample tube showing our new design;

FIG. 2 is a side elevational view thereof;

FIG. 3 is a front elevational view thereof;

FIG. 4 is a rear elevational view thereof;

FIG. 5 is a top plan view thereof; and,

FIG. 6 is a bottom plan view thereof.

1 Claim, 2 Drawing Sheets

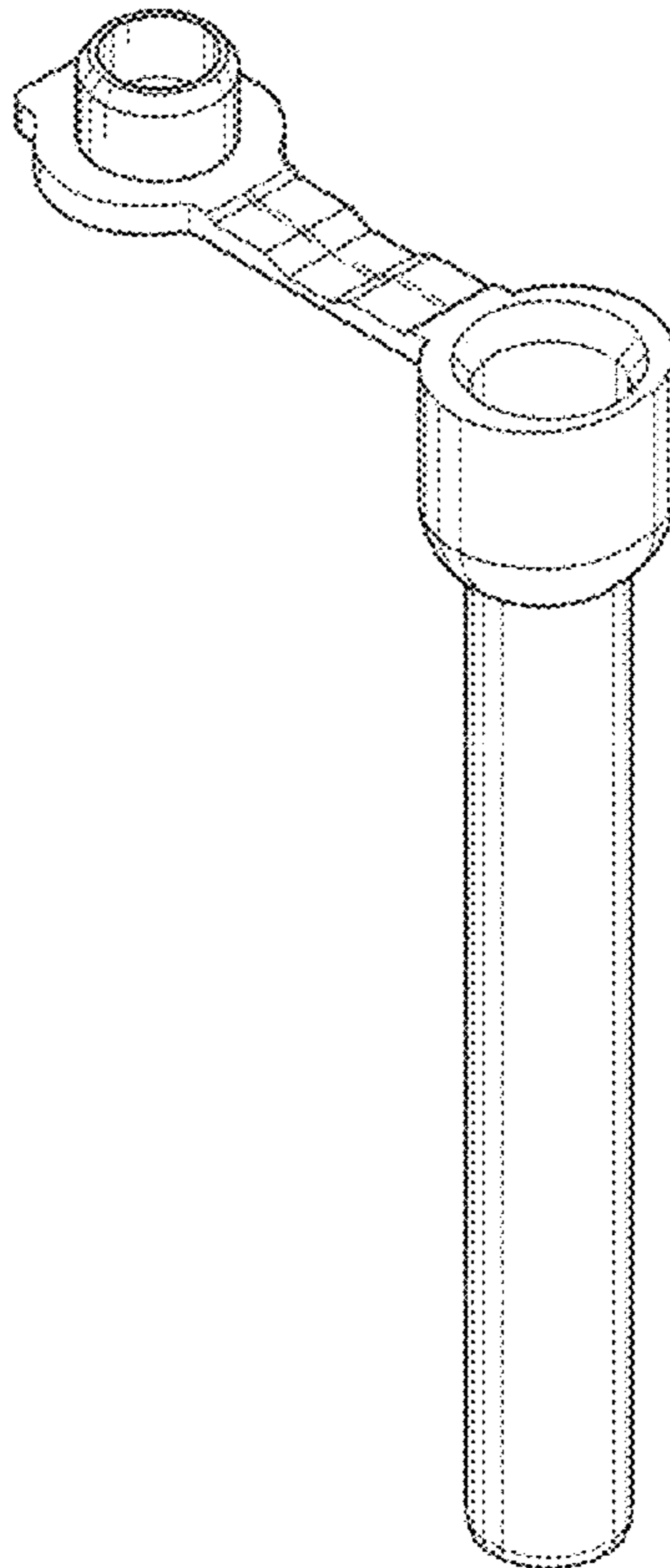

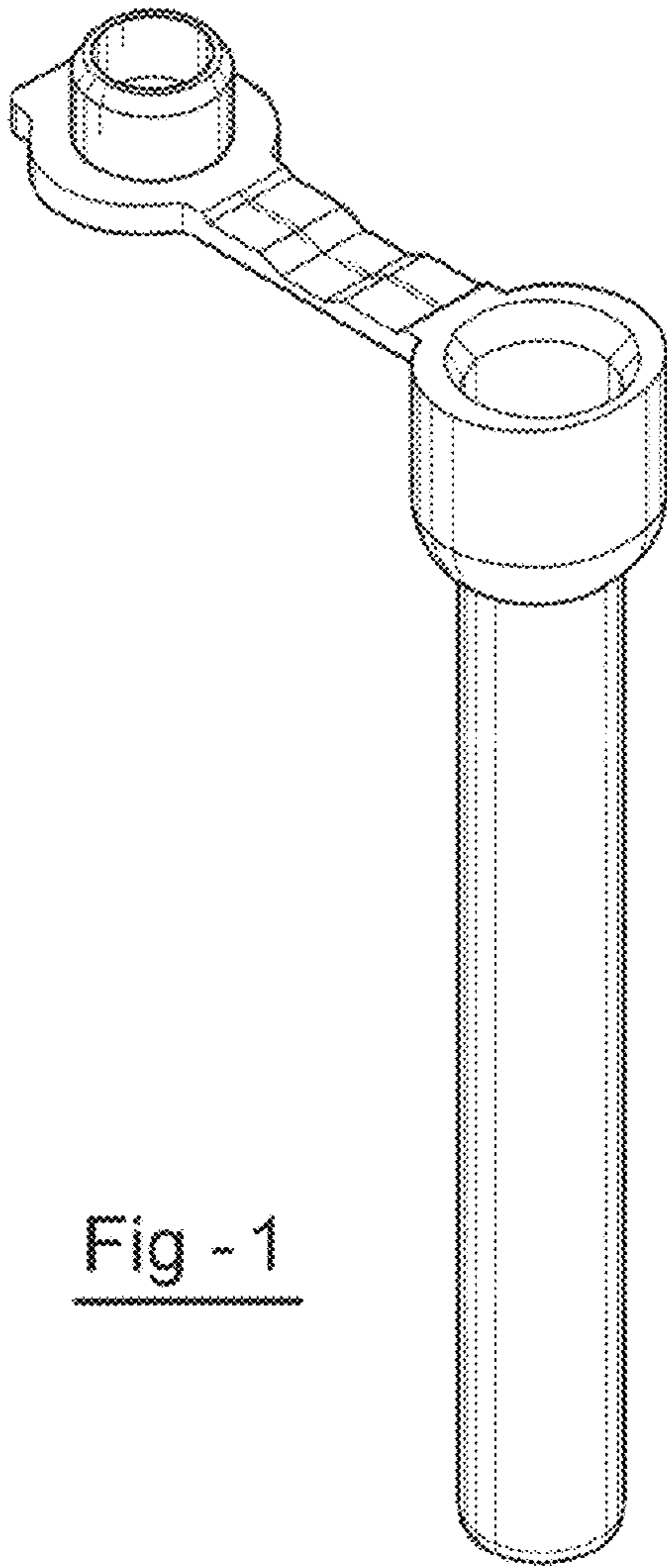

Fig - 1

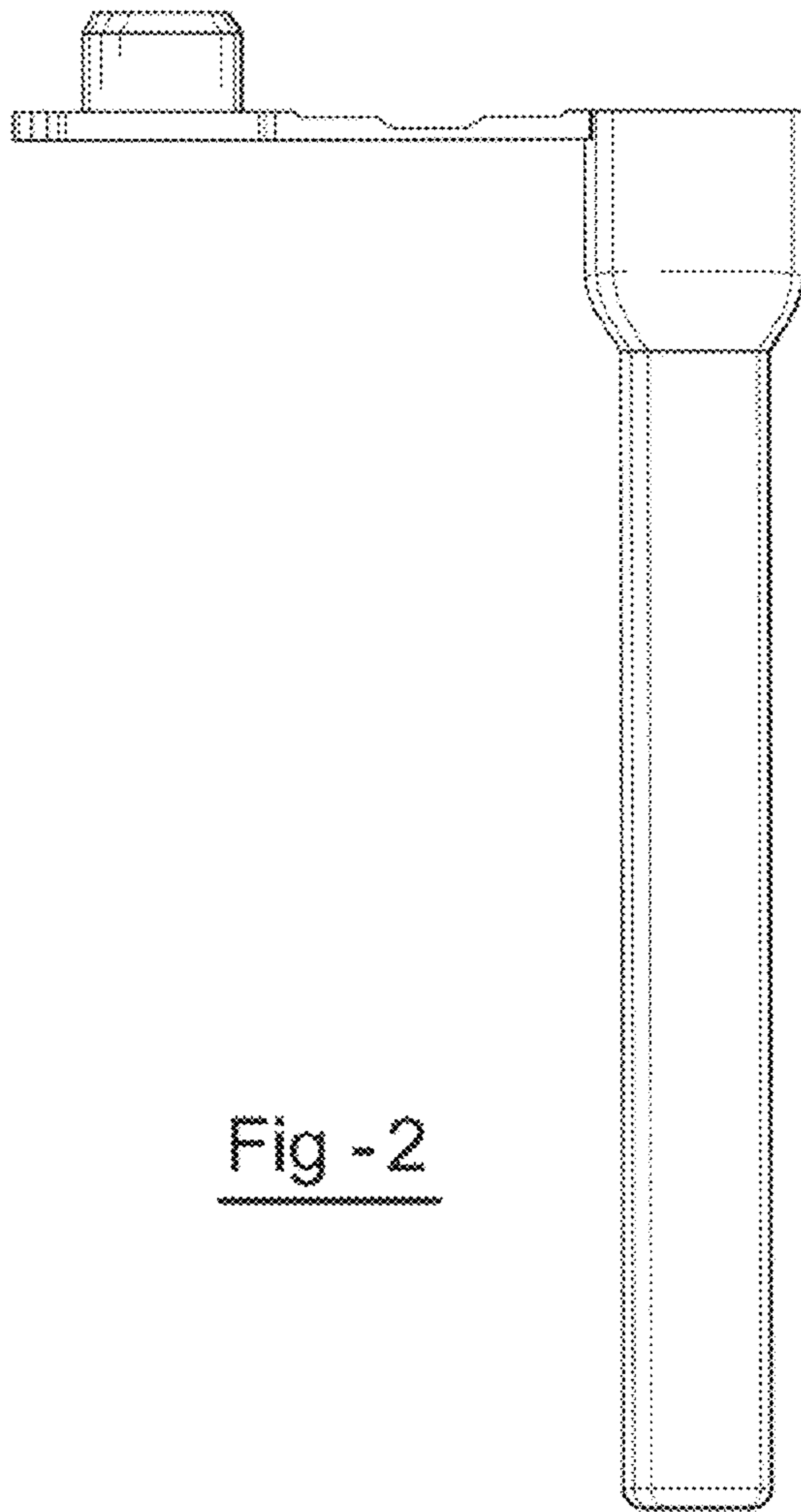

Fig - 2

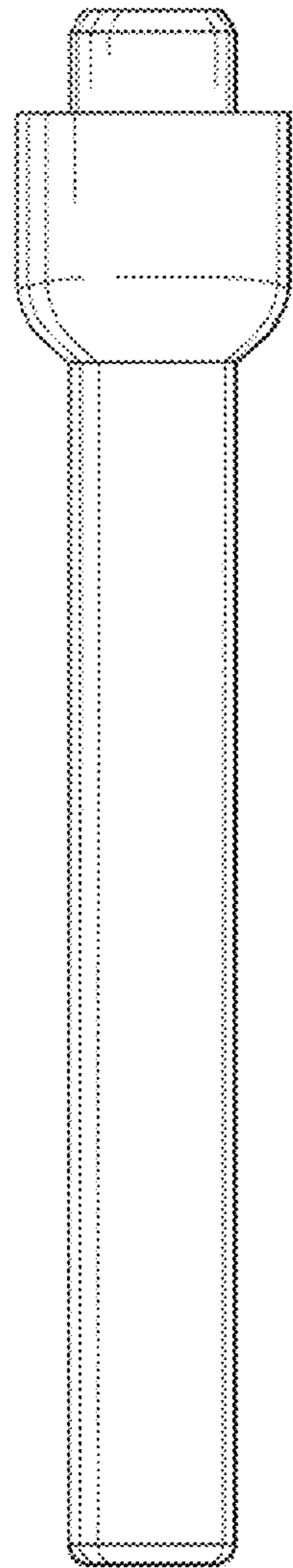

Fig - 3

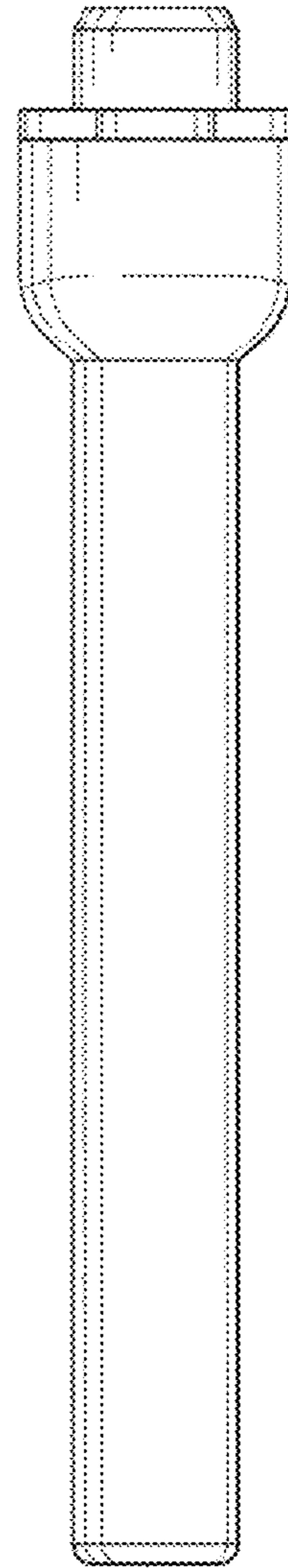

Fig - 4

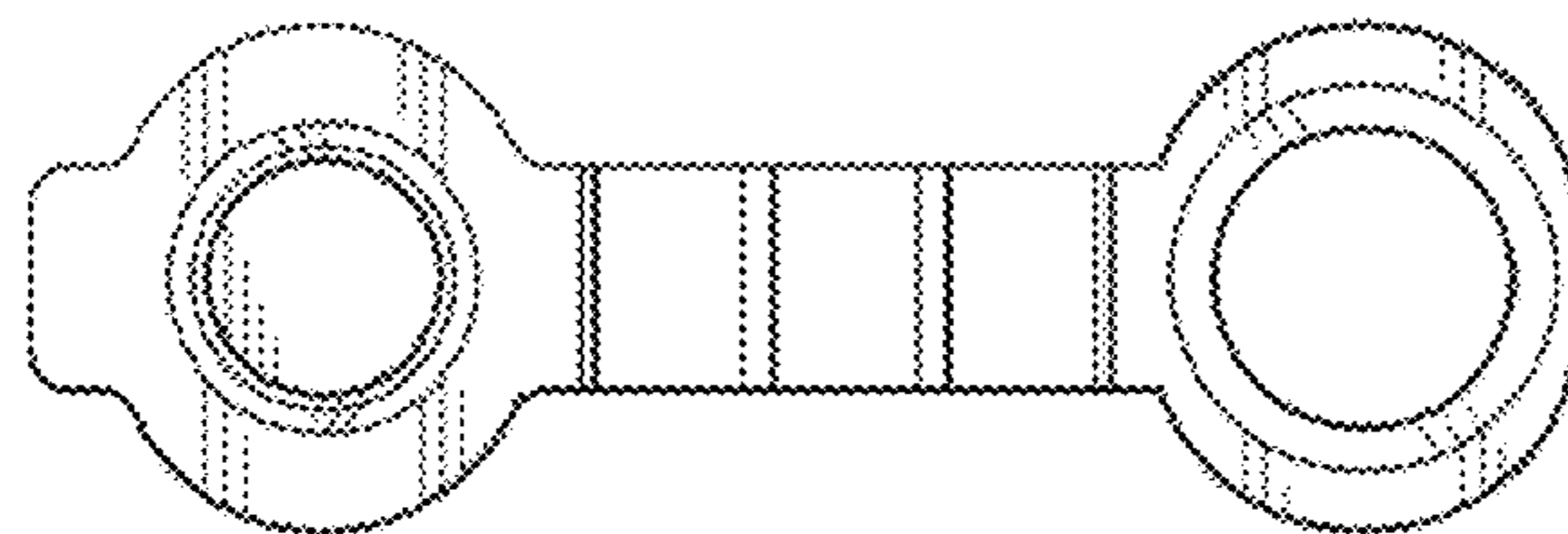

Fig - 5

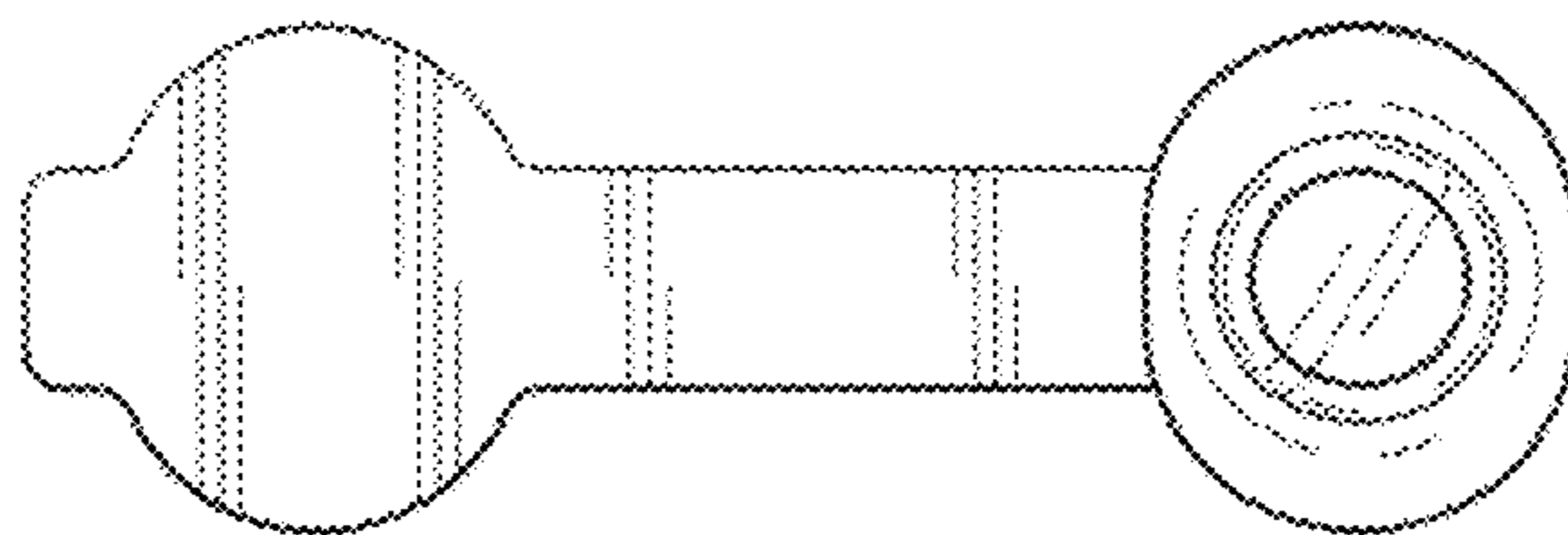

Fig - 6