



US00D659651S

(12) **United States Design Patent**  
**Wong**

(10) **Patent No.:** **US D659,651 S**

(45) **Date of Patent:** **\*\* May 15, 2012**

(54) **AUTOMATION CONTROLLER**

(75) Inventor: **Chee Lim Wong**, Singapore (SG)

(73) Assignee: **Rockwell Automation Technologies, Inc.**, Mayfield Heights, OH (US)

(\*\*) Term: **14 Years**

(21) Appl. No.: **29/378,320**

(22) Filed: **Nov. 2, 2010**

(51) **LOC (9) Cl.** ..... **13-03**

(52) **U.S. Cl.** ..... **D13/162.1**

(58) **Field of Classification Search** ..... D13/162,  
D13/162.1; D14/439; 361/679.02, 690,  
361/728, 729, 730, 796; 700/1, 17, 18, 20;  
439/76.1, 709, 715, 716

See application file for complete search history.

(56) **References Cited**

U.S. PATENT DOCUMENTS

D298,747 S	*	11/1988	Shibayama et al.	.....	D13/162.1
D307,262 S		4/1990	Abe et al.		
D307,416 S		4/1990	Abe et al.		
D307,576 S		5/1990	Abe et al.		
D307,577 S		5/1990	Abe et al.		
D325,900 S	*	5/1992	Shimizu et al.	.....	D13/162.1
D400,180 S	*	10/1998	Shimizu	.....	D13/162.1
D400,509 S		11/1998	Brunelle		
D400,510 S		11/1998	Brunelle		
D409,155 S		5/1999	Goletto		
D418,483 S	*	1/2000	Shimizu et al.	.....	D13/162.1
6,033,257 A	*	3/2000	Lake et al.	.....	439/502
6,239,986 B1	*	5/2001	Otsuka	.....	361/796
6,324,057 B1	*	11/2001	Baran et al.	.....	361/690
6,418,027 B1	*	7/2002	Suzuki et al.	.....	361/729
D477,288 S	*	7/2003	Natsui et al.	.....	D13/162.1
D477,813 S		7/2003	Droulin et al.		
D477,814 S		7/2003	Droulin et al.		
D478,322 S		8/2003	Droulin et al.		
D478,873 S		8/2003	Droulin et al.		
D480,055 S		9/2003	Droulin et al.		
D480,367 S		10/2003	Droulin et al.		

D480,368 S	10/2003	Droulin et al.
D480,369 S	10/2003	Droulin et al.
D481,014 S	10/2003	Droulin et al.
D482,005 S	11/2003	Droulin et al.
D482,663 S	11/2003	Droulin et al.
D484,134 S	12/2003	Oda
D488,133 S	4/2004	Droulin et al.
D553,579 S	10/2007	Takahashi
D559,205 S	1/2008	Takahashi et al.
D583,379 S	12/2008	Lindner et al.

(Continued)

*Primary Examiner* — Selina Sikder

(74) *Attorney, Agent, or Firm* — Fletcher Yoder, P.C.

(57) **CLAIM**

The ornamental design for an automation controller, as shown and described.

**DESCRIPTION**

FIG. 1 is a perspective view of the automation controller showing our new design, it being understood that the cut away portion indicates that the controller has an indeterminate length and that it has a uniform shape and appearance through its length.

FIG. 2 is top plan view of the automation controller set forth in FIG. 1;

FIG. 3 is a front elevational view of the automation controller set forth in FIG. 1;

FIG. 4 is a rear elevational view of the automation controller set forth in FIG. 1;

FIG. 5 is a right side elevational view of the automation controller set forth in FIG. 1;

FIG. 6 is a left side elevational view of the automation controller set forth in FIG. 1; and,

FIG. 7 is a bottom plan view of the automation controller set forth in FIG. 1.

In these drawings, the solid lines illustrate the claimed ornamental design, whereas the broken lines illustrate environmental features that form no part of the claimed ornamental design.

**1 Claim, 5 Drawing Sheets**

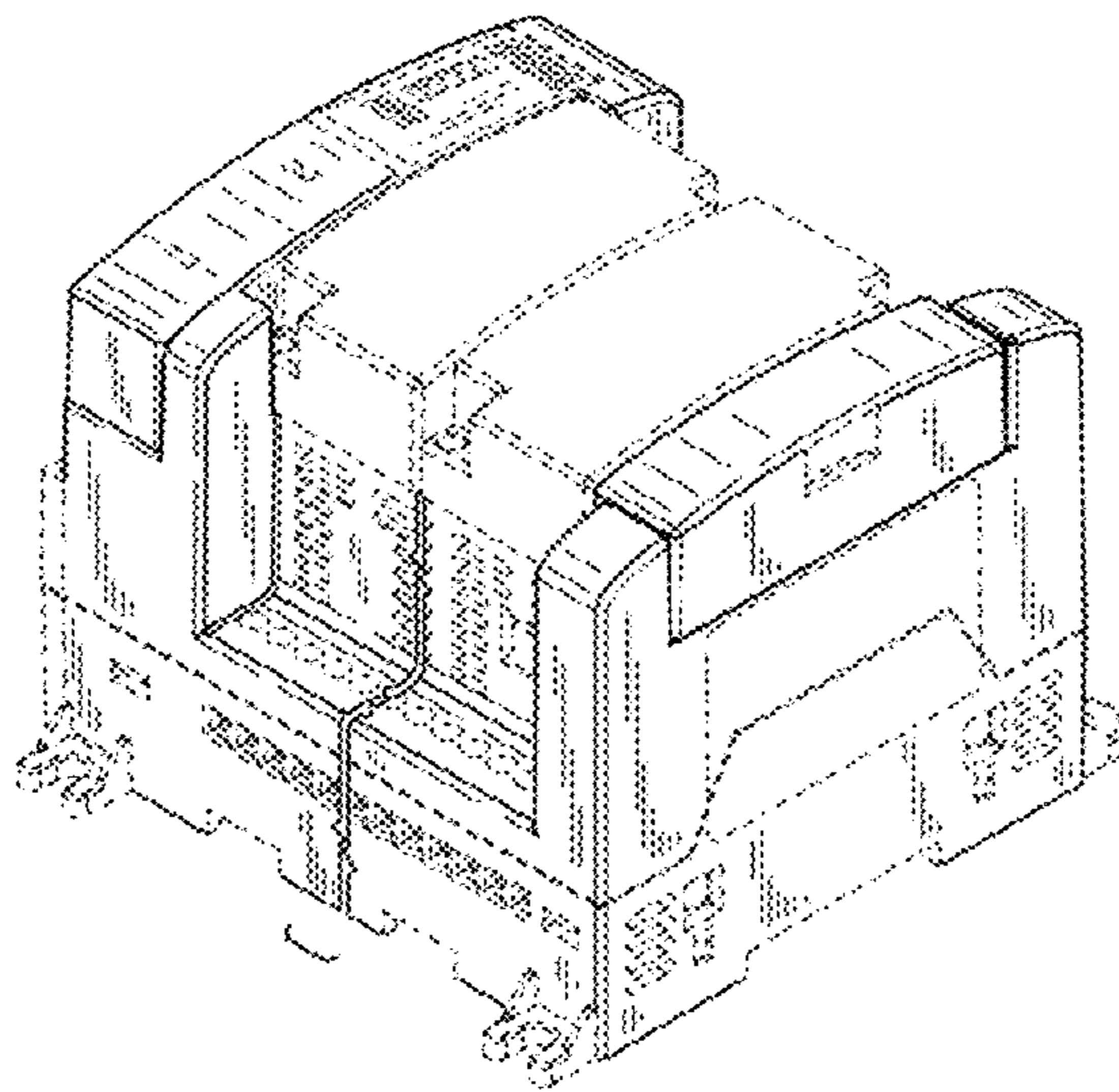

# US D659,651 S

Page 2

---

## U.S. PATENT DOCUMENTS

D583,380 S	12/2008	Lindner et al.	D598,867 S	8/2009	Nada et al.	
D583,381 S	12/2008	Lindner et al.	7,670,148 B2 *	3/2010	Kumar et al. ....	439/76.2
D583,382 S	12/2008	Lindner et al.	2001/0039649 A1 *	11/2001	Boggs et al. ....	717/4
D588,600 S	3/2009	Lindner et al.	2004/0190232 A1 *	9/2004	Chang et al. ....	361/679
D590,402 S	4/2009	Lindner et al.	2004/0267380 A1 *	12/2004	Lin .....	700/1

\* cited by examiner

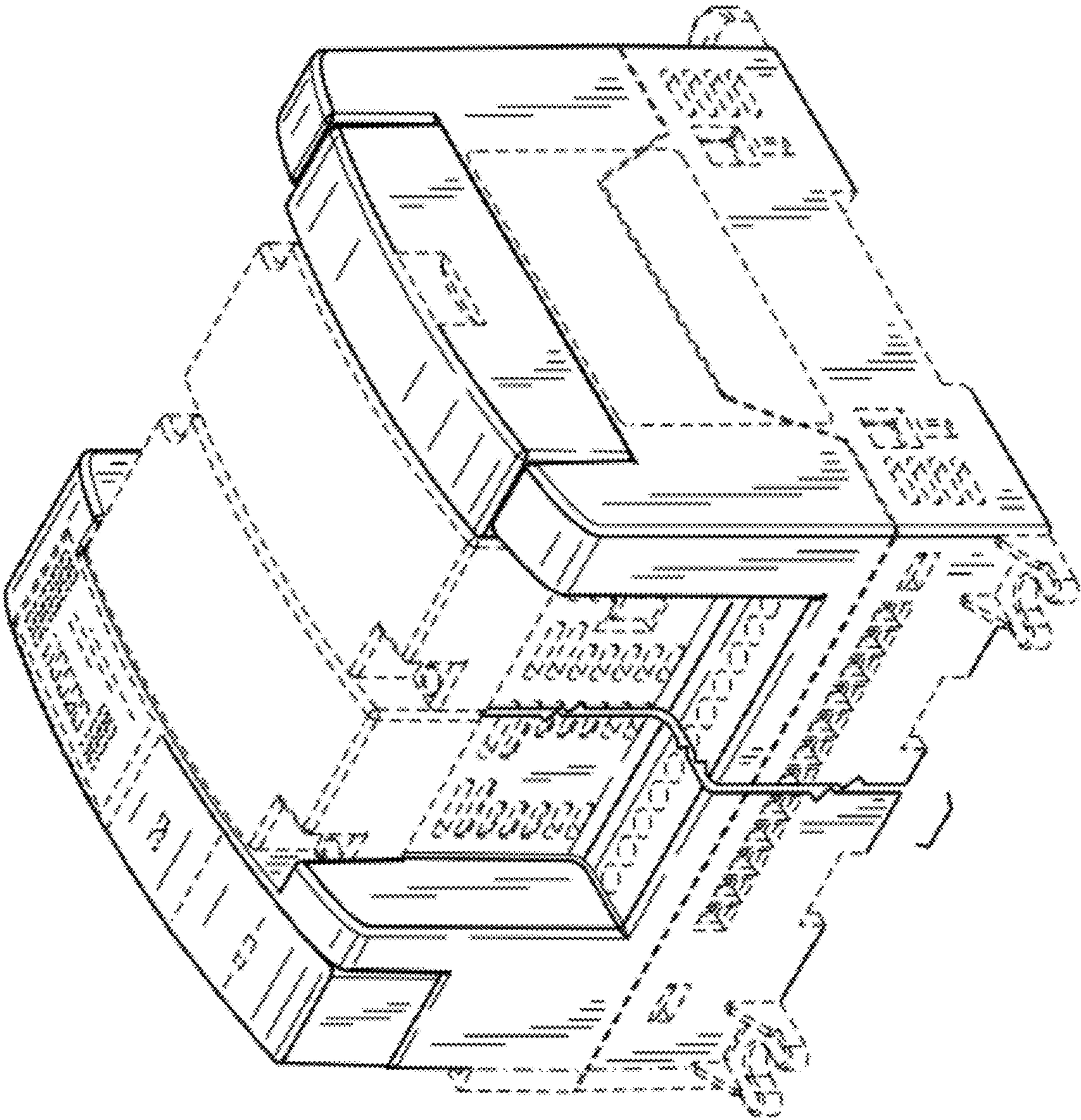

FIG. 1

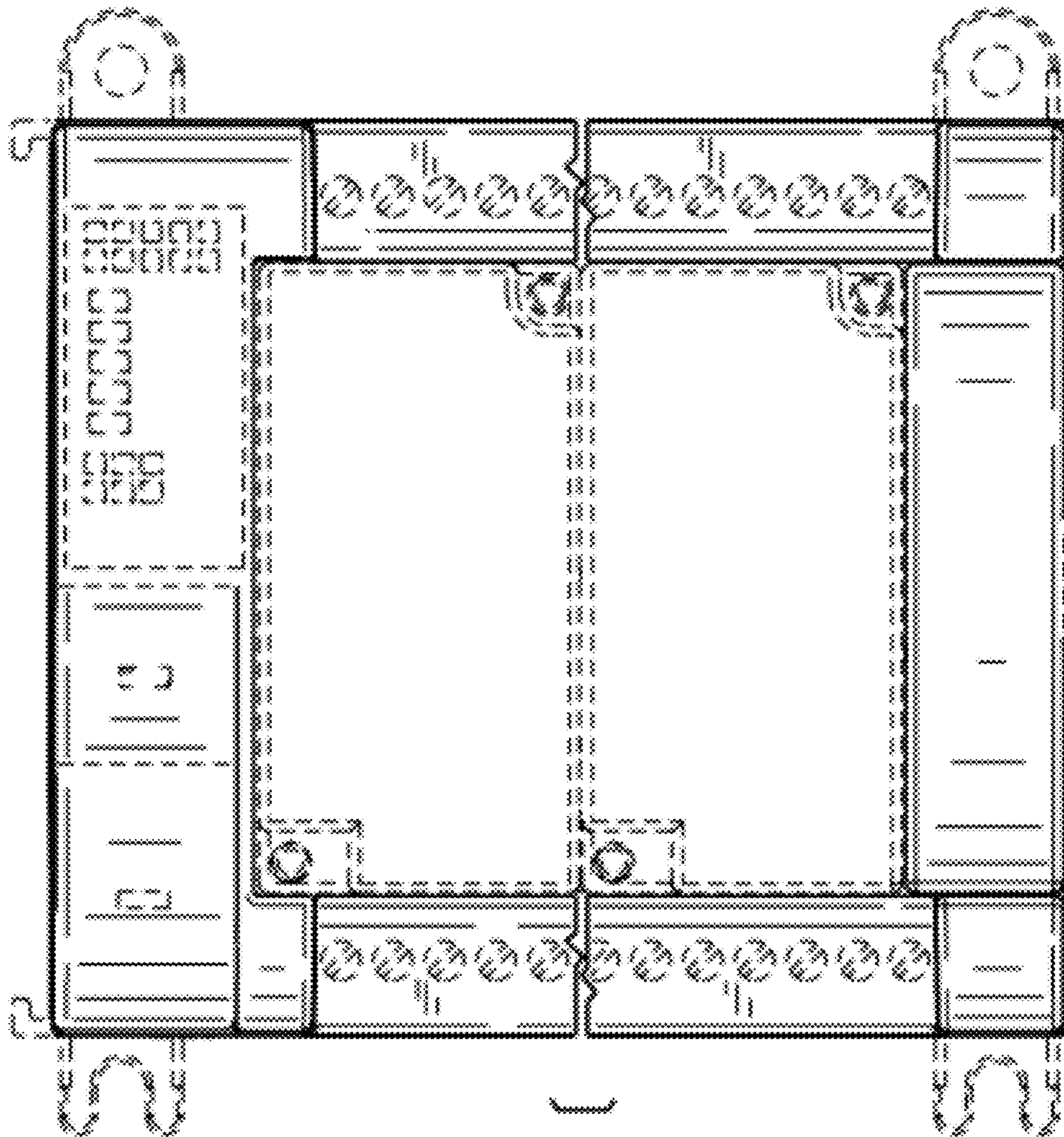

FIG. 2

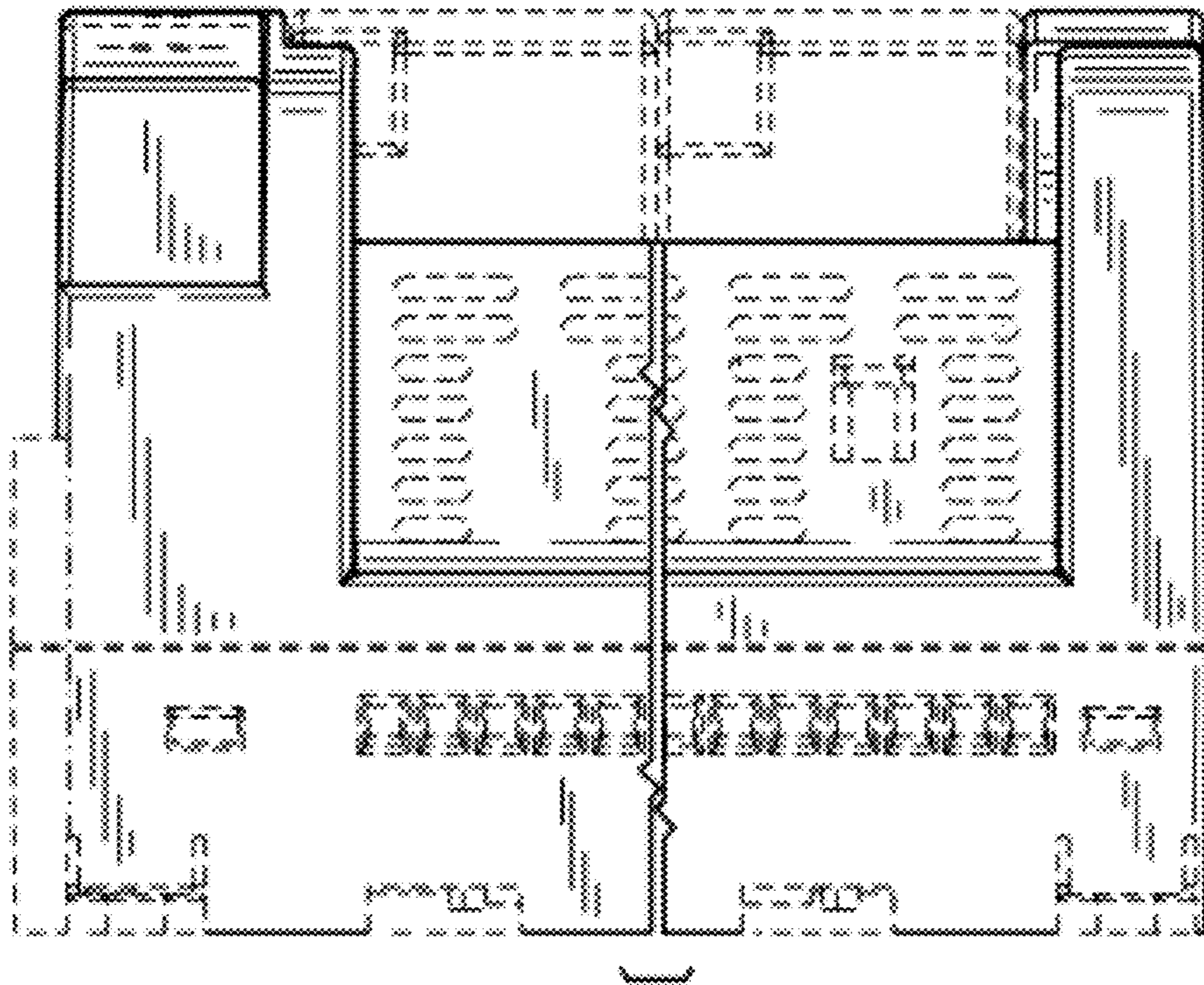

FIG. 3

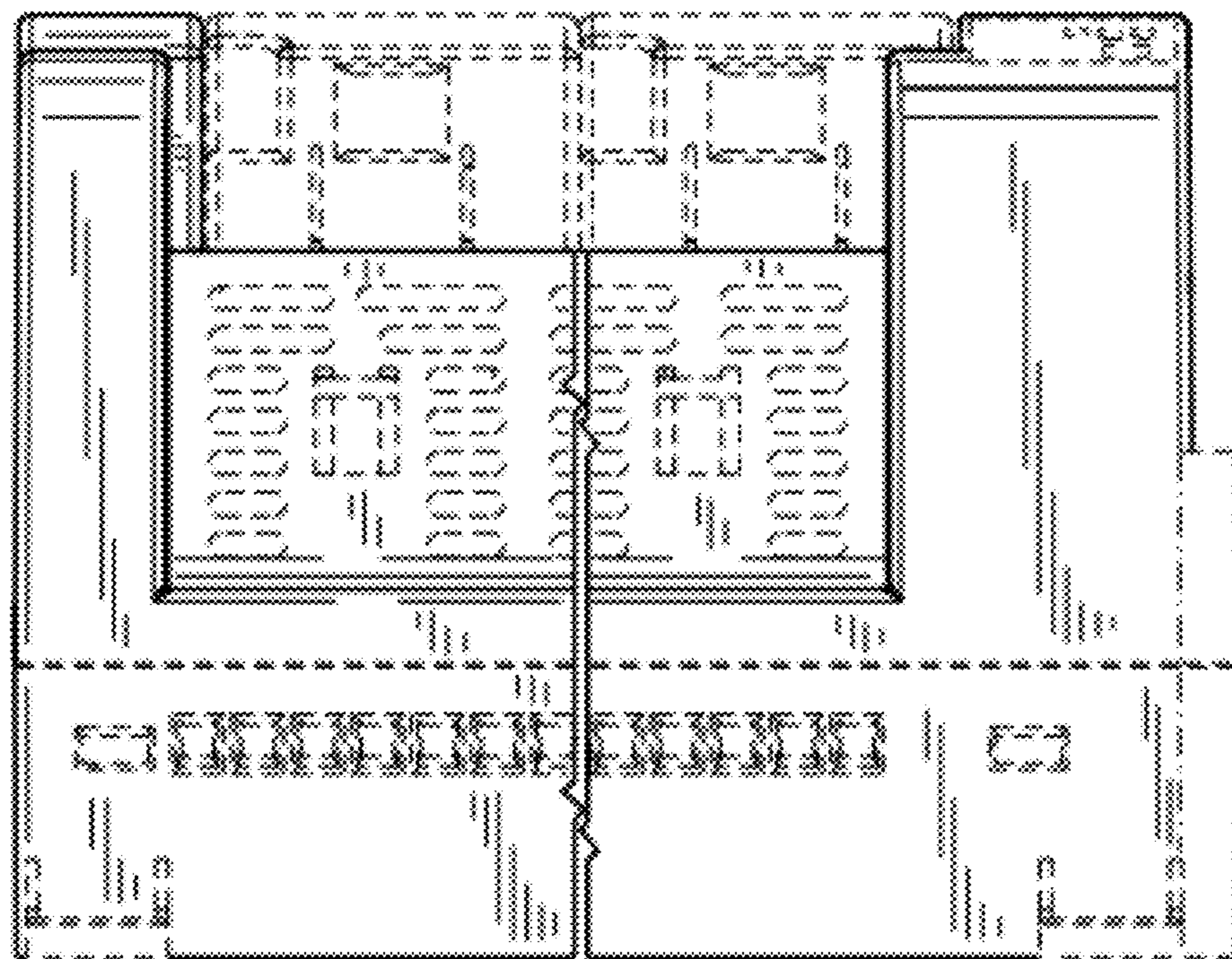

FIG. 4

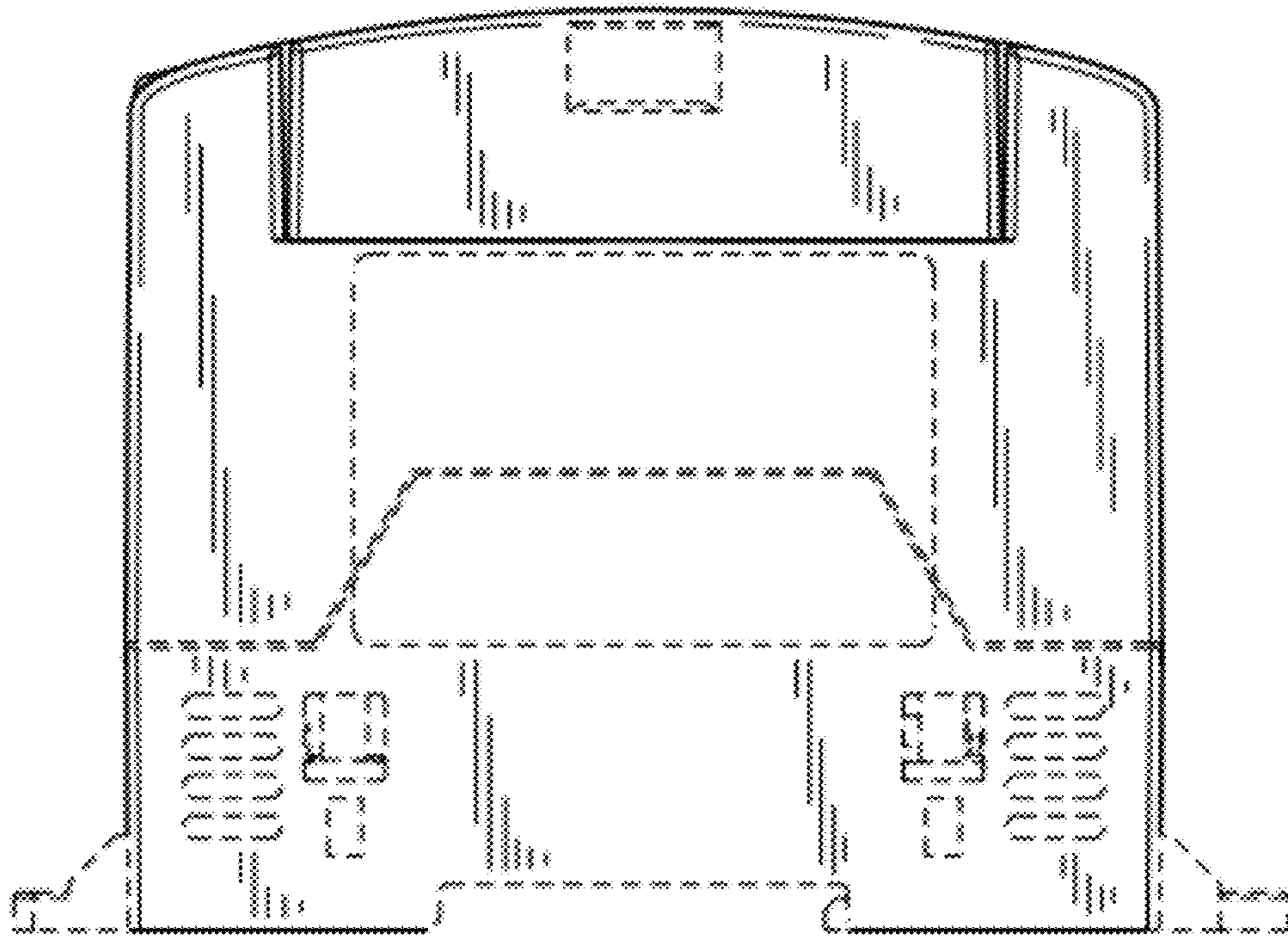

FIG. 5

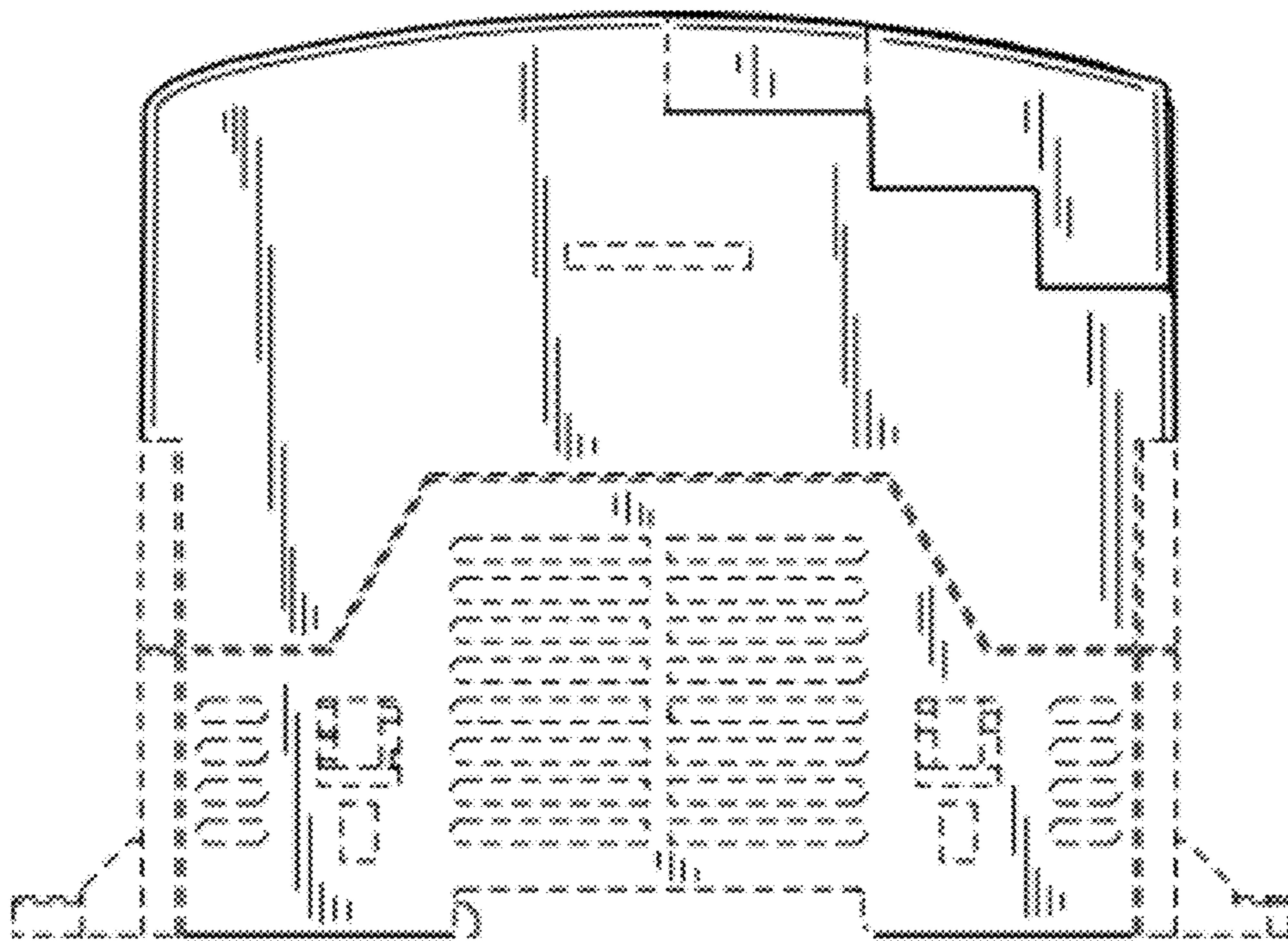

FIG. 6

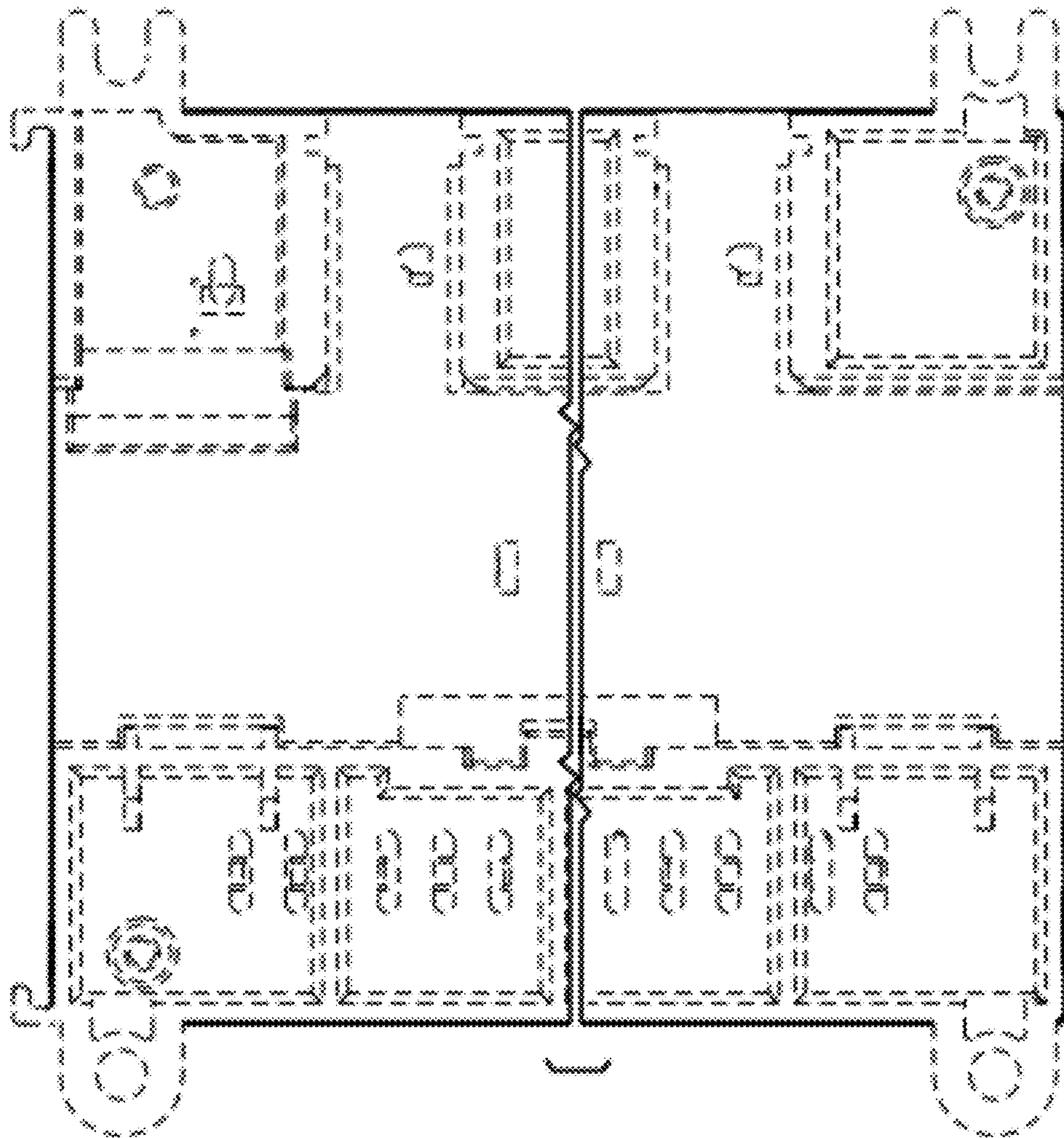

FIG. 7