



US00D659225S

(12) **United States Design Patent**
Rubin

(10) **Patent No.:** **US D659,225 S**

(45) **Date of Patent:** **** May 8, 2012**

(54) **APPARATUS FOR TEMPORARILY SEALING
A PIPE**

(75) **Inventor:** **David Edward Rubin**, Manville, NJ
(US)

(73) **Assignee:** **DPR Futures LLC**, Manville, NJ (US)

(**) **Term:** **14 Years**

(21) **Appl. No.:** **29/389,361**

(22) **Filed:** **Apr. 11, 2011**

(51) **LOC (9) Cl.** **23-01**

(52) **U.S. Cl.** **D23/260**

(58) **Field of Classification Search** D23/260–261;
239/201, 458; 285/239, 458; 40/316; 138/89,
138/109–110, 119, 134, 135; D8/397; D9/454
See application file for complete search history.

(56) **References Cited**

U.S. PATENT DOCUMENTS

D223,187	S *	3/1972	Wing	D8/397
3,901,268	A	8/1975	Mullins		
4,077,250	A	3/1978	Wesch		
4,324,270	A	4/1982	Mullins		
4,982,763	A	1/1991	Klahn		
5,172,557	A	12/1992	Hubbell, Jr.		
5,224,516	A	7/1993	McGovern et al.		
D363,767	S *	10/1995	Swaim	D23/260
5,676,174	A	10/1997	Berneski, Jr. et al.		
6,045,166	A *	4/2000	Krause	285/347
6,401,555	B1 *	6/2002	Bowers	73/866.5
D463,537	S *	9/2002	Kozu et al.	D23/262
D482,761	S *	11/2003	Gotoh et al.	D23/262
7,159,473	B1 *	1/2007	Bowers	73/861.65

D545,405	S *	6/2007	Nightlinger et al.	D23/260
D549,804	S *	8/2007	Lewis et al.	D23/262
7,419,192	B2	9/2008	Benoit et al.		
D600,323	S *	9/2009	Forsythe	D23/260
2002/0024218	A1 *	2/2002	Manuli	285/256
2002/0096209	A1 *	7/2002	Danielson et al.	137/15.09

FOREIGN PATENT DOCUMENTS

GB	2083153	A	3/1982
WO	98/51958	A1	11/1998

* cited by examiner

Primary Examiner — T. Chase Nelson

Assistant Examiner — Eric Goodman

(74) *Attorney, Agent, or Firm* — Chipperson Law Group,
P.C.; Rita C. Chipperson, Esq.

(57) **CLAIM**

The ornamental design for an apparatus for temporarily seal-
ing a pipe, as shown and described.

DESCRIPTION

FIG. 1 is a perspective view of an apparatus for temporarily
sealing a pipe;
FIG. 2 is a front elevational view thereof which is a mirror
image of a rear elevational view thereof;
FIG. 3 is a top plan view thereof which is a mirror image of a
bottom plan view thereof;
FIG. 4 is a left side view of the thereof; and,
FIG. 5 is a right side view of the thereof.
The broken line which defines the bounds of the claimed
design form no part thereof.

1 Claim, 2 Drawing Sheets

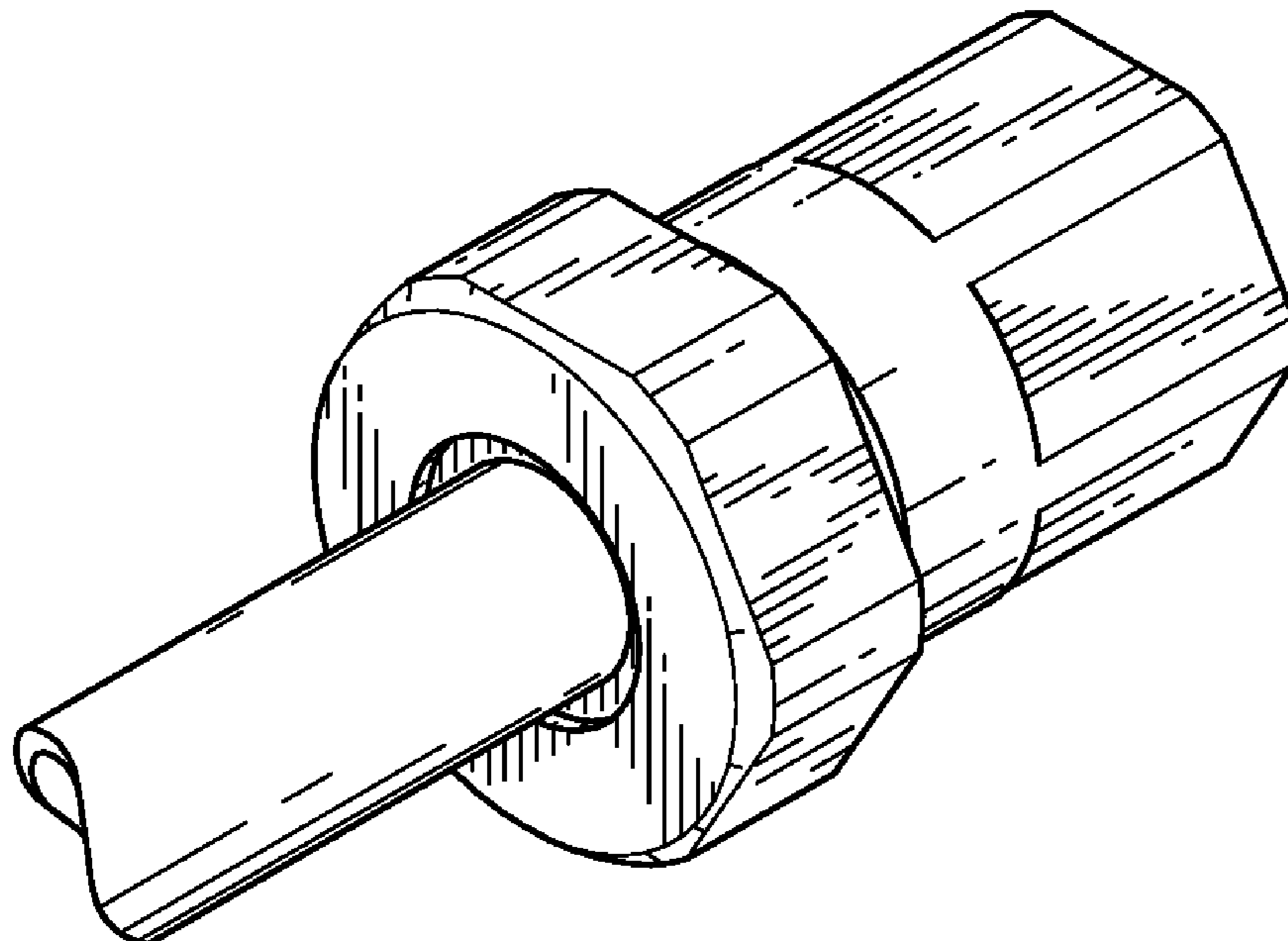

FIG. 1

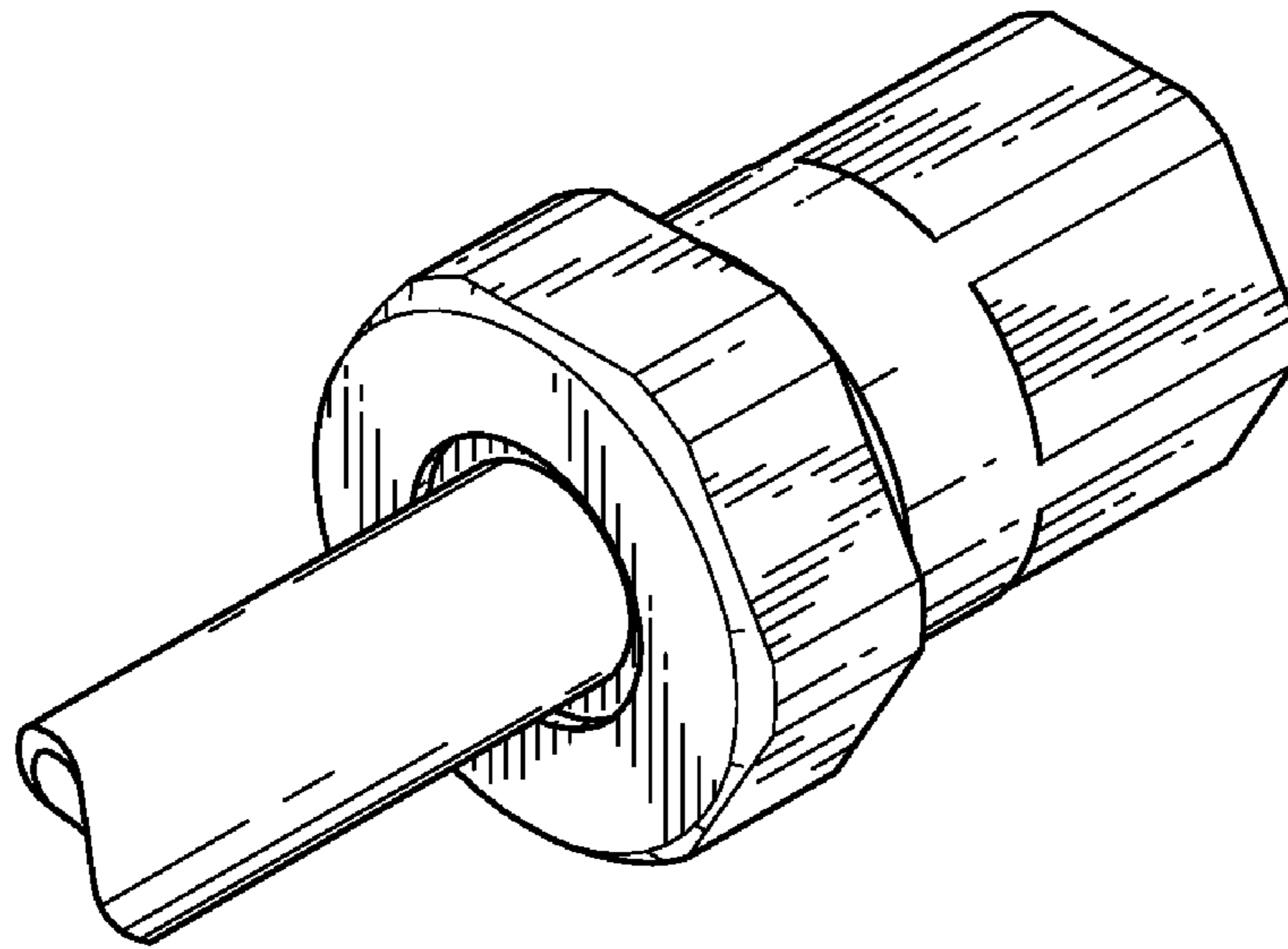

FIG. 2

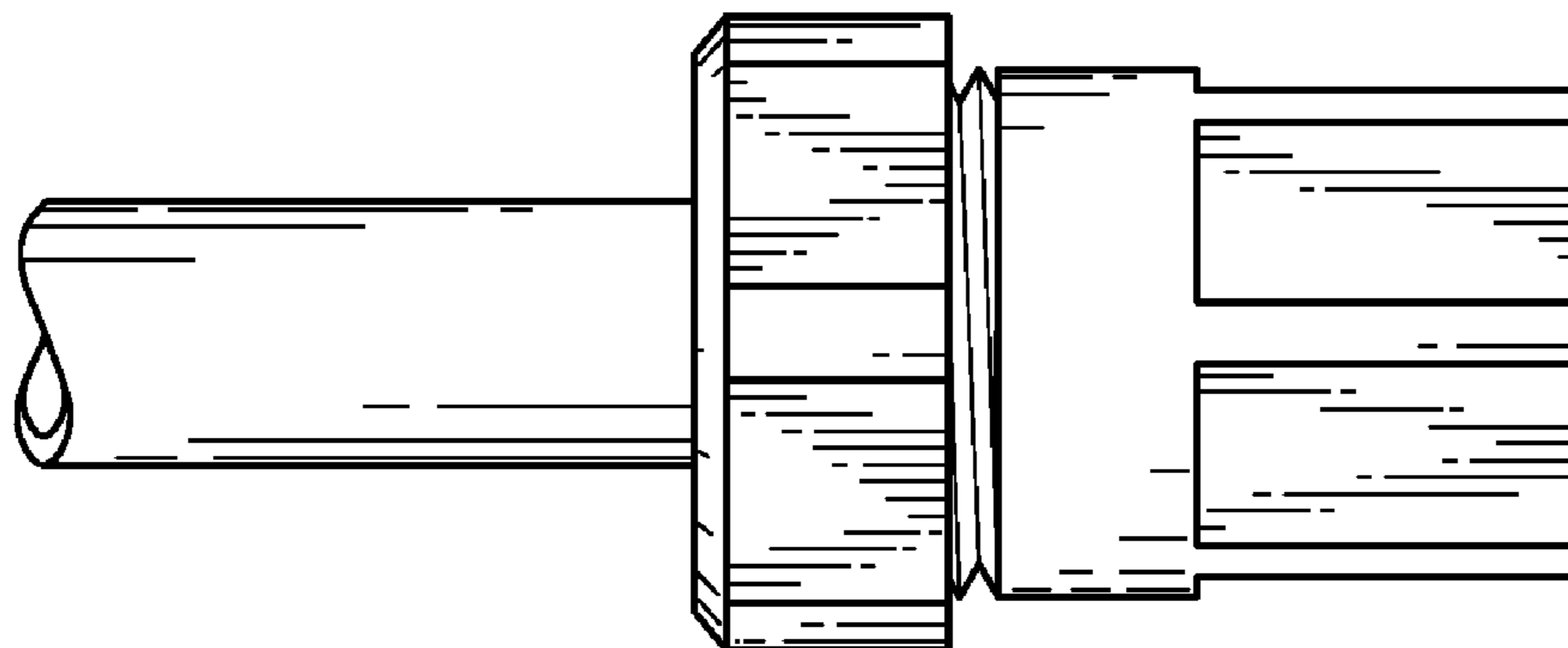

FIG. 3

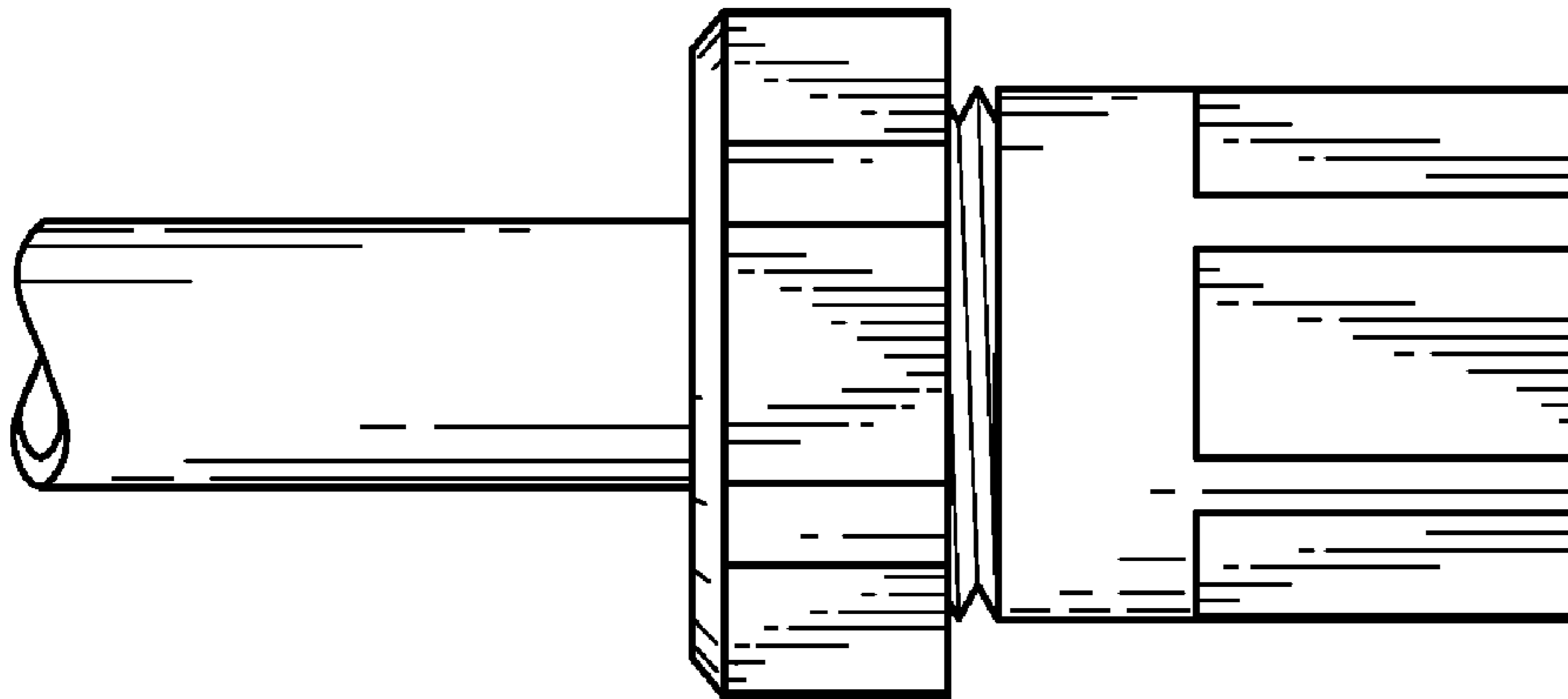

FIG. 4

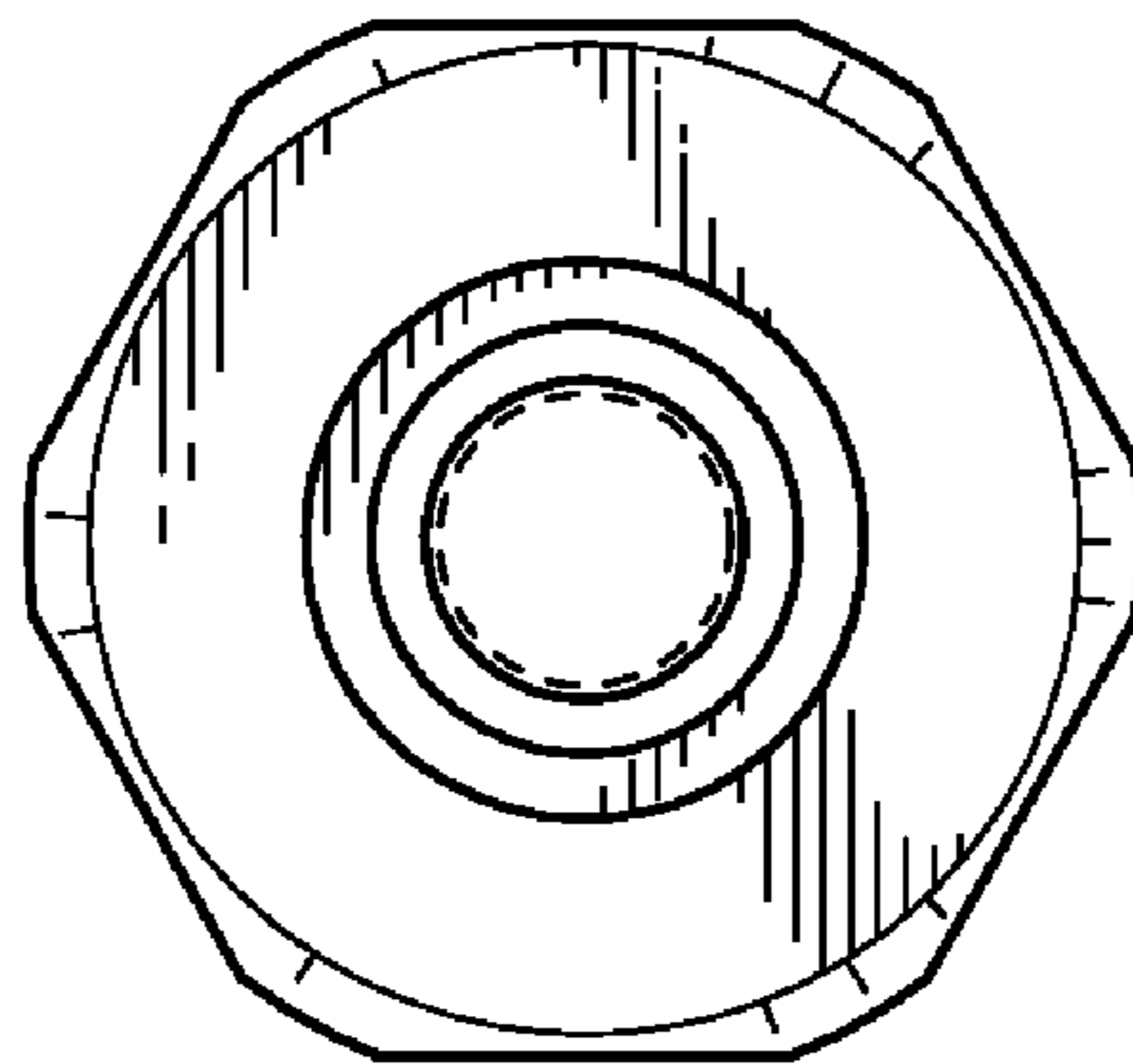

FIG. 5

